

Lansingburgh Central School District  
55 Turnpike Road  
Troy, NY 12182-2502

Visit us on our Web site:  
[www.lansingburgh.org](http://www.lansingburgh.org)

U.S. Postage Paid  
Non-Profit Organization  
Permit #642  
Troy, NY 12182-2502



# LANSINGBURGH — CENTRAL SCHOOL DISTRICT —

## CAPITAL IMPROVEMENT PROJECT

### ONE PER FAMILY

Dear parents, residents, community members, and faculty/staff,

On October 18, 2021, the Board of Education adopted a resolution approving a new capital improvement project bond vote for the Lansingburgh Central School District to take place on **December 7<sup>th</sup>, 2021**. If approved, the project will address a variety of necessary enhancements to the Rensselaer Park Elementary and Knickerbacker Middle School facilities. The project will include, among several other items, a cafeteria addition, turf softball field, track resurfacing, instructional space, building system upgrades, toilet room renovations, expanded parking, and kitchen equipment replacements.

The total project cost is \$16,664,405 of which the district is seeking approval from taxpayers for \$15,497,658. The difference would be made up with capital reserve funds, BOCES Coser, repair reserves, and American Rescue Funds. The district will receive back 92.3% through building aid and the remaining \$1,181,012, or 7.7% of the project, would be the responsibility of the taxpayer.

Residents are encouraged to review the information provided in this brochure and to attend the information session. If you have specific questions or comments, please contact Superintendent of Schools, Dr. Antonio Abitabile at (518) 233-6850 or email him at [aabitabile@lansingburgh.org](mailto:aabitabile@lansingburgh.org). Information is also available on our website at [www.lansingburgh.org](http://www.lansingburgh.org).

### The Lansingburgh Board of Education

- Michael Cusack, President
- Jason Shover, Vice President
- Andrea Fairhurst
- Jillian Manupella
- Daniella Richards
- Tina Rysedorph
- James Spear
- Jeffrey White
- Talia Pallozzi



### PUBLIC HEARING

**Tuesday  
November 23, 2021**

**6:00 p.m.**

**Turnpike  
Elementary School**

### Where to Vote:

**District 1** - Lansingburgh High School Gym Foyer, covers: north of 101st St. to South of 118th St.

**District 2** - Turnpike Elementary School gymnasium covers; North of 118<sup>th</sup> Street to the end of Pleasantdale; North drive; Corlis Park; Miami Beach Estates, Highpointe, all of Brunswick 7, and all of Speigletown.

### Financial Information

- Total Project cost is \$16,664,405.60
- Components of project paid through alternate funding:
  - Kitchen Equipment Upgrades - \$425,000
  - Security Camera Upgrades - \$51,000
  - Athletic track resurfacing - \$336,000
  - Air Conditioning/HVAC Upgrades - \$89,000
- Total amount seeking taxpayer approval is \$15,497,658.75
- Lansingburgh CSD would receive \$14,316,647 back in building aid or 92.3%
- The remaining \$1,181,012 will be the responsibility of the taxpayers
- Total Cost to the taxpayer based on an average assessed value per year:
  - Lansingburgh \$10.08
  - Brunswick \$14.05
  - Schaghticoke \$13.19
  - Pittstown \$0.28

### Eligibility

*In order to be eligible to vote, you must be:*

- A citizen of the United States.
- At least 18 years of age.
- A legal resident within the district for a period of 30 days immediately prior to December 7, 2021.

*Voters:*

- DO NOT have to own property.
- DO NOT have to be a parent or have children in school.

*Legal address is the address on your:*

1. Drivers license.
2. Federal Income Tax form.
3. Car registration form.
4. Where you are registered to vote in county, state and federal elections.

### Absentee Ballots

Absentee ballots, if delivered in person, must be delivered to the District Office by 5 p.m. on December 7. Absentee ballots, if mailed, must be received by the District Clerk by December 7. Absentee ballots can be picked up from the District Clerk, 55 Turnpike Road.

**Tuesday, December 7, 2021 ♦ 12pm - 9pm**

[www.lansingburgh.org](http://www.lansingburgh.org)

# LANSINGBURGH

## — CENTRAL SCHOOL DISTRICT —



### SCOPE OF WORK

#### ADDITIONS

- CAFETERIA ADDITION
- NEW KITCHEN SERVING LINE AND EQUIPMENT UPGRADES
- ADA ELEVATOR ADDITION

#### RENOVATIONS

- CAFETERIA RENOVATIONS
- CAFETERIA STAGE MODIFICATIONS/INSTRUCTIONAL
- GYMNASIUM UPGRADES (POSSIBLE DAYLIGHTING, LEAVE PARTITION)
- LOCKER ROOM RENOVATIONS 1 - (CONVERSION TO OFFICE, CLASSROOM, AND TOILET ROOMS)
- LOCKER ROOM RENOVATIONS 2 - (CONVERSION TO OT/PT, STORAGE, TOILET ROOMS, READING)
- ART ROOM UPGRADES (FINISHES, CABS, CLAY TRAPS, KILN VENTILATION)
- UPGRADE REMAINING TOILET ROOMS (GANG AND INDIVIDUAL CLASSROOM)
- REPLACE REMAINING DRINKING FOUNTAINS W/ ADA BOTTLE FILL UNITS
- REMOVE CORRIDOR BLEACHERS AND CONVERT TO STORAGE AND DISPLAY CABINETS
- INSTALL BLEACHERS IN CAFETERIA

#### FLOORING REPLACEMENT

- REPLACE FLOORING IN CLASSROOM BATHROOMS

#### OTHER UPGRADES (SITE & BUILDING SYSTEMS)

- ADD MORE PARKING
- REPLACE SIDEWALK BY GYM AND FRONT ENTRANCE
- PLAYGROUND RELOCATION AND REPLACEMENT
- RELOCATE BUS DROP OFF
- RAISED GARDEN BEDS
- NEW SYNTHETIC TURF FIELD WITH DUGOUTS, LIGHTING, BLEACHERSTAND SCOREBOARD
- OUTDOOR CLASSROOM
- REPLACE GYMNASIUM HVAC UNITS
- REPLACE MEDIA CENTER ROOF TOP UNIT
- RELOCATE OR MODIFY EXHAUST FANS OVER NURSES OFFICE (TOO LOUD)
- REPLACE REMAINING EXHAUST FANS - UPGRADE VENTILATION (COVID MODS)
- REPAIR CATCH BASINS
- REPLACE HOT WATER HEATER
- REMOVE AMC IN BOILER AND STORAGE ROOM
- REPLACE INACCESSIBLE CLEANOUTS ON DRAINAGE LINES
- PROVIDE ISOLATION VALVES ON HEATING AND DOMESTIC WATERSYSTEMS
- REPLACE / REPAIR NECESSARY ROOF DRAINS AND SANITARY LINES
- REPLACE PA SYSTEM - SIMPLEX (TIE IN PHONES)
- FIRE ALARM PANEL REPLACEMENT - SIMPLEX
- LED LIGHTING UPGRADES EXTERIOR
- LED LIGHTING UPGRADES INTERIOR

### FIRST FLOOR PLAN

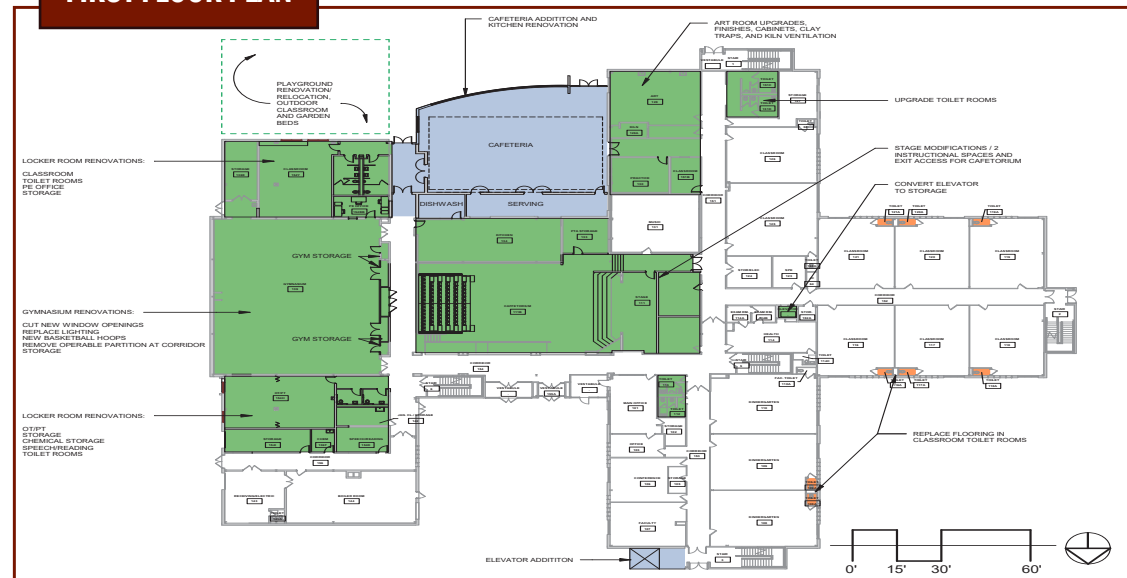

### SITE PLAN

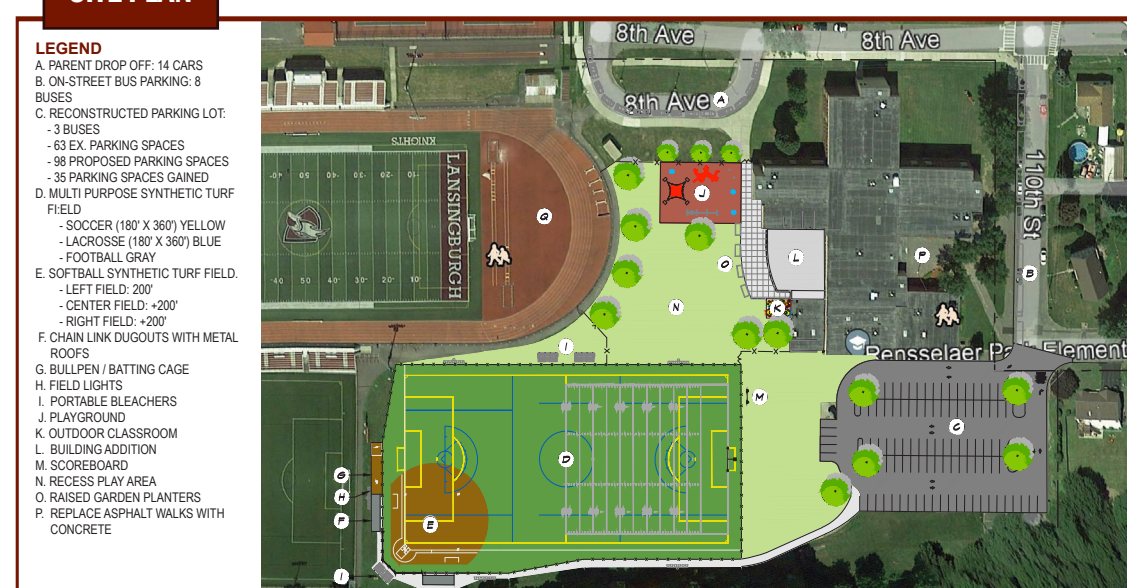

### RENDERING OF CAFETERIA ADDITION AT RENSSELAER PARK



### RENDERING OF CAFETERIA ADDITION AT RENSSELAER PARK

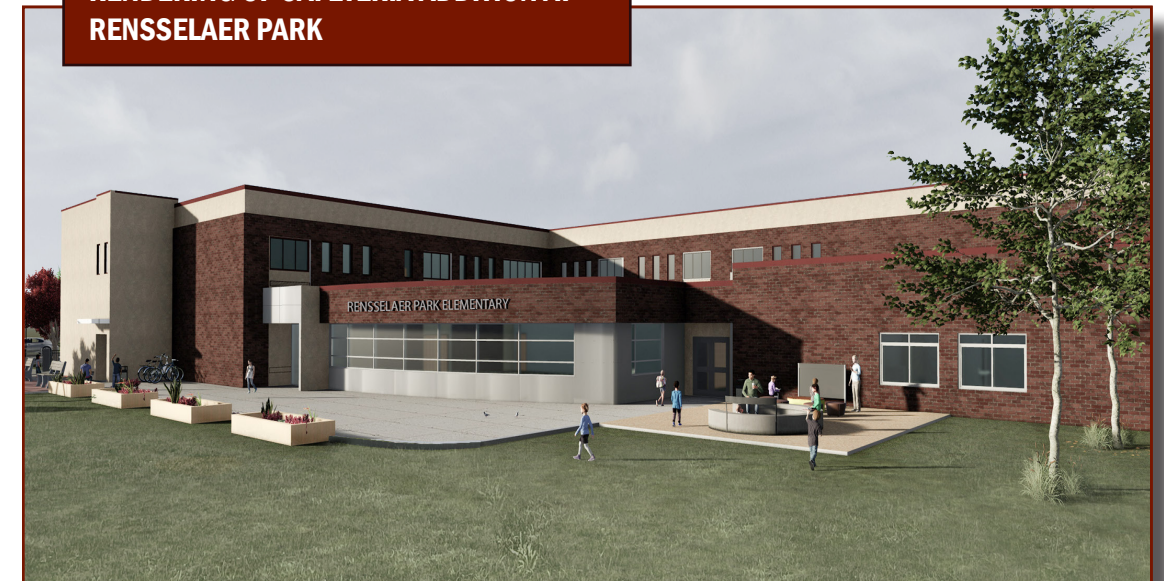

AGING ART CLASSROOM CASEWORK AND FIXTURES

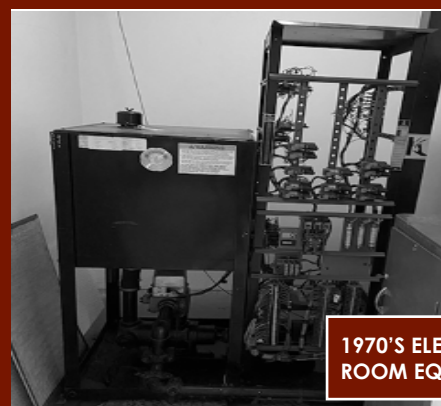

1970'S ELEVATOR & MACHINE ROOM EQUIPMENT



AGING TRACK SURFACE

YOUR



OTE COUNTS!