



Mount Pleasant Central School District **2023 Instructional Bond**

September 2023



Scope of Work Summary

District-Wide Safety, Security & Wellness

- New secure entrance vestibules
- Security cameras and devices
- Air conditioning at all gymnasiums and new construction

Hawthorne

- Reconfiguration of Kindergarten Classrooms and 4-classroom kindergarten addition
- Reorganization to cluster students by grade level and to centralize special area instruction and services
- New centralized area for performing arts, visual arts, STEM and Library/Media Center for school-wide events and community-use.

Columbus

- Classroom renovations to support small group instruction and support services
- Renovations to create a new Band Classroom and group collaboration
- New STEM Lab and 3-classroom addition



Scope of Work Summary

Westlake Middle School

- Science Lab renovations
- Locker Room renovation

Westlake High School

- Gut renovation of the theater including lighting, rigging and acoustics.
- Science Lab renovations
- Studio art classroom renovations and new STEM Lab/Makerspace
- Cafeteria addition and, Cafeteria & Kitchen renovation

Westlake Middle School High School Library

- Renovations to create a flexible modern media center to research, create, learn and innovate



Why?

- Space in general is limited and there is a lack of flexibility
- School lacks departmental/instructional spatial organization (especially Kindergarten)
 - Student support spaces are small and limited
 - **6 out of 7 Kindergarten Classrooms are undersized**
 - Music space, Library and STEM are undersized
 - Antiquated bathrooms

Good Practice

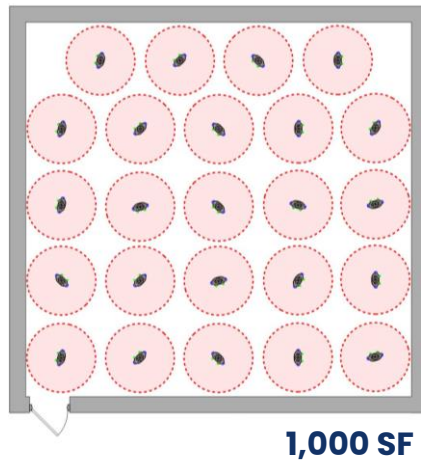

SED Minimum

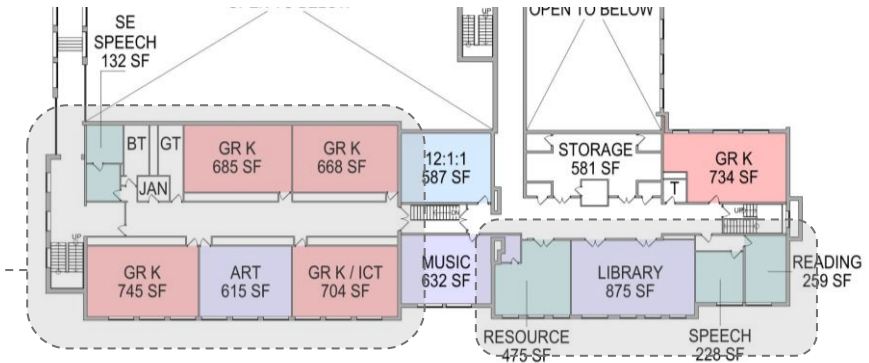
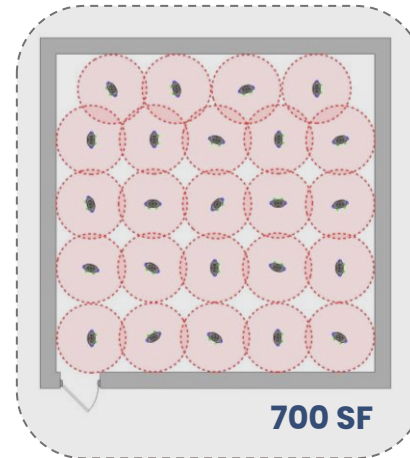
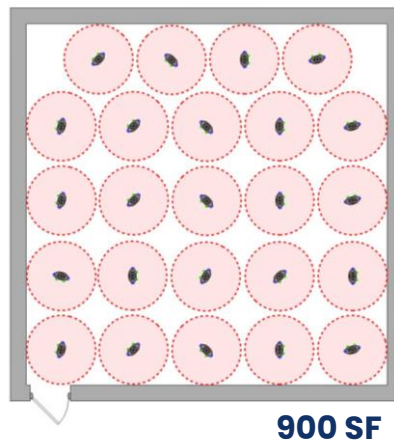

Kindergarten Classroom Addition & Reorganization

Partial Floor Plans - Proposed

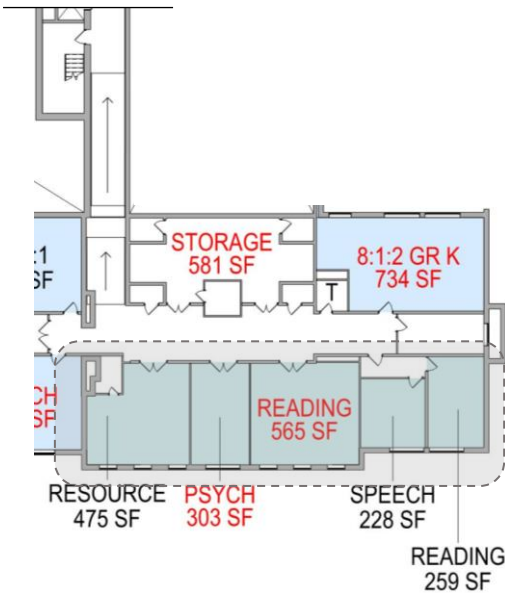
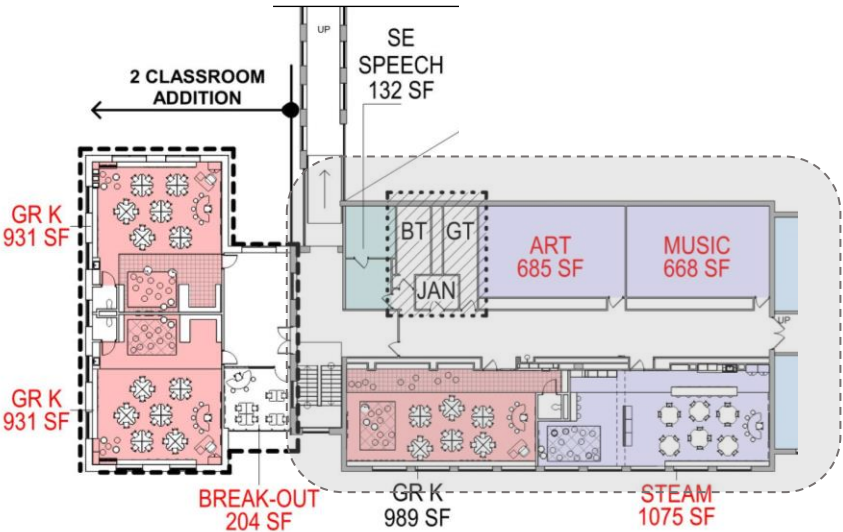
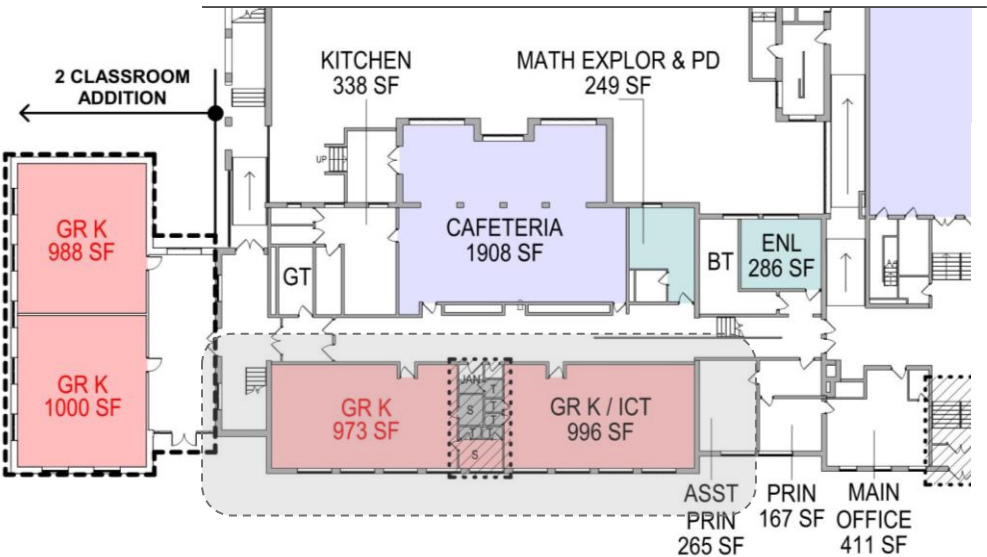

Program Legend

- GR K
- Essentials
- Special education
- Student services

Scope of Work Legend

- Renovation
- New addition
- XX New or relocated program
- XX Existing program

Mount Pleasant Central School District

Educating Each Student Today for Endless Possibilities Tomorrow

Hawthorne proposed



Existing Photos

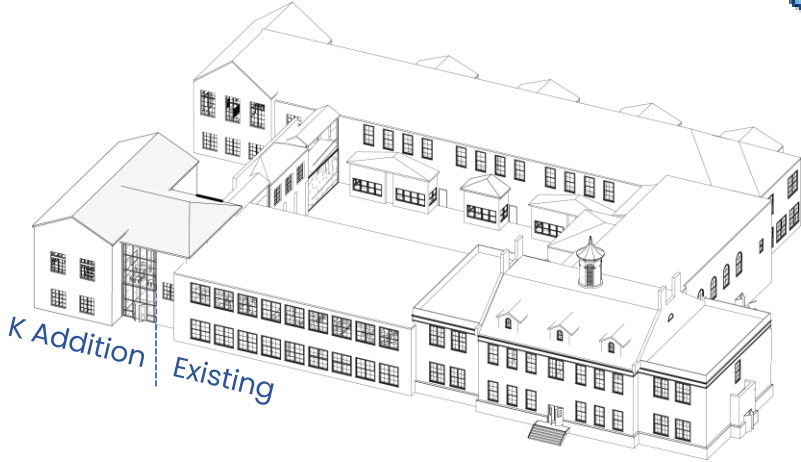

Proposed K Addition





Right-Sized 21st Century Kindergarten Classroom

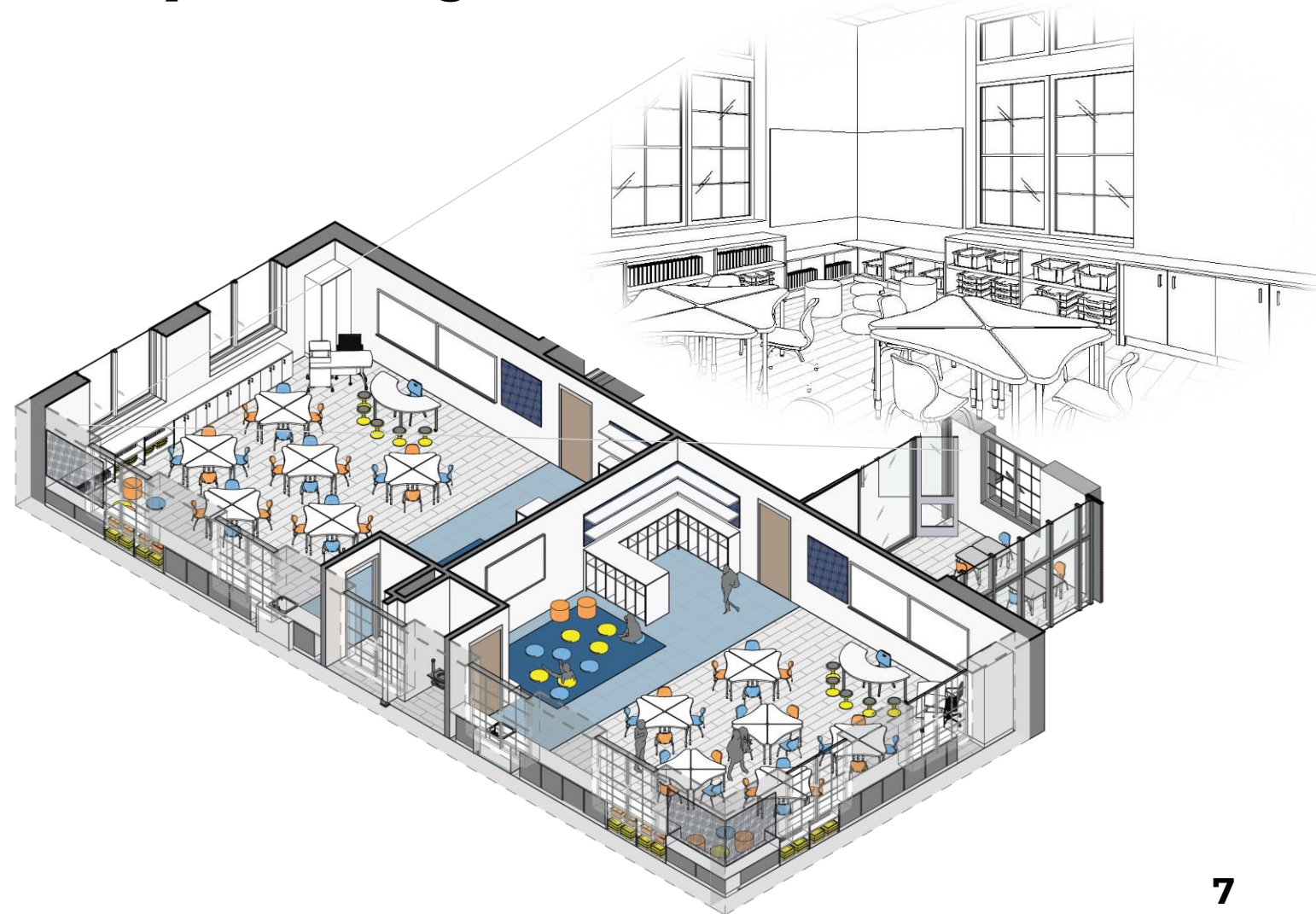
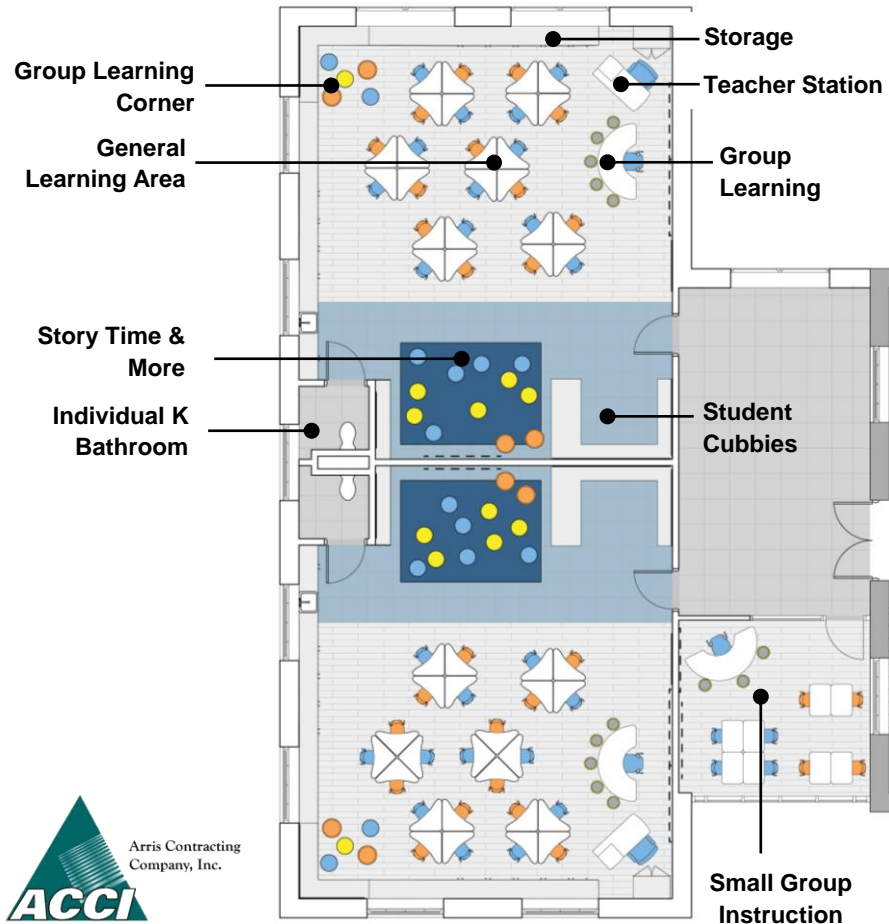



Right-Sized 21st Century Kindergarten Classroom

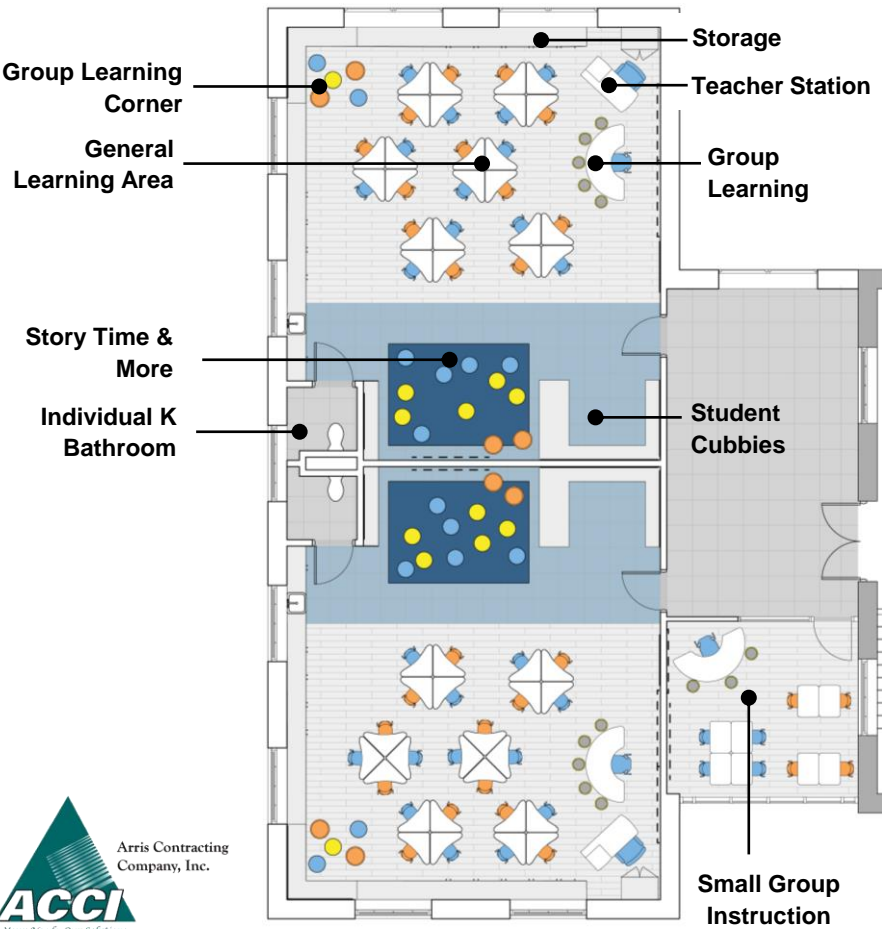



STEM Lab

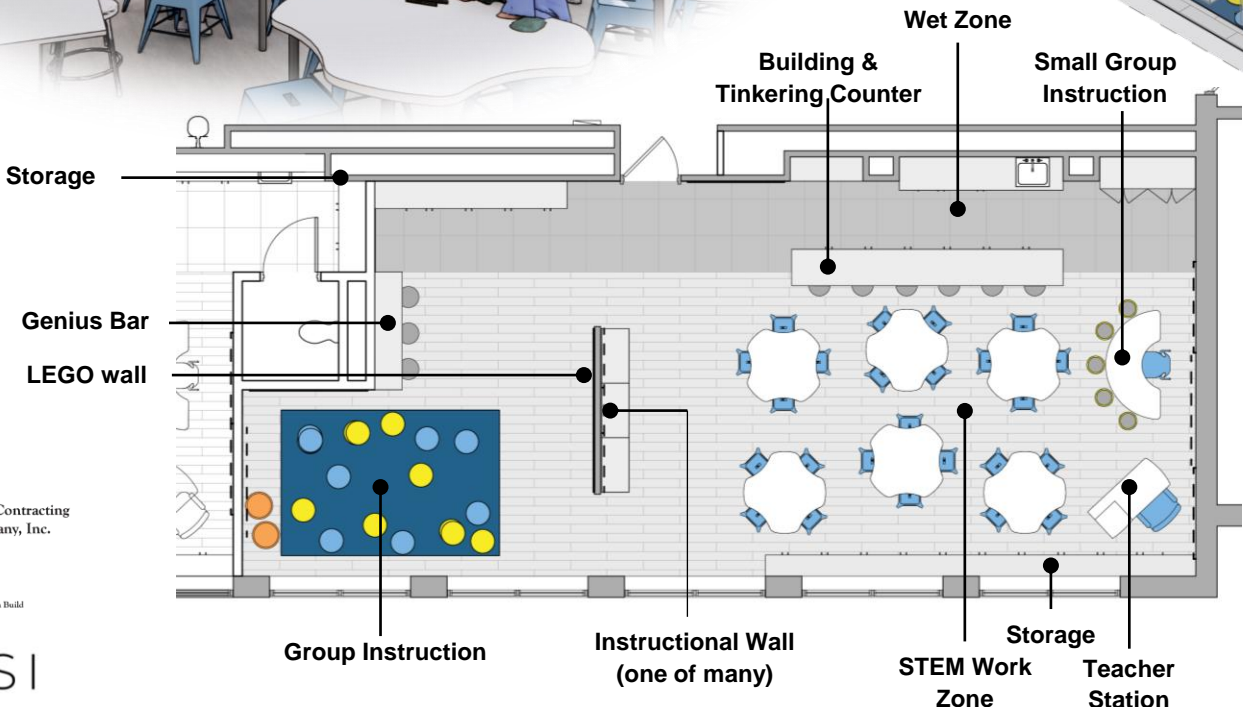
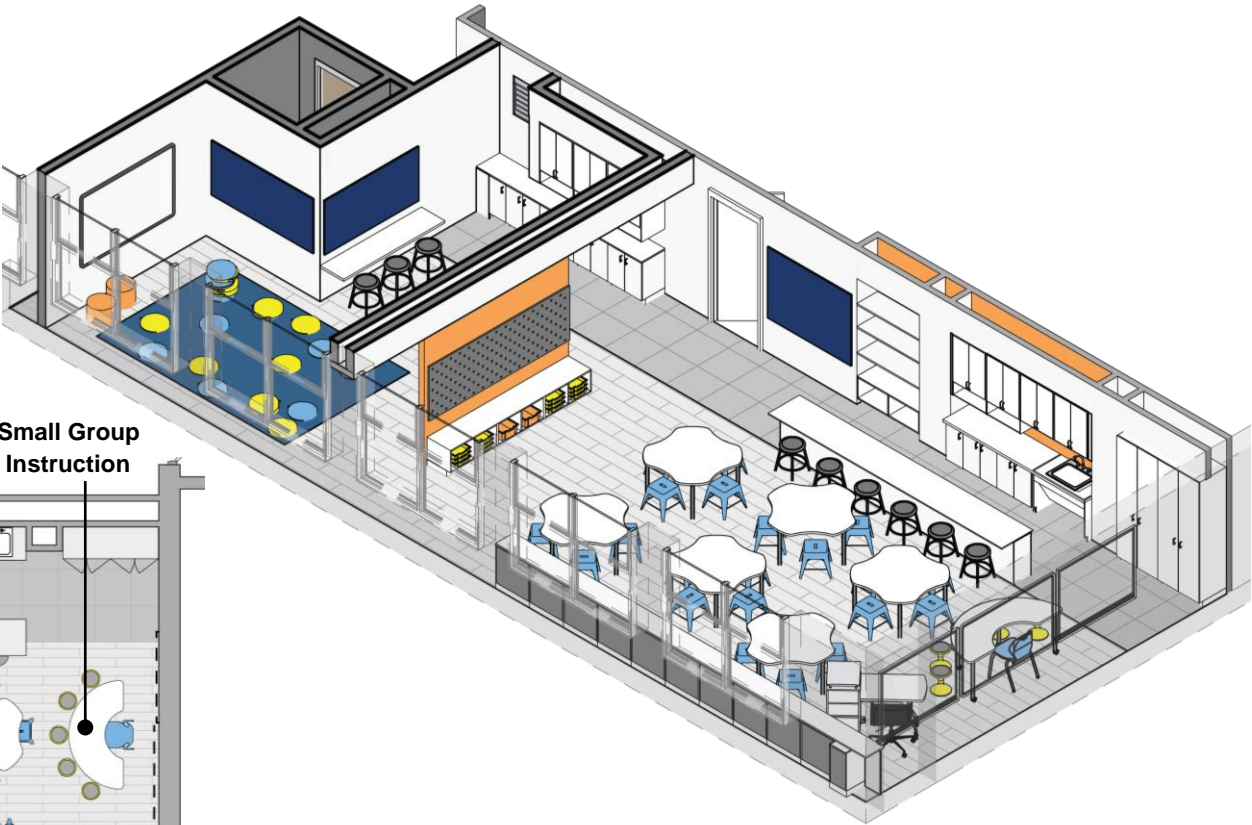



Library Media Center

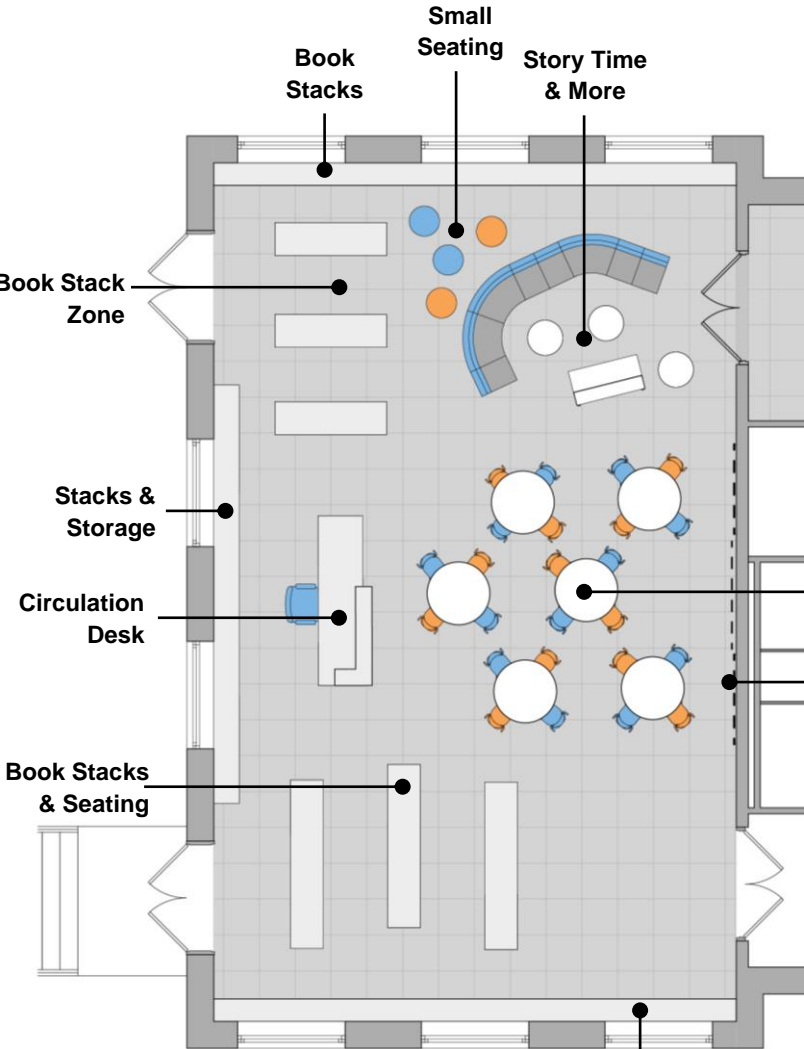

Group Instruction
Instructional Wall

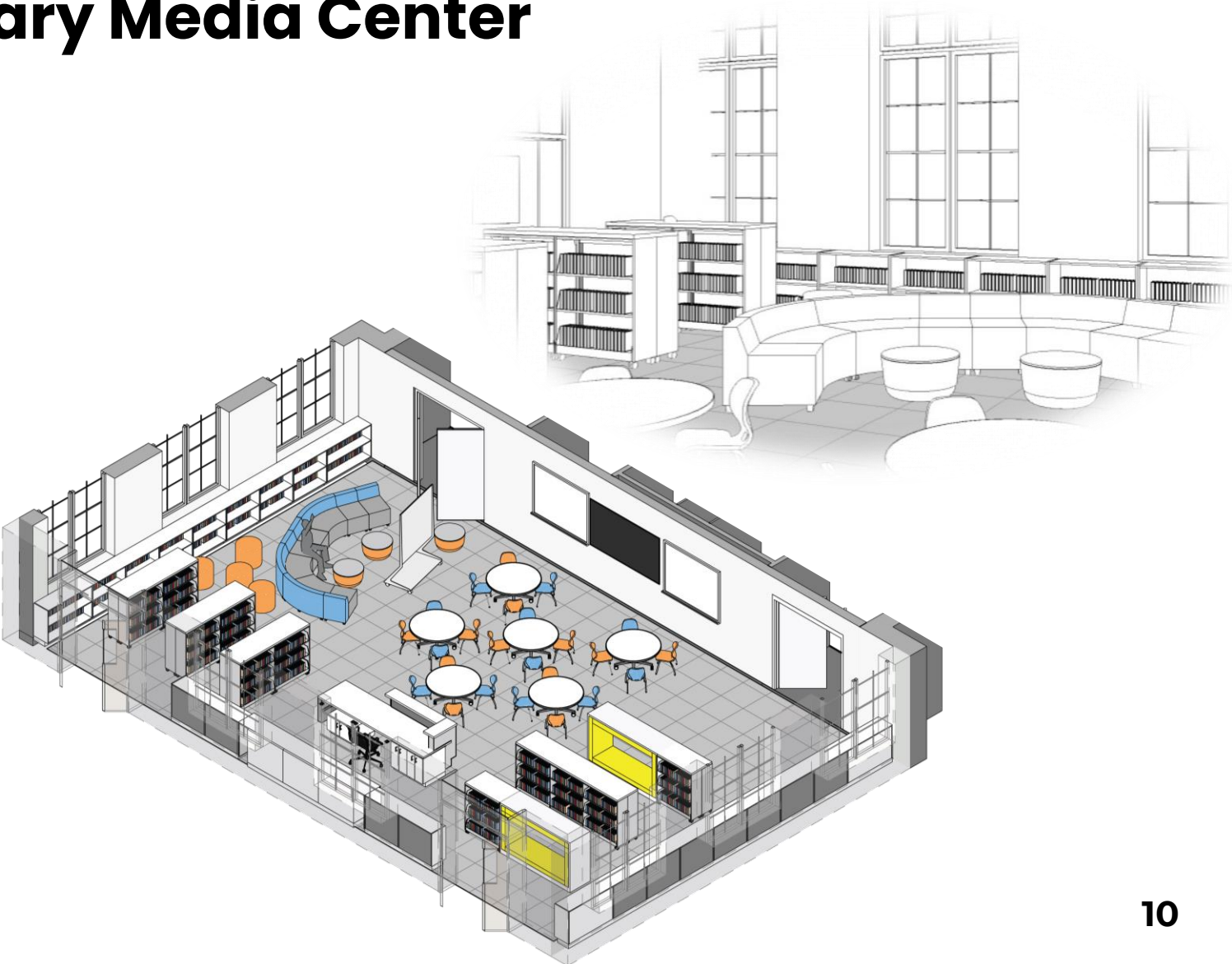



Library Media Center

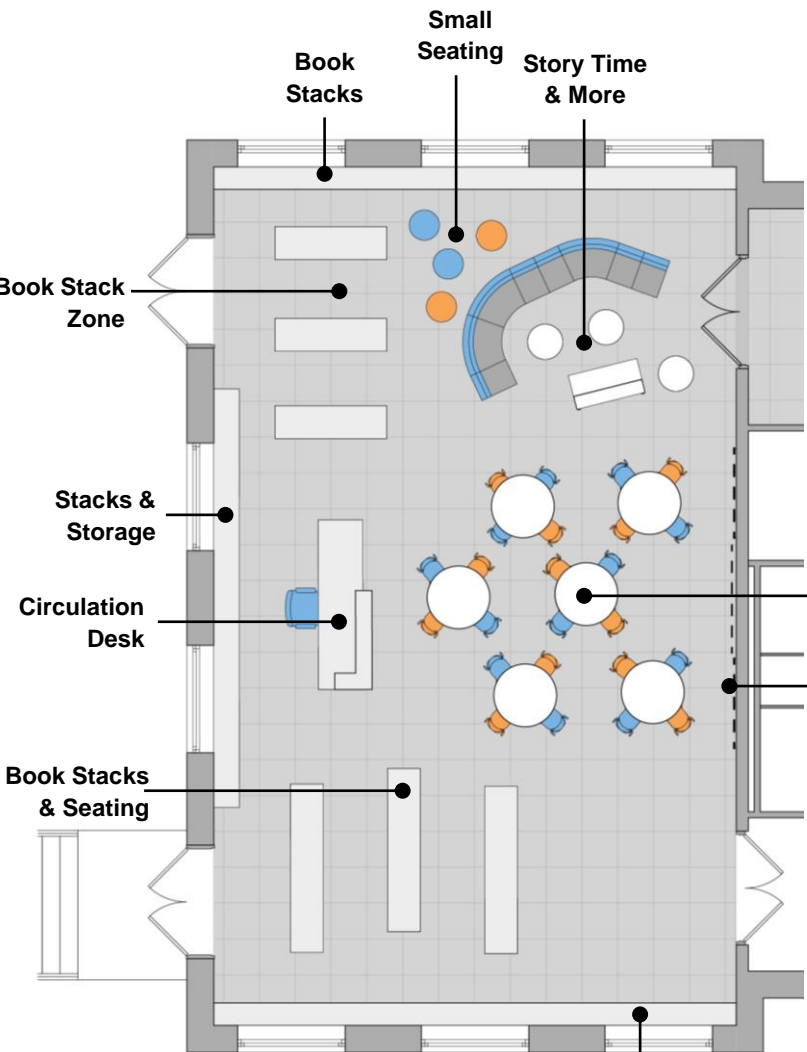

Group Instruction
Instructional Wall





Why?

- Space in general is limited and school is at capacity
- School lacks small group instructional space and student support service spaces
 - OT/PT and (1) additional Self-Contained SE Education classroom is needed
- Band takes place on the stage - school needs an Orchestra room for its newly created program

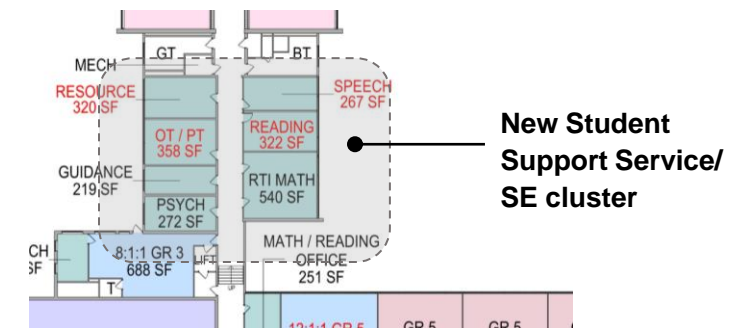
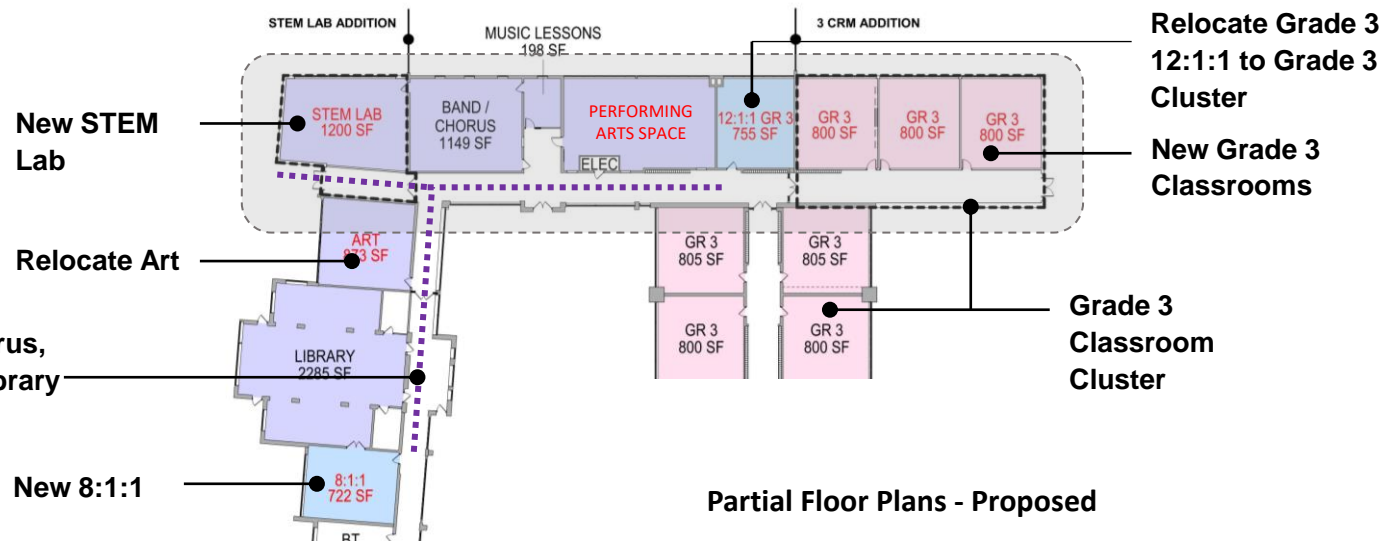

Program Legend

GR 3	XX Existing program
Essentials	XX New or Relocated Program
Special education	
Student services	



STEM Lab, Classroom Addition and Reorganization

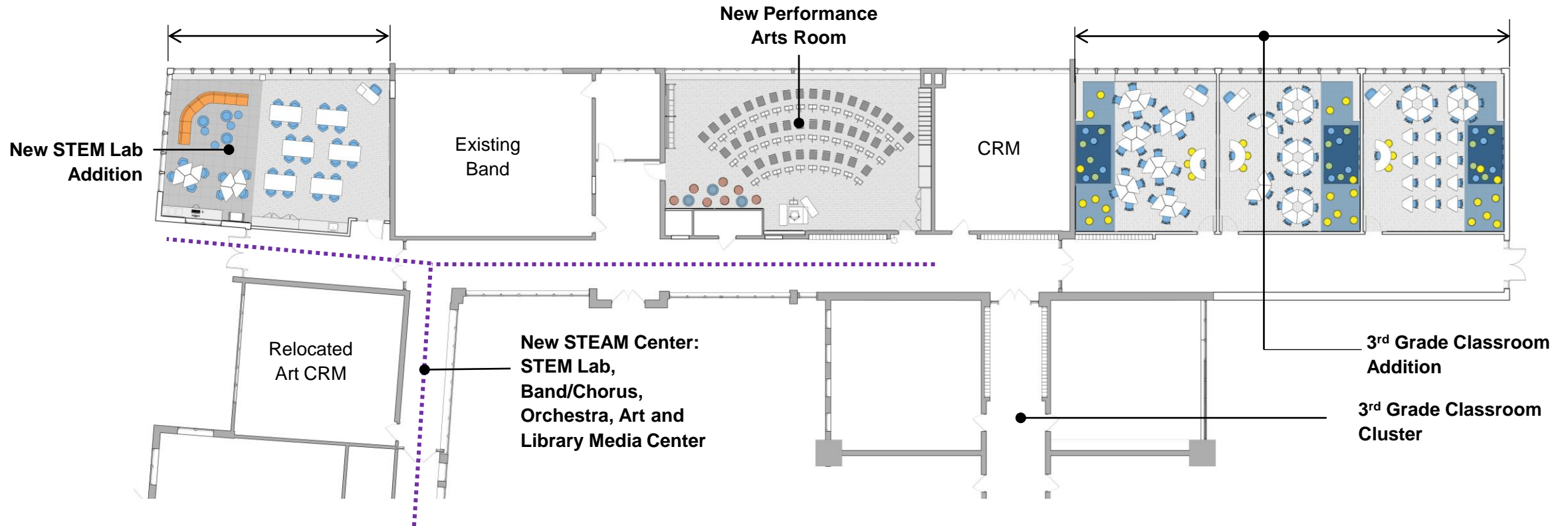

Partial Floor Plan - Proposed



Performance Art Space

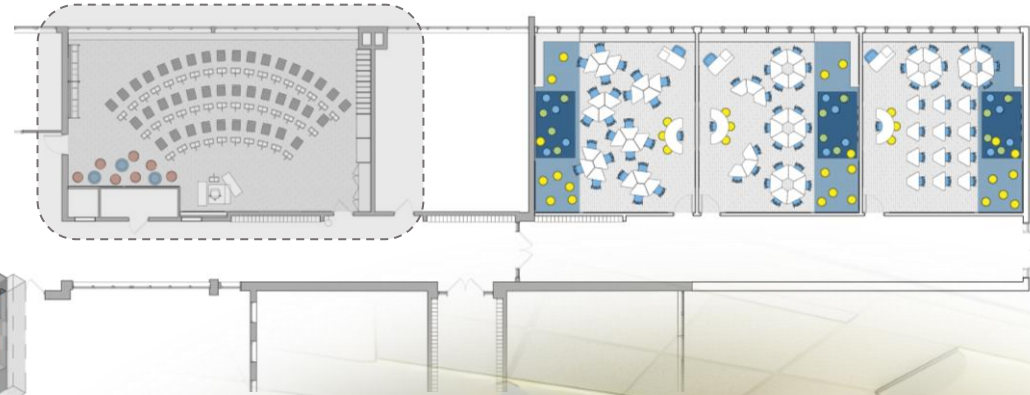
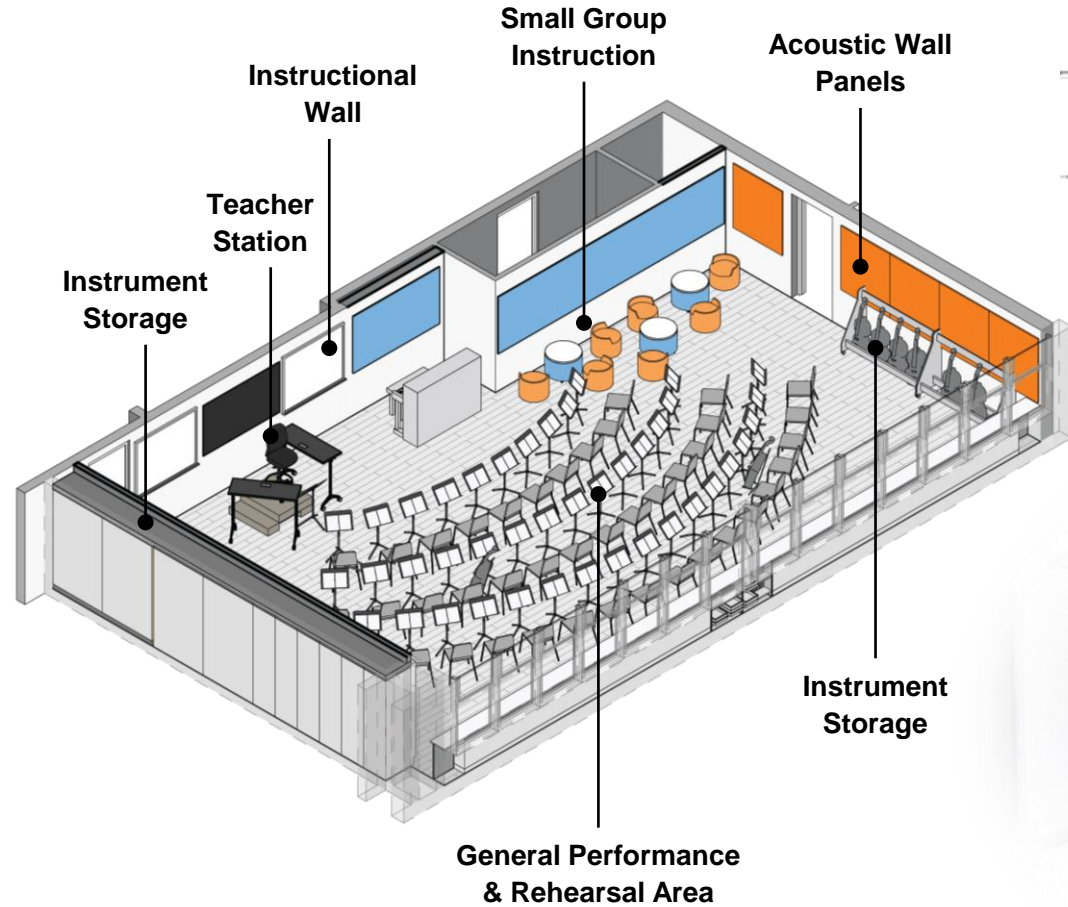



STEM Lab

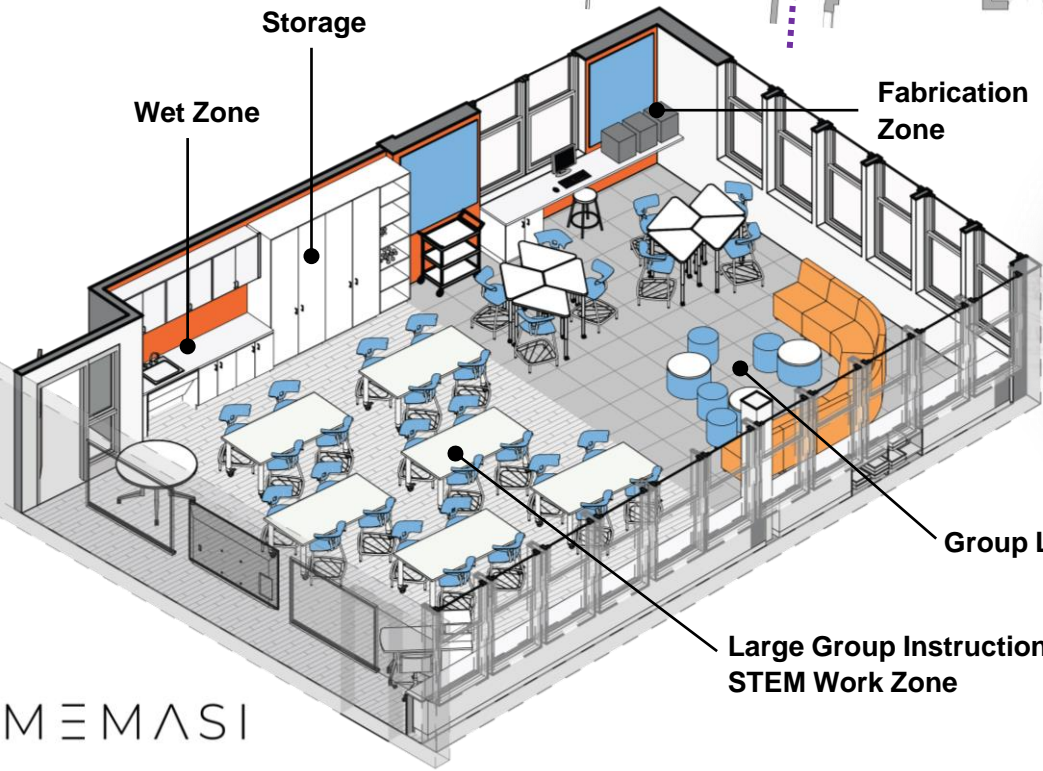
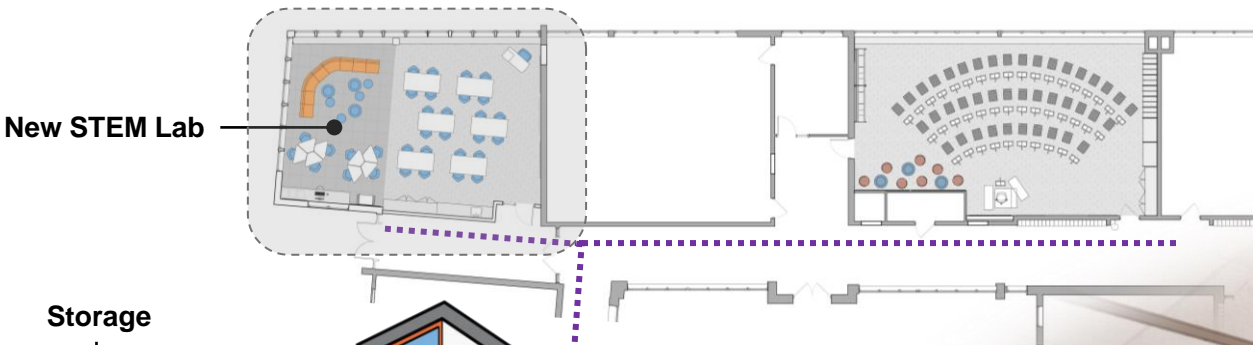



New Classroom

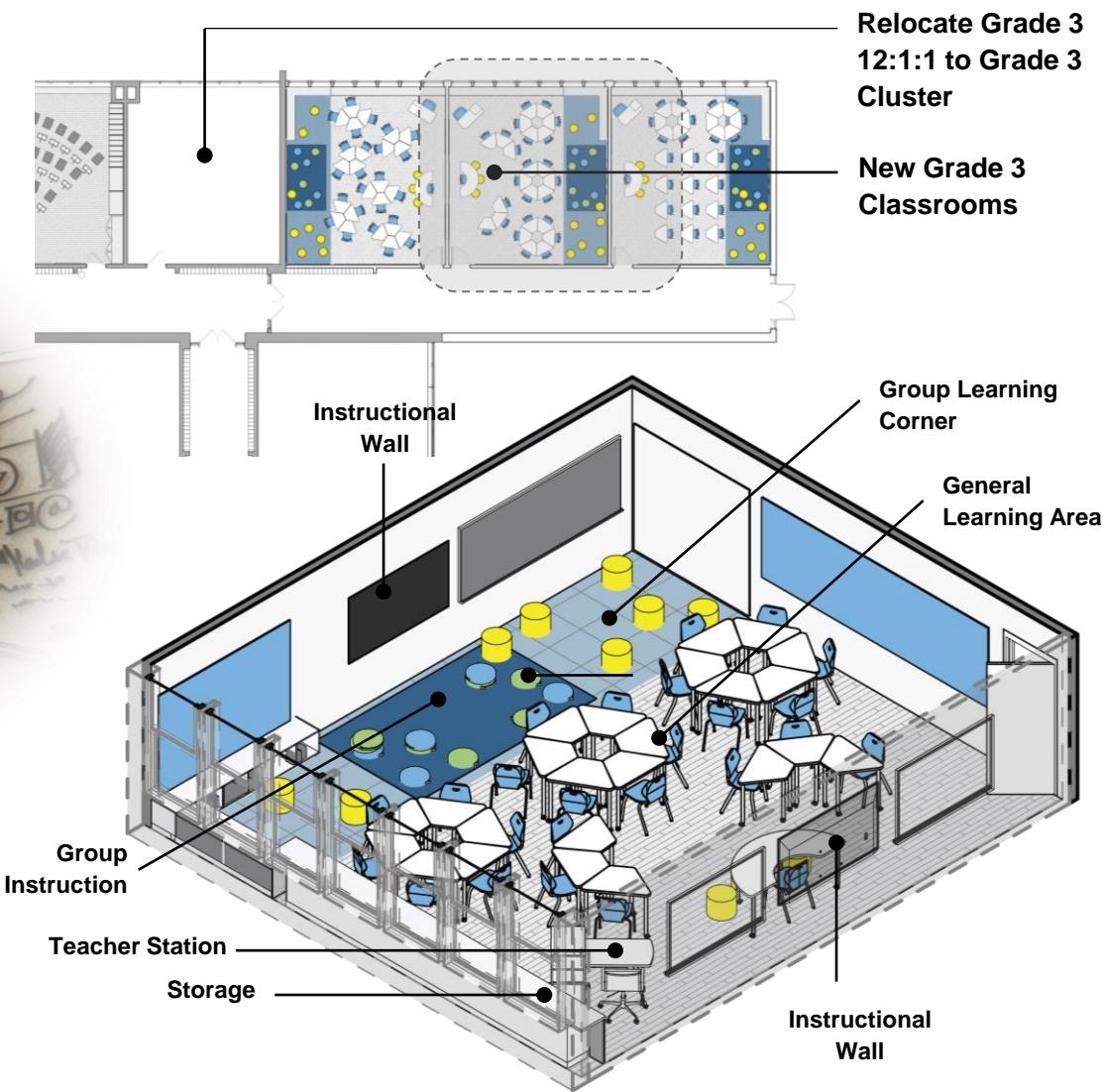



Why?

- Science Labs are rigid – lack of flexibility
- Locker Rooms are original and antiquated

Science Classroom Renovations Legend

RENOVATION LV-01 NEW CEILINGS, LIGHTING, FLOORING, LOOSE FURNITURE AND WRITE-ON WALL SURFACE

RENOVATION LV-02 REMOVE AND REPLACE ALL MILLWORK/CASEWORK. NEW FLOORING, LIGHTING, LOOSE FURNITURE AND WRITE-ON WALL SURFACE

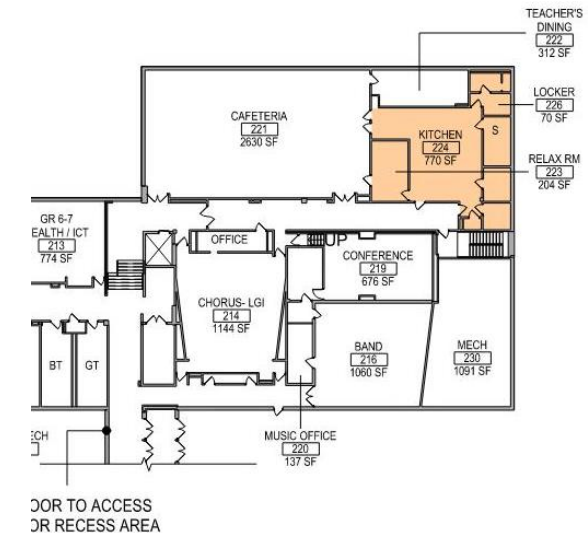
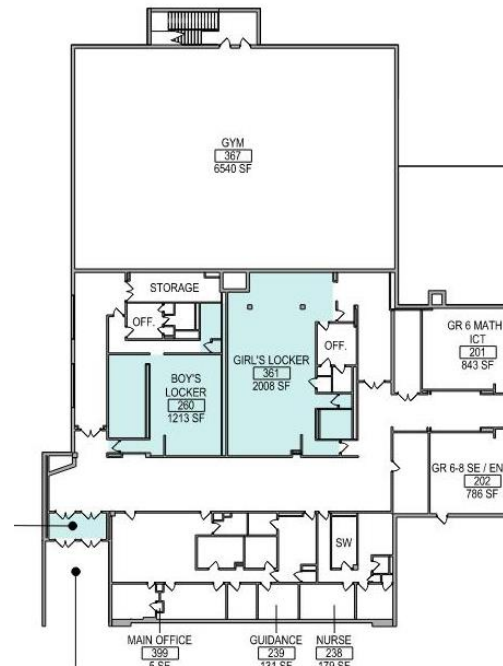
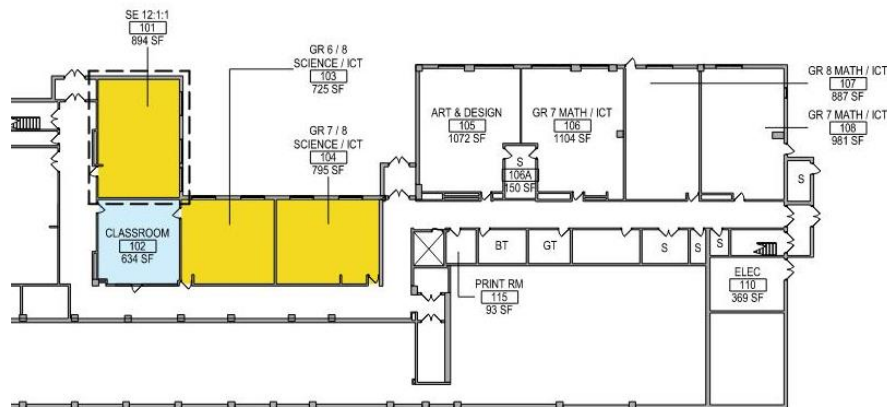

Partial Plan – Scoping Diagrams



Science Lab

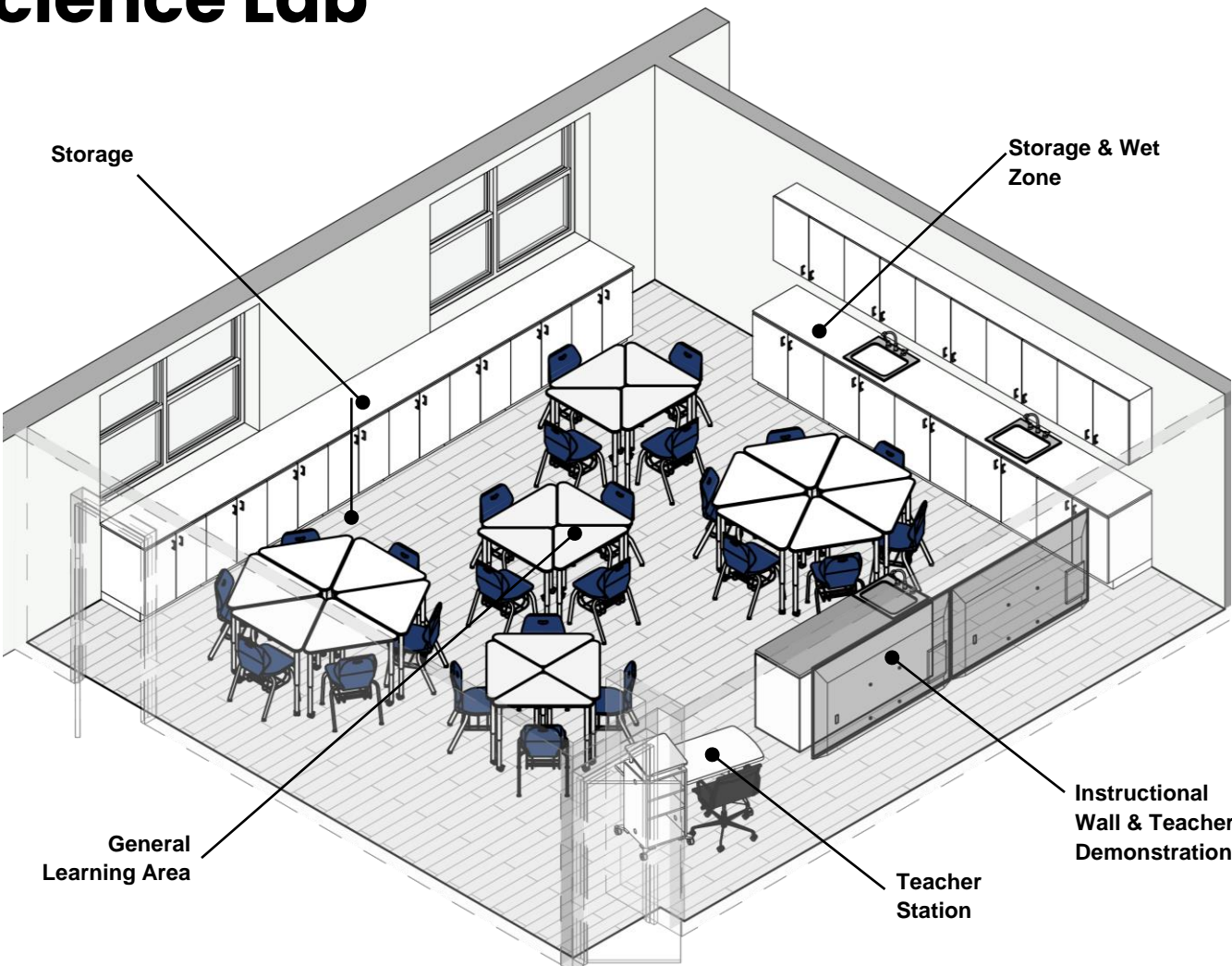

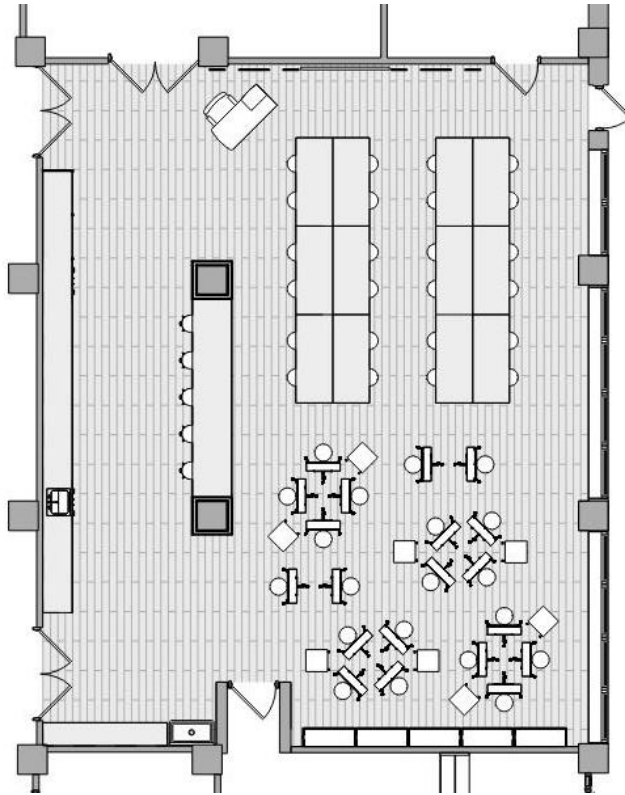

Renovation Legend

- Major renovation
- Minor to moderate renovation

Why?

- Science Labs are rigid – lack of flexibility
- School lacks STEM, Engineering Space and Makerspace
- Auditorium lighting, rigging, and audiovisual are antiquated
- Studio Art Classroom is original

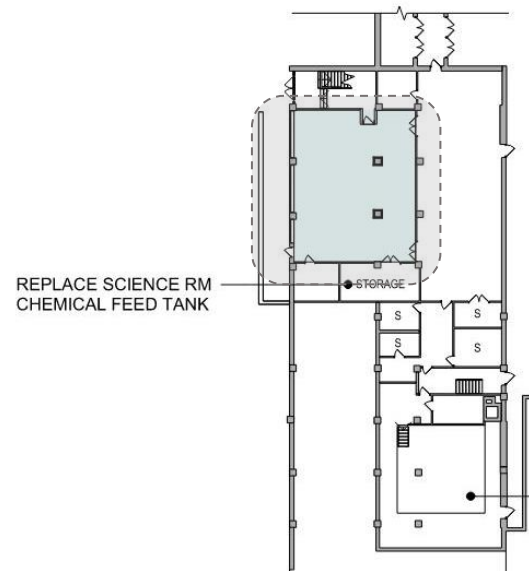

Partial Plan – Scoping Diagram

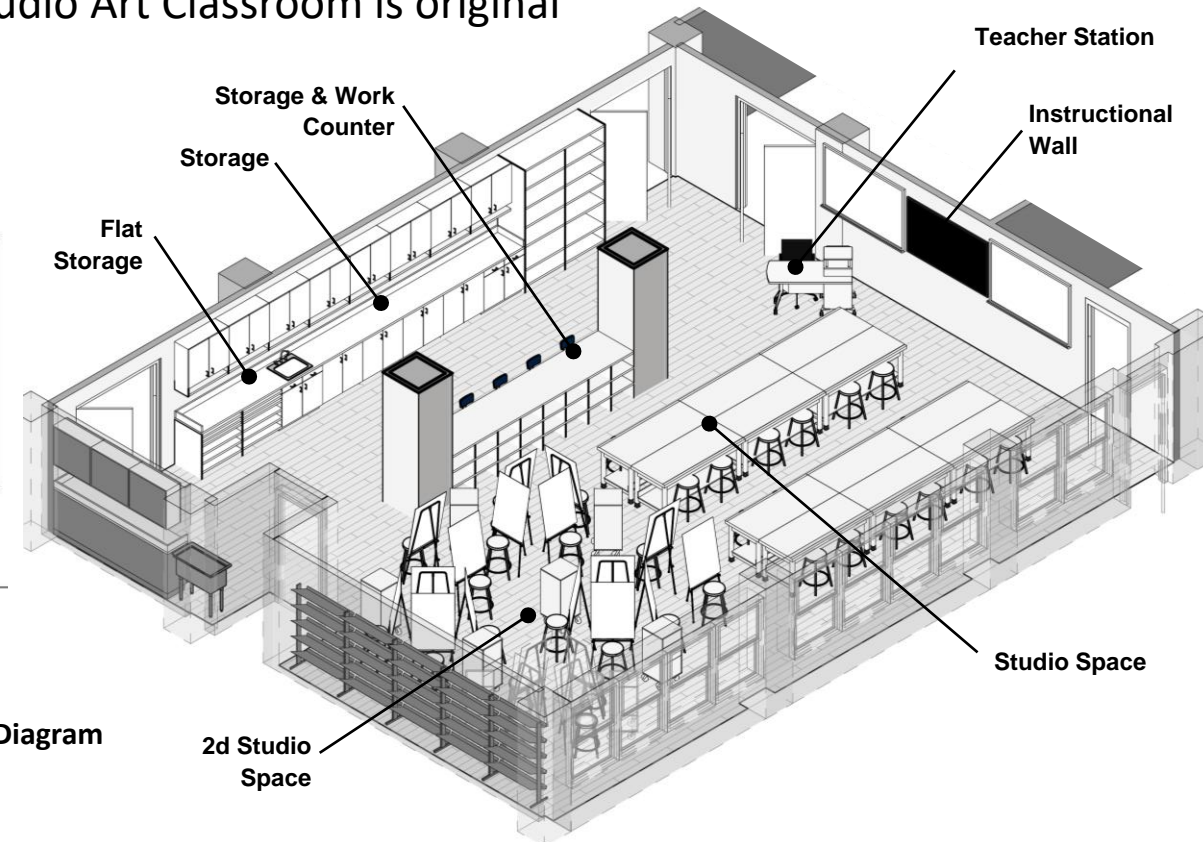



Science Classroom Renovations Legend

- RENOVATION LV-01** NEW CEILINGS, LIGHTING, FLOORING, LOOSE FURNITURE AND WRITE-ON WALL SURFACE
- RENOVATION LV-02** REMOVE AND REPLACE ALL MILLWORK/CASEWORK. NEW FLOORING, LIGHTING, LOOSE FURNITURE AND WRITE-ON WALL SURFACE
- RENOVATION LV-03** REMOVE AND RELOCATE CASEWORK ALONG WALL TO BE DEMOLISHED, NEW FLOORING, LIGHTING, LOOSE FURNITURE AND WRITE-ON WALL SURFACE

Renovation Legend

- Major renovation
- Minor to moderate renovation
- XX** Existing Program
- XX** New or relocated program

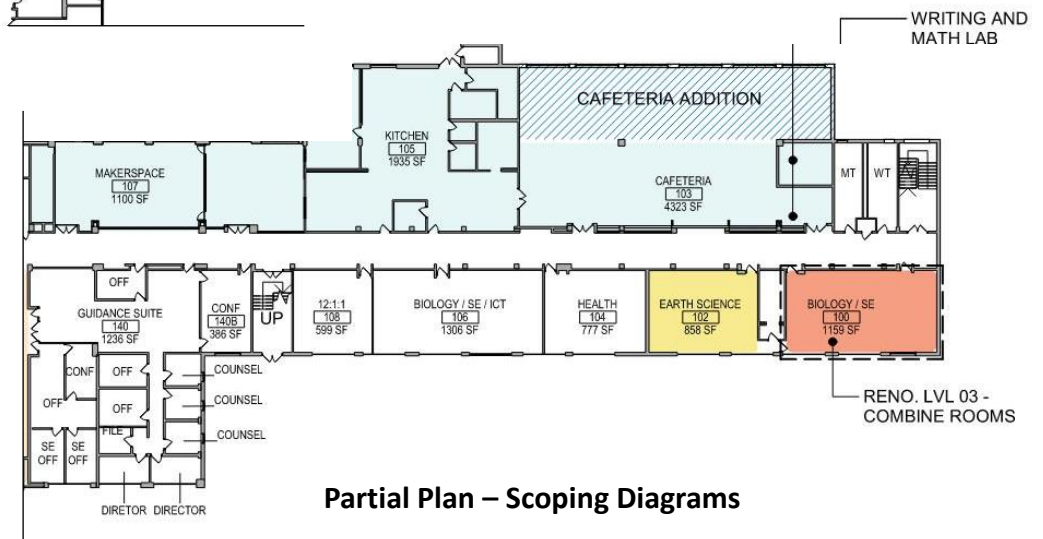
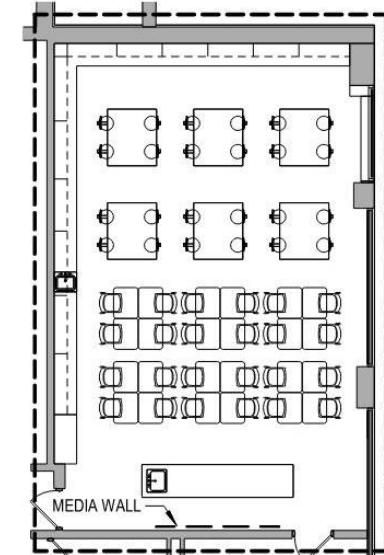
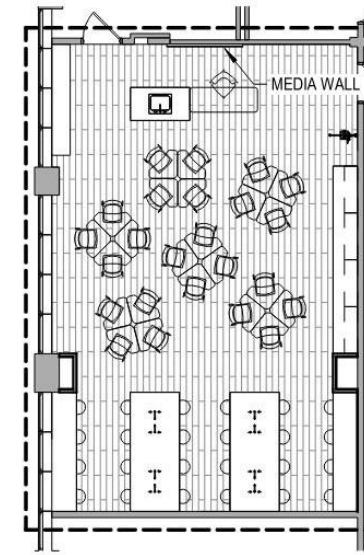
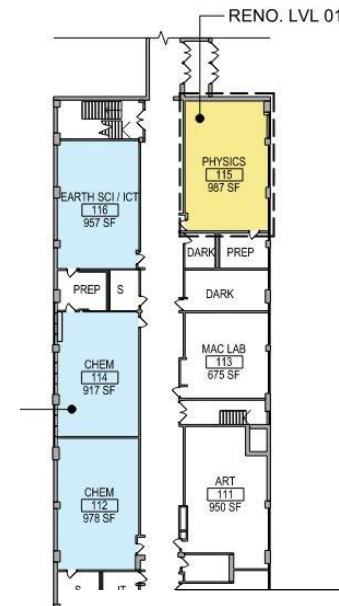

Partial Plan – Scoping Diagrams



Chemistry Lab

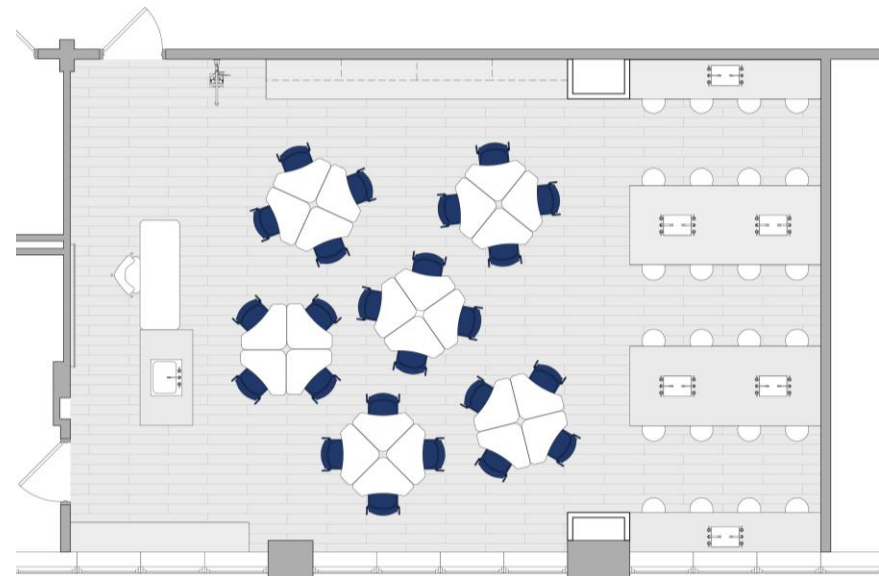
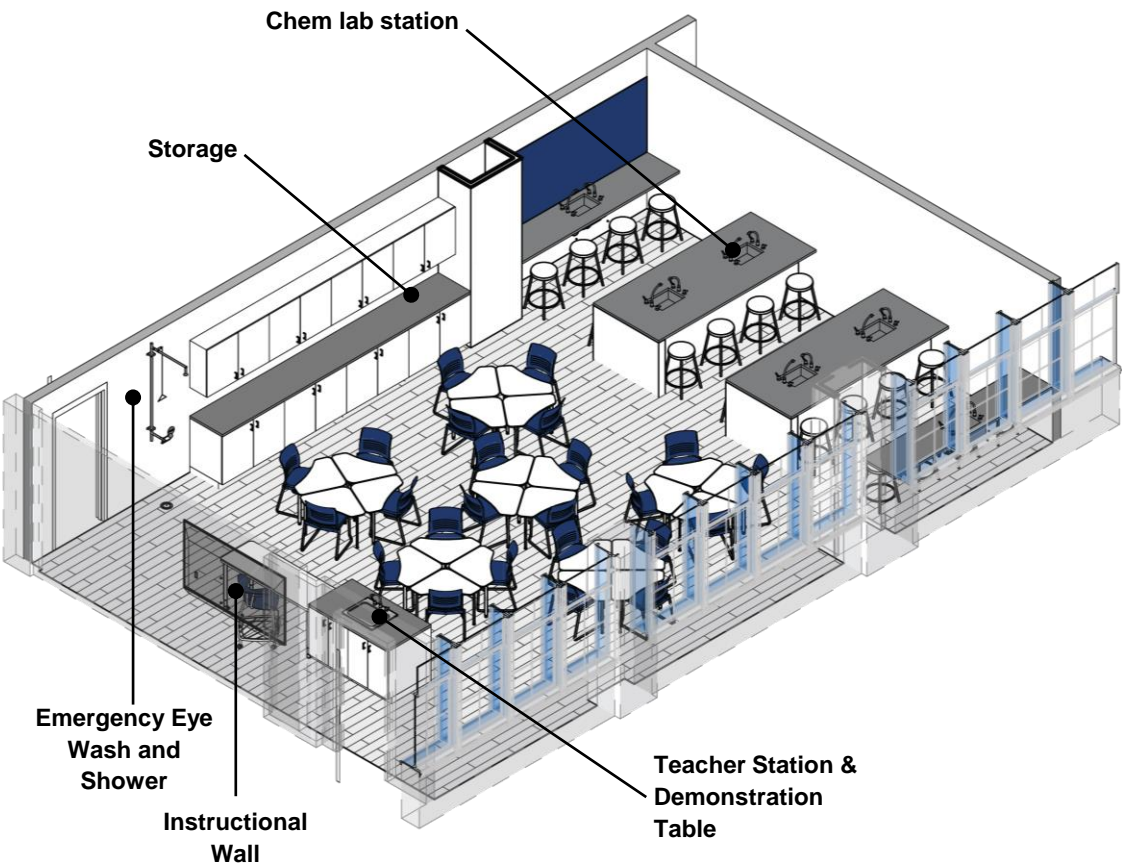

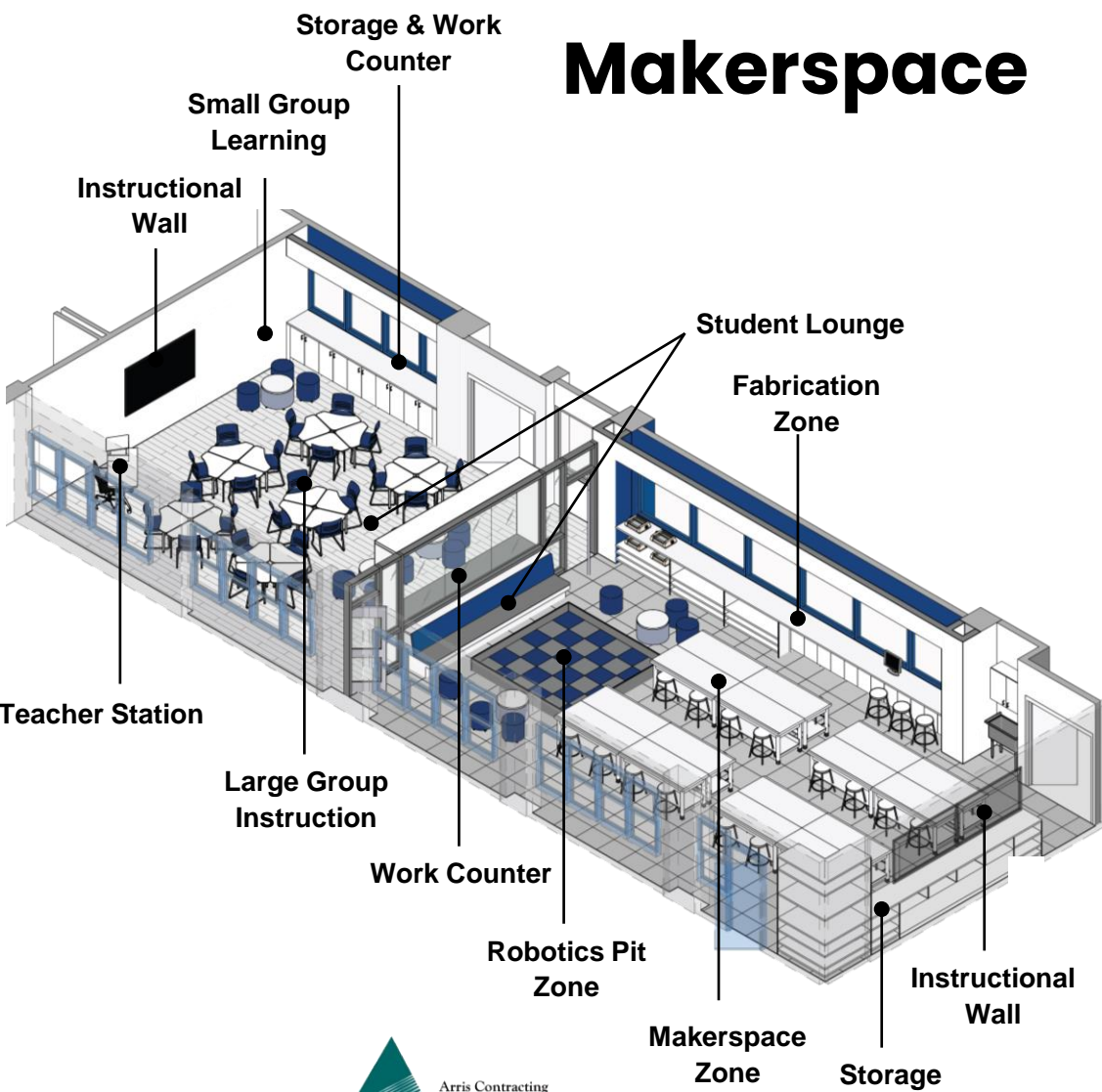

Makerspace

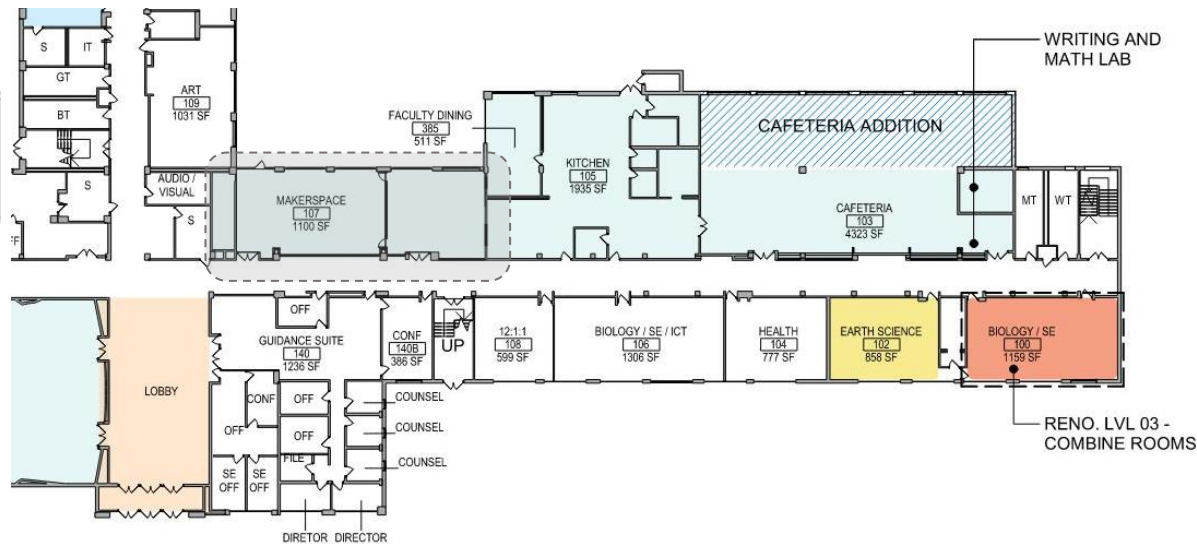
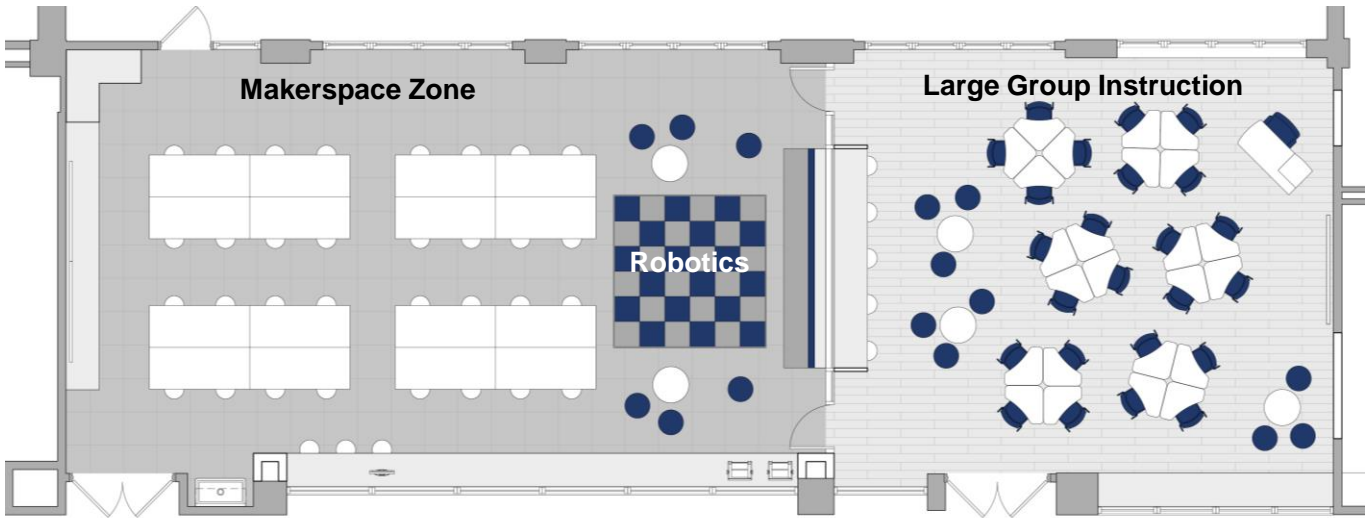



Cafeteria

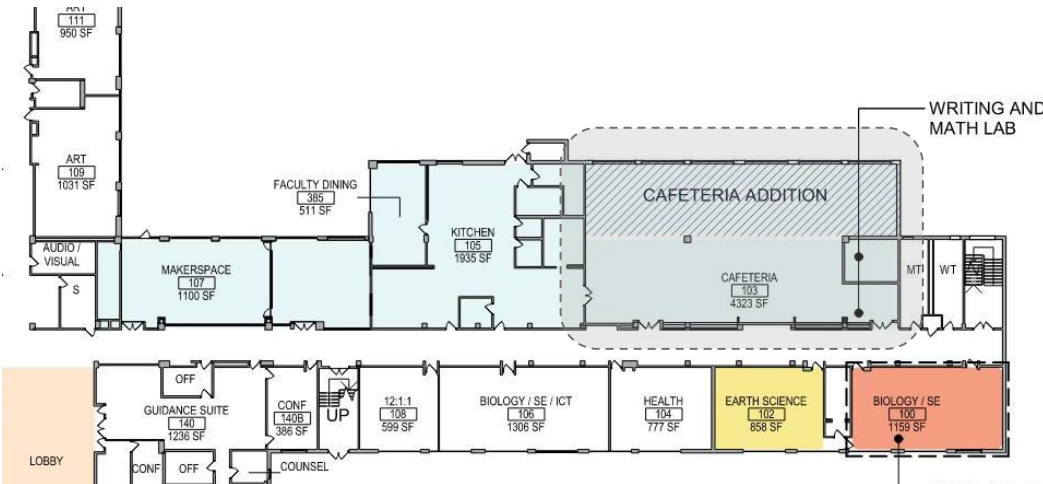
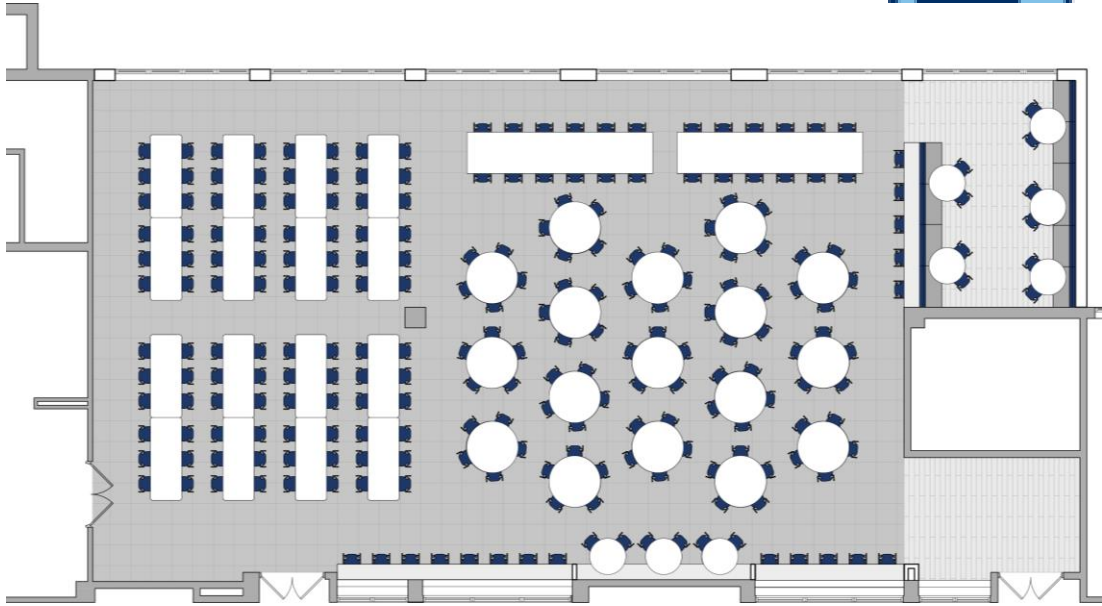
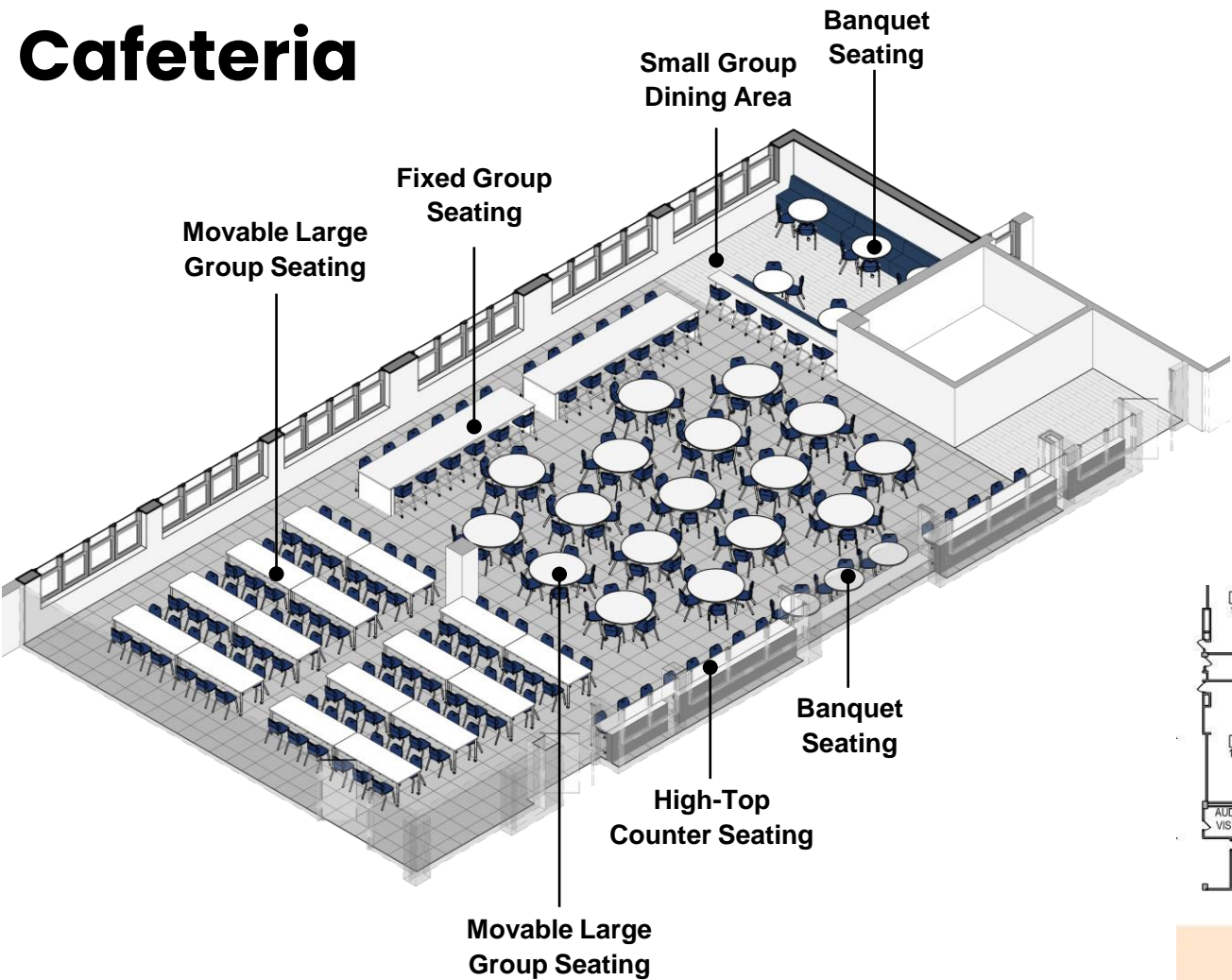



Westlake Library

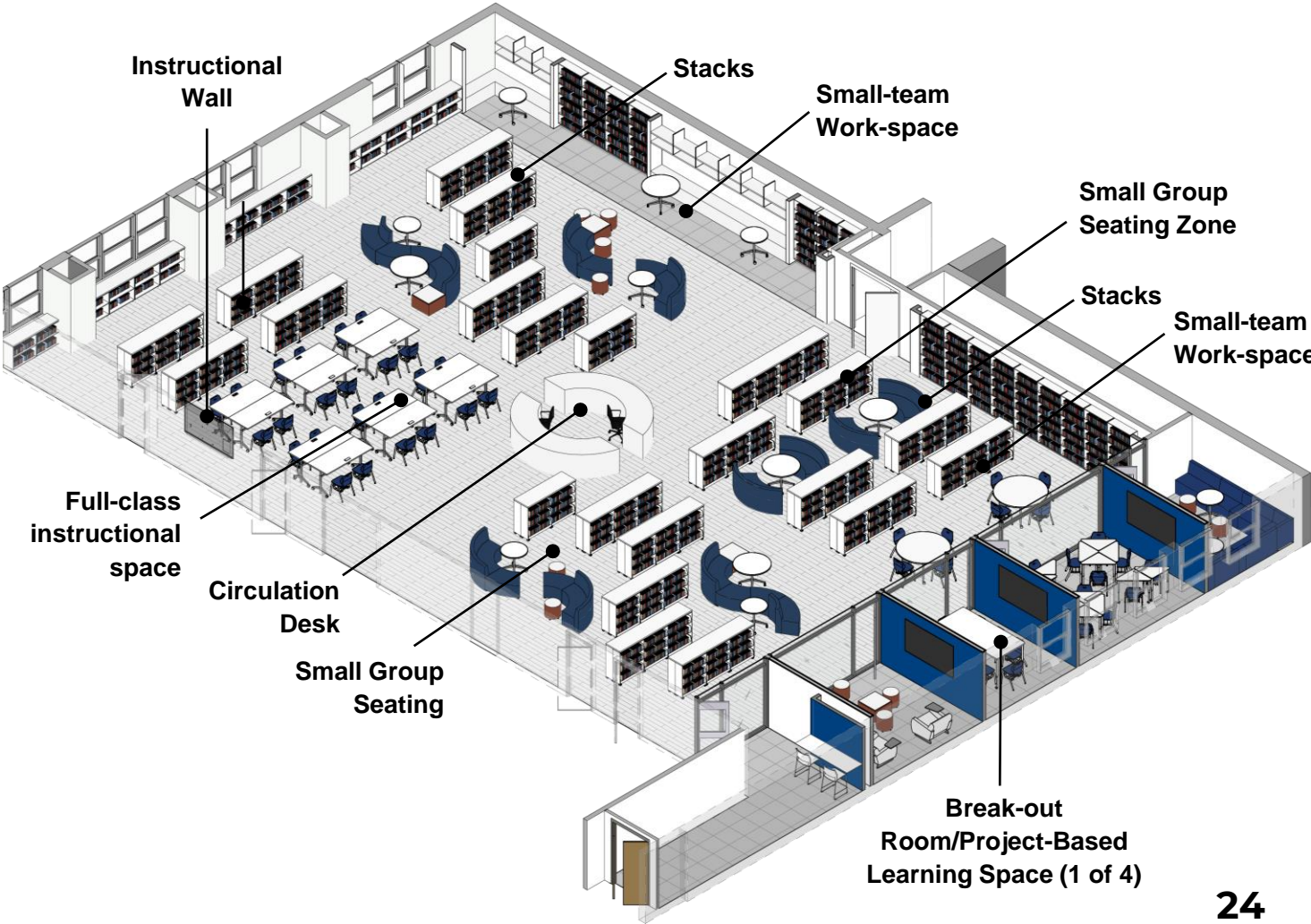



Preliminary Master Planning Schedule &

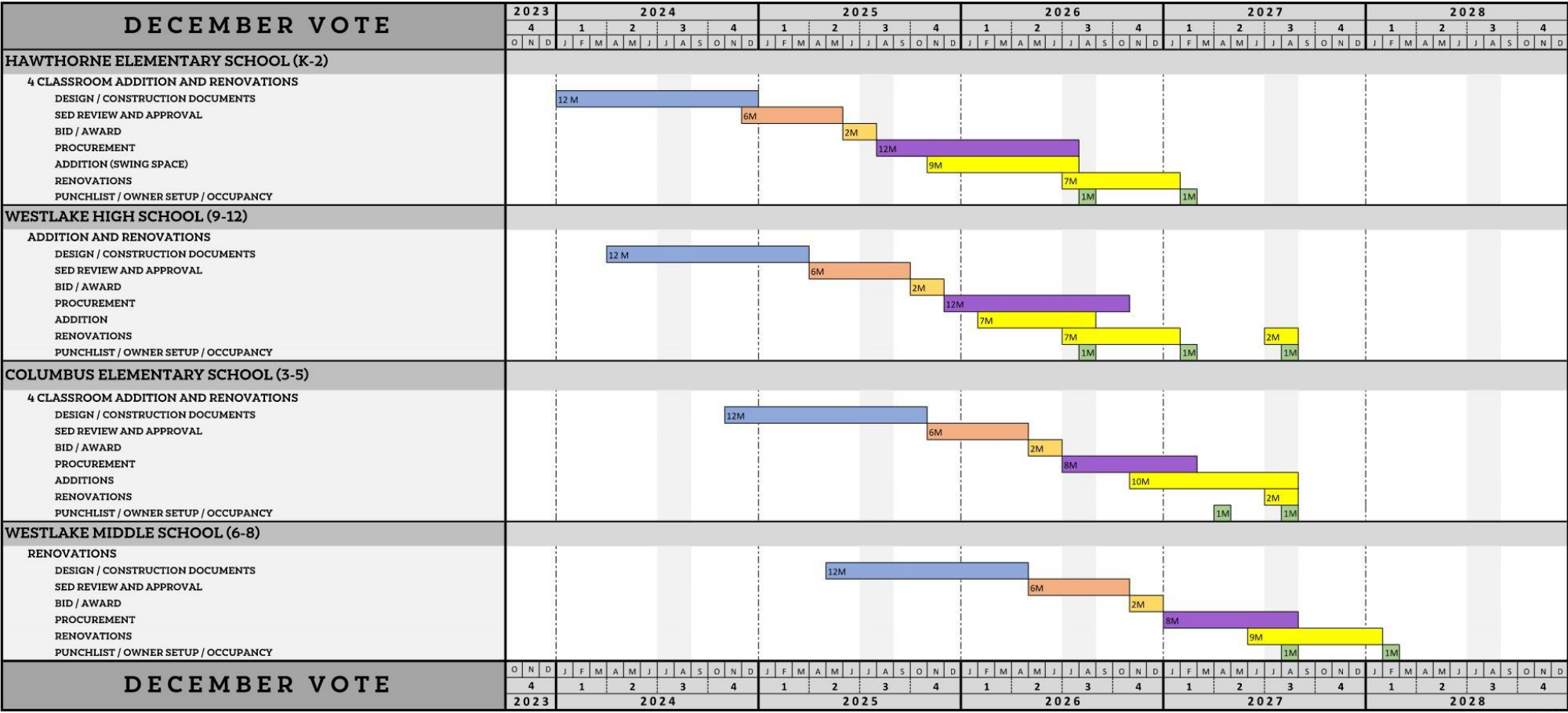



2023 Capital Bond Budget Summary

2023 Capital Bond Planning	Estimated Project Cost
Hawthorne Elementary School	
Classroom Addition - 2 Story 5,400sf	\$4,762,131
Interior Renovations	\$5,309,457
Infrastructure & Building Maintenance	\$537,852
Hawthorne Elementary School Total	\$10,609,440
Columbus Elementary School	
Classroom Additions - 1 Story 5,200sf Total	\$4,539,689
Interior Renovations	\$1,301,930
Infrastructure & Building Maintenance	\$668,272
Columbus Elementary School Total	\$6,509,891
Westlake Middle School	
Kitchen Renovation	\$338,527
Interior Renovations	\$6,744,554
Infrastructure & Building Maintenance	\$671,575
Westlake Middle School Total	\$7,754,656
Westlake High School	
Cafeteria Addition 2,300sf & Kitchen Renovation	\$3,857,712
Interior Renovations	\$9,251,621
Infrastructure & Building Maintenance	\$824,453
Westlake High School Total	\$13,933,786
District Wide Security Camera and Miscellaneous Security Device Upgrades	\$350,000
Total Estimated Project Cost	\$39,157,772
Transfer-to-Capital Auditorium Renovation	-\$3,200,000
Adjusted Bond Cost	\$35,957,772

Notes:

- Estimate includes 8% Escalation, 10% Contingency & 18% Soft Costs Allowances
- Estimate includes 2.5% Hazmat Allowance for all areas excluding additions and site work



Thank You