

Once you log into Infinite Campus (IC), you view the home page, giving you a snapshot of what you can find in most of the tabs, located on the left side of the home page.

**Student Schedule**   **Lunch Account Balance**   **Announcements**   **Inbox** (If you opt in for information to be sent to your Inbox).

The screenshot shows the Infinite Campus Home page. On the left is a dark sidebar with a menu. The main content area is white. Annotations with blue arrows point to various elements:

- Home**: Points to the 'Home' tab in the sidebar.
- Student Number**: Points to the student number field in the 'Today's Schedule' section.
- Lunch Account Balance**: Points to the 'Food Service Balance' section showing \$47.25.
- Announcements**: Points to the 'Announcements' section on the right.
- Inbox**: Points to the 'Inbox' section on the right.
- Notifications**: Points to the notification bell icon in the top right corner.

The sidebar menu includes: Home, Calendar, Attendance, Schedule, Food Service, Fees, School Store, Activity Registration, Documents, Message Center, and More.

The main content area includes: Home, Today's Schedule (23-24 NDP), Term S1 (08/10/2023 - 12/22/2023), Documents Need Attention, Recent Attendance Updates, and a 'Show More' button.

The right sidebar includes: 0 Items in Cart \$0.00, My Cart, My Accounts, and a 'Show More' button.

**TABS ON THE LEFT-HAND SIDE OF THE HOME PAGE**

Clicking *Calendar* takes you to you both your child’s schedule for the day (**Schedule**), and any days your child has been absent (**Attendance**).

The first screenshot shows the Infinite Campus Calendar page with the 'Schedule' tab selected. The sidebar menu has 'Calendar' highlighted. The main content area shows a calendar for September 2023 and a list of classes for Term S1 (08/10/2023 - 12/22/2023).

The second screenshot shows the same page with the 'Attendance' tab selected. The sidebar menu has 'Calendar' highlighted. The main content area shows a calendar for September 2023 and a list of events for Term S1 (08/10/2023 - 12/22/2023).

Annotations with blue arrows point to the 'Calendar' tab in the sidebar and the 'Schedule' and 'Attendance' tabs in the main content area.

Infinite Campus
 1

[Home](#)
[Calendar](#)
[Attendance](#)
[Schedule](#)
[Food Service](#)
[Fees](#)
[School Store](#)
[Activity Registration](#)
[Documents](#)
[Message Center](#)
[More](#)

## Attendance

S1

S2

Term S1 (08/10/2023 - 12/22/2023)

COURSE	ABSENT	TARDY
AP CompSci	0	0
AP Physics	0	0
AP US Gov	0	0
DE Engin/Des	0	0
DE H Ethics Econ Entre	0	0
DE PreCalcH	0	0 >
Digital Painting	0	0 >
English 4	0	0
St. Ignatius	0	0
Theology 4	0	0
WIN	0	0
<b>Totals</b>	<b>0</b>	<b>0</b>

Infinite Campus

 1

[Menu](#)

[Home](#)  
[Calendar](#)  
[Attendance](#)  
[Schedule](#)  
[Food Service](#)  
[Fees](#)  
[School Store](#)  
[Activity Registration](#)  
[Documents](#)  
[Message Center](#)  
[More](#)

## Schedule

23-24 NDP

Students' counselor's are listed below and are based on last name. Seniors' counselors are based on what House they are in.

Show More

S1
S2

Term S1 (08/10/2023 - 12/22/2023)

DAY: MON WIN

	DE H Ethics Econ Entre	Martinez, Sheila Rm: 502
1	8:00 AM - 9:10 AM	
1	AP US Gov 8:00 AM - 9:10 AM	Mulligan, Ian Rm: 504
2	DE Engin/Des 9:30 AM - 10:40 AM	Cesarano, Tony Rm: 804
WIN	WIN 10:45 AM - 11:25 AM	Brown, Mike Rm: 708
3	Theology 4 11:25 AM - 1:15 PM	Henrich, Cecilia Rm: 916
4	English 4 1:20 PM - 2:30 PM	Smith, Theresa Rm: 825

Info@Campus

Home

Calendar

Attendance

Schedule

**Food Service**

Fees

School Store

Activity Registration

Documents

Message Center

More

Food Service

ACCOUNT NAME	ACCOUNT #	BALANCE
[REDACTED]	[REDACTED]	\$197.75 >
<div>Pay</div>		

0  
Items In Cart  
\$0.00

My Cart

My Accounts

Click the *Fees* tab to pay your tuition. You can also print statements from this page.

Home

Calendar

Attendance

Schedule

Food Service

**Fees**

Activity Registration

Documents

Message Center

More

Person

All

School Year

2023 - 2024

Type

Paid

Total Due: \$0.00

DESCRIPTION	DUE DATE	PERSON	FEE BALANCE
Tuition - Quarterly	07/14/2023	Wood, London R	0.00
Tuition - Quarterly	10/14/2023	Wood, L	0.00
Tuition - Quarterly	01/15/2024	Wood, L	0.00
Tuition - Quarterly	04/14/2024	Wood, L	0.00

Print

Optional Payments

0 Items in Cart

\$0.00

My Cart

My Accounts

Need to buy a ticket to an event or pay a fee? Click on *School Store*, then navigate your way through the NDP Portal Store.

Home

Calendar

Attendance

Schedule

Food Service

Fees

**School Store**

Activity Registration

Documents

Message Center

More

School Search

NDP Portal Store



Shop

0 Items in Cart

\$0.00

My Cart

My Accounts

Clicking on *Documents* allows you to see and/or print your child’s schedule and unofficial transcript.

Home

Calendar

Attendance

Schedule

Food Service

Fees

School Store

Activity Registration

**Documents**

Message Center

More

Documents

School Year

23-24

Schedule

Student Schedule

23-24 NDP

Transcript

NDP Transcript

23-24 NDP

The *Message Center* gives you access to announcements posted to your portal and to the inbox (if you opt in to receive emails to your Infinite Campus portal).

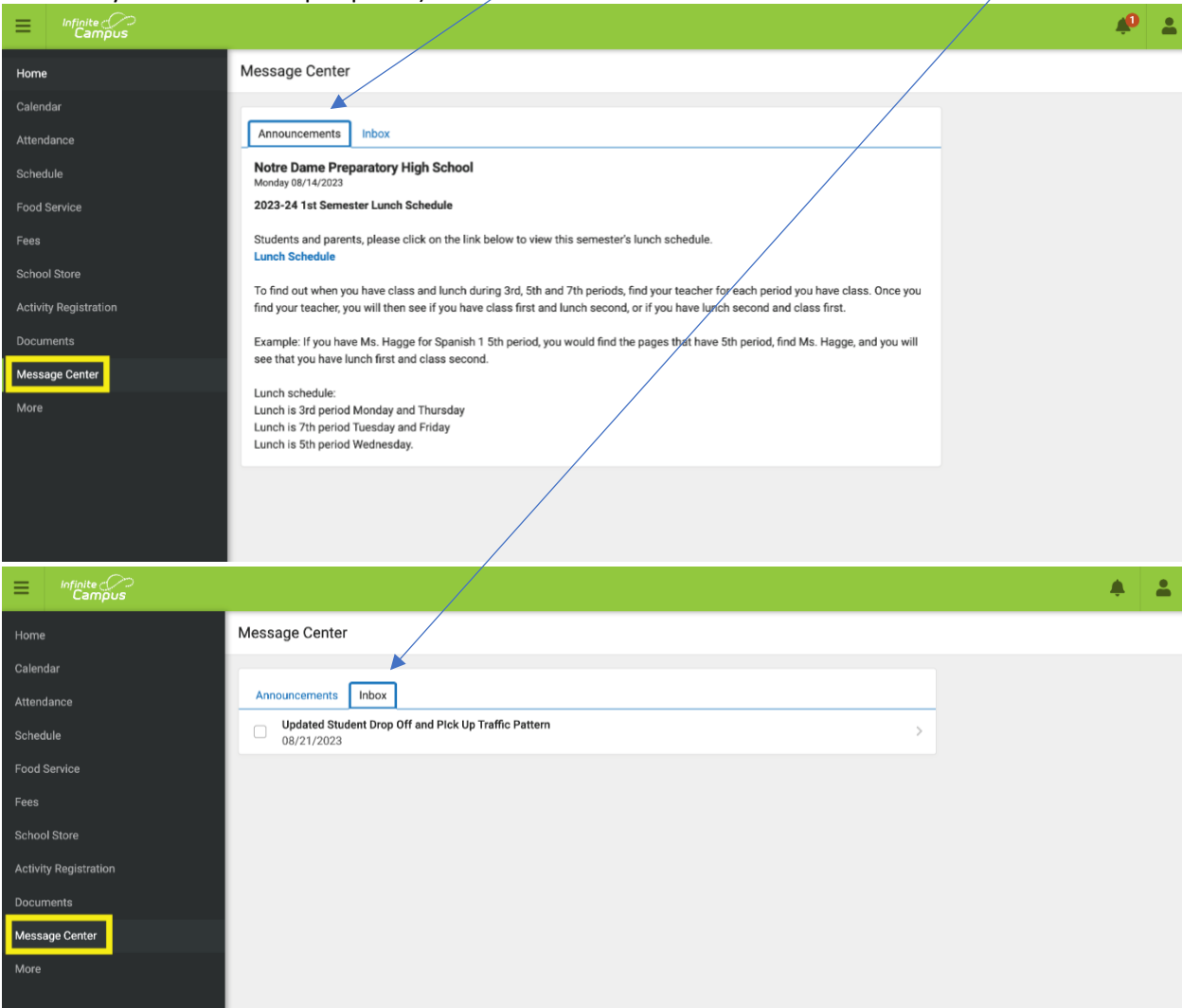

Did you know that you can update contact information in your portal? Click on *More* to view and edit your mailing address, demographics and/or family information. Please note that once you update information, it will be sent to our registrar for approval.

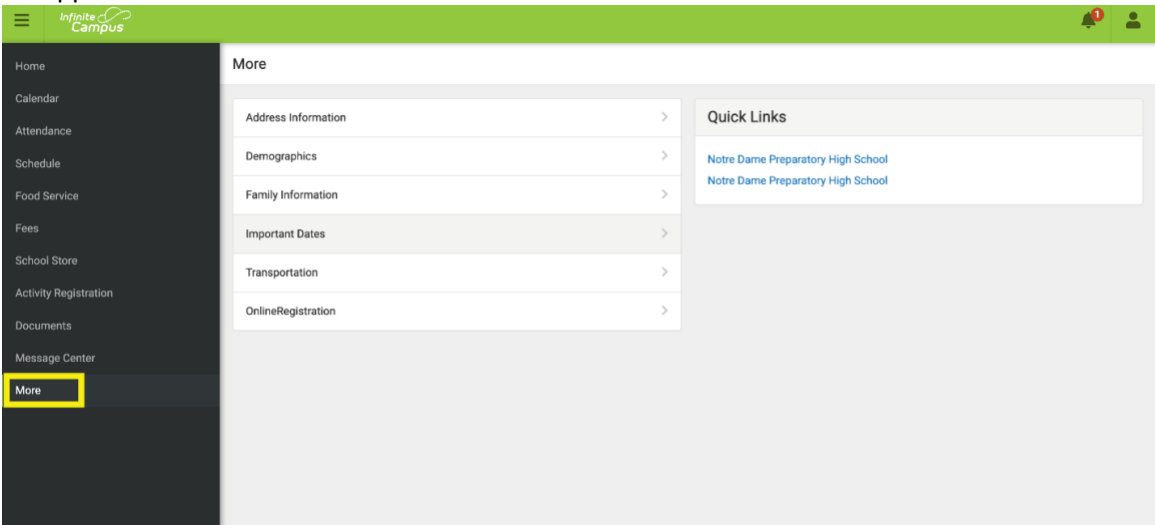

Due to privacy laws, NDP cannot automatically opt you in to text messages. To opt in, click the person icon in the upper right corner, click *Settings*, then *Contract Preferences*. From this page you can update how you would like to receive email and text notifications.

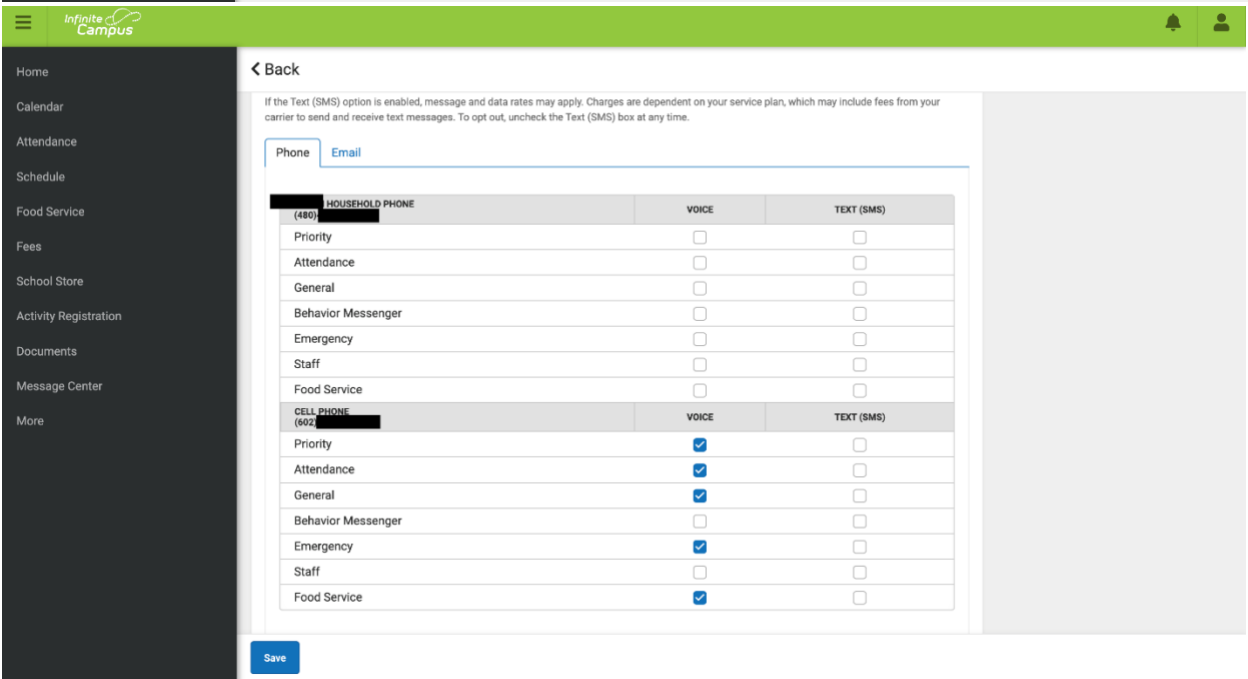
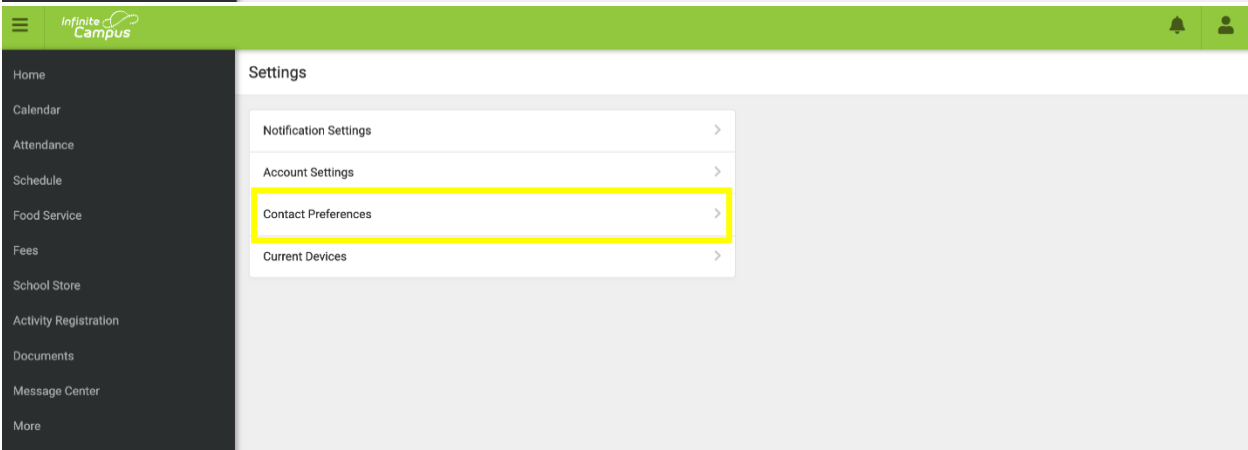
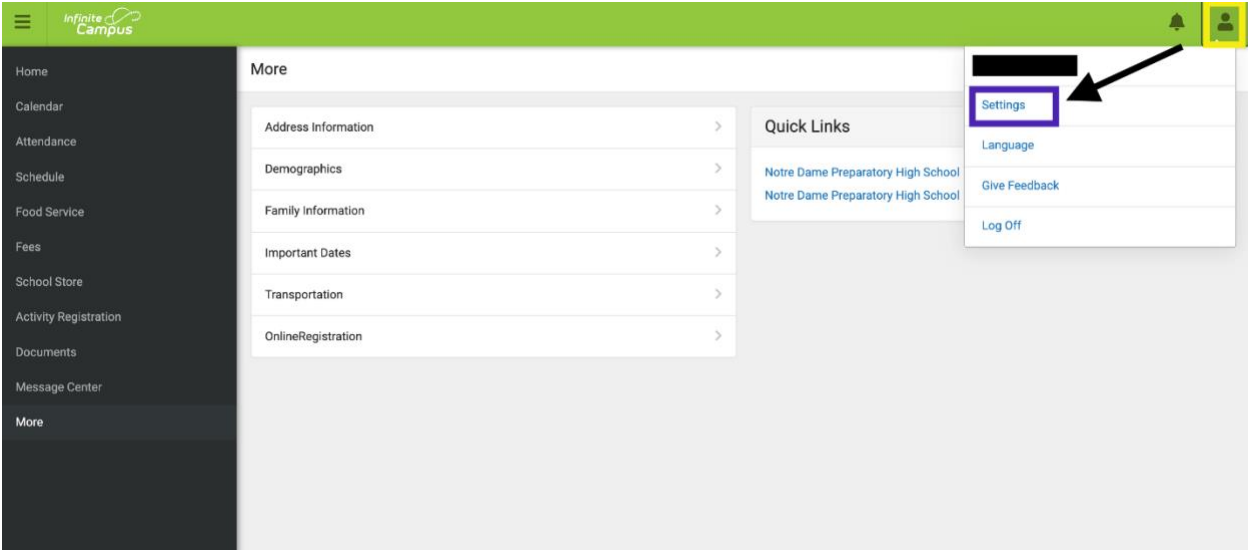

Infinite Campus

Home

Calendar

Attendance

Schedule

Food Service

Fees

School Store

Activity Registration

Documents

Message Center

More

< Back

If the Text (SMS) option is enabled, message and data rates may apply. Charges are dependent on your service plan, which may include fees from your carrier to send and receive text messages. To opt out, uncheck the Text (SMS) box at any time.

Phone

Email

PRIMARY EMAIL ADDRESS	EMAIL
Priority	<input checked="" type="checkbox"/>
Attendance	<input checked="" type="checkbox"/>
General	<input checked="" type="checkbox"/>
Teacher	<input type="checkbox"/>
Behavior Messenger	<input type="checkbox"/>
Emergency	<input checked="" type="checkbox"/>
Staff	<input type="checkbox"/>
Food Service	<input checked="" type="checkbox"/>

SECONDARY EMAIL ADDRESS	EMAIL
Priority	<input type="checkbox"/>
Attendance	<input type="checkbox"/>
General	<input type="checkbox"/>
Teacher	<input type="checkbox"/>
Behavior Messenger	<input type="checkbox"/>
Emergency	<input type="checkbox"/>
Staff	<input checked="" type="checkbox"/>

Save

You can view the 2023-24 vacation calendar listed in “Important Dates” from the *More* tab. You can also find the vacation calendar on our website by clicking [here](#).

Infinite Campus

< Back

Monday	
10/06/2023 Friday	Educator Day
10/06/2023 Friday	Fall Break
10/06/2023 Friday	School Closed
10/07/2023 Saturday	Fall Break
10/08/2023 Sunday	Fall Break
10/09/2023 Monday	Fall Break
10/09/2023 Monday	School Closed
11/10/2023 Friday	Virtual Day
11/22/2023 Wednesday	Thanksgiving Break
11/22/2023 Wednesday	School Closed

Also in *Settings* is where you can decide what type of notifications you receive. From *Settings*, just click on *Notification Settings* and decide what you want notifications you want to receive. Please note teachers do not use Infinite Campus for assignments and grades, you can access those through your Canvas account. Don't have a Canvas account? Click [here](#).

The screenshot shows the Infinite Campus interface. On the left is a dark sidebar with a menu: Home, Calendar, Attendance, Schedule, Food Service, Fees, School Store, Activity Registration, Documents, Message Center, and More. The main content area has a green header with the Infinite Campus logo and a user profile icon. Below the header is a 'Back' button. The 'Notification Settings' section is titled 'Select notifications to receive. Notifications are deleted after 30 days.' It contains several settings: 'Assignment is scored' (checked), 'All scores' (slider set to the right), 'Grade is updated' (checked), 'All grades' (slider set to the right), 'Lunch balance is low' (unchecked), 'Less than \$100' (slider set to the right), 'Attendance is updated' (checked), 'Responsive course is scheduled' (checked), and 'Document requires eSignature' (checked). A 'Save' button is at the bottom left of the settings panel.

## Who to contact:

- Questions regarding your Infinite Campus account? Email our registrar Renee Cochran/[rcochran@ndpsaints.org](mailto:rcochran@ndpsaints.org)
- Need an Infinite Campus account? Email our IT department/[helpdesk@ndpsaints.org](mailto:helpdesk@ndpsaints.org)
- Have a question regarding tuition and/or a fee? Email Benny Mazariegos/[bmazariegos@ndpsaints.org](mailto:bmazariegos@ndpsaints.org)