

**Stats**  
Seating Capacity = 289

NORTH  
3-12 Dining Room Addition  
**First Floor Plan**  
1/16" = 1'-0"  
0 8 16 32

# Phase 3

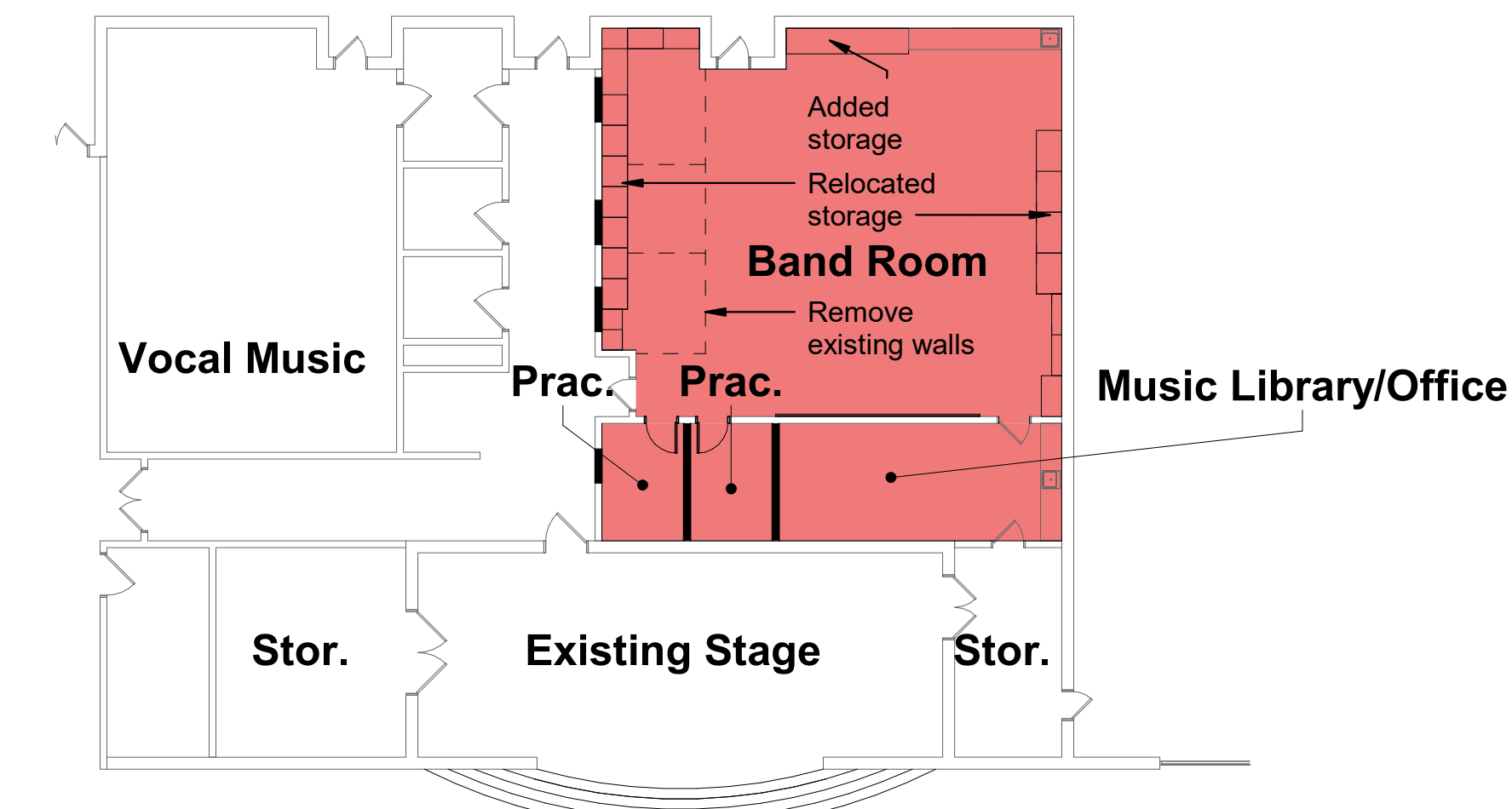

**Stats**  
Existing Area: 1,270 SF  
Revised Area: 1,446 SF  
  
\*Note: Area excludes cabinetry

NORTH  
3-12 Band Room Renovation  
**First Floor Plan**  
1/16" = 1'-0"



NORTH  
3-12 Classroom Addition  
**First Floor Plan**  
1/16" = 1'-0"  
0 8 16 32

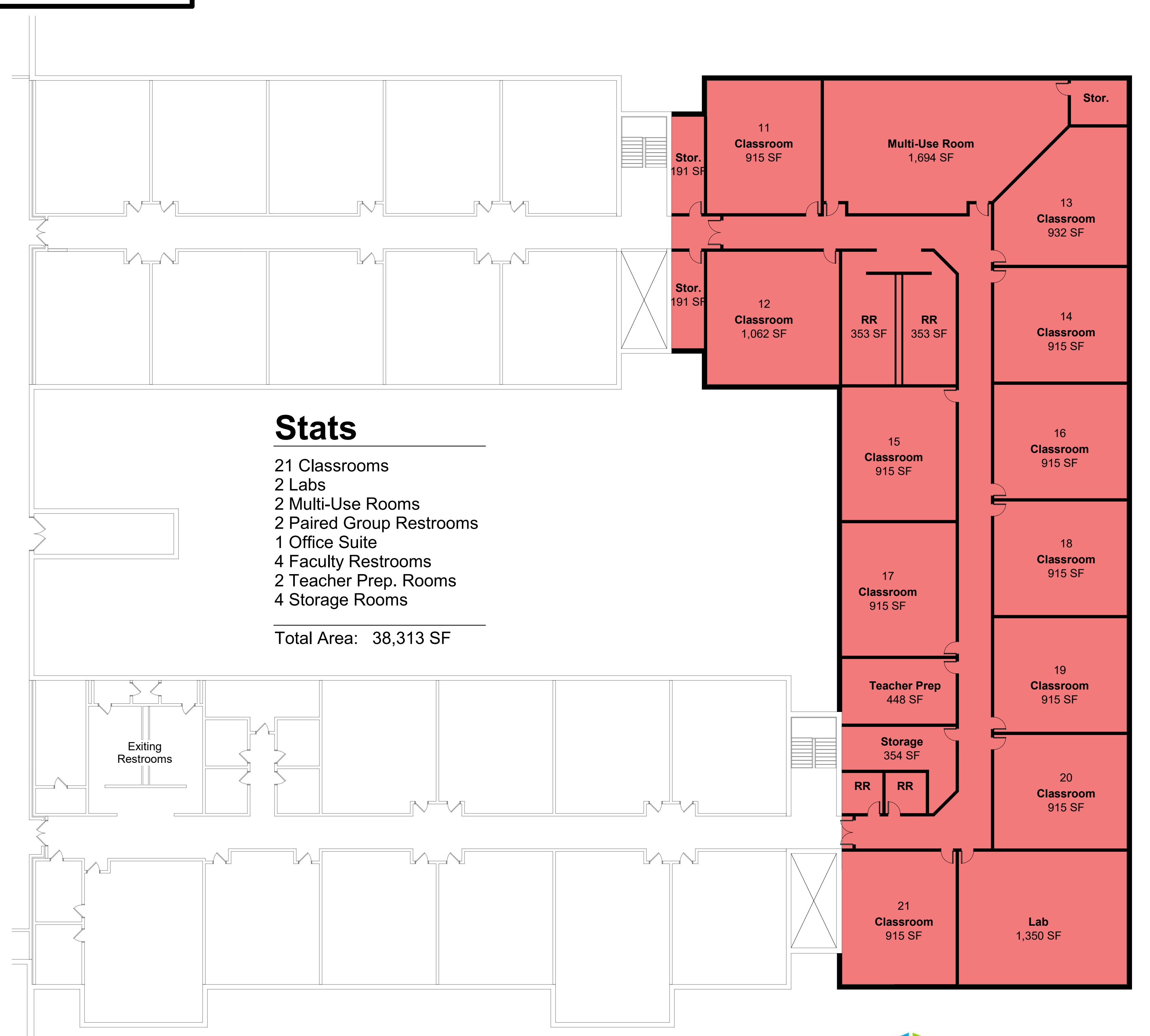

**Stats**  
21 Classrooms  
2 Labs  
2 Multi-Use Rooms  
2 Paired Group Restrooms  
1 Office Suite  
4 Faculty Restrooms  
2 Teacher Prep. Rooms  
4 Storage Rooms  
  
Total Area: 38,313 SF

NORTH  
3-12 Classroom Addition  
**Second Floor Plan**  
1/16" = 1'-0"  
0 8 16 32

# Future Phase



4/4/2023