



SEACOAST

COLLEGIATE HIGH SCHOOL
AT NORTHWEST FLORIDA STATE COLLEGE
EXPANSION PROJECT

Naming Opportunities



Empowering Students, Enriching Community

Seacoast Collegiate High School, in partnership with Northwest Florida State College, presents an extraordinary opportunity to invest in the future of Walton County. With a focus on academic excellence, student success, and community empowerment, our expansion project aims to address the pressing need for higher education options in our rapidly growing county. We invite you to join us in this transformative endeavor that will shape the lives of our students and propel our community forward.

BUILDINGS • \$1,000,000 | 2 AVAILABLE



The Accelerator will serve as a workforce and business incubation center that provides training, mentoring, and collaboration opportunities to local businesses and entrepreneurs.



The SCHS building will house grades 9 and 10.

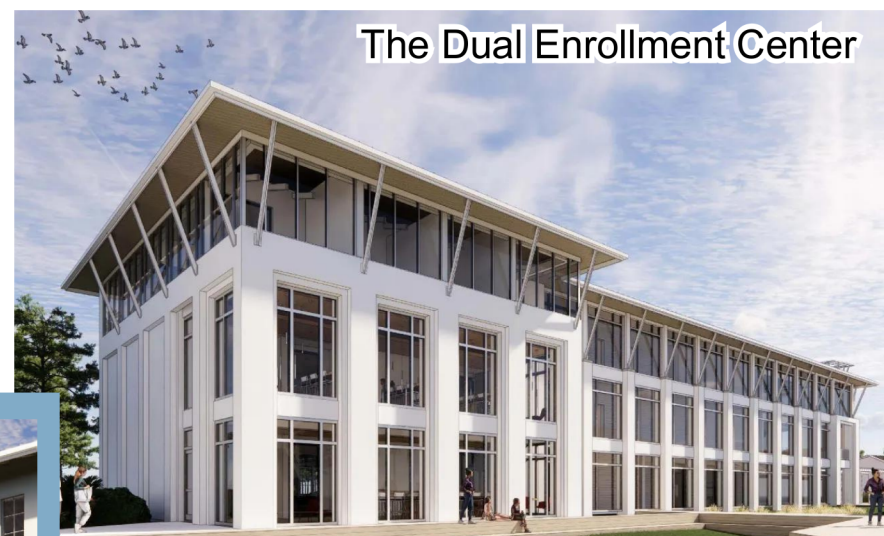

The Dual Enrollment Center will be used by NWFSC for dually enrolled students in grades 11 and 12.

OUTDOOR SPACE | 2 AVAILABLE



Academic Green • \$500,000



The Garden • \$250,000



Seacoast Stage • \$100,000



Seacoast Terrace • \$100,000

THE ACCELERATOR

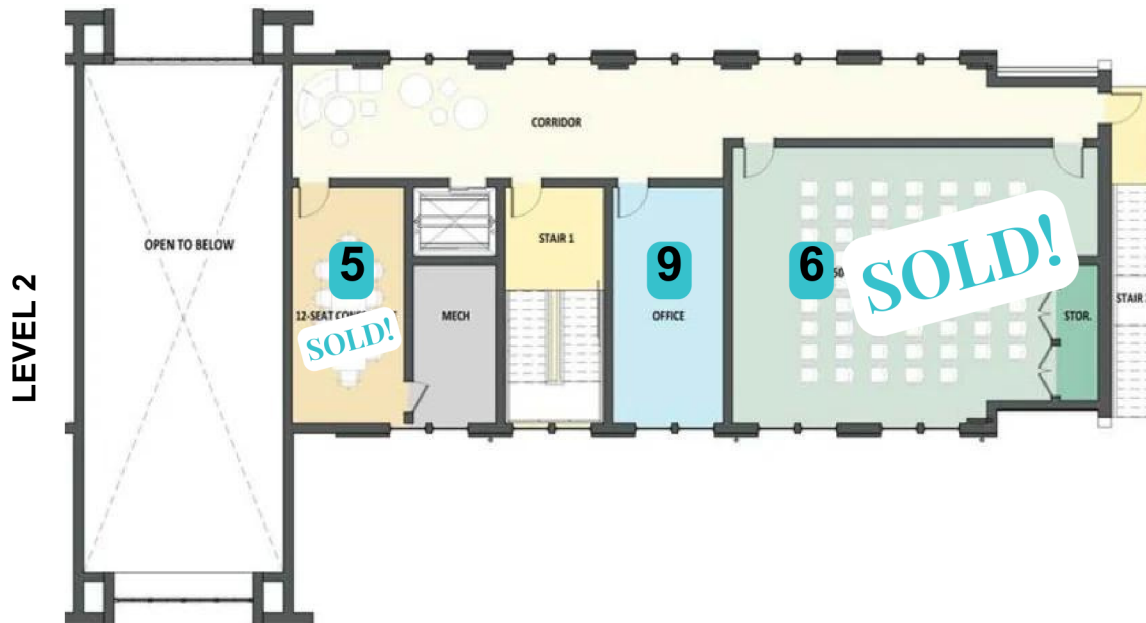

- 1. **SOLD** • Great Hall • \$100,000
- 2. **SOLD** • Cafe • \$100,000
- 3. E-Sports Arena • \$100,000
- 4. **SOLD** • Entry Lobby • \$50,000
- 5. **SOLD** • Conference Room • \$50,000
- 6. **SOLD** • Multipurpose Room • \$50,000
- 7. Reception • \$25,000
- 8. Office • \$25,000
- 9. Office • \$25,000

SCHS GRADES 9 & 10



- 1. Level 1 Learning Commons • \$30,000
- 2. Level 2 Learning Commons • \$30,000
- 3. Level 3 Learning Commons • \$30,000
- 4. Conference Room • \$30,000
- 5. Science Lab • \$25,000
- 6. Classroom • \$20,000
- 7. Classroom • \$20,000
- 8. Classroom • \$20,000
- 9. Classroom • \$20,000
- 10. Classroom • \$20,000
- 11. Classroom • \$20,000
- 12. Classroom • \$20,000
- 13. Classroom • \$20,000
- 14. Classroom • \$20,000
- 15. Classroom • \$20,000
- 16. Guidance Office • \$20,000
- 17. Office • \$20,000
- 18. SRO Office • \$20,000
- 19. Guidance Office • \$20,000
- 20. Faculty Breakroom • \$20,000
- 21. Bookkeeper's Office • \$20,000
- 22. Principal's Office • \$20,000

DUAL ENROLLMENT CENTER



Team Rooms 1-4

1. Conference Room • \$30,000
2. Writing Lab 1 • \$30,000
3. Writing Lab 2 • \$30,000
4. Level 2 Learning Commons • \$30,000
5. Testing Center • \$30,000
6. Team Room 1 • \$30,000
7. Team Room 2 • \$30,000
8. Team Room 3 • \$30,000
9. Team Room 4 • \$30,000
10. Computer Lab • \$25,000
11. Computer Lab • \$25,000
12. Science Lab • \$25,000
13. Classroom • \$20,000
14. Classroom • \$20,000
15. Office • \$20,000
16. Office • \$20,000
17. Office • \$20,000
18. Office • \$20,000
19. Office • \$20,000
20. Office • \$20,000
21. Office • \$20,000
22. Office • \$20,000
23. Office • \$20,000
24. Office Workspace & Reception • \$20,000
25. Faculty Workroom • \$20,000

SCHS DONOR TILE WALL

\$10,000 MAJOR PLACEMENT • 10 AVAILABLE





The Seacoast Collegiate High School Expansion Project in partnership with Northwest Florida State College is proudly supported by the Seaside School Foundation, Inc.

For more more information, please contact Teresa Horton, Executive Director of the Seaside School Foundation, at teresa@seasideschoolfoundation.org