

Ms. Sara Petro
School Counselor

August 10, 2023

☆
 $\sqrt{123}$



2023-2024 School Year

STUDY
HARD!



+ x ÷



Introductions



Mrs. Karlo – 12
Month Secretary



Dr. Noro – Principal



Mrs. Pesci – 10
Month Secretary



Introductions



Mrs. Trpcic –
Behavior Specialist



Ms. Petro – School
Counselor



Ms. Roman – Social
Services – University
of Pittsburgh ☆

School Nurse



- * First Aid
- * Care of Ill Children
- * Mandated Health Screening
- * Height/Weight/BMI
- * Vision Screening
- * Hearing Screening
- * Physical Examination
- * Dental Examination
- * Medication Administration
- * Assist students and families to manage acute and chronic illnesses in order to maximize educational opportunities



Mrs. Gourley –
School Nurse ☆

School Information

- 435 - 450 students
- O'Hara and Sharpsburg
- Pre-K Program
- Spanish Immersion Program
- School-Wide Title 1 Building (Funding)
- #1 in our Region in comparison to "Like Schools"
- Very comprehensive PBIS Program
- 11 Interventionists - Math and Reading
- Zen Den
- Student Change Committee

Kerr is a Title I School

Title I is Based on Three Important Ideas:

- 1. All students should have a fair, equal, and significant opportunity to obtain a high-quality education and to reach, at minimum, proficiency on state academic standards and assessments.**
- 2. Local districts, schools, and parents know best what their students need to succeed. The Title I program allows them to decide how to use these funds to implement research-based proven practices to help students who are failing or who are at risk of failing in school.**
- 3. Parents are partners in helping all students achieve. They have the right to be involved in the design and operation of their school's Title I program, and, at the same time, a responsibility to help their children succeed in school.**

What is Title I?

- Title I is one of the nation's oldest and largest federal programs supporting elementary and secondary education.
- Through Title I, the federal government disburses money to school districts based on the number of students who qualify for free or reduced lunch in each district.
- Students are selected based on their academic needs

Reading and Math Support Criteria & Selection Process for Title 1 Support Services

Students are selected for support based on their academic performance on a variety of assessments including:

- STAR 360
- PSSA
- AIMSWeb Probes
- Foundations Assessments
- Class Performance and Progress

- Who is Evaluated?

- Prior Services
 - Teacher Referral
 - Testing Data
 - New Students
-
- Teachers monitor student progress periodically to ensure that students are learning and growing

☆ Schoolwide Program - Planning & Implementation ☆

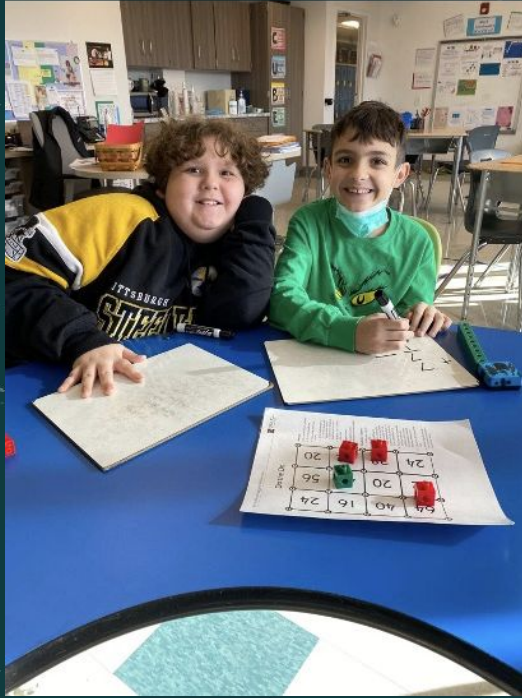

- Kerr Elementary Steering Committee holds meetings throughout the school year.
- Sets a path for the 23/24 school year regarding fund allocations, parent involvement, professional development, and resources ☆
- Monitoring of student growth and achievement data occurs at the school and district level throughout the school year. ☆

What we do that makes us special!

- PBIS Boosters twice a year
- We teach school-wide expectations throughout the school year
- Second Steps Lessons
- Spanish Instruction – Pre/k-5 during 12-week period – 12-18 lessons
- Use data driven decision making using CBAs, STAR Benchmark, PSSAs, and behavioral data to ensure student success
- SAP Program
- Student Problem Solving Team
- Kerrtoberfest
- Accelerated Reader
- Staff available during lunch and recesses to support student needs

Support Services

- Speech & Language
- Occupational Therapy
- Physical Therapy
- Educational Support
- Reading Support
- Math Support
- Family Based Resources
- Quest Program w/wo E-ELA

Social and Emotional Learning (SEL)

- Second Step is used to reach all students in the classroom.
- Small groups are offered to select students .
 - Examples of small groups
 - Skills for Learning
 - Emotion Management
 - Problem Solving
 - Social Skills
- Multiple faculty members work together to ensure that each student receives the support they need.



Typical School Day

8:30-9:00 - Arrival

9:00 - Morning Announcements & Start of School Day

10:40-1:20 - Lunch and Recess

☆ 3:20 - Dismissal



Arrival

- 8:30 – 9:00 am
- Students who ride the bus will have assigned seats on their assigned bus.
- Parents can drop their students off in the front parking lot or in the bus loop.
- Students arriving after 9:00 am are considered tardy. Parents must escort students into the building after 9:00 and provide a legal excuse.
- 3 Tardies = 1 absence



Dismissal

- Begins at 3:20
- Parent pickup will be either in the front of the building or in the bus loop depending on student's homeroom teacher.
- If a student is not riding the bus, a parent note must be sent into school.
- Any change to dismissal process, please provide a note.



Bus, Car, and YMCA Arrival & Dismissal – Directional Map

-YMCA: **Drop Off**
MUST be prior to 8:15
AM. (If Applicable)
Pick Up **MUST** be after
4:15 PM.
-Car Rider PM Pick Up
Area, if needed.

-Pre-K – Grade 2 Car
Rider AM Drop-Off
-Car Rider PM Pick
Up Area.

Grades 3-5
Parent AM Car
Drop-Off

Office Staff &
Visitor Parking

PM & AM Bus
Lane

PM & AM Bus
Lane

TURN for Staff
and Visitor
Parking Area

Staff and
Visitor Parking
Area

Bus Exit Lane
and Staff &
Visitor
Entrance and
Exit Lane

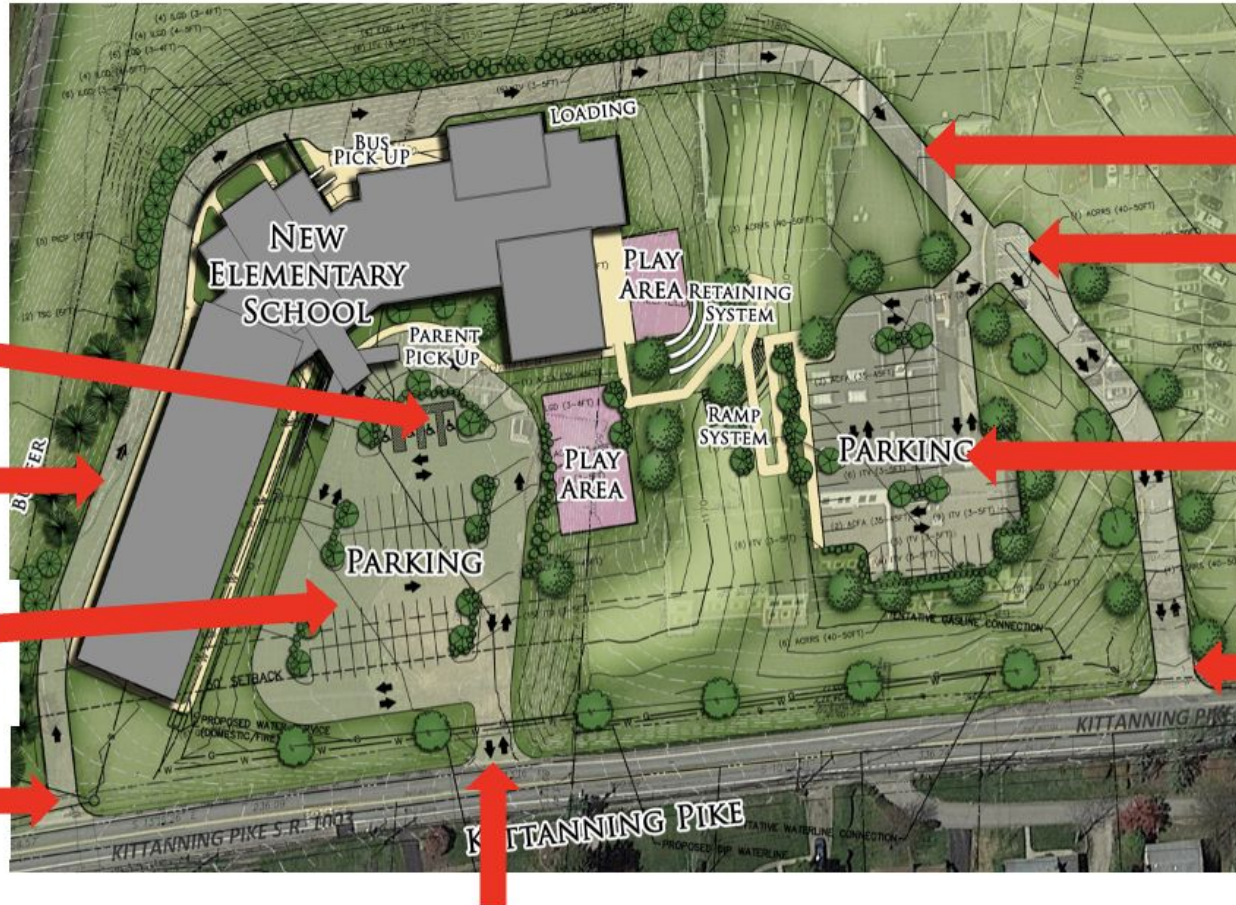

Car Rider and Visitor Parking Entrance and Exit Lanes

Attendance



- Regular attendance in school is extremely important and should be established early. Children achieve more and feel better about themselves, when instruction is continuous and when a sense of belonging is established within the classroom.
- If your child is absent, please call the school before 9:15 am.
- Educational tours and Trip Request Forms must be submitted prior for approval.
- All written excuses should be submitted the first day of attendance following the absents.
- Students who are absent 3 or more days should submit a physician's excuse.
- PA State attendance policy allows for only 10 parent excuses in a given school year. Students who miss more than 10 days will need to submit physician's excuses.





Breakfast

- Available between 8:30 – 8:55 am daily
- Monthly menus provided



Lunch

- 30 minutes daily
- Monthly menus provided



Recess

- 30 minutes daily
- Outdoor/Indo or depending on weather conditions



Educational Programs

- Eureka Math

- * Fluency
- * Application
- * Concept Development
- * Problem Set
- * Homework

Educational Programs

- Foundations (Phonics) – Grades K-3
 - Research-based, multisensory, structured language program
 - Letter identification and Phonics
 - Handwriting (using a Foundations writing grid)
 - Reading Fluency
 - Foundations teaches strategies like tapping to help with blending and reading words
 - High Frequency Words
 - Vocabulary
 - Spelling
 - Phonemic Awareness (example: rhyming)

Educational Programs

- ☆ ● ELA – Journeys
 - Researched-based ELA program ☆
 - Promotes problem-solving and critical-thinking skills
 - Authentic, award winning texts
 - Read Alouds ☆
 - Leveled Readers
 - Vocabulary Readers
 - Phonological Awareness
 - Decoding & Word Building
 - Grammar
 - ☆ ■ Writing ☆

Educational Programs

● TCI Social Studies

- Who am I?
- How do I get along with others?
- How do I make friends?
- How do I solve problems with others?
- What is a family?
- How can I be a good helper at school?
- What is in my neighborhood?
- Where am I in the world?
- How can I help take care of the world?

Educational Programs

● ☆ STEAM – National Geographic/Other Opportunities

- Life Science
 - Living v. Non-Living
- Engineering
 - Bridges & Wells
- Physical Science
 - Circuitry & Design
- Earth Science
 - Rocks, Sand, Soil
 - Water Cycle
 - Weather
- Environmental Walks
 - Seasonal
 - Audubon Society of W. PA
- Camp Allegheny
- ☆ Camp Guyasuta



Special Areas

- Technology – STEAM
- Library
- Physical Education
- Art Education
- Music Education
- Strings
- Band



Ms. Meyers - Art



Ms. Orsega - Library

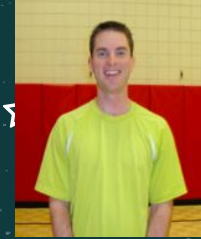

Mr. Slezak - PE



Ms. Ehman - Music



Mr. Strzempek - Technology-STEAM



Cafeteria

KITCHEN - Serving Area

Doorway

Hallway

Doorway

Gym Storage

Café Storage

Kelly, Asbury,
Hess



Kelly, Asbury,
Hess



Kelly, Asbury,
Hess



Kelly, Diamond,
Hess



Cornett, Guerrieri,
Yeager



Cornett, Guerrieri,
Yeager



Cornett, Guerrieri,
Yeager



Cornett, Diamond,
Yeager



McCall, Pentrack,
Zarlino



McCall, Pentrack,
Zarlino



McCall, Pentrack,
Zarlino



McCall, Diamond,
Zarlino



Pototo, Baldis,
Bashforth



Pototo, Baldis,
Bashforth



Pototo, Baldis,
Bashforth



Pototo, Baldis,
Lauterbach



Thompson, Traczynski,
Reese



Thompson, Traczynski,
Reese



Thompson, Traczynski,
Reese



Thompson, Traczynski,
Lauterbach



Cosentino, McKenzie,
Sharrow



Cosentino, McKenzie,
Sharrow



Cosentino, McKenzie,
Sharrow



Cosentino, McKenzie,
Lauterbach



After School Care

- YMCA of Greater Pittsburgh
 - <https://www.pittsburghymca.org/base>
 - Only after school care at this time
- Lauri Ann West
 - <https://lauriannwestcc.org>

Any changes in your child's dismissal plan need to be shared with the YMCA and your child's teacher.

Recess



Questions?