

---

# WELCOME

MARCH 29, 2022



---

# AGENDA

- **Process Overview**
- **Guiding Principles + Evaluation Criteria**
- **Conceptual Scenarios**
- **Input on Conceptual Scenarios**
- **Questions & Comments**

# PROJECTED DESIGN-BUILD TIMELINE

ESTIMATED PROCESS TO FINISHED PROJECT

2021	2022	2023	2024	2025	2026
<p>OUSD selects Bridging Architect (PE)</p> <p>PE begins site analysis and stakeholder engagement</p>	<p>PE produces Bridging Documents</p> <p>OUSD releases Request for Proposals (RFP) and selects Design-Build Entity</p>	<p>Design-Build Entity designs and produces construction documents (blueprints)</p> <p>Division of State Architect Reviews and Approves plans</p>	<p>Construction/modernization begins</p> <p>(Project phasing may result in temporary housing of students.)</p>	<p>Ongoing construction/modernization</p>	<p>Construction/modernization concludes (estimated)</p> <p><i>Phased plans could result in longer project timeline</i></p> <p>Close-out and commissioning (<i>contingent on various external factors</i>)</p>

# BRIDGING ARCHITECTS TIMELINE

## ENGAGEMENT OPPORTUNITIES

Nov-Dec 2021

- **Begin monthly engagement with Project Advisory Committee**
- Engage technical consultants
- Launch website

Jan 2022

- Preliminary site analysis with technical consultants
- Outreach campaign
- **Project Advisory Committee**

Feb 2022

- Share analysis findings with project advisory committee
- **Student Engagement #1**
- **Project Advisory Committee**

Mar 2022

- **Community Meeting #1**
- Guiding Principles workshop
- Share preliminary analyses
- **Student Engagement #2**
- Develop site concepts
- **Project Advisory Committee**

Apr 2022

- **Community Meeting #2**
- Input on site concepts
- Static concept display at school
- **Student Engagement #3**
- **Project Advisory Committee**

May 2022

- Define final site concept
- Produce Bridging Documents
- **Project Advisory Committee**

# STUDENT ENGAGEMENT

## USER PROFILES & JOURNEY MAPPING

Give a 2-4 sentence description of this person:  
Plays sports, Dress nice, Come to school  
on time, he runs track, he has siblings,  
wld have a cool person

What do they do on campus?  
He is a student Athlete, order food desk all day  
he make jokes and hanging his with Admin  
Football and track practice

What works?  
he has connects for lunch out  
school

What does he like?  
The school lunch and the  
school likes a jail

What spaces they use?  
he use the football field, and  
use the back area

What works?  
the weight room, and the  
library

What doesn't?  
the water, and the bathrooms

Core needs (2-4 most important things): More girl shirt in more people think make great,	Pain points (2-4 most pressing challenges): The gender ratio more privoms Bisser 0/0m
---------------------------------------------------------------------------------------------------	------------------------------------------------------------------------------------------------

“Library is chill”

“Cars in public spaces”

“He likes to be in the hallways”

“Need space for cheer practice”

“Small weight room”

“Staying in the lunch room doesn't work”

# GUIDING PRINCIPLES

WHAT WE HEARD

What's One Word to Describe McClymonds?



## Guiding Principles

- 13 High Quality & Sustainable Facilities
- 13 Safe & Healthy School
- 12 Quality Community School
- 11 School Image & Identity
- 8 grass roots
- 8 Campus Access & Flow
- 6 Maintain Commitment to Budget and Schedule
- 6 community
- 2 Increase learning and skills for future jobs. Wood shop, carpentry, auto shop etc.
- 1 climate adaptation and mitigation, clean up toxic soil, air, water

# GUIDING PRINCIPLES

REVISED PER 3/1 COMMUNITY MEETING



## Safe & Healthy School

Optimize student and staff health and wellness. Address deficiencies.



## High Quality & Sustainable Facilities

Provide facilities that align with best practices for 21st century learning, seismic safety, accessibility, energy efficiency, etc...



## Quality Community School

Provide space for flexible learning, fine arts, dedicated labs with industry equipment, library, community resources, counseling, restorative justice, athletics, etc...



## Grass Roots Community Engagement

Ensure that the planning, design and implementation process integrates authentic student, staff and community input and participation at all levels

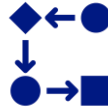

## Campus Access & Flow

Provide the optimal building and campus flow and adjacencies. Ensure access points are clear and connections, secure, and accessible.



## School Image & Identity

Strengthen the student experience of inclusion, school community and school pride. Present an inviting community interface.



## Commitment to Budget and Schedule

Minimize threats to the project's schedule and budget from unknowns or unpredictable scope features.

# GUIDING PRINCIPLES

REVISED PER 3/1 COMMUNITY MEETING



## Safe & Healthy School

Optimize student and staff health and wellness. Address deficiencies.



## High Quality & Sustainable Facilities

Provide facilities that align with best practices for 21st century learning, seismic safety, accessibility, energy efficiency, etc...



## Quality Community School

Provide space for flexible learning, fine arts, dedicated labs with industry equipment, library, community resources, counseling, restorative justice, athletics, etc...



## Grass Roots Community Engagement

Ensure that the planning, design and implementation process integrates authentic student, staff and community input and participation at all levels

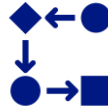

## Campus Access & Flow

Provide the optimal building and campus flow and adjacencies. Ensure access points are clear and connections, secure, and accessible.



## School Image & Identity

Strengthen the student experience of inclusion, school community and school pride. Present an inviting community interface.



## Commitment to Budget and Schedule

Minimize threats to the project's schedule and budget from unknowns or unpredictable scope features.



# GUIDING PRINCIPLES

## SUMMARY OF SITE NEEDS

Bathroom fixtures replacement

Plumbing replacement

Vapor mitigation

No seismic deficiencies in main building (A, B, H)

Classrooms & labs need updates

Thermal comfort issues in rooms on Myrtle St



Safe & Healthy School



High Quality & Sustainable Facilities



Quality Community School



Grass Roots Community Engagement



Campus Access & Flow



School Image & Identity



Commitment to Budget and Schedule

# GUIDING PRINCIPLES

## SUMMARY OF SITE NEEDS

Cafeteria not an appealing space

Bleachers in poor condition

Gym spaces need updates, especially for women's sports

Auditorium needs updates

All partner activities are in building C

Community use by partners can be inconvenient



Safe & Healthy School



High Quality & Sustainable Facilities



Quality Community School



Grass Roots Community Engagement



Campus Access & Flow





School Image & Identity



Commitment to Budget and Schedule

# GUIDING PRINCIPLES

SUMMARY OF SITE NEEDS

-  **Safe & Healthy School**
-  **High Quality & Sustainable Facilities**
-  **Quality Community School**
-  **Grass Roots Community Engagement**
-  **Campus Access & Flow**
-  **School Image & Identity**
-  **Commitment to Budget and Schedule**

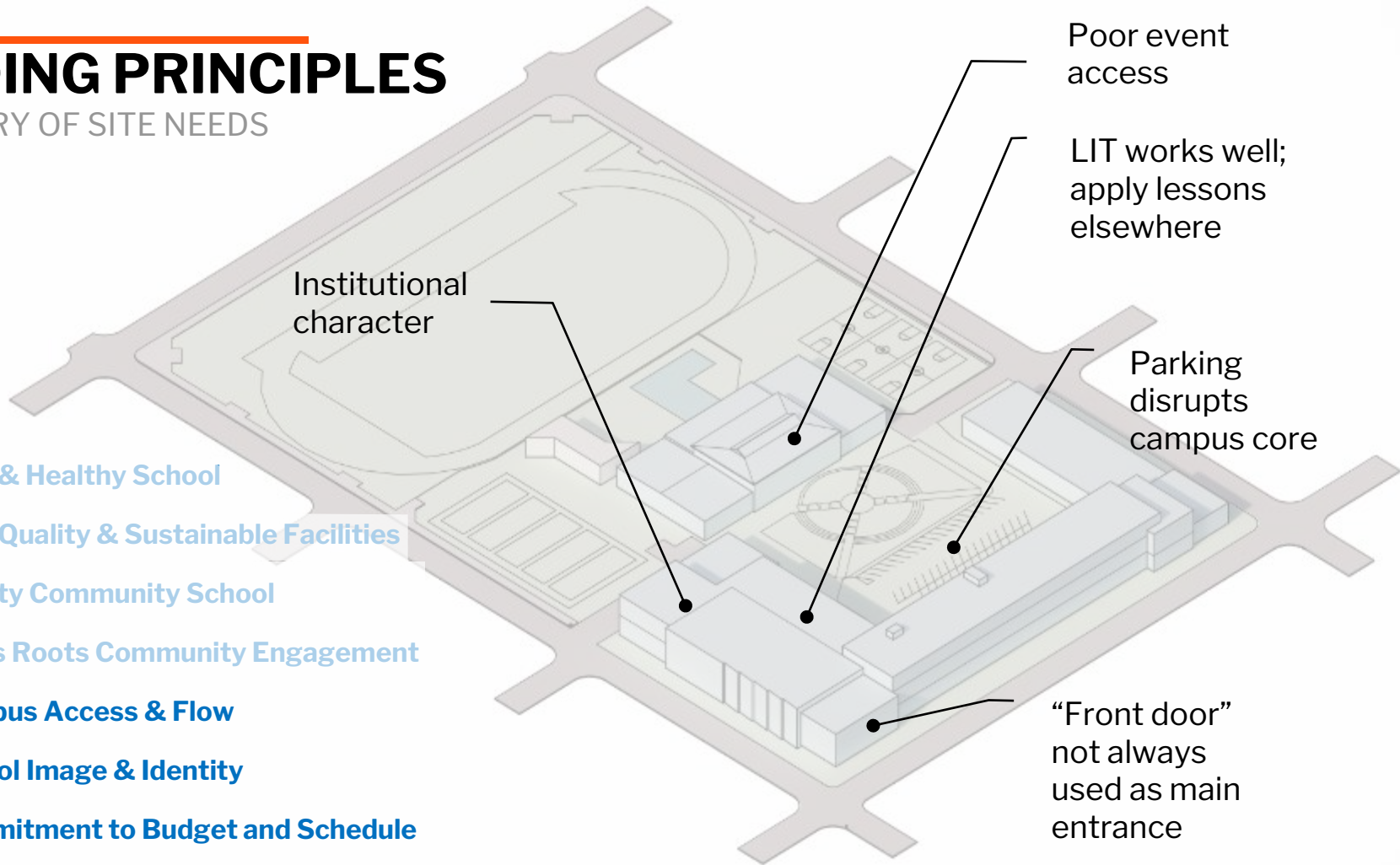

# CONCEPTUAL SCENARIOS

## KEY CONSIDERATIONS

- **\$65M Measure Y Budget**
- **Plumbing + vapor mitigation included in all scenarios**
- **Consideration of Follow-Up Projects**
- **Not a “vote” – final concept may include elements of more than one scenario**

---

# CONCEPTUAL SCENARIOS

## KEY CONSIDERATIONS

- **Scenario 1: Distributed Updates**
- **Scenario 2: New Classroom Building**
- **Scenario 3: Focus on Campus**

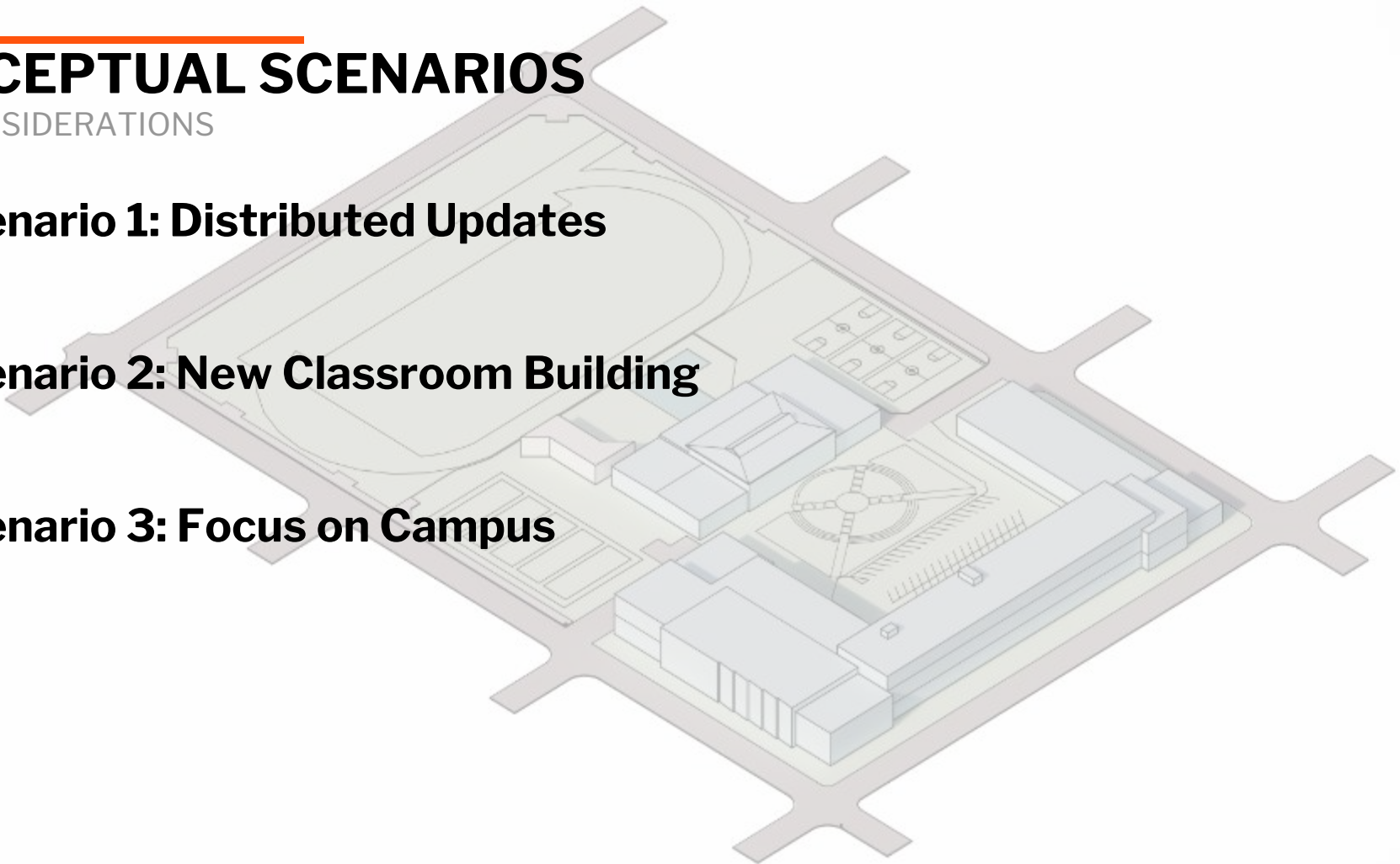

---

# SCENARIO 1

DISTRIBUTED UPDATES

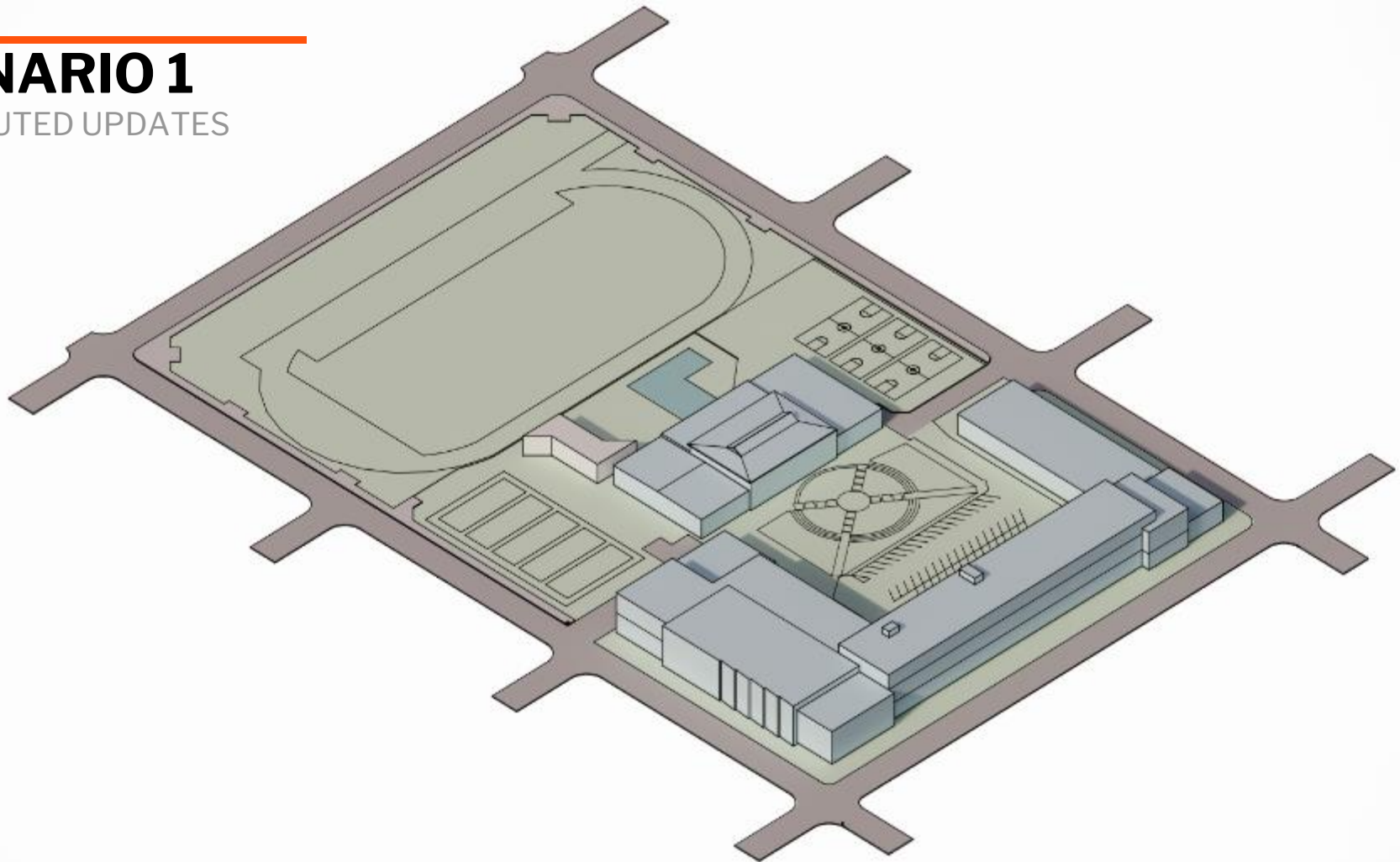

# SCENARIO 1

DISTRIBUTED UPDATES

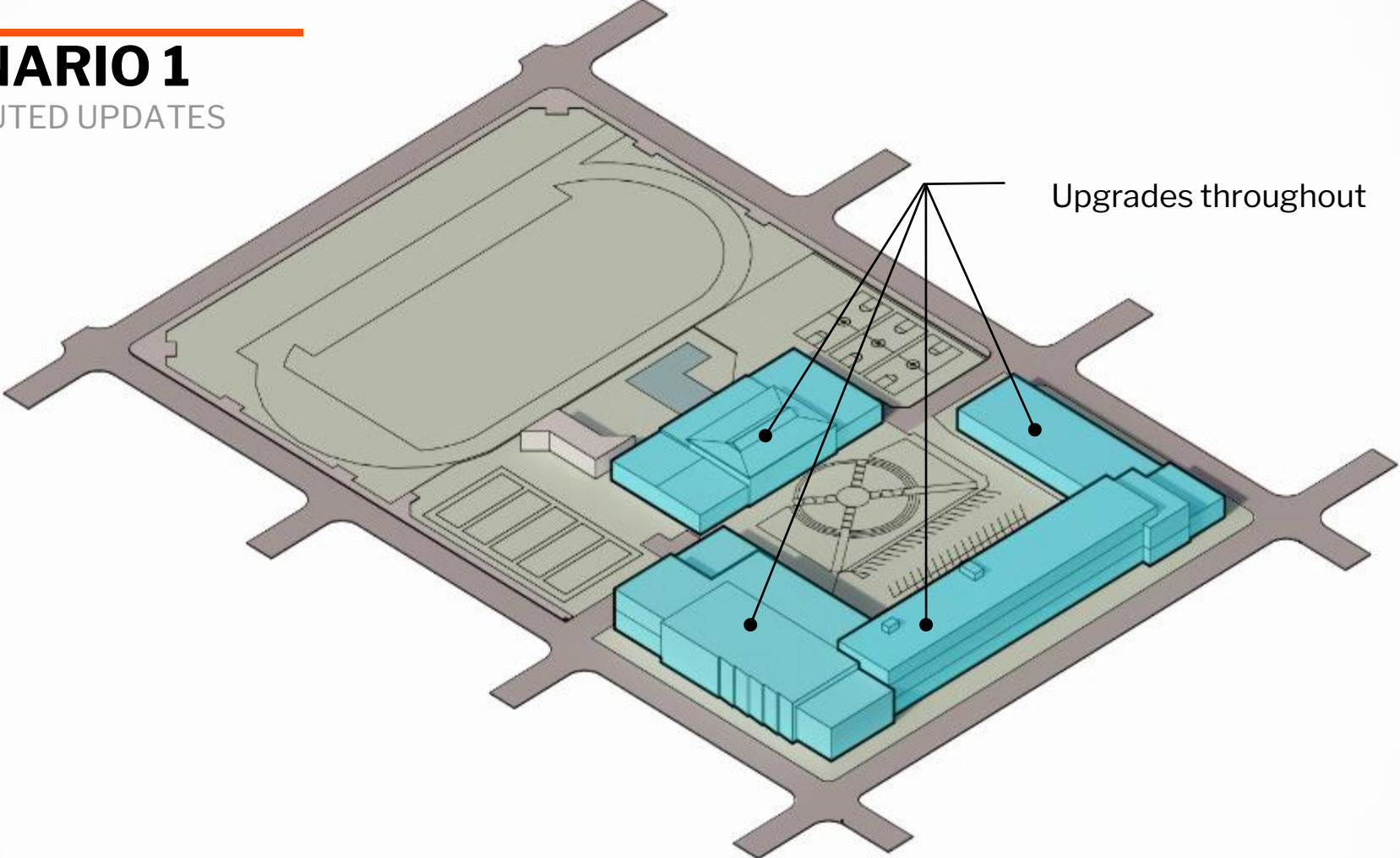

# SCENARIO 1

DISTRIBUTED UPDATES

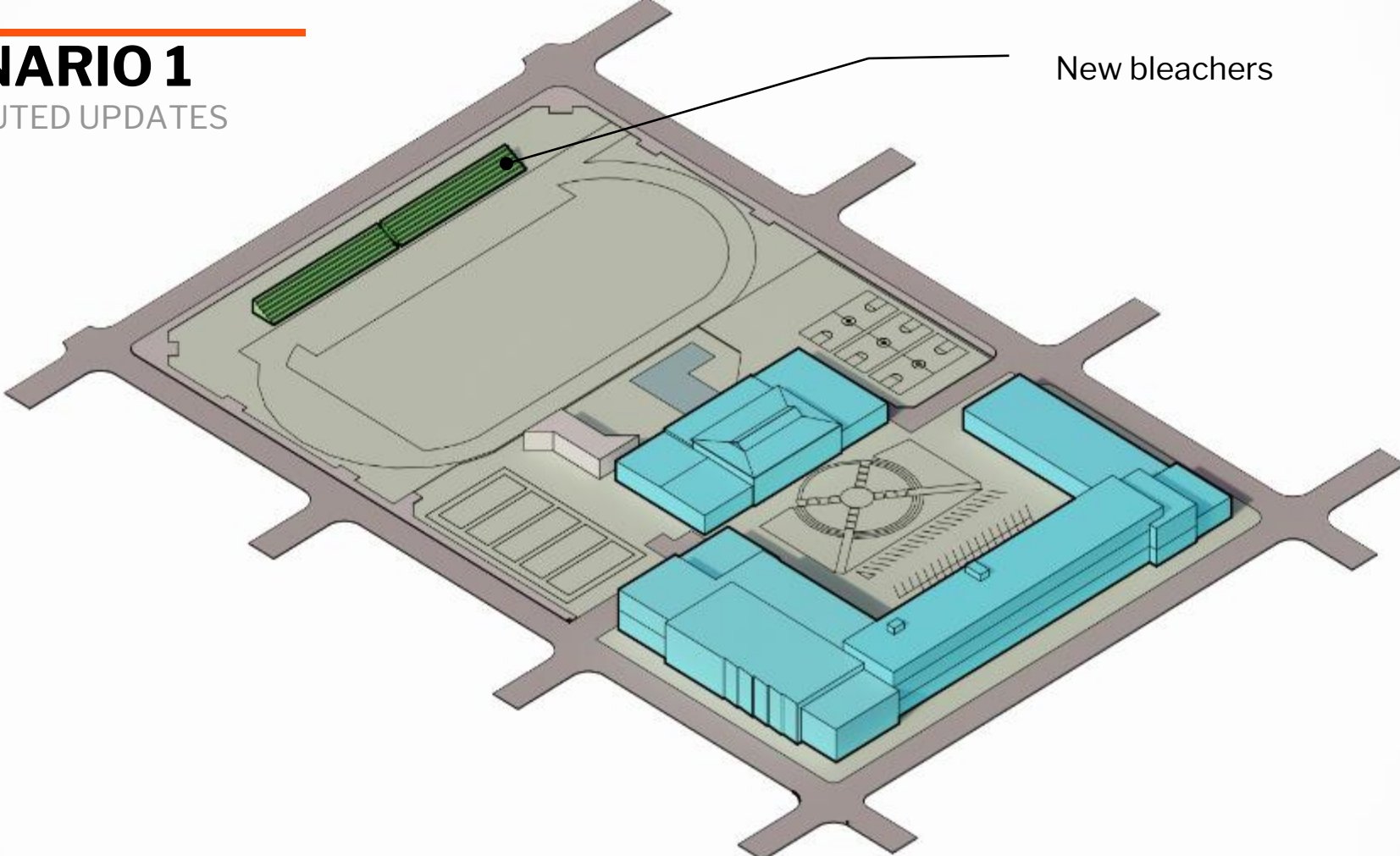

New bleachers



# SCENARIO 1

## DISTRIBUTED UPDATES

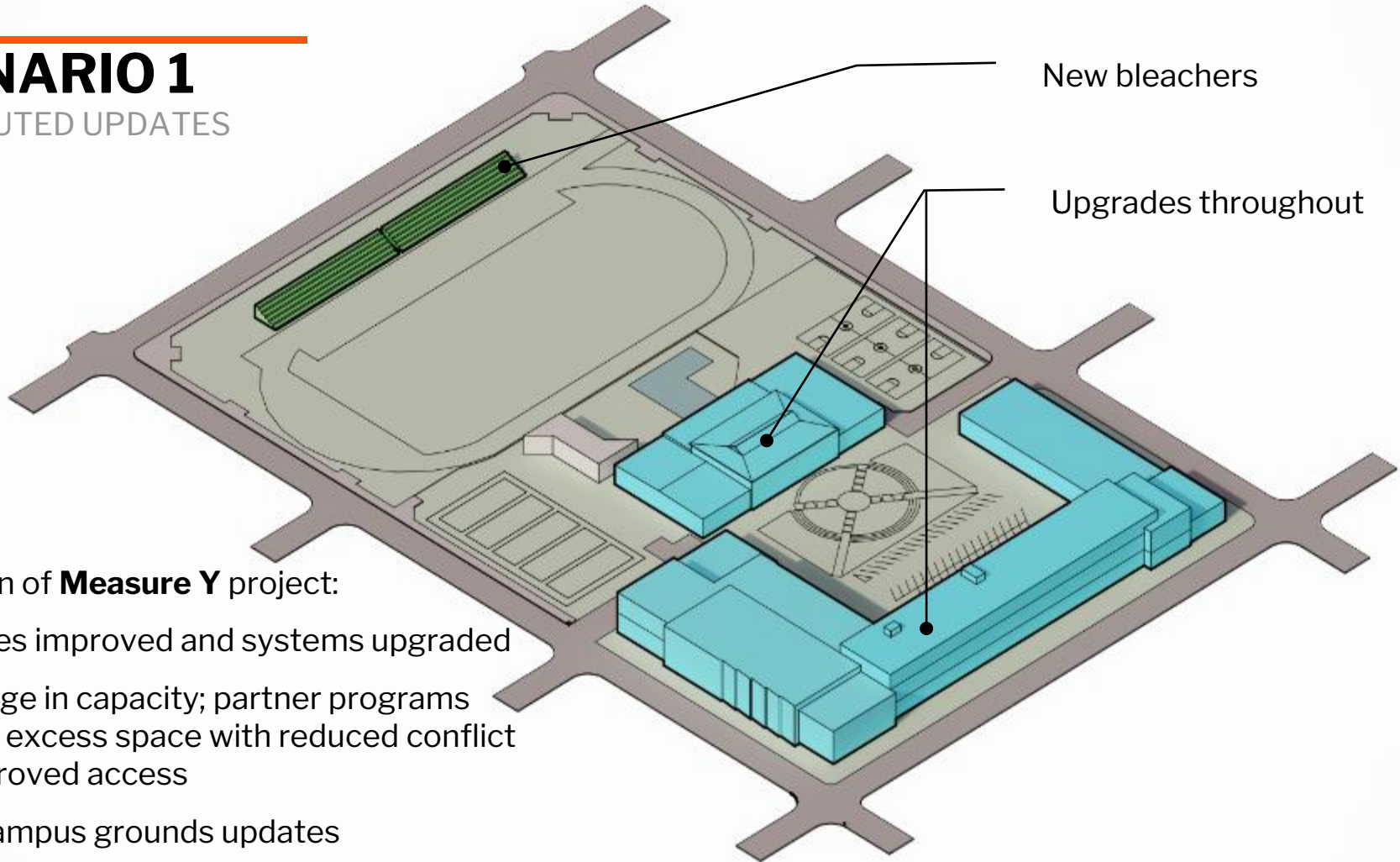

At conclusion of **Measure Y** project:

- All spaces improved and systems upgraded
- No change in capacity; partner programs to share excess space with reduced conflict and improved access
- Minor campus grounds updates

# SCENARIO 1

## DISTRIBUTED UPDATES

Updates could include:

- New HVAC system
- New classroom and lab furniture
- AV/IT upgrades
- Paint and finish upgrades
- New cafeteria furniture and kitchen equipment
- New AV in auditorium
- New football field bleachers

### New HVAC System



### Updated Classrooms/Labs



### Updated Cafeteria



### Bleacher Replacement



# SCENARIO 1

## DISTRIBUTED UPDATES

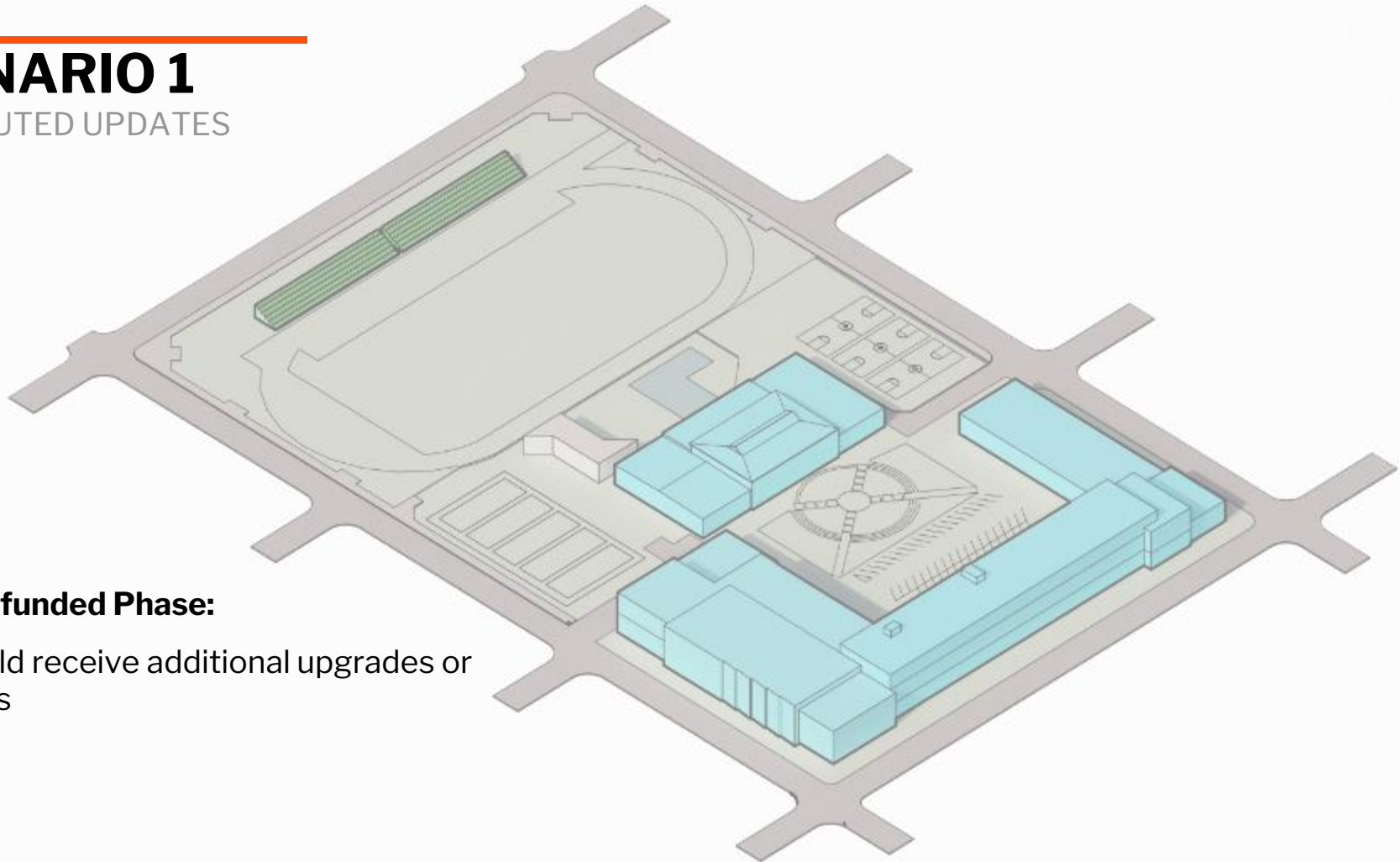

### In Future Unfunded Phase:

- Site could receive additional upgrades or buildings

# SCENARIO 2

## NEW CLASSROOM BUILDING

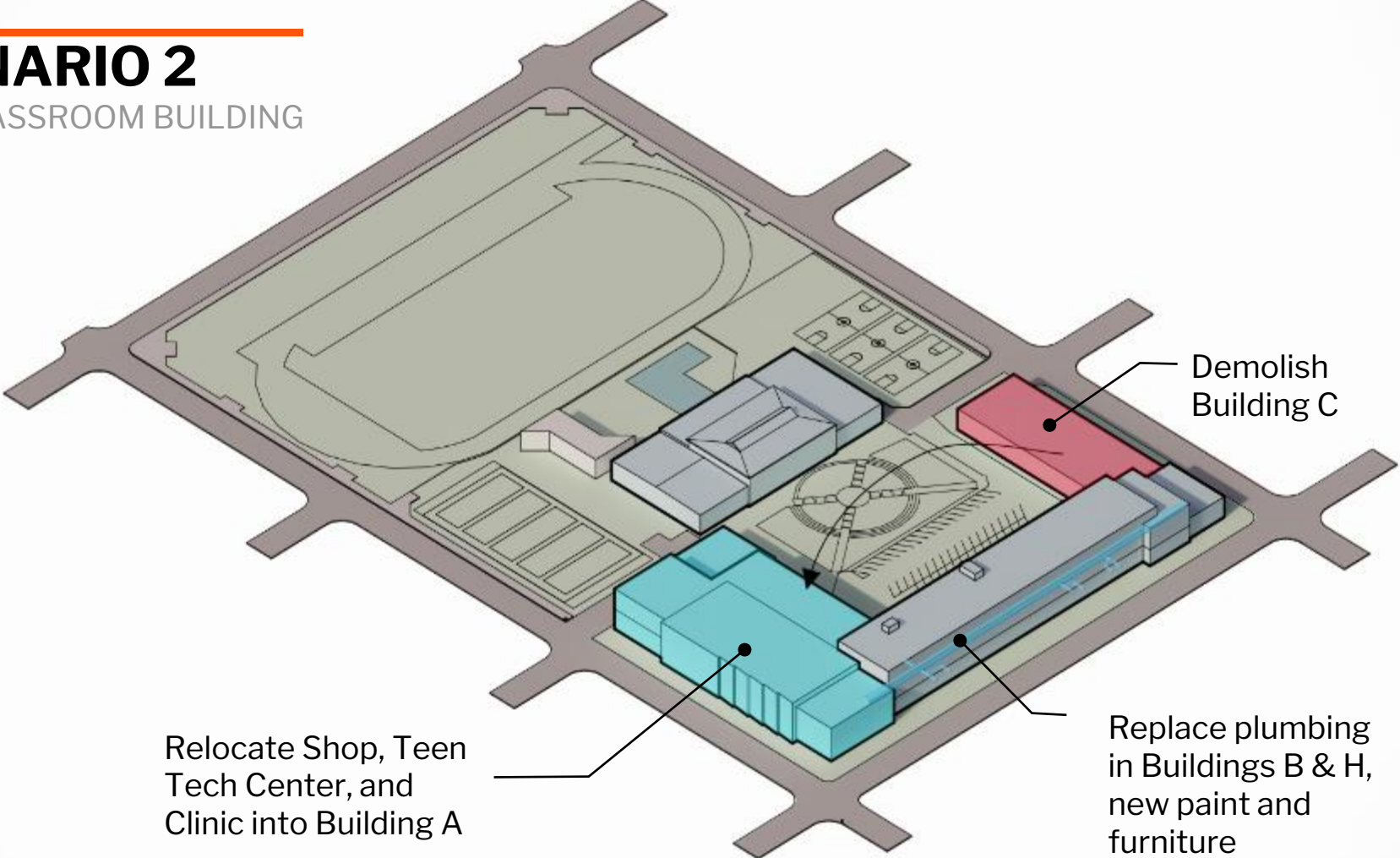

Demolish Building C

Relocate Shop, Teen Tech Center, and Clinic into Building A

Replace plumbing in Buildings B & H, new paint and furniture

# SCENARIO 2

## NEW CLASSROOM BUILDING

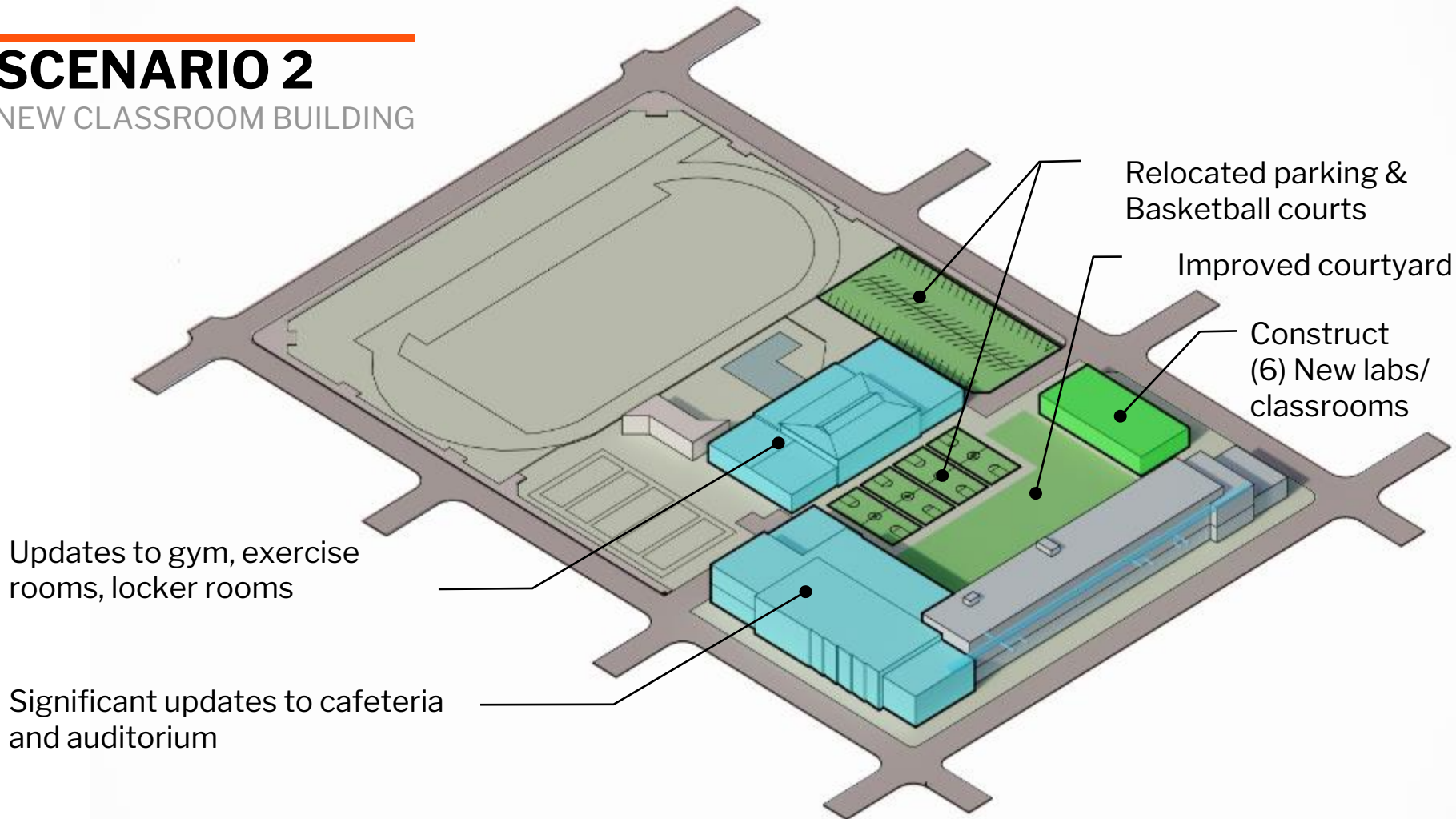

Relocated parking & Basketball courts

Improved courtyard

Construct (6) New labs/classrooms

Updates to gym, exercise rooms, locker rooms

Significant updates to cafeteria and auditorium

# SCENARIO 2

## NEW CLASSROOM BUILDING

At conclusion of **Measure Y** project:

- All systems upgraded
- Spaces in Building A and Gym updated
- New 6 classroom/lab building
- Parking and basketball courts relocated
- No change in capacity; partner programs to share excess space with reduced conflict and improved access

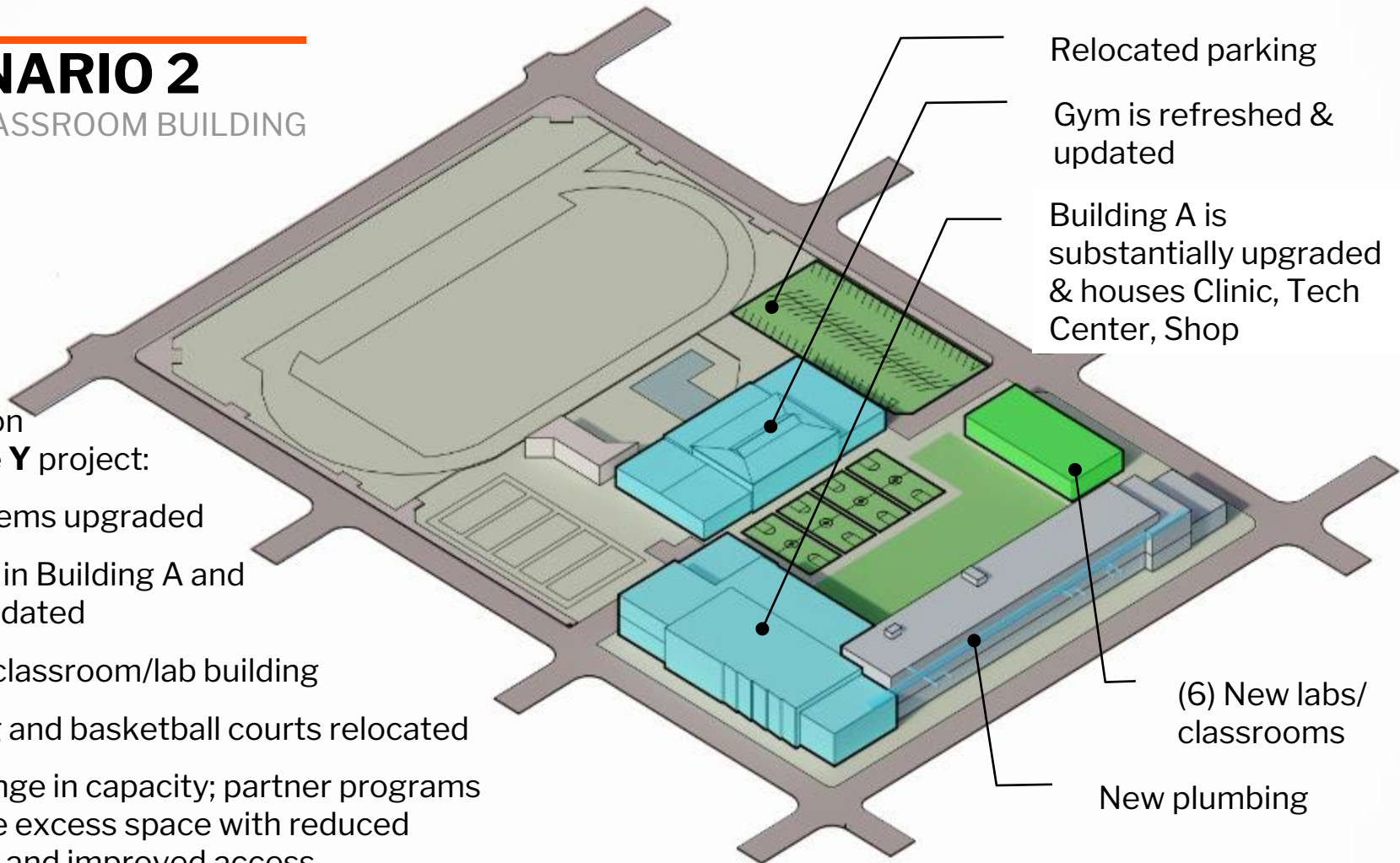

# SCENARIO 2

## NEW CLASSROOM BUILDING

Updates could include:

- New classroom/lab building
- Upgraded weight room, dance studio, and locker rooms
- Major cafeteria reconfiguration
- Auditorium refresh including AV, lighting, seating, and acoustic treatment

### New Lab Building



### Gym Upgrades



### Cafeteria Reconfiguration



### Auditorium Refresh



# SCENARIO 2

## NEW CLASSROOM BUILDING

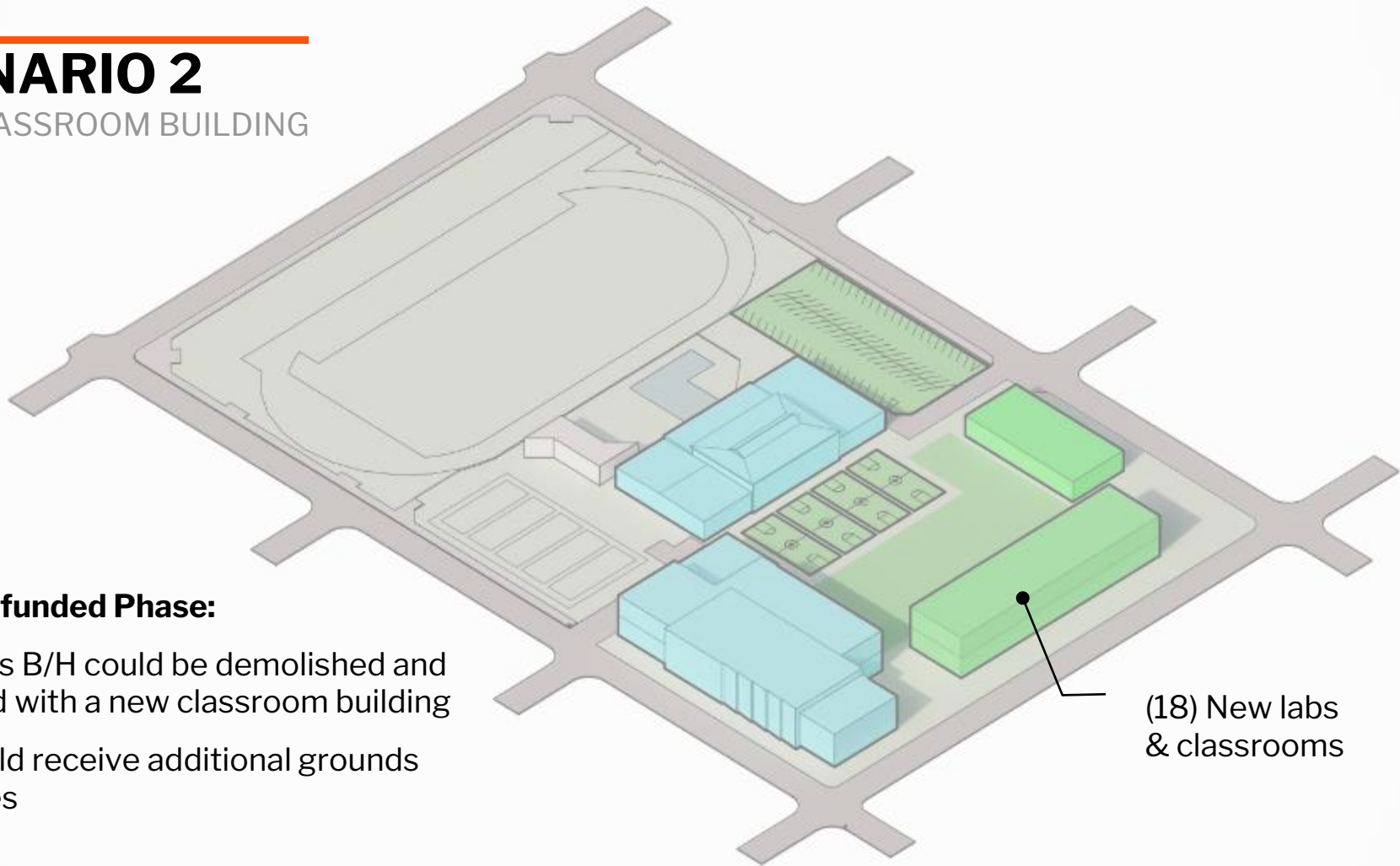

### In Future Unfunded Phase:

- Buildings B/H could be demolished and replaced with a new classroom building
- Site could receive additional grounds upgrades

(18) New labs  
& classrooms



# SCENARIO 3

FOCUS ON CAMPUS

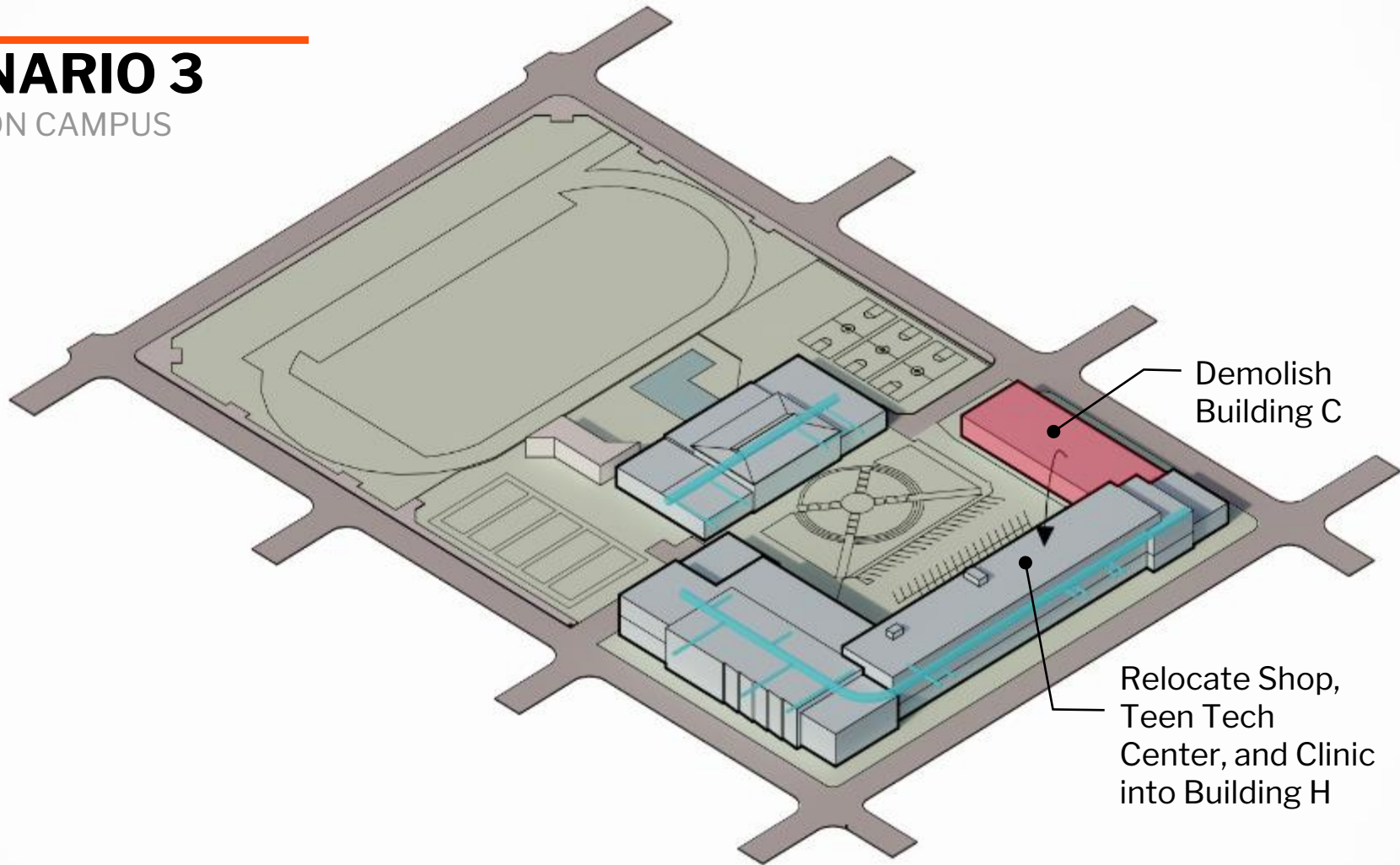

# SCENARIO 3

FOCUS ON CAMPUS

Minor updates in Gym,  
including new plumbing

New scoreboard and  
grandstand

Relocate parking &  
expand courtyard

Relocate  
basketball  
courts

Replace plumbing  
in Building A,B & H,  
new paint and  
furniture

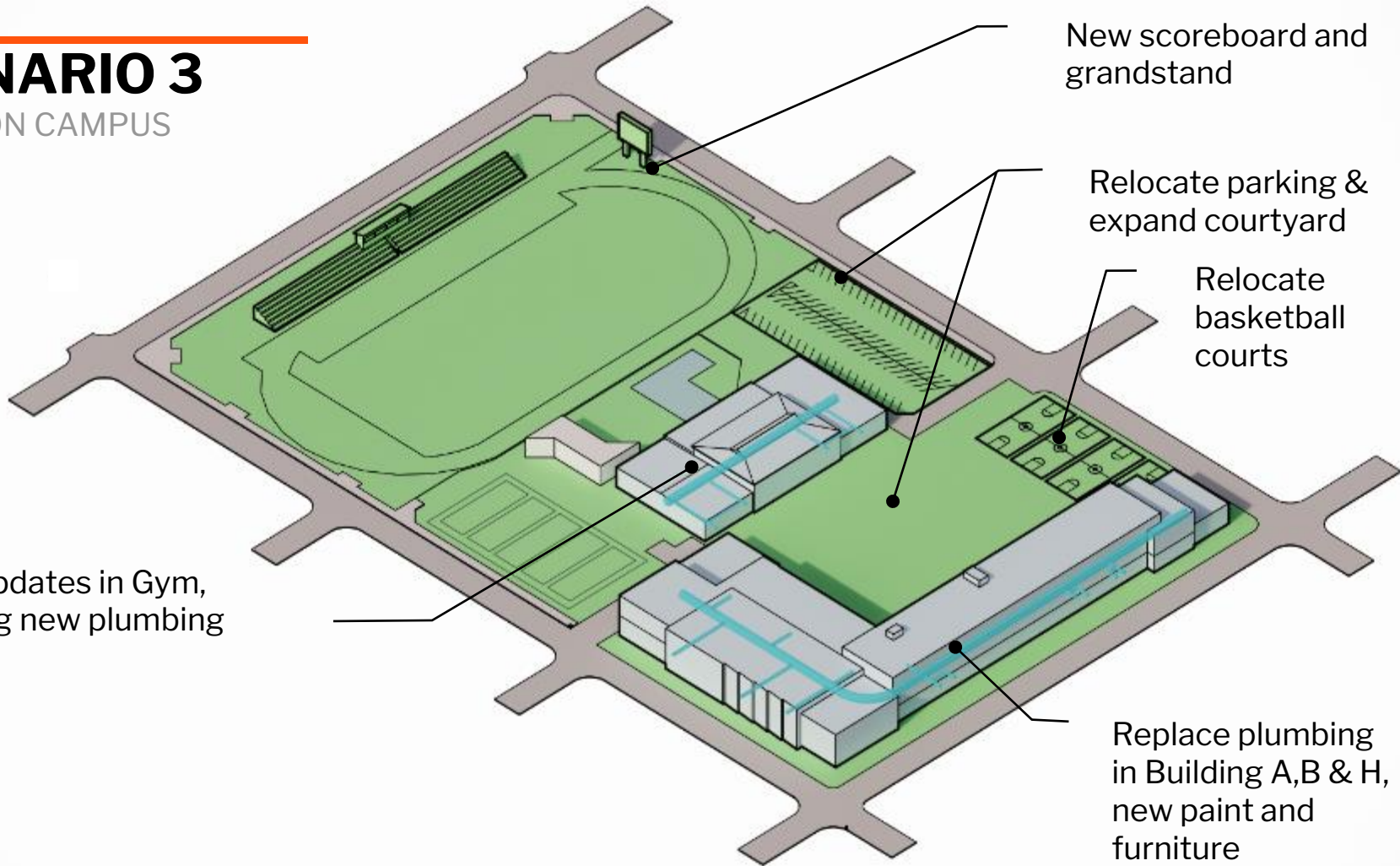

# SCENARIO 3

FOCUS ON CAMPUS

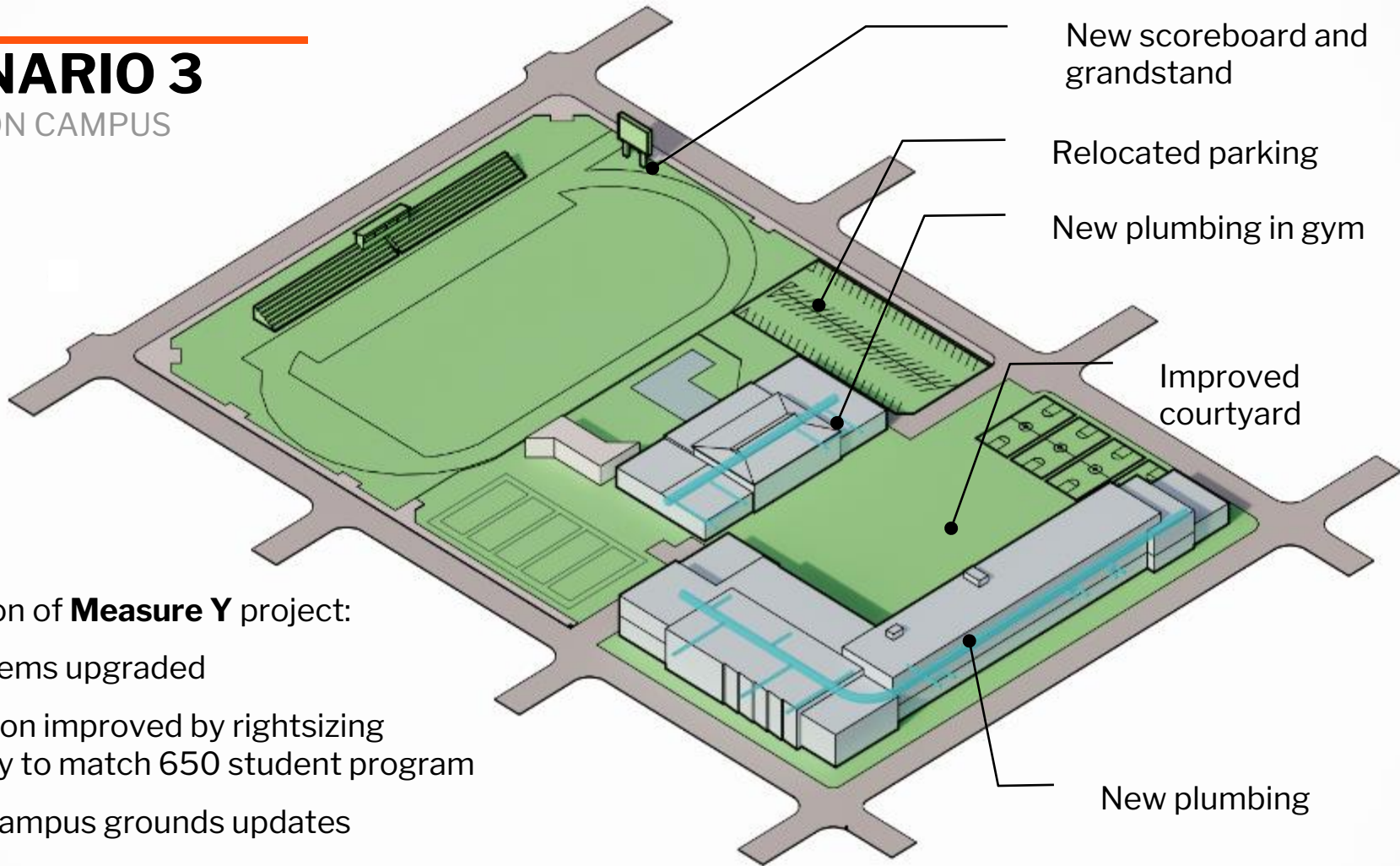

At conclusion of **Measure Y** project:

- All systems upgraded
- Utilization improved by rightsizing capacity to match 650 student program
- Major campus grounds updates

# SCENARIO 3

## FOCUS ON CAMPUS

Updates could include:

- New football grandstand and scoreboard
- Improved courtyard/relocated parking
- New primary campus entry point from 28<sup>th</sup> St
- Plumbing replaced throughout site (as in all scenarios)

### New Campus Entry



### New Grandstand



### Improved Courtyard



### Replace Plumbing



# SCENARIO 3

FOCUS ON CAMPUS

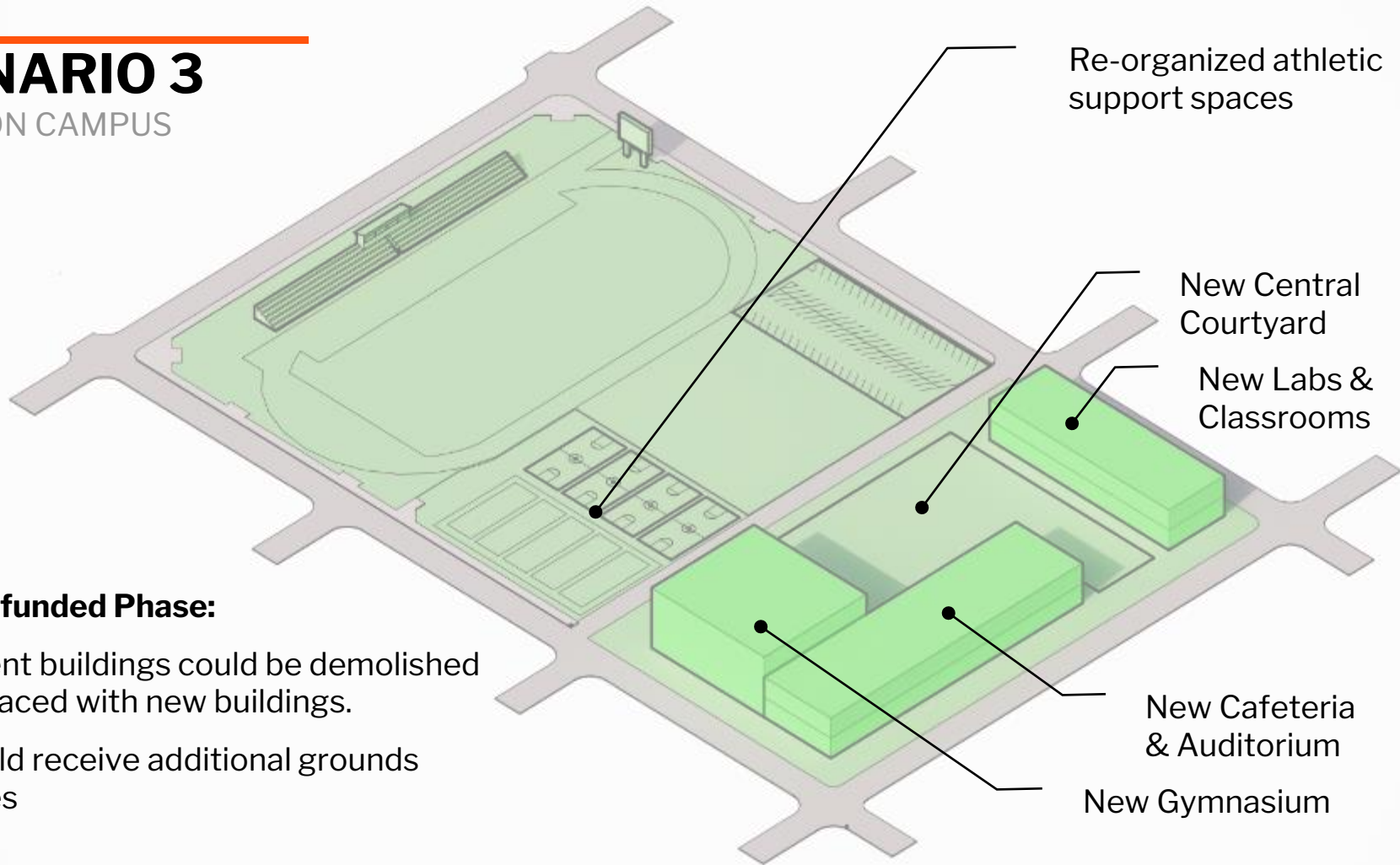

## In Future Unfunded Phase:

- All current buildings could be demolished and replaced with new buildings.
- Site could receive additional grounds upgrades

# CONCEPTUAL SCENARIOS

## COMPARISON

- = Meets criteria
- ◐ = Partially meets criteria
- = Does not meet criteria

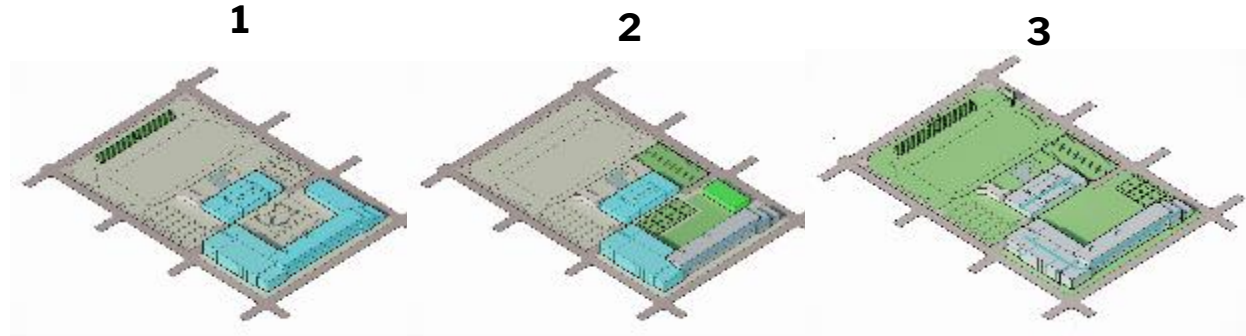

Safe & Healthy School



High Quality & Sustainable Facilities



Quality Community School



Grass Roots Community Engagement



Campus Access & Flow



School Image & Identity



Commitment to Budget and Schedule

# CONCEPTUAL SCENARIOS

## REACTIONS

### 1: DISTRIBUTED UPDATES

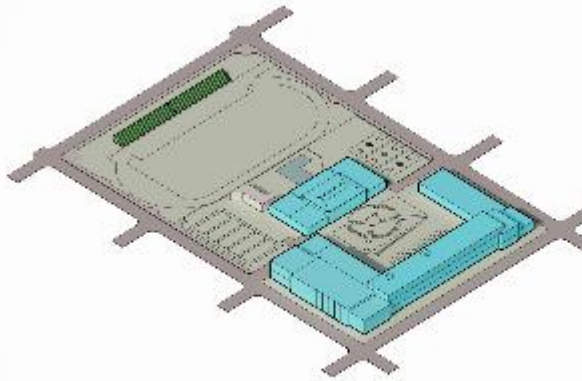

- No change in capacity or configuration
- All classrooms and labs updated
- Modest cafeteria and gym updates
- Minor campus grounds updates

### 2: NEW CLASSROOM BUILDING

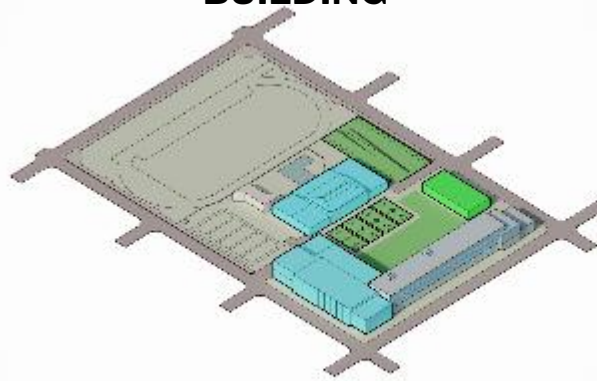

- No change in capacity
- New 6 classroom/lab building
- Focused updates for cafeteria, auditorium, and gym
- Modest campus grounds updates

### 3: FOCUS ON CAMPUS

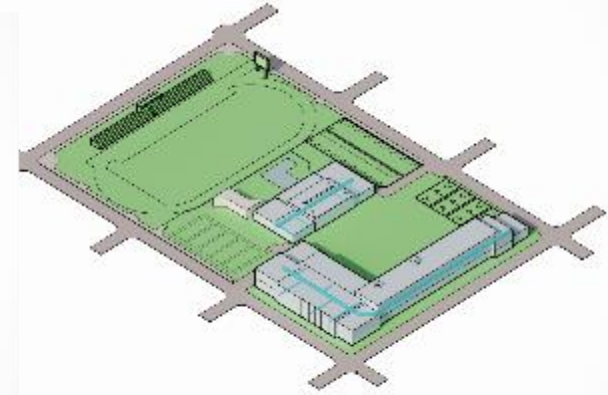

- Capacity rightsized
- Major campus grounds updates
- New paint and furniture across campus

# 1: DISTRIBUTED UPDATES

# 2: NEW CLASSROOM BUILDING

# 3: FOCUS ON CAMPUS BUILDING

APPEALING

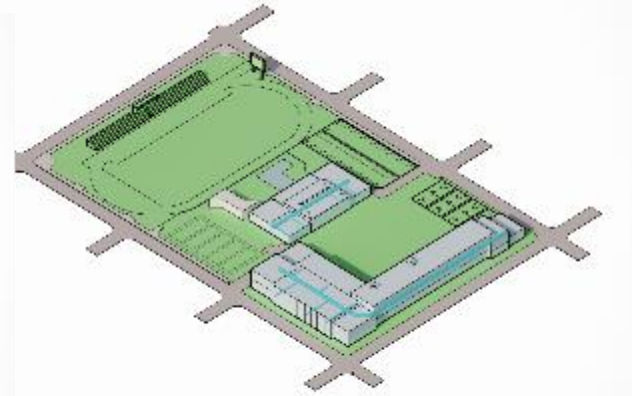
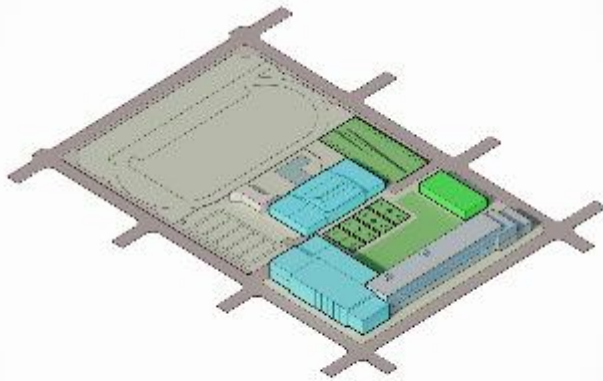
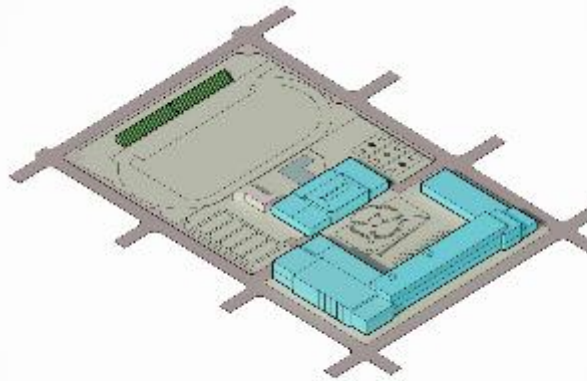

CONCERNING



---

# NEXT STEPS

- Share concepts with community – April 12<sup>th</sup>
- Continue student engagement
- Consolidate and organize reactions to conceptual scenarios
- Develop synthesized concept based on feedback
- Develop bridging documents with site concept; incorporate stakeholder needs
- To join Project Committee (next meeting May 3) or with other input:
  - [ray.bermudez@ousd.org](mailto:ray.bermudez@ousd.org)
  - <https://www.ousd.org/Page/21390>

**QUESTIONS?**  
**COMMENTS?**