

Microsoft Chromebook – Microsoft Remote Desktop Client V10 Setup and Use

This setup is only required to setup access to the Virtual Desktop. Students will only do this at the beginning of the semester or if their chromebook has to be repaired.

Step 1

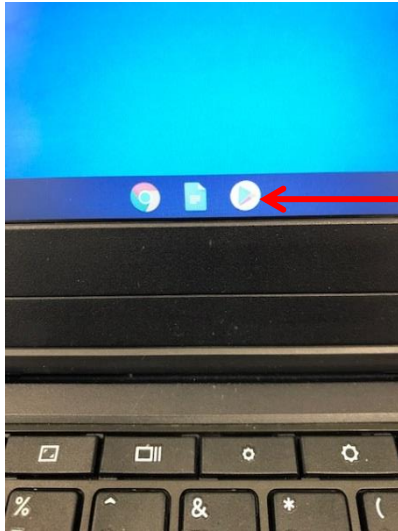

Click on Google Play Store Icon. If this is the first time, Google Play has to install. Once finished, click on the icon

Step2

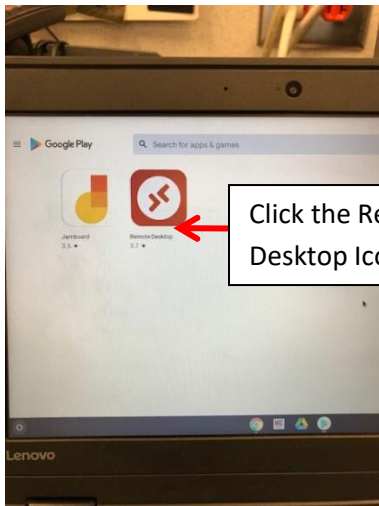

Click the Remote Desktop Icon

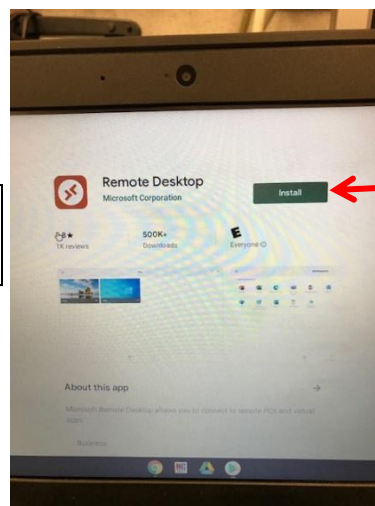

Click Install

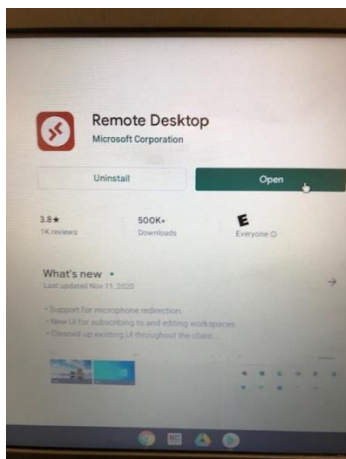

Click Open and accept Agreement

Step 3

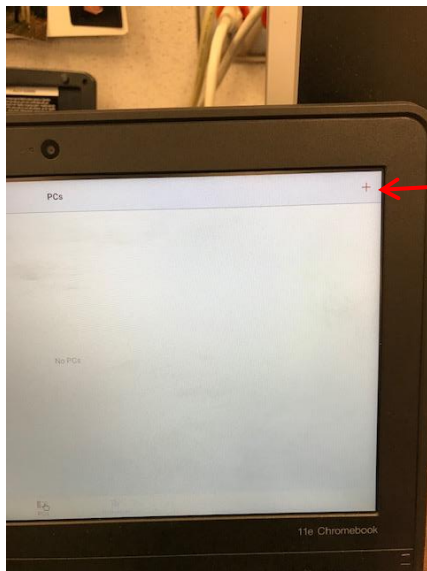

Click Red Plus (+) in top right corner of screen

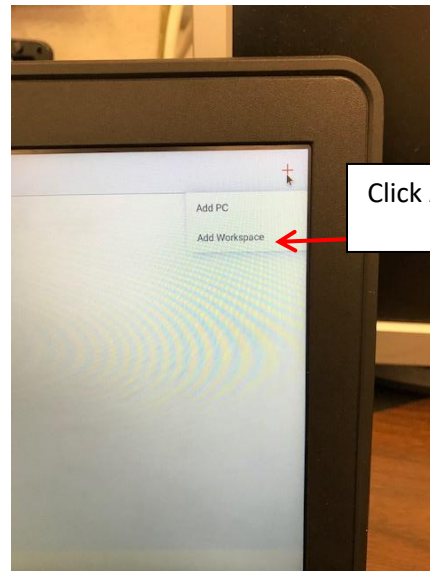

Click Add Workspace

Step 4

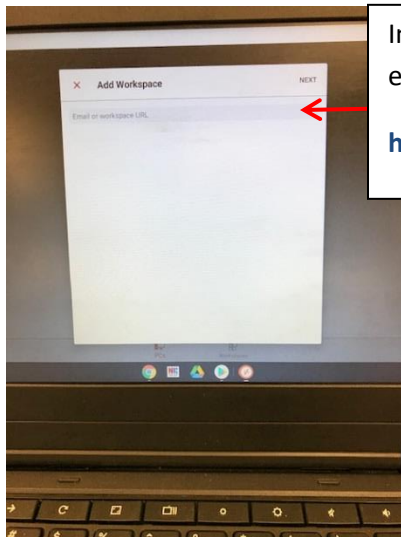

In the space that is labeled Email or Workspace URL, enter the following information:

<https://vlab.alexander.k12.nc.us>

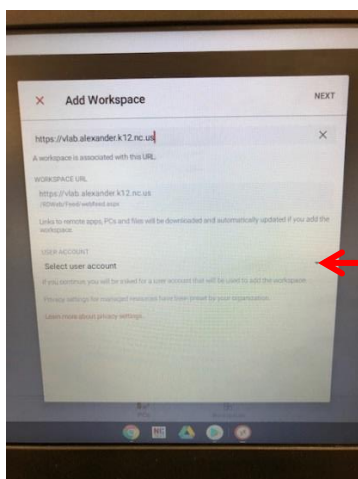

The screen will populate with a Workspace URL and will provide a line for User Account, Select User Account.

Click the down arrow and choose the radio button to "Add User Account"

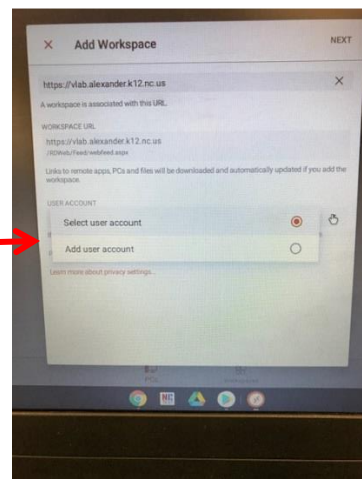

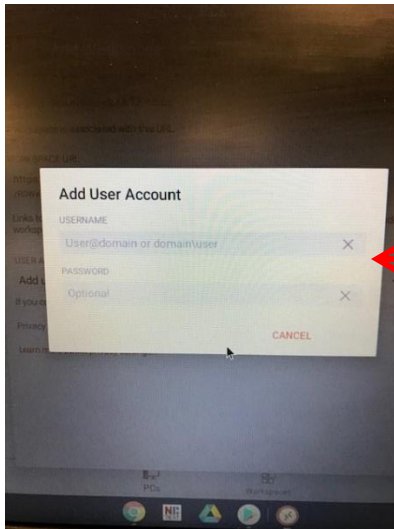

You are prompted for a username and password.

Username type the following:

ACSNC\Your Student Number
(actually type your individual student number, the first part of your email address)

Password is same password you use to login to Zscaler, the filter. It is your birthdate in 8 digit format, click save

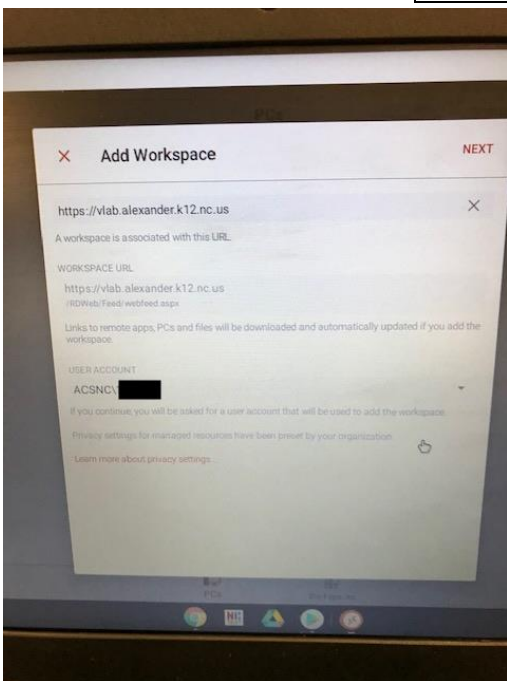

Click Next

Step 5

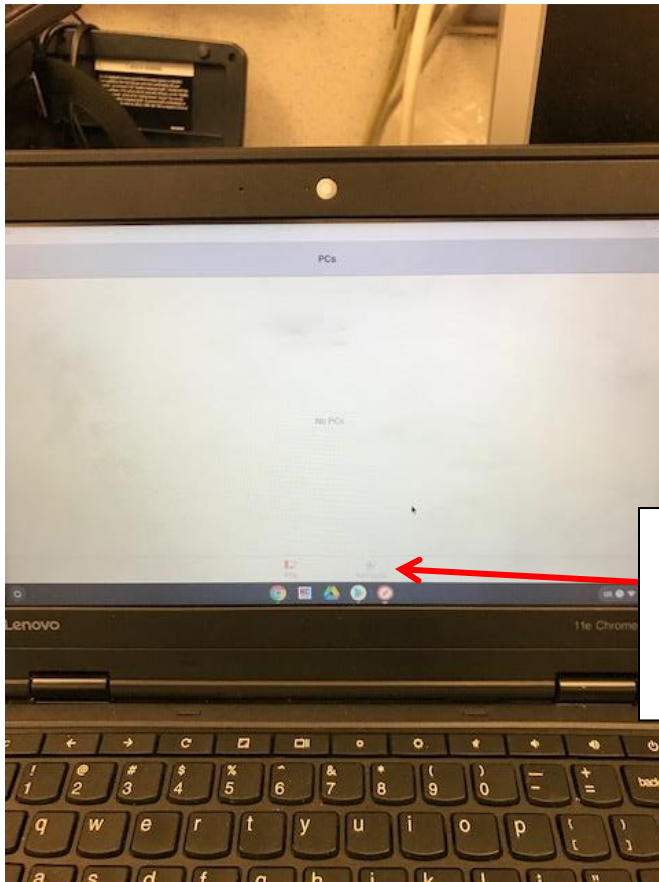

Directed back to initial screen, click the word Workspace

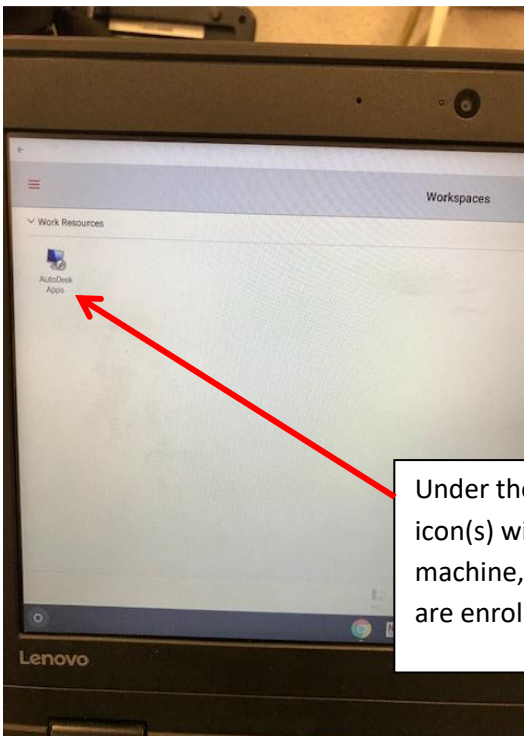

Under the words, "Work Resources" the icon(s) will appear for your virtual machine, depending which classes you are enrolled in.

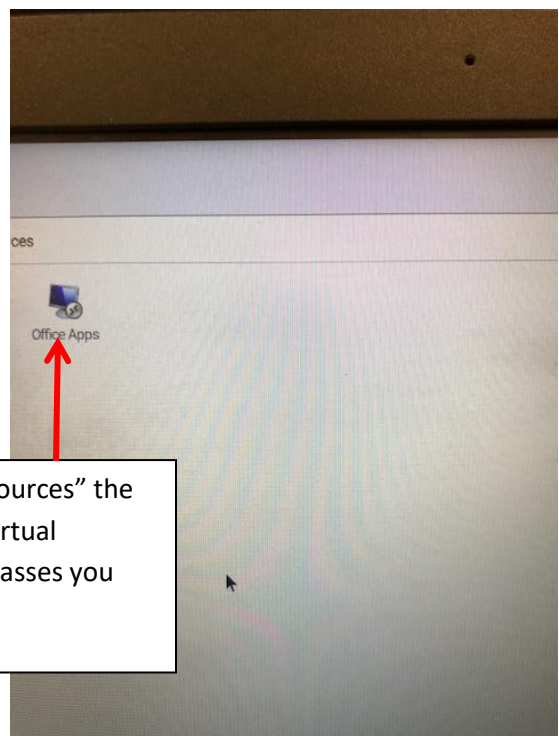

Step 6 will depend on the class you are enrolled in.

For Drafting Classes, The AutoDesk App

Click AutoDesk Icon

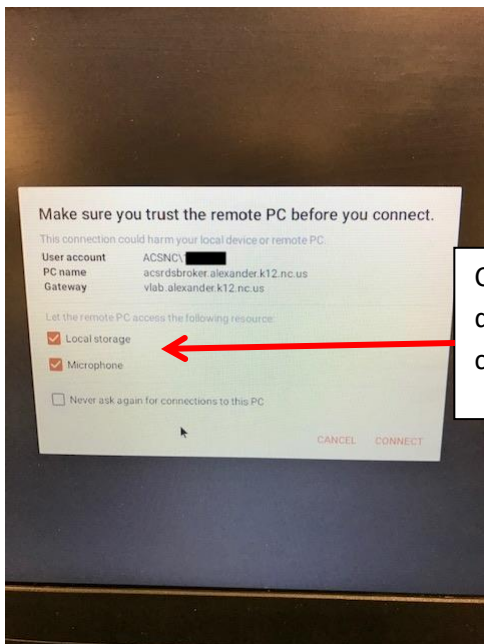
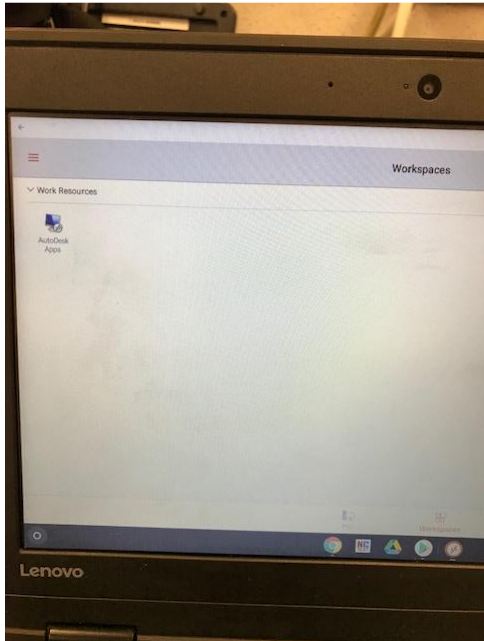

Choose "Never Ask Again" and keep the defaults that are checked, then click connect

Choose Allow for both the next dialogue boxes that appear

Allow **Microsoft Remote Desk...** to access photos, media, and files on your device?
1 of 2 DENY ALLOW

Allow **Microsoft Remote Desk...** to record audio?
2 of 2 DENY ALLOW

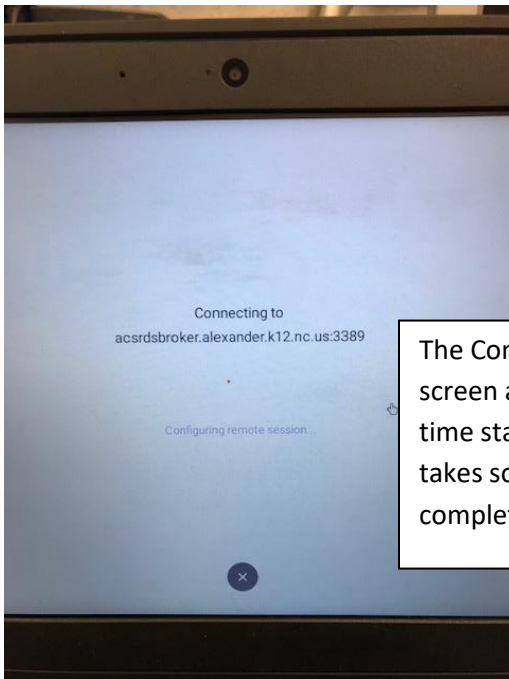

The Connecting to screen appears, first time start the session takes some time to complete,

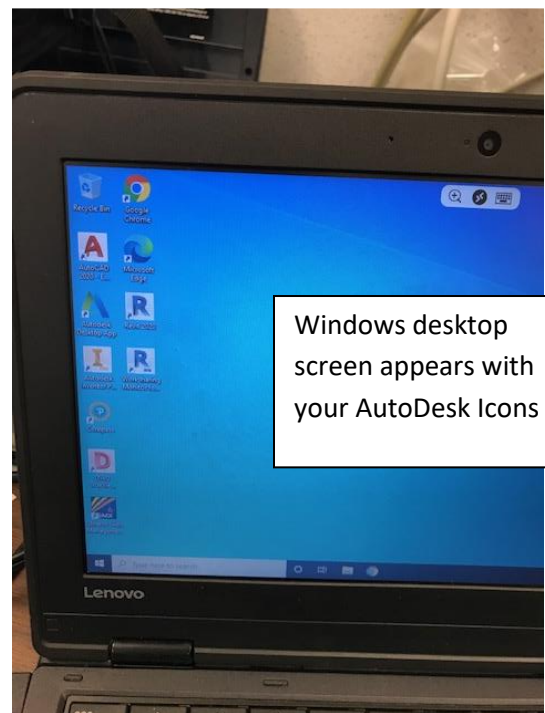

Windows desktop screen appears with your AutoDesk Icons

Step 7

Activate your AutoDesk Apps

Activate AutoCad first: click AutoCad Icon

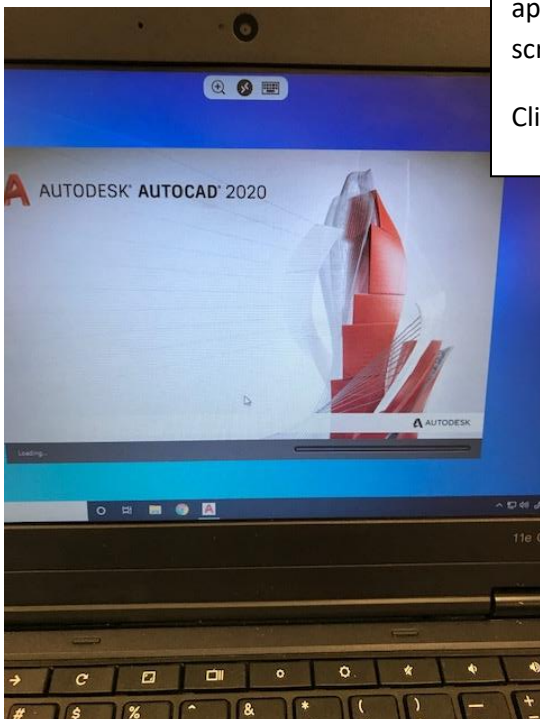
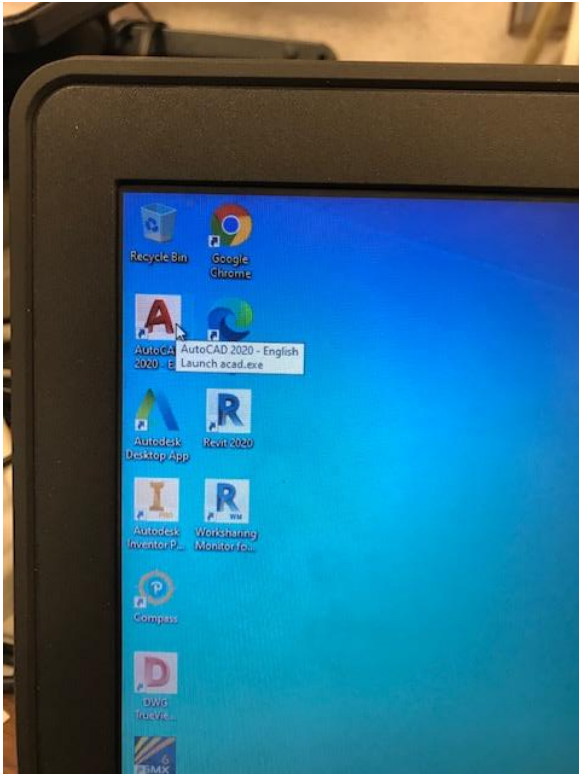

This splash screen should appear followed by this screen.

Click I agree

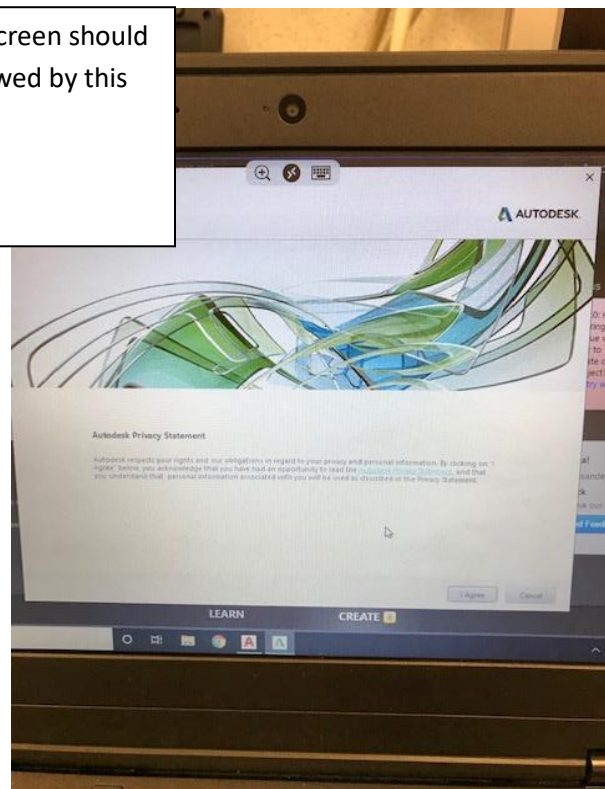

The software will be licensed, verify by looking for the words “Educational Version”

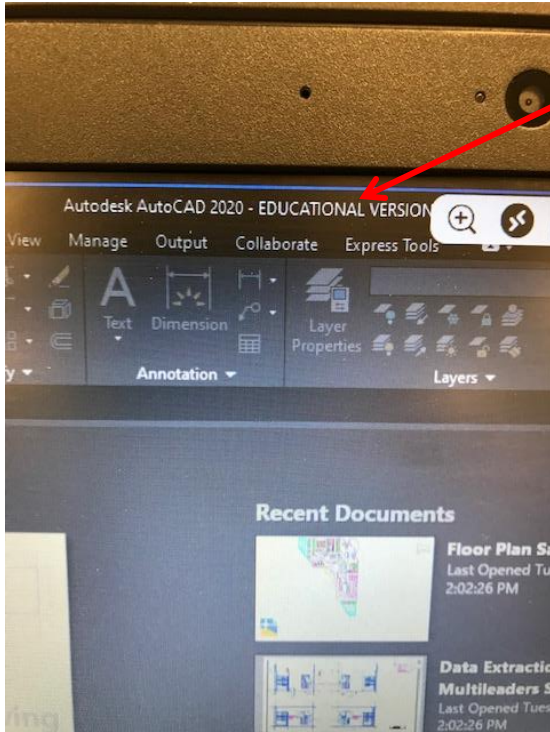

Open both Revit and Inventor to activate those apps as well.

Manage Your Virtual Machine

Hover with mouse at top of windows screen, a red bar appears, click on arrow at top left twice, returns you to the "Workspace" screen with the AutoDesk App or Microsoft Apps Icon

From the Workspace screen you can minimize the remote desktop screen by using the minus – icon in top right of screen. You are returned to your chromebook screen but can access remote desktop again by clicking on the Remote Desktop icon at bottom of screen.

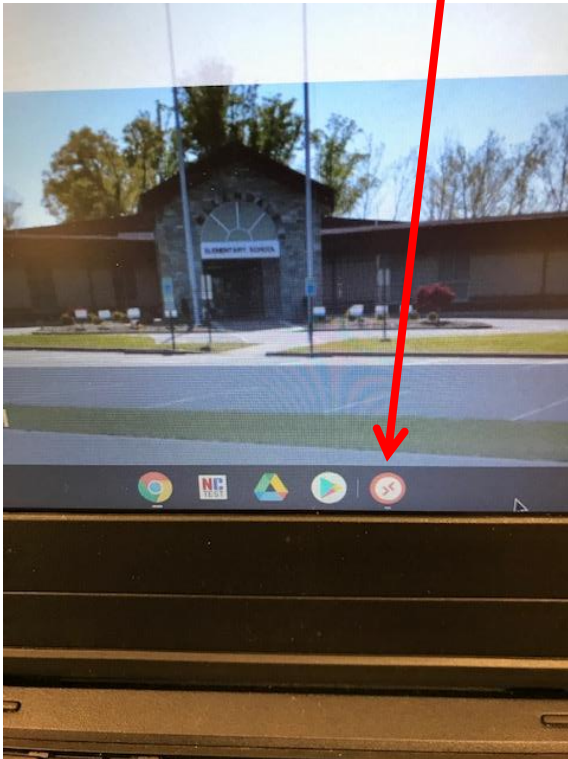

To exit from remote desktop entirely, from the Workspace screen, click the arrow at top left of screen in grey area, you are returned to chromebook screen

To start a remote desktop session after the initial setup: click on the remote desktop icon

