



Site Access Plan  
 Ferrucci Junior High School  
 3213 Wildwood Pk. Dr.  
 Puyallup, WA 98374

Scale:  
 NTS  
 Drawn By:  
 RG  
 Date:  
 May 2019  
 Site/ Bldg/ Floor No.  
 30-Site  
 Range/ Township/ Section:  
 04-19-02  
 Parcel Number(s):  
 0419023002

Sheet No.  
 C1 of 1

**NOTES:**

- A key must be obtained from Security to open the locked gate.
- There is no curb cut from the parking lot to allow access to the building and/or field

**Locked Gate**

**Field Access**

**Field**

**Building Access**

**Curb cut does not meet ADA standards**

Wildwood Park Drive SE

**Field and Building Access Photo Locations**

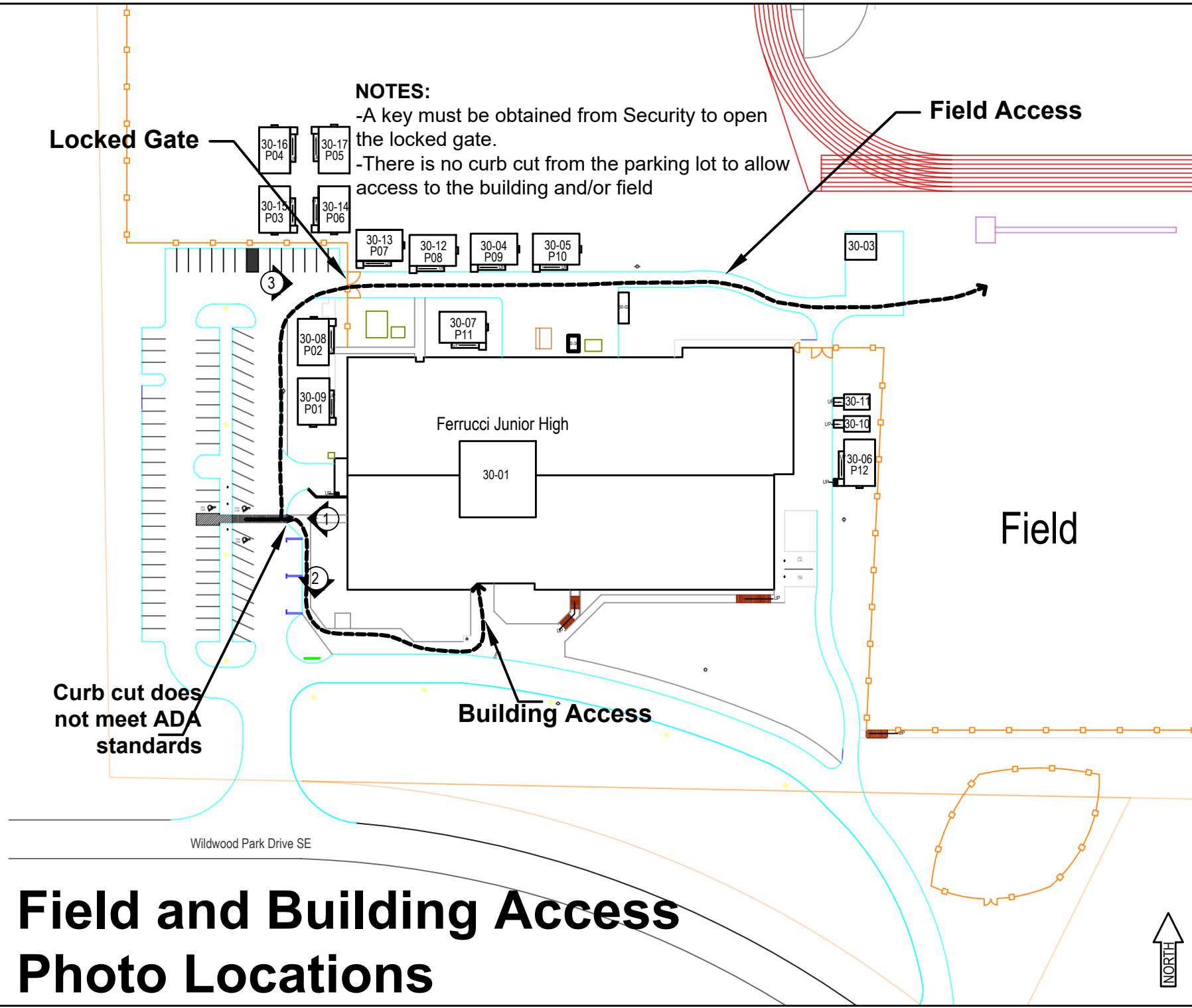

## Ferrucci Field and Building Access Picture Index

1



ADA parking stalls at Ferrucci. Note that the stalls and curb cuts do not meet all ADA standards. For building and/or field access, use the crosswalk toward the curb cut.

2



For building access, use the curb cut and continue south along the sidewalk, and around to the front of the building. For field access, continue north on the asphalt.

3



Follow the asphalt to the north end of the parking lot, and continue down the path by going through the vehicle gate. This gate is often locked. A key may be obtained from Security. For field access, follow the path east, down toward the field.