

# Signing into your Chromebook and Accessing Teams

After turning on your Chromebook you will be met by this screen. First step is to go down to the bottom right of the screen to join your at home Wi-Fi.

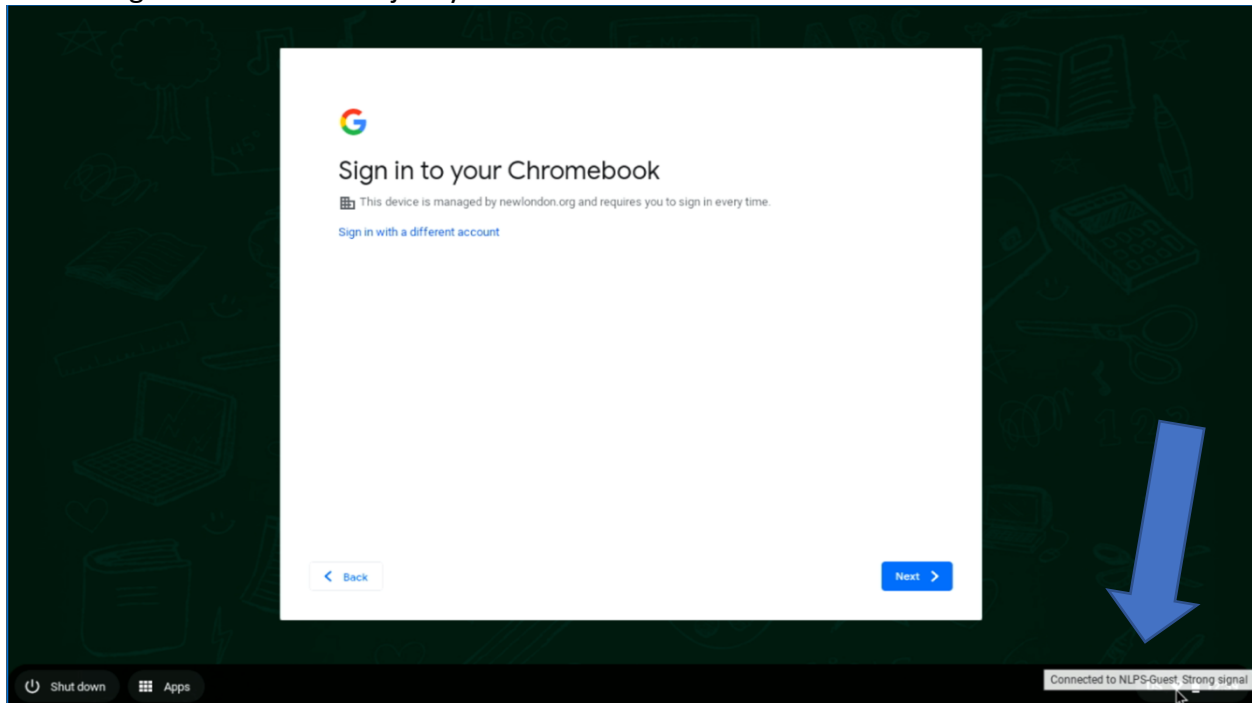

Select the WIFI button.

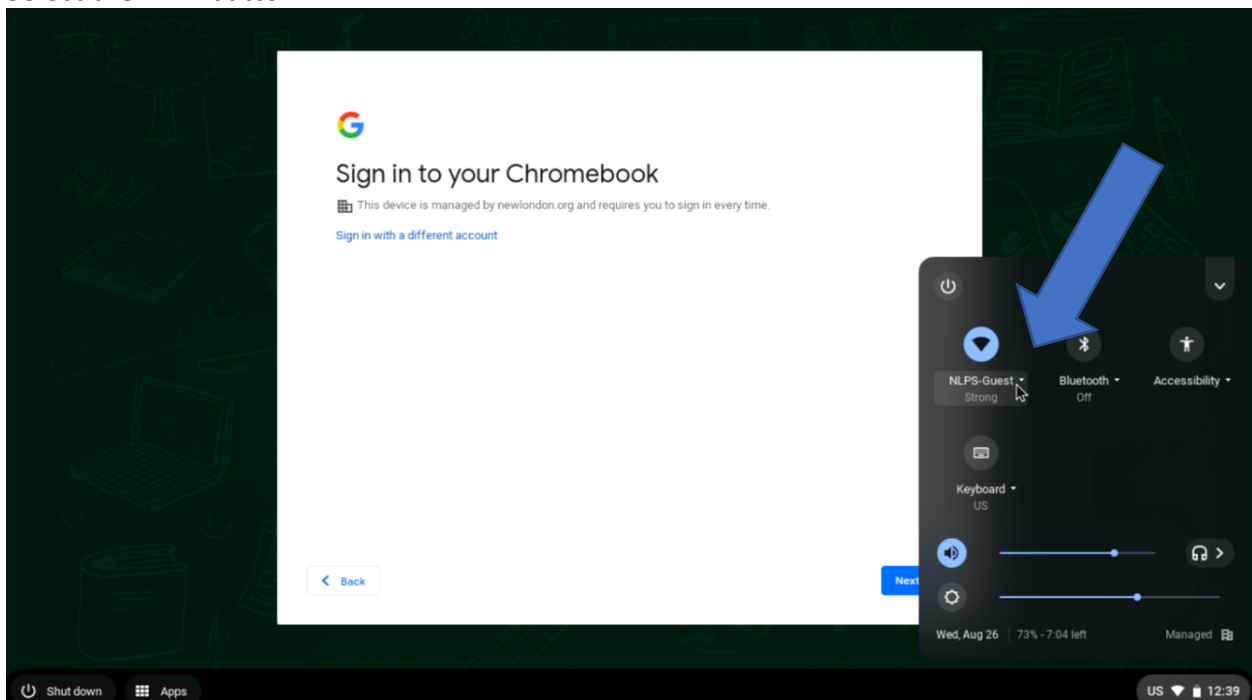

Choose your WIFI network from the list of available Networks.

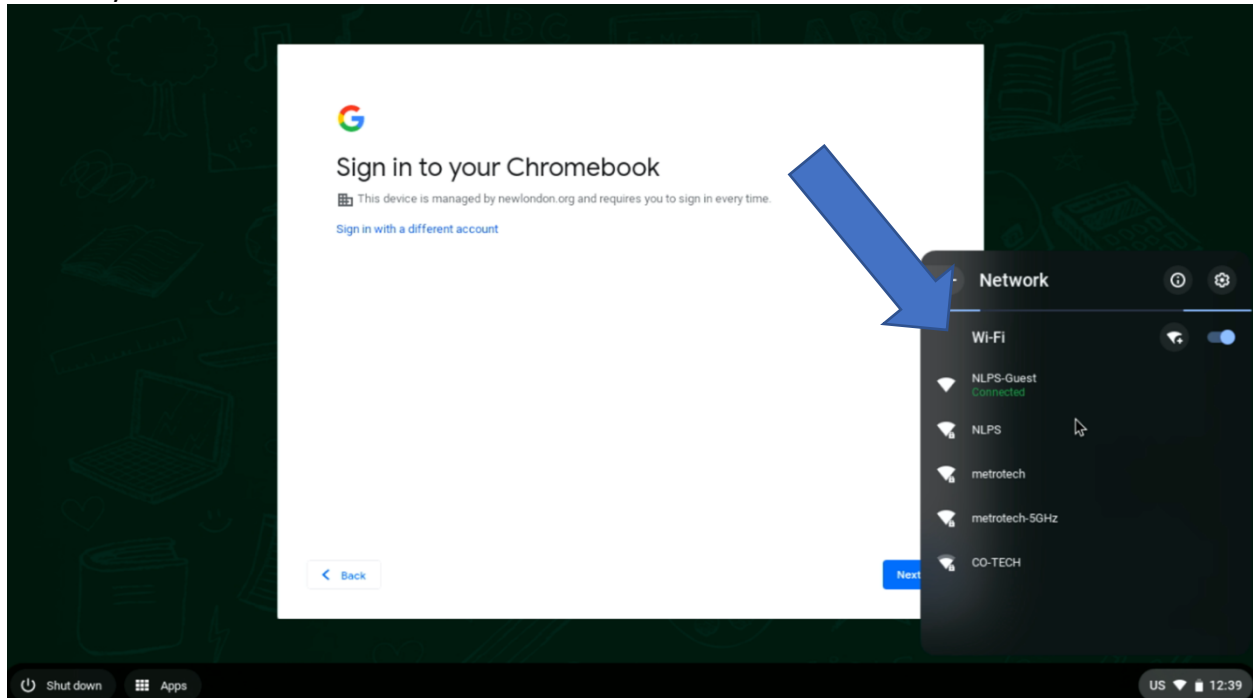

After connecting to your network, select next.

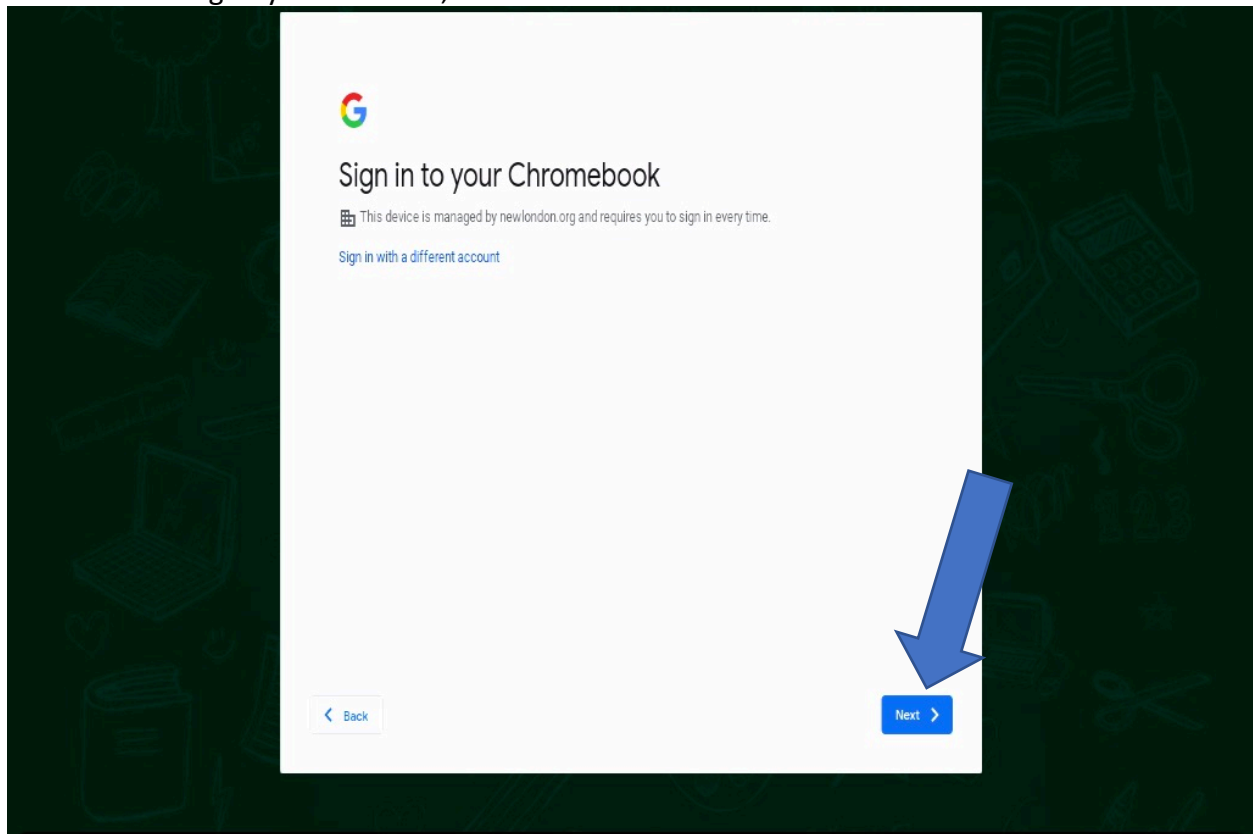

Enter your Email/Password, and then select Sign in. **\*\*If you are a middle or high school student, you will be requested at this point to create a new password. Please refer to the Student Emails and Passwords document for password requirements\*\***

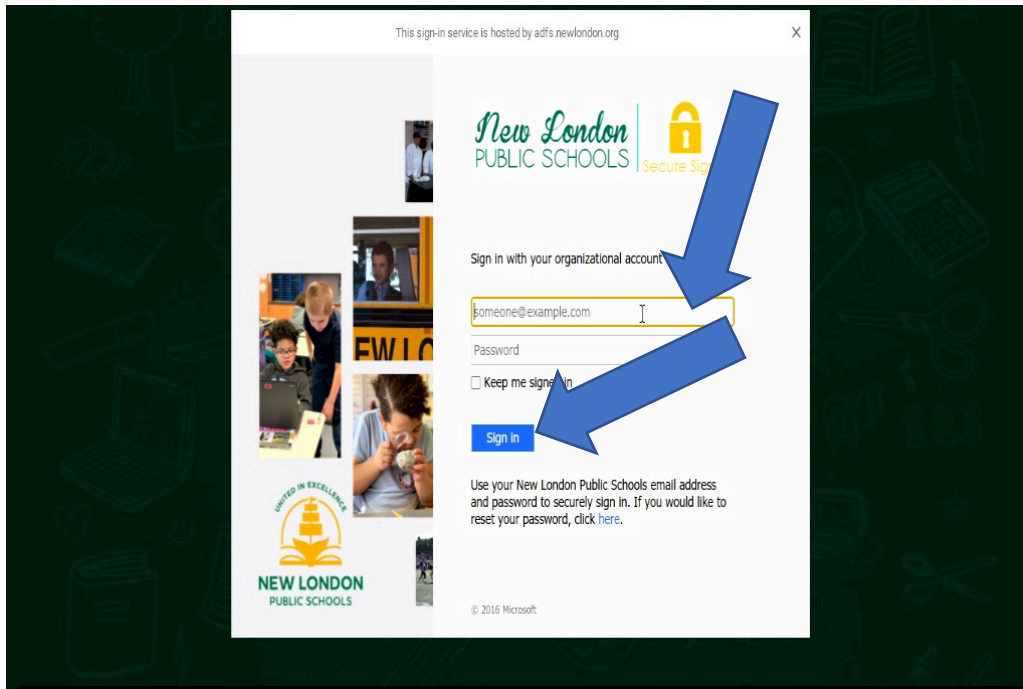

Select accept

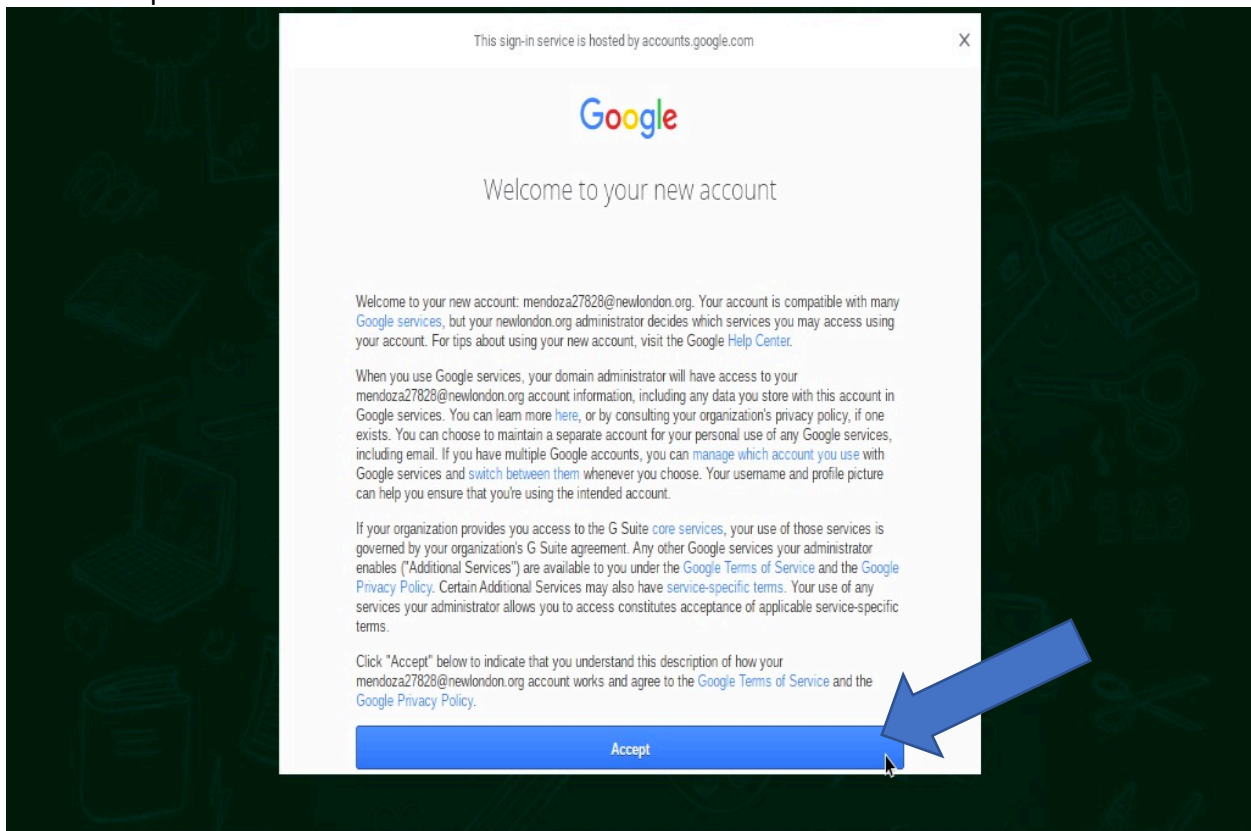

You should now arrive at the Clever Portal Page automatically.  
Select Microsoft Teams.

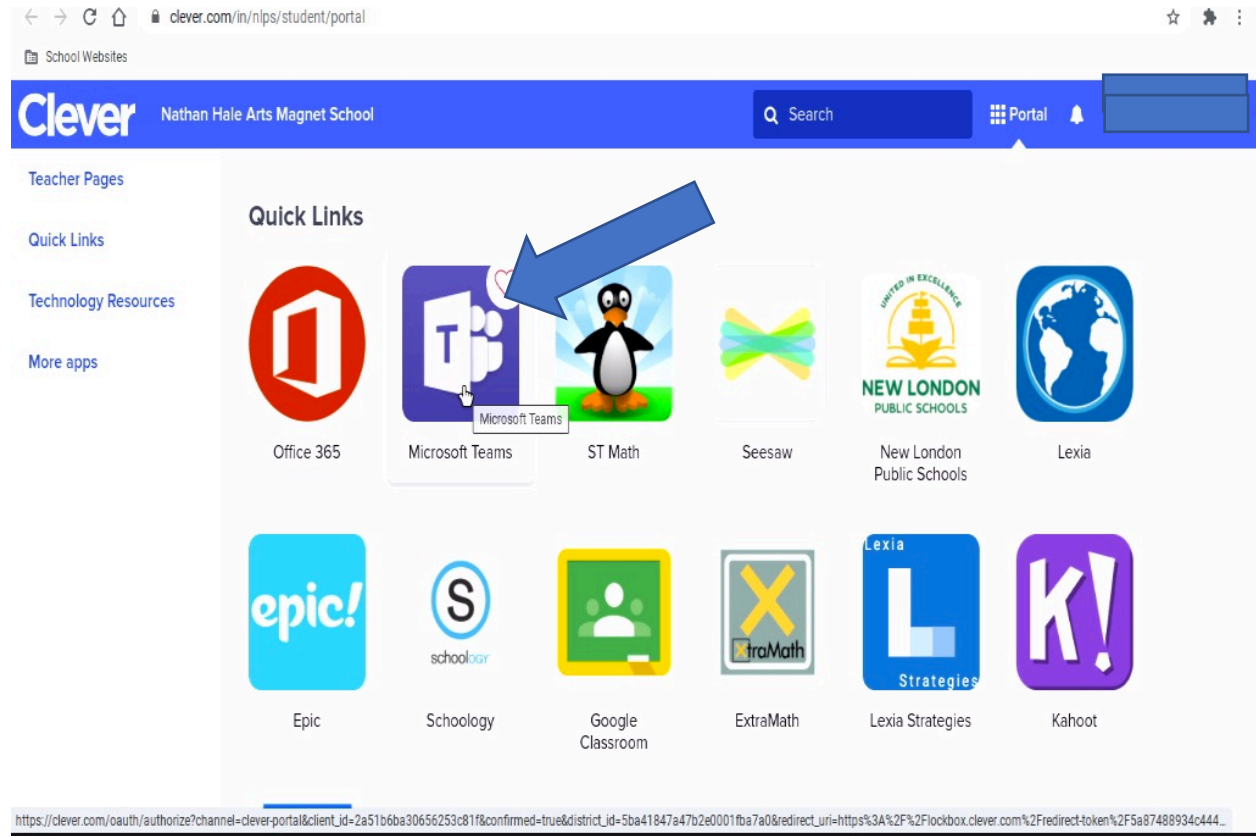

Enter your New London Email and Password and select Save.

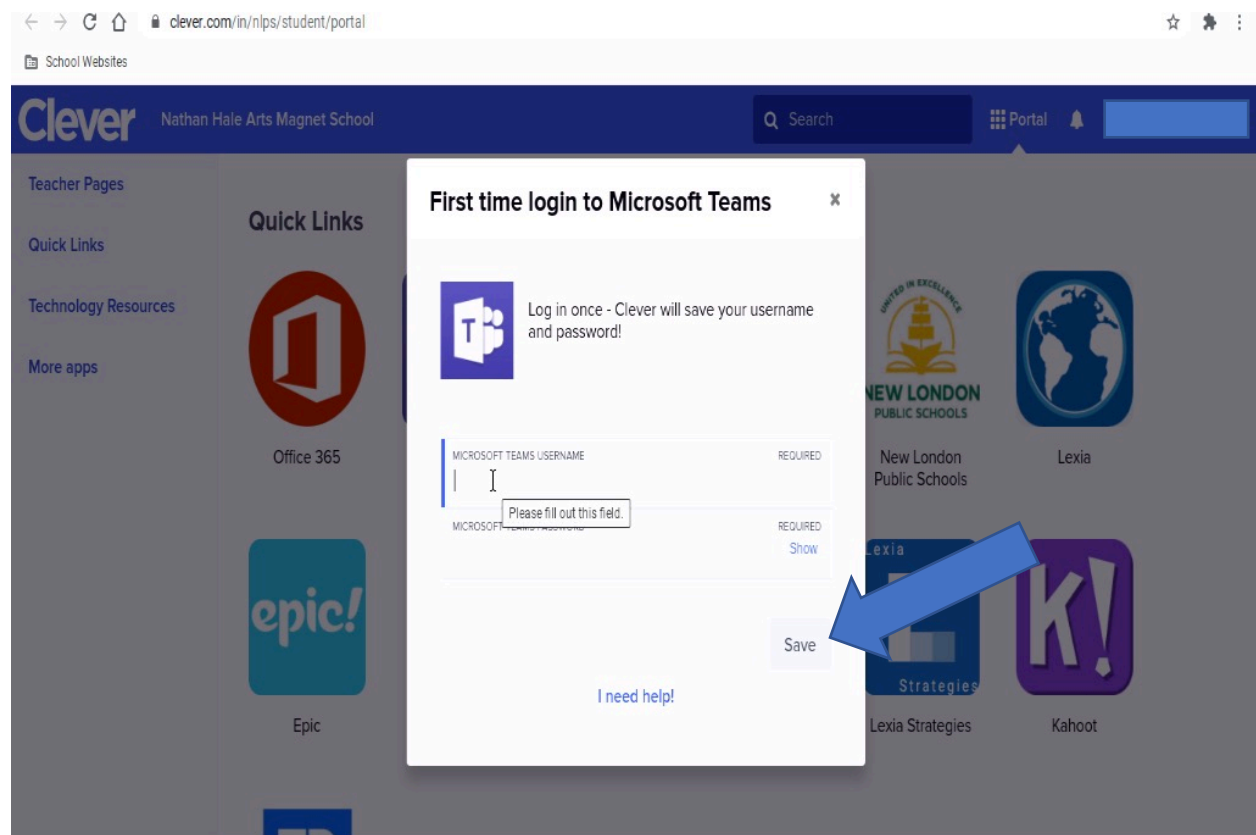

Select Don't show this again, and then select Yes.

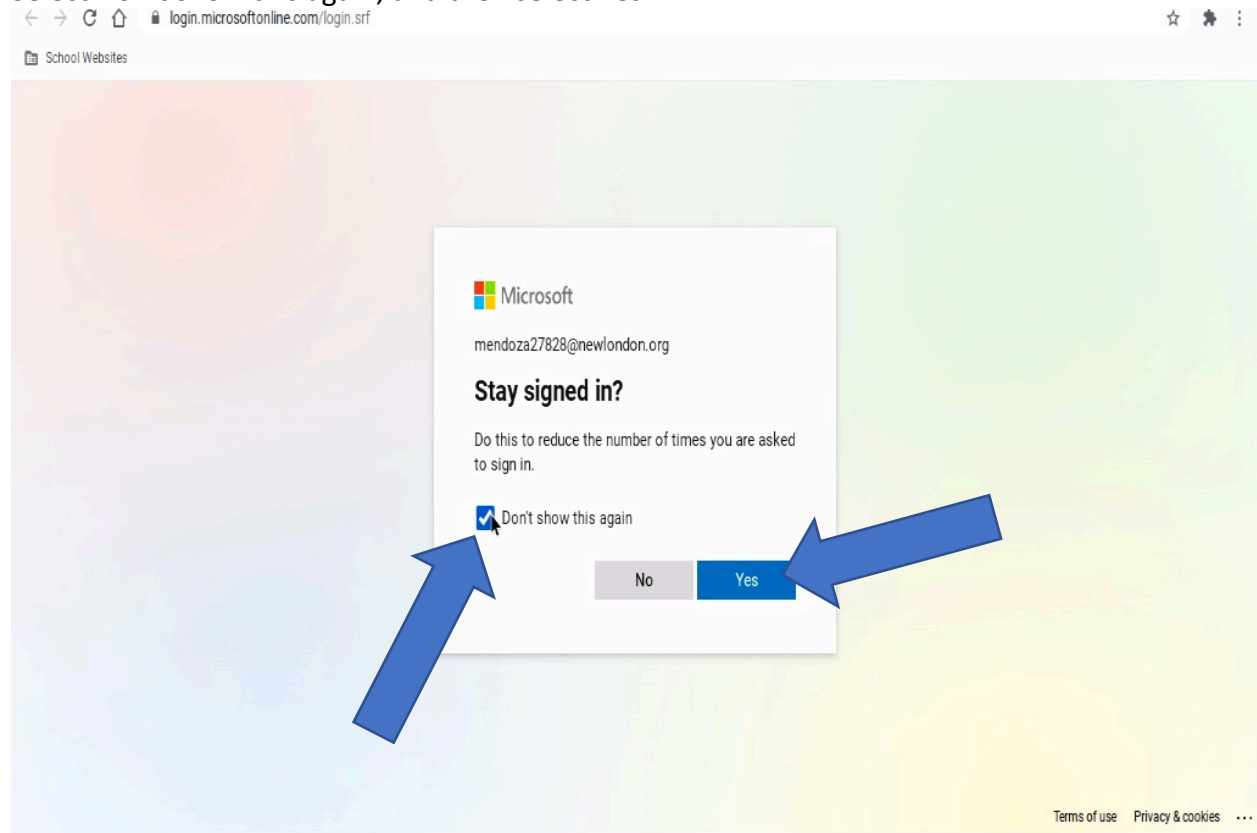

You are now signed into Microsoft Teams.

