

Puyallup High 50-S1 Base Site Plan

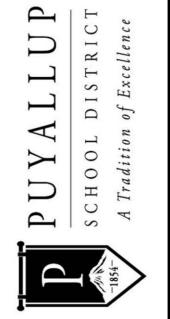
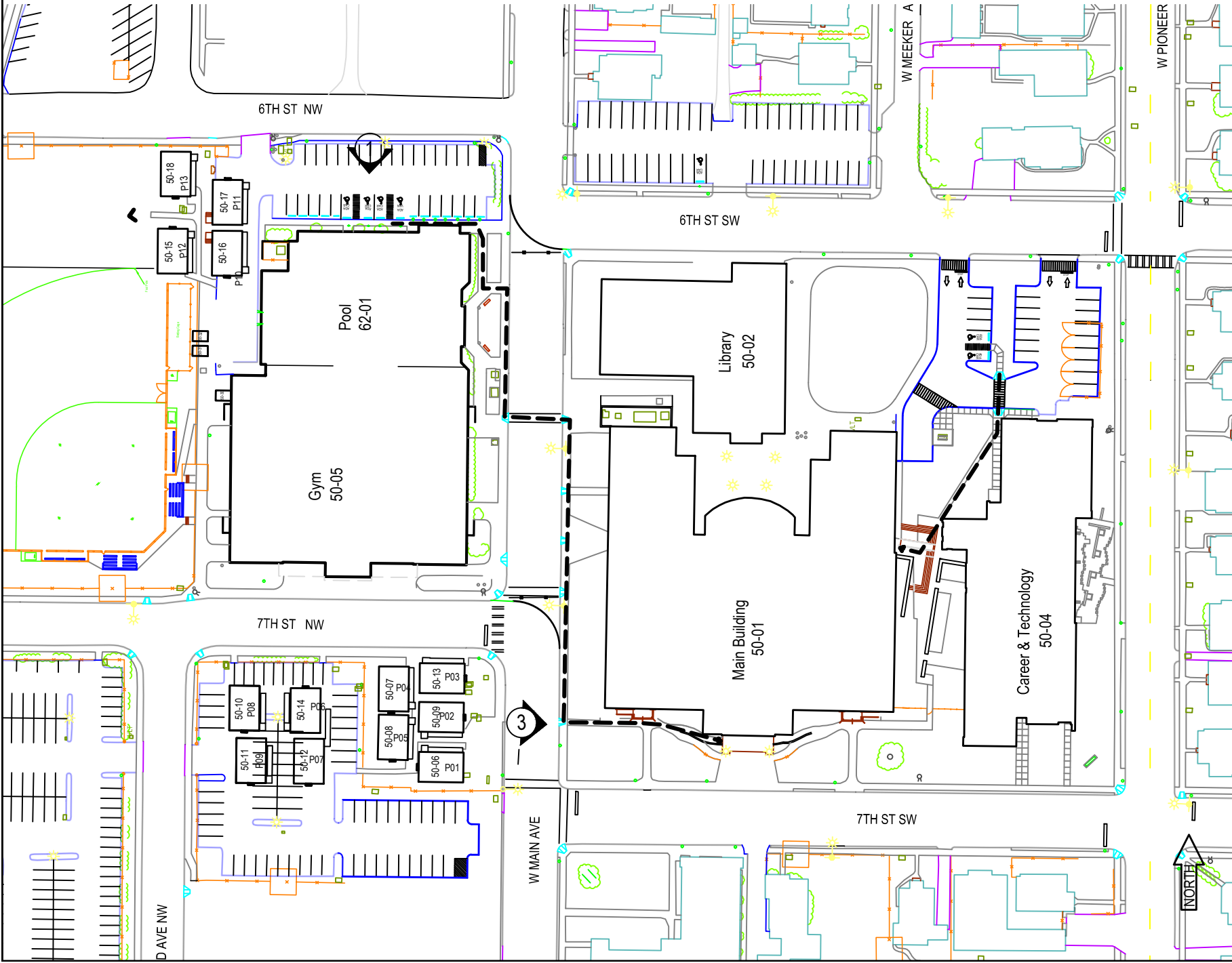

Site Access Plan
 Puyallup High School
 105 7th St. S.W..
 Puyallup, WA 98371

Scale:
 1"=100'

Drawn By:
 RG

Date:
 July 2019

Site/ Bldg/ Floor No.
 50-Site

Range/ Township/ Section:
 04-20-28

Parcel Number(s):
 5505000010
 5870000150

Sheet No.

C1 of 1

Puyallup Field and Building Access Picture Index

1



From the ADA stalls in the pool parking lot, continue north between the portables for field access. For building access, go south and follow the sidewalk west along main.

2



Use the curb cuts and crosswalk to cross West Main Ave.

3



Once across West Main, continue following the sidewalk west until you reach the corner of the main building. Turn south, following the sidewalk, and take the ramp up to the front doors.

Scale:
NTS

Drawn By:
RG

Date:
July 2019

Site/ Bldg/ Floor No.
50-Site

Range/ Township/ Section:

Parcel Number(s):

Sheet No.