



# AZUSA UNIFIED SCHOOL DISTRICT

ADDENDUM NO.2 BID 22-23-04-01

## RFP for Copiers Lease and Maintenance Services

1. In the document “Current Print Shop, Copier, Printer Information Summary,” the “Summary” tab shows Print Shop devices, such as the Xerox Nuvera MFF-120, Xerox Versant 180 P, W7845pt,v180exp. These devices are now part of this RFP.

**Current Copier,MPS and Print Shop Summary.**

Category	Meter Type	Monthly Volume	Part of this RFP 22-23-04-01
Workgroup Copier Fleet (76) Devices	B/W	626,069	Yes
	Color	86,076	Yes
D95(95pages/min)	B/W	20,726	Yes
Managed Print Services: (508) Desk-top Devices.	B/W	88,840	No
	Color	17,306	No
Nutrition Services: WC7845(MX4778750)	B/W	3,550	Yes
	Color	1,313	Yes
Xerox Nuvera MFF-120	B/W	20,837	Yes
Xerox Versant 180 P	B/W	6,726	Yes
	Color	14,319	Yes
	Color XL	-	Yes
EFI Fiery	B/W	10316	Yes
Xerox 570w/Fiery Controller (Owned by AUSD)	B/W	1,809	Yes
	Color	2,515	Yes

Summary | 76 Copiers AMV

2. The current devices are having “Follow You Print” function. This function should be kept in the new contract.

3. School Map is on the following page. School re-organization will be completed by the end of 2023. Re-org information is below:

- Foothill Middle School, Slauson Middle School, Center Middle School. All moved to the renamed -Gladstone Middle School, which is the current Gladstone High School located.
- The current Foothill MS campus will become part of Azusa High School as Azusa High School East.
- Powell Elementary School and Ellington Elementary School will be closed.

Please keep proposing the best operation plan for now and the new re-organized sites.

If the re-organization effect the lease copiers quantity, either reduced or increased, the contractor should coordinate for the best operational requirement by returning, installing more, or relocating.

4. Regarding the finisher, please propose the lease price by “with finisher” and” without finisher,” we will select the finisher base on the AMV.
5. Regarding the Paper Cut licenses, the contractor is responsible for providing the copiers with Paper Cut licenses.
6. Enrollment after the re-organization.

#	Before Re-organization	After Re-organization	
	Schools	Schools	Student enrollment
1	Azusa High School	Azusa High School	1790
2	Gladstone High School	<b>Re-organized</b>	\
3	Sierra High School	Sierra High School	190
4	Center Middle School	<b>Gladstone Middle School</b>	1416
5	Foothill Middle School		
6	Slauson Middle School		
7	Henry Dalton Elementary	Henry Dalton Elementary	310
8	Alice Ellington School (TK-8)	<b>Re-organized</b>	\
9	Victor Hodge Elementary	Victor Hodge Elementary	475
10	Charles H. Lee Elementary	Charles H. Lee Elementary	535
11	Longfellow School (PK/K)	Longfellow School (PK/K)	36
12	Magnolia Elementary	Magnolia Elementary	284
13	Clifford Murray Elementary	Clifford Murray Elementary	374
14	Paramount Elementary	Paramount Elementary	565
15	W.R. Powell Elementary	<b>Re-organized</b>	\
16	Valleydale Elementary	Valleydale Elementary	612

7. Following pages are each site’s layout maps.

**DIAGRAM OF BUILDING AREAS**

- EXISTING (1-A)
- BASIC PLANS (2-A)
- FINAL PLANS (3-A)

SCHOOL DISTRICT: **AZUSA USD** PROJECT NO.: **19-1190**

SCHOOL: **AZUSA HS** ADDRESS: **240 N. CERRITOS AVENUE, AZUSA**

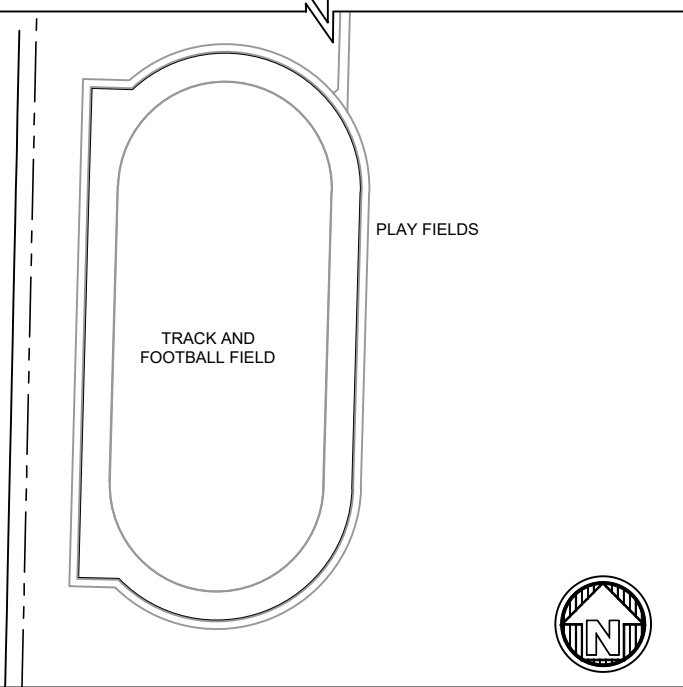
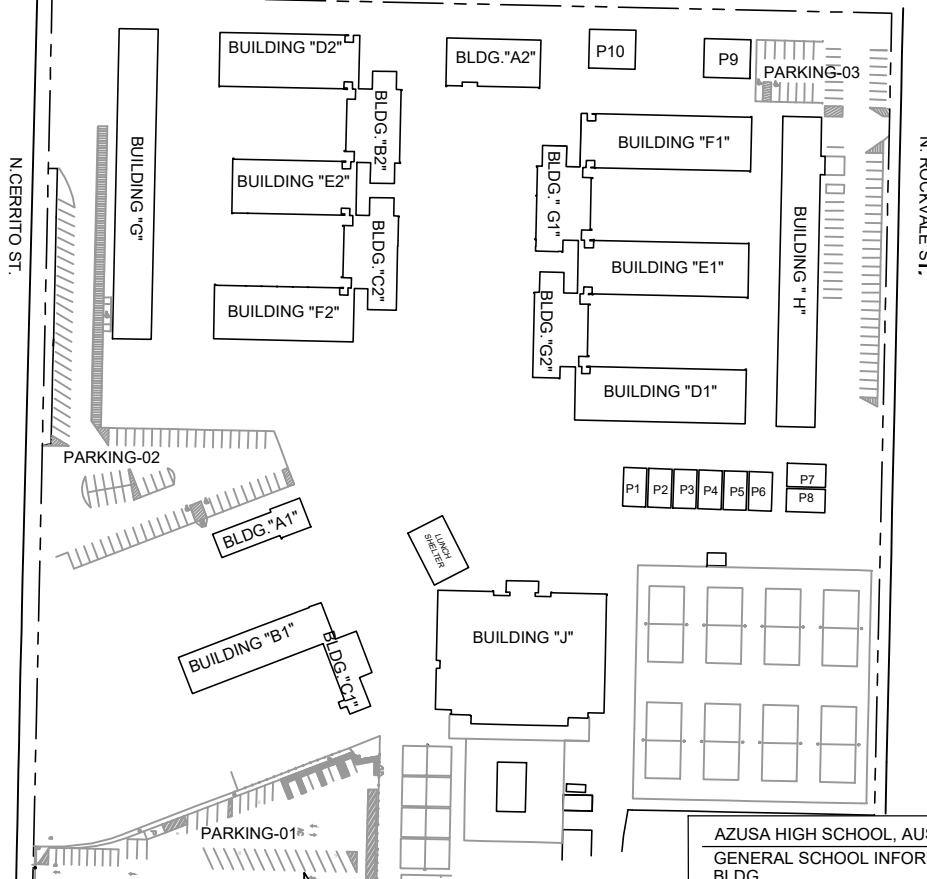

**AZUSA HIGH SCHOOL, AUSD**

**GENERAL SCHOOL INFORMATION SUMMARY**

BLDG NO.	BLDG NAME	BLDG AREA TOTAL (SF)	DSA NUMBER	DATE / YR BUILT	CLSD / CERT.
A1	ADMIN OFFICE	2,736 SF	A# 13141	N/A	N/A
A2	LIBRARY	4,773 SF	A# 14345	N/A	N/A
B1	CLASSROOMS	6,356 SF	A# 13141	N/A	N/A
B2	SENIOR HALL	5,097 SF	A# 14345	N/A	N/A
C1	KITCHEN	2,456 SF	A# 13141	N/A	N/A
C2	CLASSROOMS	5,097 SF	A# 14345	N/A	N/A
D1	CLASSROOMS	8,031 SF	A# 13141	N/A	N/A
D2	CLASSROOMS	8,031 SF	A# 14345	N/A	N/A
E1	CLASSROOMS	8,031 SF	A# 13141	N/A	N/A
E2	CLASSROOMS	8,031 SF	A# 14345	N/A	N/A
F1	CLASSROOMS	8,031 SF	A# 13141	N/A	N/A
F2	CLASSROOMS	8,031 SF	A# 14345	N/A	N/A
G	CLASSROOMS	13,213 SF	A# 14345	N/A	N/A
G1	MULTI-USE	5,097 SF	A# 13141	N/A	N/A
G2	MULTI-USE	5,097 SF	A# 13141	N/A	N/A
H	CLASSROOMS	13,213 SF	A# 13141	N/A	N/A
J	GYMNASIUM	23,304 SF	A# 13141	N/A	N/A
-	POOL	1,518 SF	A# 14361	N/A	N/A

**ADDITIONAL SCHOOL INFORMATION SUMMARY**

DSA NUMBER	BLDG(S) NAME / DESCRIPTION	DATE / YR BUILT	CLSD / CERT.	
A# 03-104209	1 LUNCH SHELTER	CONSTRUCTION	2002	Y/Y
A# 03-104210	RELOCATABLE CLASSROOM-P9	CONSTRUCTION	2002	Y/Y
A# 03-105693	9 CLASSROOM BUILDINGS	ALTERATION	2002	Y/Y
A# 03-105321	3 SHADE STRUCTURES	CONSTRUCTION	2002	Y/Y
A# 03-106140	RELOCATABLE CLASSROOMS	CONSTRUCTION	2002	Y/Y
A# 03-116693	HVAC UPGRADE AT GYM.	ALTERATION	2016	Y/Y
A# 03-118750	SITE IMPROVEMENT	CONSTRUCTION	2018	Y/Y
A# 03-119473	TRACK & FIELD, GYMNASIUM RR	ALTERATION	2019	N/A
A# 03-119731	GYMNASIUM, BLEACHERS	ALTERATION	2020	N/A
A# 03-120032	CONSTRUCTION OF MARQUEE SIGN	CONSTRUCTION	N/A	N/A
A# 03-120809	REPLACE WALKIN FRIDGE	CONSTRUCTION	N/A	N/A



Above is in compliance with Article 2022, Sub Chapter 8 Title 5 Calif. Admin. Code.

DATE DECEMBER 31, 2020  
 SHEET 1 OF 18 SHEETS  
 BY: ARCHITECTS MSP

**MSP**  
**ARCHITECTS**  
 McDonald, Soutar & Paz, Inc.  
 3575 Long Beach Blvd.  
 Long Beach, California 90807  
 562/427-5007 Fax 562/427-3007

**DIAGRAM OF BUILDING AREAS**

- EXISTING (1-A)
- BASIC PLANS (2-A)
- FINAL PLANS (3-A)

SCHOOL DISTRICT: **AZUSA USD** PROJECT NO.: **19-1190**

SCHOOL: **CENTER MS** ADDRESS: **5500 N.CERRITOS AVENUE, AZUSA**

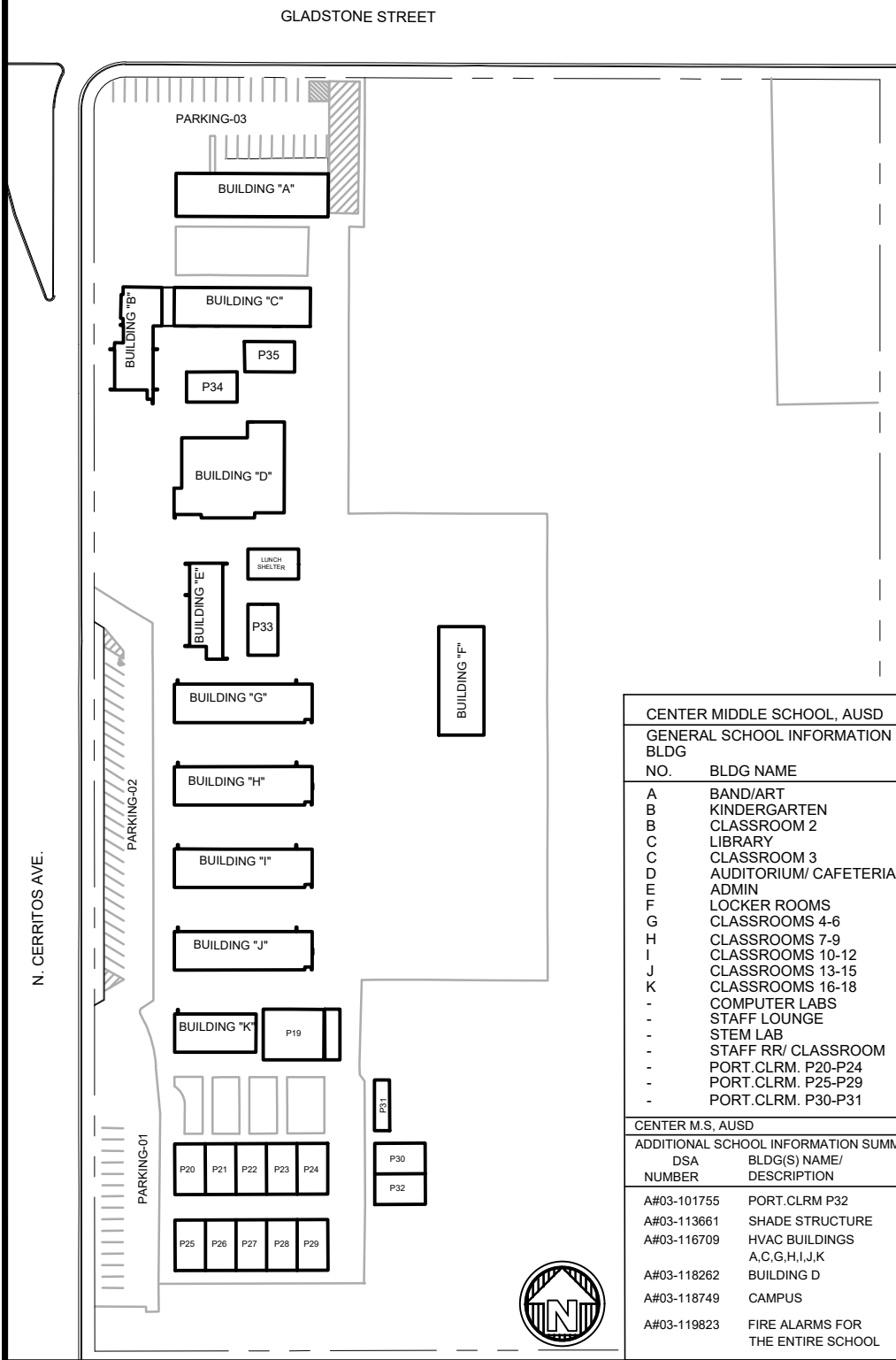

CENTER MIDDLE SCHOOL, AUSD					
GENERAL SCHOOL INFORMATION SUMMARY					
BLDG NO.	BLDG NAME	BLDG AREA TOTAL (SF)	DSA NUMBER	DATE / YR BUILT	CLSD / CERT.
A	BAND/ART	4,076 SF	A# 23175	N/A	N/A
B	KINDERGARTEN	1,272 SF	A# 5730	N/A	N/A
B	CLASSROOM 2	1,154 SF	A# 12311	N/A	N/A
C	LIBRARY	1,719 SF	A# 5730	N/A	N/A
C	CLASSROOM 3	1,719 SF	A# 7925	N/A	N/A
D	AUDITORIUM/ CAFETERIA	5,463 SF	A# 12311	N/A	N/A
E	ADMIN	1,845 SF	A# 12311	N/A	N/A
F	LOCKER ROOMS	3,067 SF	A# 12311	N/A	N/A
G	CLASSROOMS 4-6	3,286 SF	A# 12311	N/A	N/A
H	CLASSROOMS 7-9	3,286 SF	A# 12311	N/A	N/A
I	CLASSROOMS 10-12	3,286 SF	A# 12311	N/A	N/A
J	CLASSROOMS 13-15	3,286 SF	A# 12311	N/A	N/A
K	CLASSROOMS 16-18	1,933 SF	A# 12311	N/A	N/A
-	COMPUTER LABS	1,896 SF	A# 52331	N/A	N/A
-	STAFF LOUNGE	949 SF	A# 12311	N/A	N/A
-	STEM LAB	2,415 SF	A# 54613	N/A	N/A
-	STAFF RR/ CLASSROOM	1,477 SF	A# 54613	N/A	N/A
-	PORT. CLRM. P20-P24	9,671 SF	A# 56110	1991	N/A
-	PORT. CLRM. P25-P29	9,671 SF	A# 57744	1992	N/A
-	PORT. CLRM. P30-P31	1,395 SF	A# 61936	1994	N/A

CENTER M.S., AUSD				
ADDITIONAL SCHOOL INFORMATION SUMMARY				
DSA NUMBER	BLDG(S) NAME/ DESCRIPTION		DATE / YR BUILT	CLSD/ CERT.
A#03-101755	PORT. CLRM P32	CONSTRUCTION	1999	Y/Y
A#03-113661	SHADE STRUCTURE	CONST. 1 SHADE STRUCT.	2010	Y/Y
A#03-116709	HVAC BUILDINGS A,C,G,H,I,J,K	ALTERATIONS	2016	Y/Y
A#03-118262	BUILDING D	ALTERATIONS	2017	Y/Y
A#03-118749	CAMPUS	SITE IMPROVEMENT	2018	Y/Y
A#03-119823	FIRE ALARMS FOR THE ENTIRE SCHOOL	ALTERATIONS	2019	N/A

Above is in compliance with Article 2022, Sub Chapter 8 Title 5 Calif. Admin. Code.

DATE DECEMBER 31, 2020  
 SHEET 2 OF 18 SHEETS  
 BY: ARCHITECTS MSP

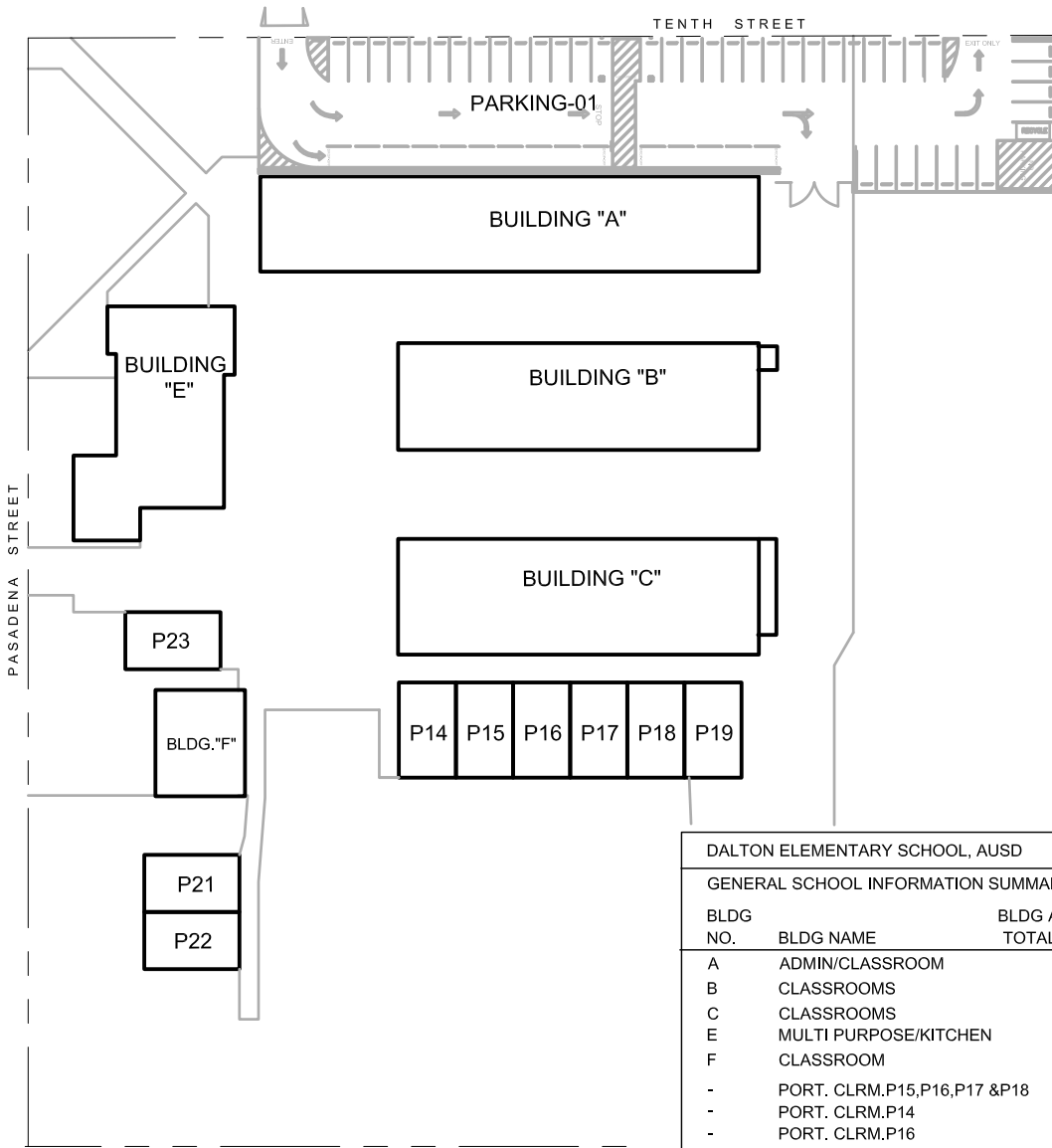

**DIAGRAM OF BUILDING AREAS**

- EXISTING (1-A)
- BASIC PLANS (2-A)
- FINAL PLANS (3-A)

SCHOOL DISTRICT: **AZUSA USD** PROJECT NO.: **19-1190**

SCHOOL: **DALTON ES** ADDRESS: **500 E. 10TH STREET, AZUSA**



DALTON ELEMENTARY SCHOOL, AUSD						
GENERAL SCHOOL INFORMATION SUMMARY						
BLDG NO.	BLDG NAME	BLDG AREA TOTAL (SF)	DSA NUMBER	DATE / YR BUILT	CLSD/ CERT.	
A	ADMIN/CLASSROOM	6,300	A#9715	1952	N/A	
B	CLASSROOMS	4,530	A#9715	1952	N/A	
C	CLASSROOMS	4,530	A#14424	1989	N/A	
E	MULTI PURPOSE/KITCHEN	4,030	A#9715	1952	N/A	
F	CLASSROOM	1,559	A#10888	1989	N/A	
-	PORT. CLRM.P15,P16,P17 &P18	3,840	A#60632	1993	N/A	
-	PORT. CLRM.P14	960	A#62689	1994	N/A	
-	PORT. CLRM.P16	960	A#65234	1996	N/A	
-	PORT. CLRM.P17 &P18	1,920	A#67698	1997	N/A	
-	PORT. CLRM.P19 &P23	1,920	A#03-100771	1998	Y/Y	
-	PORT. CLRM.P21 &P22	1,920	A#03-104444	1998	Y/Y	
-	PORT. CLRM.	960	A#03-101463	2008	Y/Y	
DALTON ELEMENTARY SCHOOL, AUSD						
GENERAL SCHOOL INFORMATION SUMMARY						
DSA NUMBER	BLDG(S) NAME/ DESCRIPTION		DATE / YR BUILT	CLSD/ CERT.		
A#03-117758	BLDG. (A, B, C, E, AND F)	ALTERATION OF (5) BUILDINGS RESTROOMS	2017	Y/Y		
A#03-118729	BLDG. A	CONST. OF 1 ENTRY GATE	2018	Y/Y		
A#03-119822	THE ENTIRE CAMPUS	ALTERATION TO 1 FIRE ALARM UPGRADE FOR THE ENTIRE CAMPUS	2019	Y/Y		
A#03-110394	NO DSA INFO	NO DSA INFO	-	-		
A#03-110819	NO DSA INFO	NO DSA INFO	-	-		
A#03-120718	THE ENTIRE CAMPUS	ALTERATION	2020	N/N		



Above is in compliance with Article 2022, Sub Chapter 8 Title 5 Calif. Admin. Code.

DATE DECEMBER 31, 2020  
 SHEET 3 OF 18 SHEETS  
 BY: ARCHITECTS MSP

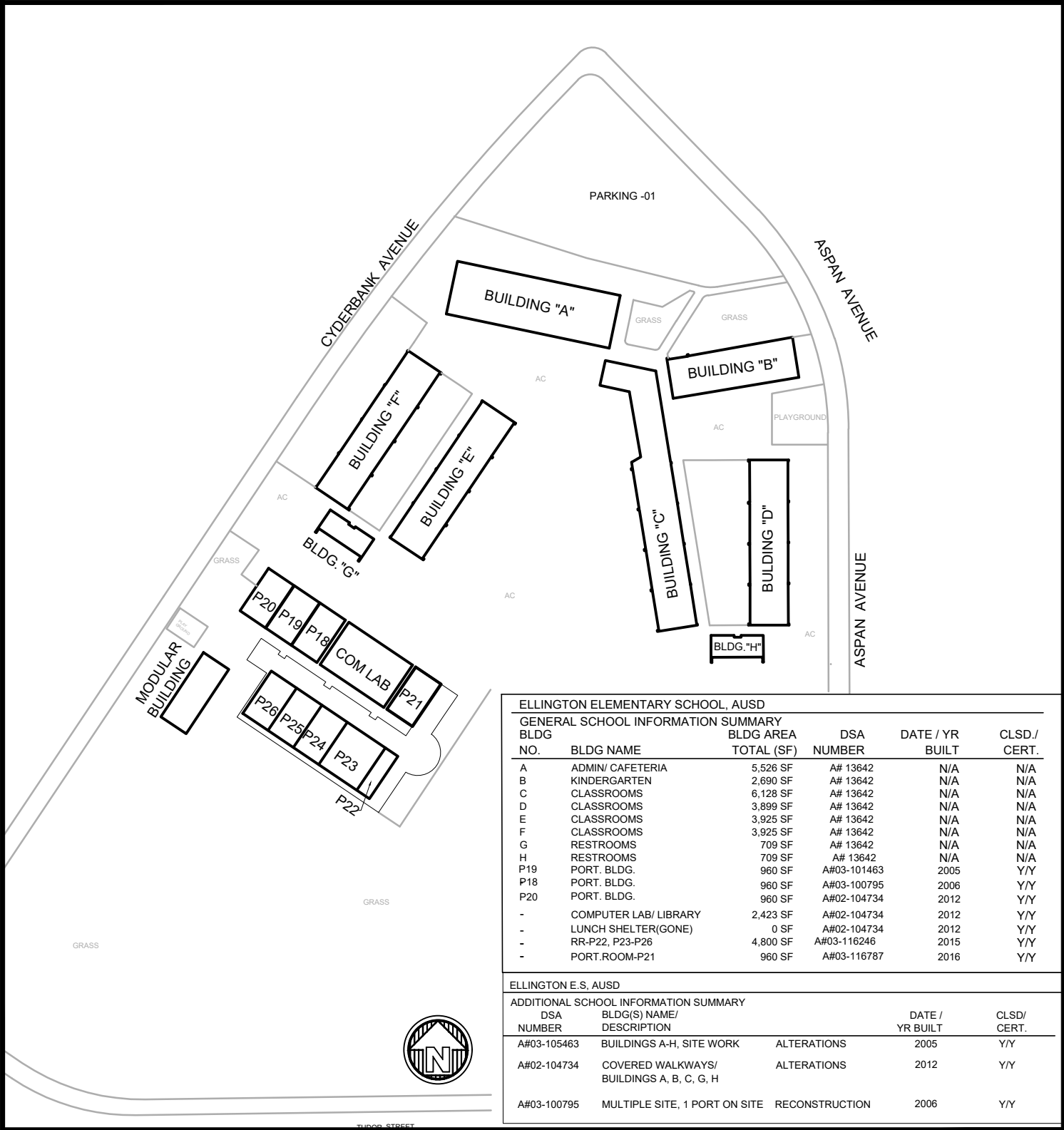

**DIAGRAM OF BUILDING AREAS**

- EXISTING (1-A)
- BASIC PLANS (2-A)
- FINAL PLANS (3-A)

SCHOOL DISTRICT: **AZUSA USD** PROJECT NO.: **19-1190**

SCHOOL: **ELLINGTON K-8** ADDRESS: **5034 N. CLYDEBANK AVENUE, COVINA**



**ELLINGTON ELEMENTARY SCHOOL, AUSD**

GENERAL SCHOOL INFORMATION SUMMARY

BLDG NO.	BLDG NAME	BLDG AREA TOTAL (SF)	DSA NUMBER	DATE / YR BUILT	CLSD / CERT.
A	ADMIN/ CAFETERIA	5,526 SF	A# 13642	N/A	N/A
B	KINDERGARTEN	2,690 SF	A# 13642	N/A	N/A
C	CLASSROOMS	6,128 SF	A# 13642	N/A	N/A
D	CLASSROOMS	3,899 SF	A# 13642	N/A	N/A
E	CLASSROOMS	3,925 SF	A# 13642	N/A	N/A
F	CLASSROOMS	3,925 SF	A# 13642	N/A	N/A
G	RESTROOMS	709 SF	A# 13642	N/A	N/A
H	RESTROOMS	709 SF	A# 13642	N/A	N/A
P19	PORT. BLDG.	960 SF	A#03-101463	2005	Y/Y
P18	PORT. BLDG.	960 SF	A#03-100795	2006	Y/Y
P20	PORT. BLDG.	960 SF	A#02-104734	2012	Y/Y
-	COMPUTER LAB/ LIBRARY	2,423 SF	A#02-104734	2012	Y/Y
-	LUNCH SHELTER(GONE)	0 SF	A#02-104734	2012	Y/Y
-	RR-P22, P23-P26	4,800 SF	A#03-116246	2015	Y/Y
-	PORT.ROOM-P21	960 SF	A#03-116787	2016	Y/Y

ELLINGTON E.S, AUSD

ADDITIONAL SCHOOL INFORMATION SUMMARY

DSA NUMBER	BLDG(S) NAME/ DESCRIPTION	ALTERATIONS	DATE / YR BUILT	CLSD/ CERT.
A#03-105463	BUILDINGS A-H, SITE WORK	ALTERATIONS	2005	Y/Y
A#02-104734	COVERED WALKWAYS/ BUILDINGS A, B, C, G, H	ALTERATIONS	2012	Y/Y
A#03-100795	MULTIPLE SITE, 1 PORT ON SITE	RECONSTRUCTION	2006	Y/Y



Above is in compliance with Article 2022, Sub Chapter 8 Title 5 Calif. Admin. Code.

DATE DECEMBER 31, 2020  
 SHEET 5 OF 18 SHEETS  
 BY: ARCHITECTS MSP

**MSP**  
**ARCHITECTS**  
 McDonald, Soutar & Paz, Inc.  
 3575 Long Beach Blvd.  
 Long Beach, California 90807  
 562/427-5007 Fax 562/427-3007

**DIAGRAM OF BUILDING AREAS**

- EXISTING (1-A)
- BASIC PLANS (2-A)
- FINAL PLANS (3-A)

SCHOOL DISTRICT: **AZUSA USD** PROJECT NO.: **19-1190**

SCHOOL: **FOOTHILL MS** ADDRESS: **151 N. FENIMORE AVENUE, AZUSA**

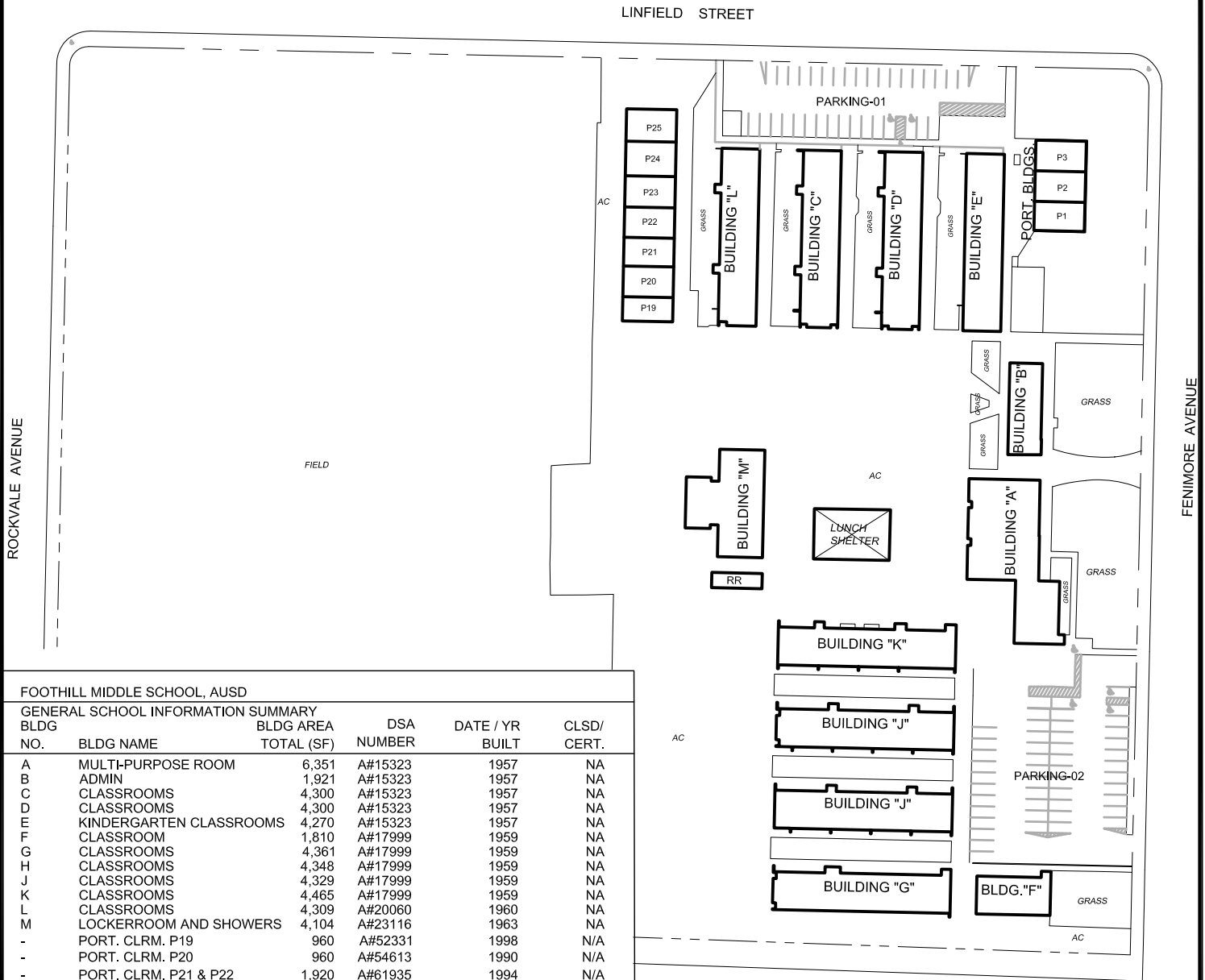

**FOOTHILL MIDDLE SCHOOL, AUSD**

GENERAL SCHOOL INFORMATION SUMMARY

BLDG NO.	BLDG NAME	BLDG AREA TOTAL (SF)	DSA NUMBER	DATE / YR BUILT	CLSD/ CERT.
A	MULTI-PURPOSE ROOM	6,351	A#15323	1957	NA
B	ADMIN	1,921	A#15323	1957	NA
C	CLASSROOMS	4,300	A#15323	1957	NA
D	CLASSROOMS	4,300	A#15323	1957	NA
E	KINDERGARTEN CLASSROOMS	4,270	A#15323	1957	NA
F	CLASSROOM	1,810	A#17999	1959	NA
G	CLASSROOMS	4,361	A#17999	1959	NA
H	CLASSROOMS	4,348	A#17999	1959	NA
J	CLASSROOMS	4,329	A#17999	1959	NA
K	CLASSROOMS	4,465	A#17999	1959	NA
L	CLASSROOMS	4,309	A#20060	1960	NA
M	LOCKERROOM AND SHOWERS	4,104	A#23116	1963	NA
-	PORT. CLRM. P19	960	A#52331	1998	N/A
-	PORT. CLRM. P20	960	A#54613	1990	N/A
-	PORT. CLRM. P21 & P22	1,920	A#61935	1994	N/A
-	PORT. CLRM. P23 & P24	1,920	A#63760	1995	N/A
-	PORT. CLRM. P25	960	A#65210	1996	N/A

GENERAL SCHOOL INFORMATION SUMMARY

DSA NUMBER	BLDG(S) NAME/ DESCRIPTION	DATE / YR BUILT	CLSD/ CERT.
A#17999	BLDG. A ADDITION	1959	NA
A#50232	THE ENTIRE CAMPUS AIR CONDITIONING	1988	Y/Y
A#51727	THE ENTIRE CAMPUS SMOKE DETECTIVE	1989	Y/Y
A#107528	PORTABLES RELOCATION	2004	NA
A#108789	PORTABLE RECONSTRUCTION	2005	Y/Y
A#107369	PORT. BLDG.P1-P3 CONSTRUCTION	2004	Y/Y
A#105683	BLDG (L, C, D, E) RECONSTRUCTION	2002	Y/Y
A#120000	THE ENTIRE CAMPUS SITE IMPROVEMENT AND FENCE	2019	NA

Above is in compliance with Article 2022, Sub Chapter 8 Title 5 Calif. Admin. Code.

DATE DECEMBER 31, 2020  
 SHEET 6 OF 18 SHEETS  
 BY: ARCHITECTS MSP

**MSP ARCHITECTS**  
 McDonald, Soutar & Paz, Inc.  
 3575 Long Beach Blvd.  
 Long Beach, California 90807  
 562/427-5007 Fax 562/427-3007

**DIAGRAM OF BUILDING AREAS**

- EXISTING (1-A)
- BASIC PLANS (2-A)
- FINAL PLANS (3-A)

SCHOOL DISTRICT: AZUSA USD PROJECT NO.: 19-1190

SCHOOL: GLADSTONE HS ADDRESS: 1340 N. ENID AVENUE, COVINA

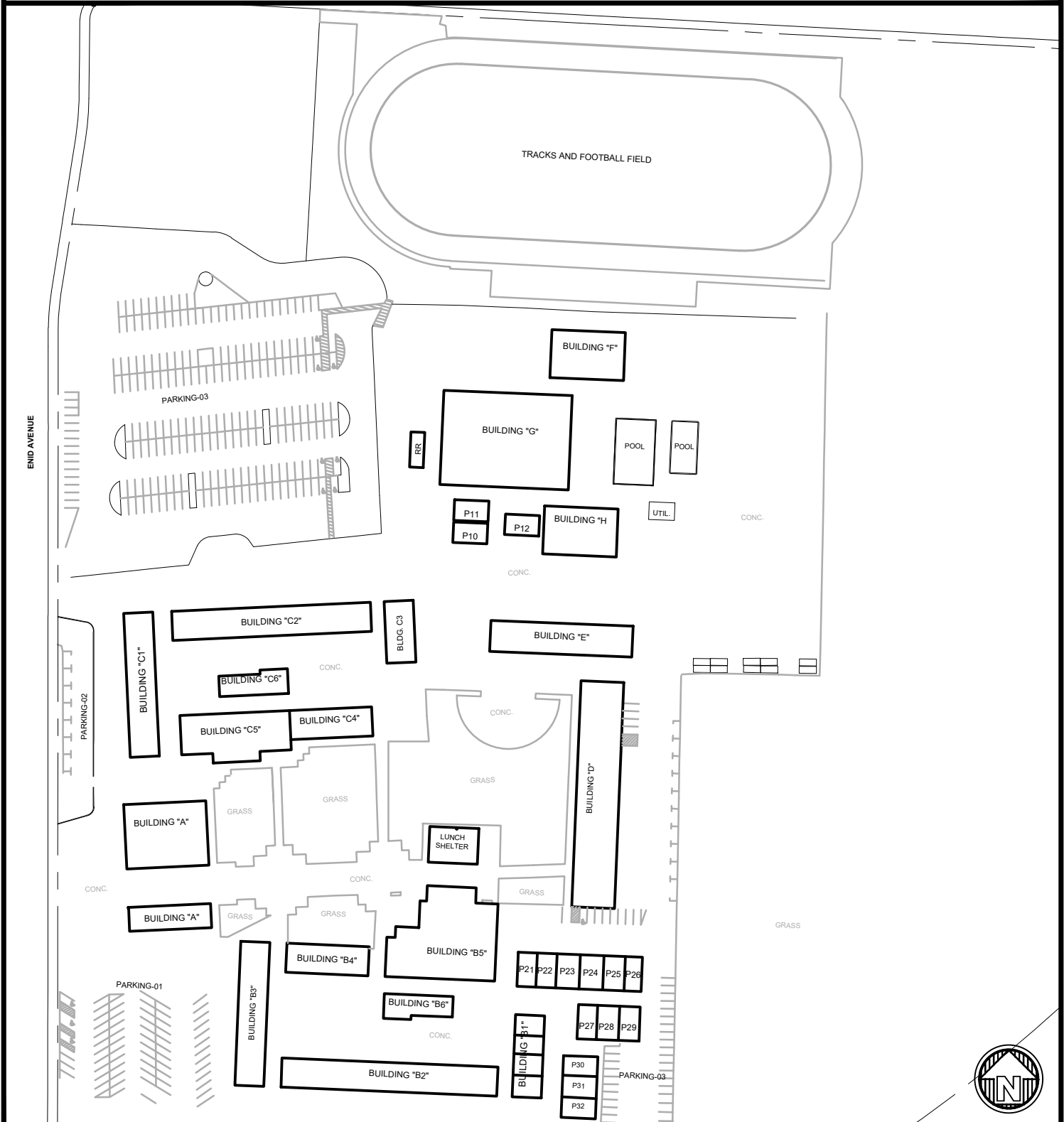

Above is in compliance with Article 222, Sub Chapter 8 Title 5 Calif. Admin. Code.

DATE DECEMBER 31, 2020  
 SHEET 7A OF 18 SHEETS  
 BY: ARCHITECTS MSP

**MSP**  
**ARCHITECTS**  
 McDonald, Soutar & Paz, Inc.  
 3575 Long Beach Blvd.  
 Long Beach, California 90807  
 562/427-5007 Fax 562/427-3007



**DIAGRAM OF BUILDING AREAS**

- EXISTING (1-A)
- BASIC PLANS (2-A)
- FINAL PLANS (3-A)

SCHOOL DISTRICT: AZUSA USD PROJECT NO.: 19-1190

SCHOOL: GLADSTONE HS ADDRESS: 1340 N. ENID AVENUE, COVINA

GENERAL SCHOOL INFORMATION SUMMARY					
BLDG NO.	BLDG NAME	BLDG AREA TOTAL (SF)	DSA NUMBER	DATE / YR BUILT	CLSD/ CERT.
A	ADMIN	7,187	A#22588	1962	N/A
B1	CLASSROOM	3,259	A#22588	1962	N/A
B2	CLASSROOM	8,573	A#22588	1962	N/A
B3	CLASSROOM	5,678	A#22588	1962	N/A
B4	CLASSROOM	3,261	A#22588	1962	N/A
B5	CLASSROOM	10,238	A#22588	1962	N/A
B6	CLASSROOM	2,086	A#22588	1962	N/A
C1	CLASSROOM	5,709	A#22588	1962	N/A
C2	CLASSROOM	7,888	A#22588	1962	N/A
C3	CLASSROOM	2,446	A#22588	1962	N/A
C4/C5	CLASSROOM	9,745	A#22588	1962	N/A
D	CLASSROOM	13,178	A#22588	1962	N/A
E	CLASSROOM	5,987	A#22588	1962	N/A
F	GIRLS SHOWER	4,807	A#22588	1962	N/A
G	GYMNASIUM	16,470	A#22588	1962	N/A
H	BOYS SHOWER	4,812	A#22588	1962	N/A
	SWIMMING POOL		A#25834	1965	N/A
C2	FIRE DAMAGE RECONSTRUCTION	7,888	A#40576	1977	N/A
P21	PORT.CLASSROOM	960	A#63760	1995	N/A
P22-P23	PORT.CLASSROOM	1,920	A#103895	2000	Y/Y
P24-P26	PORT.CLASSROOM	2,880	A#105204	2008	Y/Y

GLADSTONE HIGH SCHOOL, AUSD

GENERAL SCHOOL INFORMATION SUMMARY				
DSA NUMBER	BLDG(S) NAME/ DESCRIPTION		DATE / YR BUILT	CLSD/ CERT.
A#03-104209	SITE	Const. 1 LUNCH SHELTER	2002	Y/Y
A#03-105779	SITE	Const. 1 RELOCATABLE BUILDING	2002	Y/Y
A#03-105630	BLDG. B1,B2,B3,4 C1,C2,C3,C4,C5 BLDG D AND BLDG E- (PHASE I)	Additions to 1-C.R.BLDG(B2); Alterations to 1-7-C.R.BLDGS (B1,B2,B3,B4, C1,C3,C5), 1-SHOP BLDG (D), 1-ADMIN BLDG(A), 2-LOCKER/SHOWER BLDGS (F & H),1-GYM. BLDG(G)(#22588), 1-SCIENCE BLDG(C2)(#40576), 1-ART BLDG(C4), 1-MUSIC BLDG(E), 1-M.P. BLDG(B5)(#50232), 2-TOILET BLDGS (B6,C6)(#22588	2002	Y/Y
A#03-106407	BLDG.A BLDG.B5,B6 BLDG.G,F, AND H (PHASE II)	Alterations to - ACTIVITIES CENTER	2003	Y/Y
A#03-118170	SITE	Const. 1 NEW STEEL FENCING	2019	Y/Y
A#03-119474	SITE	TRACK AND FIELD AND GYM. RR	2019	
A#03-119727	BLDG G	GYMNASIUM BUIDING-BLEACHER REPLACEMENT	2019	
A#03-119624	BLDG. G (RESTROOM)	Alterations to 1- TRACK AND FIELD	2019	-
A#03-120033	SITE	Const. of MARQUEE SIGN	2019	Y/Y

Above is in compliance with Article 2022, Sub Chapter 8 Title 5 Calif. Admin. Code.

DATE DECEMBER 31, 2020  
 SHEET 7B OF 18 SHEETS  
 BY: ARCHITECTS MSP



**DIAGRAM OF BUILDING AREAS**

- EXISTING (1-A)
- BASIC PLANS (2-A)
- FINAL PLANS (3-A)

SCHOOL DISTRICT: **AZUSA USD** PROJECT NO.: **19-1190**

SCHOOL: **HODGE ES** ADDRESS: **700 W. 11TH STREET, AZUSA**

**HODGE ELEMENTARY SCHOOL, AUSD**

**GENERAL SCHOOL INFORMATION SUMMARY**

BLDG NO.	BLDG NAME	BLDG AREA TOTAL (SF)	DSA NUMBER	DATE / YR BUILT	CLSD./ CERT.
A	CLASSROOMS	8,796 SF	A# 24610	N/A	N/A
B	CLASSROOMS	8,796 SF	A# 24610	N/A	N/A
C	CLASSROOMS	8,796 SF	A# 24610	N/A	N/A
D	KINDERGARTEN	4,567 SF	A# 24610	N/A	N/A
-	MULTI-PURPOSE ROOM	9,027 SF	A# 24610	N/A	N/A
-	LUNCH SHELTER	3,416 SF	A#02-104814	2003	Y/Y
-	LIBRARY/ COMP.LAB/ CR	9,472 SF	A#02-104814	2003	Y/Y
PORT	CLRM. P19-P21	5,622 SF	A#03-100795	1998	Y/Y
PORT	CLASSROOM P27	917 SF	A# 65211	1996	Y/Y
PORT	CONST.BALL WALL		A# 66249	N/A	Y/Y
PORT	PDS ROOM	2,182 SF	A# 67754	1997	Y/Y

**HODGE E.S. AUSD**

**ADDITIONAL SCHOOL INFORMATION SUMMARY**

DSA NUMBER	BLDG(S) NAME/ DESCRIPTION		DATE / YR BUILT	CLSD/ CERT.
A#03- 102398	PORTABLE-CBET	CONST 1 PORTABLE	2000	Y/Y
A#03- 105460	UNITS (A,B,C)	ALTERATIONS	2002	Y/Y
A#02- 104814	UNITS (A,B,C), MULTI-PURPOSE, MULTI MEDIA PORTABLES.	ALTERATIONS	2001	Y/Y
A#03- 106279	PORTABLE BLDG.	CONST 1 PORTABLE	2003	Y/Y

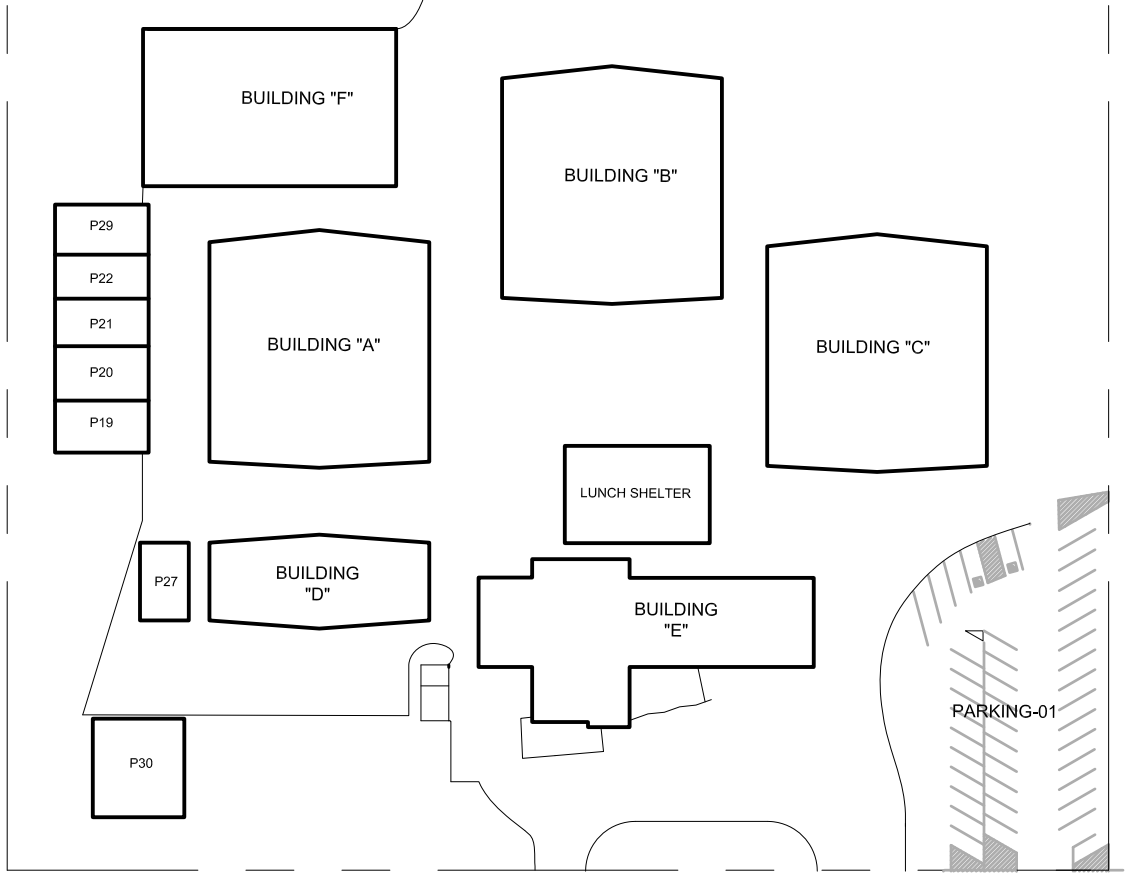

W. 11TH ST



Above is in compliance with Article 2022, Sub Chapter 8 Title 5 Calif. Admin. Code.

DATE DECEMBER 31, 2020  
 SHEET 8 OF 18 SHEETS  
 BY: ARCHITECTS MSP

**MSP**  
**ARCHITECTS**  
 McDonald, Soutar & Paz, Inc.  
 3575 Long Beach Blvd.  
 Long Beach, California 90807  
 562/427-5007 Fax 562/427-3007

**DIAGRAM OF BUILDING AREAS**

- EXISTING (1-A)
- BASIC PLANS (2-A)
- FINAL PLANS (3-A)

SCHOOL DISTRICT: **AZUSA USD** PROJECT NO.: **19-1190**

SCHOOL: **LEE ES** ADDRESS: **550 N. CERRITOS AVENUE, AZUSA**



CHARLES LEE ELEMENTARY SCHOOL, AUSD

GENERAL SCHOOL INFORMATION SUMMARY

BLDG NO.	BLDG NAME	BLDG AREA TOTAL (SF)	DSA NUMBER	DATE / YR BUILT	CLSD / CERT.
A	ADMIN/ LIBRARY	5,440 SF	A# 10317	1953	N/A
B	CAFETERIA	5,143 SF	A# 10317	1953	N/A
C	CLASSROOMS	4,431 SF	A# 10317	1953	N/A
D	CLASSROOMS	4,431 SF	A# 10317	1953	N/A
E	CLASSROOMS	4,435 SF	A# 10317	1953	N/A
F	CLASSROOMS	4,431 SF	A# 10317	1953	N/A
P17-P20	PORT. CLRM.	4,282 SF	A# 20003	1960	N/A
	PORT. CLRM.	956 SF	A# 10921	1953	N/A
P22-P24	PORT. CLRM.	3,840 SF	A#01-67755	1997	N/A
P21	PORT. CLRM.	950 SF	A# 80059	1997	N/A
P25	PORT. CLRM.	950 SF	A#01-100771	1997	N/A
	PORT. CLRM.	950 SF	A#03-101463	2008	Y/Y

CHARLES LEE E.S. AUSD

ADDITIONAL SCHOOL INFORMATION SUMMARY

DSA NUMBER	BLDG(S) NAME/ DESCRIPTION		DATE / YR BUILT	CLSD/ CERT.
A#01- 51125	BUILDINGS A-F	RECONSTRUCTION	1988	N/A
A#03 118035	BUILDINGS A-F	ALTERATIONS	2018	Y/Y
A#03 120002	CAMPUS	DOUBLE GATE	2019	N/A

Above is in compliance with Article 2022, Sub Chapter 8 Title 5 Calif. Admin. Code.

DATE DECEMBER 31, 2020  
 SHEET 9 OF 18 SHEETS  
 BY: ARCHITECTS MSP



**DIAGRAM OF BUILDING AREAS**

- EXISTING (1-A)
- BASIC PLANS (2-A)
- FINAL PLANS (3-A)

SCHOOL DISTRICT: **AZUSA USD** PROJECT NO.: **19-1190**

SCHOOL: **LONGFELLOW PK/K** ADDRESS: **245 W. 10TH STREET, AZUSA**

**LONGFELLOW ELEMENTARY SCHOOL, AUSD**

**GENERAL SCHOOL INFORMATION SUMMARY**

BLDG NO.	BLDG NAME	BLDG AREA TOTAL (SF)	DSA NUMBER	DATE / YR BUILT	CLSD / CERT.
-	PARENT VOLUNTEER	480 SF	A#3-100771	1998	Y/Y
-	LUNCH SHELTER	2,408 SF	A# 50796	1988	N/A
-	MULTI-PURPOSE / ADMIN	7,387 SF	A# 14423	1956	N/A
-	CLASSROOM/ RESTROOMS	2,240 SF	A#03-100795	1998	Y/Y
-	RELOCATED CLASSROOM	960 SF	A# 47854	1986	N/A
-	RELOCATED CLASSROOM	2,880 SF	A# 29794	N/A	N/A
-	CLASSROOMS /RESTROOM	16,000 SF	A#03-106110	2002	Y/Y

**LONGFELLOW E.S, AUSD**

**ADDITIONAL SCHOOL INFORMATION SUMMARY**

DSA NUMBER	BLDG(S) NAME/ DESCRIPTION		DATE / YR BUILT	CLSD/ CERT.
A#03-101105	PORT. CLRM(PARENT VOLUNTEER)-P10	CONSTRUCTION	2008	Y/Y
A#03-105747	MULTI-PURPOSE, ADMIN	ALTERATIONS	2002	Y/Y
A#03-106110	OLD CLASSROOMS REMOVED AND MOVED TO GLADSTONE HS/ HODGE ES	ALTERATIONS	2002	Y/Y

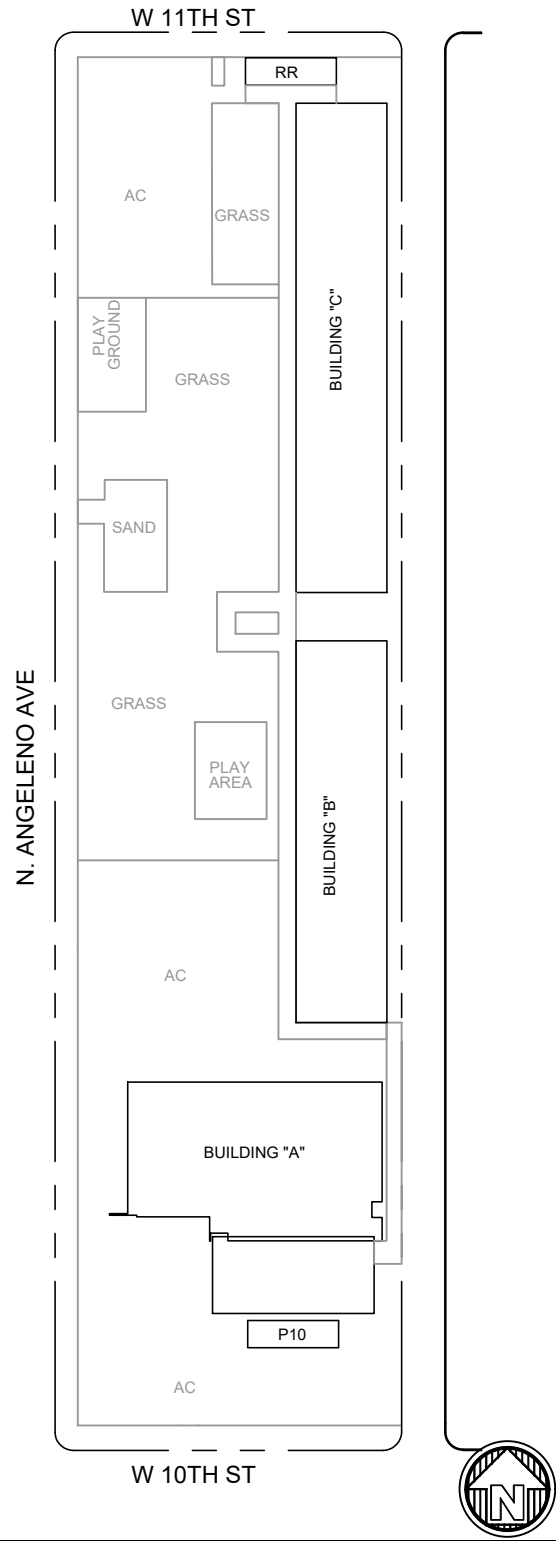

Above is in compliance with Article 2022, Sub Chapter 8 Title 5 Calif. Admin. Code.

DATE DECEMBER 31, 2020  
 SHEET 10 OF 18 SHEETS  
 BY: ARCHITECTS MSP

**MSP**  
**ARCHITECTS**  
 McDonald, Soutar & Paz, Inc.  
 3575 Long Beach Blvd.  
 Long Beach, California 90807  
 562/427-5007 Fax 562/427-3007



**DIAGRAM OF BUILDING AREAS**

- EXISTING (1-A)
- BASIC PLANS (2-A)
- FINAL PLANS (3-A)

SCHOOL DISTRICT: **AZUSA USD** PROJECT NO.: **19-1190**

SCHOOL: **MAGNOLIA ES** ADDRESS: **945 E. NEARFIELD STREET, AZUSA**

**MAGNOLIA ELEMENTARY SCHOOL, AUSD**

**GENERAL SCHOOL INFORMATION SUMMARY**

BLDG NO.	BLDG NAME	BLDG AREA TOTAL (SF)	DSA NUMBER	DATE / YR BUILT	CLSD / CERT.
A	OFFICE BUILDING	2,083 SF	A# 14867	N/A	N/A
B	CAFETERIA	5,468 SF	A# 14867	N/A	N/A
C	CLASSROOMS 1-2	2,763 SF	A# 14867	N/A	N/A
D	CLASSROOMS 3-6	4,483 SF	A# 14867	N/A	N/A
E	CLASSROOMS 7-10	4,483 SF	A# 14867	N/A	N/A
F	CLASSROOMS 11-13	4,483 SF	A# 14867	N/A	N/A
G	STAFF / CLASSROOM 15-16	4,499 SF	A# 14867	N/A	N/A
H	CLASSROOMS 17-20	4,483 SF	A# 14867	N/A	N/A
-	CLASSROOMS P21-P26	2,949 SF	A#03-103903	2002	Y/Y
-	RESTROOMS	476 SF	A#03-103903	2002	Y/Y
-	MEDIA CENTER	2,407 SF	A#03-103903	2002	Y/Y

**MAGNOLIA E.S., AUSD**

**ADDITIONAL SCHOOL INFORMATION SUMMARY**

DSA NUMBER	BLDG(S) NAME/ DESCRIPTION		DATE / YR BUILT	CLSD / CERT.
A# 51727	BUILDINGS A-H	ALTERATIONS	1989	Y/Y
A# 67754	DAYCARE	MODULAR BUILDING	1997	N/A
A#03-105383	BUILDINGS D,E,F,G,H	MODERNIZATION	2002	Y/Y
A#03-107798	BUILDINGS A,B,C,E,G, LUNCH SHELTER & MODULES	ALTERATIONS	2005	Y/Y
A#03-120020	CLASSROOM, DOOR, ENTRANCE DRIVEWAY, PARKING LOT & CHAIN LINK ROLLING GATE	ALTERATIONS	2019	N/A

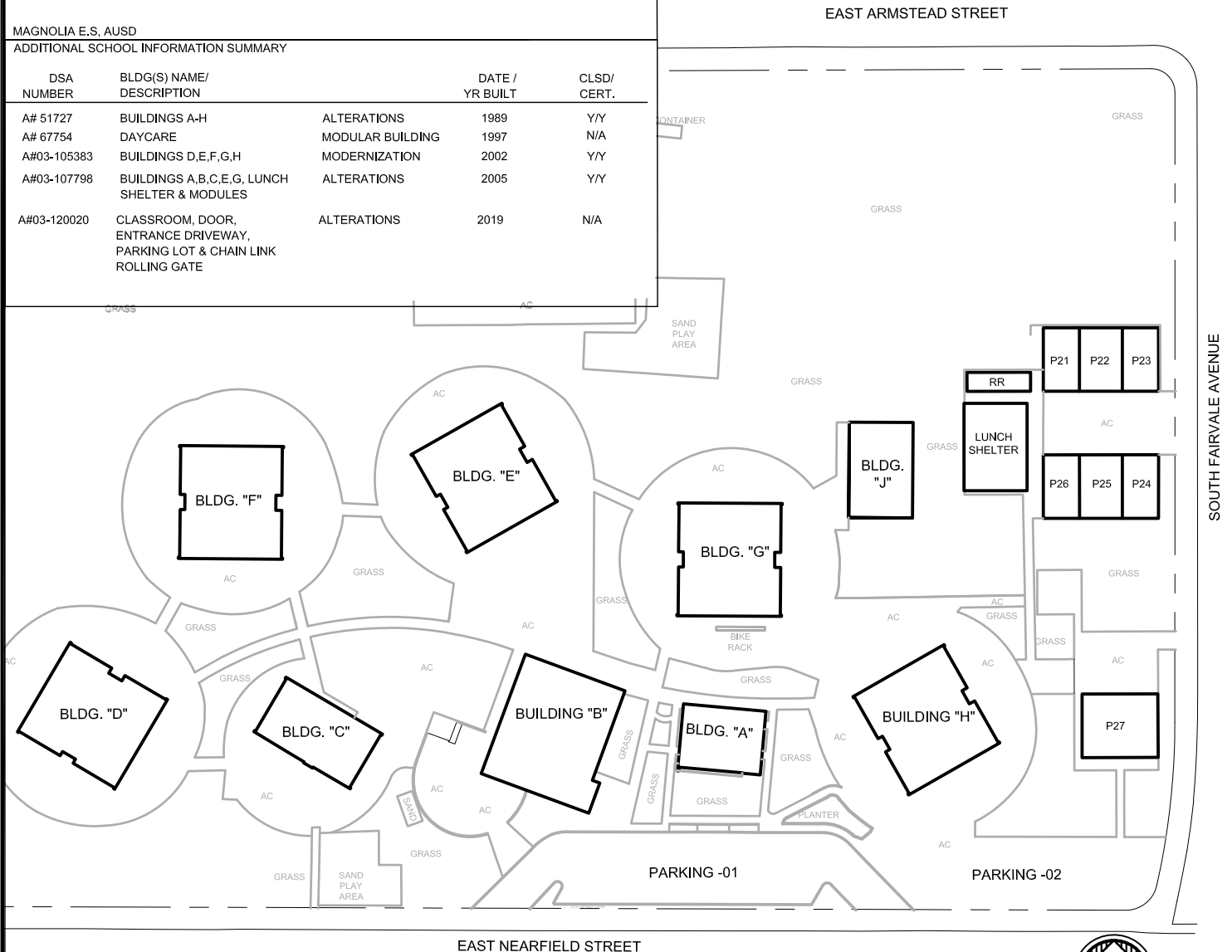

Above is in compliance with Article 2022, Sub Chapter 8 Title 5 Calif. Admin. Code.

DATE DECEMBER 31, 2020  
 SHEET 11 OF 18 SHEETS  
 BY: ARCHITECTS MSP

**MSP**  
**ARCHITECTS**  
 McDonald, Soutar & Paz, Inc.  
 3575 Long Beach Blvd.  
 Long Beach, California 90807  
 562/427-5007 Fax 562/427-3007

**DIAGRAM OF BUILDING AREAS**

- EXISTING (1-A)
- BASIC PLANS (2-A)
- FINAL PLANS (3-A)

SCHOOL DISTRICT: AZUSA USD PROJECT NO.: 19-1190

SCHOOL: MURRAY ES ADDRESS: 505 E. RENWICK ROAD, AZUSA

**MURRAY ELEMENTARY SCHOOL, AUSD**

**GENERAL SCHOOL INFORMATION SUMMARY**

BLDG NO.	BLDG NAME	BLDG AREA TOTAL (SF)	DSA NUMBER	DATE / YR BUILT	CLSD./ CERT.
A	ADMIN/ CAFETERIA	7,913 SF	A# 19116	1960	N/A
B	CLASSROOMS	6,480 SF	A# 19116	1960	N/A
C	CLASSROOMS	7,256 SF	A# 19116	1960	N/A
D	CLASSROOMS	4,454 SF	A# 19116	1960	N/A
E	CLASSROOMS	2,761 SF	A# 19116	1960	N/A
F	CLASSROOMS	4,454 SF	A# 19116	1960	N/A
-	CLASSROOMS #3	1,461 SF	A# 19116	1960	N/A
-	LIBRARY/COMPUTER LAB	2,393 SF	A# 19116	1960	N/A
-	LUNCH SHELTER	2,355 SF	A#03-107799	N/A	Y/Y
-	PORTABLE #17	959 SF	A#03-105204	N/A	N/A
-	PORTABLE #16	882 SF	A#03-102398	N/A	N/A
-	PORTABLE #15	822 SF	A#03-101463	N/A	N/A
-	PORTABLES P13,P14	1,933 SF	A# 65234	N/A	N/A
-	PORTABLES P11,P12	1,933 SF	A# 63760	N/A	N/A
-	PORTABLES P19,P22,P23	2,880 SF	A#03-102398	N/A	N/A
-	PORTABLES P24,P25,P26 &P27	3,950 SF	A#03-100771	N/A	N/A
-	PORTABLES LUNCH SHELTER	950 SF	A# 61935	N/A	N/A
-		2,400 SF	A#03-103895	N/A	N/A

**MURRAY E.S., AUSD**

**ADDITIONAL SCHOOL INFORMATION SUMMARY**

DSA NUMBER	BLDG(S) NAME/ DESCRIPTION	ALTERATIONS	DATE / YR BUILT	CLSD/ CERT.
A# 51727	BUILDINGS A-F	ALTERATIONS	1989	N/A
A#03-101447	RELOCATABLES	CONSTRUCTION	1998	Y/Y
A#03-107799	BUILDINGS A-F	ALTERATIONS	N/A	Y/Y
A#03-105462	BUILDINGS B-F	MODERNIZATION	2002	Y/Y
A#03-106482	BUILDINGS A,E & KINDERGARTEN, RESTROOMS IN C,D,F	MODERNIZATION	2003	Y/Y
A#03-108784	BUILDINGS A-F	RECONSTRUCTION	2005	Y/Y
A#03-118150	SCHOOL FRONT	ENTRY FENCING UPGRD.	2017	Y/Y

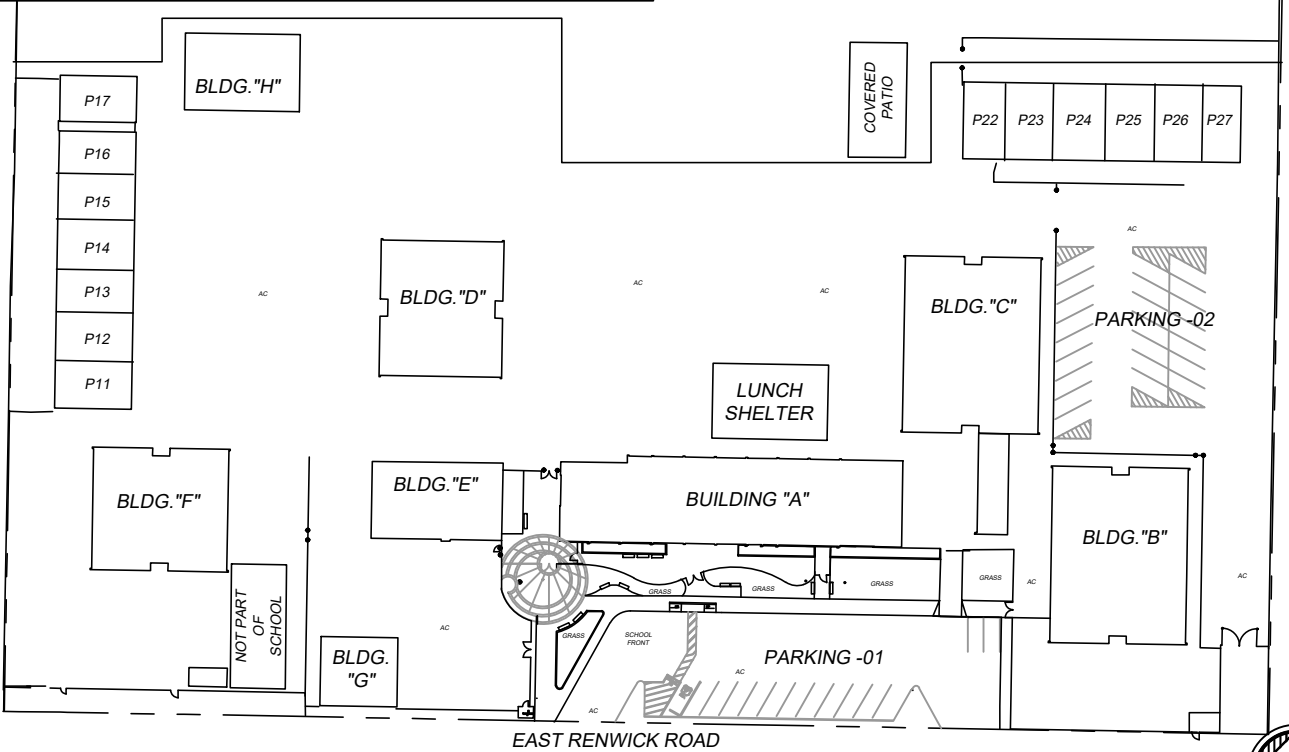

Above is in compliance with Article 2022, Sub Chapter 8 Title 5 Calif. Admin. Code.

DATE DECEMBER 31, 2020  
 SHEET 13 OF 18 SHEETS  
 BY: ARCHITECTS MSP

**MSP**  
**ARCHITECTS**  
 McDonald, Soutar & Paz, Inc.  
 3575 Long Beach Blvd.  
 Long Beach, California 90807  
 562/427-5007 Fax 562/427-3007

**DIAGRAM OF BUILDING AREAS**

- EXISTING (1-A)
- BASIC PLANS (2-A)
- FINAL PLANS (3-A)

SCHOOL DISTRICT: **AZUSA USD** PROJECT NO.: **19-1190**

SCHOOL: **PARAMOUNT ES** ADDRESS: **409 W. PARAMOUNT STREET, AZUSA**

ORANGE AVENUE

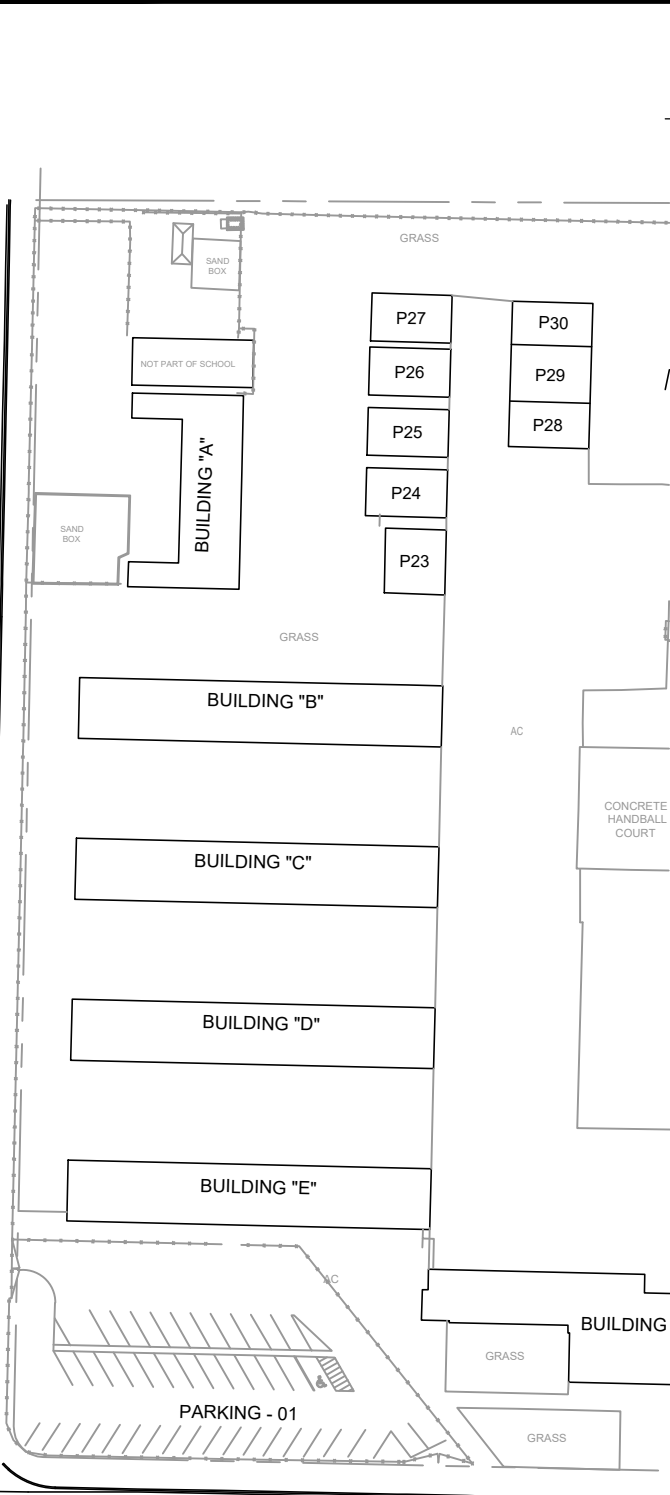

PARAMOUNT SCHOOL						
GENERAL SCHOOL INFORMATION SUMMARY						
BLDG NO.	BLDG NAME	BLDG AREA TOTAL (SF)	DSA NUMBER	DATE / YR BUILT	CLSD/ CERT.	
A	KINDERGARTEN/CLRM.	3,536	A#9547	1952	N/A	
B	CLASSROOM	4,440	A#9547	1952	N/A	
C	CLASSROOM	4,440	A#23113	1962	N/A	
D	CLASSROOM	5,469	A#9547	1952	N/A	
E	CLASSROOM	5,440	A#8154	1950	N/A	
F	ADMIN	4,440	A#23113	1962	N/A	
		5,440	A#8154	1950	N/A	
		1,911	A#8154	1950	N/A	
		6,934	A#9547	1952	N/A	
G	PORT.CLASSROOM	968	A#9467	?	N/A	
2	PORT.CLASSROOM	1,920	A#51909	1989	N/A	
-	PORT.CLRMS.P24,P25 & P26	2,880	A#52331	1989	N/A	
-	PORT.CLRMS. P28 &P29	1,920	A#67755	1997	N/A	
-	PORT.CLRMS. P30	1,930	A#03-100771	1998	Y/Y	
-	PORT.CLRMS. P27	960	A#03-102398	2000	Y/Y	

PARAMOUNT SCHOOL, AUSD				
GENERAL SCHOOL INFORMATION SUMMARY				
DSA NUMBER	BLDG(S) NAME/ DESCRIPTION		DATE / YR BUILT	CLSD/ CERT.
A#51122	BLDG. (A, B, C, D, E, & F)	RECONSTRUCTION	1989	N/A
A#66249	CAMPUS	CONSTRUCTION OF BALL WALLS	1996	N/A
A#03-116710	BLDG. (A, B, C, D, E, & F)	Alterations to 5-HVAC Upgrade at Buildings B,C,D,E.(9547,23113,51122), 9-Replace (E) built-up roofing at Bldg's A,B,C,D,E, & F & 3 modular bldg's	2016	Y/Y
A#03-119621	BLDG. A	Alterations to 1-SITE DEVELOPMENT- GATE REPLACEMENT	2019	-
A#03-119624	BLDG. (A, B, C, D, E, & F)	Alterations to 1-FIRE ALARM UPGRADE FOR THE ENTIRE CAMPUS	2019	-
A#03-1199898	PARKING LOT	Alterations to 1-PARKING LOT	2019	-



Above is in compliance with Article 2022, Sub Chapter 8 Title 5 Calif. Admin. Code.

DATE DECEMBER 31, 2020  
 SHEET 14 OF 18 SHEETS  
 BY: ARCHITECTS MSP

**MSP ARCHITECTS**  
 McDonald, Soutar & Paz, Inc.  
 3575 Long Beach Blvd.  
 Long Beach, California 90807  
 562/427-5007 Fax 562/427-3007

**DIAGRAM OF BUILDING AREAS**

- EXISTING (1-A)
- BASIC PLANS (2-A)
- FINAL PLANS (3-A)

SCHOOL DISTRICT: **AZUSA USD** PROJECT NO.: **19-1190**

SCHOOL: **POWELL ARTS** ADDRESS: **1035 E. MAUNA LOA AVENUE, AZUSA**

**POWELL ELEMENTARY SCHOOL, AUSD**

**GENERAL SCHOOL INFORMATION SUMMARY**

BLDG NO.	BLDG NAME	BLDG AREA TOTAL (SF)	DSA NUMBER	DATE / YR BUILT	CLSD / CERT.
A	ADMIN/ LIBRARY/ COMP. LAB	4,200 SF	A# 14901	1956	N/A
B	CLASSROOMS	8,584 SF	A# 14901	1956	N/A
C	CLASSROOMS	4,524 SF	A# 17434	N/A	N/A
D	MULTI-PURPOSE ROOM	4,208 SF	A# 20063	1960	N/A
E	CLASSROOMS	4,507 SF	A# 23036	N/A	N/A
K	KINDERGARTEN	2,855 SF	A#03-107800	2002	Y/Y
SHED	LUNCH SHELTER	253 SF	A#03-107800	2002	Y/Y

**POWELL E.S. AUSD**

**ADDITIONAL SCHOOL INFORMATION SUMMARY**

DSA NUMBER	BLDG(S) NAME/ DESCRIPTION		DATE / YR BUILT	CLSD/ CERT.
A#03-100771	PORT CLRM. P15	CONST. RELO. CLRM.	1998	Y/Y
A#03-105661	BUILDINGS A,B,C,D,E	ALTERATIONS	2002	Y/Y
A#03-107800	BUILDINGS A,B,D,E	ALTERATIONS	2003	Y/Y

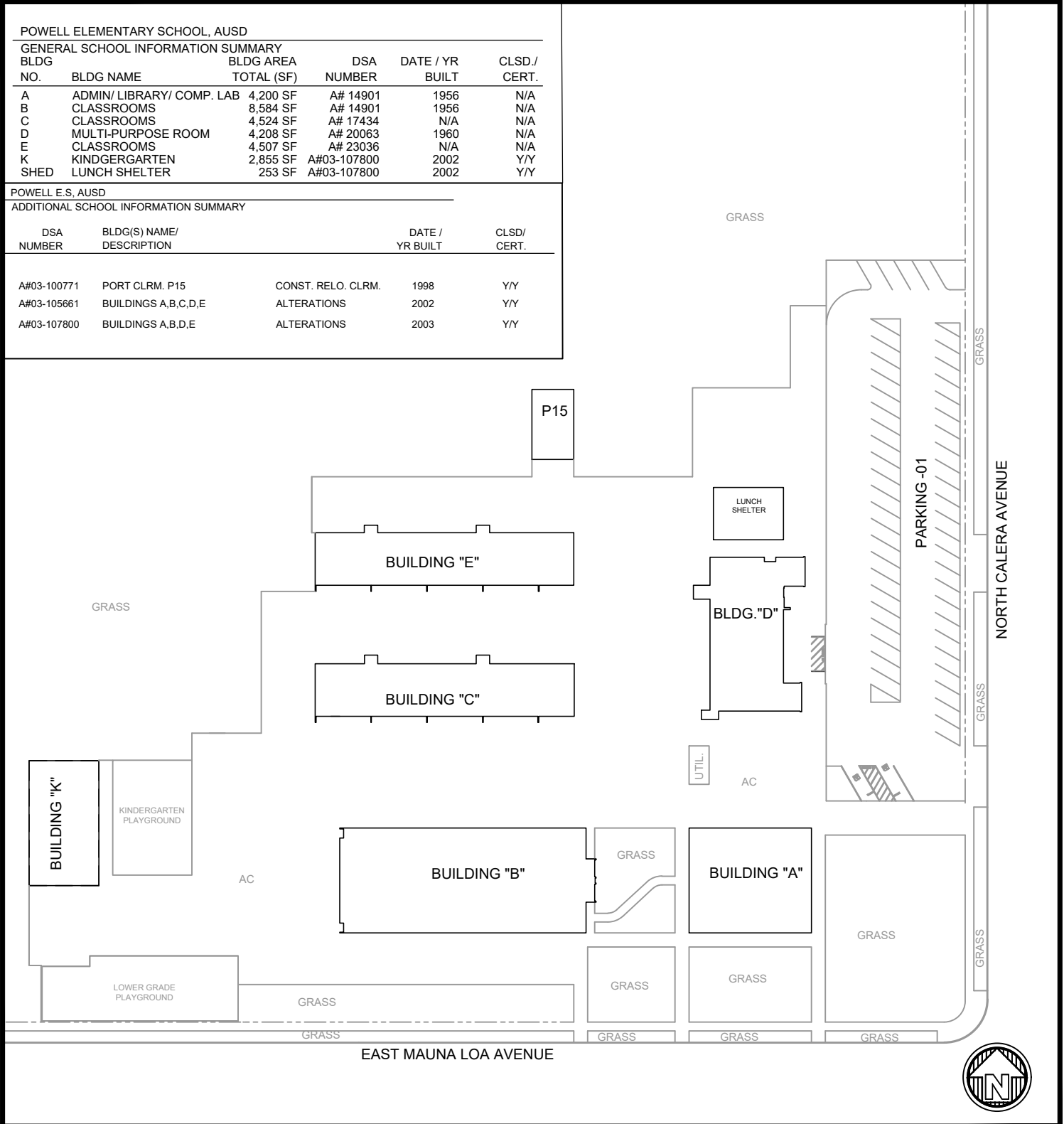

Above is in compliance with Article 2022, Sub Chapter 8 Title 5 Calif. Admin. Code.

DATE DECEMBER 31, 2020  
 SHEET 15 OF 18 SHEETS  
 BY: ARCHITECTS MSP

**MSP**  
**ARCHITECTS**  
 McDonald, Soutar & Paz, Inc.  
 3575 Long Beach Blvd.  
 Long Beach, California 90807  
 562/427-5007 Fax 562/427-3007





**DIAGRAM OF BUILDING AREAS**

- EXISTING (1-A)
- BASIC PLANS (2-A)
- FINAL PLANS (3-A)

SCHOOL DISTRICT: **AZUSA USD** PROJECT NO.: **19-1190**

SCHOOL: **SIERRA HS** ADDRESS: **1040 E. GLADSTONE STREET, AZUSA**

GLADSTONE STREET ELEMENTARY, AUSD					
GENERAL SCHOOL INFORMATION SUMMARY					
BLDG NO.	BLDG NAME	BLDG AREA TOTAL (SF)	DSA NUMBER	DATE / YR BUILT	CLSD./ CERT
A	ADMIN OFFICE	2,310 SF	15661	1957	N/A
B	MP BUILDING	6,570 SF	15661	1957	N/A
C	CLASSROOMS	7,200 SF	15661	1957	N/A
D	CLASSROOMS	6,600 SF	15661	1957	N/A
E	CLASSROOMS	6,600 SF	15661	1957	N/A
F	RESTROOMS	990 SF	15661	1957	N/A
G	CLASSROOMS	4080 SF	15661	1957	N/A
H	CLASSROOMS	3,990 SF	15661	1957	N/A
I	CLASSROOMS	3,990 SF	15661	1957	N/A
J	CLASSROOMS	3,990 SF	15661	1957	N/A
K	RESTROOMS	1,200 SF	15661	1957	N/A
L	RESTROOMS	1,380 SF	15661	1957	N/A
PARK	PARKING 1	29,200 SF	15661	1957	N/A
31/32	TEAM ROOM	1,920 SF	80059	1997	02'/VOID
SHADE	SHADE	2,400 SF	03-105629	2002	Y/Y
LIB.	LIBRARY AND COMPUTER LAB	2,400 SF	02-105711	2004	Y/Y
RR	RESTROOM	480 SF	02-105711	2004	Y/Y
PARK	PARKING 2 & AC PAD	60,800 SF	03-120206	2020	Y/Y
P33-P34	PORTABLES/FIRE ACC. LN.	1,920 SF	03-120788	2021	N/N

GLADSTONE STREET ELEMENTARY SCHOOL, AUSD				
GENERAL SCHOOL INFORMATION SUMMARY				
DSA NUMBER	BLDG(S) NAME/ DESCRIPTION	DATE / YR BUILT	CLSD/ CERT.	
A# 50232	BLDGS. (A, B, C, D, E, F, G, H, I, J, K, L)	PHASE 1 (HVAC)	1988	Y/Y
A# 50678	BLDGS. (A, B, C, D, E, F, G, H, I, J, K, L)	PHASE 2 (HVAC)	1988	Y/Y
A# 51727	BLDGS. (A, B, C, D, E, F, G, H, I, J, K, L)	DATA UPGRADE	1989	Y/Y
A# 03-105629	BLDGS. (A, B, C, D, E, F, G, H, I, J, K, L)	CAMPUS ENRICHMENT, INTERIOR SIGNAL UPGRADE, ELEC, HVAC,	2002	Y/Y
A# 02-105711	BLDGS. (A, B, F, G,) PORTS (31,32), RR, LIB, COMP LAB.	CAMPUS ENRICHMENT, EXTERIOR LIGHTING, HVAC	2004	Y/Y
A# 03-120206	SITE	CONST. OF 1 PARKING-02 LOT	2019	Y/Y

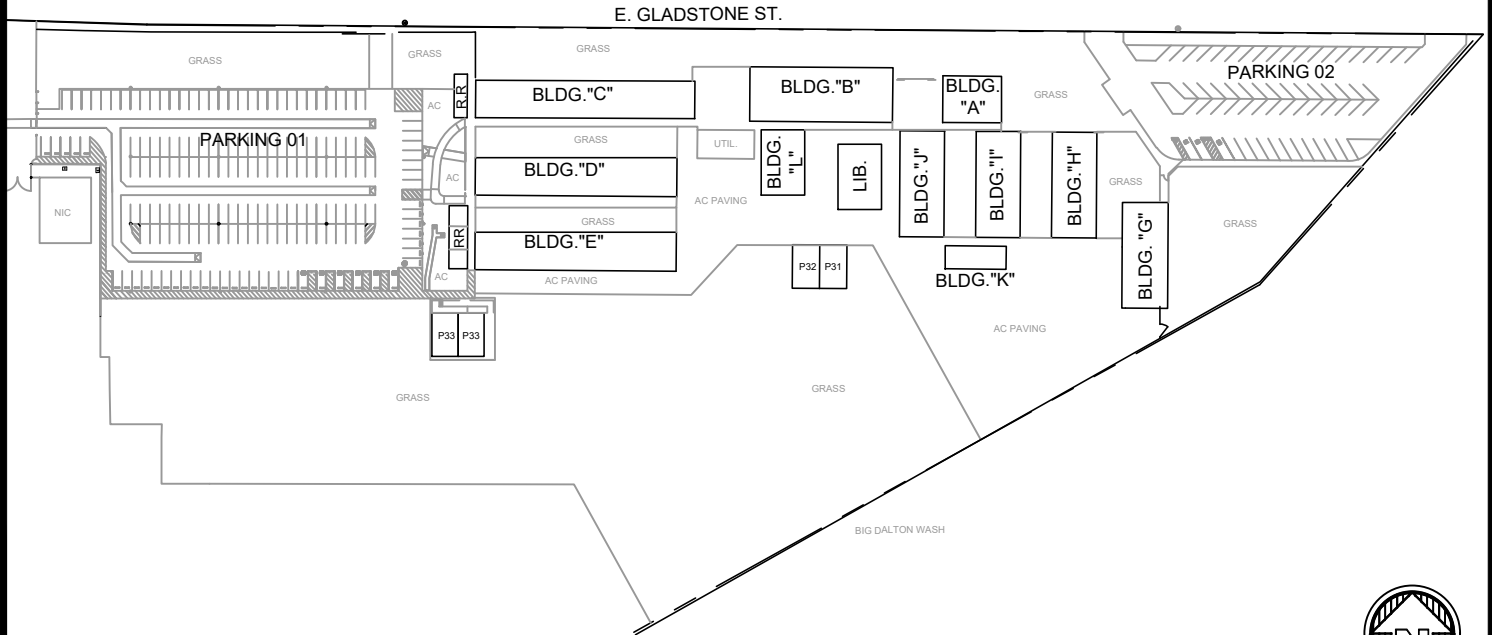

Above is in compliance with Article 2022, Sub Chapter 8 Title 5 Calif. Admin. Code.

DATE DECEMBER 31, 2020  
 SHEET 16 OF 18 SHEETS  
 BY: ARCHITECTS MSP

**MSP**  
**ARCHITECTS**  
 McDonald, Soutar & Paz, Inc.  
 3575 Long Beach Blvd.  
 Long Beach, California 90807  
 562/427-5007 Fax 562/427-3007

**DIAGRAM OF BUILDING AREAS**

- EXISTING (1-A)
- BASIC PLANS (2-A)
- FINAL PLANS (3-A)

SCHOOL DISTRICT: **AZUSA USD** PROJECT NO.: **19-1190**

SCHOOL: **SLAUSON MS** ADDRESS: **340 W. 5TH STREET, AZUSA**

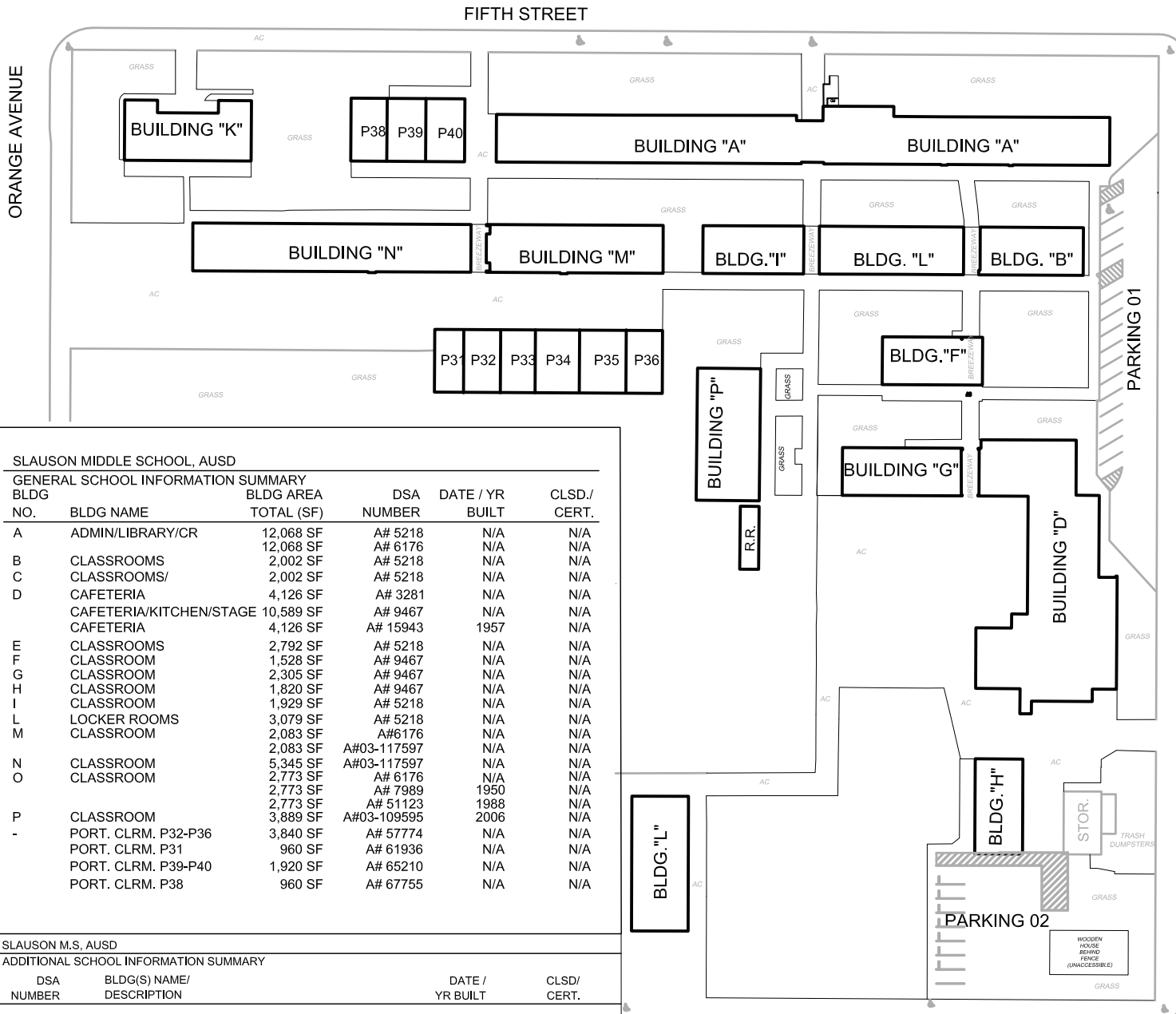

**SLAUSON MIDDLE SCHOOL, AUSD**

**GENERAL SCHOOL INFORMATION SUMMARY**

BLDG NO.	BLDG NAME	BLDG AREA TOTAL (SF)	DSA NUMBER	DATE / YR BUILT	CLSD./ CERT.
A	ADMIN/LIBRARY/CR	12,068 SF	A# 5218	N/A	N/A
B	CLASSROOMS	12,068 SF	A# 6176	N/A	N/A
C	CLASSROOMS/	2,002 SF	A# 5218	N/A	N/A
D	CAFETERIA	2,002 SF	A# 5218	N/A	N/A
E	CAFETERIA/KITCHEN/STAGE	4,126 SF	A# 3281	N/A	N/A
F	CAFETERIA	10,589 SF	A# 9467	N/A	N/A
G	CAFETERIA	4,126 SF	A# 15943	1957	N/A
H	CLASSROOMS	2,792 SF	A# 5218	N/A	N/A
I	CLASSROOM	1,528 SF	A# 9467	N/A	N/A
L	CLASSROOM	2,305 SF	A# 9467	N/A	N/A
M	CLASSROOM	1,820 SF	A# 9467	N/A	N/A
N	CLASSROOM	1,929 SF	A# 5218	N/A	N/A
O	LOCKER ROOMS	3,079 SF	A# 5218	N/A	N/A
P	CLASSROOM	2,083 SF	A#6176	N/A	N/A
-	PORT. CLRM. P32-P36	2,083 SF	A#03-117597	N/A	N/A
-	PORT. CLRM. P31	5,345 SF	A#03-117597	N/A	N/A
-	PORT. CLRM. P39-P40	2,773 SF	A# 6176	N/A	N/A
-	PORT. CLRM. P38	2,773 SF	A# 7989	1950	N/A
-	PORT. CLRM. P38	2,773 SF	A# 51123	1988	N/A
-	PORT. CLRM. P38	3,889 SF	A#03-109595	2006	N/A
-	PORT. CLRM. P32-P36	3,840 SF	A# 57774	N/A	N/A
-	PORT. CLRM. P31	960 SF	A# 61936	N/A	N/A
-	PORT. CLRM. P39-P40	1,920 SF	A# 65210	N/A	N/A
-	PORT. CLRM. P38	960 SF	A# 67755	N/A	N/A

**SLAUSON M.S., AUSD**

**ADDITIONAL SCHOOL INFORMATION SUMMARY**

DSA NUMBER	BLDG(S) NAME/ DESCRIPTION	DATE / YR BUILT	CLSD/ CERT.	
A#03-106989	SIGN STRUCTURE	CONSTRUCTION	2003	N/A
A#03-119968	FIRE ALARMS	ALTERATIONS	2019	N/A
A#03-119566	ALL BUILDINGS	ALTERATIONS	N/A	N/A
A#03-119566	TWO SHADE STRUCTURES	CONSTRUCTION	N/A	N/A
A#03-118771	BUILDING D	ALTERATIONS	2018	N/A
A# 118769	BUILDING D & WALKIN FREEZER	ALTERATIONS	2018	N/A
A#03-117597	UNDERGROUND UTILITY REPLACEMENT	ALTERATIONS	2017	YY
A# 116730	9HVAC REPLACEMENT TO BUILDINGS A,B,E,F,G,I,M,N,O	ALTERATIONS	2016	YY

Above is in compliance with Article 2022, Sub Chapter 8 Title 5 Calif. Admin. Code.

DATE DECEMBER 31, 2020  
 SHEET 17 OF 18 SHEETS  
 BY: ARCHITECTS MSP

**MSP ARCHITECTS**  
 McDonald, Soutar & Paz, Inc.  
 3575 Long Beach Blvd.  
 Long Beach, California 90807  
 562/427-5007 Fax 562/427-3007



**DIAGRAM OF BUILDING AREAS**

■ EXISTING (1-A)

□ BASIC PLANS (2-A)

□ FINAL PLANS (3-A)

SCHOOL DISTRICT: AZUSA USD PROJECT NO.: 19-1190

SCHOOL: VALLEYDALE ES ADDRESS: 700 S. LARK ELLEN AVENUE, AZUSA

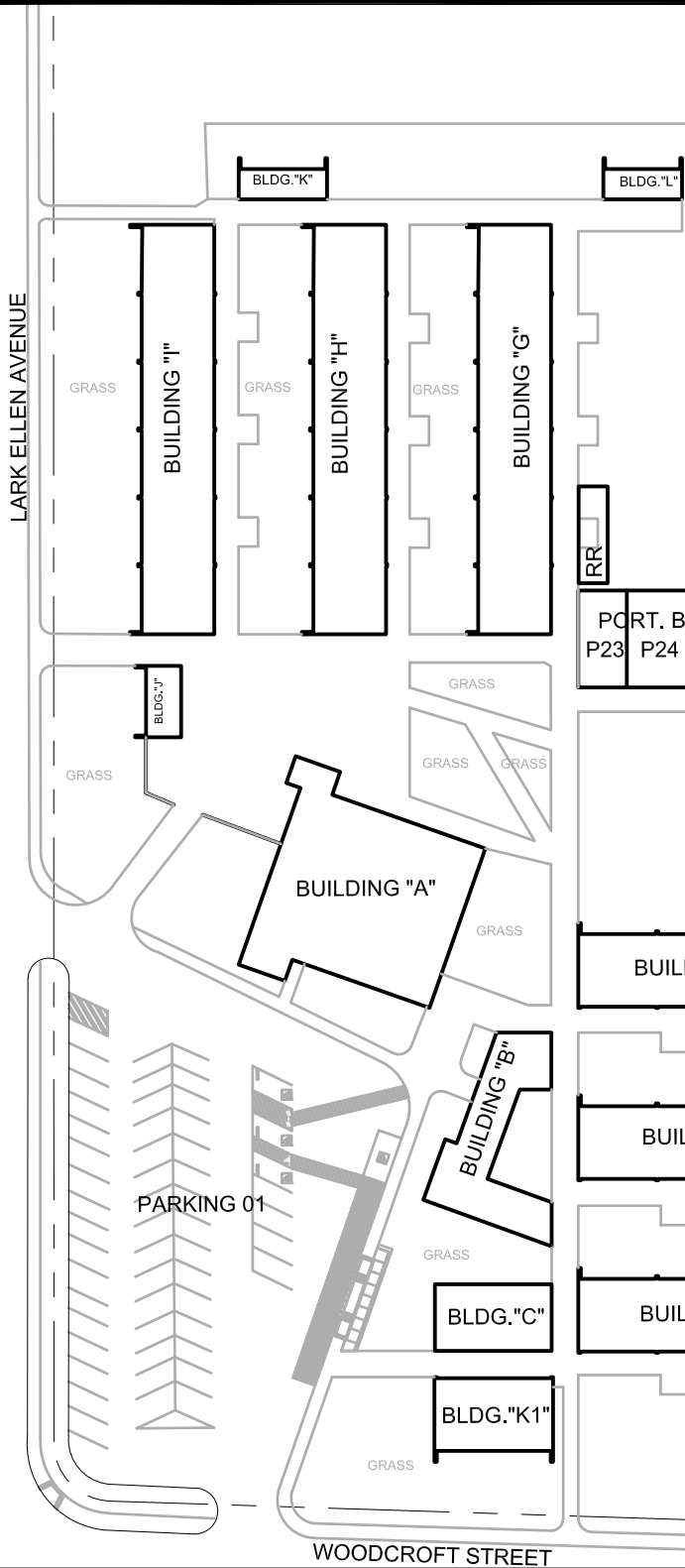

VALLEYDALE E.S., AUSD

GENERAL SCHOOL INFORMATION SUMMARY

BLDG NO.	BLDG NAME	BLDG AREA TOTAL (SF)	DSA NUMBER	DATE / YR BUILT	CLSD / CERT.
A	CAETERIA	5,945 SF	A# 12573	N/A	N/A
B	OFFICE	2,202 SF	A# 12573	N/A	N/A
C	PRE-SCHOOL/ KINDER.	2,820 SF	A# 12573	N/A	N/A
D	KINDERGARTEN 2-3	3,281 SF	A# 12573	N/A	N/A
E	STAFF WR/LOUNGE/ CR 1	3,281 SF	A# 12573	N/A	N/A
F	CLASSROOMS 2-4	3,281 SF	A# 12573	N/A	N/A
G	CLASSROOMS 5-10	5,033 SF	A# 12573	N/A	N/A
H	CLASSROOMS 11-16	5,033 SF	A# 12573	N/A	N/A
I	CLASSROOMS 17-22	5,033 SF	A# 12573	N/A	N/A
J	CUSTODIAN	429 SF	A# 12573	N/A	N/A
K	RESTROOM	454 SF	A#03-105461	N/A	N/A
L	RESTROOM	454 SF	A#03-105709	N/A	N/A
-	PORTABLE RESTROOM	480 SF	A#03-105709	N/A	N/A
-	PORTABLE CR P23-P24	2,530 SF	A#03-100795	N/A	N/A
-	PORTABLE P25-P26	2,400 SF	A#03-102398	N/A	N/A

VALLEYDALE E.S., AUSD

ADDITIONAL SCHOOL INFORMATION SUMMARY

DSA NUMBER	BLDG(S) NAME/ DESCRIPTION		DATE / YR BUILT	CLSD / CERT.
A#03-105709	BLDG A,B,C,D,RR E	ALTERATION	2004	YY
A#02-105709	LIBRARY & KINDERGARTEN	CONSTRUCTION	2004	YY
A#03-105461	BLDG E,F,G,H,I,J, RR K	ALTERATION	2002	YY

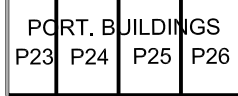

Above is in compliance with Article 2022, Sub Chapter 8 Title 5 Calif. Admin. Code.

DATE DECEMBER 31, 2020  
 SHEET 18 OF 18 SHEETS  
 BY: ARCHITECTS MSP

**MSP**  
**ARCHITECTS**  
 McDonald, Soutar & Paz, Inc.  
 3575 Long Beach Blvd.  
 Long Beach, California 90807  
 562/427-5007 Fax 562/427-3007

8 Bid Calendar Extended

<b>Mon</b>	<b>Tue</b>	<b>Wed</b>	<b>Thu</b>	<b>Fri</b>
17-Apr	18-Apr	19-Apr	20-Apr	21-Apr
Bid Publish				
24-Apr	25-Apr	26-Apr	27-Apr	28-Apr
1-May	2-May	3-May	4-May	5-May
8-May	9-May	10-May	11-May	12-May
Job Walk 11:00-2:00				
15-May	16-May	17-May	18-May	19-May
RFI Due 4:00pm				
22-May	23-May	24-May	25-May	26-May
Bid Due 11:00am	Bid Tabulation 10:00am			

ALL OTHER PROVISIONS of the Bid Documents shall remain unchanged. This Addendum is hereby made a part of the Bid Documents to the same extent as those provisions contained in the original documents and all itemized listings thereof.

NOTE: The failure or omission of any bidder to receive or examine any bid document, forms, instrument, addendum, specifications, plans, or other documents shall by no means relieve any bidder from any obligation with respect to his bid or to the contract.

END OF ADDENDUM NO.2