



# Valley Middle School Referendum

Dr. Terry Brenner

Superintendent

April 2023

# How did we get here?

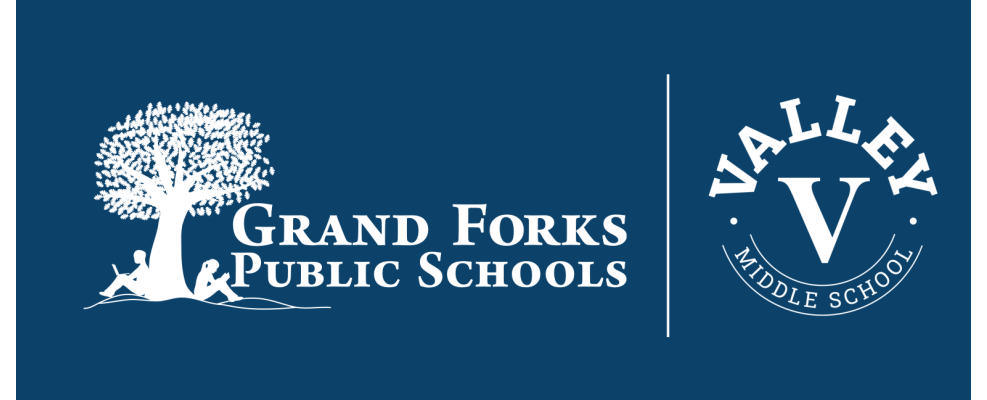

**FALL 2022** - GFPS and Local Consultants Conducted District-Wide Facility Assessment

- District-Wide Survey Sent to Aid GFPS in Facility Planning
- Results: 73% Support Building New Valley Middle School and Centralized Kitchen for \$61 Million
- 77.6% Support Implementing Safety & Security Upgrades for \$18 Million

**ICON**  
ARCHITECTURAL GROUP

**Cunningham**

**JANUARY - FEBRUARY 2023** - 60-Member Committee Participated in Design Workshop for a New Valley Middle School

**MARCH 2023** - GFPS School Board Sets Referendum for \$79 Million on May 16, 2023

# Current Challenges

## VALLEY MIDDLE SCHOOL & DISTRICT KITCHEN

- No air conditioning/dehumidification
- Lack of fresh air circulation in much of the building
- Boiler system is past its life expectancy
- Does not comply with Americans with Disabilities Act (ADA) requirements
- Cafeteria & many general & specialized classrooms such as science, Career and Technical Education (CTE), music, art, & special education are undersized
- Special Education (IDEA, 1975) added 13 additional programming categories & medically fragile students
- Lacks learning spaces to accommodate today's learning programs

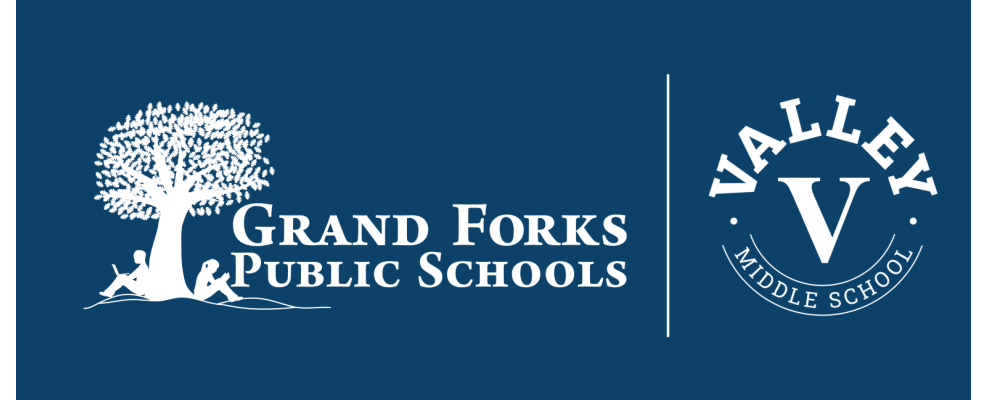



**Original tile throughout the school that has reached its end of life.**

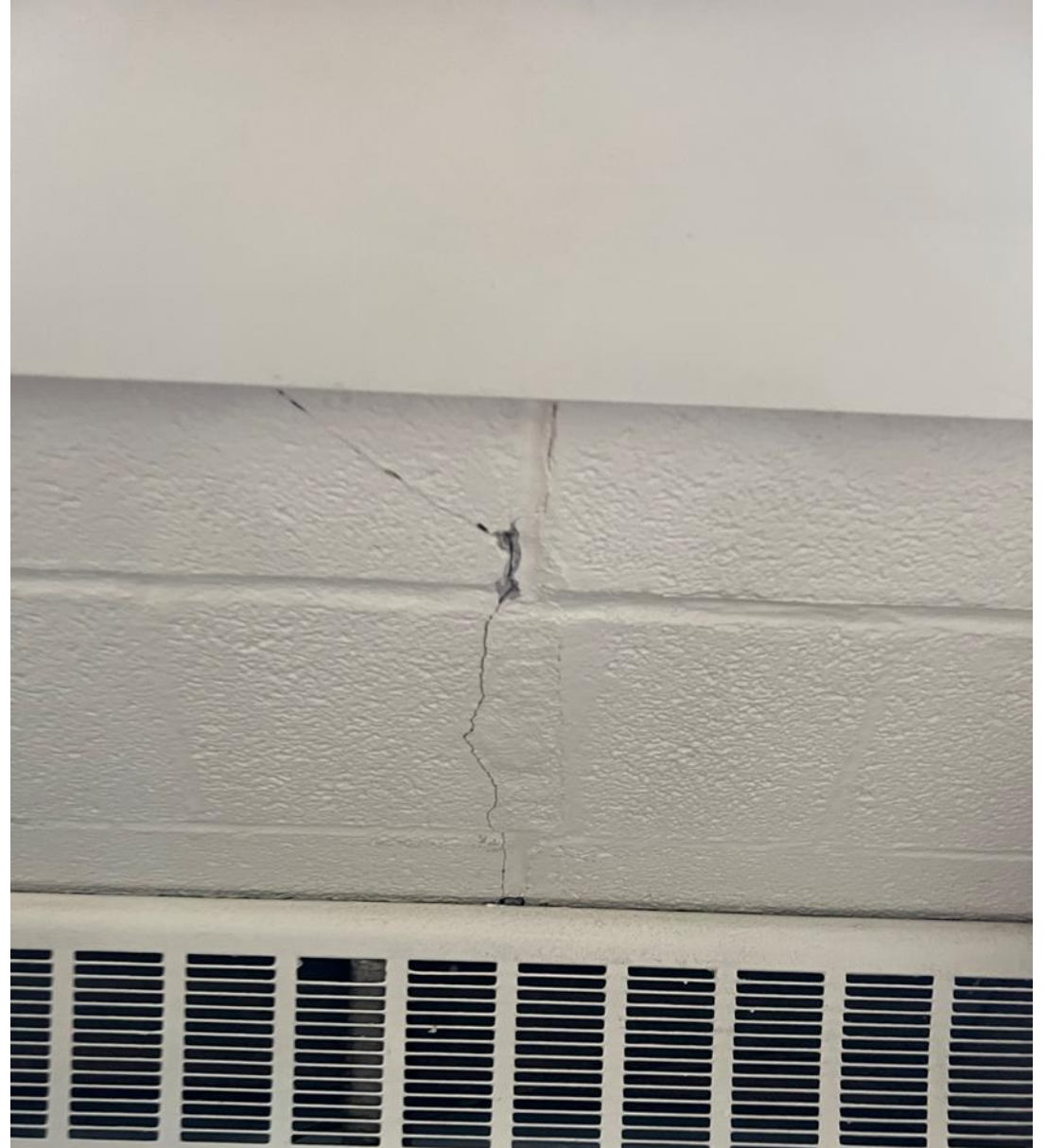

**Building shifting and noticeable large cracks in concrete blocks.**



**Adult restrooms are not accessible.**

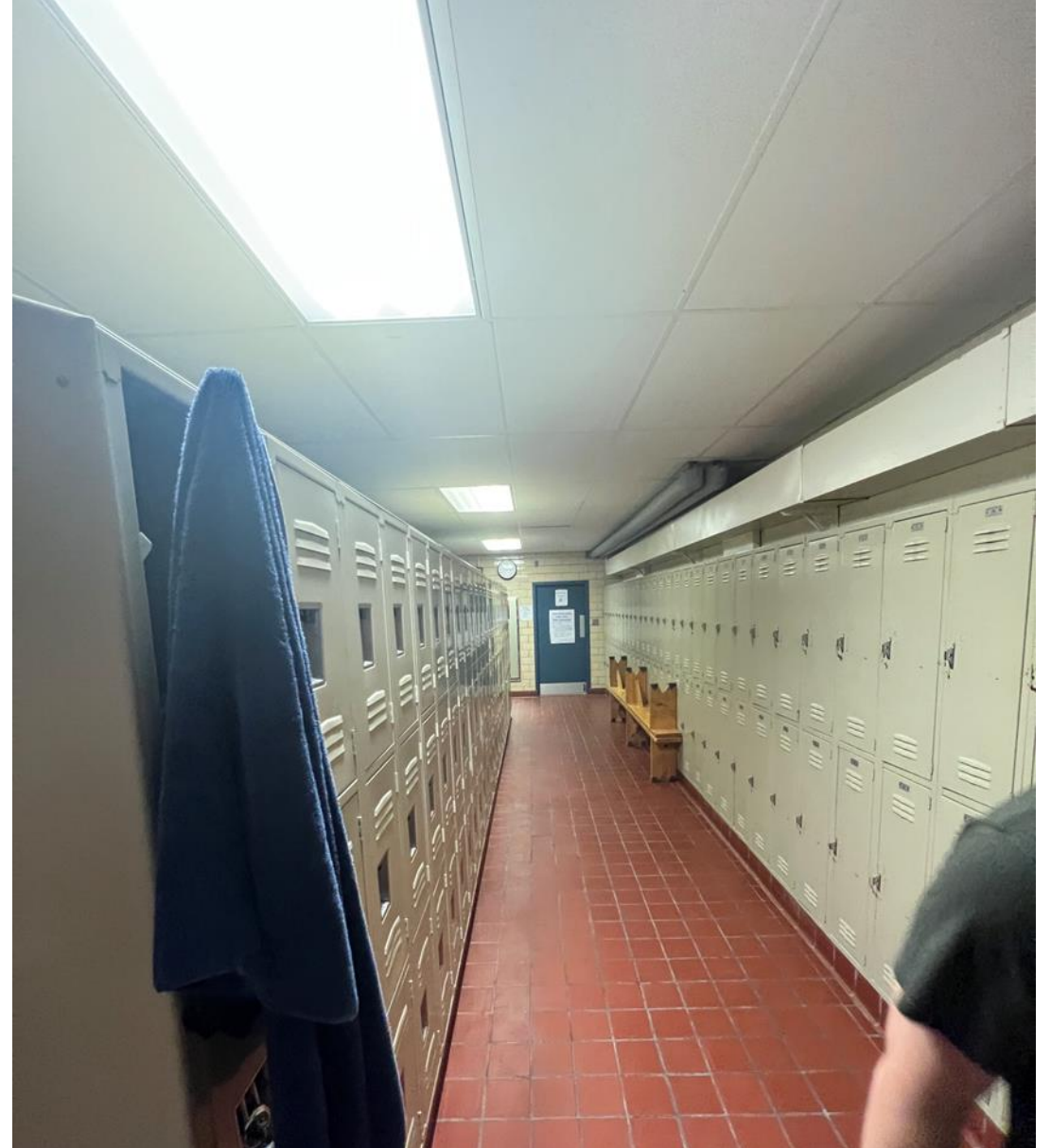

**All locker rooms are not accessible.**



**Stairwell lacking separate handrail from the guardrail and the spaces between the railings exceed the maximum 4 inches.**

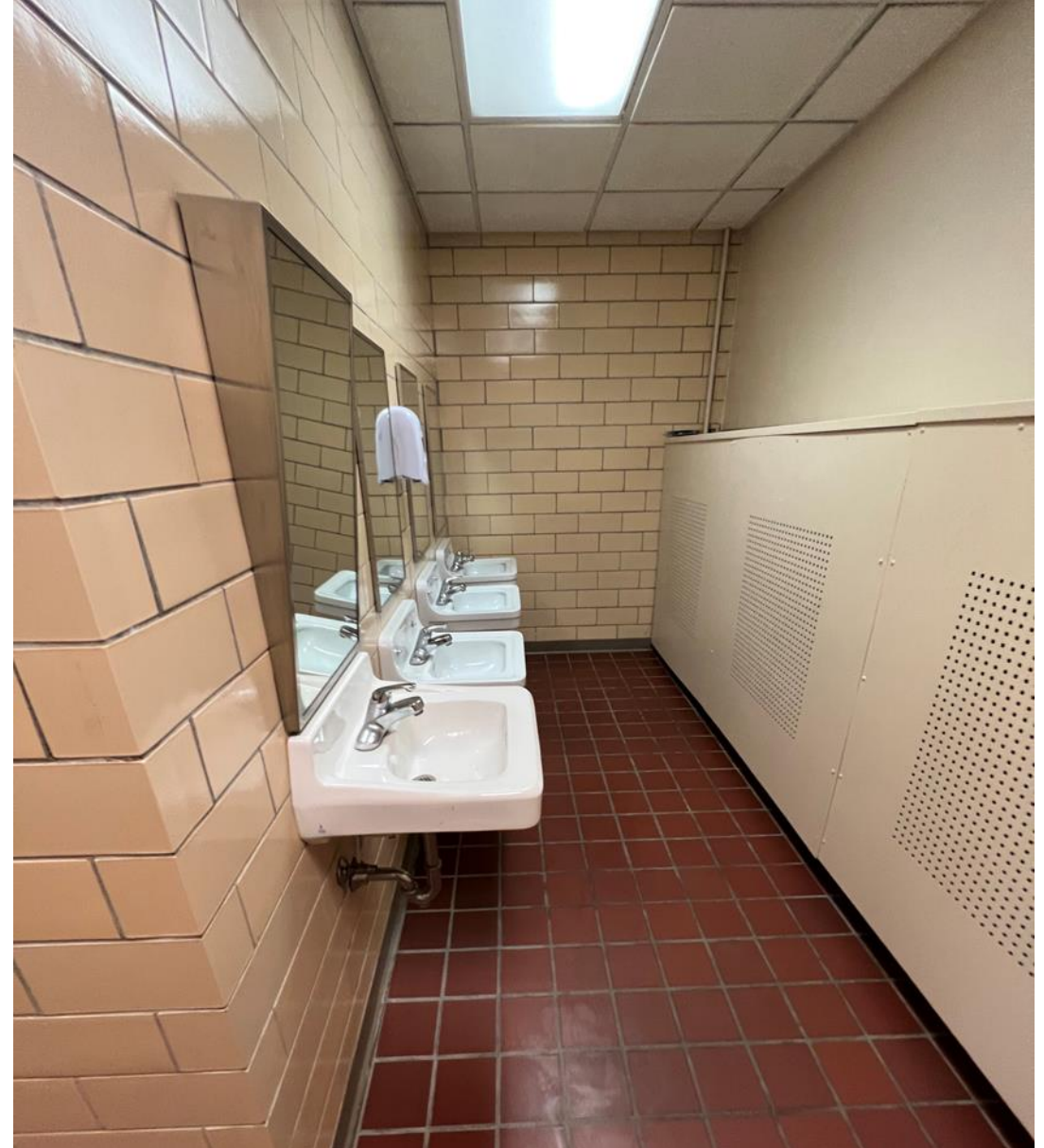

**All public restrooms in the building are not accessible.**

# Current Challenges Continued

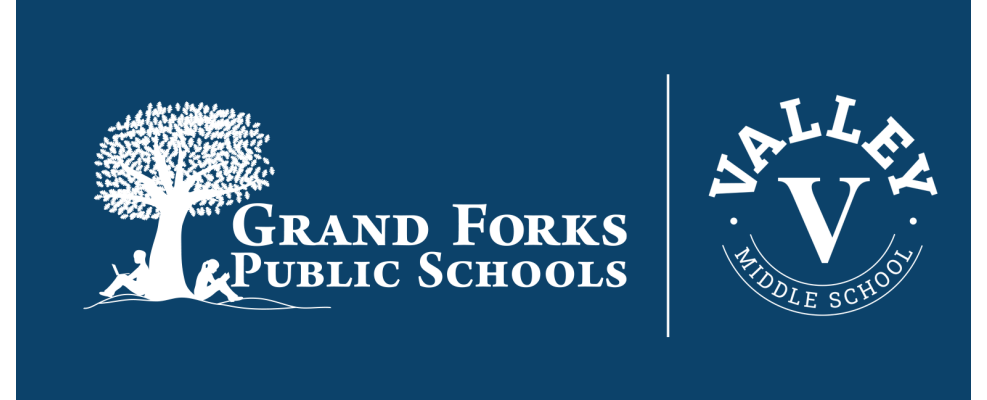

## District Kitchen

- Undersized space for production needs
- Residential setting is inefficient for loading & delivery needs of district kitchen
- Current student pick up/drop off location & food truck access creates a traffic safety issue

## Safety & Security

- Lack of physical controlled access secure entrances
- There is need for updated mass notification systems, fire panels, and security cameras
- All schools need ongoing emergency response plan updating and training.

# Secure Entrance



**Current entrances lack safety and security.**

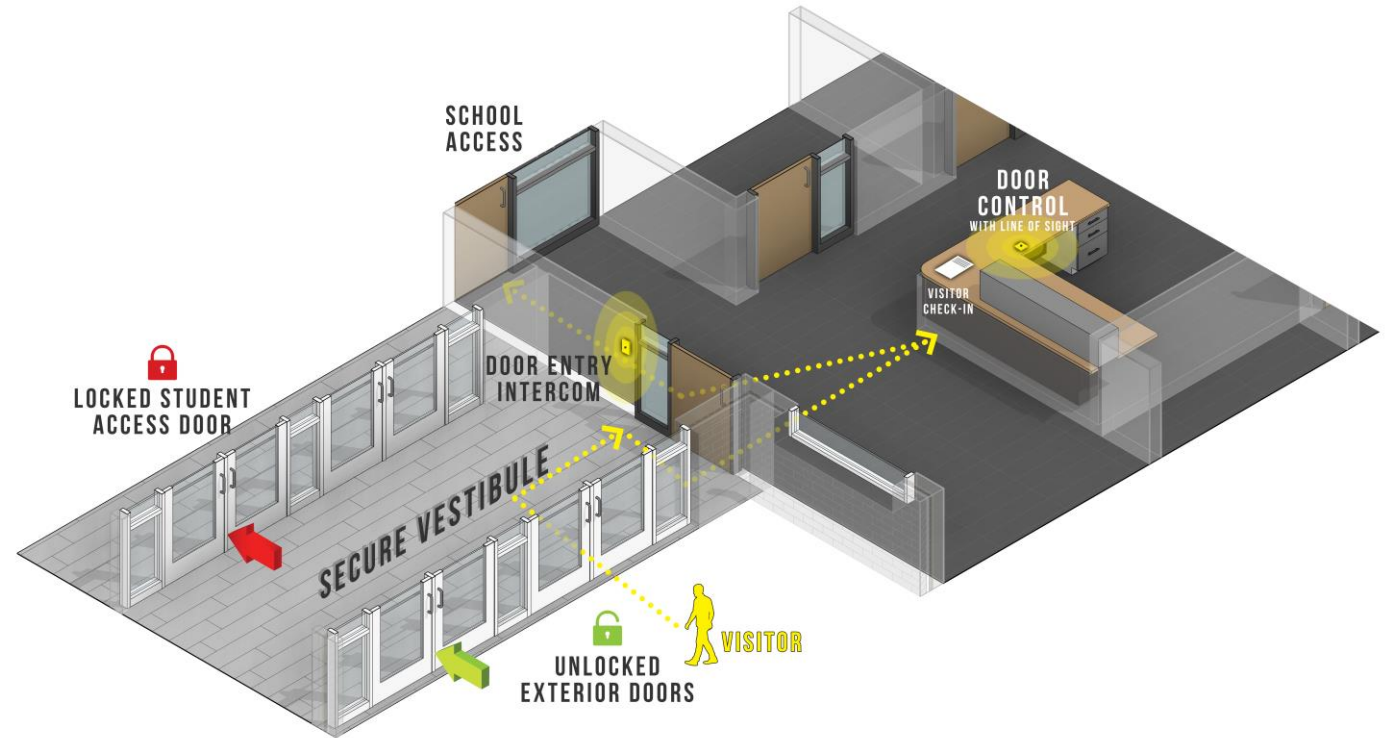

**Secure Entrance floorplan.**

# Why not renovate?

- High cost to modernize electrical and mechanical systems without improving the school's ability to deliver education
- Old age and numerous additions have created a vast amount of accessibility and code compliance issues that are not remedied inexpensively
- Cost to renovate is 75% cost to build new (FEMA 50%)

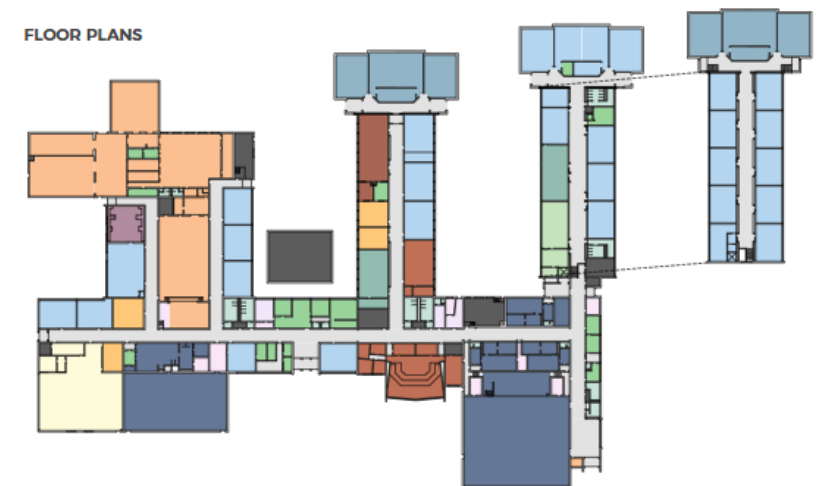

# Proposed Solution

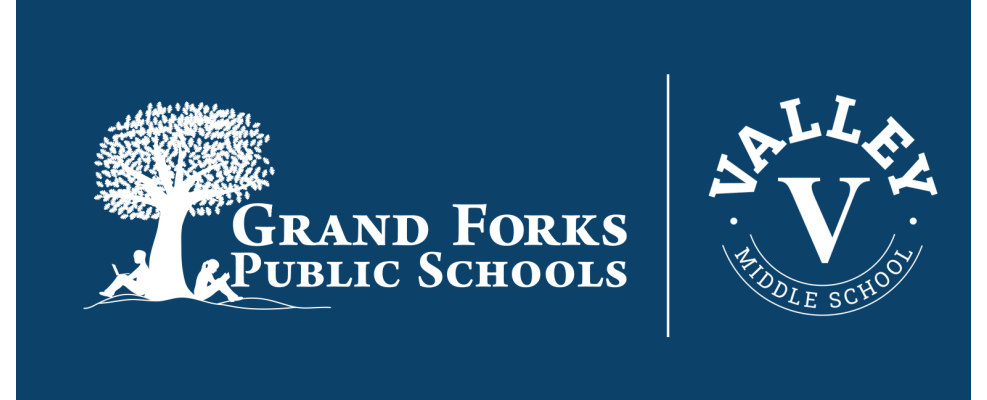

- New Valley Middle School
- Relocation of Child Nutrition Center to District Office (MSEC)
- Safety & Security Improvements

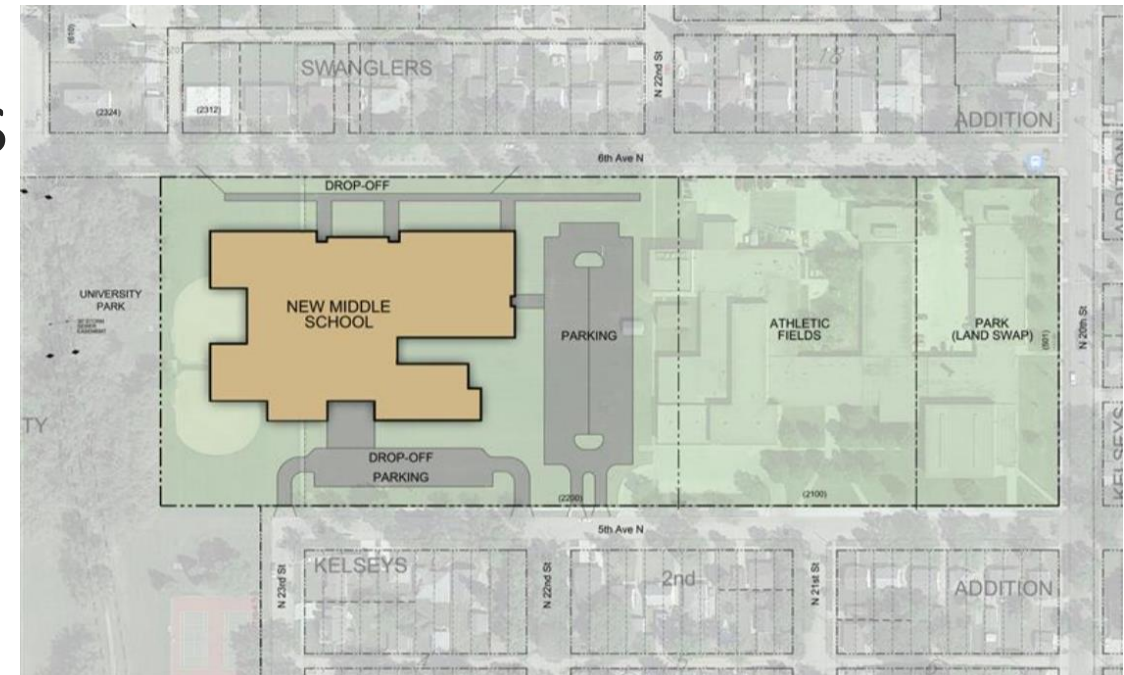

# Proposed Safety & Security Solutions

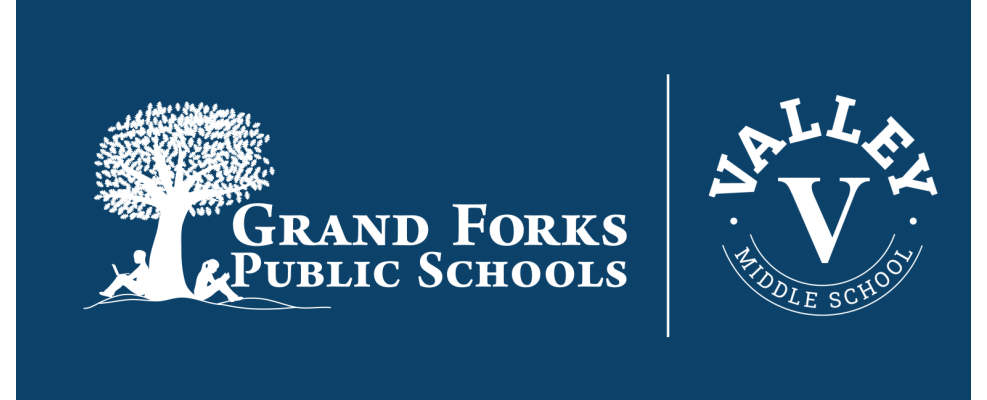

- Constructing physical secure entrances that would include updated push to talk system and utilize assigned electronic keys
- Relocating central offices to achieve a physical secure entrance
- Continued expansion of security cameras
- Improve the intercom system and identify mass notification communications options
- Install new fire panels
- Updated emergency response plans and training



**LOOKING NORTH-EAST**

**5TH AVENUE NORTH**





UNIVERSITY PARK

VALLEY MIDDLE SCHOOL

LOOKING NORTH-WEST

Valley Middle School Grades 6-8 Building Referendum

ICON  
ARCHITECTURAL GROUP

Cunningham

# Tax Impact

The estimated tax impact on a residential value of \$100,000 is \$96.93 annually.

Tax Calculator:  
[gfschools.org/tax](https://gfschools.org/tax)

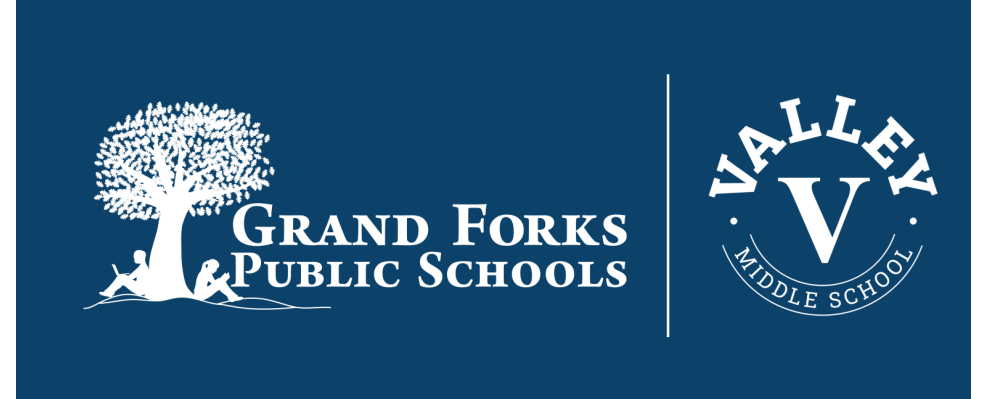

Grand Forks Public Schools - Tax Impact Estimate	
Referendum Amount	\$79,000,000
Estimated Referendum Mills	21.54
Enter Your Residential True and Full Value Below**	Estimated Annual Tax Impact*
\$100,000.00	\$96.93
Enter Your Taxable Value Below**	Estimated Annual Tax Impact
4,500	\$96.93
Enter Your Commerical or Ag Land True and Full Value Below**	Estimated Annual Tax Impact*
\$ 100,000.00	\$107.70
*Tax impact formula provided by: PFM Financial Advisors LLC (PFM.com)	
**Use Sample Tax Statement link to ensure the use of the correct property values.	

# Other Capital Improvements

\*All projects funded through building fund dollars leveraging federal dollars

**Total: \$24,770,858**

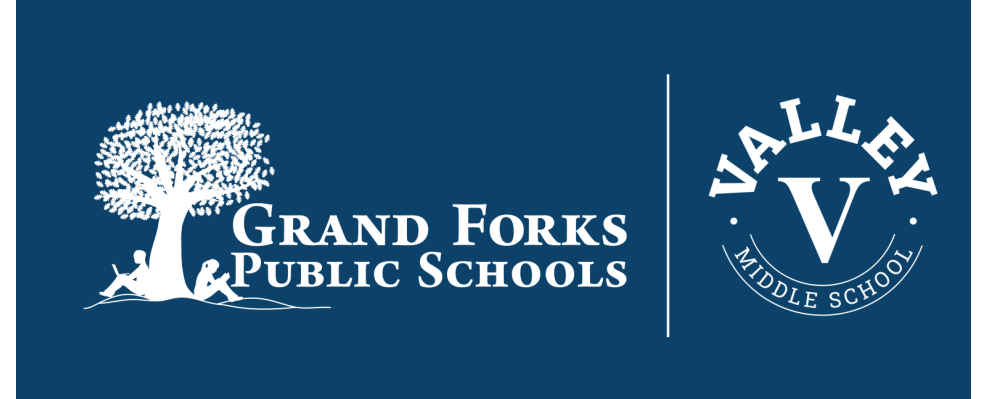

Project	Funding Source
Lake Agassiz, Viking, Kelly, Lewis & Clark, and Wilder HVAC Upgrades	Guaranteed Energy Savings Agreement
Ben Franklin HVAC and Accessibility	ESSER
South Boiler Replacement	ESSER
Phoenix Boiler Replacement	ESSER
Red River Sky Light Repair	ESSER
Central Chiller	ESSER and Resiliency Grants
Kelly Special Education Classroom	ARP IDEA Special Education

**ESSER** - Elementary and Secondary School Relief  
**ARP** - American Rescue Plan  
**IDEA** - Individuals with Disabilities Education Act  
**HVAC** – Heating, Ventilation, and Air Conditioning

# Scheduled Referendum Informational Presentations

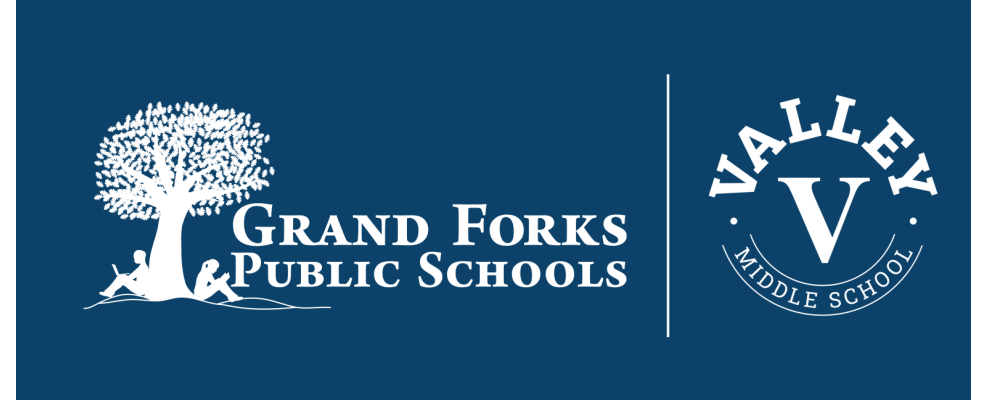

- Staff meetings at every school (18 plus MSEC)
- PTO meetings at every school (18)
- Video Message to Parents (5,400+)

Business meetings:

- ✓ UND College of Education & Human Development
- ✓ Chamber BGEA
- ✓ EDC Advisory Board
- ✓ Builders & Traders
- ✓ GF Rotary Club
- ✓ Sertoma Club

# Public Open House Presentations



**Wednesday, March 22 at 6:00 pm at Valley Middle  
School Gymnasium**

**Thursday, April 13 at 6:00 pm at Red River High  
School, Small Theatre**

**Wednesday, April 26 at 7:00 pm at Valley Middle  
School Gymnasium**

**Thursday, May 11 at 6:00 pm at Grand Forks  
Central High School Theatre**

**Childcare Available for  
Public Meetings**

Scan QR code to RSVP  
for childcare





**Forthcoming FAQs on our website,  
[www.gfschools.org](http://www.gfschools.org)**

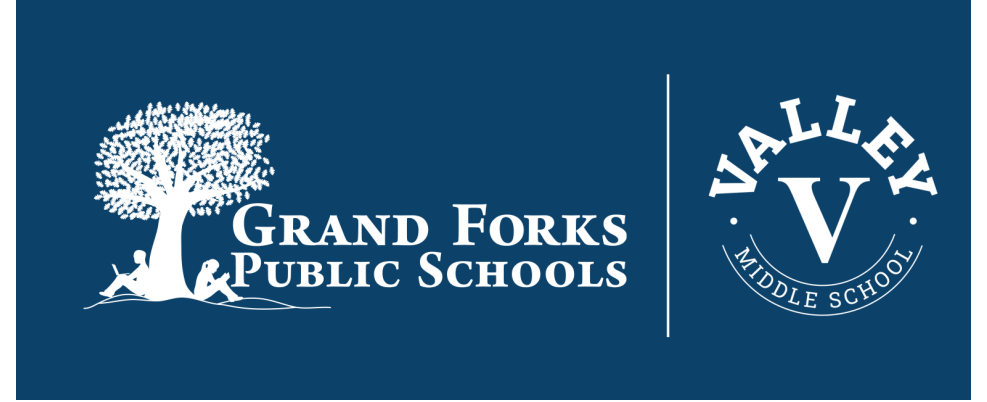

# Polling Site



## **Alerus Center**

**42nd Street, Grand Forks, ND**

## **May 16, 2023**

**7:00 a.m. - 7:00 p.m.**

# New Valley Middle School & Grand Forks Public Schools Referendum



## Background

**FALL 2022** - GFPS and Local Consultants Conducted District-Wide Facility Assessment

- District-Wide Survey Sent to Aid GFPS in Facility Planning
- Results: 73% Support Building New Valley Middle School and Centralized Kitchen for \$61 Million
- 77.6% Support Implementing Safety & Security Upgrades for \$18 Million

**JANUARY - FEBRUARY 2023** - 60-Member Committee Participated in Design Workshop for a New Valley Middle School  
**MARCH 2023** - GFPS School Board Sets Referendum for \$79 Million on May 16, 2023

## Challenges

### VALLEY MIDDLE SCHOOL & DISTRICT KITCHEN

- No air conditioning/dehumidification
- Boiler system is past its life expectancy
- Does not comply with Americans with Disabilities Act (ADA) requirements
- Cafeteria & many general & specialized classrooms such as science, Career and Technical Education (CTE), music, art, & special education are undersized
- Lacks learning spaces to accommodate today's learning programs
- Residential setting is inefficient for loading & delivery needs of district kitchen
- Current student pick up/drop off location & food truck access creates a traffic safety issue

### SAFETY & SECURITY

- 15 of 16 District schools lack adequate, secure, and controlled entrances

## Proposed Solution

### BUILD A NEW VALLEY MIDDLE SCHOOL & RELOCATE THE CENTRALIZED DISTRICT KITCHEN

The new middle school and central district kitchen would be designed to:

- Accommodate middle school structure for grades 6 - 8
- Create new adequate classrooms & instruction spaces
- Meet all building & ADA accessibility codes
- Master planned on school land should long-term growth occur
- Improve traffic congestion & safety for students, families & neighborhood residents
- Allow for efficient loading & delivery logistics

### SAFETY AND SECURITY IMPROVEMENTS

- Construct controlled-access, secure entrances at the 15 out of 16 District schools

### Public Meetings



Wednesday, March 22  
at 6:00 pm at Valley Middle School Gymnasium



Thursday, April 13  
at 6:00 pm at Red River High School, Small Theatre



Thursday, May 11  
at 6:00 pm Grand Forks Central High School Theatre

### Childcare Available for Public Meetings



Scan QR code to RSVP for childcare



Project Info  
Tax Calculator  
FAQ

at [gfschools.org/may16](https://gfschools.org/may16)

### Additional Questions or Requests

Contact Cindy Johnson  
Email: [cjohnson260@mygfschools.org](mailto:cjohnson260@mygfschools.org) | Office: 701-787-4880

## Voting

**IN PERSON**  
Tuesday, May 16, 2023  
7:00 a.m. - 7:00 p.m.  
Alerus Center

### ABSENTEE BALLOT

Absentee voter applications are available from both Grand Forks County and Grand Forks Public School District and can also be found on our website at [gfschools.org/may16](https://gfschools.org/may16)

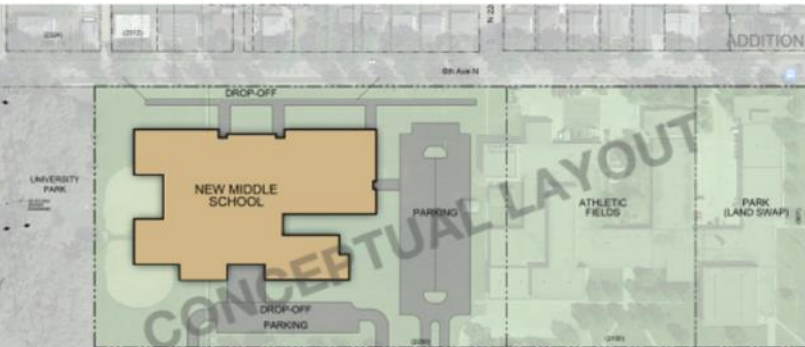

PROJECT INFO | TAX CALCULATOR [GFSCHOOLS.ORG/MAY16](https://gfschools.org/may16)

miro



# 10 Challenges

## Valley Middle School

**Air Quality:** The lack of fresh air circulation has decreased the air quality of the building.

**Electrical and Heating System:** Electrical system is at capacity and cannot support the additional capacity needed for modern learning technology. The heating (boiler) system is past its life expectancy.

**Restroom Maintenance:** Restrooms often need maintenance due to outdated plumbing.

**ADA Compliance:** Several areas such as doorway width, restrooms, and locker rooms throughout the building do not comply with the Americans with Disabilities Act (ADA) requirements.

**Undersized Spaces:** The cafeteria, general classrooms, and specialized classrooms such as science, career and technical education (CTE), music, art, and special education are undersized according to the North Dakota Department of Public Instruction (DPI). In total, the school is over 48,000 square feet smaller than what is recommended by the DPI.

**Valley Middle School Outdated Spaces:** Valley Middle School lacks the appropriate learning spaces. Lacks learning spaces to accommodate today's learning curriculum. Special Education Individuals with Disabilities Education Act (IDEA) was passed in 1975 adding 13 additional programming categories & medically fragile students.

**District Kitchen Location:** The location in a residential setting is inefficient for the loading & delivery needs of the District Kitchen. The current student pick up/drop off location and food truck access create a traffic safety issue.

**District Kitchen Systems:** Many systems need to be upgraded while other recently updated systems can be relocated to a new facility.

**Secure Entrances:** District schools lack physical controlled access secure entrances.

**Safety and Security:** There is need for updated mass notification systems, fire panels, and security cameras. All schools need ongoing emergency response plan updating and training.

FOR MORE INFORMATION, VISIT [GFSCHOOLS.ORG/MAY16](https://gfschools.org/may16)

Version 1.2  
miro

