



PROJECT UPDATE

AVONWORTH MIDDLE & HIGH SCHOOL

AGENDA

- Site Plan Approval
- Floor Plan Review
- Auditorium Scope
- Performing Arts Growth

ikm

07.19.2021

AVONWORTH SCHOOL DISTRICT

SITE PLAN APPROVAL



Option D

Parent Pickup Safety

- + 8 vehicle designated pick up lane (highlight in red) for safe pick up zone
- Three lanes of Parent que to maximize que length
- Egress circulation through West Lot or Campus Drive
- 16 pick up spaces at cellphone lot

Bus Zone

- + Sequencing bus first – 18 Double stacked parallel bus zone

Parking Summary:

- + Daily 264 spaces
- Events 336 spaces

- + Increase Size of Speed Table

- + Add turn lane at Joesph's Lane



Placemaking opportunities for:
Events areas, formal lawn, flag plazas, outdoor gathering, outdoor classroom

ADA Parking
Raised Crosswalk
Cellphone Spaces

Designated Drop/Pick up Zone

Bus Drop Off

Queuing

West Lot

South Lot

Placemaking Opportunity:
Outdoor Classroom

Option D

Circulation

- Parent Drop Off
- Bus Loop
- Pedestrian

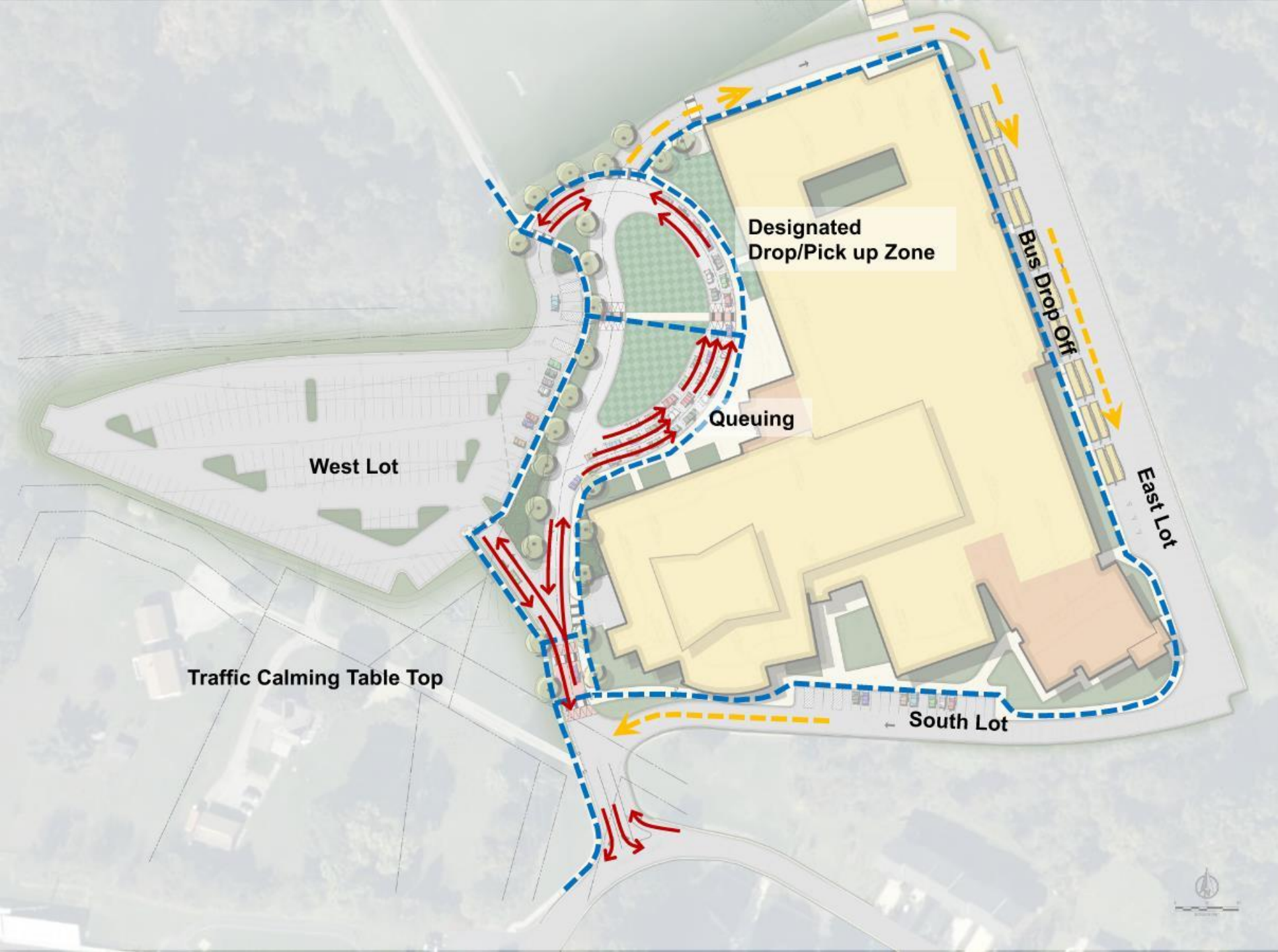

FLOOR PLAN REVIEW









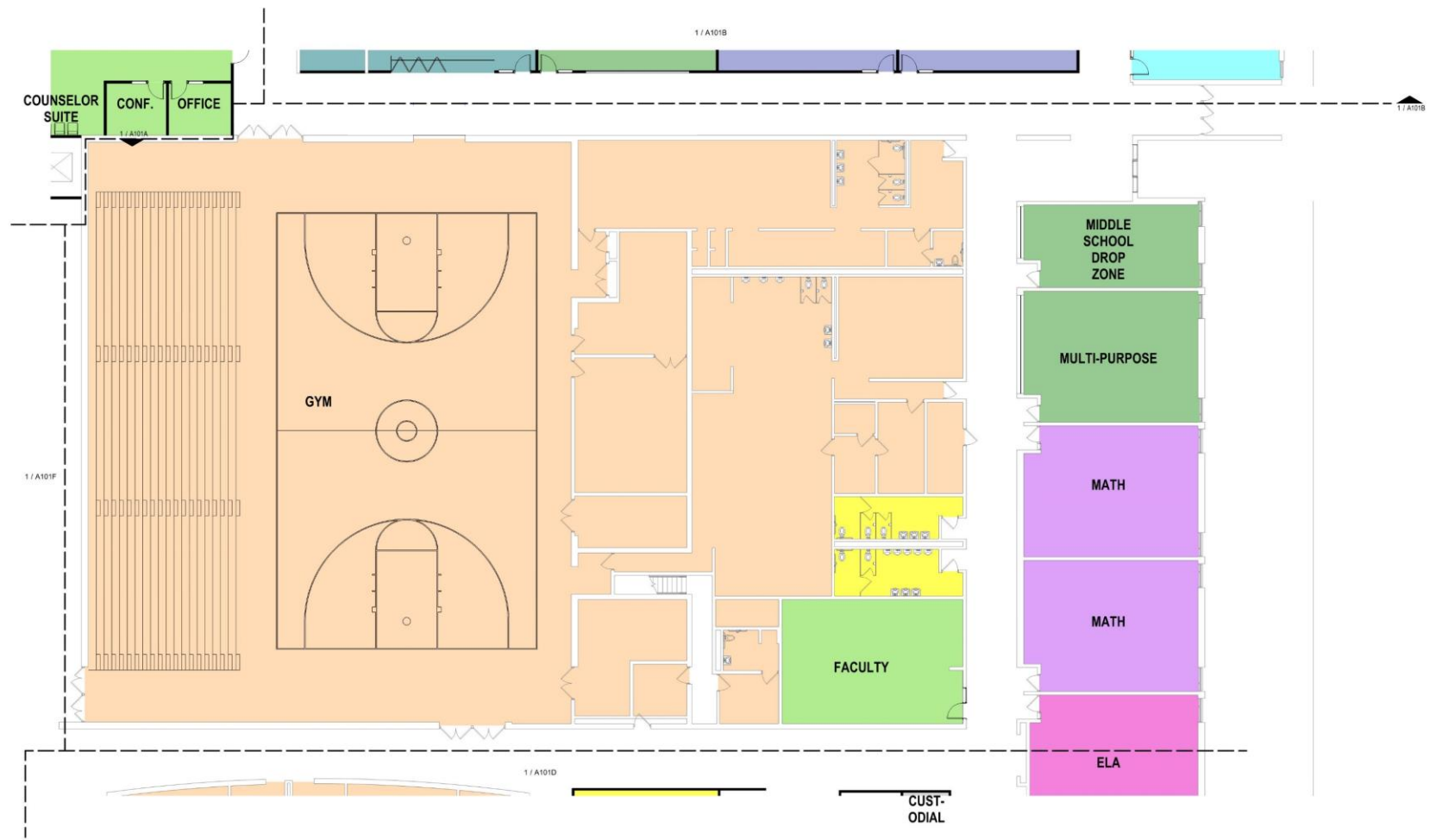

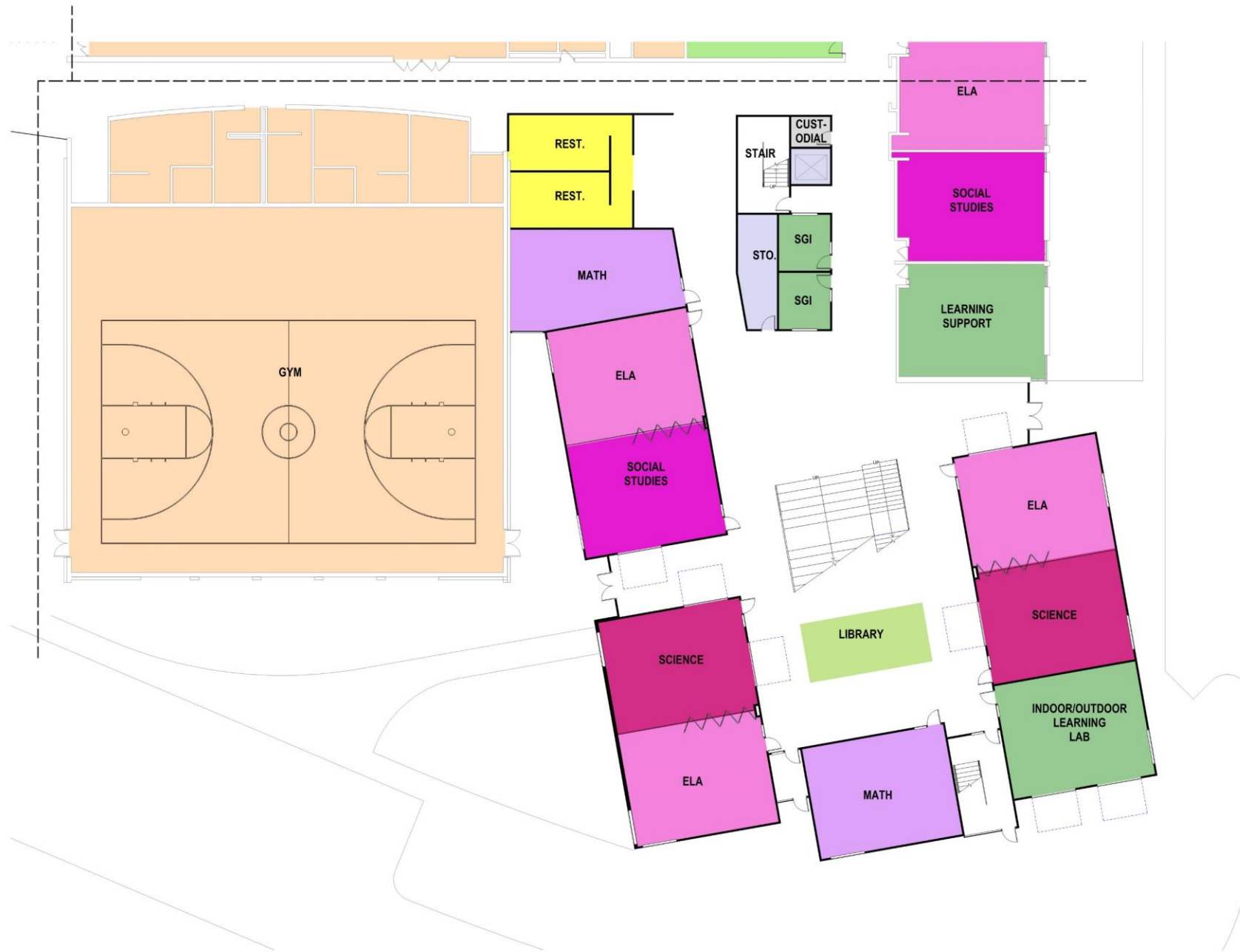



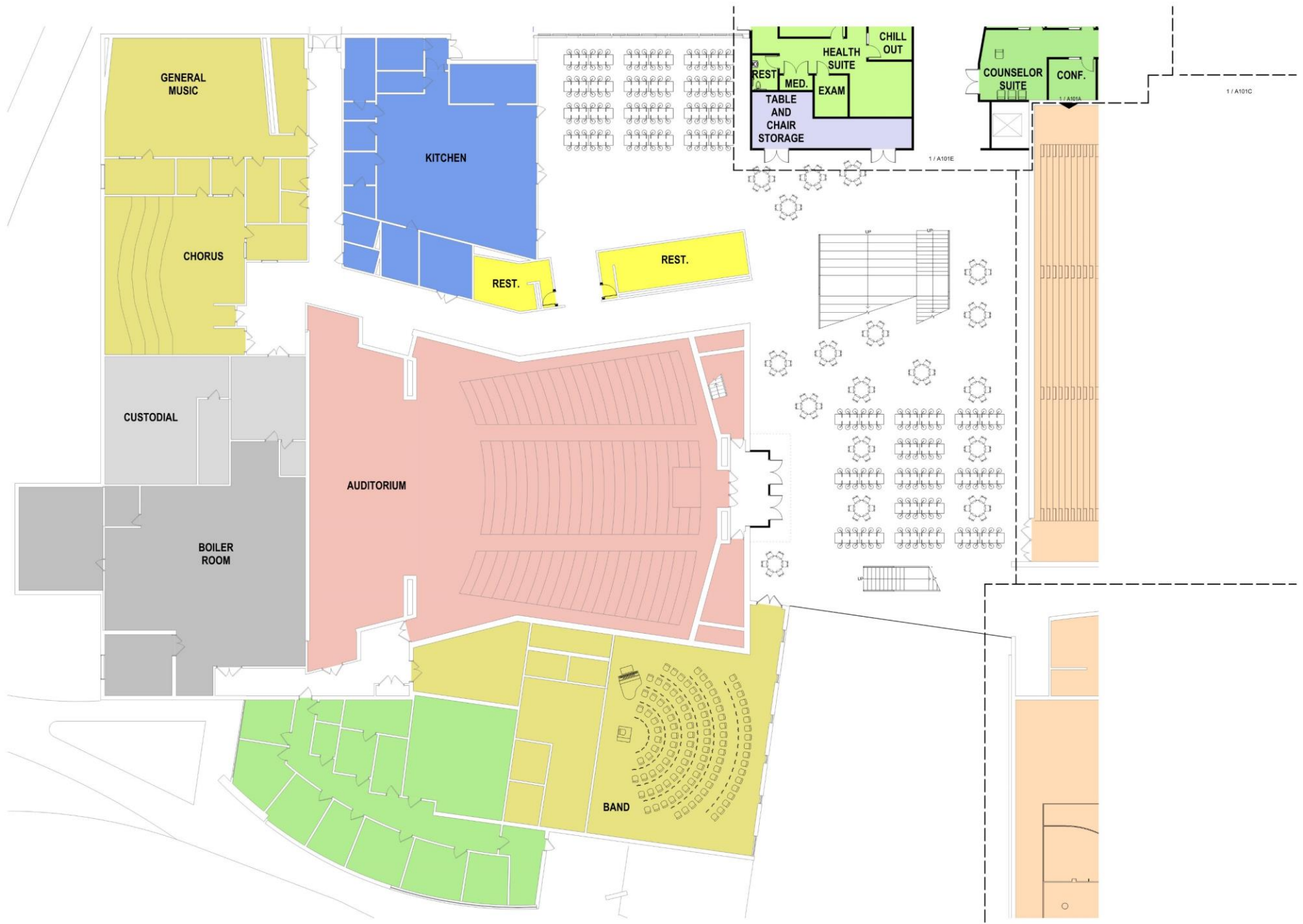

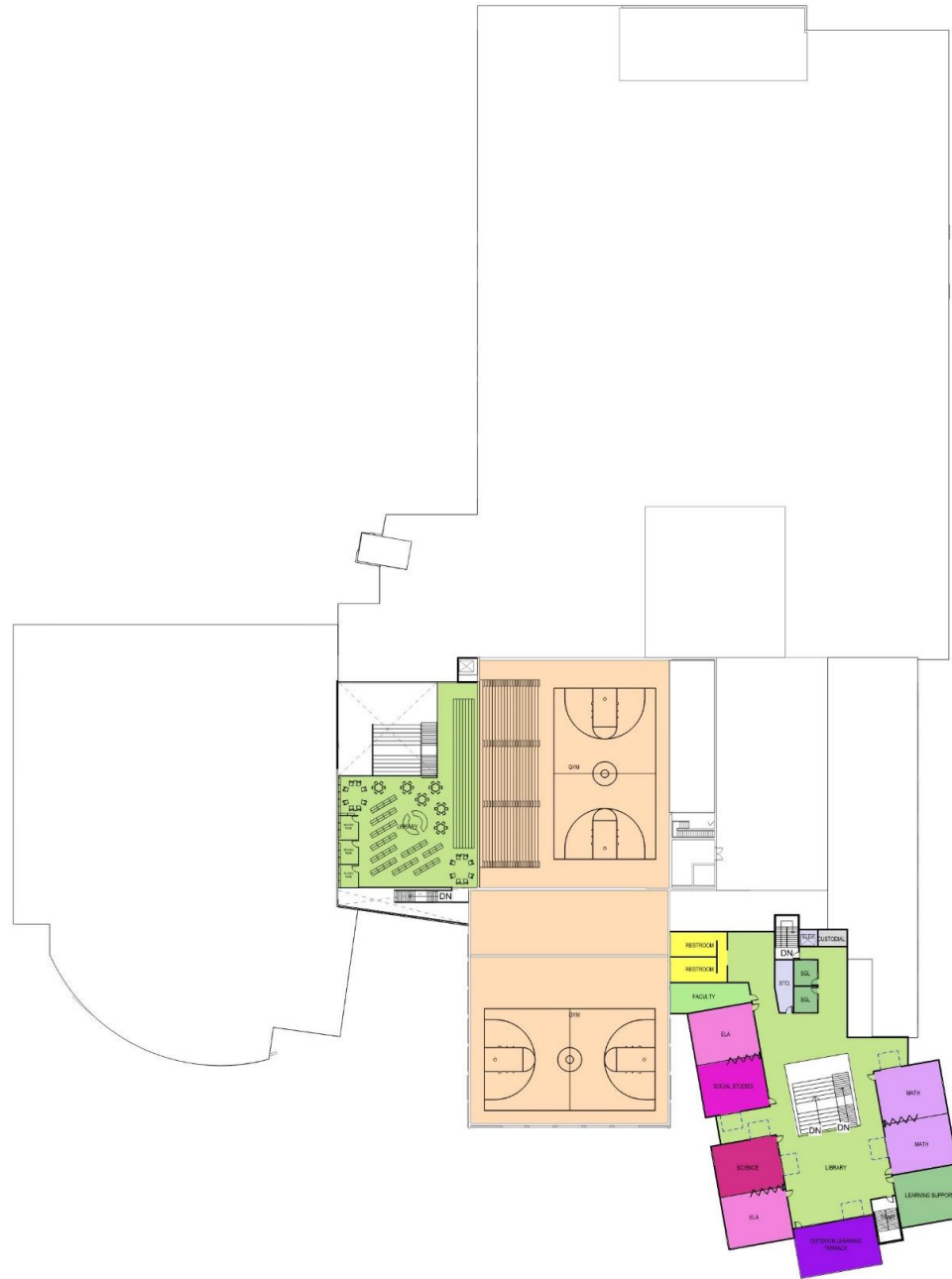

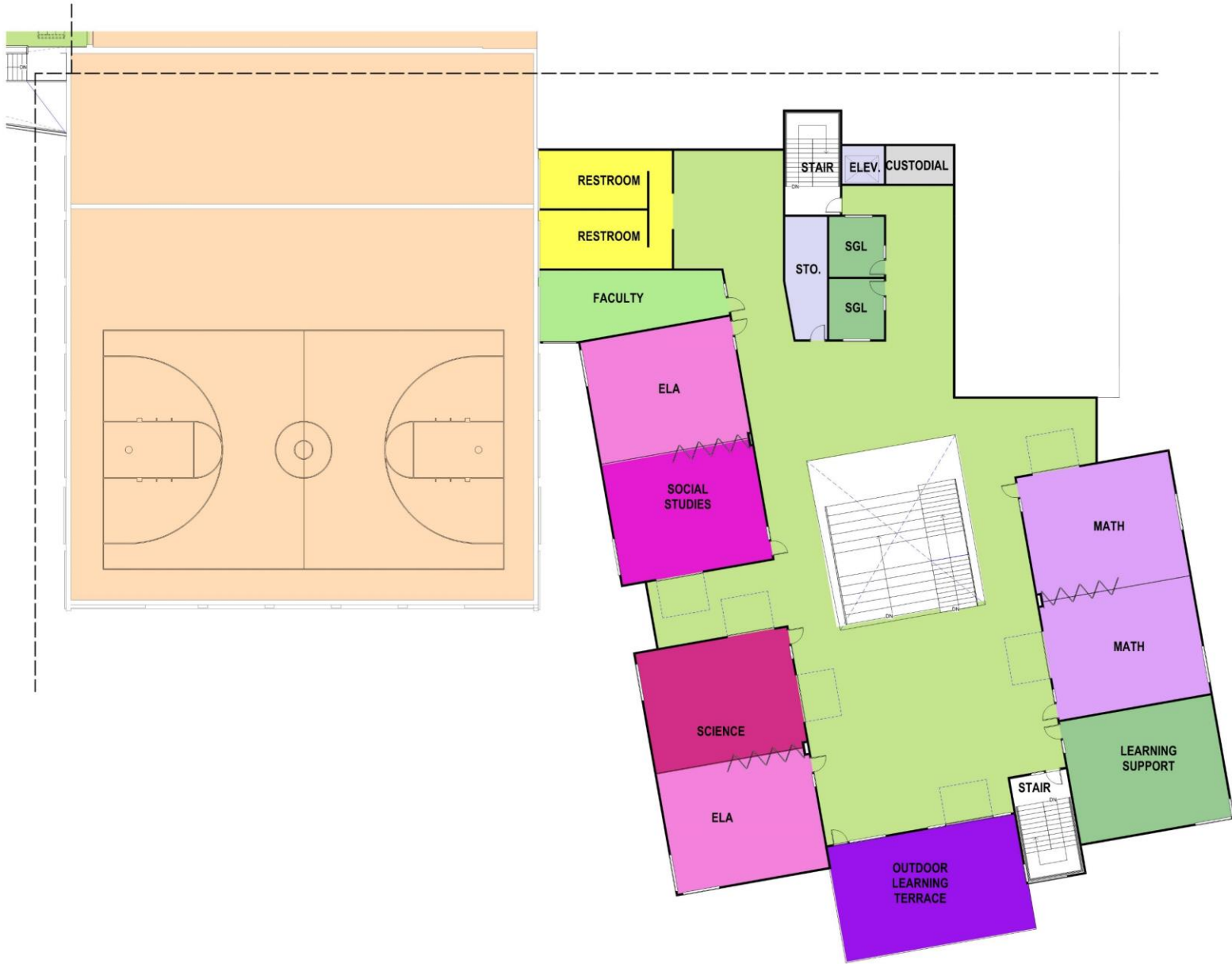

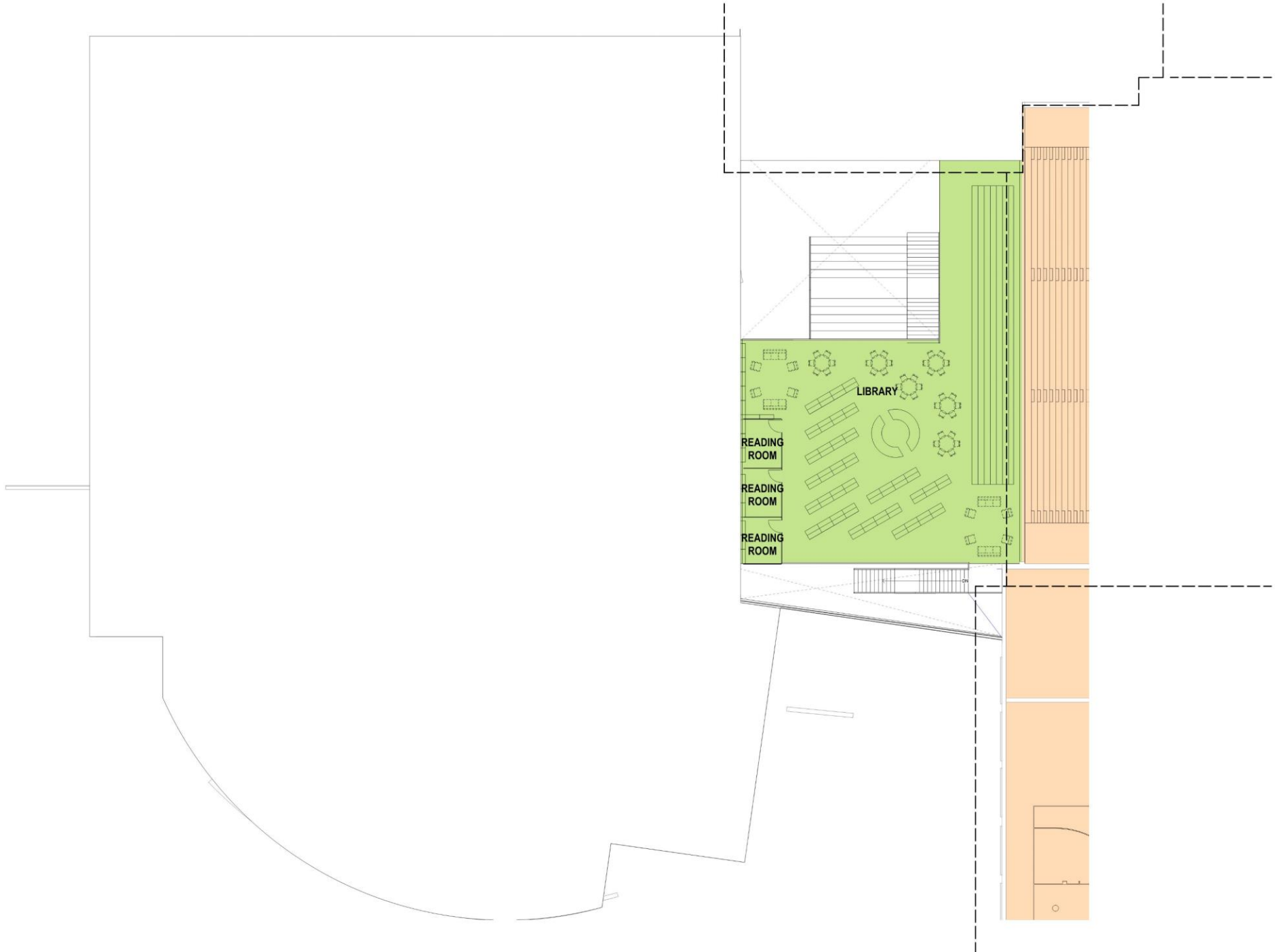

CAPACITY ANALYSIS

Classrooms		
HS Classroom.....	30	32
MS Classroom.....	22	YES
Special Education.....	2.5	YES
HS Science Classroom.....	4	6
Learning Commons.....	2	YES
Small Group Instruction (4)	2	YES
Student Resources		
Library.....	1	YES
Applied Engineering Lab.....	1	YES
Large Group Instruction.....	1	YES
TV Studio.....	1	NO
Maker Lab.....	1	YES
Home Economics.....	1	YES
Small Group Instruction (4)	2	YES
Learning Stair.....	1	2
Fine Arts		
Graphics Lab.....	2	YES
Art Work.....	1	YES
Art Lecture.....	1	YES
Performing Arts		
Band Room.....	1	YES
Choir.....	1	YES
General Music.....	1	YES
Stage.....	1	YES
Physical Education		
Main Gymnasium.....	2	YES
Auxiliary Gymnasium.....	1	YES
<hr/>		
TOTAL TEACHING STATIONS.....	82.5	87.5
CAPACITY ANALYSIS:		
(87.5) Teaching Stations x (25) Students/Station.....	2062 Students	2187.5
<hr/>		
2187.5 Students x Utilization Rate of 60%.....	1237 Students	1312
2187.5 Students x Utilization Rate of 67%.....	1381 Students	1465

AUDITORIUM SCOPE



Lighting System and Fixture migration to LED	\$275,000
Front of house lighting hoist	\$150,000
Rigging Safety upgrade	\$40,000
Rigging Line Sets	\$65,000
Draperies	\$100,000
Thrust Stage	\$75,000
House Lighting	\$75,000
Seating	\$135,000
Flooring	\$70,000
Stage Floor	\$65,000
Sound System	\$150,000
<u>Acoustic Wall Treatment</u>	<u>\$100,000</u>
Total	\$1,300,000

PERFORMING ARTS GROWTH



Current Band Enrollment by Grade

	High School Band		7 th & 8 th Grade Band		6 th Grade Band
9	25	7	35	6	60
10	25	8	50		
11	19				
12	10				
TOTAL	79		85		60

Performing Arts Space Allocation

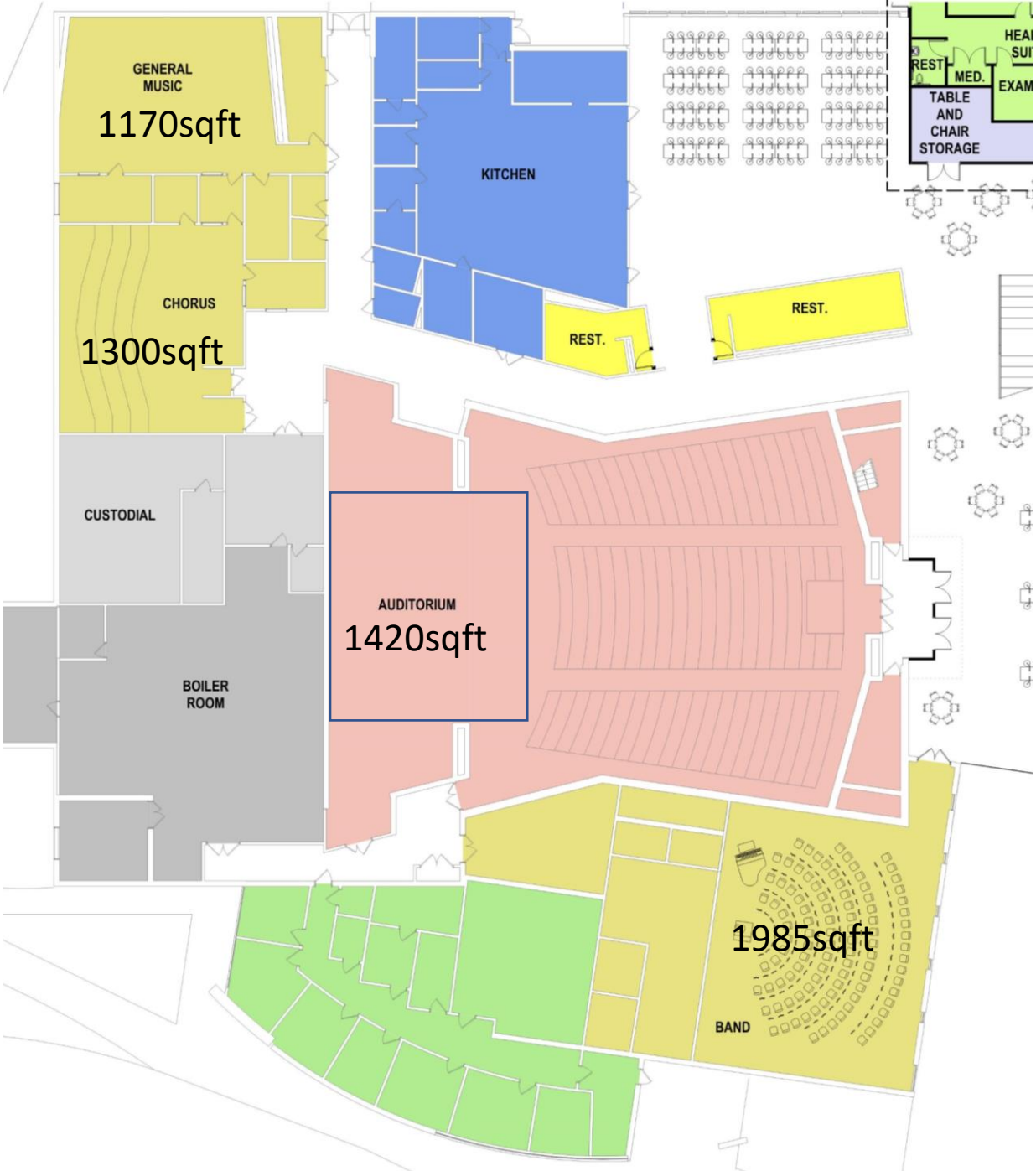

Occupancy Performing Arts Space

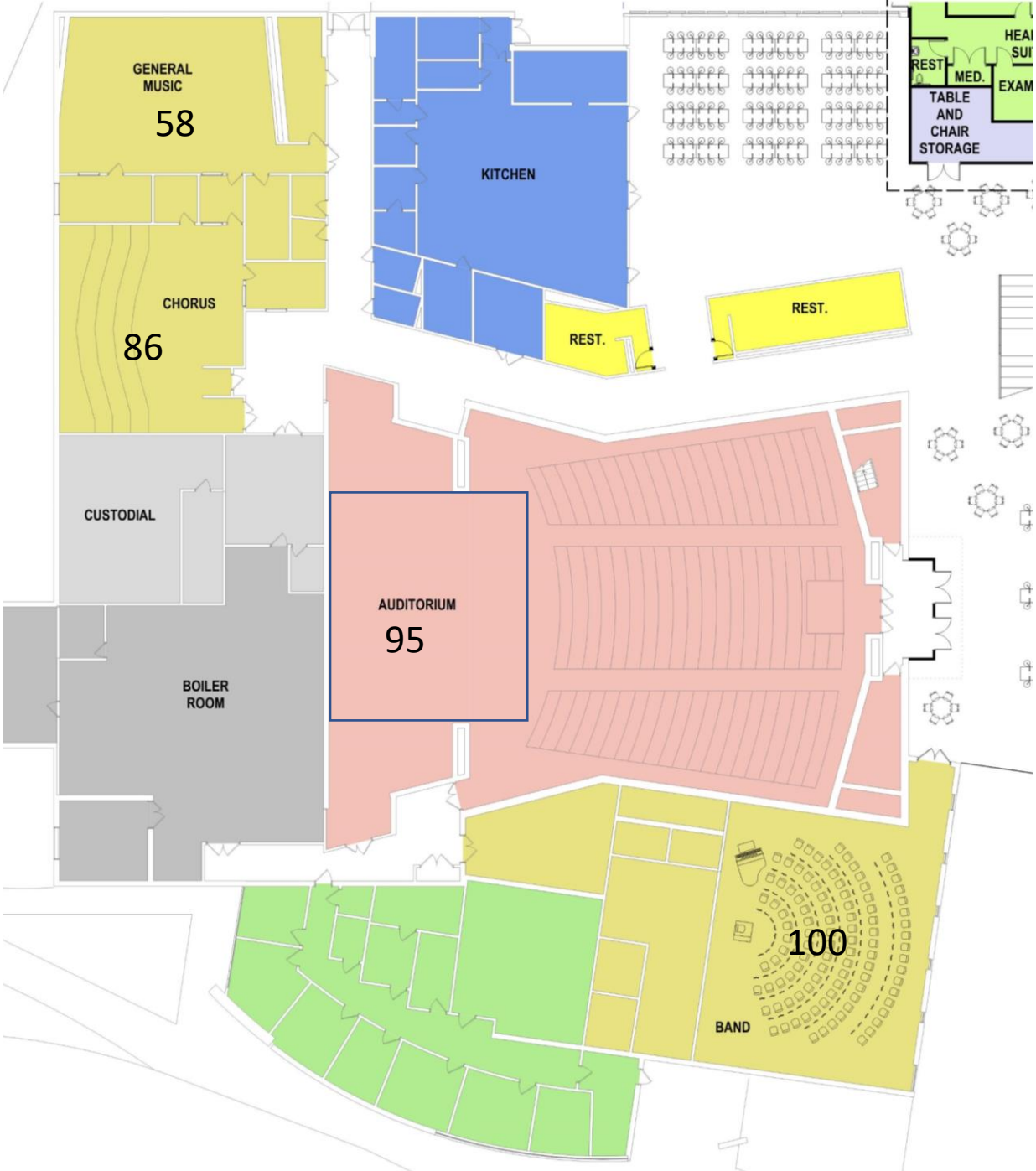



MS/HS Additions & Renovations project schedule

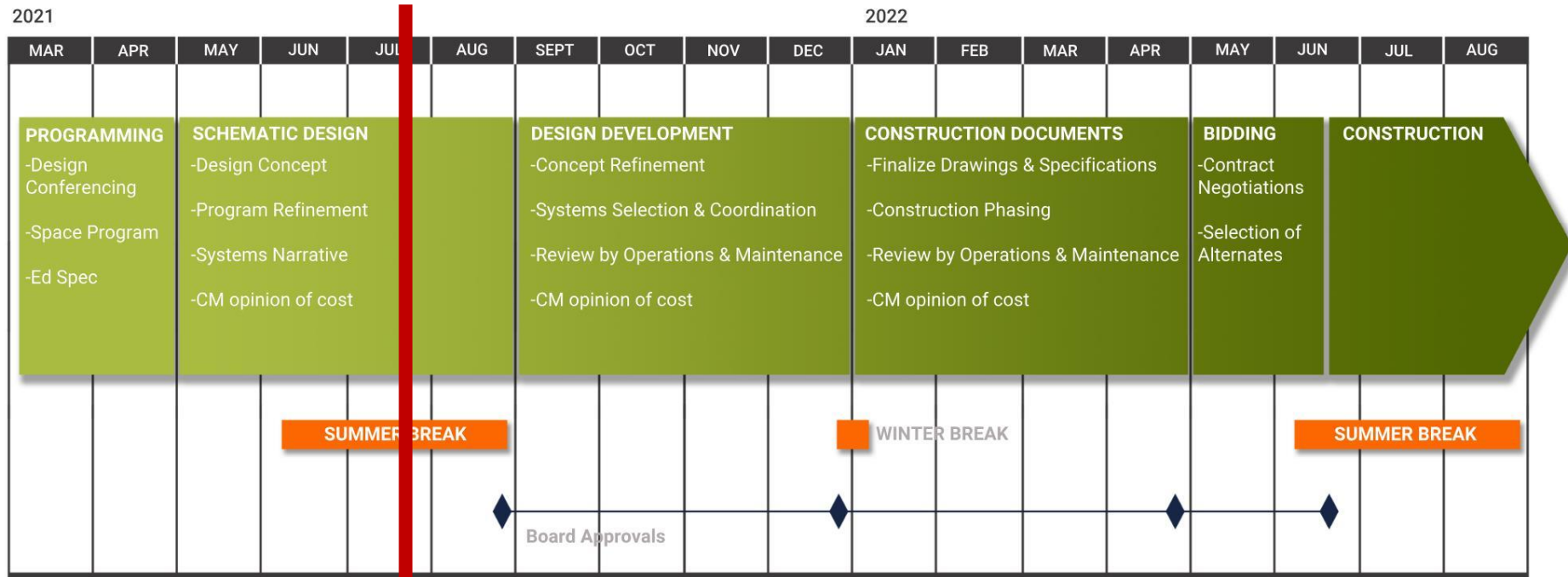

07.19.2021

ikm