



**PVSD FACILITIES MASTER PLAN:  
SCHOOL DISTRICT  
COMMUNITY OUTREACH  
MEETING**

**PORTOLA VALLEY SCHOOL DISTRICT**

**MARCH 28, 2017**

**CODY ANDERSON WASNEY**

**ARCHITECTS**



An aerial photograph of a lush, green valley. The landscape is dominated by dense forests covering rolling hills. A river winds through the valley, and a large lake is visible on the right side. The overall scene is peaceful and scenic, with various shades of green and brown from the trees and fields.

**PORTOLA VALLEY SCHOOL DISTRICT**

**THANK YOU FOR PARTICIPATING IN OUR INPUT**

**PARTICIPANTS:**

- ERIC HARTWIG, SUPERINTENDENT
- JONATHAN BARTH, CHIEF BUSINESS OFFICIAL
- CYNDI MAIJALA, PRINCIPAL CORTE MADERA SCHOOL
- LYNETTE HOVELAND, PRINCIPAL ORMONDALE SCHOOL
  
- BRENT MCCLURE, CAW ARCHITECTS
- SARAH VACCARO, CAW ARCHITECTS



A group of children are playing soccer on a large, green grassy field. In the background, there are several soccer goals and a dense line of trees under a blue sky with scattered white clouds. The scene is bright and active, with children in various colored shirts running and playing.

## **WHY IS PVSD EMBARKING ON A FACILITIES MASTER PLAN AT THIS TIME?**

- **LAST FACILITIES UPDATE WAS IN 2002**
- **EDUCATION AND WORKPLACES ARE CHANGING (EX. STEM, DESIGN, MAKER, COLLABORATION)**
- **HIGH QUALITY LEARNING ENVIRONMENT AND HIGH ACHIEVEMENT ARE LINKED**



A large, leafy tree in the foreground of a school courtyard with a building and a fountain in the background.

**WE ARE SEEKING INPUT AND PRIORITIES FROM  
THE COMMUNITY ON HOW TO KEEP PVSD  
SCHOOLS AS TOP SCHOOLS IN THE AREA**

- **FROM TEACHERS**
- **FROM STUDENTS**
- **FROM PARENTS**
- **FROM COMMUNITY MEMBERS**



# OUR EXPERIENCE





The background of the image is a whiteboard covered with numerous colorful sticky notes in shades of yellow, pink, and light blue. The notes are arranged in a somewhat organized manner, suggesting a planning or brainstorming session. The text is overlaid on this background in a large, bold, black, sans-serif font.

**FACILITIES MASTER  
PLAN OVERVIEW:  
PROCESS & SCHEDULE**



# WHAT IS A LONG RANGE FACILITIES MASTER PLAN?

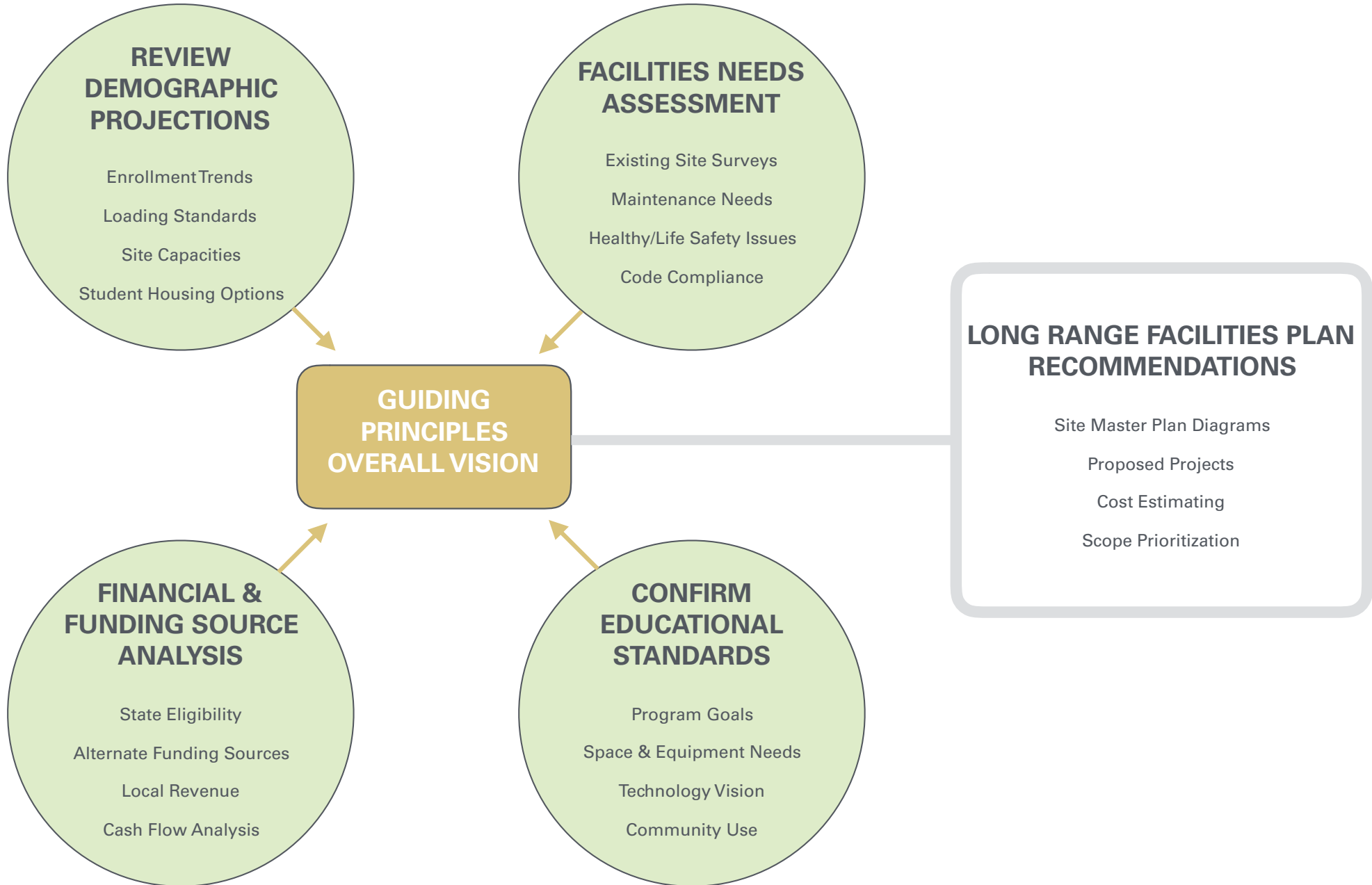



# WHY IS IT IMPORTANT?

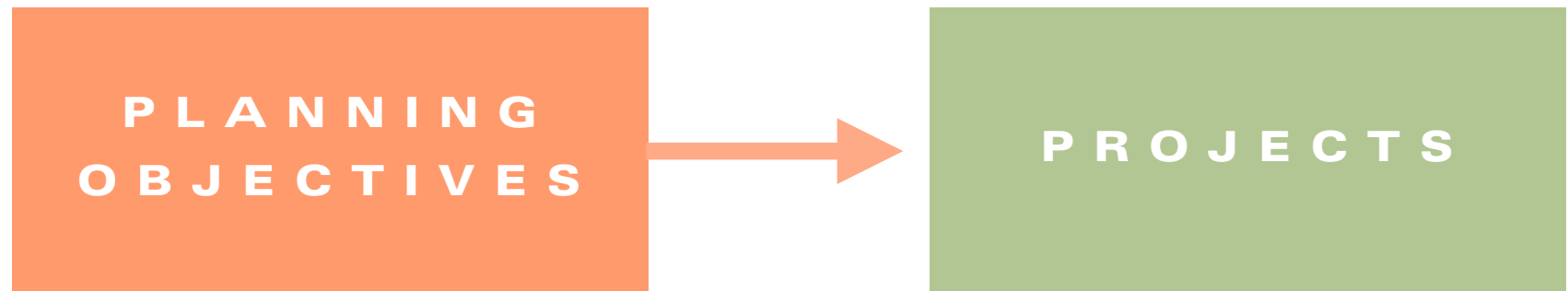
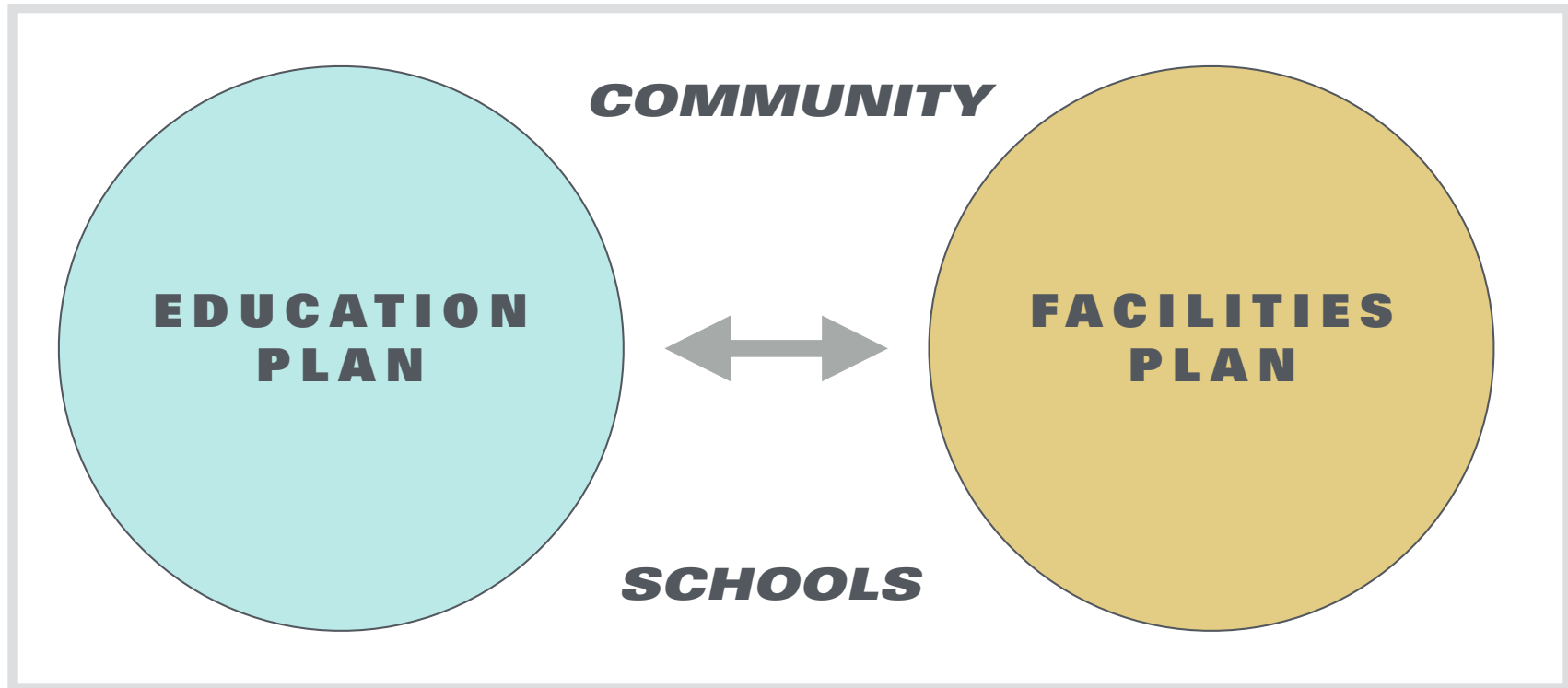



# WORKPLAN & SCHEDULE

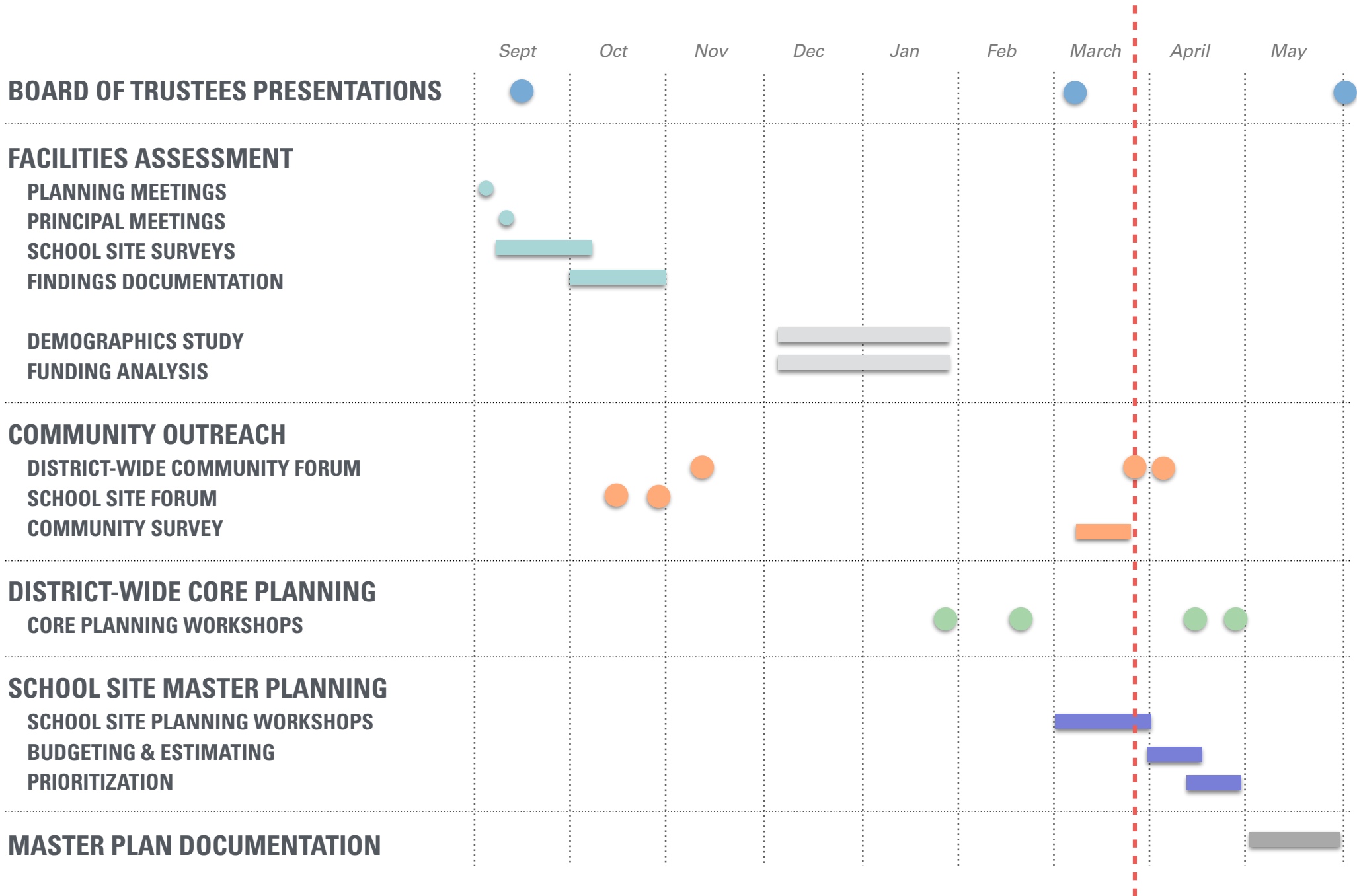





# EXISTING FACILITIES OVERVIEW & ANALYSIS



# ORMONDALE CAMPUS - OVERVIEW





# ORMONDALE CAMPUS - OVERVIEW

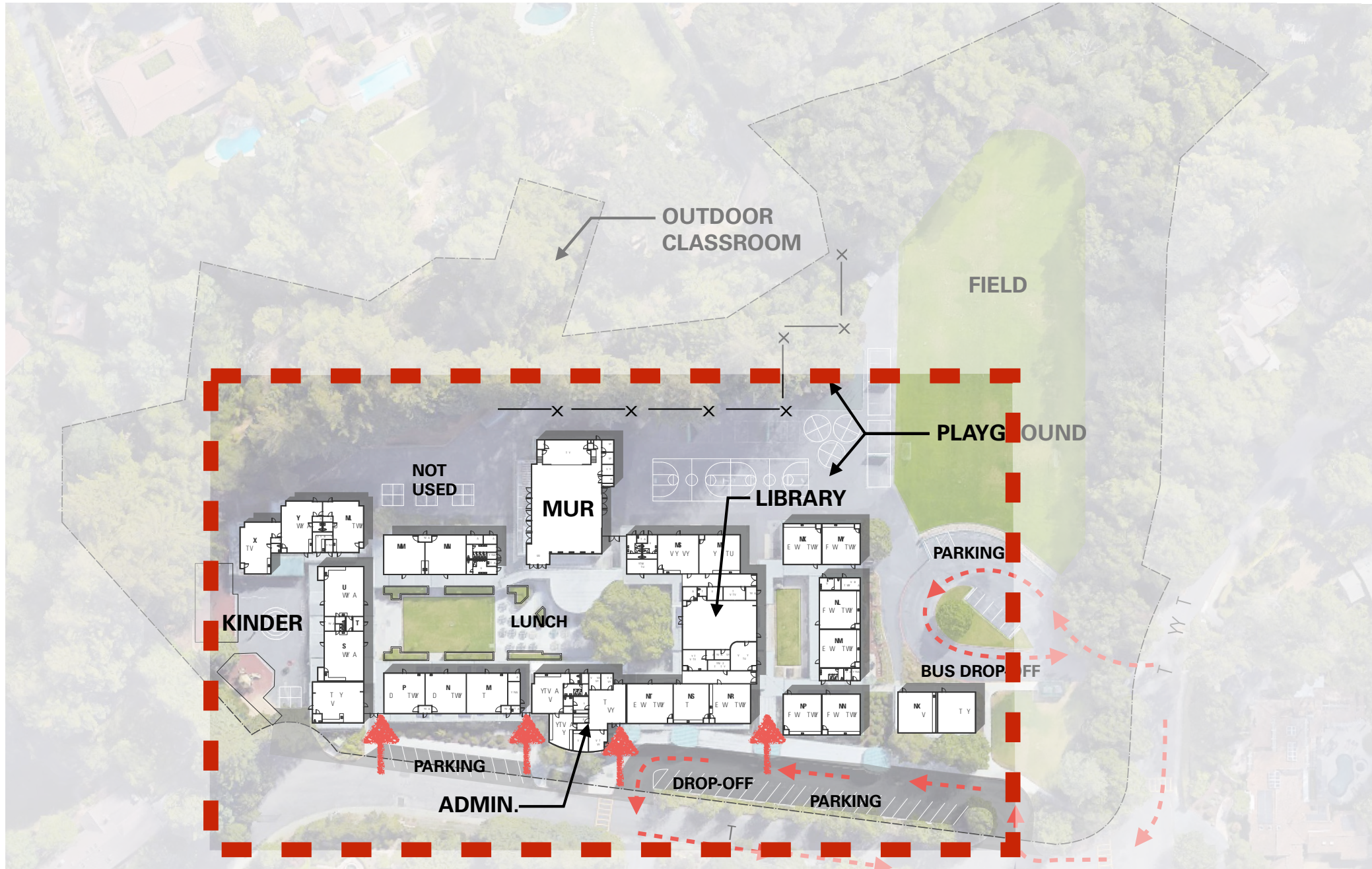



# ORMONDALE CAMPUS - CAMPUS HISTORY

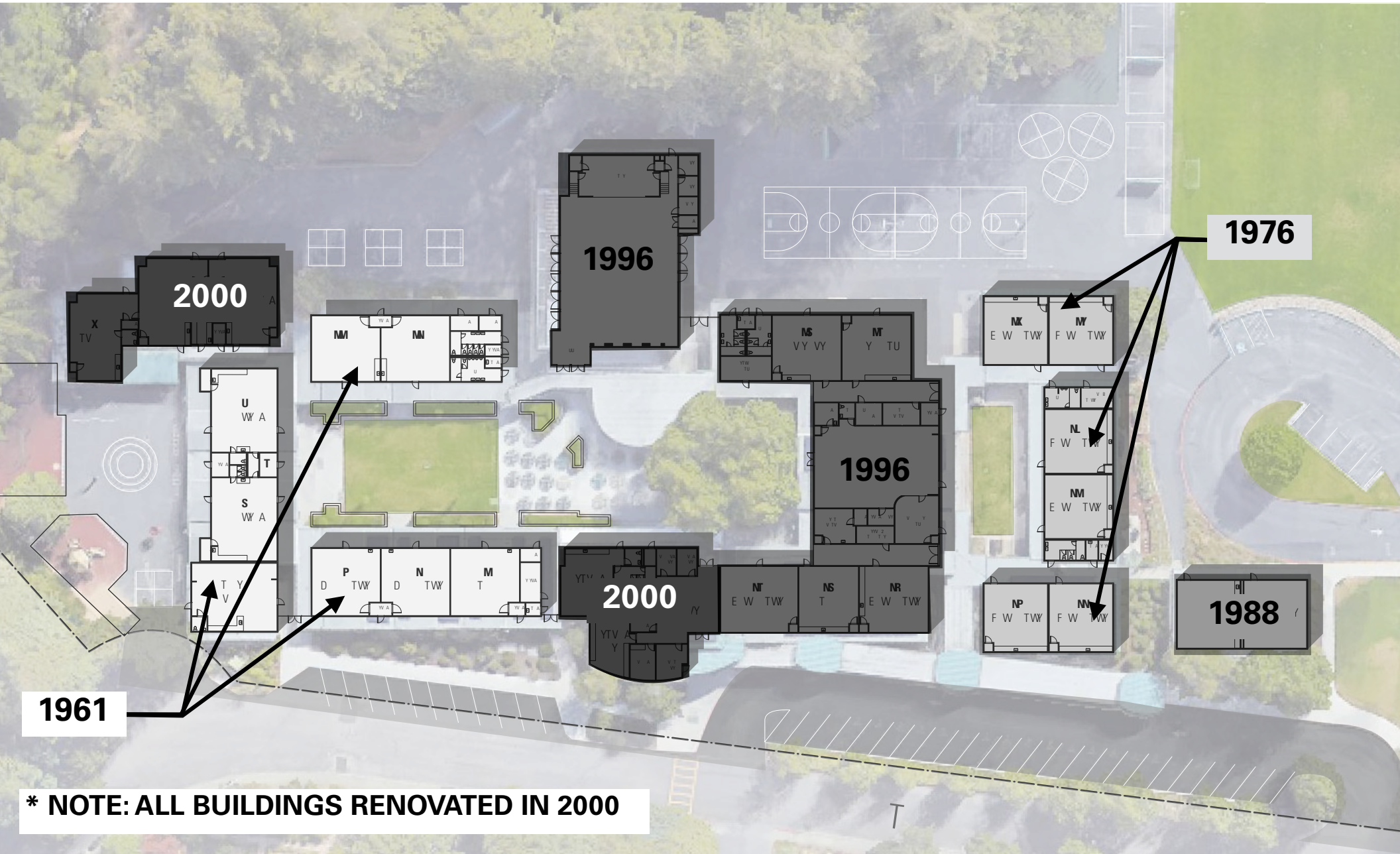

**\* NOTE: ALL BUILDINGS RENOVATED IN 2000**



# ORMONDALE CAMPUS - EDUCATIONAL PROGRAMS





# ORMONDALE CAMPUS - GRADE ZONES

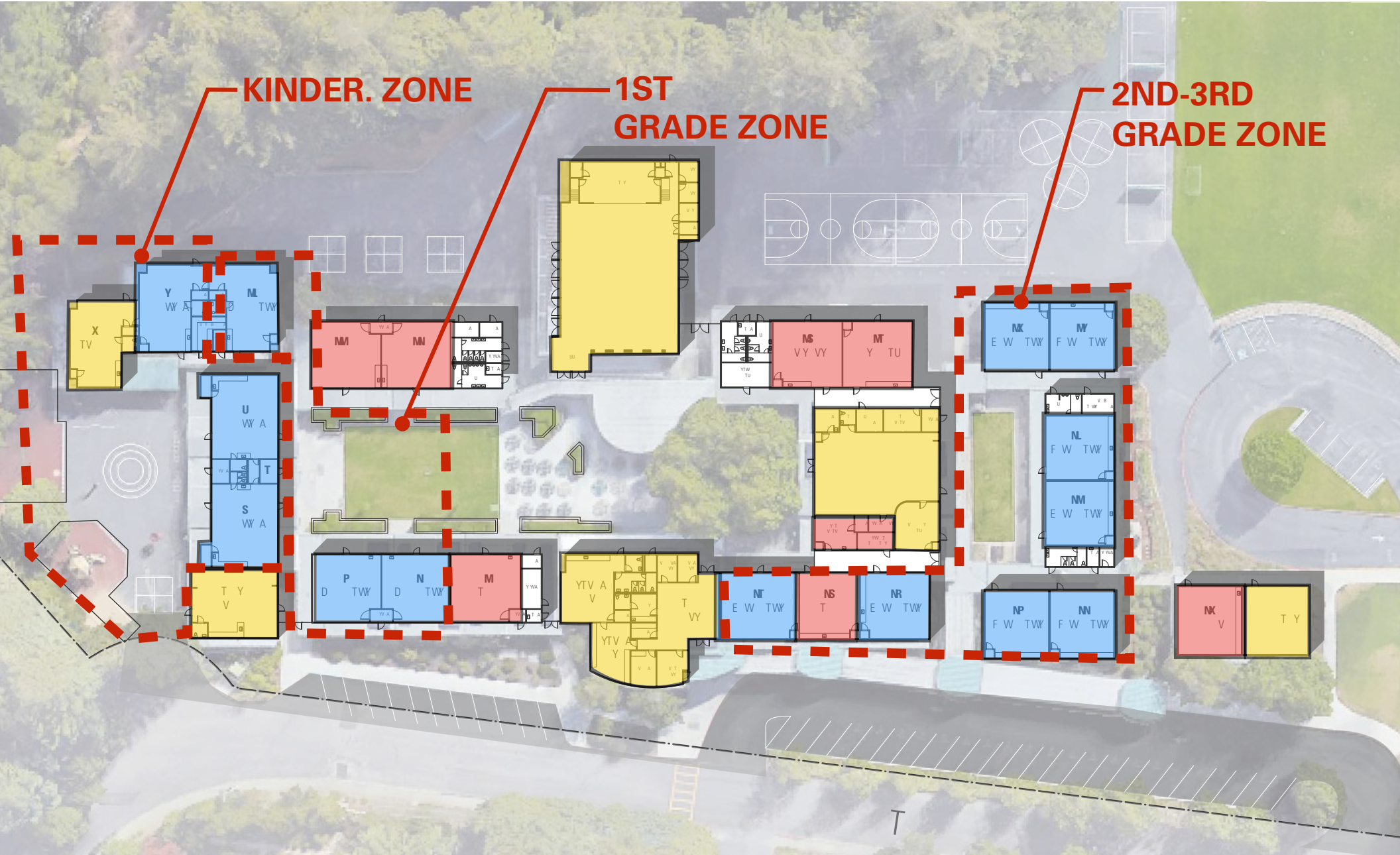



# MAIN ENTRANCE - ORMONDALE





# MAIN COURTYARD - ORMONDALE





# MAKER SPACE - ORMONDALE





# MULTI-USE ROOM (MUR) - ORMONDALE





# OUTDOOR PLAY SPACES - ORMONDALE

---





# CORTE MADERA CAMPUS - OVERVIEW





# CORTE MADERA CAMPUS - OVERVIEW





# CORTE MADERA CAMPUS - CAMPUS HISTORY

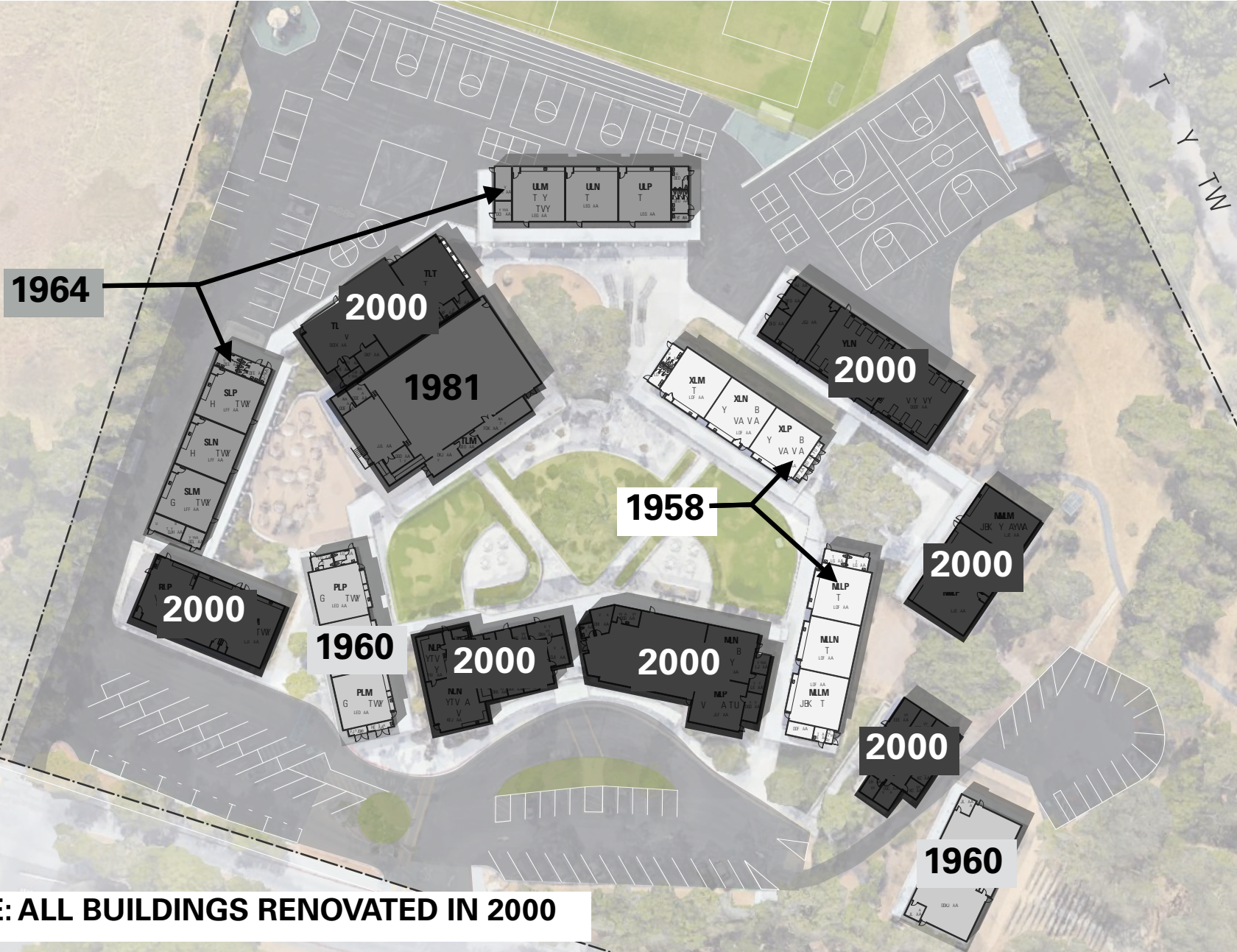

**\* NOTE: ALL BUILDINGS RENOVATED IN 2000**



# CORTE MADERA CAMPUS - EDUCATIONAL PROGRAMS

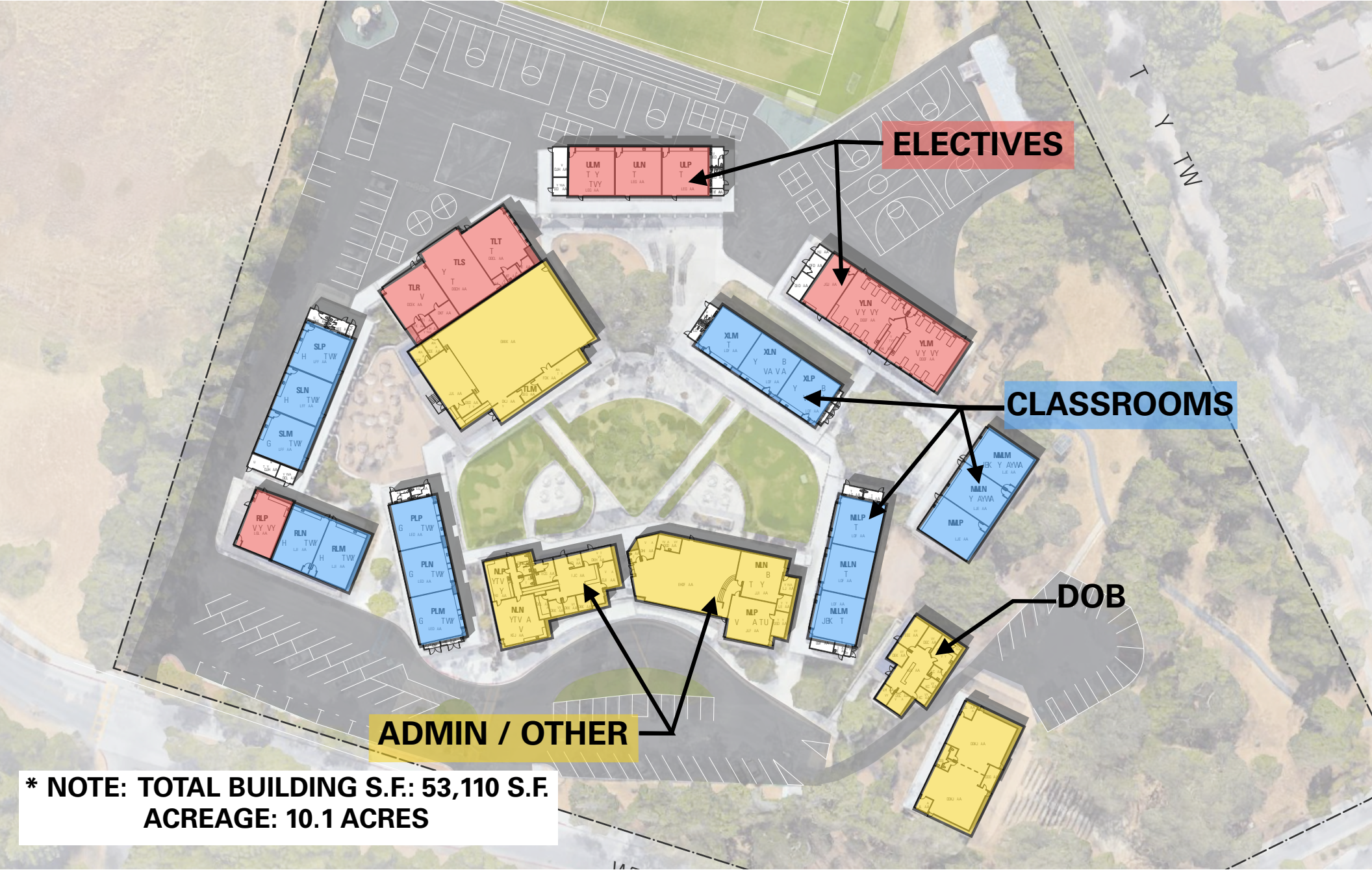



# CORTE MADERA CAMPUS - GRADE ZONES





# MAIN ENTRANCE - CORTE MADERA





# LUNCH AREA - CORTE MADERA





# SCIENCE CLASSROOM - CORTE MADERA





# MULTI-USE ROOM (MUR) - CORTE MADERA





# OUTDOOR PLAY SPACES - CORTE MADERA





# ANNEX - CORTE MADERA







EMERGING THEMES,  
IDEAS AND AREAS  
FOR IMPROVEMENT



# INPUT: INITIAL COMMUNITY OUTREACH MEETINGS

---

## School Site Community Outreach:

Ormondale Community: October 18th

Corte Madera Community: October 26th

PVSD Community: November 2nd

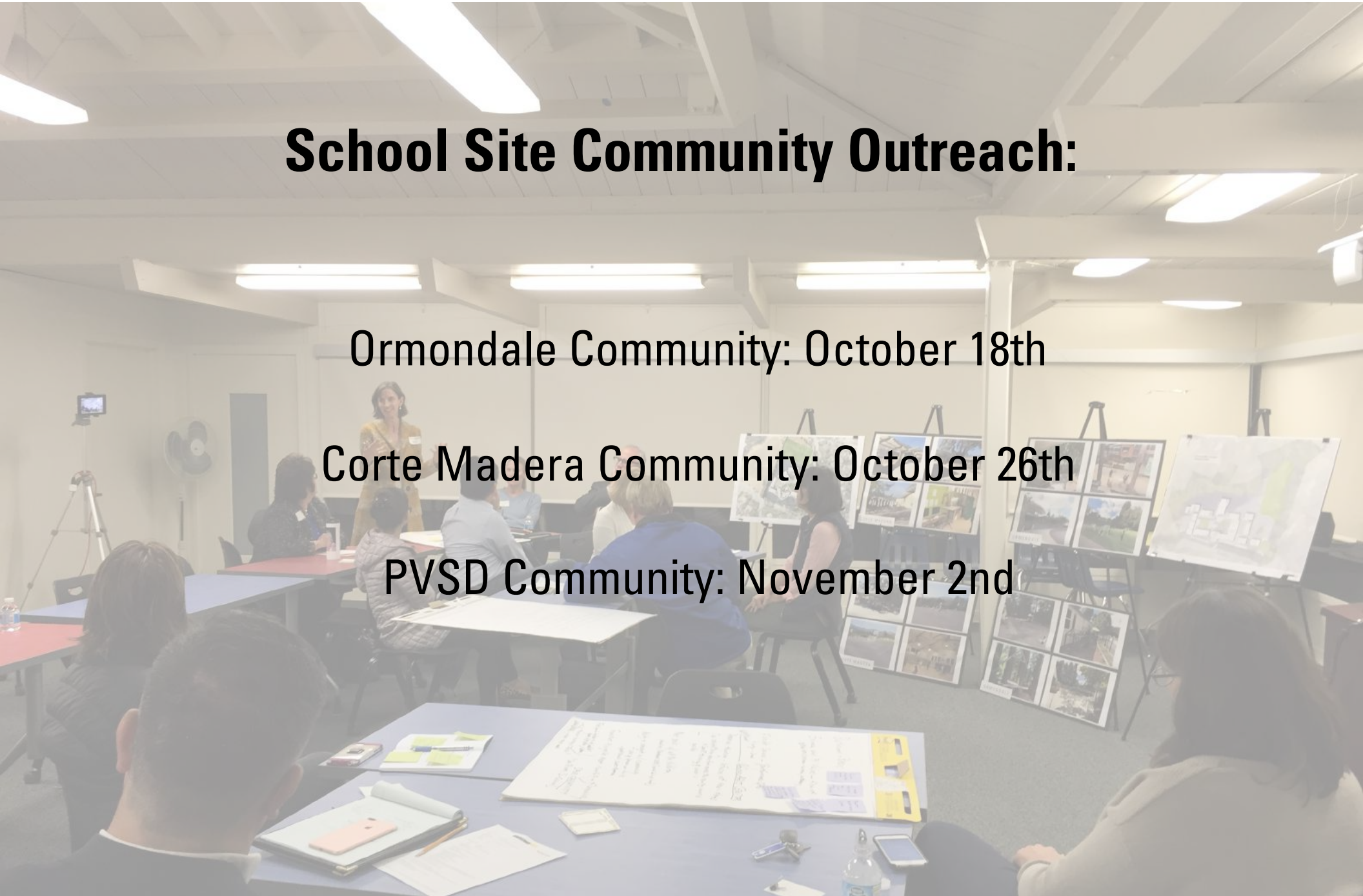



# INPUT: DISTRICT-WIDE PLANNING WORKSHOPS

## **District-Wide Planning Committee:** Teachers, Principals, Administration, Parents, Board Members

Workshop #1: January 31st

Workshop #2: March 2nd

Workshop #3: April 25th

Workshop #4: TBD



# INPUT: INITIAL COMMUNITY OUTREACH MEETINGS

---

## CLASSROOMS

CONNECT TO OUTDOORS

BREAKOUT SPACES

MAKER SPACE: CONNECT TO ART AND SCIENCE

IMPROVE ART, MUSIC & SCIENCE CLASSROOMS

## OUTDOOR SPACES

IMPROVE OUTDOOR PLAY/FUN EXPERIENCES

BETTER GROUP AND INDIVIDUAL SPACES

IMPROVE OUTDOOR CLASSROOM RESOURCES

## COMMUNITY SPACES

NEED FULL SIZE GYMNASIUM

FLEXIBLE & DEDICATED PERFORMING ARTS SPACE

CREATE A STUDENT/COMMUNITY COLLABORATION SPACE

## CAMPUS

INCREASE SECURITY, PERIMETER EDGE

UPDATE SCHOOL & DISTRICT SIGNAGE

IDENTITY FOR 4TH-5TH GRADE ZONE AT CMS



# FACILITY MASTER PLAN GUIDING PRINCIPLES

---

## Kids' learning comes first:

- A**
- STUDENT CENTERED
  - "CORE-EDUCATION" IS TOP PRIORITY
  - A PLACE FOR EVERY KID; INCREASE STUDENTS OPPORTUNITY TO FIND THEIR "SPARK"

## Consistent with Portola Valley aesthetic:

- B**
- CELEBRATE THE RURAL NATURE OF PORTOLA VALLEY THROUGH INDOOR/OUTDOOR CONNECTIONS
  - DESIGN SPACES USING SUSTAINABLE, DURABLE BUILDING MATERIALS

## Cultivate strong community relations:

- C**
- CREATE A COMMUNITY HUB FOR SCHOOL, DISTRICT, AND PUBLIC GROUPS; FACILITIES AVAILABLE FOR PUBLIC EVENTS AS WELL
  - PORTOLA VALLEY WANTS TO BE RELEVANT & COMPETITIVE, BUT DOESN'T NEED TO OUTSHINE IT'S NEIGHBORING DISTRICTS



# FACILITY MASTER PLAN GUIDING PRINCIPLES

---

## Create an adaptable campus:

**D**

- DESIGN FLEXIBLE LEARNING ENVIRONMENTS THAT ARE ABLE TO SUPPORT EDUCATION AS IT EVOLVES
- GENERATE SPACES THAT CAN BE EASILY SCALED TO SUPPORT FUTURE PROGRAM CHANGES AND DEMOGRAPHIC BUBBLES

## Improve Campus Safety & Security:

**E**

- PROVIDE EACH SCHOOL WITH THE ABILITY TO SECURELY LOCKDOWN CORE OF CAMPUS
- PROMOTE A BALANCE BETWEEN OPENNESS OF INDOOR / OUTDOOR CONNECTION VS. SAFETY ON CAMPUS



## PRELIMINARY COMMUNITY SURVEY FINDINGS

---

NEED FOR FACILITY IMPROVEMENTS?

**61%**

**SOME NEED FOR  
IMPROVEMENTS**

IMPORTANT TO EVALUATE GRADE  
LEVEL CONFIGURATION BETWEEN  
ORMONDALE AND CORTE MADERA?

**55%**

**IMPORTANT TO  
EVALUATE**



## **EMERGING THEMES - FOR BOTH CAMPUSES:**

---

- **MODERNIZING AND UPDATING TECHNOLOGY IN CLASSROOMS TO CREATE STATE-OF-THE ART TEACHING SPACES.**
- **MODERNIZING AND UPDATING CLASSROOMS TO CREATE FLEXIBILITY, CONNECTIONS TO BREAK-OUT SPACES, AND CONNECTIONS TO OUTDOOR EDUCATIONAL SPACES.**
- **IMPROVING OUTDOOR LEARNING SPACES TO BETTER SUPPORT EDUCATIONAL PROGRAMS.**
- **CREATING A LARGER, MORE CENTRALLY LOCATED MAKER SPACE / CREATIVITY LAB SPACE.**



## **EMERGING THEMES - FOR BOTH CAMPUSES:**

---

- **CREATING A LARGER, MORE CENTRALLY LOCATED GARDEN SPACE**
- **IMPROVE FENCING AND GATES TO CREATE A SECURE CAMPUS PERIMETER.**
- **IMPROVE SAFETY AT NIGHT (IE: IMPROVE SITE LIGHTING AND SECURITY).**
- **IMPROVE PARKING, PICK-UP AND DROP-OFF CIRCULATION.**
- **IMPROVING GENERAL INFRASTRUCTURE SUCH AS BATHROOMS, HEATING, LIGHTING, AND DRAINAGE.**



## **EMERGING THEMES - FOR ORMONDALE:**

---

- **CREATE AN OUTDOOR GATHERING SPACE (IE: OUTDOOR AMPHITHEATER).**



## **EMERGING THEMES - FOR CORTE MADERA:**

---

- **PROVIDE (EXPAND OR BUILD A NEW) MULTI-USE SPACE FOR PERFORMANCES AND LARGER MEETINGS.**
- **PROVIDE (EXPAND OR BUILD A NEW) MULTI-USE SPACE FOR PERFORMANCES AND LARGER MEETINGS.**
- **REPAIR AND UPGRADE SOCCER FIELD FOR ATHLETIC AND COMMUNITY PROGRAMS.**
- **REPAIR, UPGRADE AND/OR RELOCATE THE OUTDOOR AMPHITHEATER (CURRENTLY IN DISREPAIR).**



# WILKES ELEMENTARY SCHOOL - MAHLUM





# WILKES ELEMENTARY SCHOOL - MAHLUM

---





# COMMON GROUND HIGH SCHOOL





# INDIAN SPRINGS SCHOOL - LAKE FLATO





NAME??





# BOOKER T. WASHINGTON STEM ACADEMY - CANNON DESIGN





# PRITZKER SCIENCE CENTER - XXX





# SEQUOIA HIGH SCHOOL - XXX





# GYMNASIUM - HUNTER'S POINT CAMPUS



**SCHOOL THEATER:**  
FIXED TIERED SEATING (350 SEATS), STAGE AND PROSCENIUM



# BOOKER T. WASHINGTON STEM ACADEMY - CANNON DESIGN





# GYMNASIUM - FISHER GYM





# GYMNASIUM - COMMON GROUND HIGH SCHOOL





# GYMNASIUM - COMMON GROUND HIGH SCHOOL





# GYMNASIUM - MANASSAS PARK ELEMENTARY SCHOOL





# PERFORMING ARTS SPACE - ROBLE THEATER



BLACK BOX THEATER:  
COMPLETELY FLEXIBLE, NO STAGE, NO FIXED SEATING



# OUTDOOR AMPHITHEATER - MARIN COUNTRY DAY SCHOOL





# OUTDOOR AMPHITHEATER - MARIN COUNTRY DAY SCHOOL





# NUEVA SCHOOL - LMS ARCHITECTS

---





# NUEVA SCHOOL - LMS ARCHITECTS





# INDIAN SPRINGS SCHOOL - LAKE FLATO

---





# OUTDOOR GATHERING SPACE - MARIN COUNTRY DAY SCHOOL





# OUTDOOR GATHERING SPACE - MARIN COUNTRY DAY SCHOOL

---





# OUTDOOR GATHERING SPACE - INDIAN SPRINGS SCHOOL





# OUTDOOR GATHERING SPACE - ST. MACARTAN'S PRIVATE SCHOOL





## **SMALL GROUP DISCUSSION:**

---

- WHAT ARE YOUR GROUPS TOP THREE THEMES AND WHAT COMPONENTS SHOULD BE INCLUDED?**
- ARE THERE ANY ADDITIONAL THEMES TO CONSIDER?**
- WHAT SHOULD THE DISTRICT CONSIDER REGARDING GRADE CONFIGURATION?**



## INDIVIDUAL VOTING EXERCISE:

---

- #1 TOP PRIORITY: VOTE WITH ONE **LIGHT GREEN** STICKER DOT
- ADDITIONAL HIGH PRIORITIES: VOTE WITH THREE **DARK GREEN** STICKER DOTS
- LEAST IMPORTANT PRIORITIES: VOTE WITH TWO **ORANGE** STICKER DOTS





# QUESTIONS & DISCUSSION







# INPUT: PRIORITIES FROM COMMUNITY SURVEY

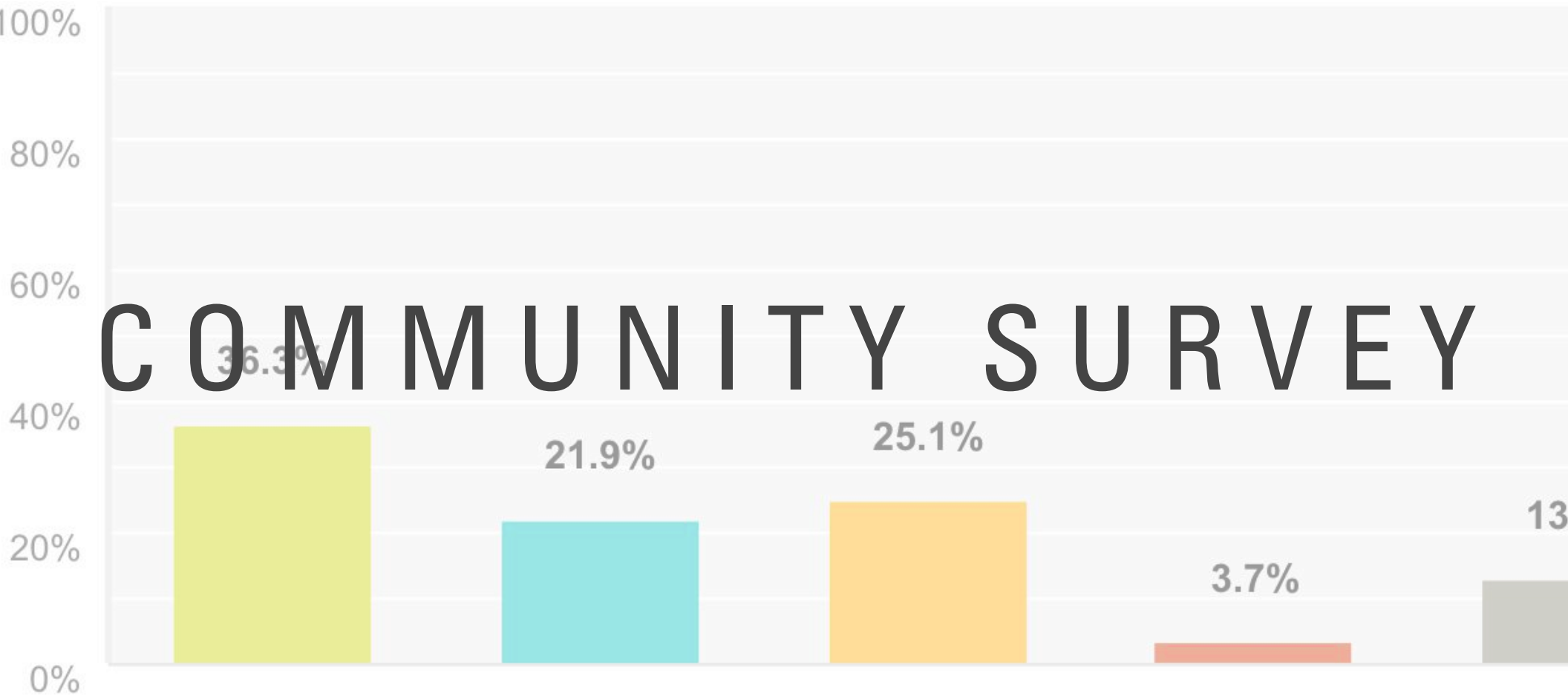



# INPUT: PRIORITIES FROM COMMUNITY SURVEY

CONSIDERING FACILITIES, BUILDINGS AND GROUNDS AT BOTH SCHOOL CAMPUSES, WOULD YOU SAY THAT THE SCHOOLS IN PORTOLA VALLEY SCHOOL DISTRICT HAVE A **GREAT NEED** FOR MORE MONEY, **SOME NEED**, **A LITTLE NEED** OR **NO REAL NEED** FOR MORE MONEY FOR FACILITIES, BUILDINGS AND GROUNDS IMPROVEMENTS?

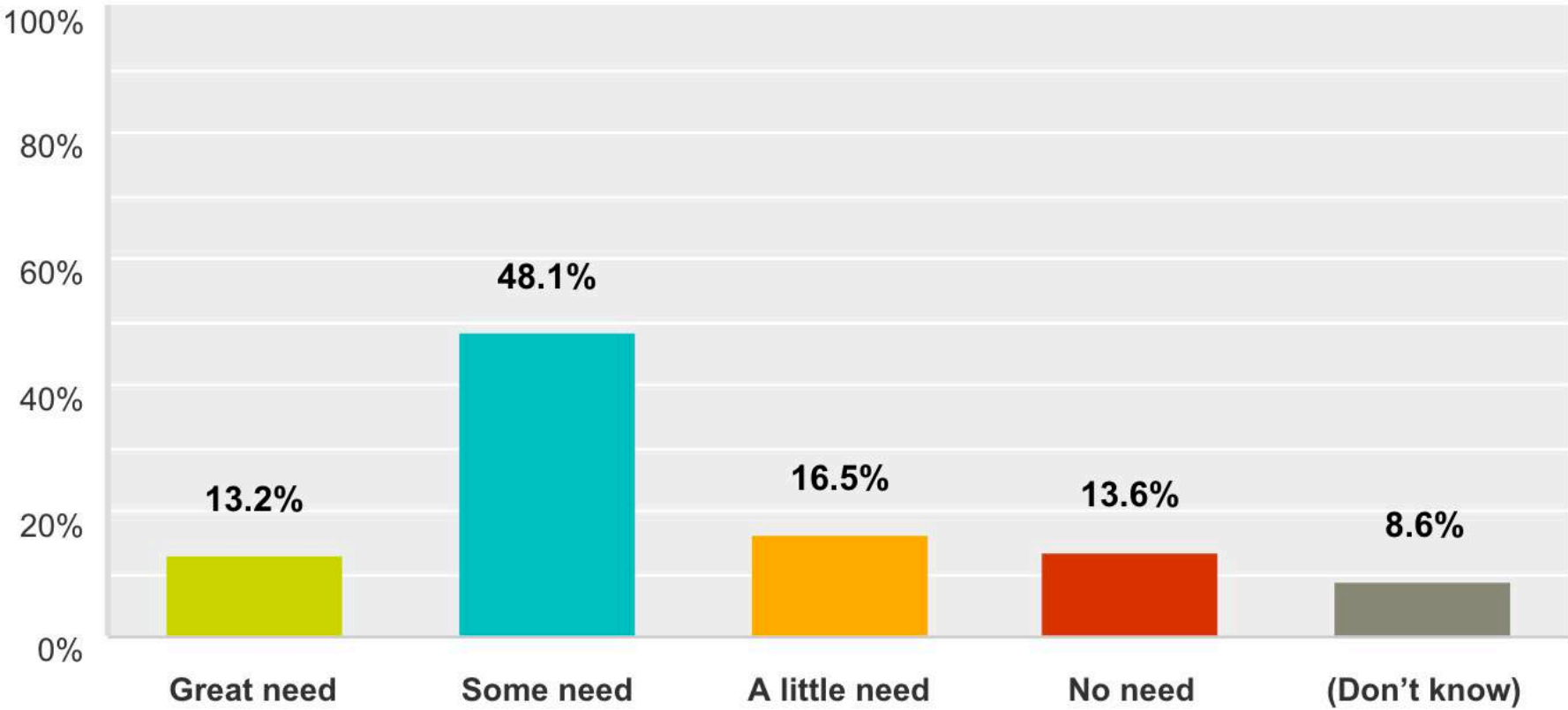



# INPUT: PRIORITIES FROM COMMUNITY SURVEY

---

## TOP 10 PRIORITIES FROM THE LIST OF POTENTIAL AREAS FOR IMPROVEMENT INCLUDED IN SURVEY:

**1 . MODERNIZING AND UPDATING CLASSROOMS TO CREATE FLEXIBILITY, CONNECTIONS TO BREAK-OUT SPACES, AND CONNECTIONS TO OUTDOOR EDUCATIONAL SPACES.**

**2 . IMPROVING GENERAL INFRASTRUCTURE SUCH AS BATHROOMS, HEATING, LIGHTING, AND DRAINAGE.**

**3 . MODERNIZING AND UPDATING TECHNOLOGY IN CLASSROOMS TO CREATE STATE-OF-THE ART TEACHING SPACES.**

**4 . UPGRADE PLAYGROUND AND PLAY STRUCTURES.**

**5 . IMPROVING OUTDOOR LEARNING SPACES TO BETTER SUPPORT EDUCATIONAL PROGRAMS.**



## INPUT: PRIORITIES FROM COMMUNITY SURVEY

---

**6.**

**IMPROVE PARKING, PICK-UP AND DROP-OFF CIRCULATION.**

**7.**

**CREATING A LARGER, MORE CENTRALLY LOCATED MAKER SPACE / CREATIVITY LAB SPACE.**

**8.**

**PROVIDE (EXPAND OR BUILD A NEW) MULTI-USE SPACE FOR PERFORMANCES AND LARGER MEETINGS.**

**9.**

**REPAIR AND UPGRADE SOCCER FIELD FOR ATHLETIC AND COMMUNITY PROGRAMS.**

**10.**

**PROVIDE (EXPAND OR BUILD A NEW) LARGER GYMNASIUM TO ACCOMMODATE FULL LENGTH COMPETITION COURTS.**



# INPUT: PRIORITIES FROM COMMUNITY SURVEY

AN ASPECT OF THE FACILITIES MASTER PLANNING PROCESS INVOLVES EVALUATING THE CURRENT GRADE LEVEL CONFIGURATION BETWEEN THE TWO SCHOOLS: ORMONDALE (K-3RD GRADES) AND CORTE MADERA (4TH-8TH GRADES). ON A SCALE OF 1 (NOT IMPORTANT) TO 5 (VERY IMPORTANT) PLEASE RATE THE LEVEL OF IMPORTANCE FOR EVALUATING THE CURRENT GRADE LEVEL CONFIGURATION.

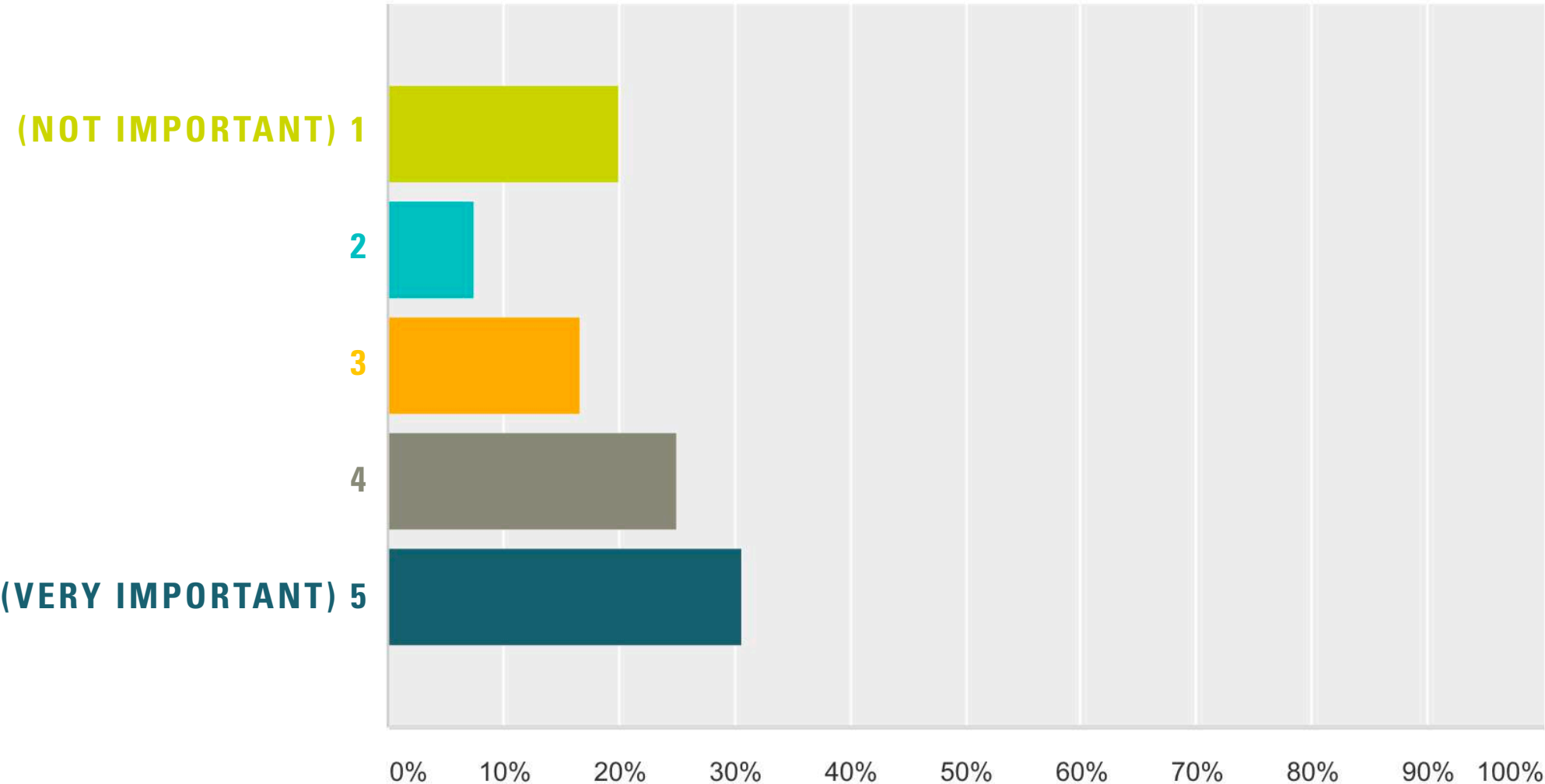



## INPUT: PRIORITIES FROM COMMUNITY SURVEY

PLEASE IDENTIFY THE IDEAL GRADE CONFIGURATION FOR THE TWO SCHOOLS:

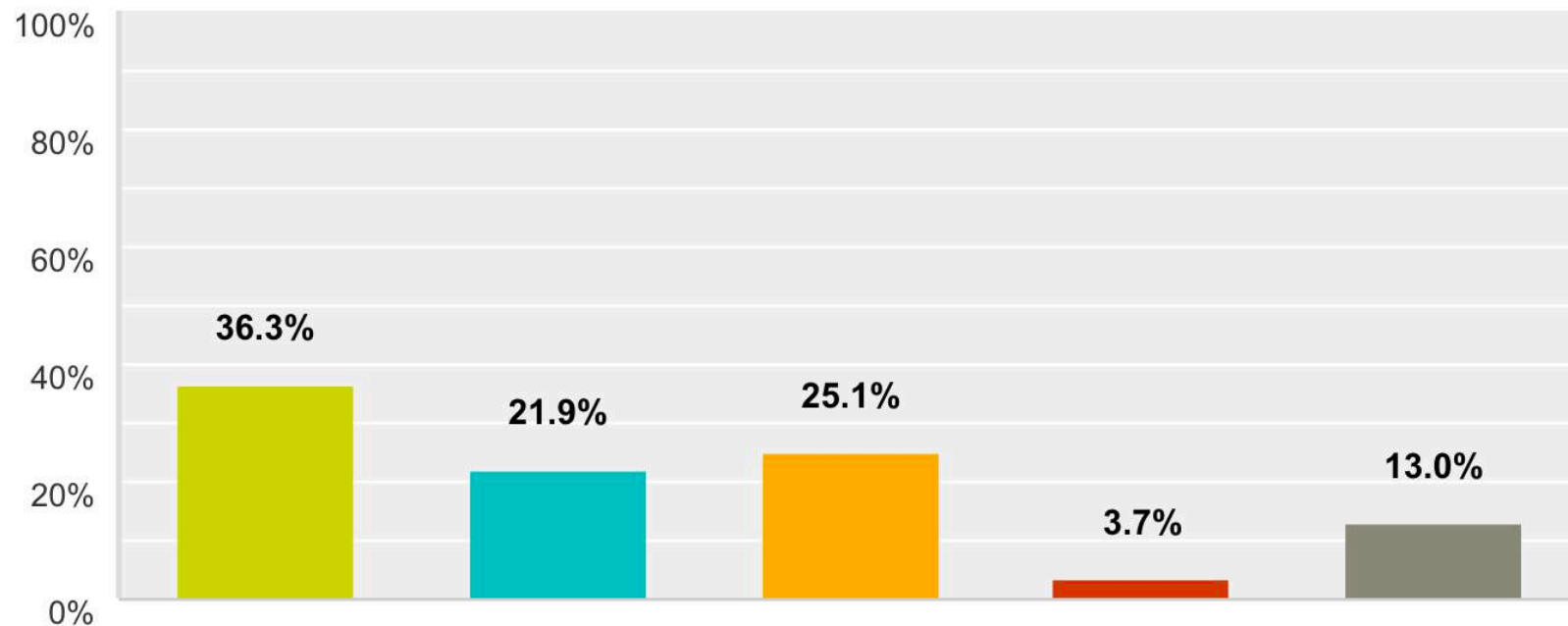

- **NO CHANGE:** ORMONDALE (K-3RD GRADES), CORTE MADERA (4TH-8TH GRADES)
- **MOVE 4TH GRADE TO ORMONDALE:** ORMONDALE (K-4TH GRADES), CORTE MADERA (5TH-8TH GRADES)
- **MOVE 4TH AND 5TH GRADE TO ORMONDALE:** ORMONDALE (K-5TH GRADES), CORTE MADERA (6TH-8TH GRADES)
- **MOVE 6TH-8TH GRADE TO ORMONDALE, MOVE K-5TH GRADES TO CORTE MADERA:** ORMONDALE (6TH-8TH GRADES), CORTE MADERA (K-5TH GRADES)
- **OTHER:** BETTER DEFINE 4TH/5TH GRADES SPACES & PROGRAMS AT CMS, KEEP FLUID YEAR TO YEAR, MOVE 6-8TH GRADES TO ANOTHER DISTRICT, NOT ENOUGH INFO



# INPUT: PRIORITIES FROM COMMUNITY SURVEY

PLEASE IDENTIFY THE IDEAL GRADE CONFIGURATION FOR THE TWO SCHOOLS:

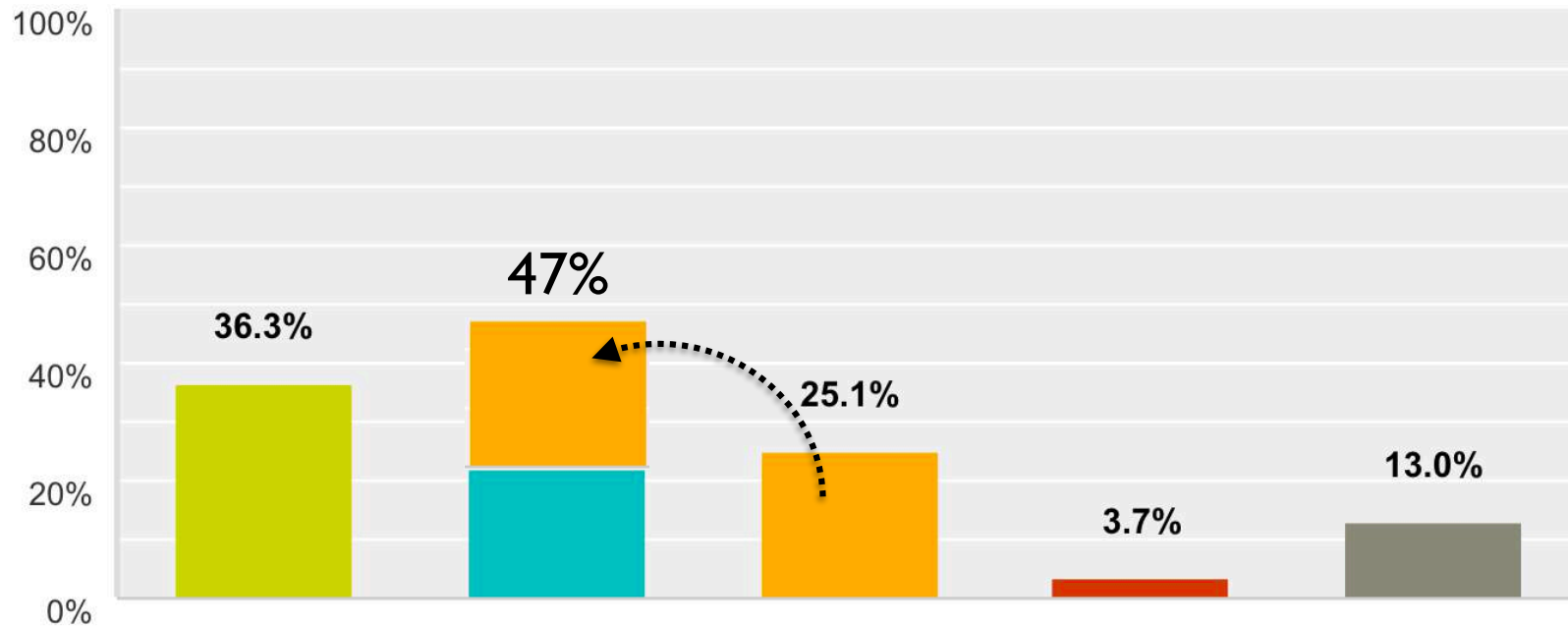

- **NO CHANGE:** ORMONDALE (K-3RD GRADES), CORTE MADERA (4TH-8TH GRADES)

- **MOVE 4TH GRADE TO ORMONDALE:** ORMONDALE (K-4TH GRADES), CORTE MADERA (5TH-8TH GRADES)

- **MOVE 4TH AND 5TH GRADE TO ORMONDALE:** ORMONDALE (K-5TH GRADES), CORTE MADERA (6TH-8TH GRADES)

- **MOVE 6TH-8TH GRADE TO ORMONDALE, MOVE K-5TH GRADES TO CORTE MADERA:** ORMONDALE (6TH-8TH GRADES), CORTE MADERA (K-5TH GRADES)

- **OTHER:** BETTER DEFINE 4TH/5TH GRADES SPACES & PROGRAMS AT CMS, KEEP FLUID YEAR TO YEAR, MOVE 6-8TH GRADES TO ANOTHER DISTRICT, NOT ENOUGH INFO



## INPUT: PRIORITIES FROM COMMUNITY SURVEY

---

### PLEASE PROVIDE ANY ADDITIONAL GENERAL COMMENTS OR IDEAS TO CONSIDER RELATED TO FACILITY IMPROVEMENTS AND THE MASTER PLANNING PROCESS:

- “I WOULD LOVE TO SEE MORE CONNECTION TO **OUTDOOR LEARNING SPACES**, CREATIVE NATURAL SPACES FOR PLAY AND NEW, IMPROVED PLAYGROUND AREAS FOR BOTH SCHOOLS.”
- “PLEASE COME UP WITH A **FIXED AREA FOR SERVING LUNCH**.”
- “...COVER THE OUTSIDE EATING AREA... BENEFITS: AN OUTDOOR MULTI-USE TEACHING AND MEETING SPACE AS WELL AS A **COVERED EATING AREA** TO USE RAIN OR SHINE.”
- “THE KIDS DO NOT HAVE ENOUGH ACTIVITIES TO DO DURING THEIR RECESS OR LUNCH ... THEY HAVE **OUTGROWN THE PLAY STRUCTURES**. THEY ARE IN DESPERATE NEED OF MAJOR UPGRADES IN THE FIELD.”
- “WOULD LOVE TO SEE THE CMS FACILITIES MORE **OPEN FOR COMMUNITY USAGE**, ESPECIALLY THE GYM AS THERE IS NO INDOOR GYM SPACE OPEN TO THE COMMUNITY IN THE PV AREA.”
- “GIVEN THE **AMAZING NATURAL ENVIRONMENT** SURROUNDING OUR SCHOOLS, IT WOULD BE GREAT TO INCORPORATE THAT MORE INTO THE CURRICULUM (SCIENCE, PE, ETC).”
- “**MUR IS TOO SMALL** FOR OUR SCHOOL TO HOST BASKETBALL GAMES. THE FIELDS ARE DANGEROUS FOR HOSTING TOURNAMENTS AND REGULAR FIELD USE.”