

PVSD FACILITIES MASTER PLAN: BOARD STUDY SESSION

PORTOLA VALLEY SCHOOL DISTRICT

MARCH 21, 2018

CAW
ARCHITECTS

- 
- **COMMUNITY OUTREACH**
 - **LONG RANGE MASTER PLAN DEVELOPMENT**
 - **BUDGETING & COST MODELING**
 - **PLAN PRIORITIZATION**
 - **FINALIZING THE FACILITIES MASTER PLAN**

2017 FACILITIES MASTER PLAN DEVELOPMENT



















The site plan illustrates a school campus layout. At the top, a 'FIELD' is located. To the left, a 'NEW FUND-A-NEED PLAY STRUCTURE' is marked. The central area contains several buildings: a 'MAKER SPACE' with 'HOT LUNCH' nearby, a 'GYMNASIUM' with 'ELECTRICAL' and 'PE.' rooms, and a 'SCIENCE' building with '5TH' and '4TH' grades. A 'LUNCH PORCH' and 'BLEACHERS' are also shown. To the right, there are 'CLASSROOMS' and 'SCIENCE' buildings, along with a 'NEW FUND-A-NEED NINJA OBSTACLE COURSE (FAR SIDE OF FIELD)' and a 'NEW FUND-A-NEED PIVOT BENCH'. The bottom section features a 'PARKING LOT' with 'DROP-OFF' zones, a '2ND DRIVE AISLE', and a 'MULTI-USE PERFORMANCE BLDG.' with 'MUSIC', 'PERF. ARTS', and 'SUPPORT' rooms. An 'OUTDOOR AMPHITHEATER' is located near the performance building. The plan also includes various outdoor spaces like 'PLAY YARD', 'GARDEN', and 'QUAD' areas.

ORMONDALE CAMPUS: FACILITY MASTER PLAN



WOODSIDE ELEMENTARY SCHOOL

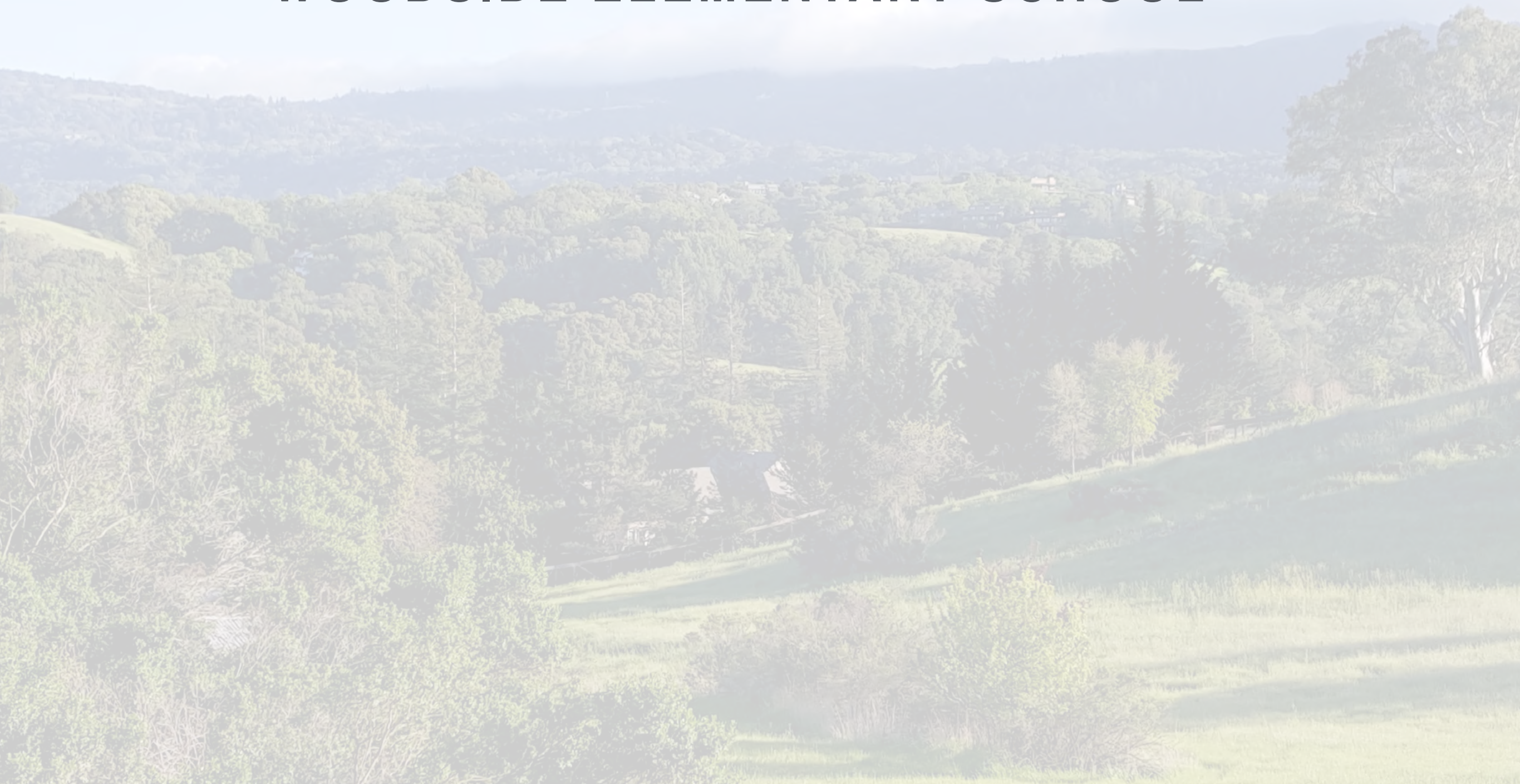









UPPER LAUREL CAMPUS

MENLO PARK CITY SCHOOL DISTRICT











LA ENTRADA MIDDLE SCHOOL

LAS LOMITAS ELEMENTARY SCHOOL DISTRICT

LA ENTRADA MIDDLE SCHOOL

CLASSROOM DESIGN - TYPICAL LAYOUT

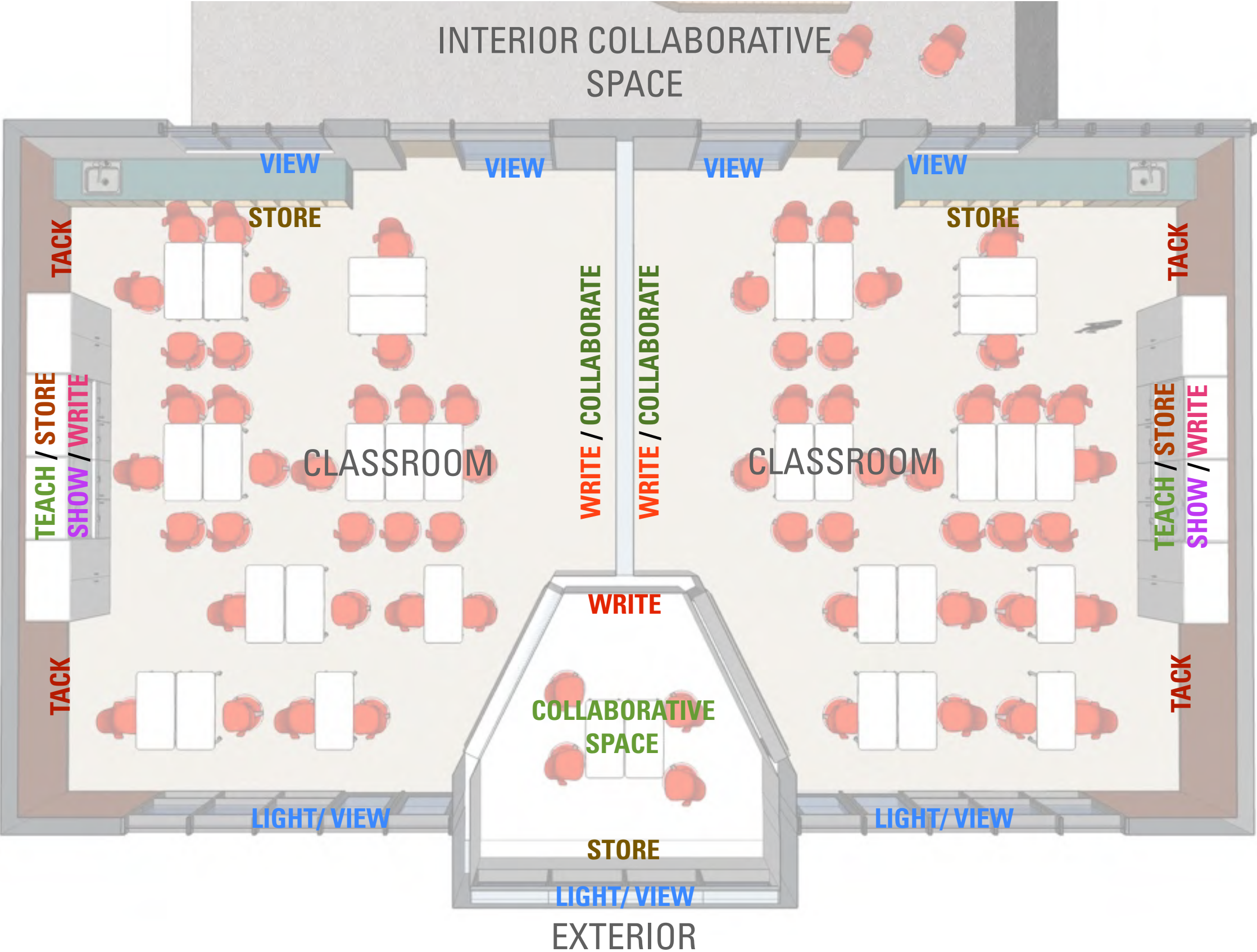

LA ENTRADA MIDDLE SCHOOL

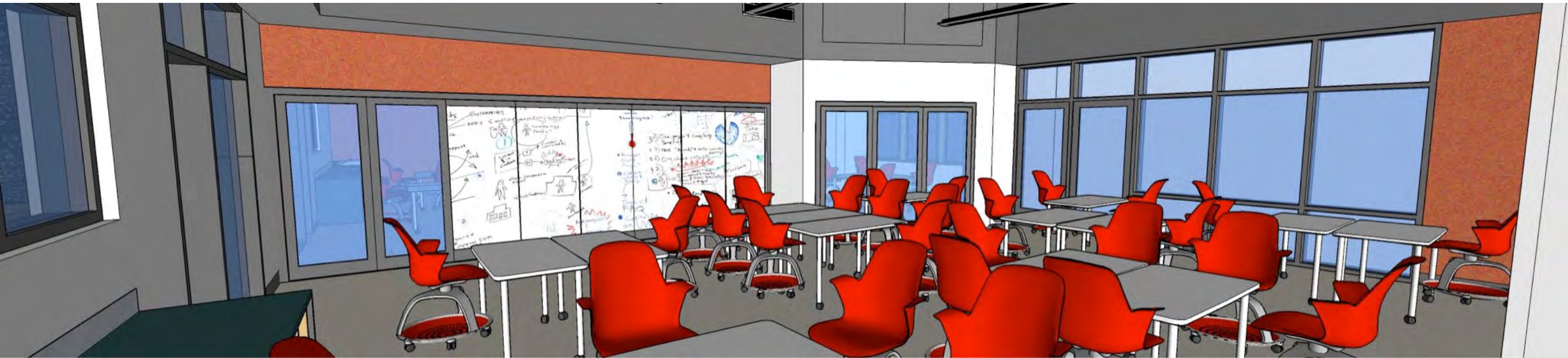

MOVEABLE WALL CLOSED



MOVEABLE WALL OPEN

LA ENTRADA MIDDLE SCHOOL

BUILDING FLOOR PLAN - COMMON SOCIAL SPACES

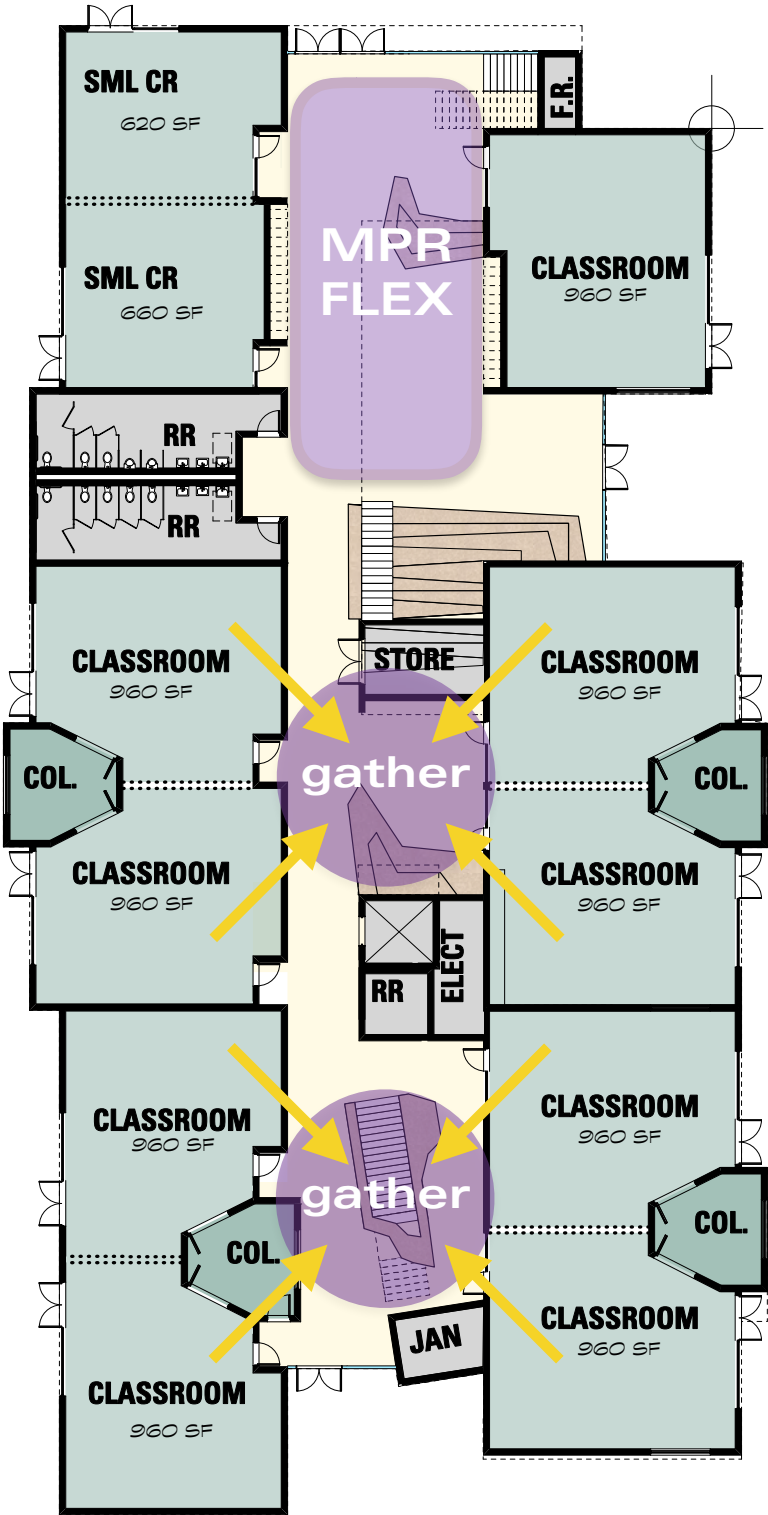

FIRST FLOOR

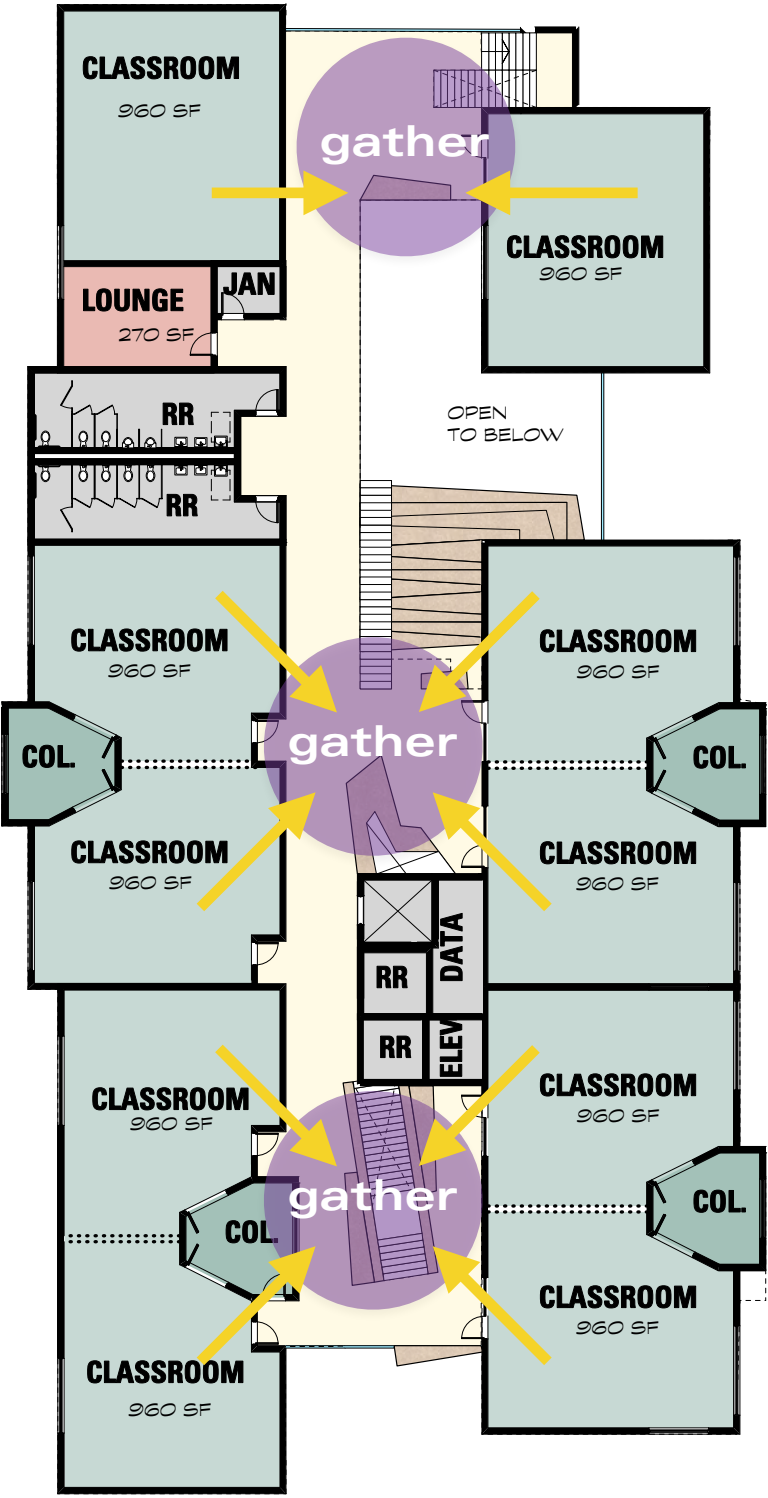

SECOND FLOOR

LA ENTRADA MIDDLE SCHOOL

COMMON SOCIAL SPACES



LA ENTRADA MIDDLE SCHOOL



ORMONDALE SCHOOL - ALTERNATE STUDY



CORTE MADERA- ALTERNATE STUDY



A young boy with dark hair is looking intently at a laptop screen. The background is a blurred classroom setting with shelves of books and other students. The word "QUESTIONS" is overlaid in the center in a large, bold, black font. The letter 'E' in "QUESTIONS" is highlighted with a green-to-yellow gradient. The laptop is a dark grey or black, and the boy is wearing a dark blue shirt.

QUESTIONS