



# Update on FCPS Construction/Renovation Projects

August 2018



# New Elementary at Athens-Boonesboro

---

▶ Architect:	EOP Architects
▶ General Contractor:	Griggs Enterprises
▶ GC Contract Sum:	\$17,860,200
▶ Total Project Cost:	\$23,801,841
▶ Change Orders to Date (2):	\$94,362.93
▶ Scheduled Contract Completion Date:	August 2019
▶ % of Contract Completed:	13.86 %
▶ Revised Completion Date per GC:	No Change

# New Elementary at Athens-Boonesboro

Schematic Rendering of Final Façade



August 2018

# New Elementary at Athens-Boonesboro

---

## ▶ **Work Completed to Date (July):**

### **Sector C:**

- ▶ Structural masonry continued
- ▶ Door frames continued
- ▶ Interior footers
- ▶ Underground MEP

### **Sector D:**

- ▶ Foundations
- ▶ Perimeter foundations continued
- ▶ Foundations
- ▶ Underground MEP

### **Sector E:**

- ▶ Foundations
- ▶ Underground MEP

### **Outside building pad:**

- ▶ Storm drainage began
- ▶ Parking lot grading continued
- ▶ Lowering of waterline along highway is complete
- ▶ Testing of forced main was completed and passed

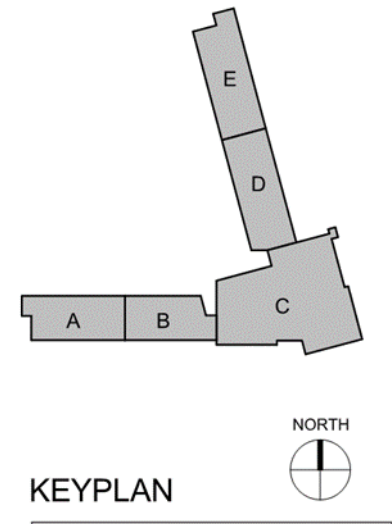

# New Elementary at Athens-Boonesboro

## ▶ **Current Work Effort (August):**

### **Sector A:**

- ▶ Begin perimeter footers and underground MEP

### **Sector B:**

- ▶ Begin perimeter footers and underground MEP

### **Sector C:**

- ▶ Continue slabs and masonry
- ▶ Interior footers
- ▶ First course of CMU

## ▶ **Sector D:**

- ▶ Foundations
- ▶ Underground electric
- ▶ First course CMU

### **Sector E:**

- ▶ Complete underground MEP and slabs
- ▶ Foundations and underground electric
- ▶ First course CMU

### **Outside building pad:**

- ▶ Connect sanitary gravity line from building to lift station
- ▶ Install and connect lift station to gravity line and forced main
- ▶ Continue storm and site utilities
- ▶ Begin footers at site retaining walls

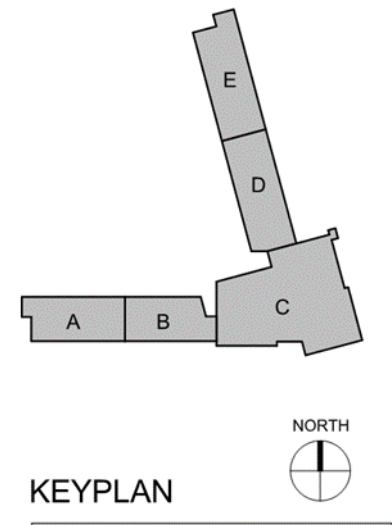

# New Elementary at Athens-Boonesboro

Interior of Gym



Café – Stage



Perimeter Foundations (A)



Perimeter Foundations (B)





# New Elementary at Athens-Boonesboro

## Interior Footers (E)



## Perimeter Foundations (E)



## Storm Line Installations

