

1703 N. Beauregard St.

Swing Space

Virtual Community Meeting
Office of Capital Programs, Planning and Design
May 31, 2023



ES PARA ESPAÑOL,
SELECCIONE "Español"

AM ለአማርኛ "Amharic"
የሚለው ይምረጡ

AR لسماع الترجمة باللغة
العربية، اختر "Arabic"



Agenda

- ❖ Introductions
- ❖ Timeline & Budget
- ❖ Design Update
- ❖ Swing Space Logistics Considerations
- ❖ Next Steps
- ❖ Questions



Introductions

- Erika Gulick, Executive Director of Facilities
- Azuka Bartlett, Director of Capital Programs, Planning, and Design
- Sophie Huemer, Principal Planner
- Arte'a Funderburk, CIP Communications Specialist
- Karen Gioconda, Senior Associate, Perkins Eastman
- City of Alexandria Staff

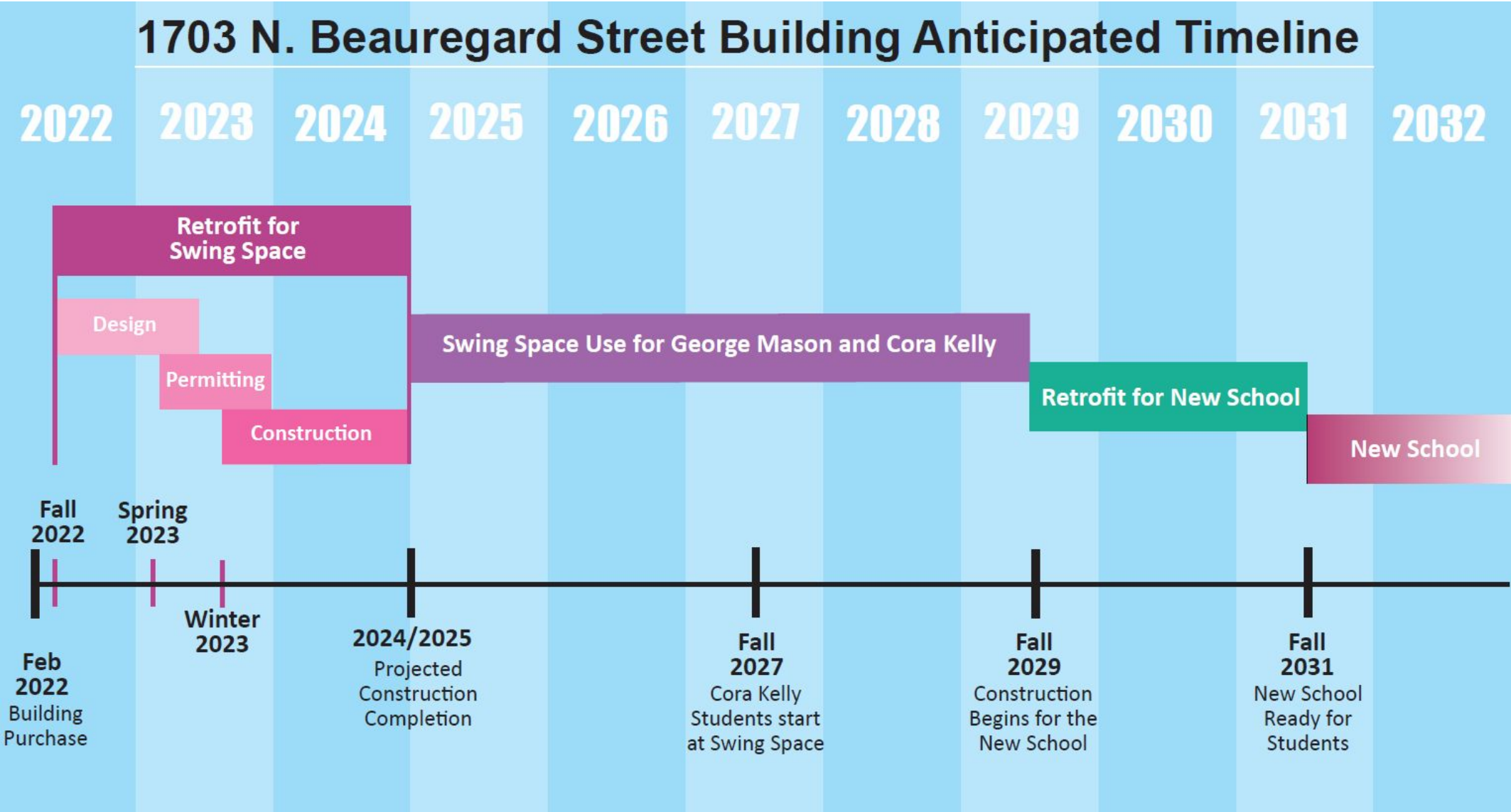



Budget

FY23 Allocated: \$24.5M

FY24 Proposed: \$5M

Total: \$29.6M

→ This budget is for the swing space. Funding for the permanent school is included in FY33.



Design Principles

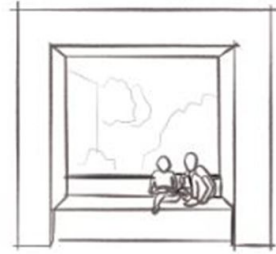

High-Performance Learning Environment

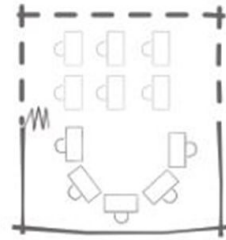

Flexibility at Multiple Scales



Supporting the Many Dimensions of Well-Being

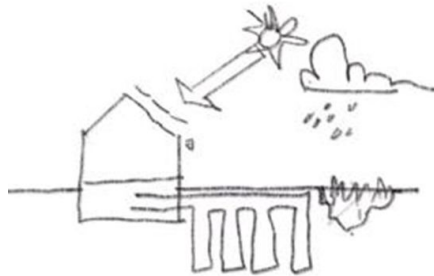

Responsible Stewardship of Resources

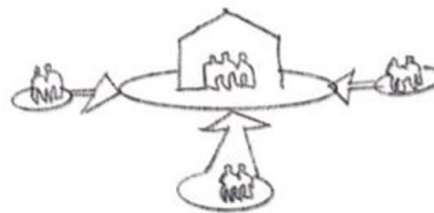

Positive & Connected Culture



A Supportive Teaching Environment



Program

LEVEL 4

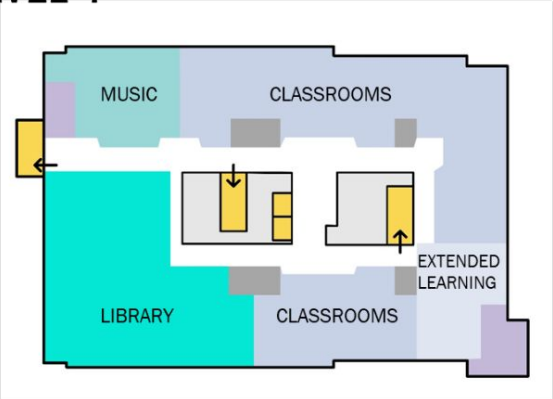

LEVEL 2

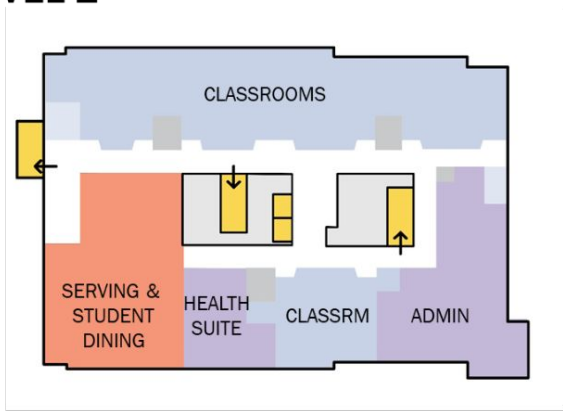

LEVEL 3

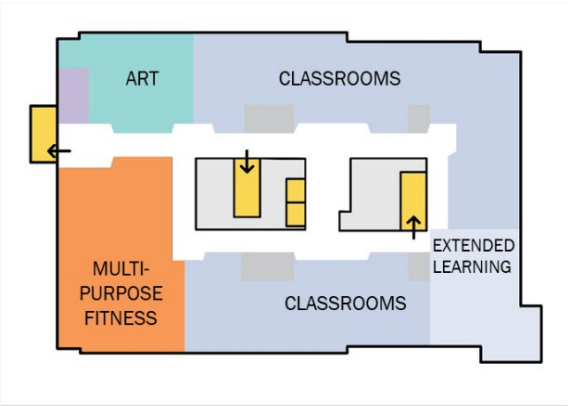

LEVEL 1

BOTANICAL PRESERVE

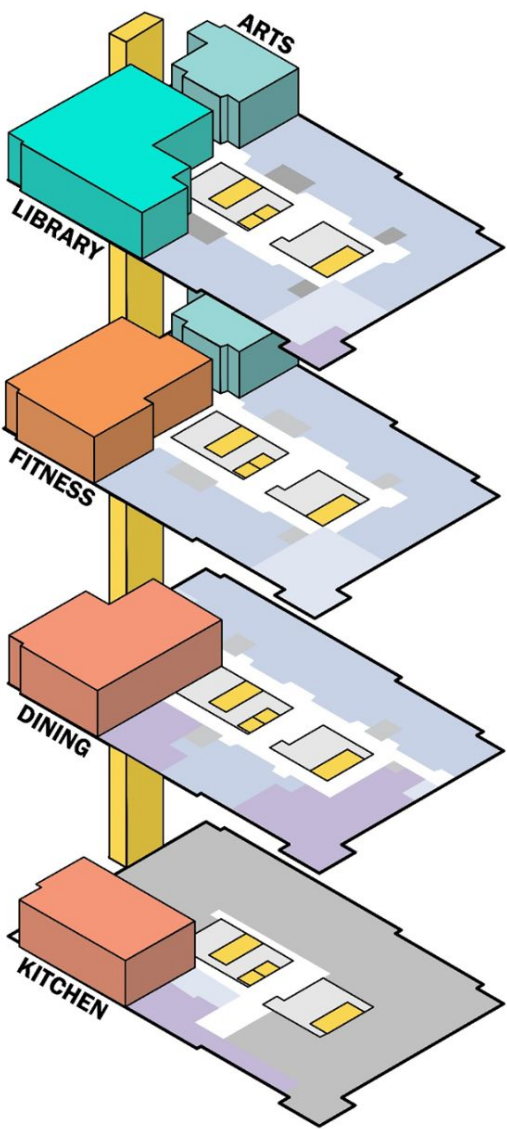
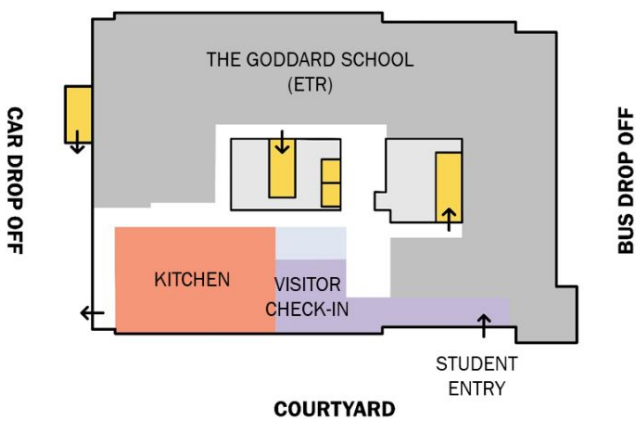



Concept: Nest

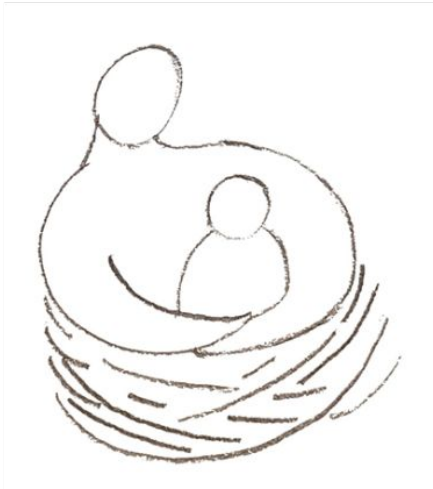

A Welcoming Refuge

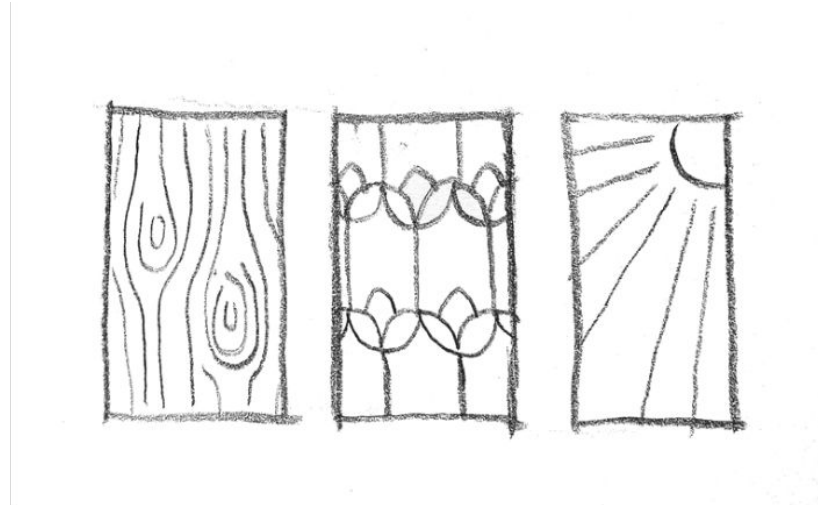

Highlighting
Connection to Nature

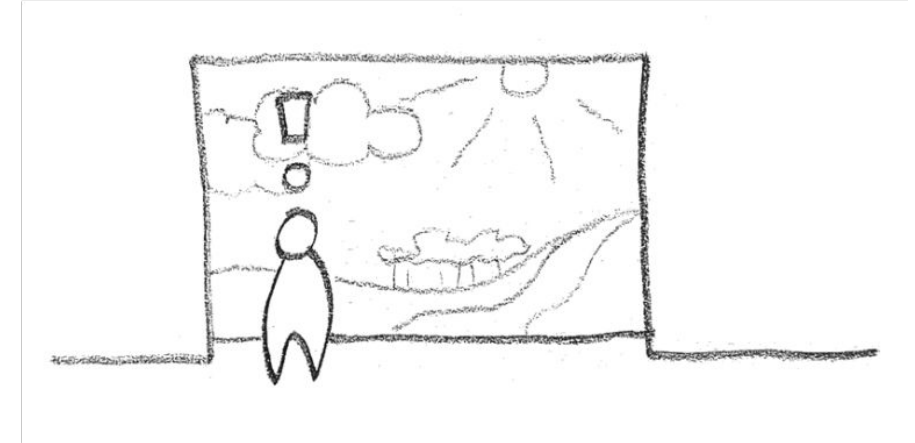

Enhancing the Journey
with Moments of Delight



Sunset Field Mood Board





Sunset Field Color Palette 1

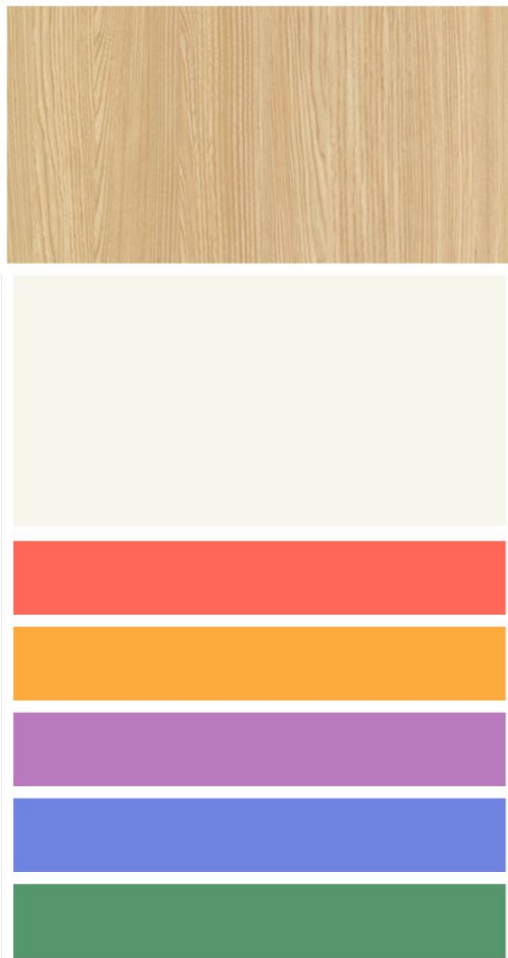



Sunset Field Color Palette 2

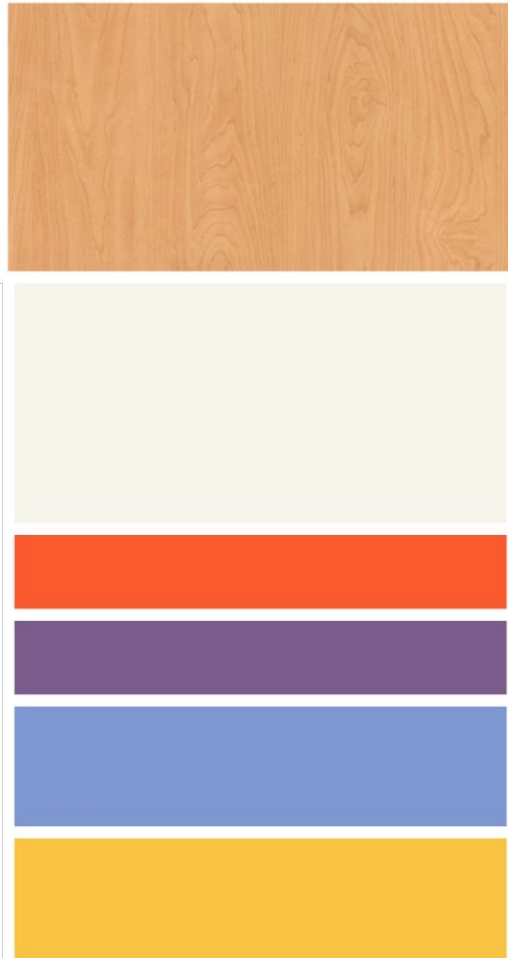



Daytime Forest Mood Board





Daytime Forest Color Palette 3

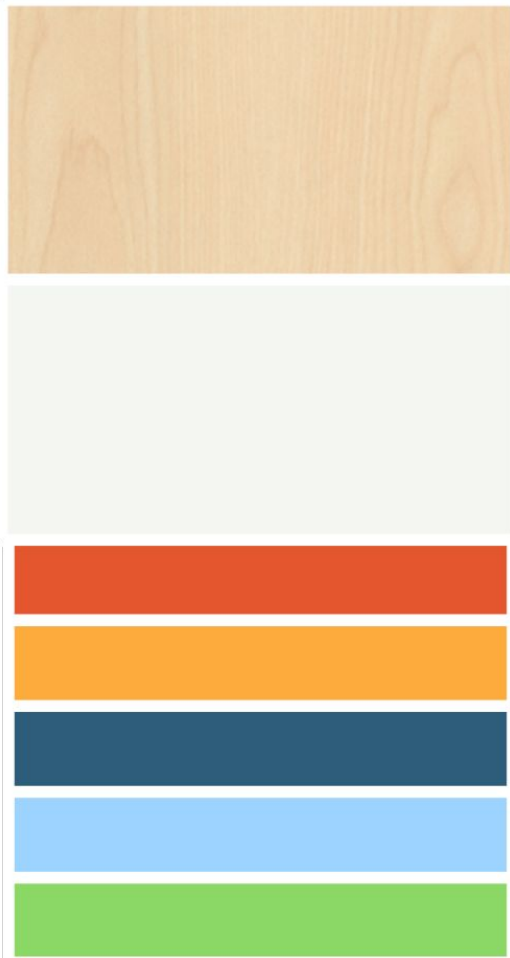



Daytime Forest Color Palette 4

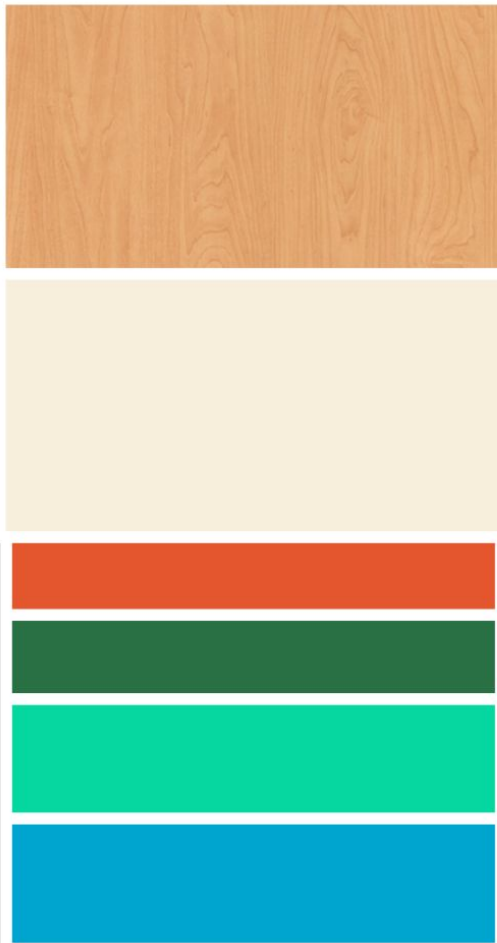



Which color palette inspires you?

Sunset 1



Sunset 2

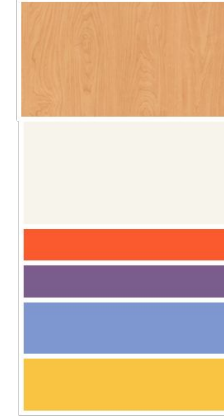

Forest 1

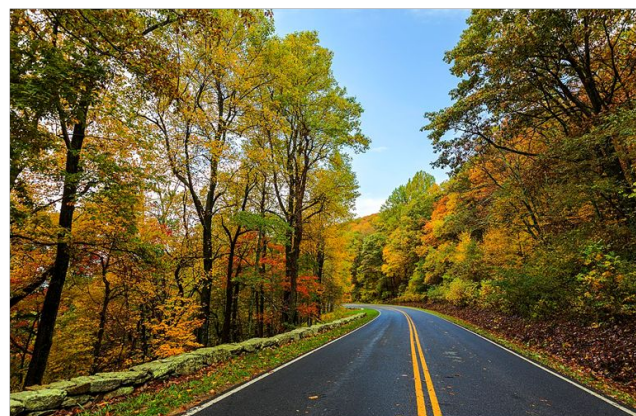

Forest 2

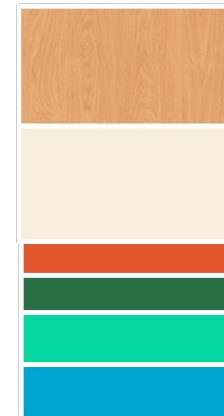



Site Plan

Orange = Bus

Yellow = Parent

Blue = Recess

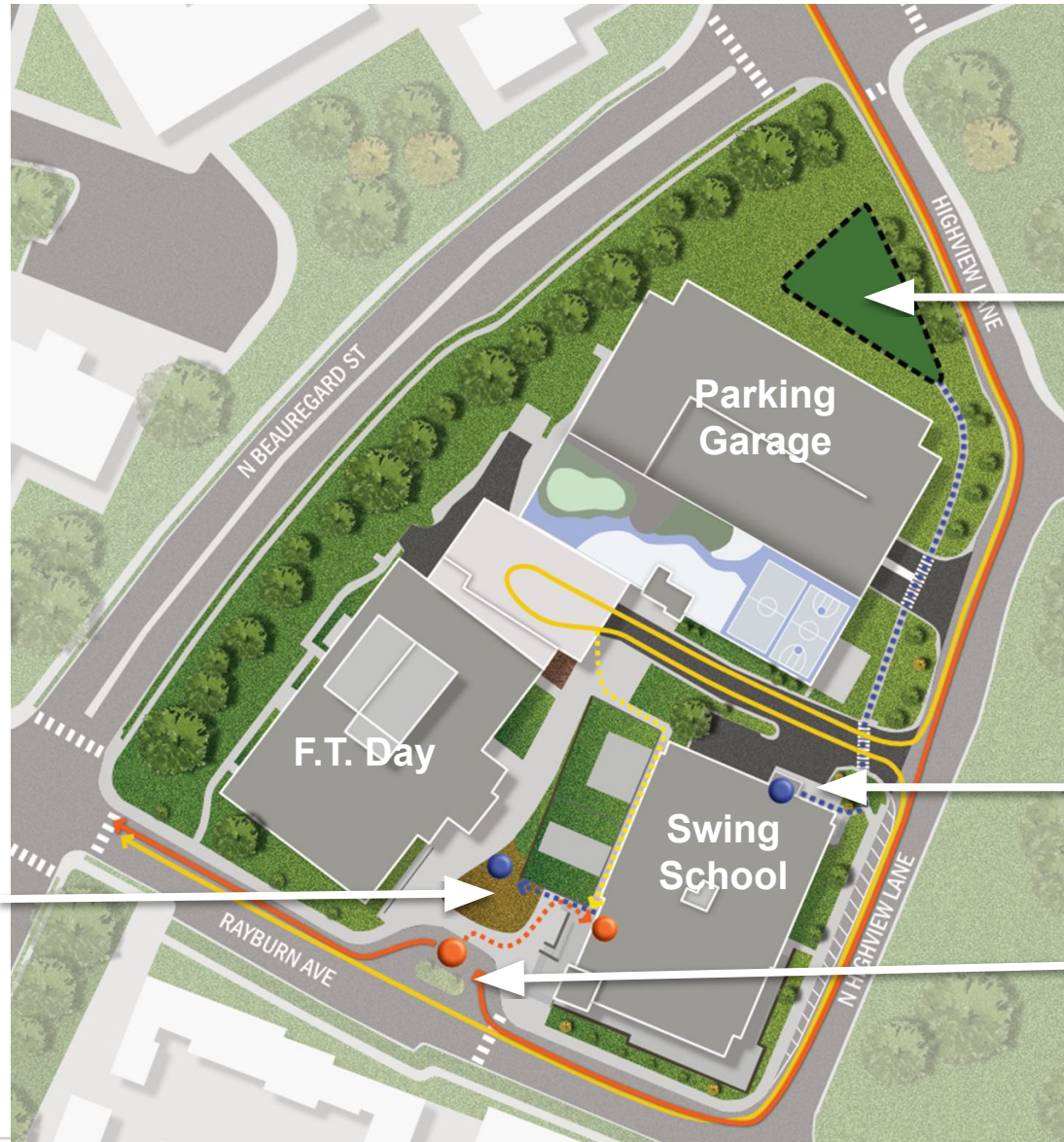

Potential Playground Location

Stair Addition

Bus Loop

Natural Playground



What natural playground elements inspire you?



Interactive Game



Balance



Climbing



Music



Crawling



What playground equipment inspires you?



Climbing/Sliding



Music



Spinning



Cooperative Play



Balance



Tactile Play



Swing Space Logistics Considerations

→ Transportation

- ◆ Students will be provided transportation
- ◆ Traffic Impact Analysis
 - Review with internal and external stakeholders the drop off and pick up procedures

→ Close coordination with Ferdinand T. Day

- ◆ Staggered start and dismissal times
 - Arrival and dismissal times will be evaluated to reduce congestion and ensure safe and efficient access to the campus for parents and ACPS transportation



Next Steps and Communications

- **Design Phase:** Ongoing
- **Community Meeting #3: Fall 2023**
 - ◆ Project Update
- **Communications:**
 - ◆ Information communicated on the [Capital Programs, Planning, and Design Webpage](#)
 - ◆ Sign up for our [CIP Newsletter](#)



Contacts

Azuka Bartlett, Director of Capital Programs, Planning, and Design
azjargal.bartlett@acps.k12.va.us

Sophie Huemer, Principal Planner
sophie.huemer@acps.k12.va.us

Arte'a Funderburk, CIP Communications Specialist
artea.funderburk@acps.k12.va.us

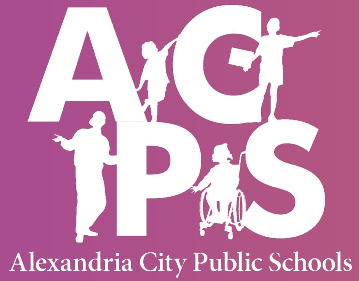

Questions?



Interim Superintendent
Dr. Melanie Kay-Wyatt

School Board
Meagan L. Alderton, Chair
Jacinta Greene, Vice Chair

Willie F. Bailey, Sr.
Kelly Carmichael Booz
Abdel-Rahman Elnoubi

Christopher Harris
Tammy Ignacio

Michelle Rief
Ashley Simpson Baird