



Preparing Students
for **Success** and
Enhancing
Community Value



2019 2020 Annual Report

**Bulloch
County
Schools**

BULLOCH COUNTY BOARD OF EDUCATION



Bulloch County Board of Education 2019-20 – Pictured Standing (L-R): Dr. Stuart Tedders, Maurice Hill, Mike Sparks, and Jimmy “Jay” Cook; and Seated (L-R): Cheri Wagner, April Newkirk, Glennera Martin, and Heather Mims.

District 1

CHERI WAGNER

Term: 1/1/2013 – 12/31/2020
clwag68@yahoo.com

District 3

DR. STUART H. TEDDERS

912.478.1922 (W)
Term: 1/1/2017 – 12/31/2020
stedders@bullochschools.org

District 5

GLENNERA MARTIN

912-764-3291 (H)
Term: 1/1/2015 – 12/31/2022
gmartinsugarhill@yahoo.com

District 7

HEATHER MIMS, VICE CHAIRMAN

912.541.3514(H)
Term: 1/1/2017 – 12/31/2020
hdmims@bullochschools.org

District 2

MIKE SPARKS, CHAIRMAN

912.842.2460 (H)
Term: 1/1/2011 – 12/31/2022
msparks@bullochschools.org

District 4

APRIL NEWKIRK

912.690.5973
Term: 1/1/2019 – 12/31/2022
aprilcnewkirk@gmail.com

District 6

JIMMY “JAY” COOK, JR.

912-489-3137 (H)
Term: 1/1/2015 – 12/31/2022
jlcook1964@gmail.com

District 8

MAURICE HILL

912.764.7134(W&H)
Term: 1/1/2005 – 12/31/2020
hillmaurice@yahoo.com

Board Secretary

MARY HENLEY

Administrative Assistant
to Superintendent
912.212.8500
mhenley@bullochschools.org
boe@bullochschools.org

Superintendent of Schools

CHARLES WILSON, ED.S., MBA, CPA

912-212-8500
cwilson@bullochschools.org

BOARD OF EDUCATION MEETINGS

Visit www.bullochschoools.org/board for a schedule of meeting dates and times, maps of the areas that each Board member represents, Board agendas and meeting packets, and official minutes of meetings. Board meetings are held in the board room of the school district's Central Office.

WATCH BOARD MEETINGS LIVE OR LATER

Board meetings can be watched live or later. They are live streamed online at www.bullochschoools.org/boardlive, and the unedited videos are uploaded and archived to the same website immediately following each meeting.

OPEN RECORDS REQUESTS

The public may direct all Open Records Requests to the Custodian of Records
recordscustodian@bullochschools.org.

BOARD LEGAL COUNSEL

Edenfield, Cox, Bruce & Edenfield
115 Savannah Avenue
Statesboro, GA 30458
912.764.8600 | www.edenfieldlaw.com

KEY ISSUES FORUM

An online source of FAQs, information, and feedback
www.bullochschoools.org/keyissues

WWW.BULLOCHSCHOOLS.ORG/BOARD

**Bulloch
County
Schools**

STRATEGIC PLAN

VISION

By 2020, we will become a school system that prepares our students to be contributing members of society, based upon their interests and abilities, and the opportunity to pursue the colleges and careers of their choice.

BELIEF & CORE VALUES

We believe everyone can learn and grow in a continuous improvement culture that incorporates our core values. Our core values signify our expectations of ourselves and each other, from the boardroom to our classrooms.

Be Relational: We build relationships with others through integrity, compassion, and respect.

Be Purposeful: We pursue what needs to be accomplished through appropriate and intentional effort.

Be Reflective: We evaluate our efforts in relation to our purpose.

Be Resourceful: We implement resourceful solutions through innovation and collaboration.

Be Courageous: We exemplify commitment, determination, and grit in making needed changes happen.

Be Accountable: We hold ourselves accountable for the decisions we make and the actions we take.

MISSION

The mission of Bulloch County Schools is to prepare students for success and enhance community value.

BULLOCH COUNTY SCHOOLS STRATEGIC PLAN (2015-2020)

Adopted by Board of Education 02/12/2015; Revised 01/06/2016

COLLEGE & CAREER READINESS	STAKEHOLDER & COMMUNITY SUPPORT	RESOURCE OPTIMIZATION
Increase College & Career Ready Performance Index Scores	Increase stakeholder and community involvement for student success	Develop funding plan to improve school operating capacity
Provide all students with relevant, real-world learning experiences	Develop partnerships with parents, community & organizations	Develop a place for necessary facilities & infrastructure upgrades
Utilize new and existing technologies	Develop partnerships with regional employers & post-secondary	Improve school nutrition: quality, health, costs, & local partners
Provide professional development needed for all employees	Increase stakeholder access to information	Develop plan to attract, retain & promote effective employees

SEE THE COMPLETE BULLOCH COUNTY SCHOOLS
STRATEGIC PLAN 2015-2020
AT WWW.BULLOCHSCHOOLS.ORG/STRATEGICPLAN.

STATE RECOGNITIONS

Governor's Office of Student Achievement

Silver AWARD
Greatest gains
in student
achievement

SEB Middle
School

Georgia Department of Education

Title I
Distinguished
Schools

SEB Middle
School

Georgia School Public Relations Association

Best in Class Award
for Multimedia

Bulloch County
Schools Cultural
Diversity Video

GA Association of School Personnel Administrators

Best in Class Award
Employee Recruitment
Materials

Bulloch County
Schools Cultural
Diversity Video

BULLOCH COUNTY SCHOOLS AT-A-GLANCE

SCHOOLS

- **15** Schools (total)
- **9** Elementary Schools (PK-5)
- **3** Middle Schools (6-8)
- **2** High Schools (PK, 9-12)
- **1** Middle-High (6-12)

ALTERNATIVE LEARNING CENTERS

- Transitions Learning Center (6-12)
- Graduation Performance Academy (9-12)
- Cedarwood (GNETS)

FACULTY & STAFF

- **1,486** Full-time
- **2,121** full, part-time, contract, substitute, & seasonal employees
- **653** Classroom Teachers
- **60** Administrators
- Bulloch County's 2nd largest employer

TRANSPORTATION

- **113** School Bus Routes
- **113** drivers, **22** bus monitors, and **7** mechanics make up our driving force
- **5,000+** student bus riders; Ride 2x daily
- **6,200** miles bus drivers travel each day
- **1.1** million miles bus drivers travel annually
- **20** days regular rotation for bus inspections & service

STUDENT MOBILITY RATE

17.0%

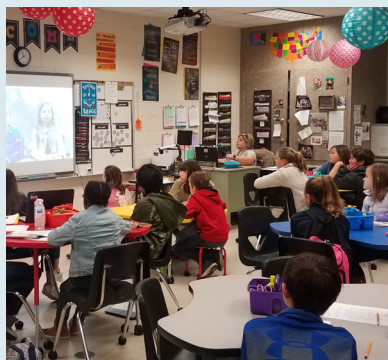

MILLAGE RATE

- Bulloch: **9.427***
- Bryan: **15.075**
- Candler: **14.000**
- Chatham: **18.881**
- Effingham: **17.077**
- Emanuel: **13.657**
- Evans: **14.000**
- Jenkins: **15.466**

(Bulloch County Schools also receives a one percent local option sales tax. This mixed portfolio helps keep property taxes lower. If you factor in LOST collections, the effective millage rate is 15.735)

SCHOOL NUTRITION PROGRAM

- **59.18%** Students who receive free or reduced-price lunches.
- **90.86%** of students at Langston Chapel Elementary School receive free or reduced lunch; Highest percentage in district.
- All students receive free breakfast.

PER-PUPIL EXPENDITURES

2015: **\$7,651.70**
2016: **\$8,383.34**
2017: **\$8,511.00**
2018: **\$8,876.00**

GRADE-LEVEL READING

- **46.7%** - 3rd grade students reading at or above the grade level target
- **71.7%** - 8th grade students reading at or above the grade level target

STATE RECOGNITIONS

Monsanto Corporation

\$2,500 America's Farmers Grow Communities Grant for STEM

Stilson Elementary School

Friends of the NRA

\$3,100 Grant for Equipment

SEB High School JROTC Rifle Team
A GHSA Sanctioned Sport

Ogeechee Technical College

Adult Education EAGLE Delegate

Cathleen Brown
Bulloch County Schools Transportation Department

GA Department of Audits & Accounts

Certificate of Achievement for Excellent Financial Reporting

Bulloch County Board of Education & Troy Brown, CFO

BULLOCH COUNTY SCHOOLS AT-A-GLANCE

STUDENT ENROLLMENT

10,634 (March 2019 FTE)

14% Special Programs

3% English for Speakers of Other Languages (ESOL Services)

8.2% Gifted Services

5,449 Male

5,185 Female

STUDENT DIVERSITY

24 Countries

18 Languages

49.4% Caucasian

38.4% Black

6.5% Hispanic

1.6% Asian/Pacific Islander

3.9% More than one race & other

0.2% American Indian/Alaskan Native

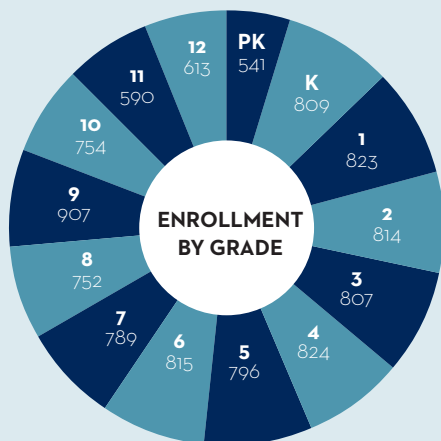

ECONOMICALLY DISADVANTAGED 62.8%
HOUSING DISPLACED 176+



ENGLISH LANGUAGE LEARNERS

4% of students

SCHOOL ATTENDANCE

Score is based on students w/less than six unexcused absences divided by enrollment; 100-point scale)

State Elementary Average **91.8**

Bulloch County Schools Avg. **86.9**

State Middle/High Average **90.3**

Bulloch County Schools Avg. **88.5**

SCHOOL DISCIPLINE

4,391 Total discipline incidents

1,755 Students involved in incidents

24.8% led to out-of-school suspensions

53.6% led to in-school suspension

0.5% led to expulsion from system

SAFE & SUBSTANCE-FREE ENVIRONMENT

Total Reported Bullying Incidents **43**

Total Reported Fighting Incidents **149**

Total Reported Battery Incidents **28**

Total Reported Disorderly Conduct **177**

Total Reported Threats **69**

Total Reported Drug Incidents **12**

Total Reported Sexual Harassments **14**

Total Reported Weapons-Knife **9**

Total Reported Weapons - Gun **0**

STUDENT SUPPORT PROVIDERS

School Social Workers for District: **3**

School Psychologists: **5**

School Counselors (Full-Time): **27**

School Resource Officers: **6**

School Safety Director: **1**

STRATEGIC PLAN DASHBOARD

Bulloch County Schools Strategic Plan Dashboard

*Preparing students for success
and enhancing community value*

By 2020, we will become a school system that prepares our students to be contributing members of society, based upon their interests and abilities, and the opportunity to pursue the colleges and careers of their choice.

4-Year Cohort Graduation Rates

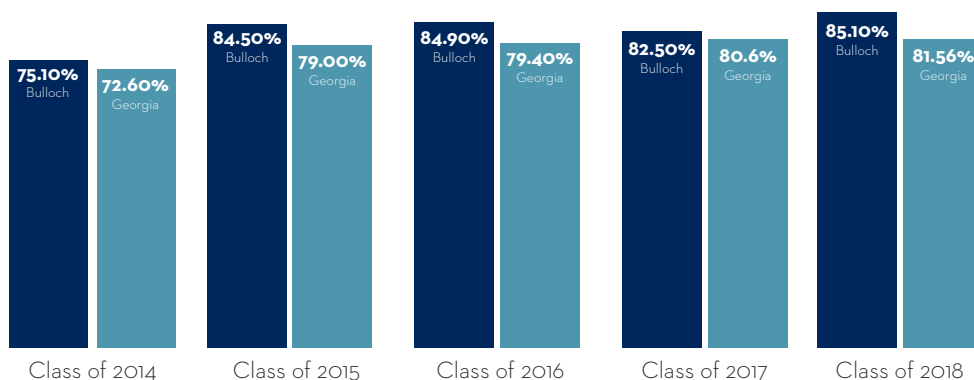

Note: Updated graduation rate data is released each September. For the most recent data visit www.bullochschools.org.

56.6%

Graduates who were deemed college-ready based on national assessments (SAT/ACT)

Top Institutions Graduates Attend

Georgia Southern University, East Georgia State College, Ogeechee Technical College, University Of Georgia, Abraham Baldwin Agricultural College, Georgia College & State University

46.86%

2017 graduates who were eligible for the HOPE or Zell Miller Scholarship

2.0%

Dropout rate for grades 9-12

372

Students age 16 and older who are dual-enrolled

224

Number of college courses taken by dual-enrolled students



617

Number of 2017 Graduates

606

Number of 2018 Graduates.

646

Number of 2019 Graduates.

ACHIEVEMENT



SAT Class of 2018 Mean Score Avg.

Bulloch: 1060
Georgia: 1033
United States: 1068

ACT Class of 2018 Composite Score Avg.

by Institution

Bulloch: 20.4

Georgia: 20.4

United States: 20.8

Advanced Placement (AP) Class of 2018

178 students took 224 AP exams. Studentsscored a three or higher out of five on 117 of the tests (52.2%) to earn post-secondary credit for the course.

74.8 (C)

District's performance grade assigned by the Georgia Department of Education, based on College & Career-Ready Performance Index results

Bulloch County's overall College & Career-Ready Performance Index is higher than 63% of GA school districts. See CCRPI Scores on Page 13

None of our schools are on the Governor's Office of Student Achievement's state turnaround list. Three-year CCRPI averages show no schools require state intervention

LEARNING



2,500+

Professional development hours completed by Bulloch County Schools' faculty & staff

2800+

Students using YouScience career aptitude tool to help make college and career decisions.

4500+

Number of elementary school children learning better leadership skills and habits through Stephen Covey's The Leader in Me program.

20

Career pathways offered across three high schools



3,000

Books to be distributed through the Bulloch Book Bus to increase childhood literacy skills

COMMUNITY



24-7

Launched online school registration tool

80

Number of beds built by Statesboro High School Construction students for Beds for Bulloch, a partnership with Luke's Project 11, BAK Builders, & Tippins Polk Construction Company for children in need.



9

Number of after school care sites operated by the Statesboro-Bulloch County Parks & Recreation Department at our elementary schools.

Launched online tool to rent school facilities at www.bullochschools.org/rent

\$10K

Grant from the Coca-Cola Company to Portal Middle High School athletics after the school was selected as one of 50 national winners of the Powerade Powers Up High School Athletics contest.

RESOURCES



\$1.7 million
sq. ft.

Amount of internal and external square feet of school facilities



77%

Avg. elementary school capacity; 5308 enrollment with 6,909 capacity.

78%

Avg. middle school capacity; 2,298 enrollment with 2,958 capacity

69%

Avg. high school capacity; 2,790 enrollment with 4,070 capacity

27

Number of E-SPLOST projects completed since 2016

12

New playgrounds and/or recess areas for elementary students

\$43 million

Bonds secured to begin in June 2018 to begin E-SPLOST IV projects.

ENGAGEMENT



200+

Hours of parent engagement events in our schools



938

Parents who participated in the GA School Climate Survey for Bulloch County Schools

400+

Number of regular, active parents and community members who volunteer in our schools with PTOs, advisory councils, and events

23,047+

Followers across our social media platforms; up 20%+ from previous school year



2.43 million

Visits to our district and school websites in 2018-2019

STATE SUPERINTENDENT & BOARD HONOR 2019 REACH GA SCHOLARS

2nd Cohort of graduates receive \$120K in scholarships +HOPE

Bulloch County Schools' second cohort of REACH Georgia scholars were honored during two local ceremonies in May 2019 by State School Superintendent Richard Woods, state dignitaries from the Governor's Office of Student Achievement and the State Board of Education as well as the Bulloch County Board of Education and its Foundation for Public Education. The five scholars will receive a combined \$120,000 in scholarships from the REACH program in addition to HOPE scholarships.

The majority of the graduating scholars were honor graduates, some are the first in their family to go to college, and for the second year in a row, one is a valedictorian. In 2014, they were each selected to be a REACH scholar based on the strength of their seventh-grade academic, attendance, and behavior records.

REACH Georgia is a needs-based mentoring and scholarship program designed to ensure that the state's academically promising students have the academic, social, and financial support needed to graduate from high school and complete college. Bulloch

County Schools began participating in the program in 2013. Since that time the school district has selected 35 students, five each year, to be REACH Georgia scholars. The Bulloch County Foundation for Public Education provides the annual \$7500 in local matching funds that are combined with additional financing from REACH Georgia and participating colleges and universities in the state.



The scholars from the Class of 2019 were the following: (Front Row - L-R: **Alberto Rodriguez** -Plans to attend Georgia Southern University and major in Construction Management; **Brian Phillips** -Plans to attend Ogeechee Technical College and Georgia Southern University and major in Logistics; **Nancy Martinez** -Plans to attend Wesleyan College and major in

Biology; **Michael Vescio** -Statesboro High School Valedictorian; Plans to attend Georgia Southern University, where he was accepted into their honors program and major in Biochemistry; and **Destiny Hartwell** -Plans to attend the University of Georgia and pursue a major in Sports Broadcasting.

YOUSCIENCE HELPS STUDENTS CHOOSE CAREERS

Bulloch County Schools' three high schools use a new online career assessment tool, YouScience, to help students select career fields that best match their skills and interests. YouScience helps build communities by aligning talent with education and industry. Its talent discovery platform uncovers students' natural talents and aligns them with suggested best-fit, high-demand pathways and careers. Knowing the careers for which their interests and skills are best suited, can help students

focus on learning more about the education and skills required for those careers.

Guidance counselors provide the innovative tools to ninth through twelfth-grade students. They also help parents and students better understand career aptitude results and recommend next steps for students. Any students who have not yet completed a YouScience assessment can do so at www.youscience.com and check with their counselor for login information.



FUTURE GEORGIA EDUCATORS

Bulloch County Schools' Teaching as a Profession career pathway helps to lead students to education professions. The school district hosts an annual Georgia Future Educators' Signing Ceremony to honor high school graduates, who have completed the pathway program and plan to pursue education majors in college. The Teaching as a Profession career pathway is part of the district's Career Technical & Agricultural Education program. The courses provide students an

opportunity to explore the field of education and its possibilities. The career pathway is also one of the initiatives the school system implemented to help create a future pool of culturally diverse Bulloch County education leaders for possible future positions with the school district. The 2019 Future Georgia Educators were Malory Gagne, Cara Richardson, Hope Hutchens, Shanya Mikell, Allison Martin, Addison Platt, and Jackson Hamilton.

GRADUATION PERFORMANCE ACADEMY

Free summer & night school option helps students catch up or move ahead

Bulloch County Schools provides high school and select middle school students the opportunity to earn academic credits outside of the regular school day to either recover credits in order to graduate on time, or to move ahead and graduate early. Launched in January 2018, with a \$196,000 federal grant, the GPA has already served nearly 300 students.

Located in the William James Educational Complex at the rear of the district's Central Office, the GPA operates from 4:15 p.m. until 6:45 p.m., Monday through Thursday during the school year. In the summer two, three-hour sessions are offered for students to either choose a morning or afternoon half-day or combine them for a full-day.

The GPA's flexible hours plus free meals and bus transportation help remove any barriers to student participation. The program is one initiative to help further reduce the dropout rate and continue to raise the district's graduation rate, which is currently 85.1 percent.

Students in the GPA have support from the program's guidance counselor, who serves as a graduation specialist, and four certified teachers, one for each of the four core subjects. The program has proved to be just the boost that some students need to then dual-enroll at one of Bulloch County's three post-secondary institutions or be employed at one of the many available work-based-learning job sites.

RESOURCE OPTIMIZATION



New playground
at Stilson
Elementary



New athletic complexes
at three
middle schools



New right-turn lane
lane at Sallie Zetterower
Elementary **improves**
traffic flow



New playground
at Mill Creek
Elementary
School

E-SPLOST FUNDS CAPITAL IMPROVEMENTS FOR SCHOOLS

Since 2003, the Bulloch County Board of Education has leveraged Statesboro's growth as a regional retail sales and tourism hub to fund capital improvement needs for our public schools. This is done by using an education special purpose local option sales tax (E-SPLOST) which reduces the need or extent of property taxes or future millage rate increases. E-SPLOSTs also cause the tax burden to be shared more fairly among property and non-property owners and leverage the sales taxes paid by visitors to our community.

In November 2017, more than 90 percent of voters approved to continue the collection of a one-cent education special local option sales tax for an additional five years (January 2019- December 2023). Previously approved in 2003, 2005, and 2009, this fourth E-SPLOST allowed the Bulloch County Board of Education to secure \$43 million in bonds in June 2018, in order to immediately begin capital improvements to school and athletic facilities. These needs were identified by each school's principal and were reviewed and prioritized by a community committee.

Since 2016, the school system has made significant capital improvements funded by remaining E-SPLOST III funds and bond proceeds leveraged from approval of E-SPLOST IV. For complete information about E-SPLOSTs I-IV and the progress of current projects visit www.bullochschoools.org/esplost.



Groundbreaking for
new Portal Middle High
School **Agricultural**
Education Barn



Athletic **track**
resurfacing at
Statesboro High
School



Construction progress
for Portal Middle High
School **Agricultural**
Education Barn



Nevils
canopy wall
and connection
of west wings



Portal Middle
High School
Athletic Complex
improvements



New
playground
at Portal
Elementary School

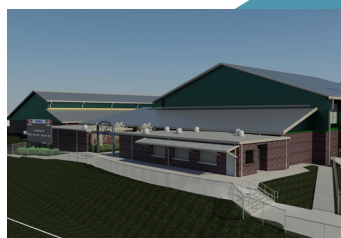

Portal Middle
High School
Concessions &
Fieldhouse additions



Electronic
retractable
bleachers installed
in all middle school gyms

FINANCIAL TRANSPARENCY AND EFFICIENCY

GENERAL FUND HIGHLIGHTS (\$ MILLIONS)

Fiscal Year	QBE Revenues	Property Tax Revenues	Local Option Sales Tax Revenues	Total Revenues	Total Expenditures	Revenues over/(under) Expenditures	Ending Fund Balance
FY '10	\$36.70	\$16.40	\$9.70	\$70.10	\$68.60	\$1.50	\$13.40
FY '11	\$41.40	\$17.30	\$10.00	\$73.10	\$66.60	\$6.50	\$19.90
FY '12	\$39.30	\$17.10	\$10.40	\$69.10	\$68.90	\$0.20	\$20.10
FY '13	\$39.50	\$16.60	\$9.60	\$69.10	\$69.30	-\$ (0.2)	\$19.90
FY '14	\$38.40	\$16.50	\$9.90	\$68.80	\$71.00	-\$ (2.2)	\$17.70
FY '15	\$44.80	\$17.40	\$10.40	\$78.40	\$75.60	\$2.80	\$20.50
FY '16	\$47.30	\$17.20	\$10.30	\$78.70	\$82.70	-\$ (4.0)	\$16.50
FY '17	\$52.10	\$17.60	\$10.60	\$84.30	\$86.00	-\$ (1.7)	\$14.80
FY '18	\$58.20	\$18.20	\$10.80	\$91.80	\$89.80	\$2.00	\$16.70
FY '19 (In Progress)	\$56.50	\$18.30	\$10.30	\$89.50	\$84.90	\$4.60	\$16.70
FY '20 (Budgeted)	\$66.50	\$19.00	\$11.40	\$101.60	\$101.80	-\$ (0.2)	\$16.90

*For complete budget information on all Bulloch County Board of Education funds, capital projects, ESPLOST and state audit reports, visit www.bullochschoools.org/budget

FISCAL YEAR 2020 ALL FUNDS BUDGETED

Total General Fund Expenditures - \$143,048,435

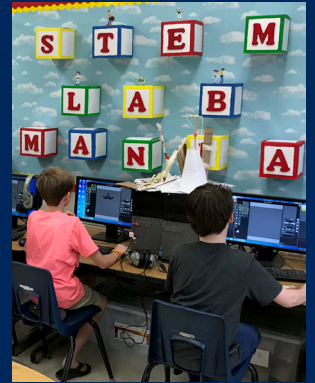
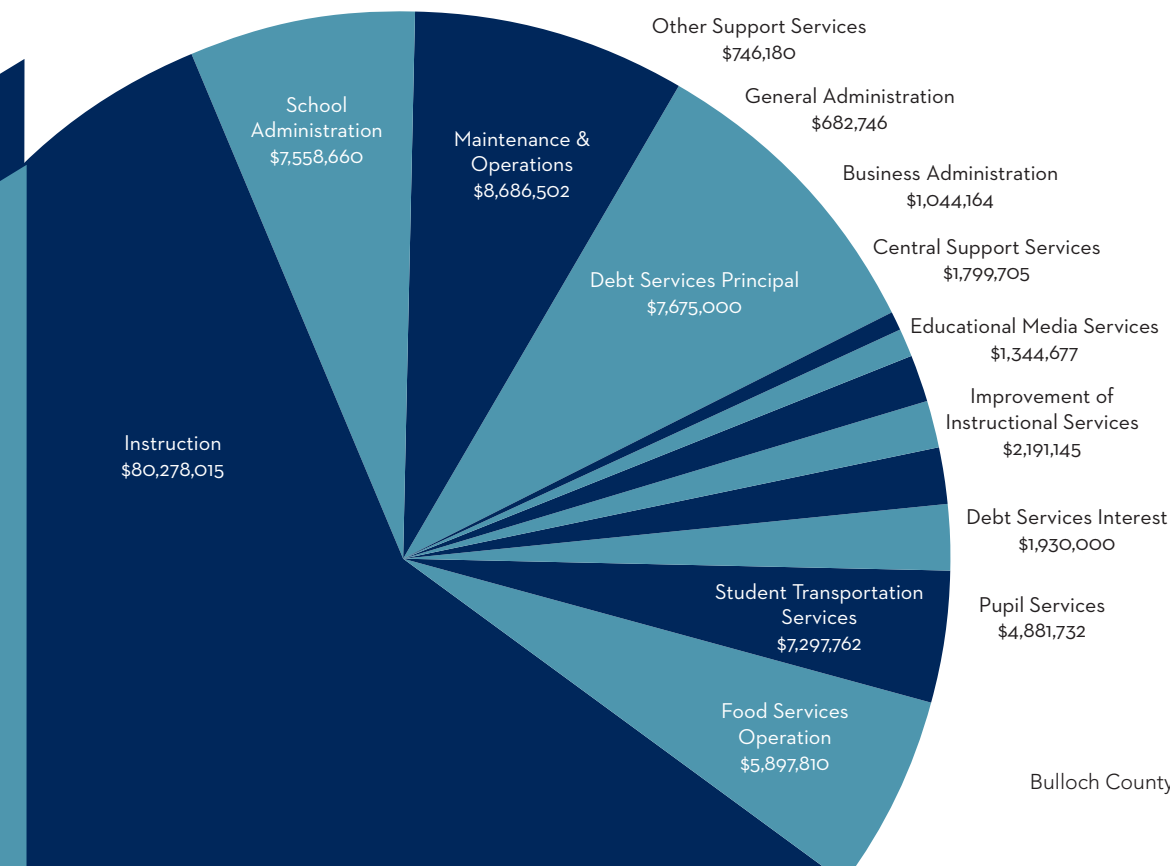

FINANCIAL HIGHLIGHTS

3.5 of 5 Stars

Financial Efficiency Rating

AA-

Standard & Poor's Credit Rating

7%

Fiscal Year 2020 Raise for non-certified employees

\$3,400

Raise for teachers Fiscal Year 2020 (certified employees)

\$2 per-hour raise

for school bus drivers

Bulloch County Schools

BULLOCH COUNTY SCHOOLS REPORT CARD

SCHOOL CLIMATE & FINANCIAL EFFICIENCY BY SCHOOL

School climate has a significant effect on a child's ability to achieve academically. Georgia is the first state in the nation to require its school systems to be accountable for their school climates and financial efficiency. These are the components of the school climate and financial efficiency data for each of our schools. This data is released annually by the Georgia Department of Education in October and January. For more accountability data for our school system and schools, visit www.bullochschoools.org/accountability.

SCHOOL	School Climate Score (100 pt. scale)	Perception of a school's climate based on responses from the state's annual GA School Climate Surveys.			Discipline	Safe & Substance-Free Environment	Attendance Rate	Financial Efficiency (Out of 5 Stars) <small>School's impact on student achievement in relation to per-pupil expenditure</small>
		Student	Faculty/Staff	Parents	The closer to 100, the more positive the school environment (100-pt. scale)			
BES	93.4 (4 Stars)	75.63	84.87	87.54	97.93	96.72	96.15	4.0
JPBES	93.0 (4 Stars)	74.27	88.04	89.87	94.39	96.91	96.82	4.0
LCES	89.4 (3 Stars)	70.13	75.53	83.34	90.77	96.36	94.04	2.0
LCMS	82.10 (3 Stars)	67.16	73.04	77.81	72.55	89.92	93.35	3.0
MLES	91.60 (3 Stars)	71.63	81.83	91.77	96.15	94.78	93.92	1.5
MCES	89.10 (3 Stars)	73.99	81.05	82.51	87.31	94.92	95.04	3.0
NES	94.3 (4 Stars)	79.38	87.63	84.92	98.05	100	95.03	3.0
PES	91.9 (4 Stars)	78.36	85.48	85.65	96.12	94.87	93.48	2.5
PMHS	84.40 (4 Stars)	69.96	80.83	69.81	83.58	88.98	91.67	2.0
SZES	92.90 (4 Stars)	74.87	87.33	87.49	96.58	97.84	93.77	3.5
SEBHS	81.10 (3 Stars)	n/a	79.12	73.51	88.69	92.30	92.46	4.5
SEBMS	85.1 (4 Stars)	69.28	80.86	77.14	85.48	88.27	95.04	4.5
SHS	80.10 (3 Stars)	59.47	76.72	70.64	68.98	89.42	93.02	4.0
SES	93.0 (4 Stars)	73.45	83.72	87.26	98.43	96.67	95.40	2.0
WJMS	83.6 (4 Stars)	68.43	76.0	74.80	78.26	88.40	94.85	3.5

**Bulloch
County
Schools**

WWW.BULLOCHSCHOOLS.ORG

BULLOCH COUNTY SCHOOLS REPORT CARD

COLLEGE & CAREER READINESS PERFORMANCE INDEX (CCRPI)

The College & Career Ready Performance Index (CCRPI) is Georgia's comprehensive school accountability measurement tool. The overall CCRPI score is based on a 100-point scale. It measures schools' and their school systems' performance in four areas: Content Mastery; Academic Progress; Closing the Achievement Gap; and College & Career Readiness. For high schools, the graduation rate is added as a fifth measurement area.

CCRPI scores are the basis for accountability in Bulloch County Schools' five-year Strategic Waivers School System (SWSS) contract with the Governor's Office of Student Achievement (GOSA). The district's 2015-16 (FY '16) CCRPI scores are the baseline performance data year for the contract. From the baseline year (2016) through 2021, the district's 15 schools must show at least a three percent improvement each year on the gap between the 2016 score and a perfect score of 100. To See Bulloch County Schools' performance on all state and national assessments, visit www.bullochschoools.org/accountability. Bulloch County Schools' overall district score for 2018 was 74.8, which resulted in grade of C from the GOSA.

ELEMENTARY	Content Mastery	Progress	Closing Achievement Gap	College & Career Readiness	2018 CCRPI Total Score
Component Weight	30%	35%	15%	20%	100%
Georgia	65.7	84.4	85.0	79.1	77.8
Bulloch	63.2	80.7	63.2	80.3	72.7
BES	78.0	80.2	77.3	83.7	79.8
JPB	68.0	96.0	75.0	83.4	81.9
LCES	39.9	68.2	70.5	73.8	61.2
MLES	55.5	80.8	11.1	78.2	62.2
MCES	60.1	70.8	65.0	78.5	68.3
NES	71.8	79.7	62.5	83.3	75.5
PES	76.3	74.8	86.1	82.6	78.5
SZES	57.8	79.3	47.7	78.2	67.9
SES	58.5	80.5	89.3	80.5	75.2



MIDDLE	Content Mastery	Progress	Closing Achievement Gap	College & Career Readiness	2018 CCRPI Total Score
Component Weight	30%	35%	15%	20%	100%
Georgia	65.1	81.0	78.8	82.4	76.2
Bulloch	65.3	86.3	81.3	82.4	78.5
LCMS	51.7	79.4	73.2	76.7	69.6
Portal (6-8)	56.0	78.1	37.5	82.6	68.7
SEBMS	78.3	94.9	75.0	85.5	85.1
WJMS	64.7	84.7	100.0+	83.9	80.8

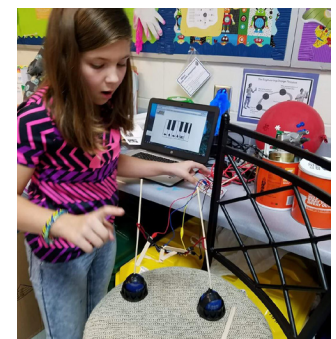

HIGH	Content Mastery	Progress	Closing Achievement Gap	College & Career Readiness	Graduation Rate 4-Year	2018 CCRPI Total Score
Component Weight	30%	35%	10%	15%	15%	100%
Georgia	66.9	83.0	70.0	73.4	82.0	75.3
Bulloch	65.9	84.6	69.4	72.7	85.1	75.8
PHS	58.0	78.8	61.8	70.8	86.2	70.8
SEBHS	77.7	90.5	96.3	72.2	88.5	84.2
SHS	59.5	83.8	42.7	73.2	82.8	70.7



STUDENT RECOGNITIONS

Professional
Association of
GA Educators

**BULLOCH
COUNTY STAR
STUDENT**

Abby McMillan
Southeast Bulloch
High School

National FFA Organization

**7th PLACE IN NATION
Nursery/Landscape
Career Development
Event Team**

Amonica Kirkland, Cayla
Morris, Caree McGahee, &
Heidi Sawyer
Portal Middle High School

Georgia FCCLA
Leadership
Conference

**19 GOLD &
2 SILVER MEDALS**

Statesboro High
FCCLA Chapter

Georgia FCCLA

**FIRST STATE
OFFICER ELECTED**
in school history

Keylee Phillips of
Statesboro High
GA FCCLA
Vice President of
Community Service

WE CAN HELP

*Students & families collect
over three tons of food*

Bulloch County Schools hosted a We CAN Help food drive on Nov. 5 - 9, 2018, for our community's two local food banks. The project was in partnership with Woodmen Life Chapter 158's Fight Food Insecurity campaign and in recognition of National Hunger & Homelessness Awareness Month.



SEB CULINARY ARTS STUDENT EARNS STATE HONOR

Athena Russell of Southeast Bulloch High School was named a ProStart Student of the Year state finalist. The ProStart Student of the Year Award represents the best of Georgia's culinary arts students and reflects great accomplishment and excellence in the career pathway. Russell was offered a \$2,000 scholarship from Coca-Cola and the Georgia Restaurant Association to support her post-secondary culinary arts education.

STUDENTS RAISE \$6.2K FOR LITERACY

Students and teachers from Bulloch County Schools raised more than \$6,200 in September 2018 for First Readers of Bulloch County. By donating their spare change in a competitive drive, more than 5,200 children from 300 classrooms collected 742 pounds of change.

First Readers of Bulloch County partners with the school district to encourage reading, improve literacy in pre-school children, and encourage families to read at home by supplying free books. First Readers mails new books and literacy materials free of charge each month to children in Bulloch County who are five-years-old and younger.



MATTIE LIVELY ELEMENTARY PRE-K STUDENT WINS \$1.5K FOR COLLEGE

**GA Path2College 529 Plan
& DECAL selects four state winners**

Sarah Porter, a pre-kindergarten student at Mattie Lively Elementary School was selected as one of four state winners in the second annual Pre-K to College Sweepstakes. Porter and each state winner received \$1,529 for their college savings, and their schools each received \$529. The contest is sponsored by the Georgia Path2College 529 Plan and the Department of Early Care and Learning (DECAL).

SEB ADVANCED CHORUS WINS NATIONAL CHORAL FESTIVAL

Group also marks 10 years of superior ratings by GA's music educators

Southeast Bulloch High School's Advanced Chorus earned the highest rankings at the Festival of Gold in San Francisco, California in April 2019. Under the leadership of Choral Director Brent Whitaker, the 48-member Advanced Chorus was invited to participate in the exclusive national festival which is reserved for the most elite choirs in the nation. Dr. Anton Armstrong of the St. Olaf Choir, and Dr. Craig Jessop of the "Singing Sergeants" and the Mormon Tabernacle Choir were both clinicians and judges for the event. This year the Advanced Chorus also celebrates a decade of straight superior ratings from the Large Performance Group Ensemble festival by the Georgia Music Educators Association (GMEA).



FACULTY & STAFF RECOGNITIONS

GA Assoc. of Teachers
of Family and
Consumer Sciences

Carl Perkins
Outstanding Service
Nominee

Bethany Gilliam
Statesboro High
School

Georgia School Public
Relations Association

GOLD AWARDS
For Annual Report; Student
Handbook; and Multimedia
& Film Categories

Hayley Greene
Public Relations & Mkt.
Specialist

Bulloch County Schools
Aspiring Leaders
Program Alumni

PROMOTION
Statesboro High School

Chad Prosser
Promoted from assistant
principal to principal

Bulloch County Schools
Aspiring Leaders Program
Alumni

PROMOTION
SEB Middle School

Brad Boykin
Promoted from assistant
principal to principal

2018-2019 SCHOOL-LEVEL TEACHERS OF THE YEAR

Tasheina White	Brooklet Elementary School
Daisy Lewis	Julia P. Bryant Elementary School
Marci Cochran	Langston Chapel Elementary School
Triann Favors	Langston Chapel Middle School
Kem Dennard	Mattie Lively Elementary School
Paige L. Rountree	Mill Creek Elementary School
Nicole Riggs	Nevils Elementary School
Samantha Motes	Portal Elementary School
Valarie Thompson	Portal Middle High School
Diana Hendricks	Sallie Zetterower Elementary
Courtney Alligood	Southeast Bulloch Middle School
Steven Bonnette	Southeast Bulloch High School
Meredith Simmons	Statesboro High School
Anna Swint	Stilson Elementary School
Kimberly Wagoner	William James Middle School
Stacy Cowart	Pre-K Teacher of the Year (SEBHS)

2018-19 BULLOCH COUNTY SCHOOLS RETIREES

This year's retirees have served our community a total of 901 years.

Denise Brookins	Beverly Schofill	Jo McCullough
Nancy Moseley	Carolyn Wright	Dorothy Wilkerson
Julie Chambers	Christie Page	Roosevelt Martin
Lisa Sapp	Dana DiNitto	Lue Wiggins
Annette Milton	Jennifer Quick	Willie Wooden
Nancy Smith	Dr. Debbie Cartee	Larry Williams
Dr. Virginia Bennett	Katherine Roberson	Emerson Chester
Dr. Ken LeCain	Janice Wilson	Felecia Prince
Cynthia Davis	Lucy Brinson	Rebecca Anderson
Patricia Akins	Sandra Stall	Vickie Bohannon
Karen LeCain	John Page	Robert Ware
Vicky Marshall	Barbara Brinson	Gwendolyn Lane
Deloris McCall	James Freeman	
Ruby Mikell	Donald Garrick	

TASHEINA WHITE, 2018-2019 BULLOCH COUNTY TEACHER OF THE YEAR (COHORT 2020)

Tasheina White, the music teacher and choral director for Brooklet Elementary School (BES), is the 2020 Bulloch County Teacher of the Year.

An educator with 10 years of experience, she has served BES and Bulloch County for four years. She obtained a Masters of Art in Teaching (MAT) for Music Education from Piedmont College and a Bachelor of Music (B.Mus.) in Music Therapy from the University of Georgia.

During her four years at Brooklet Elementary School, White has managed to build a chorus of over 60 voices, create a dynamic step team, and write two original musicals for her students to perform. She also serves on the school's Lighthouse Team which manages a leadership operating system at the school.



2019 TRANSPORTATION HONORS

Director's Cup	John Whitaker
Special Director's Award	Brad Boykin, Principal of SEB Middle
Bus Monitors of the Year	Betty Tremble & Ruby Hill
Service Technician	Stephen Peavy
Team Brooklet	Paula Watson
Team Julia P. Bryant	Kenneth West
Team Langston Chapel	Tim Mock
Team Mattie Lively	Ernest Harris
Team Mill Creek	Faith Mobley
Team Nevils	Edward Rich
Team Portal	Frances Robinson
Team Sallie Zetterower	Stacey Goode
Team Stilson	Cindy Powell
Team Special Education	Lucinda Walker

BULLOCH COUNTY FOUNDATION FOR PUBLIC SCHOOL EDUCATION

*A charitable foundation that supports
these worthwhile education programs*

*REACH GA Scholarships • STAR Student/Teacher
Innovation Grants to Teachers • Teacher of the Year Program*



\$1,000

The grant amount provided
each year to the
Bulloch County
Teacher of the Year

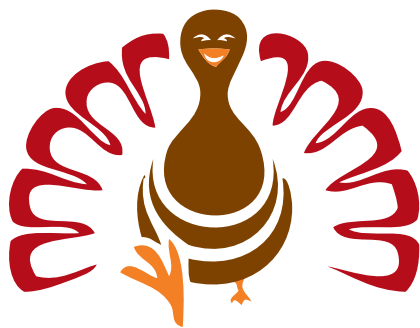

300+

People who annually
participate
in one of our main
fundraisers
Statesboro Turkey Trot 5K

Saturday before
Thanksgiving;
In Downtown Statesboro

Innovation Grants

Since 2006, the Bulloch County Foundation for Public Education (Foundation) has funded more than 200 innovative teacher grants totaling nearly \$250,000 to fund learning experiences for Bulloch County children.

Charitable Giving

The Foundation provides a way for individuals, businesses, industries and civic organizations to invest in local education programs that benefit public, charter, private and home-schooled students. In addition, the Foundation's two major fundraising campaigns are the Statesboro 5K Turkey Trot and Bulloch County Schools' Jeans Fridays, which is an employee payroll deduction option.

College Scholarships

The Foundation funds Bulloch County Schools' annual participation in the REACH Georgia Scholarship Program with a \$7,500 annual contribution. As a result, each year five graduating REACH scholars each receive \$20K - \$30K in scholarships for college in addition to the HOPE scholarship.

STAR Student / STAR Teacher

The Foundation is the local underwriting sponsor for the Professional Association of GA Educator's STAR program. The Foundation's financial support makes this program possible locally for Bulloch County's public, private and charter schools.

Teacher of the Year Program

The Foundation is one of the main corporate sponsors for Bulloch County Schools' Teacher of the Year program. The Foundation annually provides a \$1,000 grant to the district's teacher of the year.

We've provided to help
make college possible for

Bulloch's **35** REACH
Georgia Scholars since
2013



\$250,000

Innovation grant funds provided
to more than 200 teacher
projects since 2006



**Bulloch
County
Schools**

150 Williams Road, Suite A | Statesboro, GA 30458
T: 912.212.8500 | F: 912.212.8529
www.bullochschoools.org | boe@bullochschoools.org



**ANNUAL REPORT
2019-2020**
proudly produced by

