

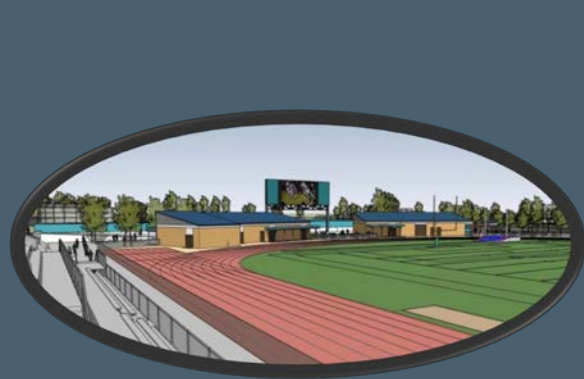

Hacienda La Puente Unified School District

Measure BB - Bond Projects Monthly Report



Regular Board Meeting
August 23, 2018

Business Services Division

Planning

- Accessibility compliance considerations of the design phase are in progress for the following projects:

School	21 st Century Classrooms	Interim Housing
Cedarlane K-8	X	X
Grandview K-8	X	
Mesa Robles K-8	X	X
Workman ES	X	
Nelson ES	X	
Los Altos ES	X	X

Planning – cont.

- Assessment of building elements have been completed for the following schools:

- Los Altos ES
- Nelson ES
- Workman ES
- Los Altos ES
- Baldwin ES
- Sunset ES
- Wing Lane ES
- California ES
- Cedarlane K-8
- Grandview K-8
- Mesa Robles K-8
- Newton MS
- Orange Grove MS
- Sierra Vista MS
- Sparks MS
- Lassalette TK-8
- Fairgrove K-8
- Valinda K-8
- Amar
- La Puente HS
- Wilson HS
- Workman HS
- Los Altos HS

Planning – cont.

- ❑ Design guidelines are being prepared by HED.
- ❑ 3D models prepared based on previously scanned classrooms are being used for preparing design guideline drawings.
- ❑ Architects to share their comments with HED so that they can be incorporated into the design guidelines.
- ❑ As of now, 46 pages of drawings (draft) have been prepared for design guidelines.
- ❑ The following slides are samples of draft documents.

Planning – cont.

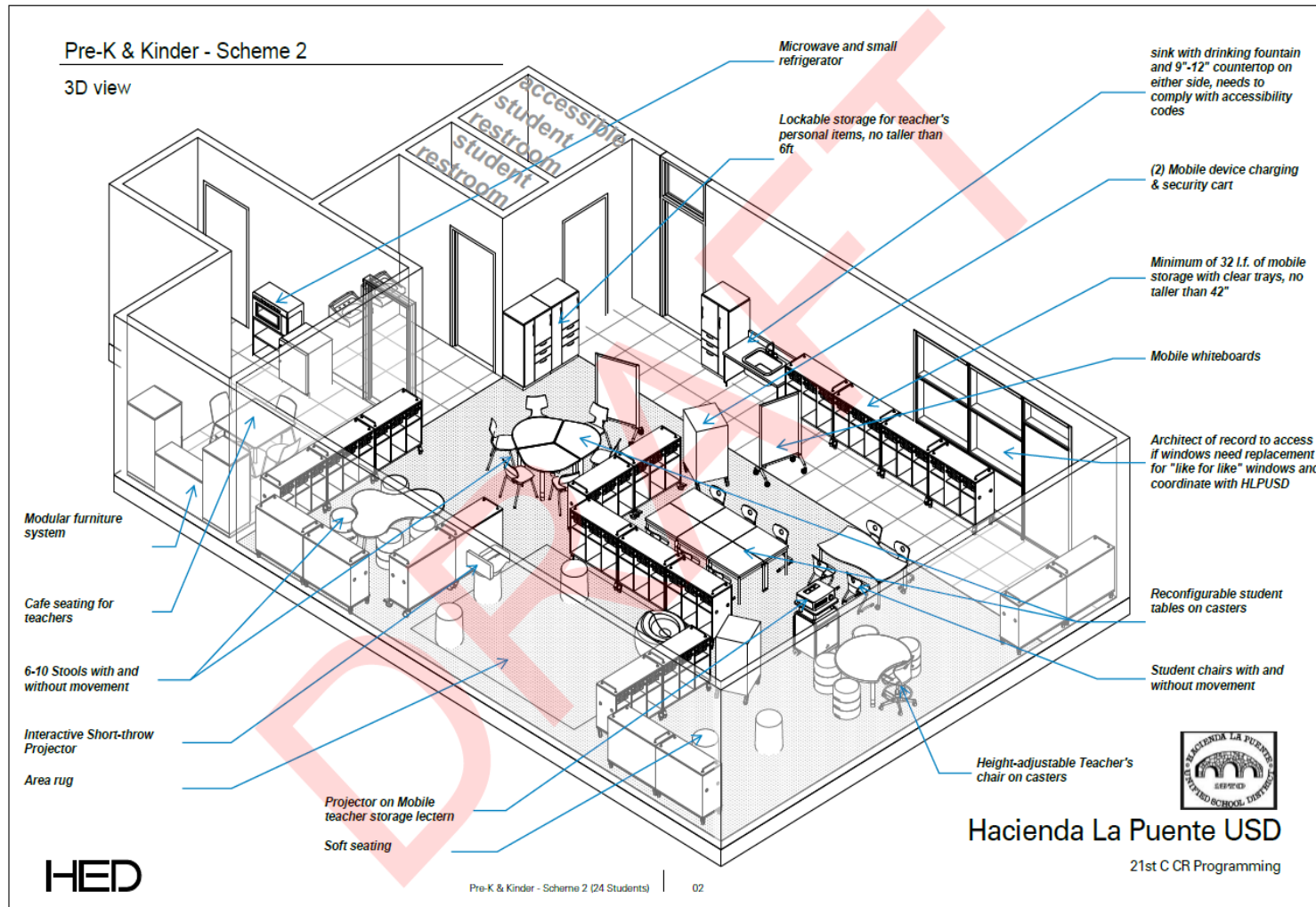

Planning – cont.

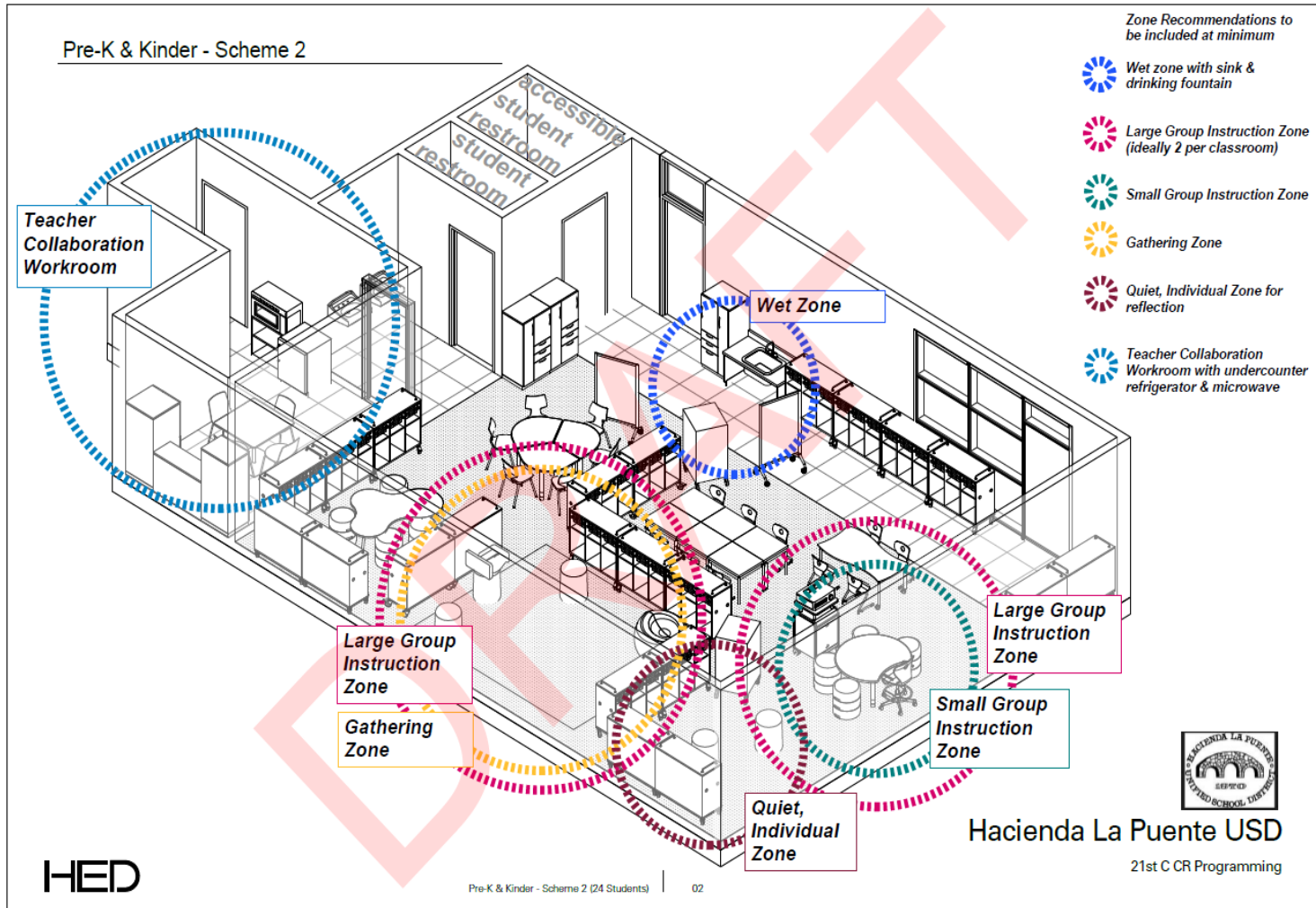

Planning – cont.

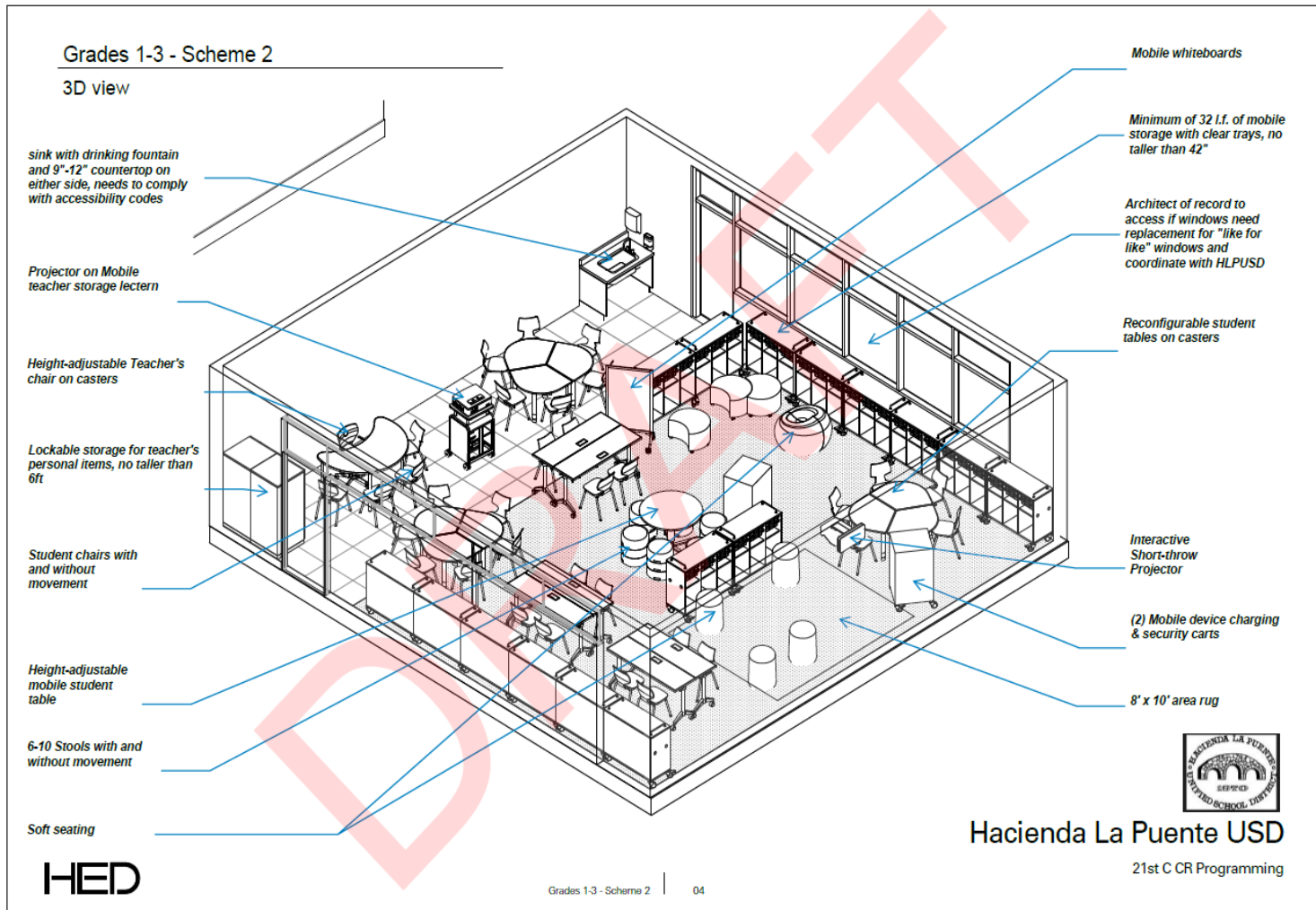

Planning – cont.

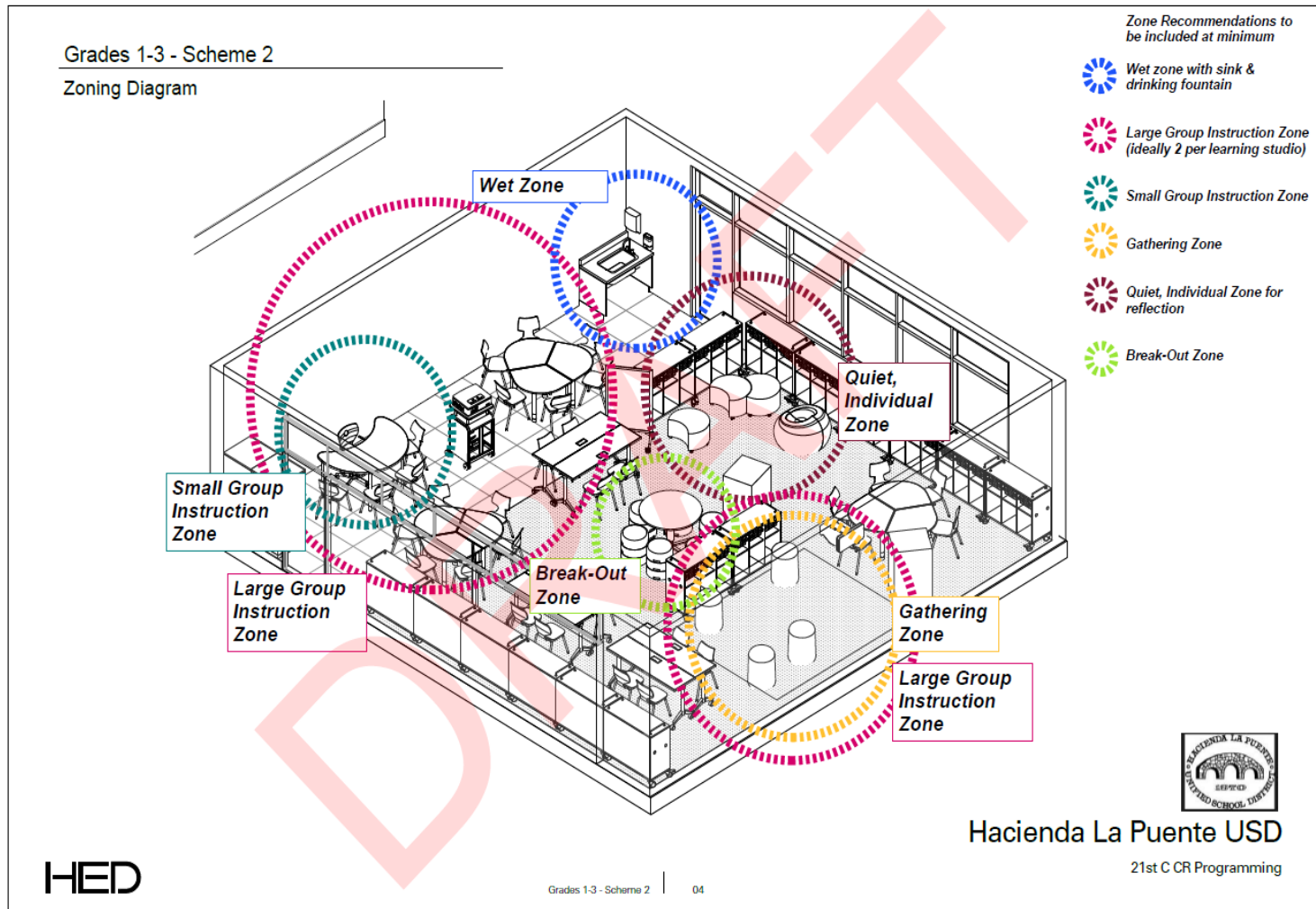

Planning – cont.

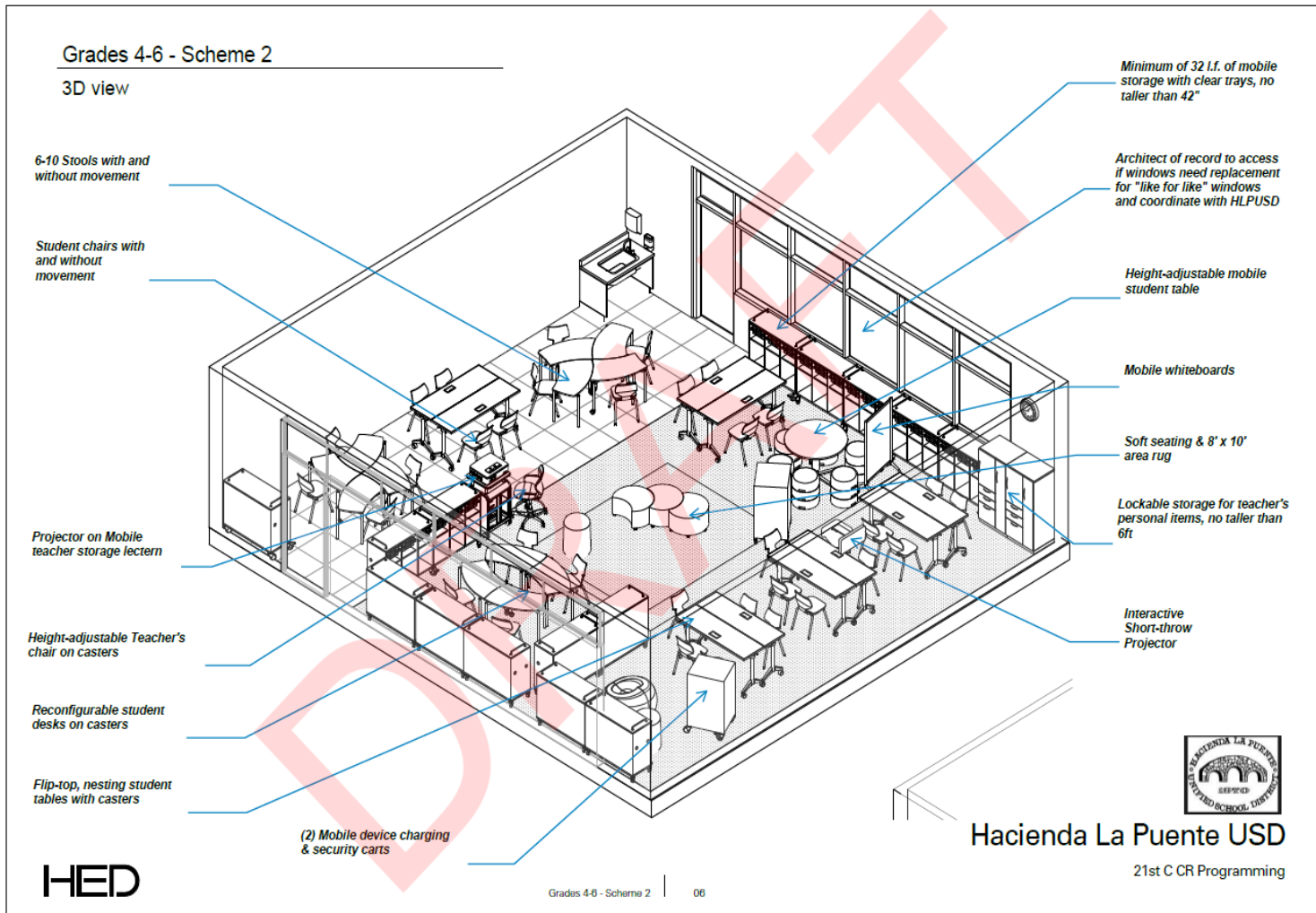

Planning – cont.

Grades 4-6 - Scheme 2

Zoning Diagram

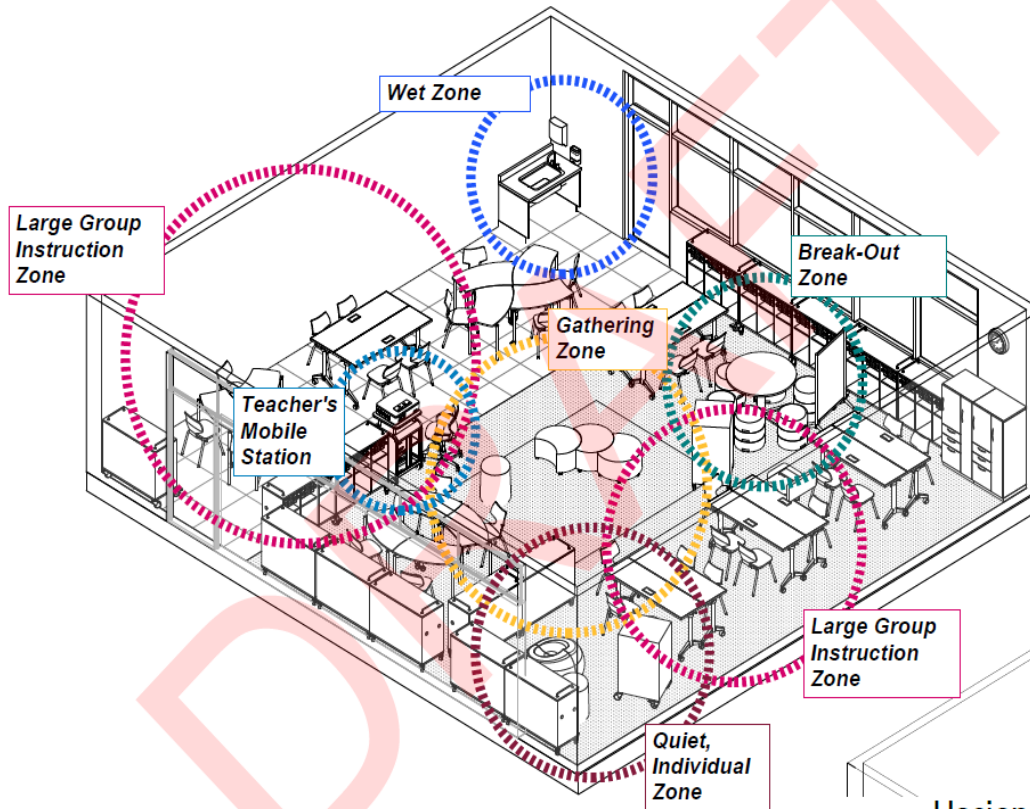

Zone Recommendations to be included at minimum



Wet zone with sink & drinking fountain



Large Group Instruction Zone (ideally 2 per learning studio)



Break-Out Zone for student small group collaboration



Gathering Zone



Quiet, Individual Zone for reflection



Teacher's Mobile Station



Hacienda La Puente USD

21st C CR Programming

Planning – cont.

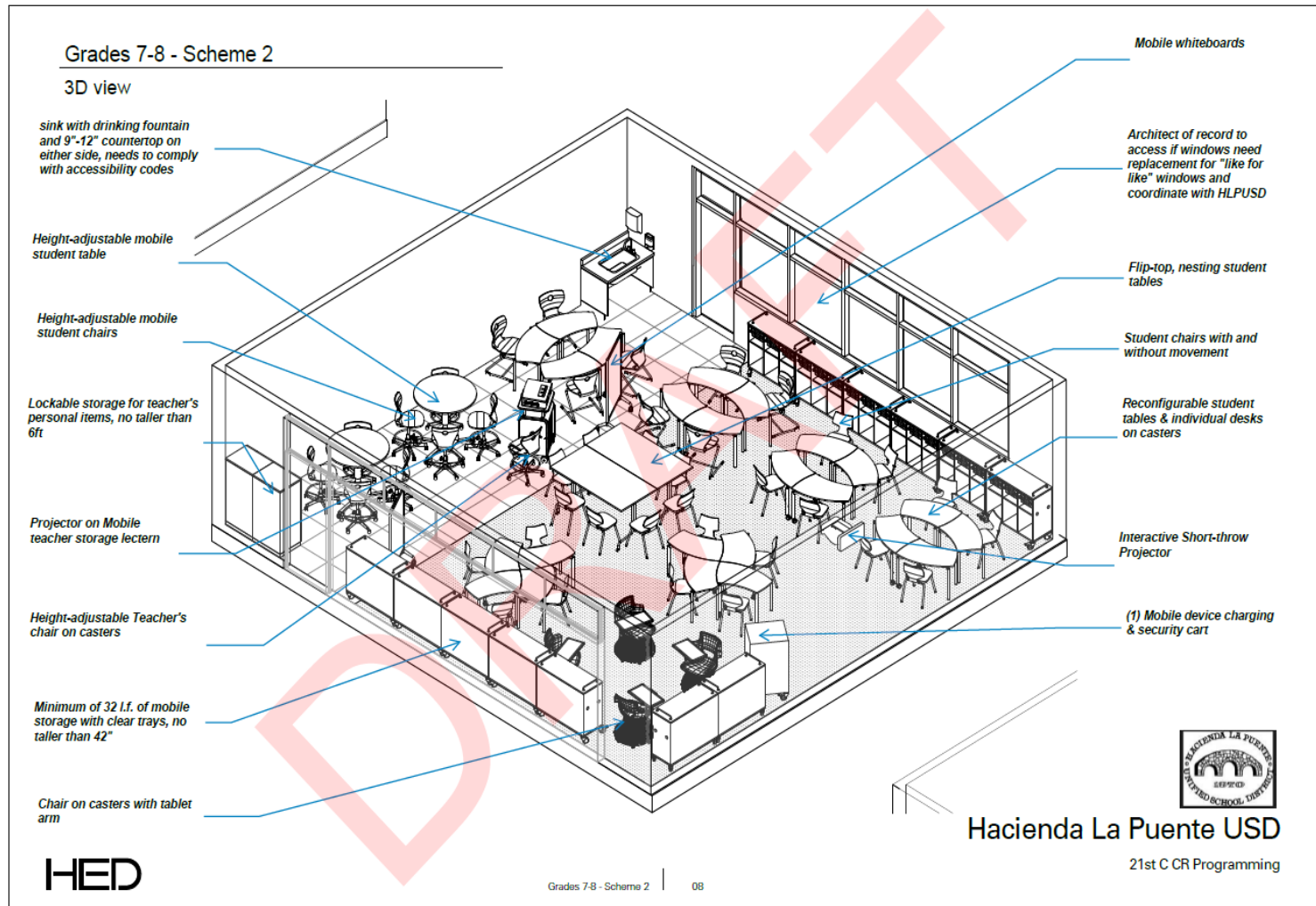

Planning – cont.

Grades 7-8 - Scheme 2

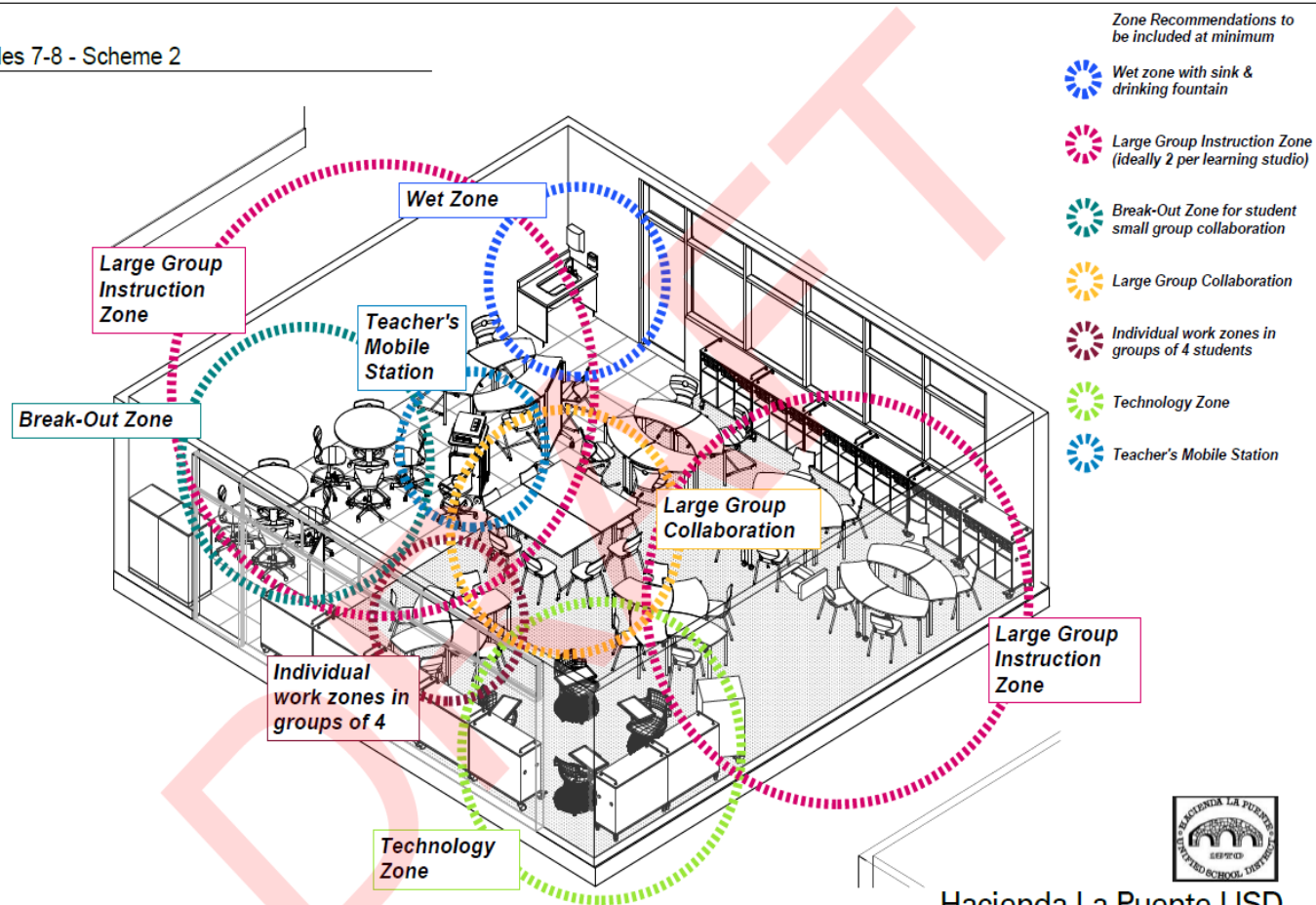

Planning – cont.

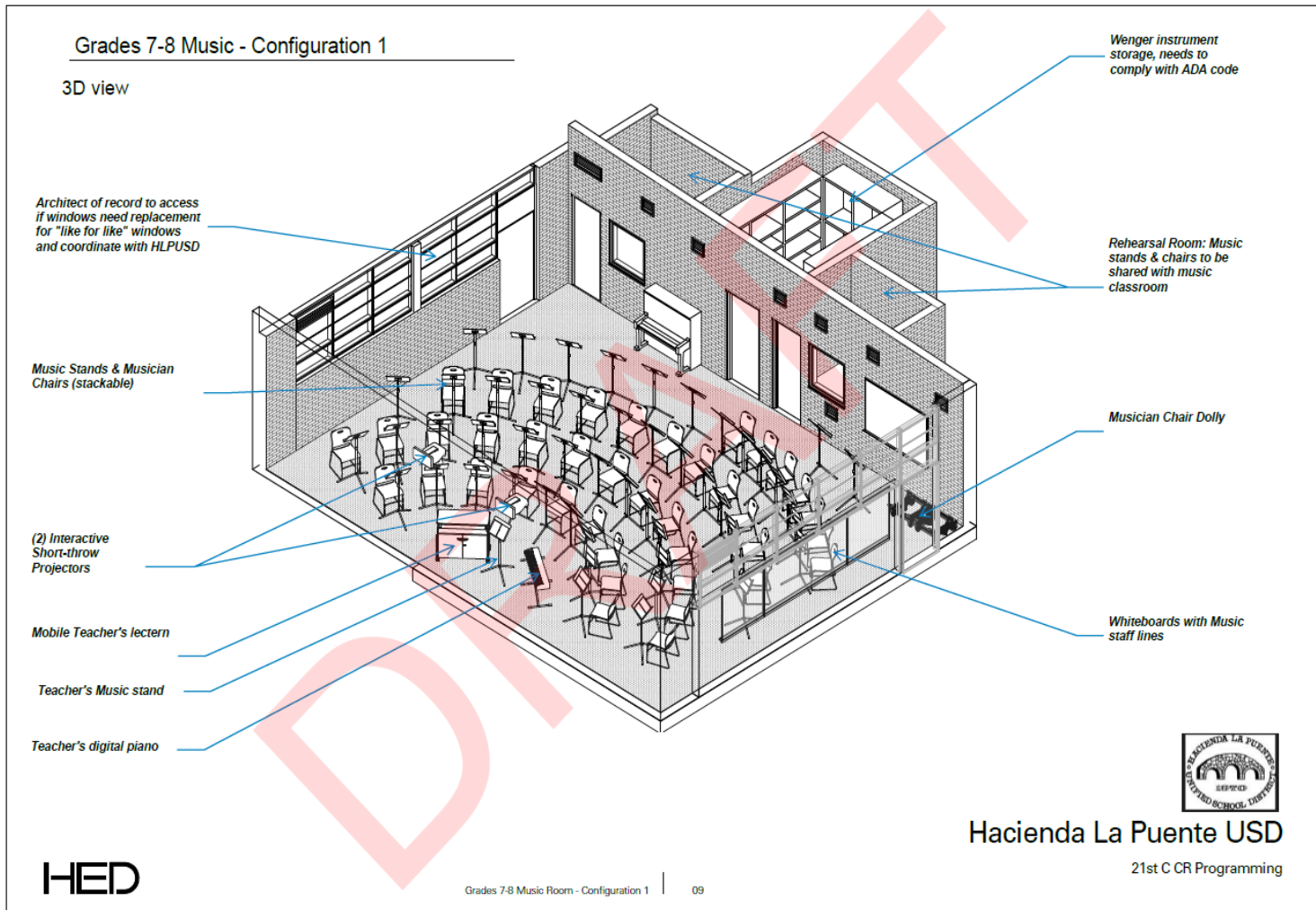

Planning – cont.

Grades 7-8 Music - Configuration 1

Wall Finishes

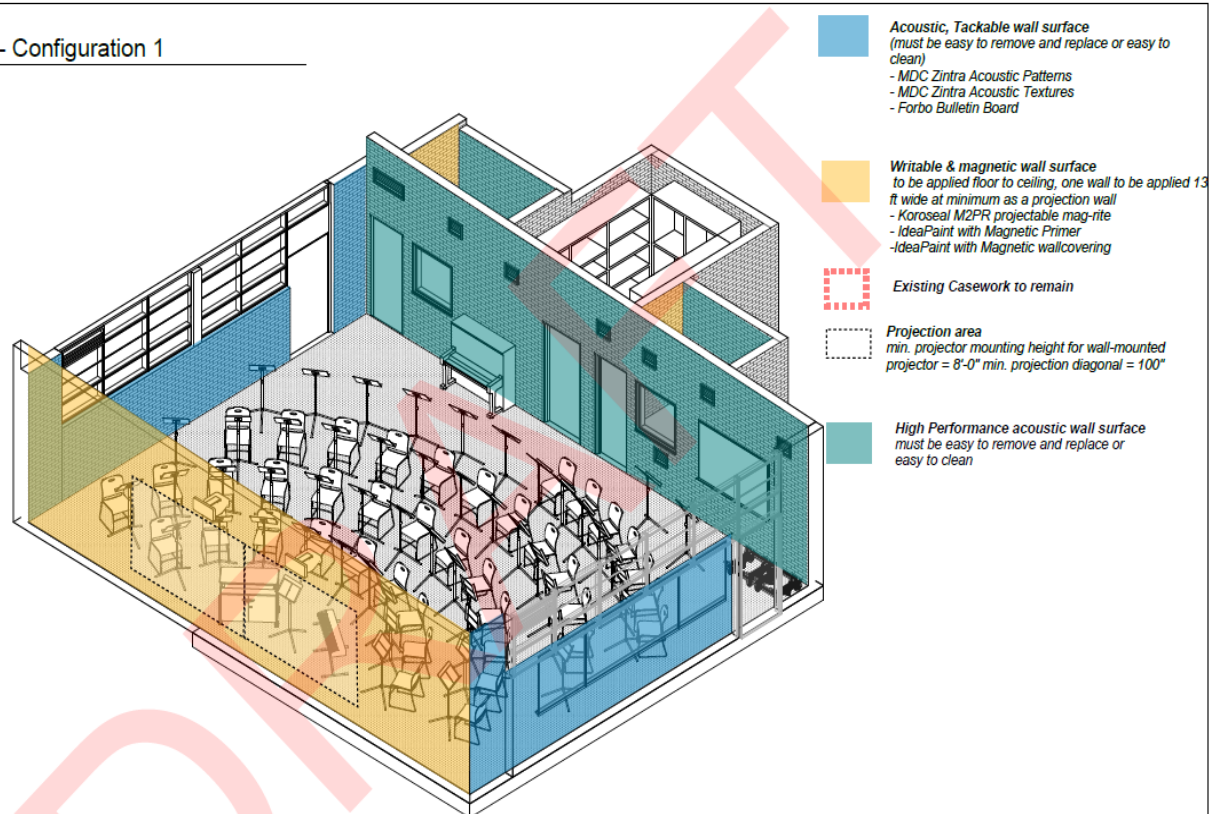

Hacienda La Puente USD

21st C CR Programming

Planning – cont.

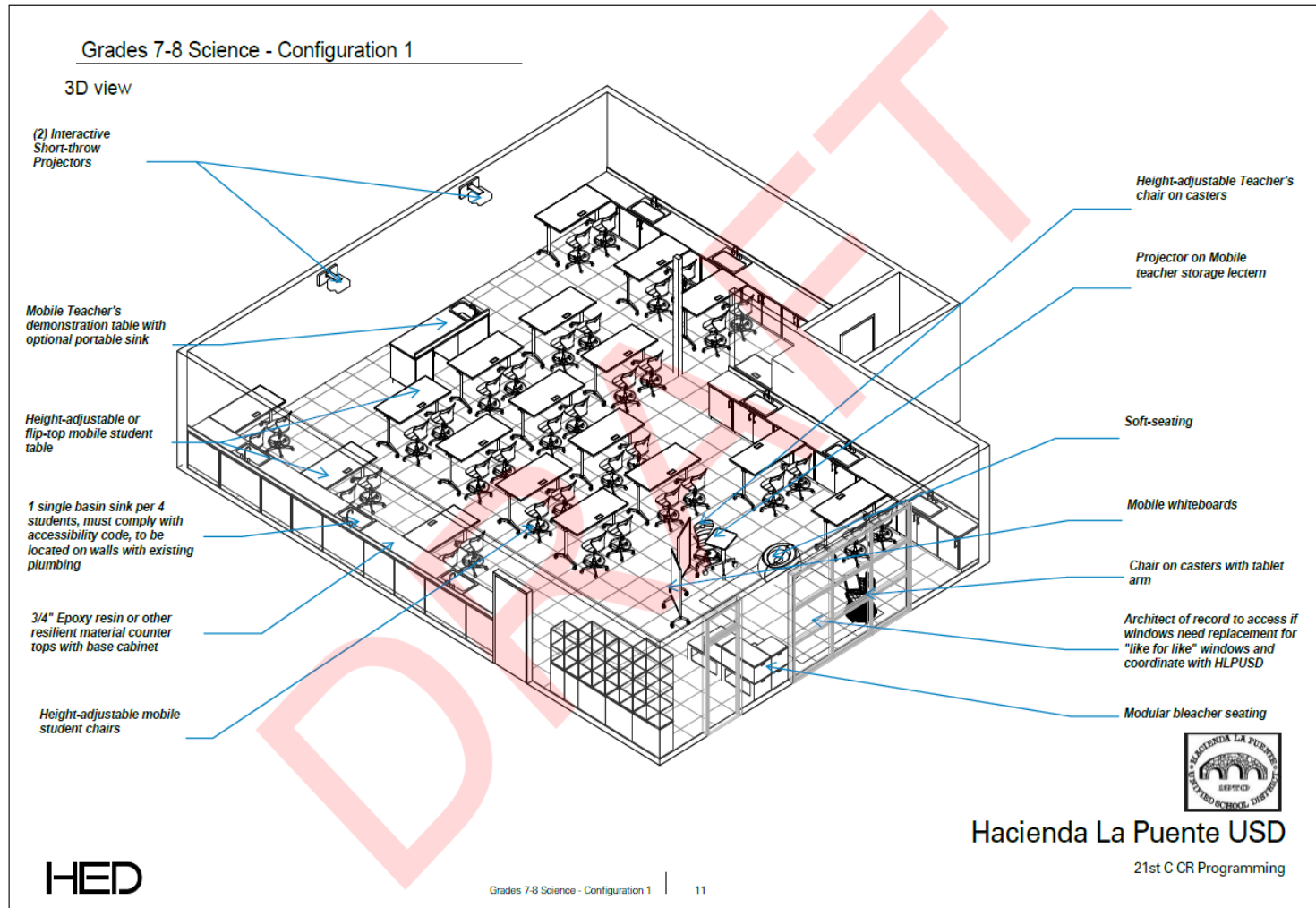

Planning – cont.

Grades 7-8 Science - Configuration 2

Wall Finishes

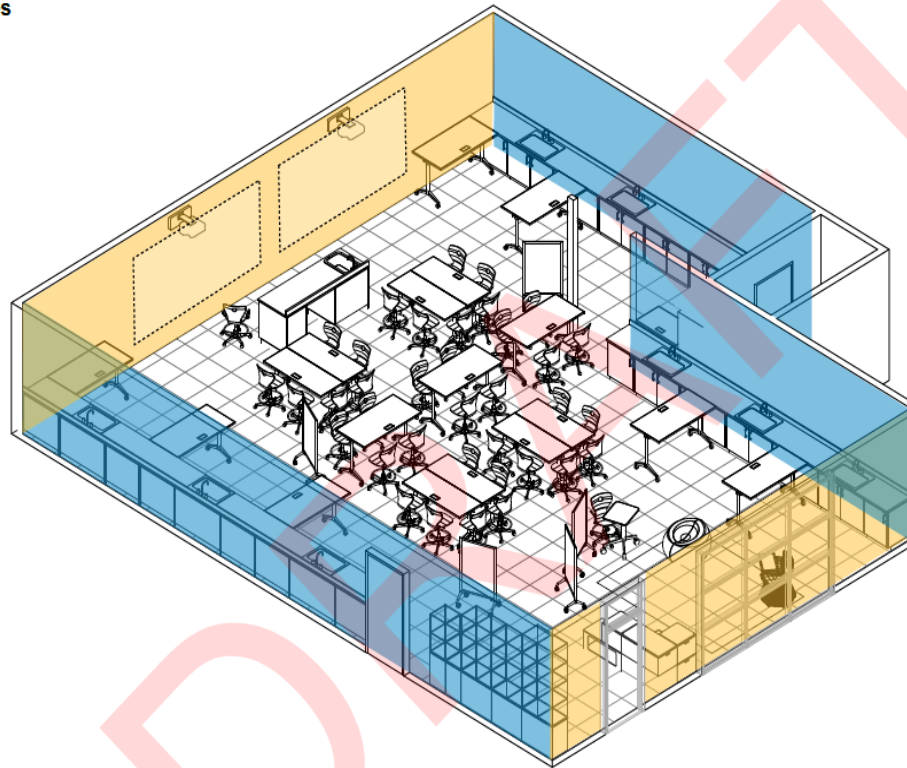

Acoustic, Tackable wall surface
(must be easy to remove and replace or easy to clean)
-Forbo Bulletin Board

Writable & magnetic wall surface
to be applied floor to ceiling, one wall to be painted 13
ft wide at minimum as a projection wall
-IdeaPaint with Magnetic Primer
-IdeaPaint with Magnetic wallcovering

Existing Casework to remain

Projection area
min. projector mounting height for wall-mounted
projector = 8'-0", min. projection diagonal = 100"



Hacienda La Puente USD

21st C CR Programming

Planning – cont.

- ❑ Currently evaluating:
 - ❑ DSA requirements for the 21st Century Classroom and Interim Housing projects.
 - ❑ School sites for future phases.



Thank you!