



# Hacienda La Puente Unified School District

## Measure BB - Bond Projects Monthly Report



Regular Board Meeting  
September 28, 2017

Business Services Division

# Latest News

- The Citizens Bond Oversight Committee (CBOC) was conducted on September 6, 2017

# Planning

- Phase 1 of the 21st Century Classroom Project:  
The Board of Education approved the following school sites for Phase 1 of the 21st Century Classroom Project:

- La Puente Quad: Nelson Elementary School
- Los Altos Quad: Newton Middle School
- Wilson Quad: Cedarlane Academy
- Workman Quad: Grandview Academy

# Planning

- Phase 2 of the 21st Century Classroom Project :  
The Board of Education approved the following  
school sites for Phase 2 of the 21st Century  
Classroom Project:

- La Puente Quad: Sparks Middle School
- Los Altos Quad: Los Altos Elementary School
- Wilson Quad: Mesa Robles School
- Workman Quad: Workman Elementary

# Planning

- ❑ Business Services Division held meetings with Phase 1 and Phase 2 schools' Principals on September 7<sup>th</sup>, 2017 and September 13<sup>th</sup>, 2017, to discuss about current schools' configurations
- ❑ Site maps provided to the Principals at the meeting for the schools' comments:

# Phase 1



## NELSON ELEMENTARY SCHOOL

330 N. CALIFORNIA AVENUE, LA PUENTE, CALIFORNIA 91744  
 HACIENDA LA PUENTE UNIFIED SCHOOL DISTRICT  
 15859 E. GALE AVE. LA PUENTE, CA 91749  
 COUNTY OF LOS ANGELES

DIAGRAM BUILDING AREAS	
<input checked="" type="checkbox"/>	EXISTING (1-2)
<input type="checkbox"/>	BASIC PLANS (2-4)
<input type="checkbox"/>	FINAL PLANS (3-4)

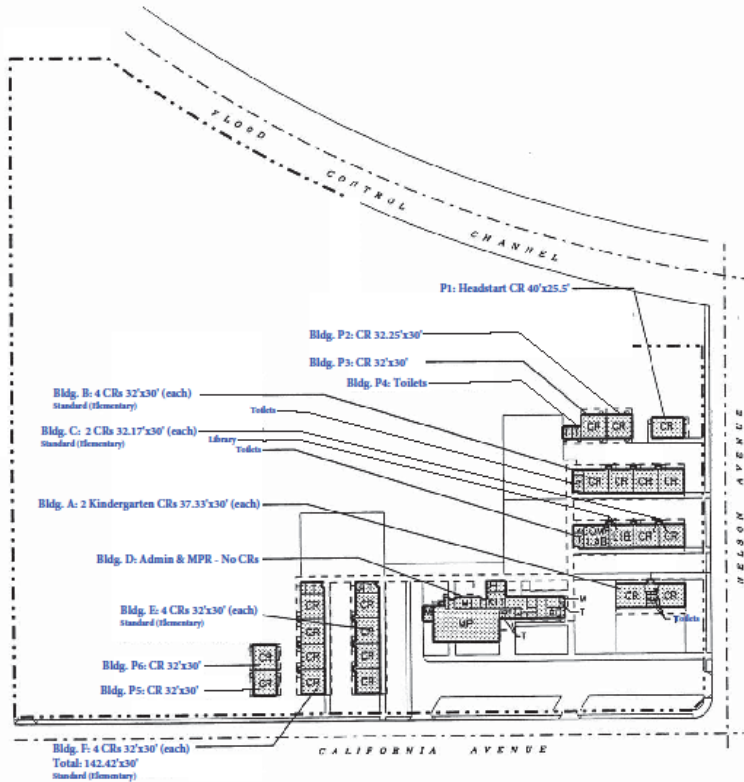

**SITE PLAN**  
**FACILITIES**  
**Measure BB**



## NEWTON MIDDLE SCHOOL

15616 NEWTON STREET, HACIENDA HEIGHTS, CALIFORNIA 91745  
 HACIENDA LA PUENTE UNIFIED SCHOOL DISTRICT  
 15859 E. GALE AVE. LA PUENTE, CA 91749  
 COUNTY OF LOS ANGELES

DIAGRAM BUILDING AREAS	
<input checked="" type="checkbox"/>	EXISTING (11-2)
<input type="checkbox"/>	BASIC PLANS (2-4)
<input type="checkbox"/>	FINAL PLANS (3-4)

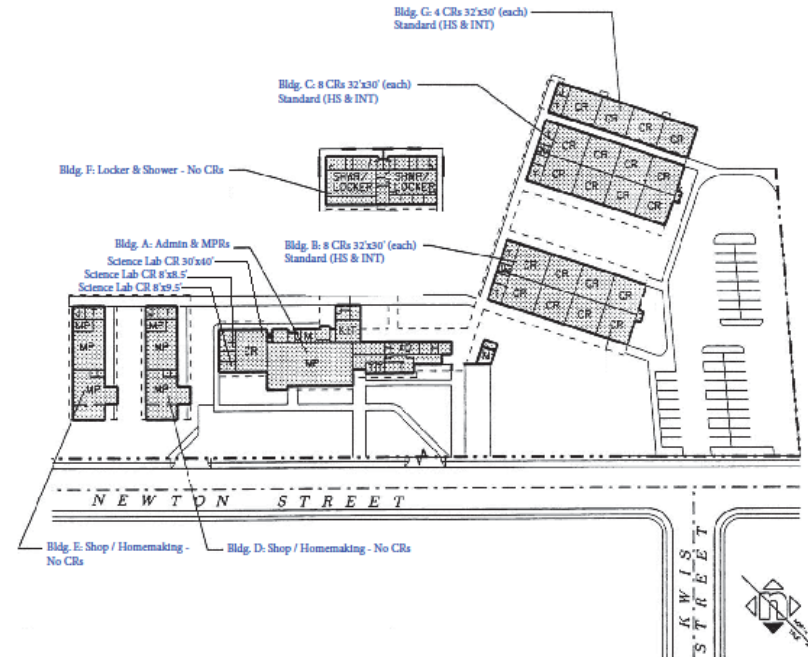

**SITE PLAN**  
**FACILITIES**  
**Measure BB**

# Phase 1



## CEDARLANE MIDDLE SCHOOL

16333 CEDARLANE DRIVE, HACIENDA HEIGHTS, CALIFORNIA 91745  
 HACIENDA LA PUENTE UNIFIED SCHOOL DISTRICT  
 15959 E. GALE AVENUE, LA PUENTE, CA 91749  
 COUNTY OF LOS ANGELES

DIAGRAM BUILDING AREAS

<input checked="" type="checkbox"/>	EXISTING	(1-4)
<input type="checkbox"/>	BASIC PLANS	(2-4)
<input type="checkbox"/>	FINAL PLANS	(3-4)

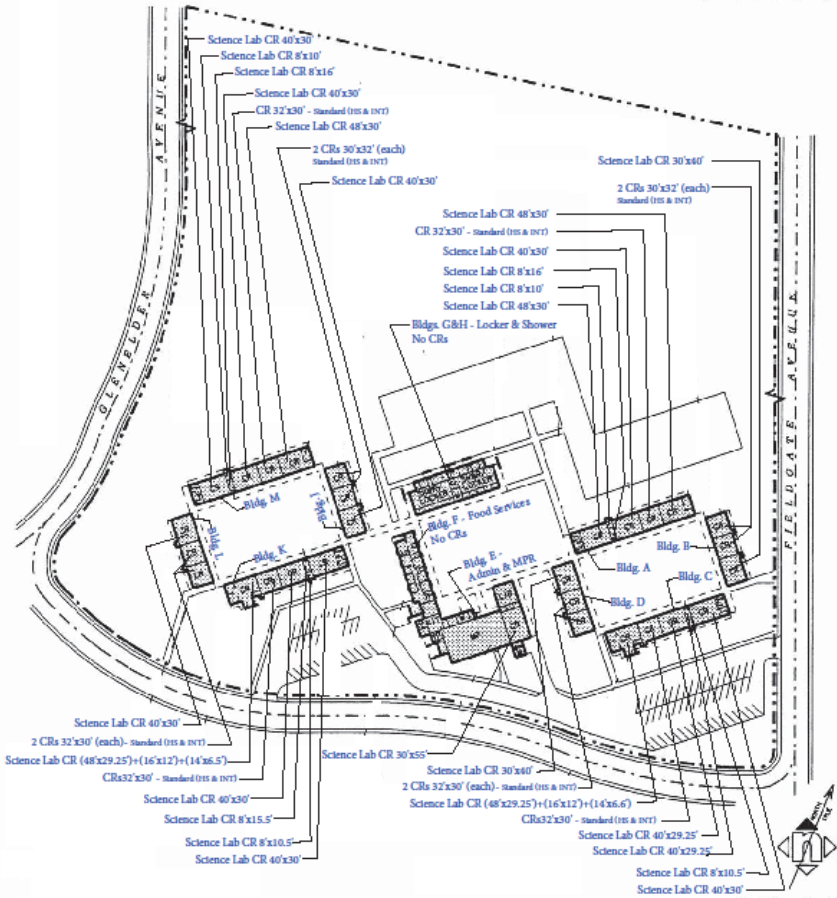

**SITE PLAN**  
**FACILITIES**  
 Measure BB



## GRANDVIEW K-8 SCHOOL

795 N. GRANDVIEW LANE, VALINDA, CALIFORNIA 91744  
 HACIENDA LA PUENTE UNIFIED SCHOOL DISTRICT  
 15959 E. GALE AVENUE, LA PUENTE, CA 91749  
 COUNTY OF LOS ANGELES

DIAGRAM BUILDING AREAS

<input checked="" type="checkbox"/>	EXISTING	(1-4)
<input type="checkbox"/>	BASIC PLANS	(2-4)
<input type="checkbox"/>	FINAL PLANS	(3-4)

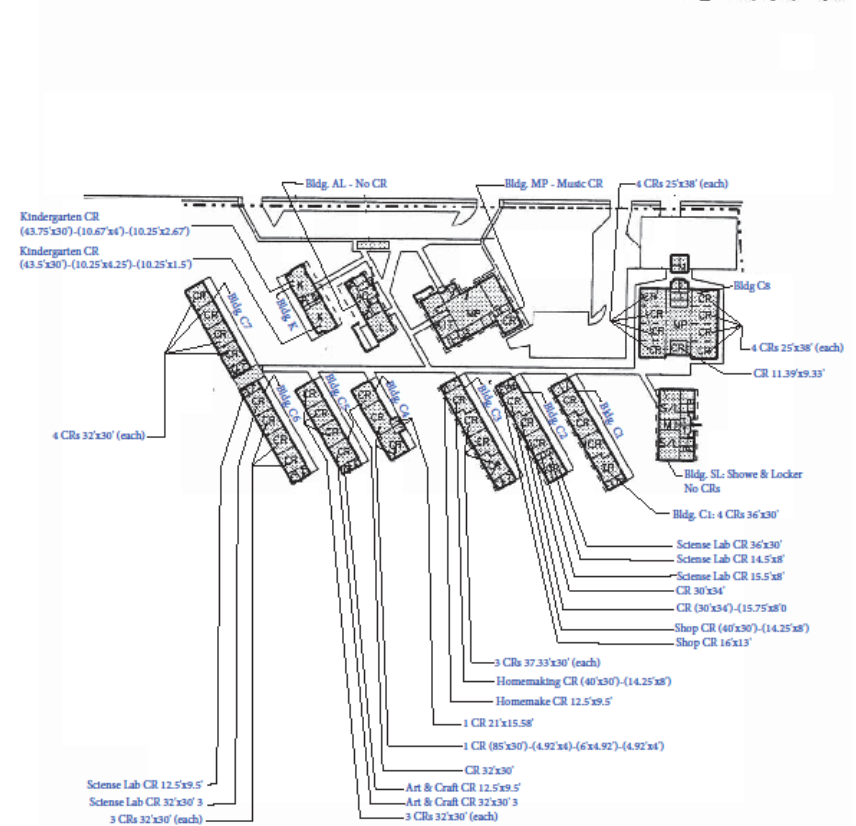

**SITE PLAN**  
**FACILITIES**  
 Measure BB

# Phase 2



## SPARKS MIDDLE SCHOOL

15100 GIORDANO STREET, LA PUENTE, CALIFORNIA 91744  
 HACIENDA LA PUENTE UNIFIED SCHOOL DISTRICT  
 15559 E GALE AVE. LA PUENTE, CA 91749  
 COUNTY OF LOS ANGELES

DIAGRAM BUILDING AREAS	
<input checked="" type="checkbox"/>	EXISTING 11-2
<input type="checkbox"/>	BASIC PLANS 12-1
<input type="checkbox"/>	FINAL PLANS 13-1



## LOS ALTOS ELEMENTARY SCHOOL

15565 LOS ALTOS DRIVE, HACIENDA HEIGHTS, CALIFORNIA 91745  
 HACIENDA LA PUENTE UNIFIED SCHOOL DISTRICT  
 15559 E GALE AVE. LA PUENTE, CA 91749  
 COUNTY OF LOS ANGELES

DIAGRAM BUILDING AREAS	
<input checked="" type="checkbox"/>	EXISTING 11-2
<input type="checkbox"/>	BASIC PLANS 12-3
<input type="checkbox"/>	FINAL PLANS 13-3

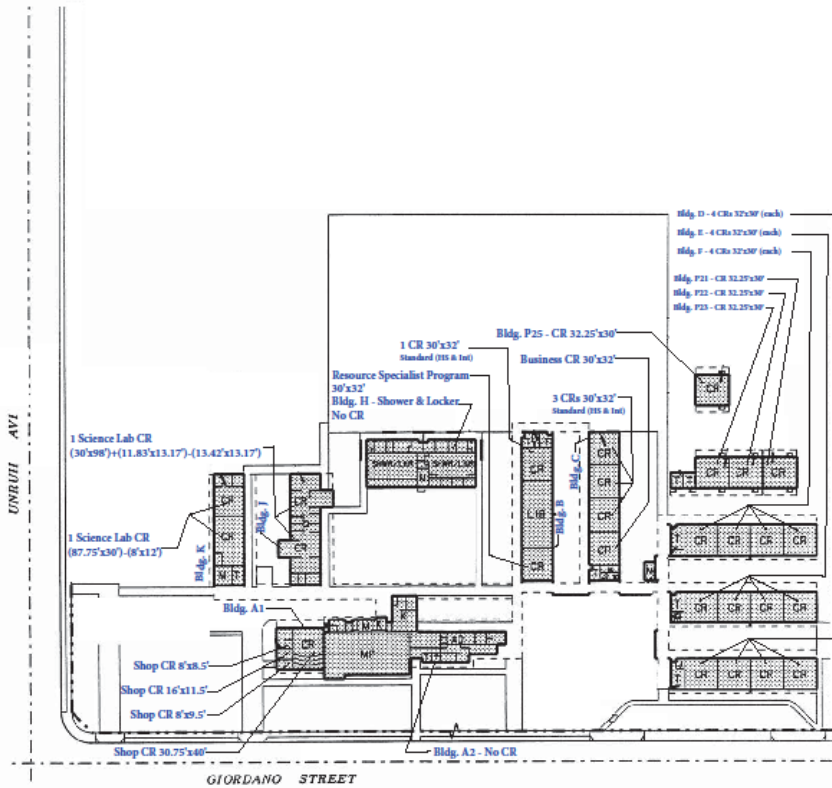

**SITE PLAN**  
**FACILITIES**  
 Measure BB

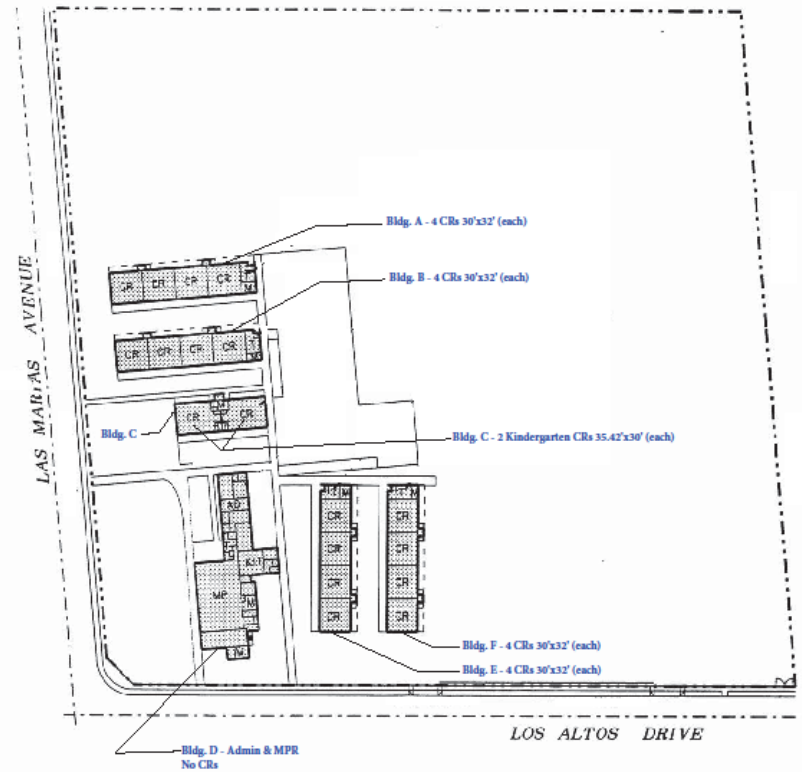

**SITE PLAN**  
**FACILITIES**  
 Measure BB



# Phase 2



## MESA ROBLES ELEMENTARY SCHOOL

16060 MESA ROBLES DRIVE, HACIENDA HEIGHTS, CALIFORNIA 91745  
 HACIENDA LA PUENTE UNIFIED SCHOOL DISTRICT  
 1899 E. GALE AVE. LA PUENTE, CA 91749  
 COUNTY OF LOS ANGELES

DIAGRAM BUILDING AREAS	
<input checked="" type="checkbox"/>	EXISTING 11-1
<input type="checkbox"/>	BASIC PLANS 12-1
<input type="checkbox"/>	FINAL PLANS 13-1

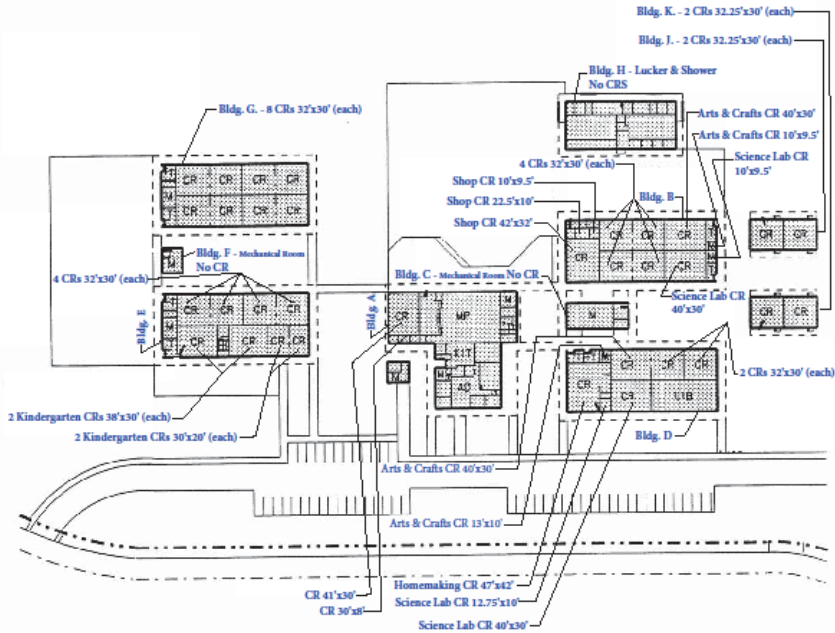

**SITE PLAN**  
**FACILITIES**  
 Measure BB



## WORKMAN ELEMENTARY SCHOOL

16000 WORKMAN STREET, LA PUENTE, CALIFORNIA 91744  
 HACIENDA LA PUENTE UNIFIED SCHOOL DISTRICT  
 1899 E. GALE AVE. LA PUENTE, CA 91749  
 COUNTY OF LOS ANGELES

DIAGRAM BUILDING AREAS	
<input checked="" type="checkbox"/>	EXISTING 11-1
<input type="checkbox"/>	BASIC PLANS 12-1
<input type="checkbox"/>	FINAL PLANS 13-1

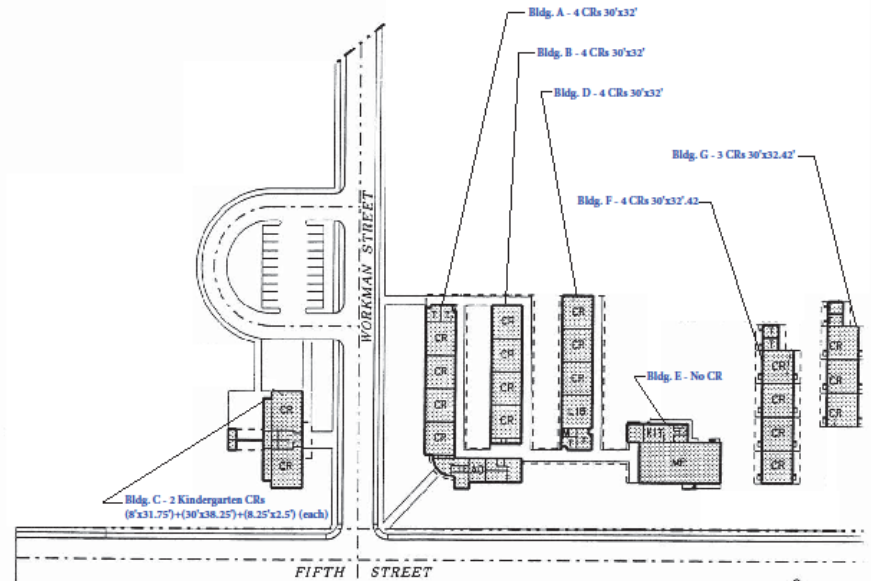

**SITE PLAN**  
**FACILITIES**  
 Measure BB

# Planning

- Meetings with Phase 1 and Phase 2 schools' staff to discuss the upcoming 21<sup>st</sup> Century Classroom project have been scheduled as follows:

Phase 1	Phase 2
Nelson ES (TBD)	Sparks MS (10/13/2017)
Newton MS (9/21/2017)	Los Altos ES (10/3/2017)
Cedarlane Academy (9/19/20017)	Mesa Robles School (10/17/2017)
Grandview Academy (TBD)	Workman ES (TBD)

# Planning

- ❑ The Board held a special meeting on September 7<sup>th</sup>, 2017 to interview eight (8) firms to provide architectural services for Measure BB bond projects
- ❑ On September 14<sup>th</sup>, 2017, The Board approved a panel of seven (7) architectural firms to be used for Measure BB bond projects
- ❑ Staff is currently negotiating a master agreement with identified architects



***Thank you!***