



Hacienda La Puente Unified School District

Measure BB - Bond Projects Monthly Report



Regular Board Meeting
October 25, 2018

Business Services Division

Progress Report

Timeline

Date		Activity
November	2016	Measure BB Bond was passed
June	2017	\$70M of bonds were sold
June	2017	The Bond department was approved by the Board
August	2017	Phases 1 and 2 of the projects were defined
October	2017	Seven (7) architectural firms were brought on board

Progress Report – cont.

Timeline – cont.

To prepare for the input, the District coordinated various field trips, requested and partnered with HLPTA

Date		Location/Activity
October 26	2017	Anaheim Union High School District
October 26	2017	Westminster School District
November 2	2017	Furniture survey forms submitted to attendees
December 15	2017	Arcadia Unified School District
December 15	2017	Walnut Valley Unified School District

Progress Report – cont.

Timeline – cont.

The District set up more field trips for HLPTA members to receive their input and comments in regards to the 21st Century Classroom furniture

Date		Location/Activity
January 19	2018	Culver-Newlin's tradeshow at Disneyland Hotel
January 24	2018	Lakeshore's headquarter visit
March 5	2018	Lakeshore's headquarter visit

Progress Report – cont.

- The October 26, 2017 field trip involved a variety of 21st century classroom and furniture setups.
- So, a survey form seven (7) pages in length was prepared to capture all of the attendees input and comments.
- On November 2, 2017, the attendees received the survey.
- On the following four (4) slides are samples of the survey forms.

Furniture and Classroom Setup Survey Forms Submitted on November 2, 2017

Questionnaire

**Site Visits at Anaheim Union High School District (AUSHD)
and Westminster School District (WSD) on October 26, 2017**

Resources for responding to the Questionnaire:

A) Photos:

1) [Anaheim Union High School District:](#)

https://hlpusdk12caus-my.sharepoint.com/personal/amir_hlpusd_k12_ca_us/_layouts/15/guestaccess.aspx?folderid=04a193d15e9064c82a2997a2925fc5821&authkey=ASmN57xOLvBOx5war0jGqL0

2) [Westminster School District:](#)

https://hlpusdk12caus-my.sharepoint.com/personal/amir_hlpusd_k12_ca_us/_layouts/15/guestaccess.aspx?folderid=08b0538d8704e41858a7c186bf0fc3613&authkey=AWFY_S6JoO7IXL9hizvmvJ8

B) Personal notes and other photos taken by who answers the questionnaire.

Furniture and Classroom Setup Survey Forms Submitted on November 2, 2017 – Cont.

Date: _____

Name: _____

Position / School or Department: _____

Email Address: _____

Direct Phone Number (Preferably Cell Phone): _____

.....

Questions:

- 1) How many different student's and teacher's chairs have you seen at AUHSD's schools?
- 2) How many different student's and teacher's desks have you seen at AUHSD's schools?
- 3) At AUHSD, have been too much variety of color selections at:
 - a) Inside of each classroom?
 - b) Inside of each school?
 - c) Between the schools?
- 4) How many different student's and teacher's chairs have you seen at WSD's school?
- 5) How many different student's and teacher's desks have you seen at WSD's school?
- 6) At WSD, have been too much variety of color selections at:
 - d) Inside of each classroom?
 - e) Inside of each school?
 - f) Between the schools?
- 7) Consider all furniture and classroom conditions seen at all of the sites, and rank the following items based on their priority to be considered in your opinion:

Furniture and Classroom Setup Survey Forms Submitted on November 2, 2017 – Cont.

a) **Student's Chair (Ranking 1 through 26. 1 is highest and 26 is lowest):**

Note: If you are not willing the item to be considered, please write zero (0) in ranking section.

- 1 Easy movable by sliding over the carpet and hard floor (____)
- 2 Include a basket under the chair as storage for the student (____)
- 3 The table be included in the chair set and moves easily at all directions freely, along with the chair (____)
- 4 Adjustable Height (____)
- 5 Having tall back support (____)
- 6 Color of the furniture (____)
- 7 The furniture to be sturdy (____)
- 8 Weight of the furniture (____)
- 9 Ventilation at sitting area and back support (____)
- 10 Appearance of the chair (____)
- 11 Clean easily (____)
- 12 Graffiti resistance (____)
- 13 Sitting and back support areas made by hard materials (____)
- 14 Sitting and back support areas made by cushion materials (____)
- 15 Having stools, along with regular chairs in classrooms (____)
- 16 Chairs made by metal and non-metal parts (____)
- 17 Chairs made all by non-metal parts (____)
- 18 Having nametag holder on the back support to provide information about the classroom (____)
- 19 Legs include wheels (____)
- 20 Legs include bended polish metal without wheels (____)
- 21 Straight solid legs without wheels (____)
- 22 Rotatable sitting area (____)
- 23 Adjustable back support (____)
- 24 Armrest (____)
- 25 Size of the chair (____)
- 26 Chairs to be stock on top of each other (____)

Furniture and Classroom Setup Survey Forms Submitted on November 2, 2017 – Cont.

e) Classroom's Environment (Ranking 1 through 30. 1 is highest and 30 is lowest):

Note: If you are not willing the item to be considered, please write zero (0) in ranking section.

- 1 Voice amplification system (____)
- 2 Carpet flooring (____)
- 3 Polished concrete flooring (____)
- 4 Epoxy flooring (____)
- 5 Acoustical panels on the walls (____)
- 6 Acoustical panels on the ceilings (____)
- 7 Natural lighting (____)
- 8 Proper lighting (unnatural) (____)
- 9 Air circulation (____)
- 10 Digital wall clock (____)
- 11 Analog wall clock (____)
- 12 Color of the floor (____)
- 13 Color of the walls (____)
- 14 Color of the ceiling (____)
- 15 Ceiling mounted projector (____)
- 16 LED/LCD interactive panel (____)
- 17 Wall mounted projector screen (____)
- 18 Wall mounted media and lighting control (____)
- 19 Lockable storage cabinets (____)
- 20 Bookshelves (____)
- 21 Wall mounted tackboards (____)
- 22 Lockable and movable tablet / laptop charging cabinets (____)
- 23 Electrical and data floor mounted outlets (____)
- 24 Operable window blinds (____)
- 25 Sink and faucets inside the classrooms (____)
- 26 Standalone and movable coat / backpack hanger (____)
- 27 Wheeled podium (____)
- 28 Desk lamp for teacher's station (____)
- 29 Wheeled printer cart (____)
- 30 Operable windows (____)

Progress Report – cont.

Timeline – cont.

To receive HLPTA's comments on submitted survey forms

Date		Location/Activity
January 12	2018	Met with HLPTA and received the request to revise the survey form
January 16	2018	The District revised the forms based on HLPTA's request for simplicity and general guidelines only and sent them to HLPTA
January 23	2018	HLPTA revised the forms and sent them to the District
January 29	2018	The District added NCS's items to the forms and submitted to HLPTA (the next two slides represent the final revised survey forms)

Final Revision of Survey Forms Submitted to HLPTA on January 29, 2018

CATEGORIES	ITEM DESCRIPTION	{GRADE LEVEL}					NOTES
		{Subject 1}	{Subject 2}	{Subject 3}	{Subject 4}	{Subject 5}	
FLOORING							
Carpet							
Vinyl							
Concrete							
Expoxy							
CEILING							
Stapled/Glued Tile							
Acoustical panels on the ceilings							
WALLS							
Painted Drywall	District standard						
Tackboard	Tack board glued to existing walls, not every wall can get tack board						
Furred Walls with Tackboard	Furred out walls with tackboard, allows all walls to have tackboard						
Writable Wall surfaces							
White Boards							
Acoustical panels on the walls							
LIGHTING							
Operable Window Blinds	Operable windows blinds						
Dimmable Lighting							
Natural Lighting	Windows new and existing						
TECHNOLOGY							
Front Wall Mounted Flat Panel Screen (Touch), video display from Teacher laptop	47" fixed monitors						
Side Wall Mounted Flat Panel Screen (Non Touch)							
Cabinet Intergrated LED/LCD	Fixed interactive LED/LCD tv units						
Movable LED/LCD	Movable interactive LED/LCD tv units						

Final Revision of Survey Forms Submitted to HLPTA on January 29, 2018

– Cont.

CATEGORIES	ITEM DESCRIPTION	{GRADE LEVEL}					NOTES
		{Subject 1}	{Subject 2}	{Subject 3}	{Subject 4}	{Subject 5}	
Movable Projectors							
Voice Amplification System							
Lockable and movable tablet / laptop charging cabinets							
Wall mounted media and lighting control							
Teacher laptop computer							
Student laptop computers in mobile cart	e.g. Class set needed,						
Student desktop computers	E.g. larger screens and more powerful systems for Art, Engineering or Career Tech Ed specialties						
Wireless network	Capacity to support classroom set of up to 40 devices, personal devices also in upper grades.						
Classroom networked black and white laserprinter with network jack and wireless							
Teaching Workstation	e.g. Mobile cart, desk on wheels, fixed desk						
CABINETRY							
Fixed Storage							
Movable Storage							
Sink and faucets							
Wheeled podium							
Wheeled printer cart							

Progress Report – cont.

Timeline – cont.

To address HLPTA's comments on submitted survey forms

Date		Location/Activity
February 2	2018	The District followed up with HLPTA to receive their comments on the survey forms
February 2	2018	HLPTA asked questions as to method of implementing the survey process and applying the results to the schools not included in phases 1 and 2
February 5	2018	The District responded back to HLPTA's questions
February 12	2018	The District received HLPTA's last update in regards to the status of survey forms

Progress Report – cont.

- In the 2017-2018 school year, the District purchased and installed new 21st century classroom furniture at different schools.
- This allowed HLPTA members to interact with the new furniture in their own classrooms and provide feedback to the District.
- The list of the schools and costs of the furniture are as follows:

School	Costs
Grandview Academy	\$13,800.90
Grandview Academy	\$930.57
Los Molinos ES	\$11,839.82
Bixby ES	\$16,277.20

School	Costs
California ES	\$15,673.00
California ES	\$9,450.90
Los Altos ES	\$19,481.75
Wedgeworth ES	\$24,086.00

Grand Total: \$111,540.14

Progress Report – cont.

- HED Architects was chosen by the District to prepare the Design Guidelines.
- Samples of the Design Guidelines documents are as follows:

Progress Report – cont.

Grades 1-3 - Scheme 2

Zoning Diagram

Classroom designed for 34-40 students,
dependent upon area of the classroom

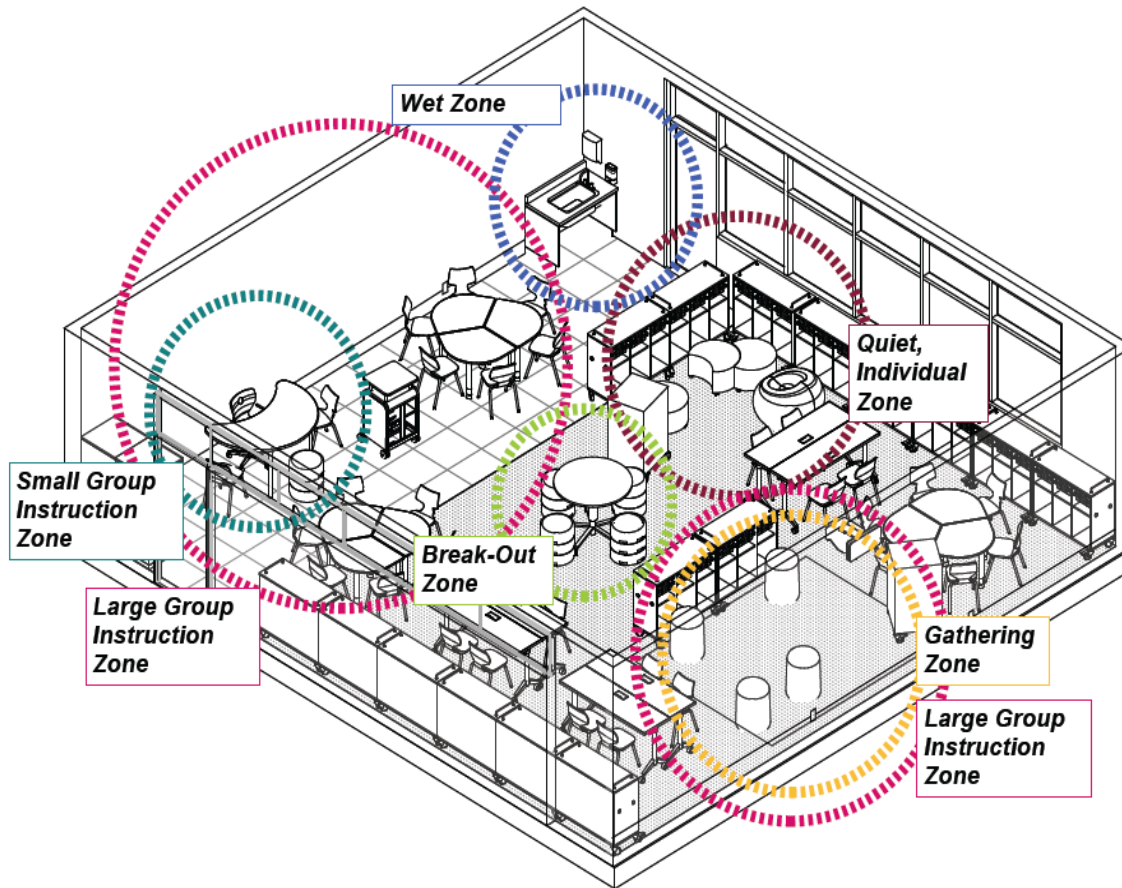

*Zone Recommendations
(% of main learning area to be
allocated each zone)*

-  **Wet zone with sink & drinking fountain (5-10%)**
-  **Large Group Instruction Zone (ideally 2 per learning studio, 55-60%)**
-  **Small Group Instruction Zone (5-10%)**
-  **Gathering Zone (10-15%)**
-  **Quiet, Individual Zone for reflection (10-15%)**
-  **Break-Out Zone (5-10%)**



Hacienda La Puente USD

21st C CR Programming

Progress Report – cont.

Grades 1-3 - Scheme 2

3D view

Classroom designed for 34-40 students, dependent upon area of the classroom

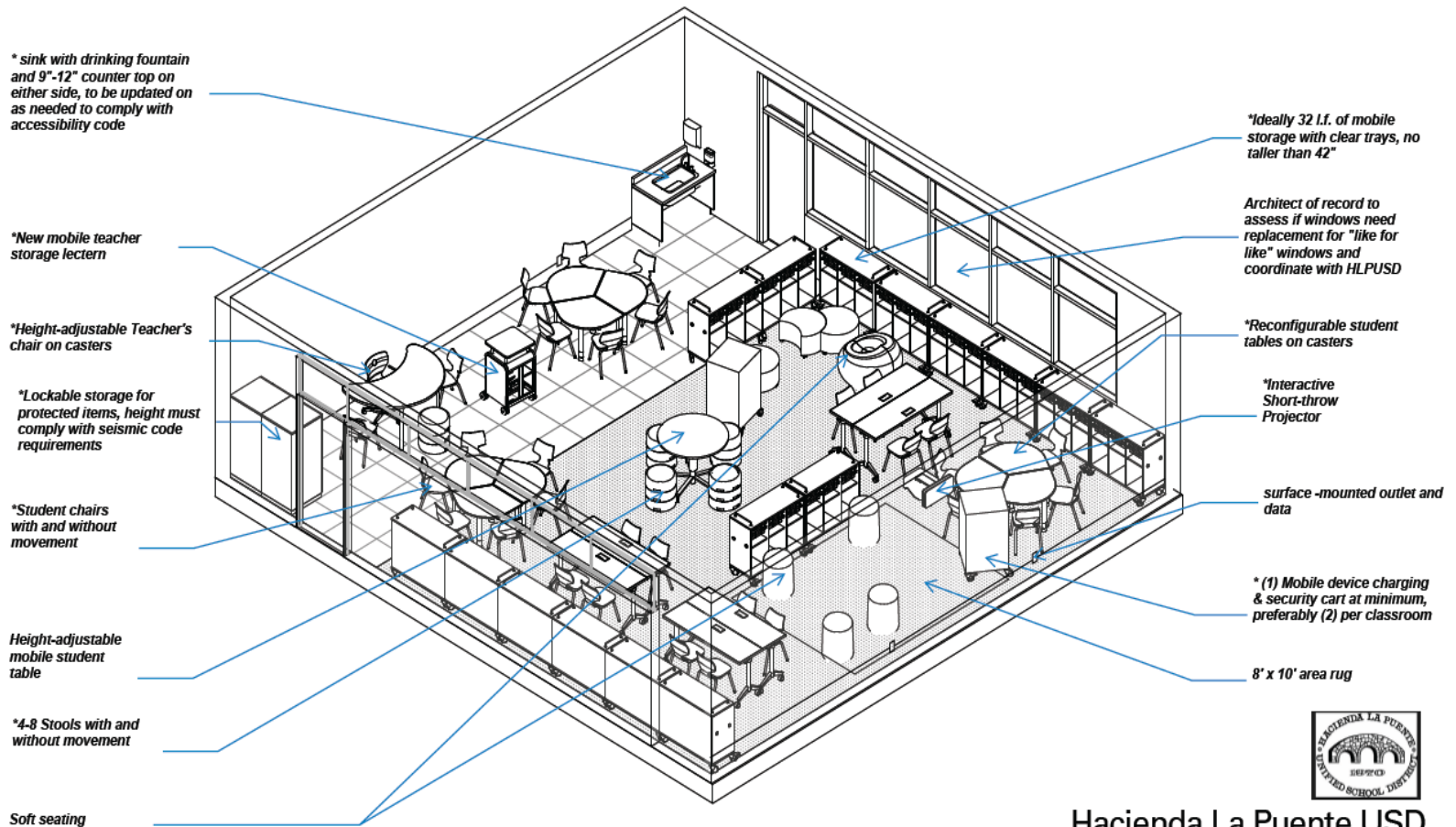

Hacienda La Puente USD

21st C CR Programming

* asterisked items are pieces that should be prioritized in the furniture plans.

Progress Report – cont.

Grades 1-3 - Scheme 2

Wall Finishes

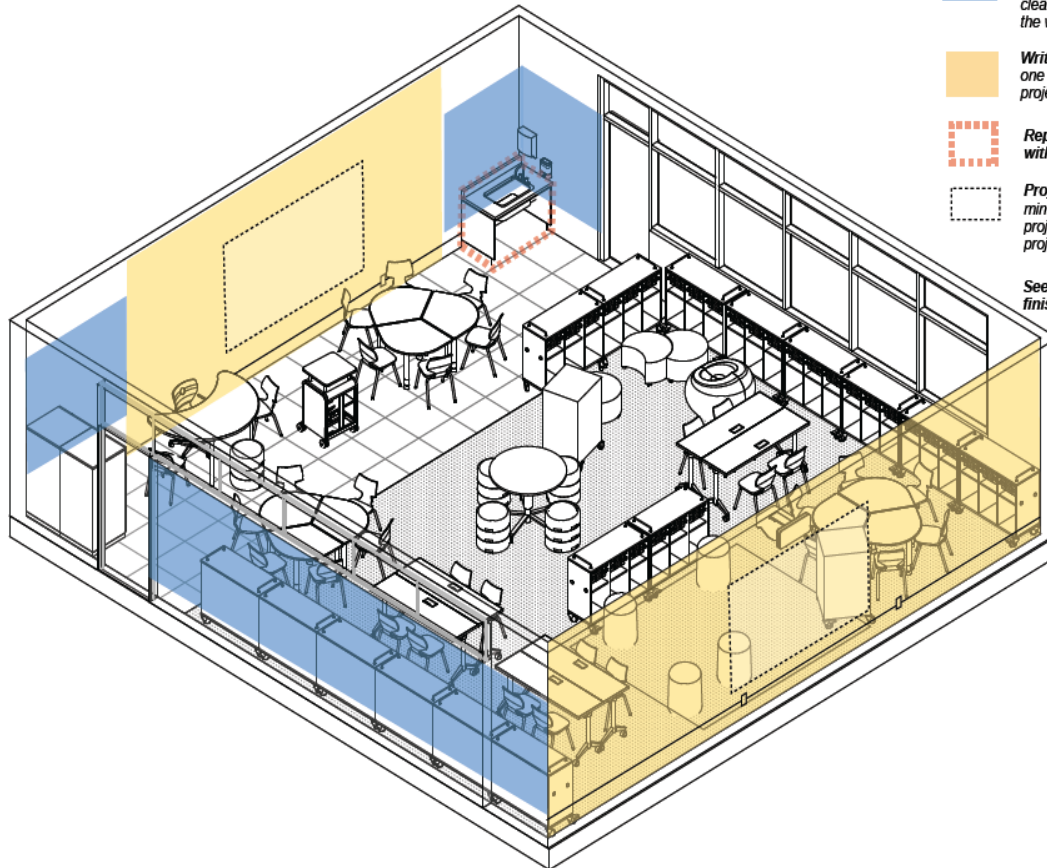

Classroom designed for 34-40 students, dependent upon area of the classroom

Acoustic, Tackable wall surface
attached to the wall with glue, must be easy to clean, should be applied to no more than 30% of the wall surfaces

Writable & magnetic wall surface
one wall to be painted 10ft wide at minimum as a projection wall

Replace existing sink and cabinet with new where applicable

Projection area
min. projector mounting height for wall-mounted projector = 7'-0" for 6'-8" head clearance, min. projection diagonal = 100"

See attached for a list of recommended finishes



Hacienda La Puente USD

21st C CR Programming

Progress Report – cont.

Grades 1-3 - Scheme 2

Floor Finishes

Classroom designed for 34-40 students,
dependent upon area of the classroom

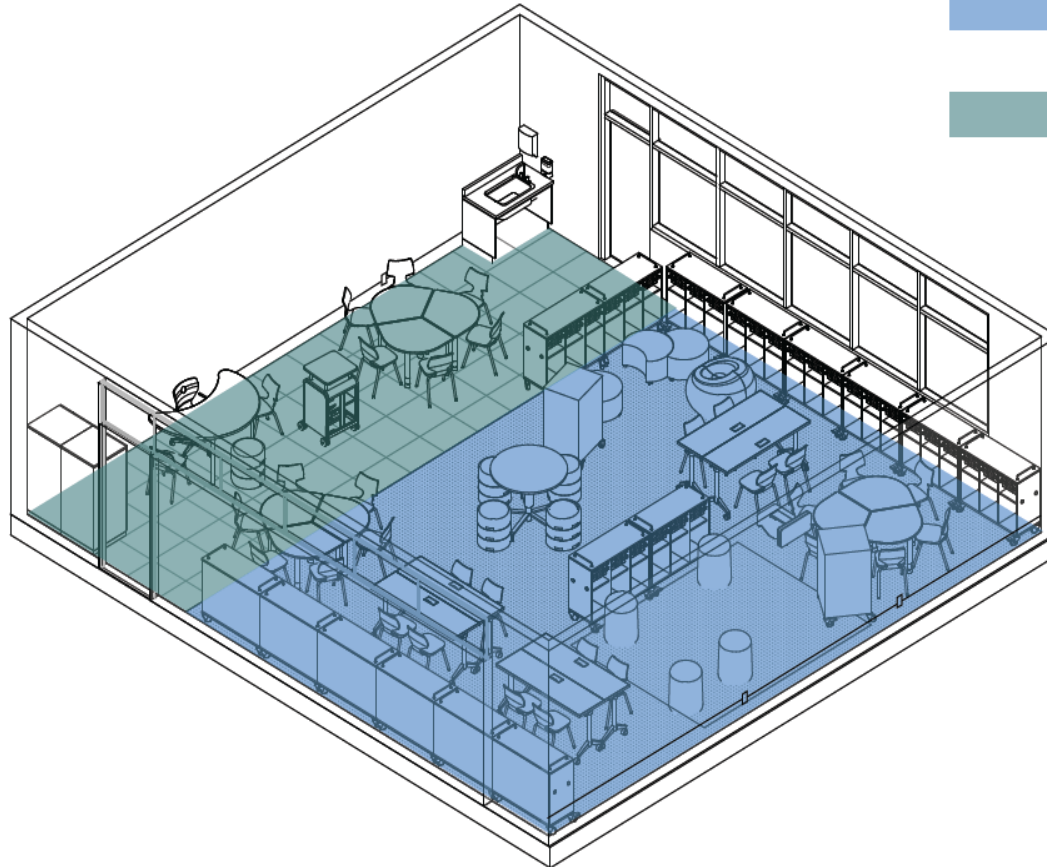

Carpet or rubber flooring
Deviate from light colors and solid patterns,
generally a cross pattern is best for high
traffic. maximum 85% of the main learning
area

Rubber Flooring or Linoleum
for wet zone
maximum 15% of the main learning area

See attached for a list of recommended
finishes



Hacienda La Puente USD

21st C CR Programming

Progress Report – cont.

Grades 1-3 - Scheme 2
Testing Layout

Classroom designed for 34-40 students,
dependent upon area of the classroom

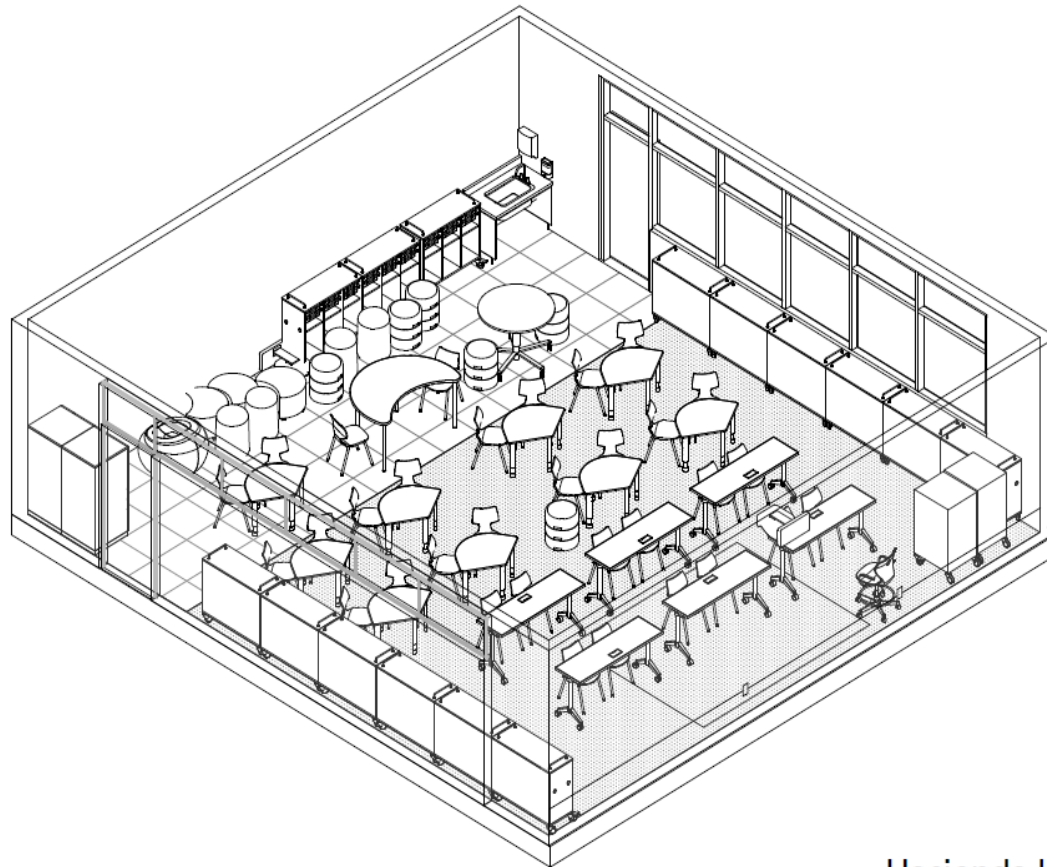

Progress Report – cont.

- ❑ The District has prepared and assigned construction budgets for the twelve (12) projects in phases 1 and 2, (which included interim housing and 21st century classrooms) and submitted them to the architects.
- ❑ Service fees were negotiated with on-board architects, based on the established construction budgets, and POs were issued.

Progress Report – cont.

- ❑ The Bond team assessed building elements of more than 32 sites, room-by-room, to document existing conditions and evaluate the needs in detail.
- ❑ The District held pre-application meetings with DSA and submitted Request for Finding of Unreasonable Hardship (form 1-RUH), in order to minimize the cost of construction outside of the classrooms.
- ❑ Architects prepared topographic land surveying documents at some schools in regards to accessible path of travel. More schools have been scheduled.

Progress Report – cont.

- ❑ The District negotiated and started purchasing twenty (20) new portable classrooms for interim housing.
- ❑ The District issued various RFQs, reviewed Statements of Qualifications (SOQs), and ranked them based on the type of consulting services (e.g. construction inspection, materials testing and inspection, Geotechnical, PLA monitoring, and SWPPP).
- ❑ The District has held quarterly meetings with the community's representatives, through Citizens Bond Oversight Committee (CBOC).

Planning

- Accessibility compliance considerations are in progress for the following projects:

School	21 st Century Classrooms	Interim Housing	Architect
Cedarlane K-8	X	X	PBK
Grandview K-8	X		HED
Mesa Robles K-8	X	X	Office p.S.
Sparks MS	X		HED
Newton MS	X	X	HED
Workman ES	X		SVA
Nelson ES	X		TDM
Los Altos ES	X	X	TDM

Planning – cont.

- ❑ Purchasing of twenty (20) new portable classrooms are in progress for Interim Housing.
- ❑ Topographic land surveying for designing accessible path of travel at the following school sites:

School	Status
Grandview K-8	Completed
Mesa Robles K-8	Completed
Workman ES	In progress
Newton MS	In progress
Sparks MS	In progress

Planning – cont.

- Currently evaluating:
 - DSA requirements for the 21st Century Classroom and Interim Housing projects.
 - School sites for future phases.
 - 21st Century Classroom committee will resume their monthly meetings.



Thank you!