

St. Helens Middle School

Growing the Future



2022-2023 STUDENT/PARENT HANDBOOK

Be Safe. Be Respectful. Be Responsible.

Show your SHMS PRIDE!!

**St. Helens School District Mission
“Strengthening Community Through Exceptional Schools”**

**St. Helens Middle School
354 N. 15th
St. Helens, OR 97051**

**Telephone: (503) 366-7300
Fax: (503) 366-7306
www.sthelens.k12.or.us**

St. Helens Middle School Handbook

Table of Contents

Bell Schedule	3
School Map	4
District Calendar	5
Student Behavior	6-8
PRIDE	6
When Things Go Wrong	6
Safety	7
Dress and Appearance	7-8
How-To Information	8-13
Attendance and Absences	8
Communications	9
Emergency Situations	9
Internet Access & Computer Usage	9
Electronic Devices	9-10
Arrival/Departure	10
Visitors	10
Medication at School	10
Transportation/Bus Expectations	10
Lunch/Cafeteria	11
Supplies/PE Clothes/Lockers	11-12
Registration/Yearbook Fee	12
District Handbook Info	12
Academic Questions	12-14
Parent-Student-Teacher Conferences	12
Eligibility Requirements	12-13
Make-up Work	13
Special Needs/Tutoring	13
Progress Reports	14
Course Descriptions	14
Assemblies and Dances	14
Middle School Office	503-366-7300
District Office	503-397-3085

2022-2023 Bell Schedules

6th Grade – Regular

1st	8:45 – 9:46
2nd	9:50 – 10:50
Focus - 3rd	10:54 – 11:34
Lunch	11:38 – 12:08
4th	12:12 – 1:12
5th	1:16 – 2:16
6th	2:20 – 3:20

6th Grade – Early Release

Every Wednesday, beginning 9/14

1st	8:45 – 9:28
2nd	9:32 – 10:14
Focus - 3rd	10:18 – 10:58
Lunch	11:02 – 11:32
5th	11:36 – 12:18
4th	12:22 – 1:04
6th	1:08 – 1:50

7th Grade – Regular

1st	8:45 – 9:46
2nd	9:50 – 10:50
3rd	10:54 – 11:54
Focus – 4th	11:58 – 12:38
Lunch	12:42 – 1:12
5th	1:16 – 2:16
6th	2:20 – 3:20

7th Grade – Early Release

Every Wednesday, beginning 9/14

1st	8:45 – 9:28
2nd	9:32 – 10:14
3rd	10:18 – 11:00
5th	11:04 – 11:46
Focus – 4th	11:50 – 12:30
Lunch	12:34 – 1:04
6th	1:08 – 1:50

8th Grade – Regular

1st	8:45 – 9:46
2nd	9:50 – 10:50
3rd	10:54 – 11:54
Lunch	11:58 – 12:28
Focus – 4th	12:32 – 1:12
5th	1:16 – 2:16
6th	2:20 – 3:20

8th grade – Early Release

Every Wednesday, beginning 9/14

1st	8:45 – 9:28
2nd	9:32 – 10:14
3rd	10:18 – 11:00
5th	11:04 – 11:46
Lunch	11:50 – 12:20
Focus – 4th	12:24 – 1:04
6th	1:08 – 1:50

St. Helens Middle School 2022-2023

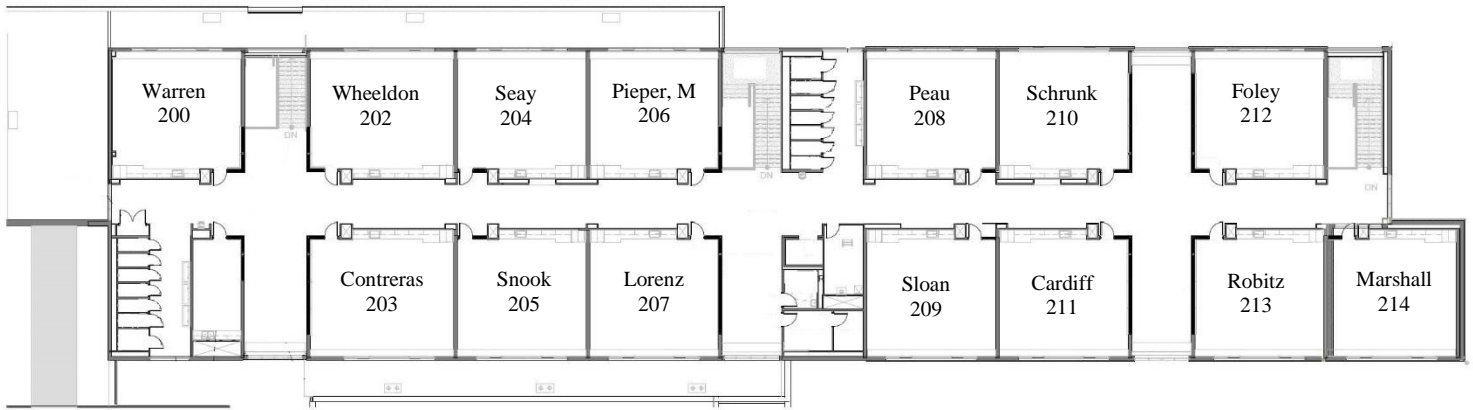

ST. HELENS SCHOOL DISTRICT 2022-2023 COMMUNITY CALENDAR

JULY 2022					Tchr	Stu
M	T	W	T	F	Days	Days
				1	0	0
4	5	6	7	8	0	0
11	12	13	14	15	0	0
18	19	20	21	22	0	0
25	26	27	28	29	0	0
					0	0

JANUARY 2023					Tchr	Stu
M	T	W	T	F	Days	Days
2H	3	4	5	6	4	4
9	10	11	12	13	5	5
16H	17	18	19	20	4	4
23	24	25	26	27	5	5
30	31				2	2
					20	20

H	Holiday No School for staff or students
---	--

PD	Professional Development Day - No School for students
----	--

TWD	Teacher Work Day - No School for students
-----	--

AUGUST 2022					Tchr	Stu
M	T	W	T	F	Days	Days
1	2	3	4	5	0	0
8	9	10	11	12	0	0
15	16	17	18	19	0	0
22	23	24	25	26	0	0
29PD	30PD	TWD			3	0
					3	0

FEBRUARY 2023					Tchr	Stu
M	T	W	T	F	Days	Days
		1	EQ	TWD	3	2
6	7	8	9	10	5	5
13	14	15	16	17	5	5
20H	21	22	23	24	5	4
27	28				2	2
					20	18

Non Contract Day - No School for staff or students

First Day of School

EQ	End of quarter - staff & student attend (11/9-early release)
----	---

K-12 Early Release

SEPTEMBER 2022					Tchr	Stu
M	T	W	T	F	Days	Days
			TWD	2	1	0
5H	6	7	8	9	5	4
12	13	14	15	16	5	5
19	20	21	22	23	5	5
26	27	28	29	30	5	5
					21	19

MARCH 2023					Tchr	Stu
M	T	W	T	F	Days	Days
		1	2	3	3	3
6	7	8	9	10	5	5
13	14	15	16	17	5	5
20	21	22	23	24	5	5
27	28	29	30	31	0	0
					18	18

I	State Teacher Inservice Day No School
---	--

Conferences-No School for students D=Day E=Evening

Last Day of School - early release

OCTOBER 2022					Tchr	Stu
M	T	W	T	F	Days	Days
3	4	5	6	7	5	5
10	11	12	13	I	4	4
17	18	19	20	21	5	5
24	25	26	27	28	5	5
31					1	1
					20	20

APRIL 2023					Tchr	Stu
M	T	W	T	F	Days	Days
3	4	5	6	7	5	5
10	11	12	EQ	TWD	5	4
17	18	19	20	21	5	5
24	25	26	27	28	5	5
					20	19

EC	Emergency Closure Make up Days (if needed)
----	---

End of 1st Quarter

November 9, 2022	46 Days
------------------	---------

End of 2nd Quarter

February 2, 2023	42 Days
------------------	---------

End of 3rd Quarter

April 13, 2023	43 Days
----------------	---------

End of 4th Quarter/Semester

June 16, 2023	44 Days
---------------	---------

Total Student Days	175
--------------------	-----

NOVEMBER 2022					Tchr	Stu
M	T	W	T	F	Days	Days
	1	2	3	4	4	4
7	8	EQ	TWD	11H	5	3
14	15	16	17	18	5	5
21E	22D	23	24H	25	3	0
28	29	30			3	3
					20	15

MAY 2023					Tchr	Stu
M	T	W	T	F	Days	Days
1	2	3	4	5	5	5
8	9	10	11	12	5	5
15	16	17	18	19	5	5
22	23	24	25	26	5	5
29H	30	31			3	2
					23	22

DECEMBER 2022					Tchr	Stu
M	T	W	T	F	Days	Days
			1	2	2	2
5	6	7	8	9	5	5
12	13	14	15	16	5	5
19	20	21	22	23	0	0
26	27	28	29	30	0	0
					12	12

JUNE 2023					Tchr	Stu
M	T	W	T	F	Days	Days
			1	2	2	2
5	6	7	8	9	5	5
12	13	14	15	16	5	5
19H	TWD	21	22	23	1	0
26	27	28	29	30	0	0
					13	12

Last Day for Seniors: TBD
Senior Awards: TBD
Senior Assembly Staff & Students: TBD
Graduation: TBD

Teacher Days	190
Student Days	175

Adopted by School Board - *Revisions - October Inservice date & Spring Break
Added Juneteenth as non-contract day

- August 29 & 30 - Teacher In-Service
- August 31 & September 1 - Teacher Workday
- October 7 - Statewide Inservice
- November 10 - Teacher Workday
- November 21, 22 - K-12 Parent/Teacher Conferences

- February 3 - Teacher Workday
- April 14 - Teacher Workday
- June 16 - Last Day for Students
- June 20 - Teacher Workday
- June 21, 22, 23, 26 - Emergency Closure Make up Days (if needed)

CONFERENCE HOURS
11/21/2022 - No School w/12pm - 8 pm conferences
11/22/2022: No School w/8 am - 4 pm conferences

STUDENT BEHAVIOR

SHMS PRIDE: We are kind, respectful and responsible.

We have PRIDE at SHMS. What does this mean? We strive to be **P**resent and Prepared, **R**espectful, show **I**ntegrity and **D**etermination, and strive for **E**xcellence. Always let **PRIDE** be your guide as you make decisions during your school day.

Your teachers will teach you how to show **PRIDE** this year--in your classrooms, in the halls, in the cafeteria, outside at rec time, on the school grounds, in the bathrooms, in the locker rooms, on the bus, and during school activities. Listen carefully and practice the lessons your teachers will be sharing during the first few weeks of school in each of the school locations. Remind each other, and staff will remind you with formal lessons and informally each day throughout the school year.

Your teachers and other adults will often catch you in the act of showing **PRIDE** and celebrate by giving you a **PRIDE** ticket. Save these tickets. Every Friday, you can buy prizes with them from the **PRIDE** store during lunchtime.

Present and Prepared

Respectful

Integrity

Determination

Excellence

St. Helens Middle School students, always remind yourselves that you are at school to learn and that learning is important, challenging, rewarding and fun. Learning is about growing intellectually, physically, socially, and personally. While teachers share information and resources and guide learning opportunities, you will challenge yourselves to read, write, participate, and think at deeper and richer levels of understanding.

There is so much to learn about your worlds and about yourselves. Middle school is an exciting time of discovery and investigation. Pursue this challenge with energy and enthusiasm. Your teachers will do the same.

WHEN THINGS GO WRONG: What happens when students make poor decisions?

Consequences: There are natural consequences for everything we do—positive and negative. Always strive to think before you act; this will help you experience many more positive than negative consequences and will make your school life much more rewarding.

That said, we all make mistakes. Sometimes we make poor choices in the hopes that we will impress others, sometimes because we're sad or angry or embarrassed or nervous or afraid, or sometimes just because we're having a bad day. Your teachers understand all of this and want to help you navigate difficult times, encouraging positive decisions with positive outcomes as you learn a variety of problem solving techniques.

Discipline: If you make a poor decision, your teachers will take the time to teach and reteach appropriate behaviors. Sometimes all you need is a reminder, and you're on your way! Sometimes, depending on the severity or repetition of the poor behavior choice, you will receive a consequence, anything from lunch detention to suspension from school. Your teachers will contact your parents, and sometimes they will set up a meeting to support you in creating a plan for change.

It is important for you and your parents to read the St. Helens School District Family and Student handbook to understand behaviors and their consequences. The handbook can be found on the school district's website (www.sthelens.k12.or.us), the district office, and in the main office of the middle school. Remember that consequences assigned to you by the school are designed to help you learn appropriate behaviors so that you can experience all the benefits school has to offer.

Safety: We teach and expect positive, respectful, responsible and kind behaviors because every one of us deserves the right to be safe and feel safe at school. When a student is not being safe, causing harm to self or others, or causing any sort of disruption in the learning environment, we need to intervene. "We" means students and adults alike.

Students, if you witness unsafe, unkind, irresponsible, or inappropriate behavior of any kind, and you believe you alone can't make it stop, please seek assistance from any trusted adult. Report unsafe behaviors to any adult in the school, or report it to your parents and ask them to make the report. We can help when we know what is happening.



We recognize that creating a safe learning environment is a critical part of helping each child achieve academic success. SafeOregon will give your child another medium for communicating with our school administration when school safety incidents occur. Students can access the SafeOregon system through a link on our school web site or they may go directly to the safeoregon.com web site. Tips can be submitted through the web form on the SafeOregon web site, or by text, email, live call and mobile app.

DRESS AND APPEARANCE

In order to provide an atmosphere conducive to learning and to ensure the safety, health and well-being of all students and staff, all students shall follow the guidelines listed below:

Allowable Dress and Grooming

- Students must wear clothing including both a shirt with pants or skirt, or the equivalent and shoes.
- Shirts and dresses must have fabric in the front, back and on the sides.
- Clothing must cover undergarments and waistbands, bra straps excluded.
- Fabric covering all private parts must not be see-through.
- Clothing must be suitable for all scheduled classroom activities including physical education, science labs, STEAM classroom, and other activities where unique hazards exist.
- Specialized courses may require specialized attire, such as sports uniforms, concert attire, or safety gear.

Non-Allowable Dress and Grooming

- Clothing may not depict, advertise or advocate the use of alcohol, tobacco, marijuana or other controlled substances.
- Clothing may not be sexually suggestive, depict pornography, nudity or sexual acts.
- Clothing may not use or depict hate speech targeting groups based on race, ethnicity, gender, sexual orientation, gender identity, religious affiliation or any other protected groups.

- Clothing, including gang identifiers, must not threaten the health or safety of any other student or staff.
- Costumes or face cover/paint are not allowed unless for special occasions or themed dress days.

Students violating the dress & appearance standard will meet with the principal or designee in private and will be given the opportunity to correct their dress or appearance and return to class. Students refusing to correct their dress or appearance will be referred for non-compliance and will receive discipline consistent with policies for similar violations.

HOW-TO INFORMATION

ATTENDANCE AND ABSENCES

Oregon law requires students to maintain regular school attendance. (ORS 339.010) Per statute, truancy may be defined as 8 unexcused ½ days in any four week period or 5 or more absences in a 3 month period. Students missing 10 or more consecutive days are dropped from official school rolls and will have to be re-enrolled. The responsibility of regular attendance is held by the parent. The school's responsibility is to maintain accurate attendance records and see that students are in attendance, unless they have an acceptable excuse. When an excessive number of absences or tardies occur, parents will receive a letter. If the attendance does not improve, the student and parents will be referred to Truancy Enforcement.

Remember to call the school before 9:00 am when your student is absent, stating the reason. You may also send a note with your student when they return, stating the reason for the absence.

When should students stay home from school?

- If they are sick (fever of 100°F or higher, vomiting, diarrhea, coughing of mucous), even if they do not have COVID-19 or symptoms of COVID-19
- If they are showing symptoms of COVID-19
- If they test positive for COVID-19, even if they show no symptoms

EXCUSED ABSENCES

- Student illness
- Family emergency
- Medical appointments
- Court appearances
- Funerals
- School sponsored activities

All other absences are considered **unexcused**. Following an absence, students must communicate directly with classroom teachers to follow classroom grading policies and complete assignments.

The school will contact parents via the automated caller about their student's unexcused absences at 9:30 and 6:00 daily. Successful contact is dependent upon up-to-date information from parents and school personnel and our automated systems.

CLASSROOM TARDIES

Students should be in their seats and ready to learn by the time the tardy bell rings. Timelines helps everyone learn and avoids classroom disruptions. Classroom tardies will be addressed as follows: 1st tardy – life happens, 2nd tardy – problem solve with classroom teacher, 3rd tardy – continue to problem solve and one lunch detention, 4th and beyond – student support plan.

HALL PASSES/BATHROOM PASSES

Students leaving classrooms or in the hallway during class times must have a pass. Students without the proper pass will be asked to return to class. Students may be required to turn in their cell phone to their teacher when requesting a bathroom pass.

STUDENT OFFICE USAGE

The office staff has numerous tasks to accomplish to ensure that school is run smoothly. So that our office staff is available to handle emergencies as they arise, please help by following school expectations/procedures.

COMMUNICATIONS

Office Hours: 8:00 am – 4:00 pm. **Phone Number:** 503-366-7300

Calls to Faculty – If you wish to speak with a teacher, it is best to call early in the day and be prepared to leave a message. Most teachers are working with students throughout the day and cannot return calls until after students leave the building or after meetings conclude. Please allow up to 48 hours for a reasonable response time. Calls concerning student safety will prompt a quicker response time.

E-mailing Faculty – Teachers may be able to respond to an e-mail message sooner than phone calls.

If you use **Social Media**, there is a **Facebook** account for middle school parents. The name of the group is: St. Helens Middle School Information Page. Visit this site daily for updates about the middle school.

Newsletter - A **newsletter** will be sent home via e-mail.

EMERGENCY DRILLS/SITUATIONS

Fire, earthquake and lockdown drills are an important safety precaution. We have a fire drill each month and earthquake and Standard Response Protocol drills throughout the year. During a drill or actual emergency situation, it is essential that students follow directions quickly and quietly! Teachers and other adults on campus will instruct students on emergency procedures and exit routes, and review this with students periodically.

Telephone Messages for Students – Emergency messages for students will be delivered as soon as possible. With over 600 students, we ask that messages be for emergencies only. Students will only be allowed to access cell phones during their lunch periods.

INTERNET ACCESS AND COMPUTER USAGE

Every student has access to computers. Students are given a username and password and should not pass it out, as they are responsible for accounts. Internet usage can be monitored and rules include:

- School usage only
- Students may not change settings on computers
- No downloaded games are allowed

Students are responsible for their actions while using the school district's computer resources. Computer misuse may lead to students being held monetarily accountable and to disciplinary consequences, including revoking of privileges and leading up to expulsion, depending on the severity of the infractions.

ELECTRONIC DEVICES

Students' personal electronic devices must be on silent and out of sight in the hallways and classroom, unless teacher directed. Students may use electronic devices at lunch and recreation time. Devices are expected to be

muted and students must use headphones for audio. Personal speakers are not allowed at school. Students violating this policy will be subject to:

- 1st violation – Teacher/staff reminder
- 2nd violation – Office check-in and returned to student at the end of the school day.
- 3rd violation – 3 day office check-in and returned to student at the end of each school day.
- 4th violation – 2 week office check-in and returned to student at the end of each school day.
- 5th violation – Indefinite office check-in and returned to student at the end of each school day.
 - Privilege is earned back based on grades and behavior.

CLASSROOM REMOVAL

Sometimes a student may be asked to leave their classroom due to student behavior that is causing a severe disruption to the learning environment. The decision to remove a student from the learning environment is made after multiple attempts to redirect or correct the negative student behavior. The length of removal can be as short as 10 minutes or as long as the remainder of the class period. Students removed from the classroom for disruptive behavior will receive, at a minimum, one after school detention that day or the following day. Teachers will contact parents through email or phone to notify the parent of the after school detention.

ARRIVAL/DEPARTURE FROM SCHOOL

Students who walk or ride to school should not arrive before 8:20 am. School doors open for students at 8:35 am and students are to remain at school upon their arrival. Parents are asked to drop off or send students to school to arrive no earlier than 8:25 am, as we do not provide supervision earlier. Students eating breakfast may enter the cafeteria area at 8:25 am. A staff member will be on duty in the cafeteria. Once students arrive they are expected to remain in the outside commons area until the building chimes ring. **Students not riding buses are expected to leave campus directly after school**, not loitering or lingering in the building.

VISITORS

Parents and/or Guardians are always welcome at SHMS but must report to the school office upon entering the building. School personnel have the right to know the identity of all persons in the building.

MEDICATION AT SCHOOL

Any student who is expected to take medication during school hours must have on file in the school office a signed Medication Administration Agreement. Parents must complete a Medication Administration Agreement for office staff to administer prescription medicines. All medicines, including over-the-counter medications, must be in the original container and stored in the health room. Inhalers used by asthmatics can be carried by the student, but a Self-Medication Agreement signed by the parent must also be on file.

TRANSPORTATION

Students riding a bus other than that of their assigned route **must have written permission from parent or guardian**. Upon presentation of written permission, the school office will issue an Alternate Bus Destination Permission form which must be presented to the driver. **School rules and expectations are still in effect on school buses. Students receiving bus tickets will receive appropriate consequences.** Durham School Services can be reached at 503-397-9072.

BICYCLES, SKATEBOARDS, SCOOTERS, ROLLERBLADES, ETC.

Bikes and scooters must be parked in stands and should be securely locked. The district assumes no responsibility or liability for loss or damage to bicycles. **WALK YOUR WHEELS.** Bike-riding, skateboarding, scooter riding, rollerblading and the like is NOT allowed on school property **AT ANY TIME**. Riding such vehicles

on any district property may result in loss of item (confiscation) and parent pick up/loss of privilege. Helmets are required under state law for bicycle riders.

CAFETERIA

In order to make lunch an enjoyable and safe time for the students, and to keep the cafeteria clean, safe and ready for all students' use, and to prevent the spread of disease, we ask students to follow the cafeteria expectations.

LUNCH

The cafeteria serves breakfast and lunch daily. Lunches may also be brought from home. Breakfast will be \$1.75 and lunch will be \$3.00. Families are encouraged to complete the application for free and reduced meals on our district website.

FOOD/BEVERAGE

Food and drinks should be consumed in the cafeteria during breakfast or lunch. Eating or snacking in the hallways or classrooms is not allowed. Students are encouraged to bring a water bottle to school for classroom use. Open beverages are not allowed in lockers. Student energy drinks and coffee are not allowed in the school building. Gum will be confiscated if it becomes a distraction to the learning environment. Teachers may, at times, allow food and beverages in the classroom.

SUPPLIES

Schools supplies are listed below.

- 4 Package #2 Pencils
- 1 3-Ring Large 3-in Binder
- 1 Pencil Pouch
- 5 Index-Divide Folders w/Pockets
- 3 Packages Notebook Paper – college ruled
- 1 Package Pens (6th grade)
- 4-5 Spiral Notebooks – college ruled
- 1 Pack of Low-Odor Dry-Erase Markers (for math)
- 1 Pair of Scissors
- 1 Metric Ruler
- 2 Sets of Colored Pencils
- 2 Glue Sticks (6th grade: 10 glue sticks)
- 1 Calculator (Recommended: TI-30X IIS)
- 1 Set of Earbuds (for use w/Chromebooks)
- 1 Set of PE Clothes
- 1 Cinch Bag for PE Clothes

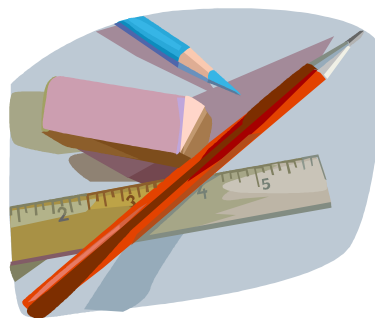

P.E. CLOTHES

Students must have clothes designated for PE only. Only cinch bags will be allowed in the locker room; no backpacks.

- ◆ Shorts or Athletic pants, T-shirt (must have sleeves), tennis shoes, socks

PLEASE PRINT NAME ON ALL SCHOOL SUPPLIES & P.E. CLOTHING

RESTROOM USAGE

Students can help by using the facilities and supplies as designed and in a timely fashion, leaving the restrooms clean and honoring the privacy of others and the maintenance of the facilities. Students leaving classes to use the restrooms are required to have a hall pass in their possession.

LOCKERS

Lockers are the property of the St. Helens School District and are provided as a privilege. Misuse may result in loss of locker use. At no time does the school district relinquish its exclusive control of lockers. Periodic general inspections of lockers may be conducted by school authorities for any reason at any time without notice, student's consent, or a search warrant. **Students are not to share lockers or their combinations or attach stickers or other items which are difficult to remove.** Students may be fined for failing to follow these guidelines. Students will be expected to maintain proper cleanliness of their lockers. Please do not write on any part of the lockers.

TEXTBOOKS

There is no fee for textbooks, but students are responsible for damaged or lost textbooks. Students may be charged for excessive damage to library books and textbooks, or charged for replacement costs of lost books.

REGISTRATION FEE AND YEARBOOKS

Registration/Activity Fee = \$20

Yearbook = \$20

DISTRICT HANDBOOK/GENERAL INFORMATION is available online @ www.sthelens.k12.or.us under the "parent info" heading.

ACADEMIC QUESTIONS

PARENT TEACHER CONFERENCES

By attending **Parent/Teacher Conferences**, parents are provided a specific time to learn about their student's progress. This is the time to ask questions or share concerns about your student's needs. In addition, parents, teachers or counselors may schedule conferences at any time during the year. Teachers encourage parents to request a conference, or to e-mail them, when they have questions or concerns. Parents may also access their students' academic and behavioral information via **Parent Vue**, and will be able to obtain a password and username granting them access to both classroom and their individual student's information by showing a valid ID card. Teachers are expected to update this information at a minimum every two weeks.

Homework, or assigned work that is completed beyond the classroom, occurs for various reasons:

- **PRACTICE** - to repeat and reinforce classroom activities
- **PREPARE** - to get students prepared for the next class
- **EXTEND** - to apply new learning, or transfer it to another setting
- **CREATE** - to get students to integrate skills and create something new

While homework times can vary considerably and depend on many factors, most students have homework on weeknights that ranges from 30-60 minutes.

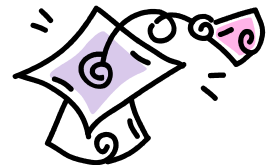

ELIGIBILITY REQUIREMENTS FOR MS SPORTS AND EXTRA-CURRICULAR ACTIVITIES

Students are expected to be passing all of their classes in order to participate in Middle School sports and/or activities and field trips during the school day or any sporting events after school hours.

MIDDLE SCHOOL ATHLETICS

If a student has a failing grade at the end of the previous Quarter, then the student is placed on academic probation for the current sport season.

- Students on academic probation will not be allowed to participate for the week if grades remain less than 60%.
- Students on academic probation for three consecutive weeks will be removed from the team.
- Students not on academic probation are still expected to be passing all classes.

Because Band, Choir, Science, Humanities, Art, PE, Math, Health and STEAM are academic classes, and field trips may be part of the academic grade, they do not fall under this guideline.

NON-ACADEMIC FIELD TRIPS

Non-academic field trips are club and school-related trips that are not tied to any class. These would be trips like those for Slamboo or Million Word Readers, as well as award trips. Students may only attend these trips if they are passing all classes.

If a student has a specialized plan that addresses this ruling, the specific plan will be followed.

SCHEDULE CHANGES

Schedules are determined by the enrichment choice made in the spring of the previous school year, math placement and other educational factors. Students who have mistakes on, or concerns about, their schedules can sign up to see the counselor. Please keep in mind that changes to schedules are rare and will be done to meet educational needs per principal approval. The deadline for changes is five days from the beginning of the quarter.

MAKE-UP WORK

Students and/or parents are responsible for requesting make-up work. If students are present the day an assignment is given, the assignment is due on time. Students having unexcused absences will be expected to make up missed work.

SPECIAL NEEDS

The State of Oregon and federal laws mandate educational services for children with disabilities. St. Helens Middle School offers educational programs and services for eligible students. Services provided are appropriate to each child's disability. If you have questions or concerns, please contact a school counselor.

STUDY HELPS

Unless in meetings, teachers are available for after-school study helps. Please make arrangements with them.

The library is open in the morning for study. Please arrange ahead of time with the library. Locker areas and teachers will not be available at this time: it is simply a time to study.

TUTORING

The school counselors can assist with the arrangement of tutoring in the event of an expulsion or extended absence (greater than 10 days, requiring a doctor's note) due to illness. Tutoring can be arranged outside of these circumstances. Tutors are independent contractors who work at an hourly rate and the costs are the responsibility of the parents. A list of tutors can be obtained from the main office by request.

REPORT CARDS AND PROGRESS REPORTS

Report Cards are mailed home every 9 weeks. Parents are encouraged to e-mail teachers or request a conference whenever parents have questions or concerns about their student's progress. By accessing Parent Vue on the district web site, parents may receive current classroom information regarding their individual student(s).

COURSE DESCRIPTIONS

Links to Oregon State Standards can be found on the school's website at www.sthelens.k12.or.us. Individual teacher websites, course goals and lessons show links to standards.

ASSEMBLIES

Assemblies are held throughout the year. Assemblies include programs like student recognitions, spirit assemblies, team meetings, guest speakers and guest and student performances. Certain expectations will help to make these activities an enjoyable and safe time for the students, participants and guests.

DANCES

In order to make school dances an enjoyable and safe time for the students, we encourage students to follow all school behavior expectations. **Students may be excluded based on behaviors at administrative or adult discretion.**