



181 US Hwy 46
Mine Hill, NJ 07803
(908) 654-8068
(800) 783-0567
Fax 908-654-8069

LEAD IN DRINKING WATER REPORT

Performed At:

Watchung Borough Schools
Bayberry Elementary School
113 Bayberry Lane
Watchung, NJ 07069
908-755-8184

Valley View Middle School
50 Valley View Road
Watchung, NJ 07069
908-755-4422

Performed For:

Watchung Borough Schools Board of Education Office
Mr. Dave Walker
1 Dr. Parenty Way
Watchung, NJ 07069

Prepared By:

LEW Corporation
181 US Hwy 46
Mine Hill, NJ 07803

Phone (908) 654-8068
Fax (908) 654-8069
Website <http://www.LEWCorp.com>

Inspection Date: 11/13/2021
Project Number: 210439

Table of Contents

Contact Information.....	3
Introduction	4
Sampling Methodology	4
Drinking Water Results	5
Recommendations	5
Additional Recommendations	5

Appendices

Appendix A	Exceedances
Appendix B	Recommendations
Appendix C	All results
Appendix D	Floor Plan(S)
Appendix E	Laboratory Data

Contact Information

Agency

Client Contact:	Mr. Dave Walker
Client Name:	Watchung Borough Schools Board of Education Office
Street Address	1 Dr. Parenty Way Watchung, NJ 07069
Phone Number:	(908) 755-4422 x1120

Risk Assessor(s)

Site Assessor(s):	Michael Mosier
License:	NJDOH # 035762
Signature:	
Date:	November 24, 2021
E-Mail:	mmosier@lewcorp.com
Date:	January 12, 2022

Firm

Organization:	LEW Corporation
Certification #:	NJDCA 00015 E
Street:	181 US Hwy 46
City, State & Zip:	Mine Hill, NJ 07803
Phone Number:	908-654-8068
Web Address:	http://www.lewcorp.com

Laboratory

Organization:	Environmental Hazard Services, LLC
Street:	7469 Whitepine Road
City, State & Zip:	Richmond, VA 23237
NJDEP Certification #	VA008
Phone Number:	800-347-4010

Introduction

LEW Corporation was contracted by Watchung Borough Schools Board of Education to test for the presence of lead in drinking water in six schools in the district.

Sampling Methodology

LEW Corporation followed the July 13, 2016 amendments to NJAC 6A:26. Full details on sampling practices can be found in Districts Sampling Plan.

All samples were collected in 250mL wide mouth plastic containers that was prepackaged by the analytical laboratory. The sample containers may contain nitric acid, if expedited analysis is required. If not, nitric acid will be added to each sample upon arrival at the laboratory. At each sample location, the first draw sample was taken after it was determined that the water had been standing in the plumbing system for greater than eight hours but less than forty-eight hours. If second draw samples were collected, they were collecting following a flushing protocol outlined in the District's Sampling Plan.

Drinking Water Results

On November 13, 2021, LEW Corporation collected the following number of water samples:

Bayberry Elementary School

- 38 first draw samples collected and 1 QAQC sample collected
- 3 samples above the 15ppb action level

Valley View School

- 16 first draw samples collected and 1 QAQC sample collected
- 0 samples above the 15ppb action level

The complete list of samples that exceeded the 15ppb limit can be found in Appendix A. The complete list of all sample results can be found in Appendix C. The laboratory results can be found in Appendix E.

Certain outlets could not or were not tested due to various reasons. The following table lists those locations and the reason why samples were not collected.

School	Sample Location	Reason for not testing.
Bayberry Elementary	Hallway by Faculty Room (16-BB-TL-WC)	Not functioning
Bayberry Elementary	Room A-205 (32-BB-A205-BB)	Not functioning
Bayberry Elementary	Room D-204 (35-BB-D204-BB)	Not functioning
Bayberry Elementary	Room D-208 (37-BB-D208-BB)	Not functioning

Recommendations

Those outlets where the first draw sample tested below 15ppb are not considered to be elevated and no mitigation is necessary.

For those outlets where the first draw sample exceeds 15ppb the following steps are recommended:

- 1) Immediately discontinue use of the outlets.
- 2) Conduct second draw (flush) samples on these outlets to further delineate source of contamination.

A complete list of recommendations per outlet can be found in Appendix B.

Additional Recommendations

- 1) Follow-up samples should be collected after any remediation efforts in order to determine the efficacy of the work.

- 2) Any of the inoperable/non-functioning outlets listed above that are brought back into service should be sample.
- 3) Comply with all requirements set forth in NJAC 6A:26.

Appendix A Exceedances

Building	Date Collected	Sample ID	Sample Location	Concentration ppb
Bayberry Elementary	11/13/2021	19-BB-C113-BB	Rm C113 Bubbler	23
Bayberry Elementary	11/13/2021	22-BB-C126-BB	Rm C126 Bubbler	27.1
Bayberry Elementary	11/13/2021	27-BB-C121-BB	Rm C121 Bubbler	32.8

Appendix B Recommendations

Building	Sample Location	Concentration ppb	Recommendations
Bayberry Elementary	Rm C113 Bubbler	23	1) Immediately discontinue use of the outlets. 2) Conduct second draw (flush) samples on this outlet to further delineate source of contamination.
Bayberry Elementary	Rm C126 Bubbler	27.1	1) Immediately discontinue use of the outlets. 2) Conduct second draw (flush) samples on this outlet to further delineate source of contamination.
Bayberry Elementary	Rm C121 Bubbler	32.8	1) Immediately discontinue use of the outlets. 2) Conduct second draw (flush) samples on this outlet to further delineate source of contamination.

Appendix C All Results

Bayberry Elementary

Sample ID	Collection Date	Collection Location	Concentration ug/L (ppb)
1-BB-SK-S	11/13/2021	APR KITCHEN SINK	<1.00
2-BB-MPR-WC	11/13/2021	MPR WATER COOLER	<1.00
3A-BB-173-BF	11/13/2021	HALL A173 LEFT BOTTLE FILLER	<1.00
3B-BB-173-WC	11/13/2021	HALL A173 RIGHT WATER COOLER	<1.00
4-BB-A103-S	11/13/2021	A103 SINK	<1.00
5-BB-A108-S	11/13/2021	A108 SINK	<1.00
6-BB-C101-BB	11/13/2021	RM C101 BUBBLER	3.52
7-BB-C102-BB	11/13/2021	RM C102 BUBBLER	3.80
8-BB-C103-BB	11/13/2021	RM C103 BUBBLER	<1.00
9-BB-C104-BB	11/13/2021	RM C104 BUBBLER	2.99
10-BB-C105-BB	11/13/2021	RM C105 BUBBLER	2.05
11-BB-C106-BB	11/13/2021	RM C106 BUBBLER	1.84
12-BB-C107-BB	11/13/2021	RM C107 BUBBLER	3.81
13-BB-C108-BB	11/13/2021	RM C108 BUBBLER	1.27
14-BB-C109-BB	11/13/2021	RM C109 BUBBLER	1.85
15-BB-C110-BB	11/13/2021	RM C110 BUBBLER	1.89
17-BB-C111-BB	11/13/2021	RM C111 BUBBLER	1.50
18-BB-C120-S	11/13/2021	RM C120 SINK	<1.00
19-BB-C113-BB	11/13/2021	RM C113 BUBBLER	23.0
20-BB-C124-BB	11/13/2021	RM C124 BUBBLER	11.4
21-BB-C115-BB	11/13/2021	RM C115 BUBBLER	<1.00
22-BB-C126-BB	11/13/2021	RM C126 BUBBLER	27.1
23-BB-C117-BB	11/13/2021	RM C117 BUBBLER	<1.00
24-BB-C128-BB	11/13/2021	RM C128 BUBBLER	1.01
25-BB-C119-BB	11/13/2021	RM C119 BUBBLER	<1.00
26-BB-C130-BB	11/13/2021	RM C130 BUBBLER	1.09
27-BB-C121-BB	11/13/2021	RM C121 BUBBLER	32.8
28-BB-C132-BB	11/13/2021	RM C132 BUBBLER	<1.00
29-BB-A117-WC	11/13/2021	HALL RM A117 WATER COOLER	<1.00
30-BB-A133-BB	11/13/2021	HALL RM 133 BUBBLER	6.31
31-BB-A115-S	11/13/2021	A117 SINK	<1.00
32-BB-A128-BB	11/13/2021	RM A128 BB	1.67
34A-BB-GYM-BF	11/13/2021	GYM BOTTLE FILLER	<1.00
34B-BB-GYM-WC	11/13/2021	GYM WATER COOLER	<1.00
36-BB-D206-BB	11/13/2021	RM D206 BUBBLER	1.19
38-BB-D120-BB	11/13/2021	RM D210 BUBBLER	2.05
39-BB-D212-BB	11/13/2021	RM D212 BUBBLER	4.18
40-BB-D214-BB	11/13/2021	RM D214 BUBBLER	1.70
41-BB-SR-S	11/13/2021	SUNROOM SINK (QAQC)	<1.00

Valley View School

Sample ID	Collection Date	Collection Location	Concentration ug/L (ppb)
1-VV-101E-S	11/13/2021	Rm 101 E SINK	<1.00
2-VV-101-WC	11/13/2021	HALL RM 101 WATER COOLER	1.02
3-VV-GYM-BF	11/13/2021	GYM BOTTLE FILLER	<1.00
4-VV-GYM-BF	11/13/2021	GYM WATER COOLER	<1.00
5-VV-NS-BB	11/13/2021	NURSE BUBBLER	1.65
6-VV-SK-SL	11/13/2021	SAT KITCHEN SINK L	1.00
7-VV-144-BB	11/13/2021	RM 144 BUBBLER	5.03
8-VV-148-WC	11/13/2021	HALL RM 148 WATER COOLER	2.88
9-VV-136-BB	11/13/2021	RM 136 BUBBLER	<1.00
10-VV-134-BB	11/13/2021	RM 134 BUBBLER	1.23
11-VV-132-BB	11/13/2021	RM 132 BUBBLER	<1.00
12-VV-238-WC	11/13/2021	HALL RM 238 WATER COOLER	1.36
13-VV-L-BB	11/13/2021	KITCHEN BUBBLER	<1.00
14-VV-FR-S	11/13/2021	FACULTY RM SINK	<1.00
16-VV-SK-SR	11/13/2021	SATELLITE KITCHEN SINK R	<1.00
17-VV-SR-S	11/13/2021	SUNROOM SINK (QAQC)	<1.00
15-VV-201-WC	11/13/2021	RM 201 WATER COOLER	<1.00

Appendix D Floor Plan(s)

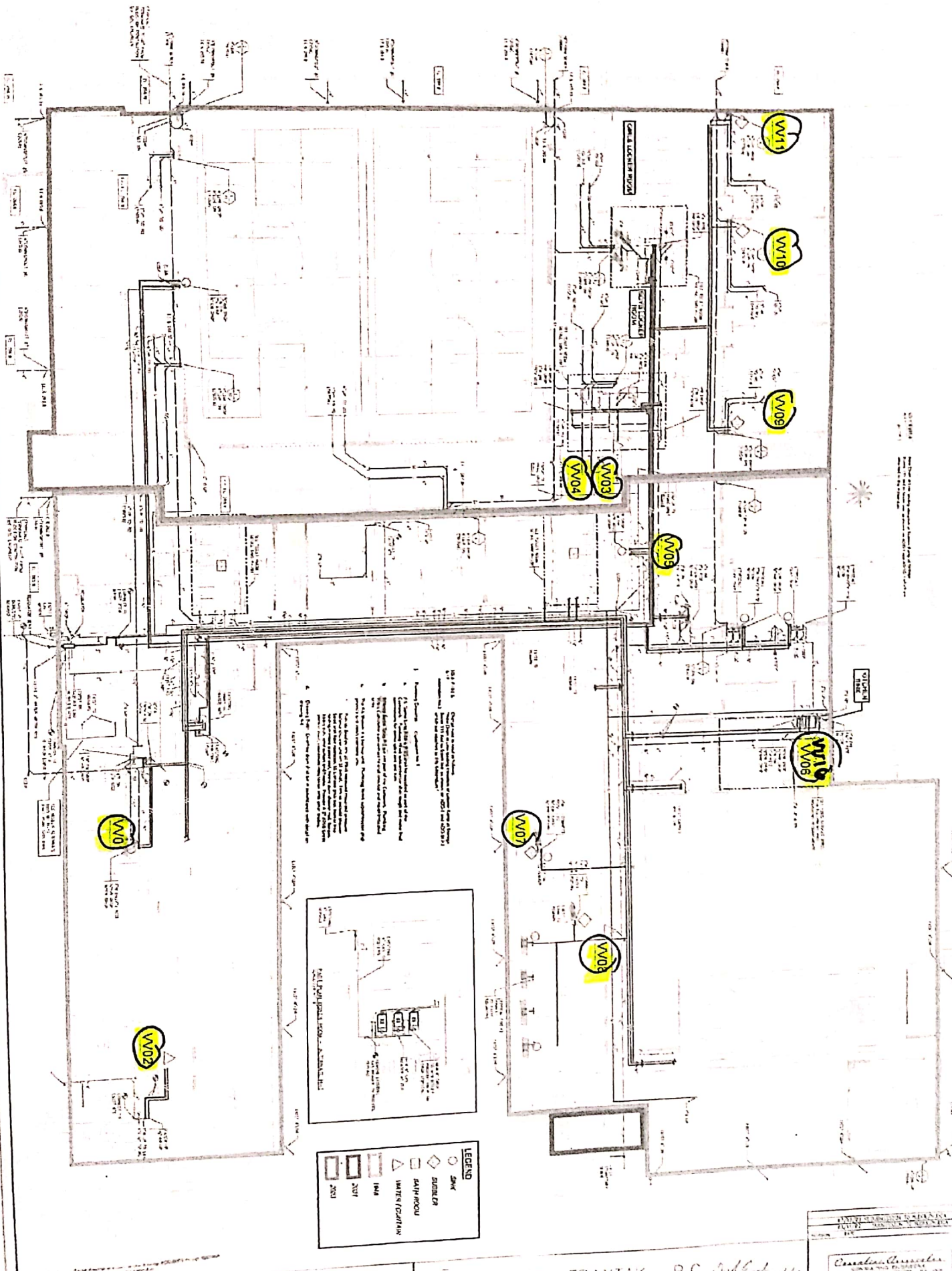

1. Všechny prvky a části zařízení jsou označeny podle svého účelu a funkce. Všechny prvky a části zařízení jsou označeny podle svého účelu a funkce. Všechny prvky a části zařízení jsou označeny podle svého účelu a funkce.

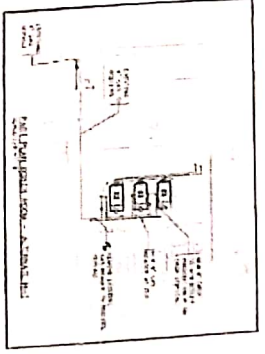

LEGENDA	
◊	DWG
◇	DUBLET
□	PAVN ROOM
△	WATER COLUMN
□	PAV
□	ZAV
□	ZAV

Bayberry School

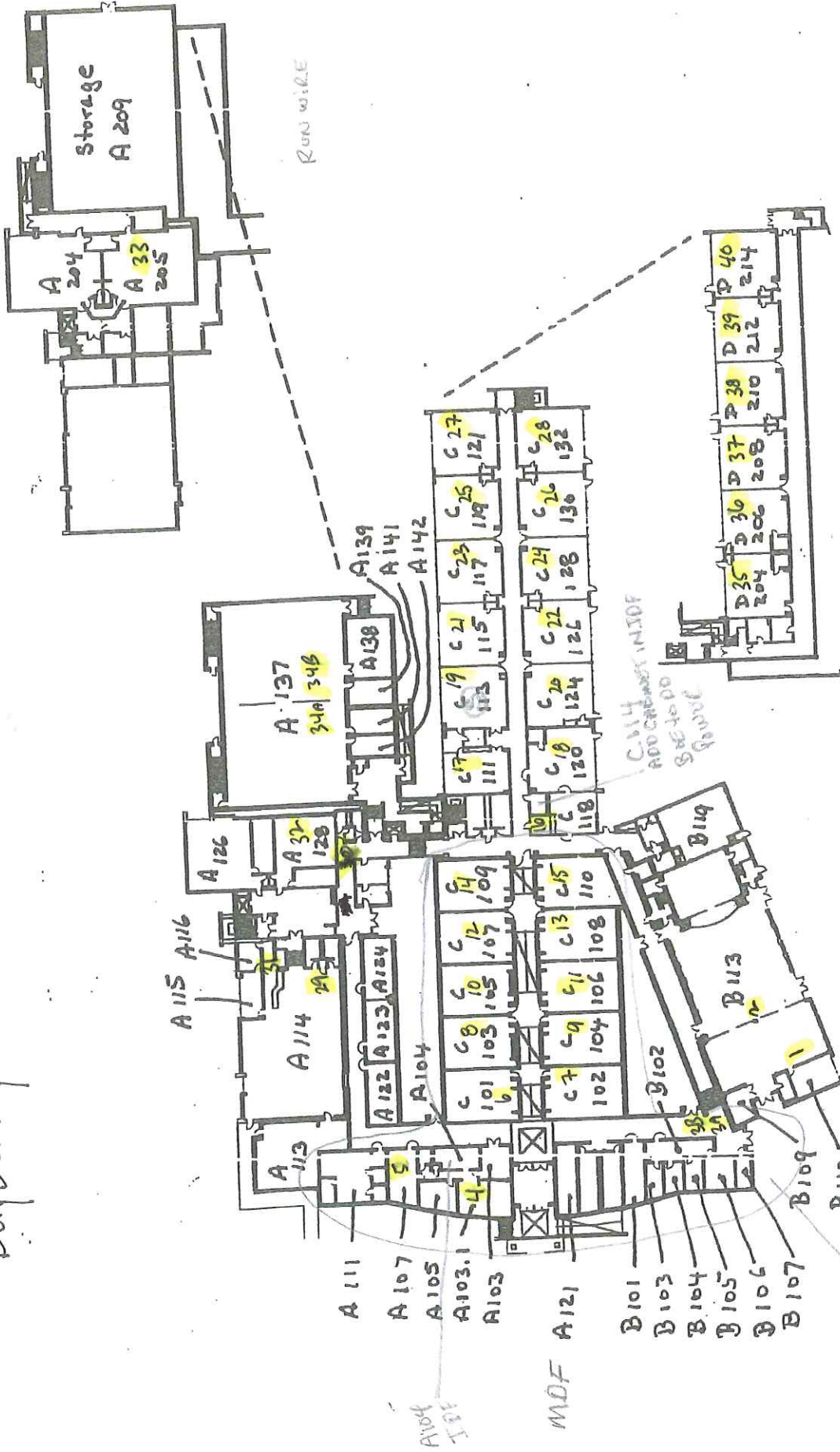

KEY PLAN (indicating scope of work)

N.T.S.
 Prepared for review
 11-5-2014
 Produced by
 [Signature]

Appendix E Laboratory Data



Environmental Hazards Services, L.L.C.
 7469 Whitepine Rd
 Richmond, VA 23237
 Telephone: 800.347.4010

Lead in Drinking Water Analysis Report

Report Number: 21-11-02526

Client: LEW Corp
 181 US Hwy 46
 Mine Hill, NJ 07803

Received Date: 11/16/2021
 Reported Date: 01/11/2022
 Sampled By: Michael Mosier
 Tech Certification #:

Project/Test Address: 210439; Bayberry; 113 Bayberry Lane; Watchung, NJ

Client Number:
 201327

Laboratory Results

Fax Number:
 Ext 18 Melissa

Lab Sample Number	Client Sample ID	Collection Date	Collection Location	Concentration ug/L (ppb)	Analysis Date	Narrative ID
21-11-02526-001	1-BB-SK-S	11/13/2021	APR KITCHEN SINK	<1.00	11/18/2021	
21-11-02526-002	2-BB-MPR-WC	11/13/2021	MPR WATER COOLER	<1.00	11/18/2021	
21-11-02526-003	3A-BB-173-BF	11/13/2021	HALL A173 LEFT BOTTLE FILLER	<1.00	11/18/2021	
21-11-02526-004	3B-BB-173-WC	11/13/2021	HALL A173 RIGHT WATER COOLER	<1.00	11/18/2021	
21-11-02526-005	4-BB-A103-S	11/13/2021	A103 SINK	<1.00	11/18/2021	
21-11-02526-006	5-BB-A108-S	11/13/2021	A108 SINK	<1.00	11/18/2021	
21-11-02526-007	6-BB-C101-BB	11/13/2021	RM C101 BUBBLER	3.52	11/18/2021	
21-11-02526-008	7-BB-C102-BB	11/13/2021	RM C102 BUBBLER	3.80	11/18/2021	
21-11-02526-009	8-BB-C103-BB	11/13/2021	RM C103 BUBBLER	<1.00	11/18/2021	
21-11-02526-010	9-BB-C104-BB	11/13/2021	RM C104 BUBBLER	2.99	11/18/2021	
21-11-02526-011	10-BB-C105-BB	11/13/2021	RM C105 BUBBLER	2.05	11/18/2021	
21-11-02526-012	11-BB-C106-BB	11/13/2021	RM C106 BUBBLER	1.84	11/18/2021	
21-11-02526-013	12-BB-C107-BB	11/13/2021	RM C107 BUBBLER	3.81	11/18/2021	

Rev 1.0 (Revised On: 01/11/2022): Changed sample description on sample 27 per client request.

Environmental Hazards Services, L.L.C

Client Number: 201327

Report Number: 21-11-02526

Project/Test Address: 210439; Bayberry; 113 Bayberry Lane; Watchung, NJ

Lab Sample Number	Client Sample ID	Collection Date	Collection Location	Concentration ug/L (ppb)	Analysis Date	Narrative ID
21-11-02526-014	13-BB-C108-BB	11/13/2021	RM C108 BUBBLER	1.27	11/18/2021	
21-11-02526-015	14-BB-C109-BB	11/13/2021	RM C109 BUBBLER	1.85	11/18/2021	
21-11-02526-016	15-BB-C110-BB	11/13/2021	RM C110 BUBBLER	1.89	11/18/2021	
21-11-02526-017	17-BB-C111-BB	11/13/2021	RM C111 BUBBLER	1.50	11/18/2021	
21-11-02526-018	18-BB-C120-S	11/13/2021	RM C120 SINK	<1.00	11/18/2021	
21-11-02526-019	19-BB-C113-BB	11/13/2021	RM C113 BUBBLER	23.0	11/18/2021	
21-11-02526-020	20-BB-C124-BB	11/13/2021	RM C124 BUBBLER	11.4	11/18/2021	
21-11-02526-021	21-BB-C115-BB	11/13/2021	RM C115 BUBBLER	<1.00	11/18/2021	
21-11-02526-022	22-BB-C126-BB	11/13/2021	RM C126 BUBBLER	27.1	11/18/2021	
21-11-02526-023	23-BB-C117-BB	11/13/2021	RM C117 BUBBLER	<1.00	11/18/2021	
21-11-02526-024	24-BB-C128-BB	11/13/2021	RM C128 BUBBLER	1.01	11/18/2021	
21-11-02526-025	25-BB-C119-BB	11/13/2021	RM C119 BUBBLER	<1.00	11/18/2021	
21-11-02526-026	26-BB-C130-BB	11/13/2021	RM C130 BUBBLER	1.09	11/18/2021	
21-11-02526-027	27-BB-C121-BB	11/13/2021	RM C121 BUBBLER	32.8	11/18/2021	
21-11-02526-028	28-BB-C132-BB	11/13/2021	RM C132 BUBBLER	<1.00	11/18/2021	
21-11-02526-029	29-BB-A117-WC	11/13/2021	HALL RM A117 WATER COOLER	<1.00	11/18/2021	
21-11-02526-030	30-BB-A133-BB	11/13/2021	HALL RM 133 BUBBLER	6.31	11/18/2021	
21-11-02526-031	31-BB-A115-S	11/13/2021	A117 SINK	<1.00	11/18/2021	
21-11-02526-032	32-BB-A128-BB	11/13/2021	RM A128 BB	1.67	11/18/2021	
21-11-02526-033	34A-BB-GYM-BF	11/13/2021	GYM BOTTLE FILLER	<1.00	11/18/2021	

Environmental Hazards Services, L.L.C

Client Number: 201327

Report Number: 21-11-02526

Project/Test Address: 210439; Bayberry; 113 Bayberry Lane; Watchung, NJ

Lab Sample Number	Client Sample ID	Collection Date	Collection Location	Concentration ug/L (ppb)	Analysis Date	Narrative ID
21-11-02526-034	34B-BB-GYM-WC	11/13/2021	GYM WATER COOLER	<1.00	11/18/2021	
21-11-02526-035	36-BB-D206-BB	11/13/2021	RM D206 BUBBLER	1.19	11/18/2021	
21-11-02526-036	38-BB-D120-BB	11/13/2021	RM D210 BUBBLER	2.05	11/18/2021	
21-11-02526-037	39-BB-D212-BB	11/13/2021	RM D212 BUBBLER	4.18	11/18/2021	
21-11-02526-038	40-BB-D214-BB	11/13/2021	RM D214 BUBBLER	1.70	11/18/2021	
21-11-02526-039	41-BB-SR-S	11/13/2021	SUNROOM SINK	<1.00	11/18/2021	

Method: EPA 200.8
 Analyst: Ailea Cabatbat
 Accreditation #: NJ VA008

Reviewed By Authorized Signatory: *Melissa Kanode*

Melissa Kanode

QA/QC Clerk

Sample Results denoted with a "less than" (<) sign contain less than the reporting limit which is 1 ppb.

The EPA Maximum Contaminant Level for Lead in Drinking Water is 15 ppb. The results herein conform to NELAC standards, where applicable, unless otherwise narrated on this report. Results represent the analysis of samples submitted by the client. Sample location, description, field parameter results, etc., were provided by the client. This report cannot be reproduced, except in full, without written approval from Environmental Hazards Services, L.L.C.

LEGEND ug/L= micrograms per liter ppb = parts per billion



ENVIRONMENTAL HAZARDS SERVICES, LLC

ONLINE CLIENT PORTAL AVAILABLE FOR ANALYSIS RESULTS AT: www.leadlab.com

Water Chain-of-Custody Form

SHIP TO: 7469 Whitepine Rd, Richmond, VA 23237
Phone: (800) 347-4010 FAX: (804) 275-4907

21-11-02526



Due Date: 11/23/2021 (Tuesday) AE

Company Name: LEW CORP

Address: 181 US Highway 46

Phone: (908-654-8068)

Email: labresults@lewcorp.com

Fax: 908-654-8069

City/State/Zip: Mine Hill, NJ 07803

Account #: 201327

Project Name / Collection Address: Barberry / 113 Barberry Lane

City/State/Zip: WATZVILLE, NJ

Project #: 210434

Sampled By: Michael Mosier

License #: (If Required):

1257600V8U94766989

Water Source: (Check One) Public Well

Well Tag #: (If Applicable):

<input checked="" type="checkbox"/>	5 Day Turnaround	<input type="checkbox"/>	3 Day Turnaround	<input type="checkbox"/>	2 Day Turnaround	<input type="checkbox"/>	1 Day Turnaround	Call Ahead
-------------------------------------	------------------	--------------------------	------------------	--------------------------	------------------	--------------------------	------------------	------------

No.	Client Sample ID	Collection Location (Eric Kitchen Sink)	Collection Date	Collection Time	Metals			Field Parameters		LAB USE
					Lead	Copper	Other	Field pH at time of Collection:	Temp. at time of Collection:	
1	1-BB-SK-S	APR KITCHEN SINK	11/13/2021		X					
2	2-BB-MPL-WC	MPL WATER COOLER								
3	3-BB-173-BF	HALL #173 1ST WATER FILTER								
4	4-BB-173-WC	↓ RIGHT WATER COOLER								
5	4-BB-A103-S	A103 SINK								
6	5-BB-A108-S	A108 SINK								
7	6-BB-C101-BB	Rm C101 RUBBER								
8	7-BB-C102-BB	Rm C102 RUBBER								
9	8-BB-C103-BB	Rm C103 RUBBER								
10	9-BB-C104-BB	Rm C104 RUBBER								

Released by: MICHAEL MOSIER

Signature: [Signature]

Date/Time: 11/13/2021

Released by: KT HARARI

Signature: [Signature]

Date/Time: 11/16/21 10:35AM



EHS Laboratories

ENVIRONMENTAL HAZARDS SERVICES, LLC

Water Chain-of-Custody Form

SHIP TO: 7469 Whitepine Rd. Richmond, VA 23237

Phone: (800) 347-4010 FAX: (804) 275-4907

ONLINE CLIENT PORTAL AVAILABLE FOR ANALYSIS RESULTS AT: www.leadlab.com

P.2

Company Name: LEW CORP

Account #: 201327

Address: 181 US Highway 46

City/State/Zip: Mine Hill, NJ 07803

Phone: (908-654-8068

Email: labresults@lewcorp.com

Fax: 908-654-8069

Project Name / Collection Address: Bayberry / 113 Bayberry Lane

City/State/Zip: Hawthorn, NJ

Project #: 210439

Sampled By: Michael Mosier

License # (If Required):

Water Source: (Check One) Public Well

Well Tag # (If Applicable):

~ For Lab Use Only ~

2526

No.	Client Sample ID	Collection Location (Exc: Kitchen Sink)	Collection Date	Collection Time	Metals			Field Parameters		LAB USE
					Lead	Copper	Other	Field pH at time of Collection:	Temp. at time of Collection:	
1	10-BB-C105-BB	Rm C105	BUBBLER		X					
2	11-BB-C106-BB									
3	12-BB-C107-BB									
4	13-BB-C108-BB									
5	14-BB-C109-BB									
6	15-BB-C110-BB									
7	16-BB-C111-BB									
8	17-BB-C120-S	SINK								
9	18-BB-C113-BB	BUBBLER								
10	20-BB-C124-BB									

Released by: MICHAEL MOSIER

Signature: [Signature]

Date/Time: 11/13/2021

Released by: KTHARRIS

Signature: [Signature]

Date/Time: 11-16-21 10:35 AM



Environmental Hazards Services, L.L.C.
 7469 Whitepine Rd
 Richmond, VA 23237
 Telephone: 800.347.4010

Lead in Drinking Water Analysis Report

Client: LEW Corp
 181 US Hwy 46
 Mine Hill, NJ 07803

Report Number: 21-11-02525
 Received Date: 11/16/2021
 Reported Date: 11/23/2021
 Sampled By: Michael Mosier
 Tech Certification #:

Project/Test Address: 210439; Valley View; 50 Valley View Rd; Watchung, NJ

Client Number:
 201327

Laboratory Results

Fax Number:
 Ext 18 Melissa

Lab Sample Number	Client Sample ID	Collection Date	Collection Location	Concentration ug/L (ppb)	Analysis Date	Narrative ID
21-11-02525-001	1-VV-101E-S	11/13/2021	RM 101 E SINK	<1.00	11/18/2021	
21-11-02525-002	2-VV-101-WC	11/13/2021	HALL RM 101 WATER COOLER	1.02	11/18/2021	
21-11-02525-003	3-VV-GYM-BF	11/13/2021	GYM BOTTLE FILLER	<1.00	11/18/2021	
21-11-02525-004	4-VV-GYM-WC	11/13/2021	GYM WATER COOLER	<1.00	11/18/2021	
21-11-02525-005	5-VV-NS-BB	11/13/2021	NURSE BUBBLER	1.65	11/18/2021	
21-11-02525-006	6-VV-SK-SL	11/13/2021	SAT KITCHEN SINK L	<1.00	11/18/2021	
21-11-02525-007	7-VV-144-BB	11/13/2021	RM 144 BUBBLER	5.03	11/23/2021	
21-11-02525-008	8-VV-148-WC	11/13/2021	HALL RM 148 WATER COOLER	2.88	11/18/2021	
21-11-02525-009	9-VV-136-BB	11/13/2021	RM 136 BUBBLER	<1.00	11/18/2021	
21-11-02525-010	10-VV-134-BB	11/13/2021	RM 134 BUBBLER	1.23	11/18/2021	
21-11-02525-011	11-VV-132-BB	11/13/2021	RM 132 BUBBLER	<1.00	11/18/2021	
21-11-02525-012	12-VV-238-WC	11/13/2021	HALL RM 238 WATER COOLER	1.36	11/18/2021	
21-11-02525-013	13-VV-L-BB	11/13/2021	KITCHEN BUBBLER	<1.00	11/18/2021	

Environmental Hazards Services, L.L.C

Client Number: 201327

Report Number: 21-11-02525

Project/Test Address: 210439; Valley View; 50 Valley View Rd; Watchung, NJ

Lab Sample Number	Client Sample ID	Collection Date	Collection Location	Concentration ug/L (ppb)	Analysis Date	Narrative ID
21-11-02525-014	14-VV-FR-S	11/13/2021	FACULTY RM SINK	<1.00	11/18/2021	
21-11-02525-015	16-VV-SK-SR	11/13/2021	SATELLITE KITCHEN SINK R	<1.00	11/18/2021	
21-11-02525-016	17-VV-SR-S	11/13/2021	SUNROOM SINK	<1.00	11/18/2021	
21-11-02525-017	15-VV-201-WC	11/13/2021	RM 201 WATER COOLER	<1.00	11/18/2021	

Method: EPA 200.8
Analyst: Ailea Cabatbat
Accreditation #: NJ VA008

Reviewed By Authorized Signatory: 

Melissa Kanode

QA/QC Clerk

Sample Results denoted with a "less than" (<) sign contain less than the reporting limit which is 1 ppb.

The EPA Maximum Contaminant Level for Lead in Drinking Water is 15 ppb. The results herein conform to NELAC standards, where applicable, unless otherwise narrated on this report. Results represent the analysis of samples submitted by the client. Sample location, description, field parameter results, etc., were provided by the client. This report cannot be reproduced, except in full, without written approval from Environmental Hazards Services, L.L.C.

LEGEND ug/L= micrograms per liter ppb = parts per billion



EHS Laboratories™

ENVIRONMENTAL HAZARDS SERVICES, LLC

Water Chain-of-Custody Form

SHIP TO: 7469 Whitepine Rd. Richmond, VA 23237

Phone: (800) 347-4010 FAX: (804) 275-4907

ONLINE CLIENT PORTAL AVAILABLE FOR ANALYSIS RESULTS AT: www.leadlab.com

P.1



21-11-02525

Due Date: 11/23/2021 (Tuesday) AE

Company Name: LEW CORP

Address: 181 US Highway 46

Phone: (908-654-8068

Email: labresults@lewcorp.com

City/State/Zip: Mine Hill, NJ 07803

Fax: 908-654-8069

Project Name / Collection Address: Valley View So Valley View Rd.

City/State/Zip: LITTLETON, NJ

Project #: 210439

Sampled By: MICHAEL MOSIER

License #: (If Required):

Water Source: (Check One) Public Well

Well Tag # (If Applicable):

No.	Client Sample ID	Collection Location (Ex: Kitchen Sink)	Collection Date	Collection Time	Metals			Field Parameters			
					Lead	Copper	Other	Field pH at time of Collection:	Temp. at time of Collection:	Temp at Time of Receipt:	
1	1-VV-101E-S	Rm 101E SINK	11/13/2021	AM / PM	<input checked="" type="checkbox"/>						
2	2-VV-101-WC	HALL Rm 101 WATER COOLER		AM / PM							
3	3-VV-6YM-BF	6YM BOTTLE FILLER		AM / PM							
4	4-VV-6YM-WC	6YM WATER COOLER		AM / PM							
5	5-VV-NS-BB	NURSE RUBBER		AM / PM							
6	6-VV-SK-SL	SAT. KITCHEN SINK L		AM / PM							
7	7-VV-144-BB	Rm 144 RUBBER		AM / PM							
8	8-VV-148-WC	HALL Rm 148 WATER COOLER		AM / PM							
9	9-VV-136-BB	Rm 136 RUBBER		AM / PM							
10	10-VV-134-BB	Rm 134 RUBBER		AM / PM							

Released by: MICHAEL MOSIER

Signature: [Signature]

Date/Time: 11/13/2021

Released by: KTHARRIS

Signature: [Signature]

Date/Time: 11.16.21 10:28 AM



EHS Laboratories
ENVIRONMENTAL HAZARDS SERVICES, LLC

Water Chain-of-Custody Form

SHIP TO: 7469 Whitepine Rd. Richmond, VA 23237
Phone: (800) 347-4010 FAX: (804) 275-4907

ONLINE CLIENT PORTAL AVAILABLE FOR ANALYSIS RESULTS AT: www.leadlab.com

P-2

8585

~ For Lab Use Only ~

Company Name: LEW CORP

Account #: 201327

Address: 181 US Highway 46

City/State/Zip: Mine Hill, NJ 07803

Phone: (908-654-8068

Email: labresults@lewcorp.com

Fax: 908-654-8069

Project Name / Collection Address: VALLEY VIEW / 50 VALLEY VIEW RD.

City/State/Zip: WARTHWICK, NJ

Project #: 210939

Sampled By: MICHAEL MOSIER

License # (If Required):

Water Source: (Check One) Public Well

Well Tag # (If Applicable):

No.	Client Sample ID	Collection Location (Exc: Kitchen Sink)	Collection Date	Collection Time	Metals			Field Parameters		LAB USE Temp at Time of Receipt:
					Lead	Copper	Other	Field pH at time of Collection:	Temp. at time of Collection:	
11	11 - VV - 132-BB	Rm 132 RUBBER	11/12/2021	AM / PM	X					
12	12 - VV - 288-WC	HALL Rm 288 WATER COOLER		AM / PM						
13	13 - VV - L-BB	KITCHEN RUBBER		AM / PM						
14	14 - VV - FL-S	FACULTY Rm SINK		AM / PM						
15	15 - VV - SK-SR	SABOTE KITCHEN SINK		AM / PM						
16	17 - VV - SR-S	SURROOM SINK		AM / PM						
17	15 - VV - 201-WC	Rm 201 WATER COOLER		AM / PM						
8				AM / PM						
9				AM / PM						
10				AM / PM						

Released by: MICHAEL MOSIER

Signature: [Signature]

Date/Time: 11/13/2021

Released by: RTHARRIS

Signature: [Signature]

Date/Time: 11.10.21 10:38 AM

1 Day Turnaround Call Ahead