

1 First Floor 6-8 Option
A-1 1" = 20'-0"

Grades 6 / 7 / 8

Notes:			
Existing SF:	113,975	Current Enrollment:	1,140 Students
1st Floor Addition SF:	89,916	Projected Enrollment:	2,100 Students
2nd Floor Addition SF:	46,964		
Total Addition SF:	136,880		
Total SF:	250,855		
OFCC Required SF:	250,853		



Set Issuance

05/05/2023

Revision

Plains - First Floor

for
Lakota Local School District
5572 Princeton Road, Liberty Township, OH



First Floor 6-8
Option
A-1

4/24/2023 11:28:05 AM

Autodesk Docs/1227-xvt/Lakota Master Planning/227-8-0_Plains-VanGorden_R23_CENTRAL.rvt

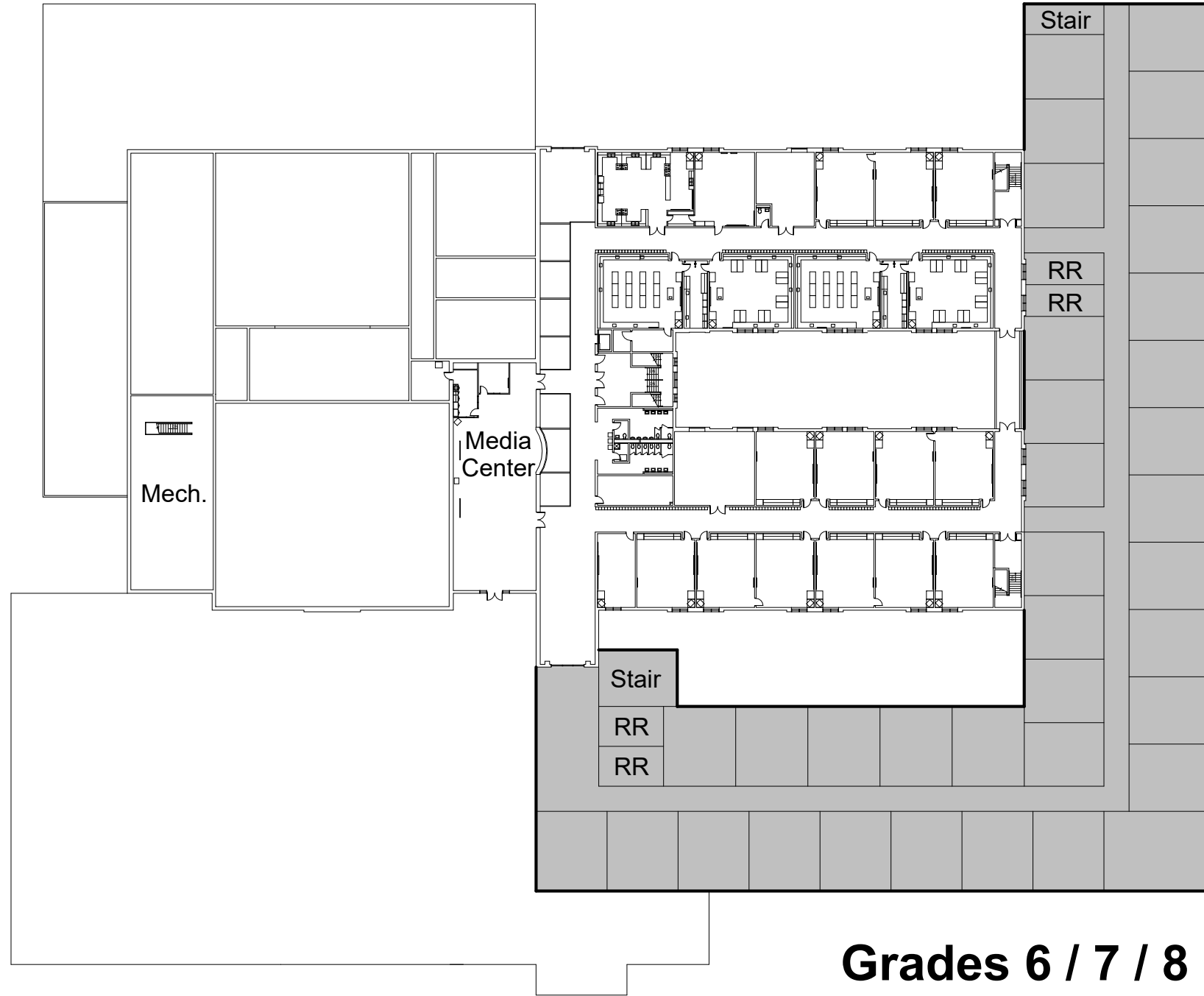

1 Second Floor 6-8 Option
 A-2 1" = 20'-0"

Grades 6 / 7 / 8

Notes:		
Existing SF:	113,975	Current Enrollment: 1,140 Students
1st Floor Addition SF:	89,916	Projected Enrollment: 2,100 Students
2nd Floor Addition SF:	46,964	
Total Addition SF:	136,880	
Total SF:	250,855	
OFCC Required SF:	250,853	



Set Issuance

05/05/2023

Revision

Plains - Second Floor

for
 Lakota Local School District
 5572 Princeton Road, Liberty Township, OH



414 Reading Road, Mason, OH 45040

Second Floor 6-8
 Option
A-2

4/24/2023 11:28:05 AM

Autodesk Docs / 027-xvt-Lakota Master Planning/227-8-0_Plains-Venue/023_CENTRAL.rvt

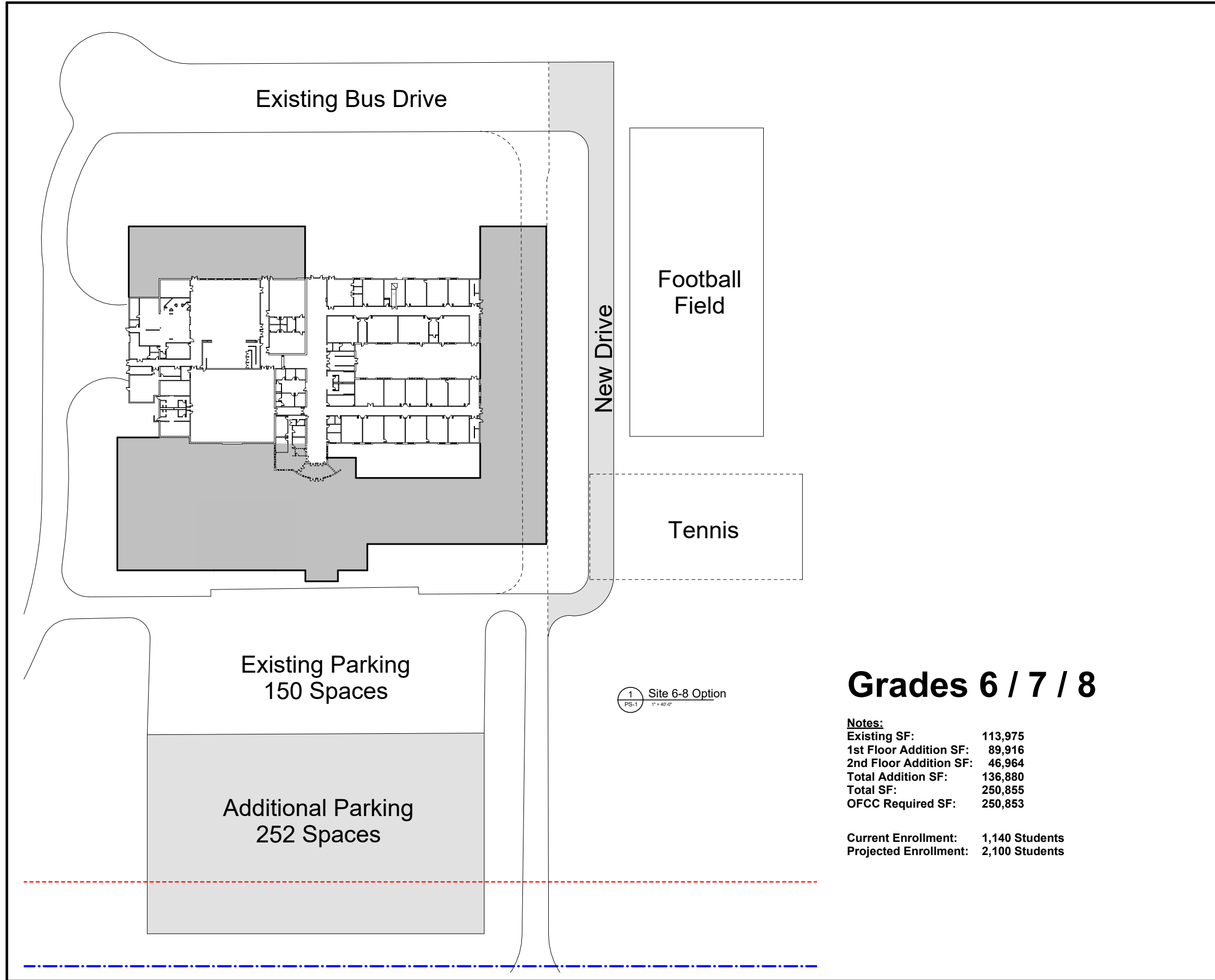

Grades 6 / 7 / 8

Notes:

Existing SF:	113,975
1st Floor Addition SF:	89,916
2nd Floor Addition SF:	46,964
Total Addition SF:	136,880
Total SF:	250,855
OFCC Required SF:	250,853

Current Enrollment:	1,140 Students
Projected Enrollment:	2,100 Students



Set Issuance

05/05/2023

Revision

Plains - Site

for
Lakota Local School District
5572 Princeton Road, Liberty Township, OH



414 Reading Road, Mason, OH 45040

Site 6-8 Option

PS-1