

Addendum
BUUSD Facilities/Transportation
Committee Meeting
May 1, 2023



☐ Bedford, NH 03110 (603) 883-0463
☒ Randolph, VT 05060 (802) 728-3376
☐ S. Burlingt., VT 05403 (802) 878-7661
☐ Springfield, VT 05156 (802) 591-4326

Engineering • Planning • Development • Management

JOB GSI Spaulding High School

SHEET NO. 1 OF 1

CALCULATED BY: SLR DATE: 5/1/2023

CHECKED BY: CJR DATE: 5/1/2023

SCALE: _____

GSI Spaulding High School

ITEM NO.	DESCRIPTION	UNIT	QUANT.	UNIT PRICE	AMOUNT
203.15	COMMON EXCAVATION	CY	650	\$15.00	\$9,750.00
203.28	EXCAVATION OF SURFACES AND PAVEMENTS	CY	15	\$35.00	\$525.00
203.31	SAND BORROW	CY	420	\$40.00	\$16,800.00
204.20	TRENCH EXCAVATION OF EARTH	CY	30	\$25.00	\$750.00
204.25	STRUCTURE EXCAVATION	CY	20	\$25.00	\$500.00
301.26	SUBBASE OF CRUSHED GRAVEL, FINE GRADED	CY	20	\$50.00	\$1,000.00
406.35	SUPERPAVE BITUMINOUS CONCRETE PAVEMENT	TON	30	\$200.00	\$6,000.00
601.2603	8" CPEP(SL)	LF	30	\$25.00	\$750.00
604.20	PRECAST CONCRETE CATCH BASIN WITH CAST IRON COVER	EA	1	\$5,000.00	\$5,000.00
605.10	UNDERDRAIN PIPE, 6 INCHES	LF	495	\$30.00	\$14,850.00
605.20	UNDERDRAIN CARRIER PIPE, 6 INCHES	LF	130	\$30.00	\$3,900.00
616.210	VERTICAL GRANITE CURB	LF	79	\$9.00	\$711.00
616.41	REMOVAL OF EXISTING CURB	LF	58	\$9.00	\$522.00
651.15	SEED	LB	25	\$20.00	\$500.00
651.18	FERTILIZER	LB	150	\$10.00	\$1,500.00
651.20	AGRICULTURAL LIMESTONE	TON	0.60	\$750.00	\$448.69
651.25	HAY MULCH	TON	0.60	\$1,000.00	\$600.00
651.35	TOPSOIL	CY	12	\$50.00	\$583.33
692.00	MOBILIZATION/DEMOBILIZATION	LS	1	\$10,000.00	\$10,000.00
900.608	SPECIAL PROVISION (PEA STONE)	CY	40	\$45.00	\$1,800.00
	Running Total				\$74,690.02
	Contingency (15%)				\$11,203.50
	CONSTRUCTION COST				\$86,000.00
	OTHER COSTS				
	Bid/Construction Phase Services (15%)				\$22,000.00
	OTHER COSTS TOTAL				\$22,000.00
	Grand Total				\$108,000.00

NOTE: In providing opinions of probable construction costs, the Client understands that DuBois & King, Inc. has no control over the cost or availability of labor, equipment or materials, or over market conditions or the Contractor's methods of pricing, and that our Opinion of Probable Construction Costs are made on the basis of our professional judgment and experience. DuBois & King, Inc. makes no warranty, expressed or implied, that the bids or the negotiated costs of the Work will not vary from the Opinion of Probable Construction Cost provided herein.



- | | | |
|-------------------------------------|------------------------|----------------|
| <input type="checkbox"/> | Bedford, NH 03110 | (603) 883-0463 |
| <input checked="" type="checkbox"/> | Randolph, VT 05060 | (802) 728-3376 |
| <input type="checkbox"/> | S. Burlingt., VT 05403 | (802) 878-7661 |
| <input type="checkbox"/> | Springfield, VT 05156 | (802) 591-4326 |

Engineering * Planning * Development * Management

JOB GSI Spaulding High School

SHEET NO. 1 OF 1

CALCULATED BY: SLR DATE: 5/1/2023

CHECKED BY: CJR DATE: 5/1/2023

SCALE: _____

PROFESSIONAL SEAL

**NOT FOR
CONSTRUCTION
CONCEPTUAL
PLANS**

[illegible]

GREEN SCHOOLS
INITIATIVE

SPAULDING
HIGH SCHOOL
155 AYERS ST.
BARRE, VT 05641

SHEET TITLE

PROPOSED
CONDITIONS
PLAN 1

DRAWN BY SLR	DATE MAY 2023
CHECKED BY CJR	D&K PROJECT # 127689
PROJ. ENG. CJR	D&K ARCHIVE #

SHEET NUMBER	
--------------	--

3

SHEET 3 OF 5

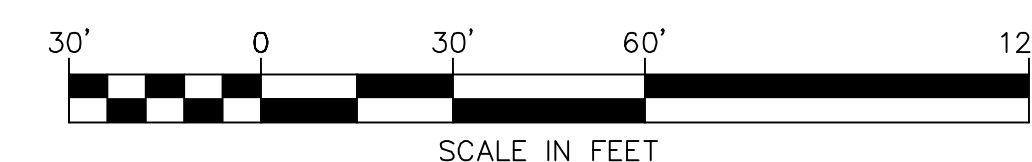
PROPOSED CONDITIONS PLAN

**NOT FOR
CONSTRUCTION
CONCEPTUAL
PLANS**

[illegible]

SPAULDING
HIGH SCHOOL

155 AYERS ST.
BARRE, VT 05641

SHEET TITLE

PROPOSED
CONDITIONS
PLAN 2

DRAWN BY SLR	DATE MAY 2023
CHECKED BY CJR	D&K PROJECT # 127689
PROJ. ENG. CJR	D&K ARCHIVE #

SHEET NUMBER
4
SHEET 4 OF 5



PROPOSED CONDITIONS PLAN

**NOT FOR
CONSTRUCTION
CONCEPTUAL
PLANS**

[illegible]

SPAULDING
HIGH SCHOOL

155 AYERS ST.
BARRE, VT 05641

SHEET TITLE

STORMWATER DETAILS

DRAWN BY SLR	DATE MAY 2023
CHECKED BY CJR	D&K PROJECT # 127689
PROJ. ENG. CJR	D&K ARCHIVE #

SHEET NUMBER

5

SHEET 5 OF 5

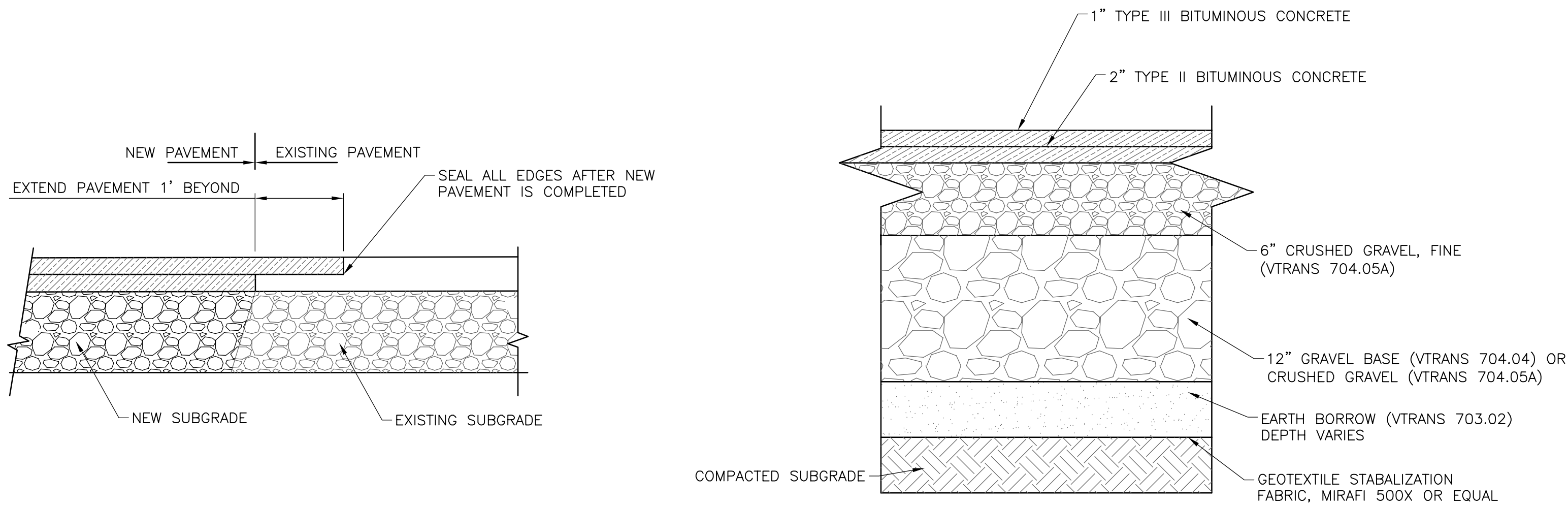

NOT TO SCALE

1. TYPE II AND TYPE III BITUMINOUS CONCRETE MIXTURES SHALL COMPLY WITH VAOT STANDARD STANDARD SPECIFICATIONS FOR CONSTRUCTION (404.06).

NOT TO SCALE

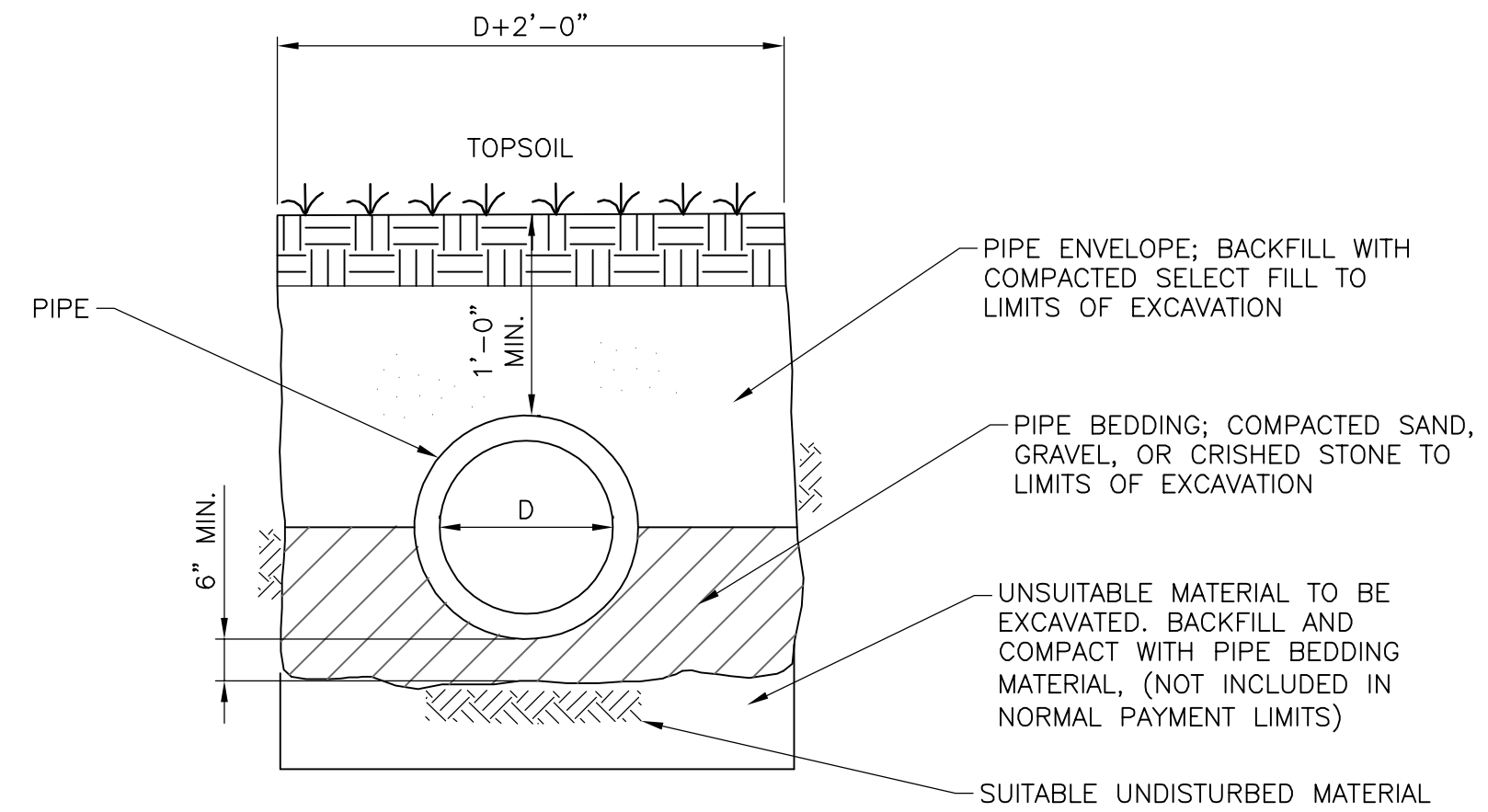

NOT TO SCALE

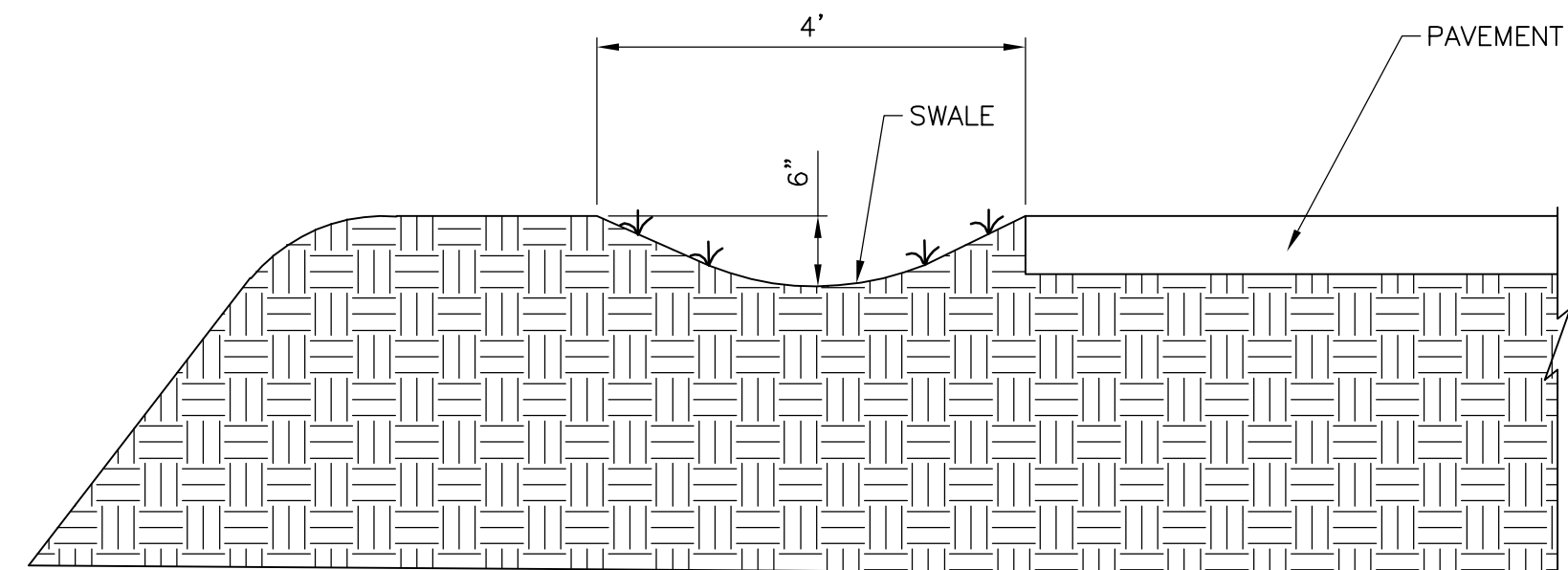

NOT TO SCALE

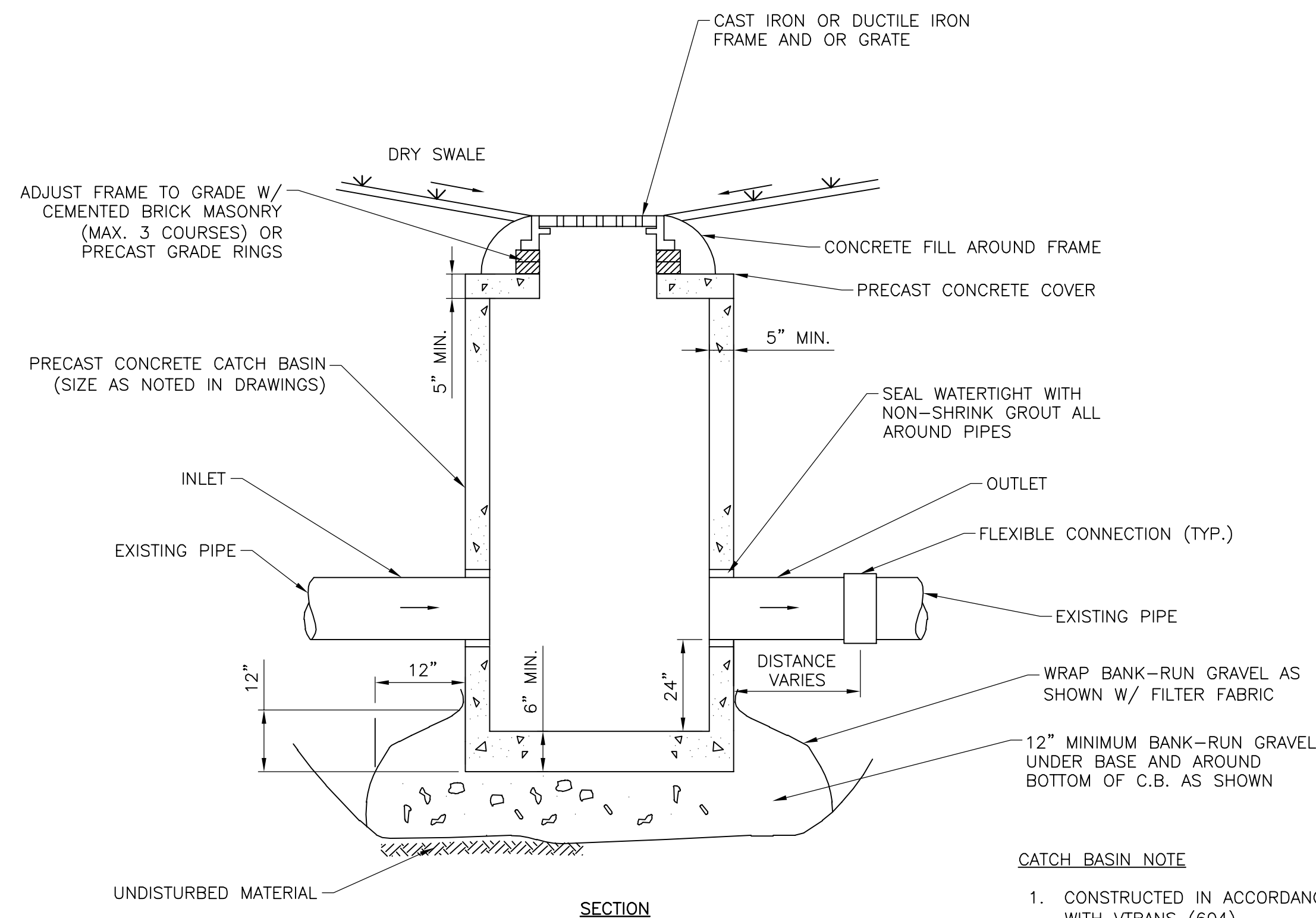

NOT TO SCALE

1. CONSTRUCTED IN ACCORDANCE WITH VTRANS (604).
2. CATCH BASIN SHALL BE CAPABLE OF WITHSTANDING A H-20 WHEEL LOADING

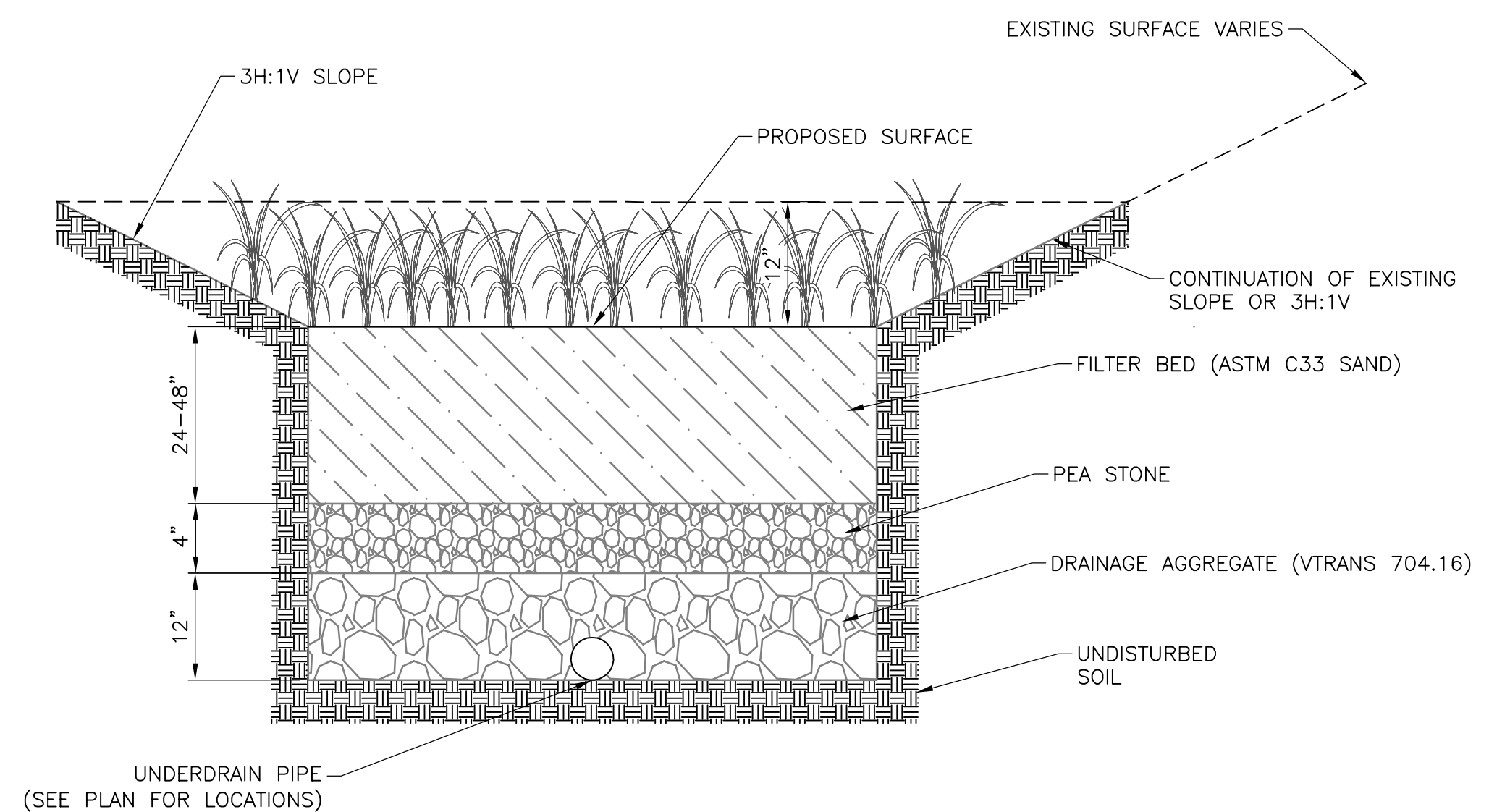

NOT TO SCALE

Application and Certificate For Payment

Page 1

To Owner: Barre Unified Union School Dis 120 Ayers St. Barre, VT 05641	Project: Barre Spaulding HS Vent. 155 Ayers St. Barre, VT 05641	Application No: 5 Date: 03/28/2023
From (Contractor): Energy Efficient Inv, Inc. 19D Star Dr. Merrimack, NH 03054	Contractor Job Number: 200409	Period To: 03/31/23 Architect's Project No:
Phone: (603) 423-6000	Via (Architect):	Contract Date: 11/15/22
Contract For:		

Contractor's Application For Payment

Change Order Summary	Additions	Deductions
Change orders approved in previous months by owner		
Number	Date Approved	
Change orders approved this month		
Totals		
Net change by change orders		

The undersigned Contractor certifies that to the best of the Contractor's knowledge, information, and belief the work covered by this Application for Payment has been completed in accordance with the Contract Documents, that all amounts have been paid by the Contractor for work for which previous Certificates for Payment were issued and payments received from the Owner, and that current payment shown herein is now due.

Contractor:
By: Ramona LaRosa Date: 3/28/23

State of: _____ County of: _____

Subscribed and sworn to before me this _____ day of _____,

_____ (year). Notary public: _____

My commission expires _____.

Original contract sum	7,267,150.00
Net change by change orders	0.00
Contract sum to date	7,267,150.00
Total completed and stored to date	1,081,569.50
Retainage	
5.0% of completed work	54,078.48
0.0% of stored material	0.00
Total retainage	54,078.48
Total earned less retainage	1,027,491.02
Less previous certificates of payment	680,266.40
6.000% of taxable amount	0.00
Current sales tax	0.00
Current payment due	347,224.62
Balance to finish, including retainage	6,239,658.98

Architect's Certificate for Payment

In accordance with the Contract Documents, based on on-site observations and the data comprising the above application the Architect certifies to the Owner that to the best of the Architect's knowledge, information and belief the Work has progressed as indicated, the quality of the Work is in accordance with the Contract Documents, and the Contractor is entitled to payment of the Amount Certified.

Amount Certified: \$ _____

Architect:

By: _____ Date: _____

This Certification is not negotiable. The Amount Certified is payable only to the Contractor named herein. Issuance, payment, and acceptance of payment are without prejudice to any rights of the Owner or Contractor under this Contract.

Lisa Penneaux 3/28/23
245-3097-19-11-4-2610-53220 (vent project)

Application and Certificate For Payment -- page 2

To Owner: Barre Unified Union School Dis
From (Contractor): Energy Efficient Inv, Inc.
Project: Barre Spaulding HS Vent.

Application No: 5 Date: 03/28/23 Period To: 03/31/23
Contractor's Job Number: 200409
Architect's Project No:

Item Number	Description	Scheduled Value	Work Completed		Materials Presently Stored	Completed and Stored to Date	%	Balance to Finish	Retention	Memo
			Previous Application	This Period						
001	General Conditions	680,720.00	30,632.40	37,439.60	0.00	68,072.00	10.00	612,648.00	3,403.60	
002	HVAC Equipment	598,000.00	18,500.00	0.00	0.00	18,500.00	3.09	579,500.00	925.00	
003	Design	133,350.00	60,007.50	0.00	0.00	60,007.50	45.00	73,342.50	3,000.38	
004	Demolition	115,000.00	9,200.00	0.00	0.00	9,200.00	8.00	105,800.00	460.00	
005	Abatement	261,000.00	0.00	32,625.00	0.00	32,625.00	12.50	228,375.00	1,631.25	
006	Masonry	39,900.00	0.00	0.00	0.00	0.00	0.00	39,900.00	0.00	
007	Steel Support	99,750.00	59,850.00	0.00	0.00	59,850.00	60.00	39,900.00	2,992.50	
008	Carpentry	99,750.00	9,975.00	9,975.00	0.00	19,950.00	20.00	79,800.00	997.50	
009	Roofing	62,500.00	0.00	12,500.00	0.00	12,500.00	20.00	50,000.00	625.00	
010	Drywall	178,000.00	0.00	17,800.00	0.00	17,800.00	10.00	160,200.00	890.00	
011	Ceilings	439,000.00	7,000.00	36,900.00	0.00	43,900.00	10.00	395,100.00	2,195.00	
012	Mechanical	1,925,000.00	192,500.00	144,375.00	0.00	336,875.00	17.50	1,588,125.00	16,843.75	
013	Spinkler	890,270.00	40,000.00	0.00	0.00	40,000.00	4.49	850,270.00	2,000.00	
014	EMS	408,000.00	53,040.00	20,400.00	0.00	73,440.00	18.00	334,560.00	3,672.00	
015	Electrical	1,007,000.00	95,665.00	50,350.00	0.00	146,015.00	14.50	860,985.00	7,300.75	
016	Crane	62,700.00	0.00	3,135.00	0.00	3,135.00	5.00	59,565.00	156.75	
017	Contractors Contingency	127,510.00	0.00	0.00	0.00	0.00	0.00	127,510.00	0.00	
018	Bonds	72,700.00	72,700.00	0.00	0.00	72,700.00	100.00	0.00	3,635.00	
019	Permits	67,000.00	67,000.00	0.00	0.00	67,000.00	100.00	0.00	3,350.00	
Application Total		7,267,150.00	716,069.90	365,499.60	0.00	1,081,569.50	14.88	6,185,580.50	54,078.48	