

LAUREL ELEMENTARY

MENLO PARK, CALIFORNIA

PROJECT DIRECTORY

CLIENT
MENLO PARK CITY SCHOOL DISTRICT
181 ENCINAL AVE, AHERTON
ATHERTON, CA 94027
PH: 650-321-7140 EXT 5614
CONTACT: AHMAD SHEIKHOESLAMI

LANDSCAPE ARCHITECT
GATES + ASSOCIATES
2671 CROW CANYON ROAD
SAN RAMON, CA 94583
PH: (925) 736-8176
CONTACT: MELONIE O'SULLIVAN

GENERAL NOTES

1. THE CONTRACTOR AGREES THAT, IN ACCORDANCE WITH GENERALLY ACCEPTED CONSTRUCTION PRACTICES, THE CONTRACTOR WILL BE REQUIRED TO ASSUME SOLE AND COMPLETE RESPONSIBILITY FOR JOB SITE CONDITIONS DURING THE COURSE OF CONSTRUCTION OF THE PROJECT, INCLUDING SAFETY OF ALL PERSONS AND PROPERTY. THIS REQUIREMENT SHALL BE MADE TO APPLY CONTINUOUSLY AND NOT BE LIMITED TO NORMAL WORKING HOURS. THE CONTRACTOR FURTHER AGREES TO DEFEND, INDEMNIFY AND HOLD OWNER AND ENGINEER HARMLESS FROM ANY AND ALL LIABILITY, REAL OR ALLEGED, IN CONNECTION WITH THE PERFORMANCE OF WORK ON THIS PROJECT, EXEMPTING LIABILITY ARISING FROM THE SOLE NEGLIGENCE OF ENGINEER.
2. EXCAVATIONS SHALL BE ADEQUATELY SHORED, BRACED AND SHEETED SO THAT THE EARTH WILL NOT SLIDE OR SETTLE AND SO THAT ALL EXISTING IMPROVEMENTS OF ANY KIND WILL BE FULLY PROTECTED FROM DAMAGE. ANY DAMAGE RESULTING FROM A LACK OF ADEQUATE SHORING, BRACING AND SHEETING, SHALL BE THE RESPONSIBILITY OF THE CONTRACTOR AND HE SHALL EFFECT NECESSARY REPAIRS OR RECONSTRUCTION AT HIS OWN EXPENSE. WHERE THE EXCAVATION FOR A CONDUIT TRENCH, AND/OR STRUCTURE IS FIVE FEET OR MORE IN DEPTH, THE CONTRACTOR SHALL PROVIDE ADEQUATE SHEETING, SHORING AND BRACING OR EQUIVALENT METHOD, FOR THE PROTECTION OF LIFE, OR LIMB, WHICH SHALL CONFORM TO THE APPLICABLE CONSTRUCTION SAFETY ORDERS OF THE DIVISION OF INDUSTRIAL SAFETY OF THE STATE OF CALIFORNIA, THE CONTRACTOR SHALL ALWAYS COMPLY WITH OSHA REQUIREMENTS.
3. ALL APPLICABLE REQUIREMENTS OF THE CALIFORNIA CONSTRUCTION AND GENERAL INDUSTRY SAFETY ERRORS, THE OCCUPATIONAL SAFETY AND HEALTH ACT AND THE CONSTRUCTION SAFETY ACT SHALL BE MET.
4. IT IS THE RESPONSIBILITY OF THE CONTRACTOR TO OBTAIN PERMITS NECESSARY TO PERFORM THE WORK SHOWN IN THESE PLANS FROM THE APPROPRIATE AGENCIES.
5. THE CONTRACTOR SHALL TAKE EFFECTIVE ACTION TO PREVENT THE FORMATION OF AN AIRBORNE DUST NUISANCE AND SHALL BE RESPONSIBLE FOR ANY DAMAGE RESULTING FROM THEIR FAILURE TO DO SO.
6. THE CONTRACTOR MUST PROVIDE FOR SAFE ACCESSIBLE INGRESS AND EGRESS FOR ADJACENT PROPERTY OWNERS AND EVA THROUGHOUT THE PERIOD OF CONSTRUCTION. TEMPORARY THROUGH ACCESS FOR THE GENERAL PUBLIC DUE TO CONSTRUCTION STAGING OR LIMITATIONS MUST BE FULLY REVIEWED AND APPROVED BY THE OWNER PRIOR TO IMPLEMENTATION. ALL ACCESS MUST BE SAFE, SECURED, FLAGGED, SIGNED, AND ACCESSIBLE PER THE APPROVED SITE ACCESS PLAN SUBMITTED BY THE CONTRACTOR AND REQUIRED BY THE OWNER.
7. DURING CONSTRUCTION, THE CONTRACTOR SHALL BE RESPONSIBLE FOR EMERGENCY VEHICLE ACCESS, PUBLIC SAFETY AND SAFETY OF EXISTING STRUCTURES. THE CONTRACTOR SHALL PROVIDE ALL LIGHTS, SIGNS, FENCING, BARRICADES, TRAFFIC CONTROLS, FLAGGERS, SHORINGS, BRACING AND GUYS OR OTHER DEVICES NECESSARY TO PROVIDE FOR SAFETY IN ACCORDANCE WITH ALL NATIONAL, STATE SPECS AND LOCAL SAFETY ORDINANCES.
8. THE CONTRACTOR SHALL POST EMERGENCY TELEPHONE NUMBERS FOR POLICE, FIRE, AMBULANCE, AND THOSE AGENCIES RESPONSIBLE FOR MAINTENANCE OF UTILITIES IN THE VICINITY OF JOB SITE.
9. ALL EXISTING UTILITIES AND IMPROVEMENTS ARE SHOWN IN THEIR APPROXIMATE LOCATIONS BASED UPON RECORD INFORMATION AVAILABLE TO THE ENGINEER AT THE TIME OF PREPARATION OF THESE PLANS. LOCATIONS MAY NOT HAVE BEEN VERIFIED IN THE FIELD AND NO GUARANTEE IS MADE AS TO THE ACCURACY OR COMPLETENESS OF THE INFORMATION SHOWN. THE CONTRACTOR SHALL NOTIFY UTILITY COMPANIES AT LEAST THREE (3) WORKING DAYS IN ADVANCE OF CONSTRUCTION TO FIELD LOCATE UTILITIES. CALL UNDERGROUND SERVICE ALERT (U.S.A.), AT 800-227-2600. IT SHALL BE THE RESPONSIBILITY OF THE CONTRACTOR TO DETERMINE THE EXISTENCE AND LOCATION OF THOSE UTILITIES SHOWN ON THESE PLANS OR INDICATED IN THE FIELD BY LOCATING SERVICES. ADDITIONAL COSTS INCURRED AS A RESULT OF CONTRACTOR'S FAILURE TO VERIFY LOCATIONS OF EXISTING UTILITIES PRIOR TO BEGINNING OF CONSTRUCTION IN THEIR VICINITY SHALL BE BORNE BY THE CONTRACTOR AND ASSUMED INCLUDED AND MERGED IN THE CONTRACT UNIT PRICE.
10. ALL EXISTING UTILITIES AND IMPROVEMENTS THAT BECOME DAMAGED DURING CONSTRUCTION MUST BE COMPLETELY RESTORED TO THE SATISFACTION OF THE CITY ENGINEER OR UTILITY AGENCY REPRESENTATIVE, AT THE CONTRACTOR'S SOLE EXPENSE.
11. ANY RELOCATION OF PUBLIC UTILITIES SHALL BE CONDUCTED IN ACCORDANCE WITH ANY AND ALL REQUIREMENTS OF THE UTILITY COMPANY REPRESENTATIVE INCLUDING FEES, BONDS, PERMITS AND WORKING CONDITIONS, ETC. THIS WORK SHALL BE DONE AT NO EXPENSE TO THE UTILITY COMPANY. THE OWNER SHALL PAY THE COST OF ALL SUCH RELOCATION WORK INCLUDING FEES, BONDS, PERMITS, ETC.
12. THE CONSTRUCTION OF ALL GRAVITY UNDERGROUND LINES (STORM DRAINS) SHALL BEGIN AT THE MOST DOWNSTREAM END, UNLESS OTHERWISE SPECIFICALLY APPROVED BY ENGINEER OR BY THE OWNER.
13. IF ARCHEOLOGICAL MATERIALS ARE UNCOVERED DURING GRADING, TRENCHING OR OTHER EXCAVATION, EARTHWORK WITHIN 50 FEET OF THESE MATERIALS SHALL BE STOPPED UNTIL A PROFESSIONAL ARCHEOLOGIST WHO IS CERTIFIED BY THE SOCIETY OF CALIFORNIA ARCHEAEOLOGY (SCA) AND/OR THE SOCIETY OF PROFESSIONAL ARCHEAEOLOGY (SOPA) HAS HAD AN OPPORTUNITY TO EVALUATE THE SIGNIFICANCE OF THE FIND AND SUGGEST APPROPRIATE MITIGATION MEASURES, IF THEY ARE DEEMED NECESSARY.
14. THE USE OR INSTALLATION OF ANY MATERIAL OR EQUIPMENT WHICH IS MADE FROM, OR WHICH CONTAINS ASBESTOS FOR USE IN THE CONSTRUCTION OF THESE IMPROVEMENTS, IS NEITHER SPECIFIED NOR RECOMMENDED. ANY PARTY INSTALLING OR USING ANY PARTY SUCH MATERIALS OR EQUIPMENT SHALL BE SOLELY RESPONSIBLE FOR ALL INJURIES, DAMAGES, OR LIABILITIES OF ANY KIND, CAUSED BY THE USE OF SUCH MATERIALS OR EQUIPMENT.
15. THE CONTRACTOR MUST MEET AND IMPLEMENT ALL NPDES, SWPPP, AND EROSION CONTROL REQUIREMENTS IN EFFECT AT THE TIME OF CONSTRUCTION.
16. SHOULD IT APPEAR THAT THE WORK TO BE DONE OR ANY MATTER RELATIVE THERETO IS NOT SUFFICIENTLY DETAILED OR EXPLAINED ON THESE PLANS, THE CONTRACTOR SHALL CONTACT GATES & ASSOCIATES AT (925) 736-8176 FOR SUCH FURTHER EXPLANATIONS AS MAY BE NECESSARY.

LAYOUT NOTES

1. CONTRACTOR SHALL VERIFY ALL UTILITIES, GRADES, EXISTING CONDITIONS AND DIMENSIONS IN THE FIELD PRIOR TO COMMENCING WORK. ALL DISCREPANCIES OR QUESTIONS SHALL BE BROUGHT TO THE ATTENTION OF THE LANDSCAPE ARCHITECT FOR RESOLUTION.
2. ALL WRITTEN DIMENSIONS SUPERCEDE ALL SCALED DISTANCES AND DIMENSIONS. DIMENSIONS SHOWN ARE FROM THE FACE OF THE BUILDING, WALL, BACK OF CURB, EDGE OF WALK, PROPERTY LINE, OR CENTERLINE OF COLUMN UNLESS OTHERWISE NOTED ON THE DRAWINGS.
3. ALL DIMENSIONS AT BUILDING ARE TO FACE OF BUILDING. ALL DIMENSIONS AT ROADWAY ARE TO FACE OF CURB.
4. ALL ANGLES ARE 45 DEGREE, 90 DEGREE, OR 135 DEGREE UNLESS OTHERWISE NOTED.
5. ALL CURVES AND ALL TRANSITIONS BETWEEN CURVES AND STRAIGHT EDGES SHALL BE SMOOTH.
6. ALL RETURN RADI AND CURB DATA ARE TO FACE OF CURB.
7. WHENEVER BOTTOM OF WALL (BW) ELEVATION IS GIVEN, IT IS FINISH PAVEMENT OR GRADE ELEVATION AT FACE OF WALL.
8. SCORE LINES IN SIDEWALKS SHALL BE SPACED TO EQUAL THE WIDTH OF THE WALKWAY, UNLESS OTHERWISE SHOWN. EXPANSION JOINTS IN SIDEWALKS SHALL BE 20' ON CENTER MAXIMUM.
9. EXPANSION JOINTS IN CONCRETE WALLS SHALL BE AT 40' O.C. MAXIMUM.
10. BUILDING LAYOUT AND LOCATION, SIDEWALK, CURB AND GUTTER, GRADING AND DRAINAGE IS BASED ON DRAWINGS PREPARED BY THE ARCHITECT AND THE CIVIL ENGINEER.
11. STATIONING HEREON IS ALONG CONSTRUCTION CENTERLINE UNLESS OTHERWISE SHOWN OR INDICATED.
12. ANY EXTRA CONSTRUCTION STAKING NECESSITATED SOLELY BY THE CONTRACTOR'S NEGLIGENCE WILL BE CHARGED TO THE CONTRACTOR ON A TIME AND EXPENSES BASIS AND PAID FOR BY THE CONTRACTOR.
13. SEE IRRIGATION DRAWINGS FOR GENERAL SYSTEM REQUIREMENTS AND FOR LOCATION OF IRRIGATION MAINLINE PIPING. SLEEVES TO ACCOMMODATE IRRIGATION PIPING, SIZED AS NEEDED, SHALL BE IN PLACE UNDER AND THROUGH SLABS AND WALLS, PRIOR TO POURING.
14. PROVIDE CONTINUOUS HEADERS AT THE EDGES OF ALL AC PAVING, SHRUB AREAS, LAWN AREAS, DECOMPOSED GRANITE WHERE IT IS NOT CONSTRAINED BY A CONCRETE PAVING OR MOW BAND.
15. ALL CONCRETE PAVEMENTS SHALL BE DOWELED INTO CURBS, SIDEWALKS, AND BUILDING FOUNDATIONS.
16. REFER TO GEOTECHNICAL REPORT FOR ADDITIONAL INFORMATION, SECTIONS, REINFORCEMENT, AND PREPARATION. IN CASE OF DISCREPANCY THE GEOTECHNICAL REPORT SHALL GOVERN.
17. ALL TYPICAL DETAILS SHALL APPLY UNLESS NOTED OTHERWISE.
18. ANY AND ALL WORK WITHIN CITY RIGHT OF WAY SHALL CONFORM TO ALL CITY STANDARD DETAILS AND SPECIFICATIONS.
19. CONCRETE FOOTINGS INSTALLED FOR ALL SITE FURNISHINGS, SPORTS EQUIPMENT, ETC.. IN DECORATIVE PAVEMENT, ASPHALT PAVING, DECOMPOSED GRANITE, CONCRETE PAVING, AND PLANTERS SHALL BE HELD BELOW GRADE.
20. ALL EXISTING ITEMS TO REMAIN SHALL BE PROTECTED AS REQUIRED. ANY DAMAGED ITEMS SHALL BE FULLY REPAIRED OR REPLACED AT THE CONTRACTOR'S EXPENSE TO THE FULL SATISFACTION OF THE OWNER.
21. CONTRACTOR SHALL BE RESPONSIBLE FOR ANY COORDINATION WITH SUBCONTRACTORS AS REQUIRED TO ACCOMPLISH OPERATIONS.
22. ALL QUANTITIES AND PAY ITEMS ARE AND WILL BE BASED ON HORIZONTAL MEASUREMENTS.
23. ALL PATTERNS, LINE TYPES, AND SYMBOLS SHOWN WITHIN THE PLAN SET REFERENCE THE LAYOUT LEGEND AND ARE PART OF THE SCOPE OF WORK. CALLOUTS ARE SHOWN FOR CLARIFICATION OF WORK, BUT DO NOT INDICATE EVERY AND ALL INSTANCES OF SUCH WORK. THE CONTRACTOR SHALL REQUEST CLARIFICATION TO ANY ITEMS (INCLUDING BUT NOT LIMITED TO PAVING, WALLS, FINISHES, COLORS, FENCING, FOUNTAINS, POTS, AND SITE FURNITURE) NOT CLEARLY IDENTIFIED TO BE PART OF THE SCOPE OF WORK PRIOR TO BID.
24. THE CONTRACT DRAWINGS MUST BE ACCOMPANIED BY CONTRACT SPECIFICATIONS. THE CONTRACTOR MUST CONTACT THE LANDSCAPE ARCHITECT AT 925-736-8176 FOR SPECIFICATIONS IF NOT RECEIVED.
25. THE CONTRACTOR IS RESPONSIBLE FOR ALL WORK AND MATERIALS OF THE CONTRACT DOCUMENTS INCLUDING ALL WORK AND MATERIALS PROVIDED BY SUBCONTRACTORS. ALL QUALIFICATIONS OF THE CONTRACT DOCUMENTS INCLUDING ALL SPECIFIC EXCLUSIONS OF ANY WORK, DETAILS, MATERIALS, AND INCIDENTALS SHALL BE CONFIRMED AND ACCEPTED IN WRITING BY THE CONTRACTOR AND OWNER UPON FINALIZATION OF BIDS AND CONTRACT. THE LANDSCAPE ARCHITECT SHALL BE NOTIFIED OF ALL QUALIFICATIONS AND NOTIFICATIONS.

SHEET LIST TABLE

Sheet Number	Sheet Title
L0.1	COVER SHEET
L0.2	LAYOUT NOTES AND LEGENDS
L1.1	DEMOLITION PLAN
L1.2	LAYOUT PLAN
L2.1	CONSTRUCTION DETAILS
L2.2	CONSTRUCTION DETAILS

GATES
+ASSOCIATES
LANDSCAPE ARCHITECTURE
LAND PLANNING · URBAN DESIGN
2671 CROW CANYON RD. SAN RAMON, CA 94583
T 925.736.8176 www.dgates.com

LAUREL ELEMENTARY

LOWER CAMPUS
MENLO PARK
CALIFORNIA

LOCATION MAP

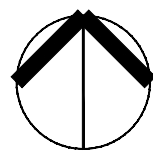
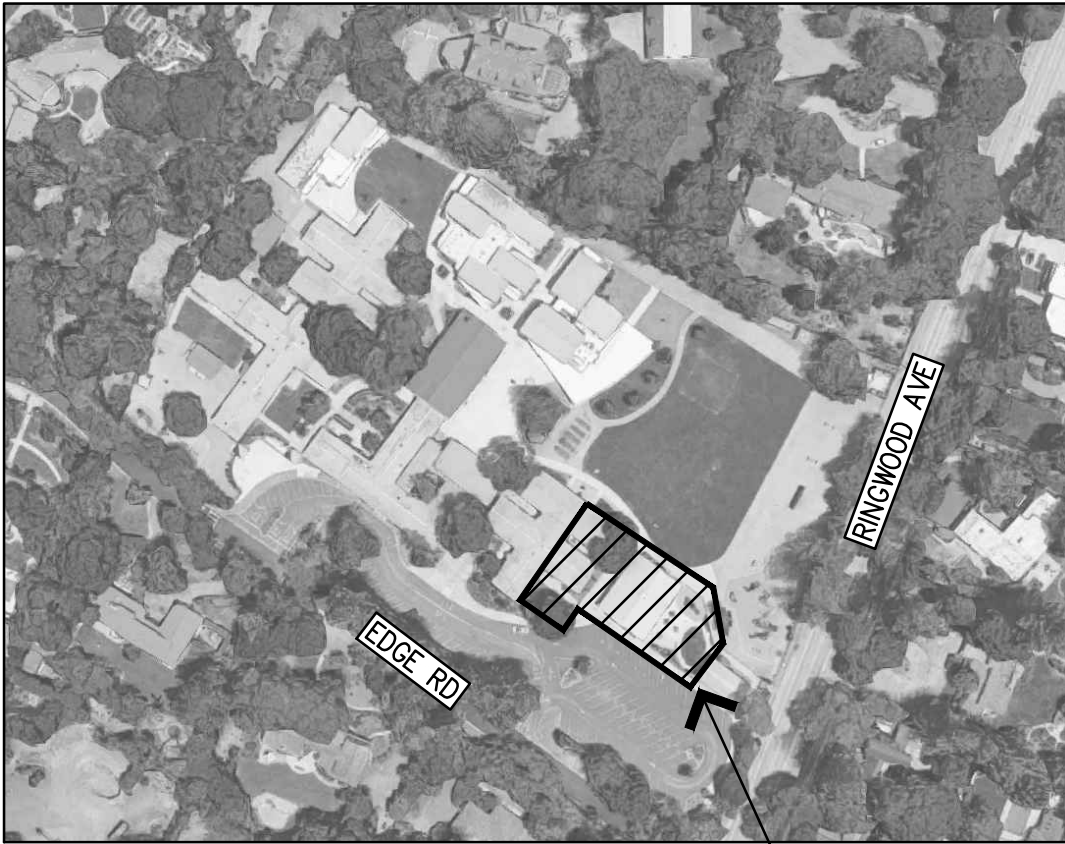

PROJECT SITE

ISSUE:	DESCRIPTION:	DATE:
1	BID SET	05/24/2019













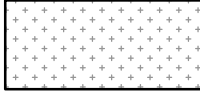

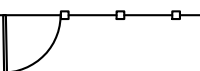
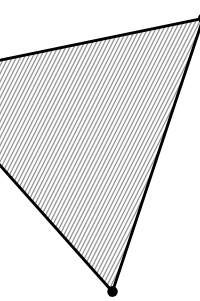
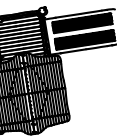
PROJECT NUMBER:	5610
DRAWN:	JK
CHECK:	MM
DATE:	05/24/2019
SCALE:	---



COVER SHEET

L0.1

LAYOUT LEGEND

	WOOD FIBER PLAY SURFACING INSTALL PER MFR SPECS	
	ARTIFICIAL TURF	1 L2.1
	FENCE WITH GATE, MATCH EXISTING	
	SAIL SHADE STRUCTURE MFR: USA SHADE MODEL: DSA PC MODEL, TRIANGLE DSA30125-16 SIZE: 25'X25'X25'	
	PLAY HOUSE	1 L2.2
	DRESS-UP WALL WITH MIRROR	2 L2.2
	PLAY AND LEARN BLACKBOARD	3 L2.2
	FOREST BUG SPINNER	4 L2.2
	EXPANSION JOINT LOCATE AS SHOWN. AT ALL JOINTS BETWEEN PAVING & WALLS, AND AT ALL CHANGES IN PAVING MATERIAL.	
	SCORELINE	
T	TREAD	
TBD	TO BE DETERMINED	
SP	SPACING	
	POINT OF BEGINNING	
F.O.B.	FACE OF BUILDING	
TYP.	TYPICAL	
EQ.	EQUAL	
CONT.	CONTINUOUS	
S.C.D.	SEE CIVIL'S DRAWINGS	
S.A.D.	SEE ARCHITECT'S DRAWINGS	
S.S.D.	SEE STRUCTURAL'S DRAWINGS	
SIM	SIMILAR	
R	RADIUS - ALL RADII GIVEN FOR WALLS ARE DIMENSIONED TO OUTSIDE OF WALLS.	
	ALIGN	
	CENTER LINE	
PL	PROPERTY LINE	
EQ	EQUAL	
	PLANTING AREA	
HDR	HEADER BOARD	

GENERAL NOTES

1. THE CONTRACTOR AGREES THAT, IN ACCORDANCE WITH GENERALLY ACCEPTED CONSTRUCTION PRACTICES, THE CONTRACTOR WILL BE REQUIRED TO ASSUME SOLE AND COMPLETE RESPONSIBILITY FOR JOB SITE CONDITIONS DURING THE COURSE OF CONSTRUCTION OF THE PROJECT, INCLUDING SAFETY OF ALL PERSONS AND PROPERTY. THIS REQUIREMENT SHALL BE MADE TO APPLY CONTINUOUSLY AND NOT BE LIMITED TO NORMAL WORKING HOURS. THE CONTRACTOR FURTHER AGREES TO DEFEND, INDEMNIFY AND HOLD OWNER AND ENGINEER HARMLESS FROM ANY AND ALL LIABILITY, REAL OR ALLEGED, IN CONNECTION WITH THE PERFORMANCE OF WORK ON THIS PROJECT, EXEMPTING LIABILITY ARISING FROM THE SOLE NEGLIGENCE OF ENGINEER.
2. EXCAVATIONS SHALL BE ADEQUATELY SHORED, BRACED AND SHEETED SO THAT THE EARTH WILL NOT SLIDE OR SETTLE AND SO THAT ALL EXISTING IMPROVEMENTS OF ANY KIND WILL BE FULLY PROTECTED FROM DAMAGE. ANY DAMAGE RESULTING FROM A LACK OF ADEQUATE SHORING, BRACING AND SHEETING, SHALL BE THE RESPONSIBILITY OF THE CONTRACTOR AND HE SHALL EFFECT NECESSARY REPAIRS OR RECONSTRUCTION AT HIS OWN EXPENSE. WHERE THE EXCAVATION FOR A CONDUIT TRENCH, AND/OR STRUCTURE IS FIVE FEET OR MORE IN DEPTH, THE CONTRACTOR SHALL PROVIDE ADEQUATE SHEETING, SHORING AND BRACING OR EQUIVALENT METHOD, FOR THE PROTECTION OF LIFE, OR LIMB, WHICH SHALL CONFORM TO THE APPLICABLE CONSTRUCTION SAFETY ORDERS OF THE DIVISION OF INDUSTRIAL SAFETY OF THE STATE OF CALIFORNIA, THE CONTRACTOR SHALL ALWAYS COMPLY WITH OSHA REQUIREMENTS.
3. ALL APPLICABLE REQUIREMENTS OF THE CALIFORNIA CONSTRUCTION AND GENERAL INDUSTRY SAFETY ERRORS, THE OCCUPATIONAL SAFETY AND HEALTH ACT AND THE CONSTRUCTION SAFETY ACT SHALL BE MET.
4. IT IS THE RESPONSIBILITY OF THE CONTRACTOR TO OBTAIN PERMITS NECESSARY TO PERFORM THE WORK SHOWN IN THESE PLANS FROM THE APPROPRIATE AGENCIES.
5. THE CONTRACTOR SHALL TAKE EFFECTIVE ACTION TO PREVENT THE FORMATION OF AN AIRBORNE DUST NUISANCE AND SHALL BE RESPONSIBLE FOR ANY DAMAGE RESULTING FROM THEIR FAILURE TO DO SO.
6. THE CONTRACTOR MUST PROVIDE FOR SAFE ACCESSIBLE INGRESS AND EGRESS FOR ADJACENT PROPERTY OWNERS AND EVA THROUGHOUT THE PERIOD OF CONSTRUCTION. TEMPORARY THROUGH ACCESS FOR THE GENERAL PUBLIC DUE TO CONSTRUCTION STAGING OR LIMITATIONS MUST BE FULLY REVIEWED AND APPROVED BY THE OWNER PRIOR TO IMPLEMENTATION. ALL ACCESS MUST BE SAFE, SECURED, FLAGGED, SIGNED, AND ACCESSIBLE PER THE APPROVED SITE ACCESS PLAN SUBMITTED BY THE CONTRACTOR AND REQUIRED BY THE OWNER.
7. DURING CONSTRUCTION, THE CONTRACTOR SHALL BE RESPONSIBLE FOR EMERGENCY VEHICLE ACCESS, PUBLIC SAFETY AND SAFETY OF EXISTING STRUCTURES. THE CONTRACTOR SHALL PROVIDE ALL LIGHTS, SIGNS, FENCING, BARRICADES, TRAFFIC CONTROLS, FLAGGERS, SHORINGS, BRACING AND GUYS OR OTHER DEVICES NECESSARY TO PROVIDE FOR SAFETY IN ACCORDANCE WITH ALL NATIONAL, STATE SPECS AND LOCAL SAFETY ORDINANCES.
8. THE CONTRACTOR SHALL POST EMERGENCY TELEPHONE NUMBERS FOR POLICE, FIRE, AMBULANCE, AND THOSE AGENCIES RESPONSIBLE FOR MAINTENANCE OF UTILITIES IN THE VICINITY OF JOB SITE.
9. ALL EXISTING UTILITIES AND IMPROVEMENTS ARE SHOWN IN THEIR APPROXIMATE LOCATIONS BASED UPON RECORD INFORMATION AVAILABLE TO THE ENGINEER AT THE TIME OF PREPARATION OF THESE PLANS. LOCATIONS MAY NOT HAVE BEEN VERIFIED IN THE FIELD AND NO GUARANTEE IS MADE AS TO THE ACCURACY OR COMPLETENESS OF THE INFORMATION SHOWN. THE CONTRACTOR SHALL NOTIFY UTILITY COMPANIES AT LEAST THREE (3) WORKING DAYS IN ADVANCE OF CONSTRUCTION TO FIELD LOCATE UTILITIES. CALL UNDERGROUND SERVICE ALERT (U.S.A.), AT 800-227-2600. IT SHALL BE THE RESPONSIBILITY OF THE CONTRACTOR TO DETERMINE THE EXISTENCE AND LOCATION OF THOSE UTILITIES SHOWN ON THESE PLANS OR INDICATED IN THE FIELD BY LOCATING SERVICES. ADDITIONAL COSTS INCURRED AS A RESULT OF CONTRACTOR'S FAILURE TO VERIFY LOCATIONS OF EXISTING UTILITIES PRIOR TO BEGINNING OF CONSTRUCTION IN THEIR VICINITY SHALL BE BORNE BY THE CONTRACTOR AND ASSUMED INCLUDED AND MERGED IN THE CONTRACT UNIT PRICE.
10. ALL EXISTING UTILITIES AND IMPROVEMENTS THAT BECOME DAMAGED DURING CONSTRUCTION MUST BE COMPLETELY RESTORED TO THE SATISFACTION OF THE DISTRICT PROJECT MANAGER OR UTILITY AGENCY REPRESENTATIVE, AT THE CONTRACTOR'S SOLE EXPENSE.
11. ANY RELOCATION OF PUBLIC UTILITIES SHALL BE CONDUCTED IN ACCORDANCE WITH ANY AND ALL REQUIREMENTS OF THE UTILITY COMPANY REPRESENTATIVE INCLUDING FEES, BONDS, PERMITS AND WORKING CONDITIONS, ETC. THIS WORK SHALL BE DONE AT NO EXPENSE TO THE UTILITY COMPANY. THE OWNER SHALL PAY THE COST OF ALL SUCH RELOCATION WORK INCLUDING FEES, BONDS, PERMITS, ETC.
12. THE CONSTRUCTION OF ALL GRAVITY UNDERGROUND LINES (STORM DRAINS) SHALL BEGIN AT THE MOST DOWNSTREAM END, UNLESS OTHERWISE SPECIFICALLY APPROVED BY ENGINEER OR BY THE OWNER.
13. THE USE OR INSTALLATION OF ANY MATERIAL OR EQUIPMENT WHICH IS MADE FROM, OR WHICH CONTAINS ASBESTOS FOR USE IN THE CONSTRUCTION OF THESE IMPROVEMENTS, IS NEITHER SPECIFIED NOR RECOMMENDED. ANY PARTY INSTALLING OR USING ANY PARTY SUCH MATERIALS OR EQUIPMENT SHALL BE SOLELY RESPONSIBLE FOR ALL INJURIES, DAMAGES, OR LIABILITIES OF ANY KIND, CAUSED BY THE USE OF SUCH MATERIALS OR EQUIPMENT.
14. THE CONTRACTOR MUST MEET AND IMPLEMENT ALL NPDES, SWPPP, AND EROSION CONTROL REQUIREMENTS IN EFFECT AT THE TIME OF CONSTRUCTION.
15. SHOULD IT APPEAR THAT THE WORK TO BE DONE OR ANY MATTER RELATIVE THERETO IS NOT SUFFICIENTLY DETAILED OR EXPLAINED ON THESE PLANS, THE CONTRACTOR SHALL CONTACT GATES & ASSOCIATES AT (925) 736-8176 FOR SUCH FURTHER EXPLANATIONS AS MAY BE NECESSARY.

LAYOUT NOTES

1. CONTRACTOR SHALL VERIFY ALL UTILITIES, GRADES, EXISTING CONDITIONS AND DIMENSIONS IN THE FIELD PRIOR TO COMMENCING WORK. ALL DISCREPANCIES OR QUESTIONS SHALL BE BROUGHT TO THE ATTENTION OF THE DISTRICT PROJECT MANAGER FOR RESOLUTION.
2. ALL WRITTEN DIMENSIONS SUPERCEDE ALL SCALED DISTANCES AND DIMENSIONS. DIMENSIONS SHOWN ARE FROM THE FACE OF THE BUILDING, WALL, BACK OF CURB, EDGE OF WALK, PROPERTY LINE, OR CENTERLINE OF COLUMN UNLESS OTHERWISE NOTED ON THE DRAWINGS.
3. ALL DIMENSIONS AT BUILDING ARE TO FACE OF BUILDING. ALL DIMENSIONS AT ROADWAY ARE TO FACE OF CURB.
4. ALL ANGLES ARE 45 DEGREE, 90 DEGREE, OR 135 DEGREE UNLESS OTHERWISE NOTED.
5. ALL CURVES AND ALL TRANSITIONS BETWEEN CURVES AND STRAIGHT EDGES SHALL BE SMOOTH.
6. ALL RETURN RADII AND CURB DATA ARE TO FACE OF CURB.
7. WHENEVER BOTTOM OF WALL (BW) ELEVATION IS GIVEN, IT IS FINISH PAVEMENT OR GRADE ELEVATION AT FACE OF WALL.
8. SCORE LINES IN SIDEWALKS SHALL BE SPACED TO EQUAL THE WIDTH OF THE WALKWAY, UNLESS OTHERWISE SHOWN. EXPANSION JOINTS IN SIDEWALKS SHALL BE 20' ON CENTER MAXIMUM.
9. EXPANSION JOINTS IN CONCRETE WALLS SHALL BE AT 40' O.C. MAXIMUM.
10. BUILDING LAYOUT AND LOCATION, SIDEWALK, CURB AND GUTTER, GRADING AND DRAINAGE IS BASED ON DRAWINGS PREPARED BY THE ARCHITECT AND THE CIVIL ENGINEER.
11. STATIONING HEREON IS ALONG CONSTRUCTION CENTERLINE UNLESS OTHERWISE SHOWN OR INDICATED.
12. ANY EXTRA CONSTRUCTION STAKING NECESSITATED SOLELY BY THE CONTRACTOR'S NEGLIGENCE WILL BE CHARGED TO THE CONTRACTOR ON A TIME AND EXPENSES BASIS AND PAID FOR BY THE CONTRACTOR.
13. SEE IRRIGATION DRAWINGS FOR GENERAL SYSTEM REQUIREMENTS AND FOR LOCATION OF IRRIGATION MAINLINE PIPING. SLEEVES TO ACCOMMODATE IRRIGATION PIPING, SIZED AS NEEDED, SHALL BE IN PLACE UNDER AND THROUGH SLABS AND WALLS, PRIOR TO POURING.
14. PROVIDE CONTINUOUS HEADERS AT THE EDGES OF ALL AC PAVING, SHRUB AREAS, LAWN AREAS, DECOMPOSED GRANITE WHERE IT IS NOT CONSTRAINED BY A CONCRETE PAVING OR MOW BAND.
15. ALL CONCRETE PAVEMENTS SHALL BE DOWELED INTO CURBS, SIDEWALKS, AND BUILDING FOUNDATIONS.
16. REFER TO GEOTECHNICAL REPORT FOR ADDITIONAL INFORMATION, SECTIONS, REINFORCEMENT, AND PREPARATION. IN CASE OF DISCREPANCY THE GEOTECHNICAL REPORT SHALL GOVERN.
17. ALL TYPICAL DETAILS SHALL APPLY UNLESS NOTED OTHERWISE.
18. ANY AND ALL WORK WITHIN DISTRICT RIGHT OF WAY SHALL CONFORM TO ALL DISTRICT STANDARD DETAILS AND SPECIFICATIONS.
19. CONCRETE FOOTINGS INSTALLED FOR ALL SITE FURNISHINGS, SPORTS EQUIPMENT, ETC.. IN DECORATIVE PAVEMENT, ASPHALT PAVING, DECOMPOSED GRANITE, CONCRETE PAVING, AND PLANTERS SHALL BE HELD BELOW GRADE.
20. ALL EXISTING ITEMS TO REMAIN SHALL BE PROTECTED AS REQUIRED. ANY DAMAGED ITEMS SHALL BE FULLY REPAIRED OR REPLACED AT THE CONTRACTOR'S EXPENSE TO THE FULL SATISFACTION OF THE OWNER.
21. CONTRACTOR SHALL BE RESPONSIBLE FOR ANY COORDINATION WITH SUBCONTRACTORS AS REQUIRED TO ACCOMPLISH OPERATIONS.
22. ALL QUANTITIES AND PAY ITEMS ARE AND WILL BE BASED ON HORIZONTAL MEASUREMENTS.
23. ALL PATTERNS, LINE TYPES, AND SYMBOLS SHOWN WITHIN THE PLAN SET REFERENCE THE LAYOUT LEGEND AND ARE PART OF THE SCOPE OF WORK. CALLOUTS ARE SHOWN FOR CLARIFICATION OF WORK, BUT DO NOT INDICATE EVERY AND ALL INSTANCES OF SUCH WORK. THE CONTRACTOR SHALL REQUEST CLARIFICATION TO ANY ITEMS (INCLUDING BUT NOT LIMITED TO PAVING, WALLS, FINISHES, COLORS, FENCING, FOUNTAINS, POTS, AND SITE FURNITURE) NOT CLEARLY IDENTIFIED TO BE PART OF THE SCOPE OF WORK PRIOR TO BID.
24. THE CONTRACT DRAWINGS MUST BE ACCOMPANIED BY CONTRACT SPECIFICATIONS. THE CONTRACTOR MUST CONTACT THE DISTRICT PROJECT MANAGER AT 925-736-8176 FOR SPECIFICATIONS IF NOT RECEIVED.
25. SUBMITTALS AND SITE MOCKUPS OF ALL WORK SHALL BE REQUIRED PRIOR TO FINAL PLACEMENT INCLUDING BUT NOT LIMITED TO ALL WALLS, PAVEMENTS, COLORS, FINISHES, METAL WORK, FENCING, AND PAINTING FOR REVIEW AND APPROVAL BY THE DISTRICT PROJECT MANAGER. SEE SPECIFICATIONS.

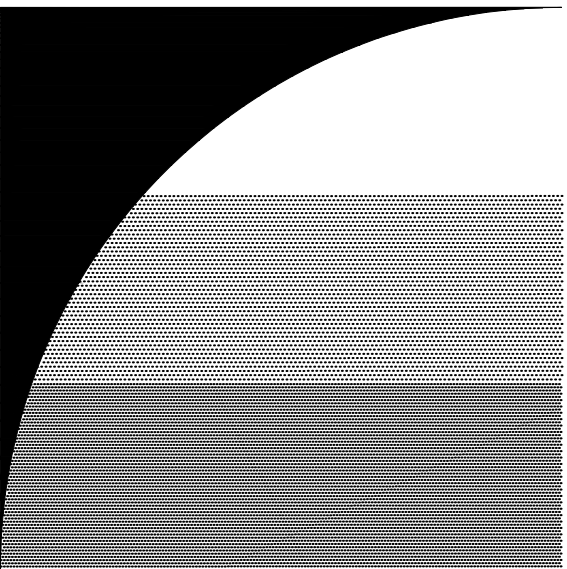

GATES
+ASSOCIATES
LANDSCAPE ARCHITECTURE
LAND PLANNING · URBAN DESIGN
2671 CROW CANYON RD. SAN RAMON, CA 94583
T 925.736.8176 www.dgates.com

LAUREL
ELEMENTARY

LOWER CAMPUS
MENLO PARK
CALIFORNIA

ISSUE:	DESCRIPTION:	DATE:
1	BID SET	05/24/2019



PROJECT NUMBER:	5610
DRAWN:	JK
CHECK:	MM
DATE:	05/24/2019
SCALE:	

LAYOUT NOTES AND
LEGENDS

L0.2

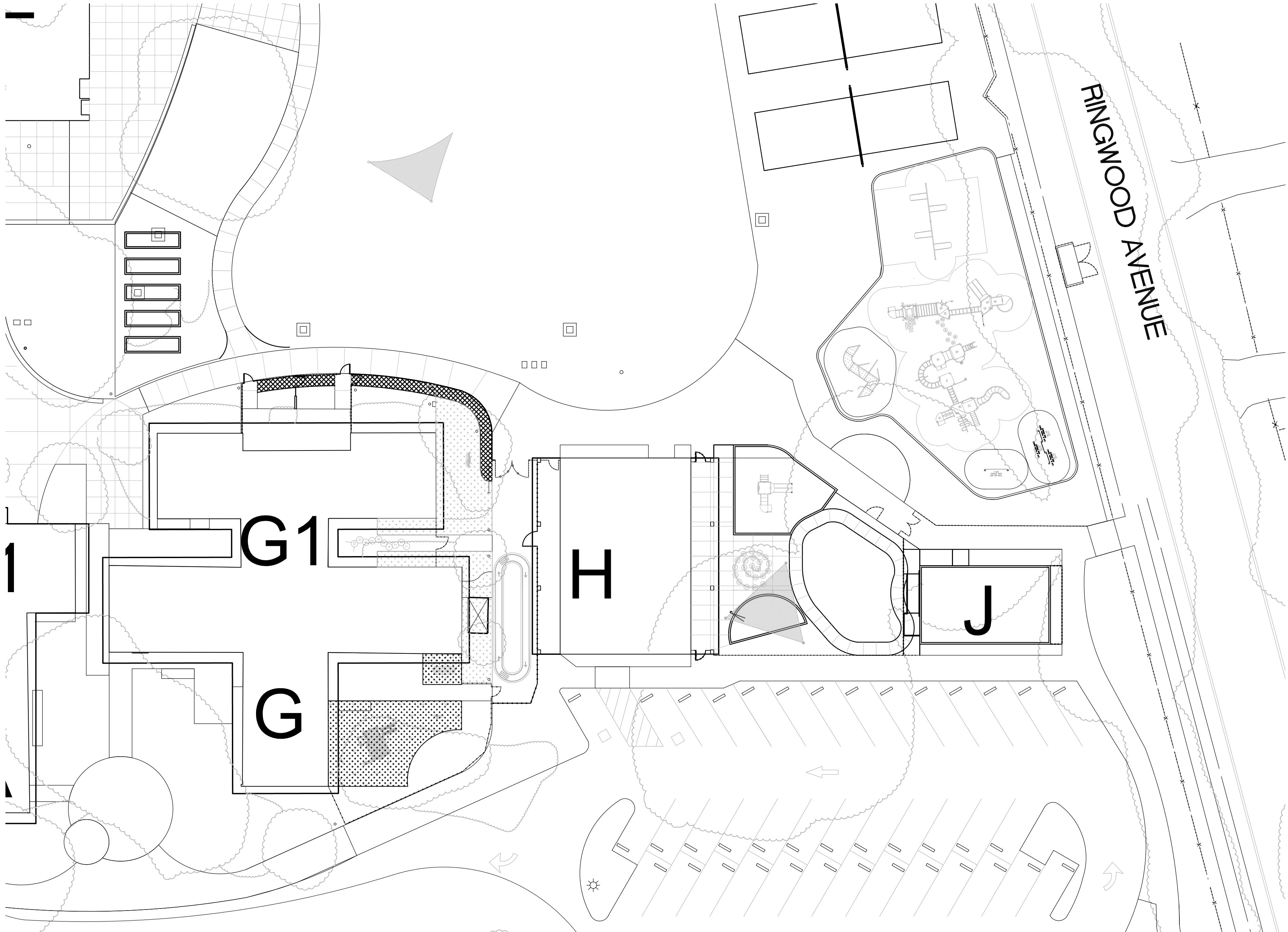

DEMOLITION LEGEND

 CLEAR AND GRUB EXISTING LANDSCAPE AREA SO NO ORGANICS ARE STILL PRESENT

DEMOLITION NOTES

- CONTRACTOR TO DEMOLISH AND REMOVE ALL IRRIGATION IN LANDSCAPE AREAS WITHIN THE LIMIT OF WORK. IF ANY IRRIGATION LINES OR MAINS ARE IN THE LIMIT OF WORK OR ARE DAMAGED THAT SERVE LANDSCAPE TO REMAIN, CONTRACTOR TO RECONNECT OR RELOCATE AT NO ADDITIONAL COST TO OWNER
- ALL UNDERGROUND UTILITIES LANDSCAPE FEATURES, AND HARDSCAPE FEATURES NOT SHOWN TO BE REMOVED THAT ARE IMPACTED OR DAMAGED BY THE CONTRACTOR OR THEIR SUB-CONTRACTOR SHALL BE REMOVED AND REPLACED IN KIND. ITEMS MAY INCLUDE, BUT NOT LIMITED TO, UNDERGROUND UTILITY AND IRRIGATION LINES, CURB, SIDEWALK, PAVEMENT, FENCING, PAVEMENT MARKINGS, PLANTING AND LANDSCAPING.
- PROTECT ALL EXISTING UTILITIES IN PLACE UNLESS OTHERWISE NOTES, REPLACE ANY DAMAGED UTILITY TO REMAIN TO KEEP OPERABLE DURING CONSTRUCTION.
- THIS DEMOLITION PLAN IS NOT A COMPLETE INVENTORY OF UTILITIES OR STRUCTURES. CONTRACTOR SHALL CONTACT ENGINEER IF ANY UNKNOWN OR UNEXPECTED UTILITIES OR OTHER STRUCTURES ARE FOUND. THE CONTRACTOR IS RESPONSIBLE FOR ALL DEMOLITION NECESSARY TO PREPARE SITE FOR DEVELOPMENT.
- ALL UTILITY DEMOLITION TO BE DISCONNECTED AND CAPPED WHERE SHOWN ON THE PLAN PER UTILITY OWNERS SPECIFICATIONS AND STANDARDS.
- CONTRACTOR IS TO COMPLY WITH ALL GENERAL AND STATE REQUIREMENTS INVOLVING THE REMOVAL AND DISPOSAL OF HAZARDOUS MATERIALS.
- CONTRACTOR'S BID IS TO INCLUDE ALL VISIBLE SURFACE AND ALL SUBSURFACE FEATURES IDENTIFIED TO BE REMOVED OR ABANDONED IN THESE DOCUMENTS.
- THE CONTRACTOR SHALL BE RESPONSIBLE FOR A SITE INSPECTIONS TO FULLY ACKNOWLEDGE THE EXTEND OF THE DEMOLITION WORK.
- BACKFILL ALL DEPRESSIONS AND TRENCHES FROM DEMOLITION.
- REMOVAL OF LANDSCAPING SHALL INCLUDE ROOTS AND ORGANIC MATERIALS
- THE CONTRACTOR SHALL MAINTAIN ALL SAFETY DEVICES, AND SHALL BE RESPONSIBLE FOR CONFORMANCE TO ALL LOCAL, STATE AND FEDERAL SAFETY AND HEALTH STANDARDS LAWS AND REGULATIONS.
- THIS PLAN IS NOT INTENDED TO BE A COMPLETE CATALOGUE OF ALL EXISTING STRUCTURES AND UTILITIES. THIS PLAN INTENDS TO DISCLOSE GENERAL INFORMATION KNOWN BY THE LANDSCAPE ARCHITECT AND TO SHOW THE LIMITS OF THE AREA WHERE WORK WILL BE PERFORMED, THIS PLAN SHOWS EXISTING FEATURES TAKEN FROM AS BUILD PLANS. THIS PLAN MAY OR MAY NOT ACCURATELY REFLECT THE TYPE OR EXTENT OF THE ITEMS TO BE ENCOUNTERED AS THEY ACTUALLY EXIST. WHERE EXISTING FEATURE ARE NOT SHOWN, IT IS NOT IMPLIED THAT THEY ARE NOT TO BE DEMOLISHED OR RELOCATED. THE CONTRACTOR SHALL PERFORM A THROUGH FILED INVESTIGATION AND REVIEW OF THE SITE WITHIN THE LIMIT OF WORK SHOWN IN THIS PLAN SET TO DETERMINATE THE TYPE, QUANTITY AND EXTENT OD ANY AND ALL ITEMS. THE CONTRACTOR SHALL BE SOLELY RESPONSIBLE FOR DETERMINING THE EXTENT OF EXISTING STRUCTURES AND UTILITIES AND QUANTITY OF WORK INVOLVED IN REMOVING THESE ITEMS FROM THE SITE
- ALL UTILITY SHUT DOWNS ARE TO BE AVOIDED. IF ANY DOWNS ARE NECESSARY CONTRACTOR TO COORDINATE DOWN WITH UTILITY OWNER WITH 48 HOUR MINIMUM NOTICE.
- ALL EXISTING STORM DRAIN, SANITARY SEWER AND WATER MAINS THAT SERVE EXISTING BUILDINGS MUST REMAIN OPERABLE DURING CONSTRUCTION, CONTRACTOR TO SET UP TEMPORARY SERVICE OR PUMPS AS NECESSARY TO ENSURE UNINTERRUPTED SERVICE.

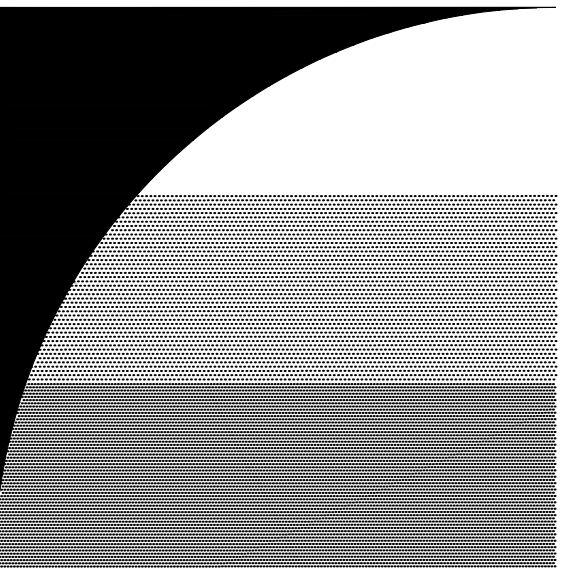

GATES
+ASSOCIATES
LANDSCAPE ARCHITECTURE
LAND PLANNING · URBAN DESIGN
2671 CROW CANYON RD. SAN RAMON, CA 94583
T 925.736.8176 www.dgates.com

LAUREL ELEMENTARY

LOWER CAMPUS
MENLO PARK
CALIFORNIA

ISSUE: 1 DESCRIPTION: BID SET DATE: 05/24/2019



PROJECT NUMBER: 5610
DRAWN: JK
CHECK: MM
DATE: 05/24/2019
SCALE: SCALE

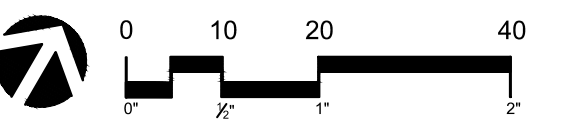

DEMOLITION PLAN

L1.1

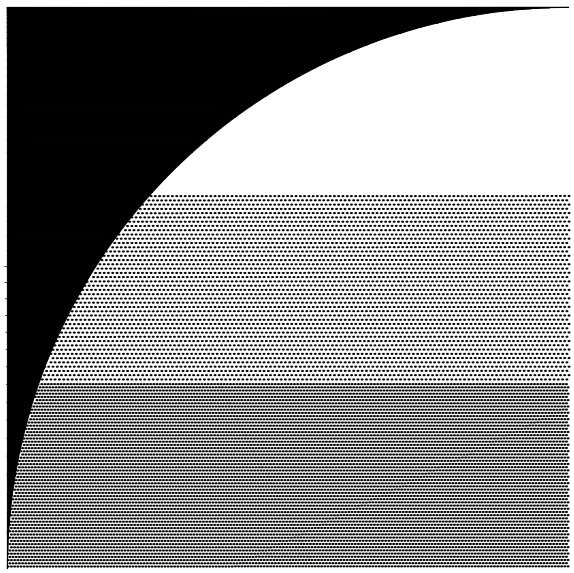
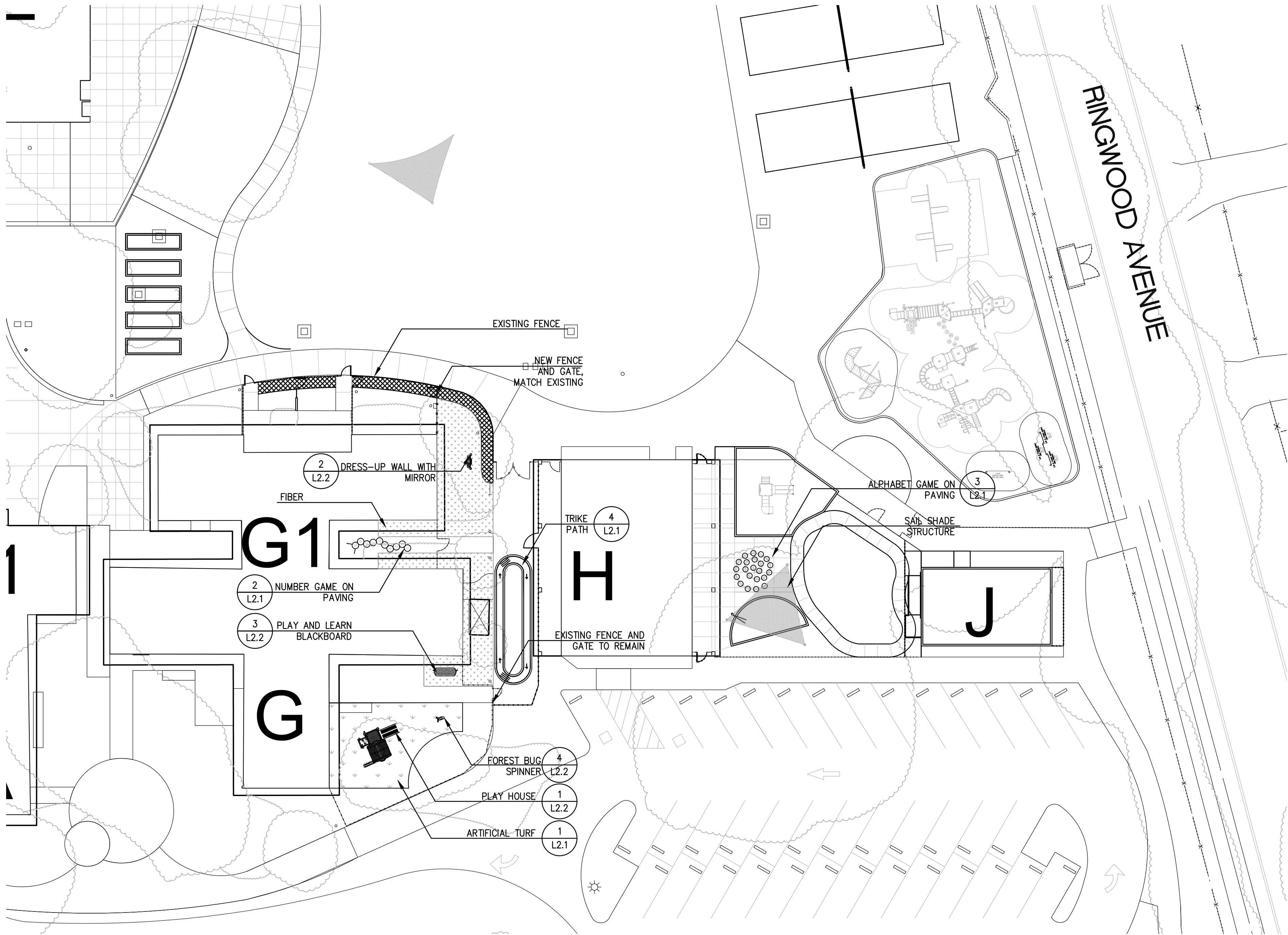

GATES
+ASSOCIATES
LANDSCAPE ARCHITECTURE
LAND PLANNING · URBAN DESIGN
2671 CROW CANYON RD. SAN RAMON, CA 94583
T 925.736.8176 www.dgates.com

LAUREL ELEMENTARY

LOWER CAMPUS
MENLO PARK
CALIFORNIA

ISSUE:	DESCRIPTION:	DATE:
1	BID SET	05/24/2019



PROJECT NUMBER: 5610
DRAWN: JK
CHECK: MM
DATE: 05/24/2019
SCALE:

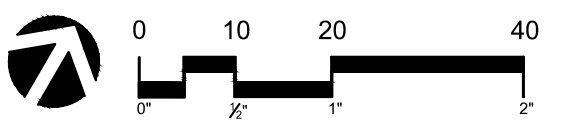

LAYOUT PLAN

L1.2

PATH: P:\MENLO PARK\MENLO PARK CITY SCHOOL DISTRICT EARLY LEARNING CENTERS\ROAD\LAUREL ELEMENTARY\SHEETS\LOG-9-LAUREL ELEMENTARY.DWG
PLOT DATE: 5/29/2019 1:28 PM

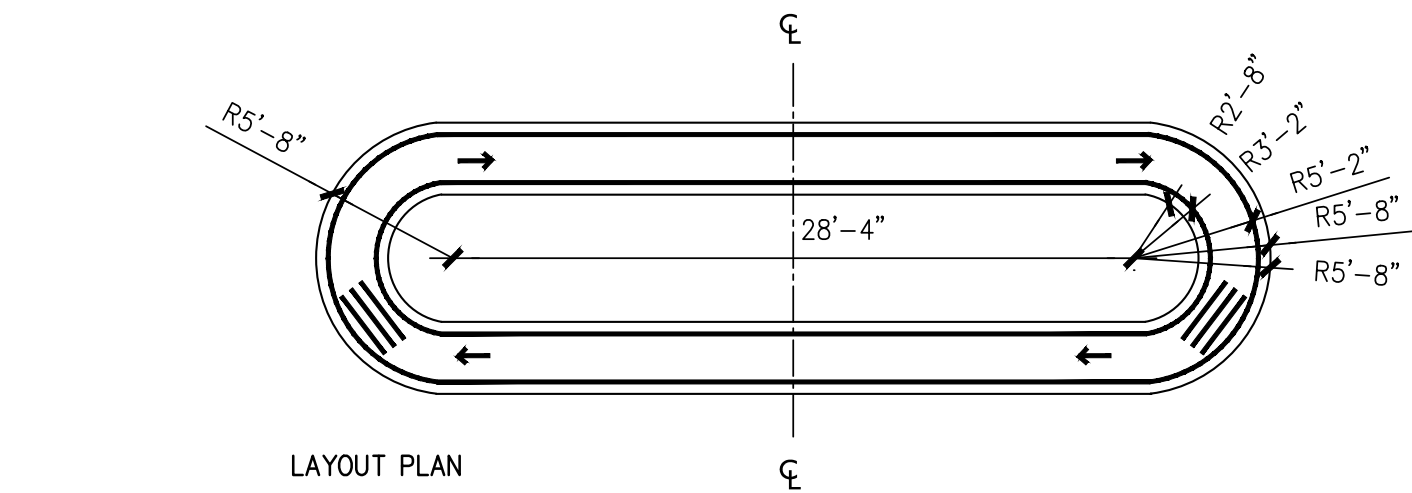

- NOTE:
1. ALL COURT MARKINGS TO BE 2" WIDE.
 2. ALL MEASUREMENTS OF COURT MARKINGS ARE TO CENTER LINES.
 3. DETAIL SHOWN FOR DESIGN INTENT ONLY.
 4. CONTRACTOR SHALL LAYOUT AND RECEIVE FINAL APPROVAL FROM ARCHITECT PRIOR TO FINAL PLACEMENT.
 5. PROVIDE SKID TEX NON-SKID ADDITIVE TO ALL PAINTED SURFACES, TYP. PROVIDE MOCKUP OF PAINTED SURFACE PRIOR TO INSTALLATION

4 TRUCK

SCALE: 1/8" = 1'-0"

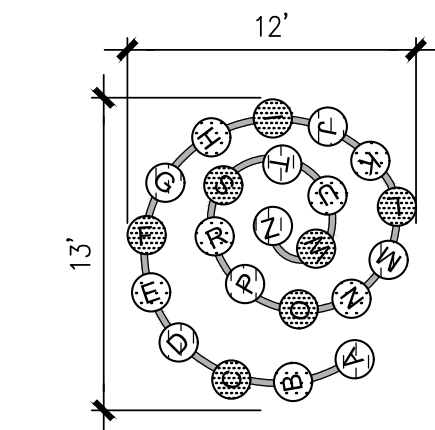

- COLOR LEGEND:
- BLUE
 - RED
 - BEIGE
 - GREEN

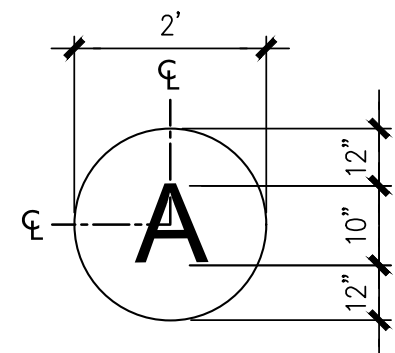

ENLARGEMENT N.T.S.

- NOTE:
1. ALL COURT MARKINGS TO BE 2" WIDE.
 2. ALL MEASUREMENTS OF COURT MARKINGS ARE TO CENTER LINES.
 3. DETAIL SHOWN FOR DESIGN INTENT ONLY.
 4. CONTRACTOR SHALL LAYOUT AND RECEIVE FINAL APPROVAL FROM ARCHITECT PRIOR TO FINAL PLACEMENT.
 5. PROVIDE SKID TEX NON-SKID ADDITIVE TO ALL PAINTED SURFACES, TYP. PROVIDE MOCKUP OF PAINTED SURFACE PRIOR TO INSTALLATION

3 ALPHABET GAME

SCALE: 1/8" = 1'-0"

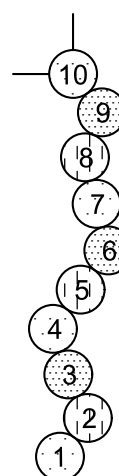

- COLOR LEGEND:
- BLUE
 - RED
 - BEIGE

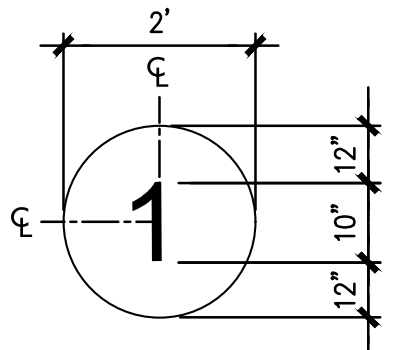

ENLARGEMENT N.T.S.

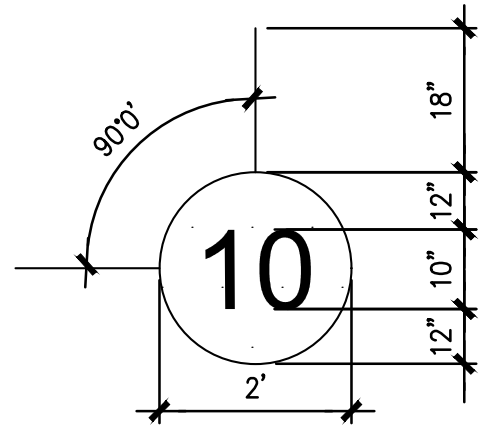

ENLARGEMENT N.T.S.

- NOTE:
1. ALL COURT MARKINGS TO BE 2" WIDE.
 2. ALL MEASUREMENTS OF COURT MARKINGS ARE TO CENTER LINES.
 3. DETAIL SHOWN FOR DESIGN INTENT ONLY.
 4. CONTRACTOR SHALL LAYOUT AND RECEIVE FINAL APPROVAL FROM ARCHITECT PRIOR TO FINAL PLACEMENT.
 5. PROVIDE SKID TEX NON-SKID ADDITIVE TO ALL PAINTED SURFACES, TYP. PROVIDE MOCKUP OF PAINTED SURFACE PRIOR TO INSTALLATION

2 NUMBER GAME

SCALE: 1/8" = 1'-0"

- NOTES:
1. FINISH GRADES OF SYNTHETIC TURF SHALL BE THE TOP OF INFILL MATERIAL. INFILL MATERIAL SHALL BE A MINIMUM OF 1/4" BELOW AND 1/2" MAXIMUM ADJACENT SURFACES.
 2. SYNTHETIC TURF AND IN FILL:
MFR: SYNLAWN OR APPROVED EQUAL
MODEL: SYNLAWN PLAY PREMIUM 3. INSTALL PER MFR SPECS AND DETAILS

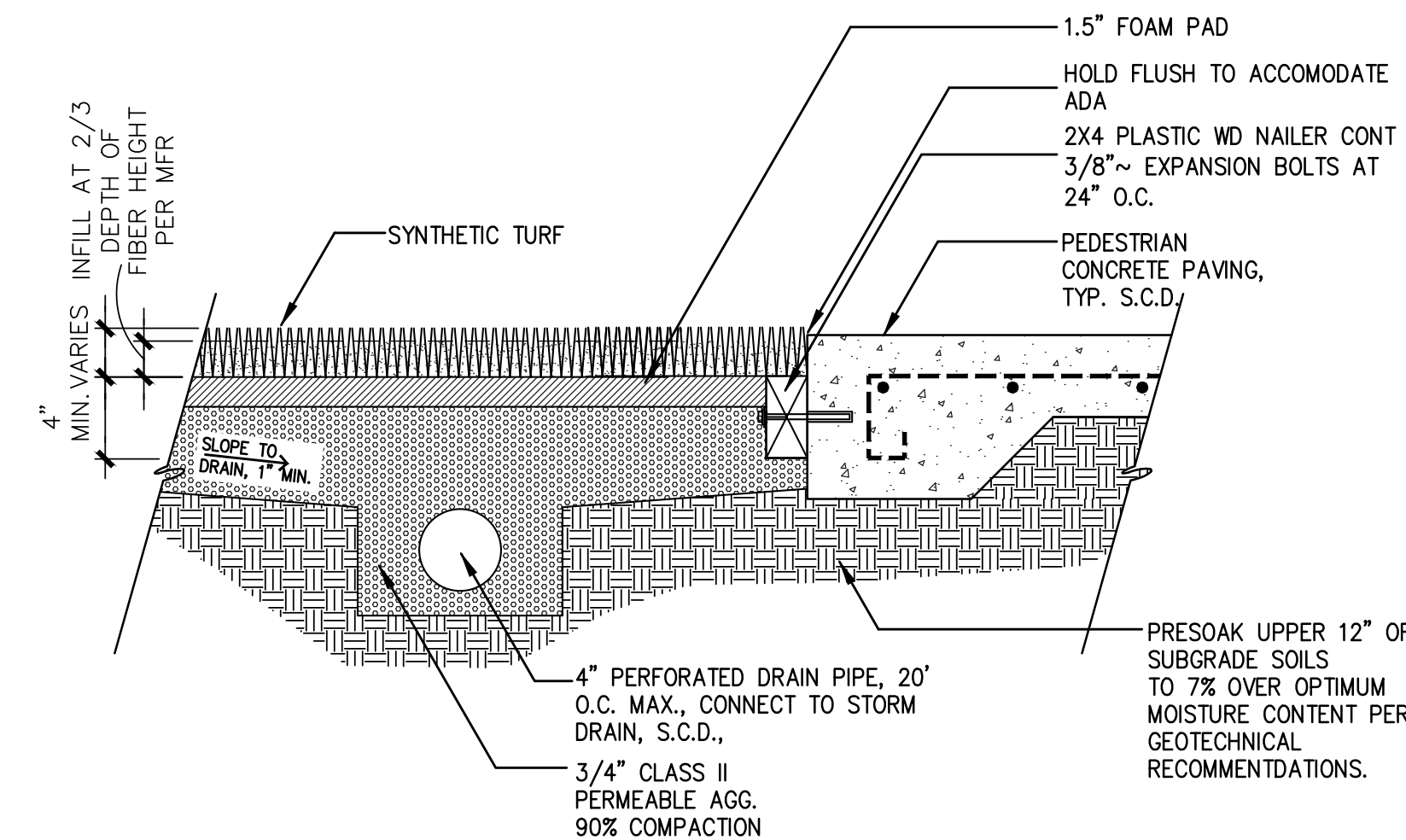

1 SYNTHETIC TURF

SCALE: 1-1/2" = 1'-0"

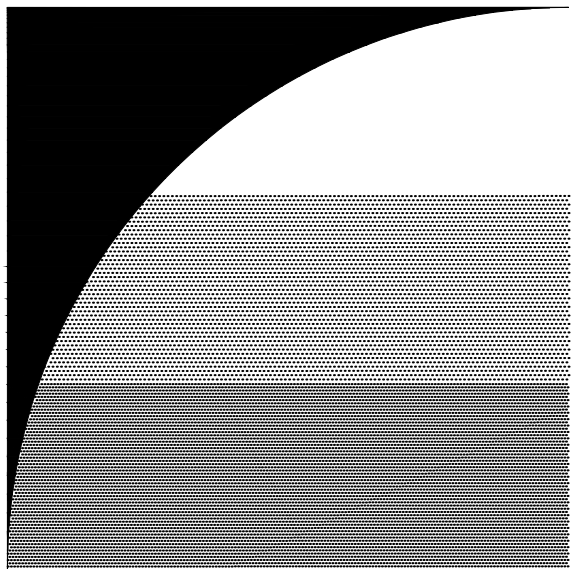

GATES
+ASSOCIATES

LANDSCAPE ARCHITECTURE
LAND PLANNING · URBAN DESIGN

2671 CROW CANYON RD. SAN RAMON, CA 94583
T 925.736.8176 www.dgates.com

LAUREL
ELEMENTARY

LOWER CAMPUS
MENLO PARK
CALIFORNIA

ISSUE:	DESCRIPTION:	DATE:
1	BID SET	05/24/2019



PROJECT NUMBER:	5610
DRAWN:	JK
CHECK:	MM
DATE:	05/24/2019
SCALE:	PER DETAIL



CONSTRUCTION
DETAILS

L2.1

