

# LAUREL SCHOOL UPPER CAMPUS

MENLO PARK CITY SCHOOL DISTRICT



## BOARD OF TRUSTEES

MARIA HILTON

JEFF CHILD

STACEY JONES

JOAN LAMBERT

TERRY THYGESEN

MAURICE GHYSLS

SUPERINTENDENT

AHMAD SHEIKHOESLAMI

CHIEF BUSINESS AND  
OPERATIONS OFFICER



**MEASURE "W"  
BOND DOLLARS  
AT WORK.  
THANK YOU  
FOR YOUR  
SUPPORT !**

**OPENS SEPTEMBER 2016**

FOR FURTHER  
INFORMATION CALL

**650-321-7140**  
[WWW.MPCSD.ORG](http://WWW.MPCSD.ORG)



QUALITY CONSTRUCTION SINCE 1959  
INSTITUTIONAL • COMMERCIAL • INDUSTRIAL  
[WWW.ROEBBELEN.COM](http://WWW.ROEBBELEN.COM) | 916.939.4000 | CA #734124  
ISO 9001:2008 | ISO 14001:2004 | OHSAS 18001:2007 | DVB# #1012610



[WWW.RGMASOCIATES.COM](http://WWW.RGMASOCIATES.COM)  
925.671.7717 / CA # 94518

**Menlo Park City School District**  
**Laurel School Upper Campus**  
**Community Update Meeting**

**May 2015**

# Meeting Agenda

---

- Introduction to the Construction Team:
  - Menlo Park City School District
  - Construction Manager: RGM & Associates
  - General Contractor: Roebbelen
- Contact information & Communication
- Review Project information
- Discuss Construction Schedule and Work
- Site Access and Fencing Project
- Question and Answer

# Menlo Park City School District

---

- Ahmad Sheikholeslami
  - Chief Business and Operations Officer
  - [ahmad@mpcsd.org](mailto:ahmad@mpcsd.org)
  - 650-321-7140 (office)
  - 650-303-6230 (emergency only)
- Kim Go
  - Administrative Assistant to CBOO
  - [kgo@mpcsd.org](mailto:kgo@mpcsd.org)
  - 650-321-7140 ext. 5611
- Website Updates
  - [district.mpcsd.org](http://district.mpcsd.org)

# Construction Management: RGM and Associate

---

- Ralph Caputo
  - Program Director
  - Email: [ralph@rgmassociates.com](mailto:ralph@rgmassociates.com)
  - Phone: 925-671-7717
- Eric Scheuermann
  - Sr. Project Manager (on site)
  - Neighbors main site contact point
  - Email: [eric@rgmassociates.com](mailto:eric@rgmassociates.com)
  - Phone: 510-908-3303

# Contractor: Roebbelen Contracting Inc.

---

- Adam Villacara
  - Vice President
- Bill Sheets
  - Senior Project Manager
- Craig Bonnell
  - Project Superintendent
- Project Engineer
  - To be determined
- Contact information
  - Upon the set up of the site office contact information will be made available





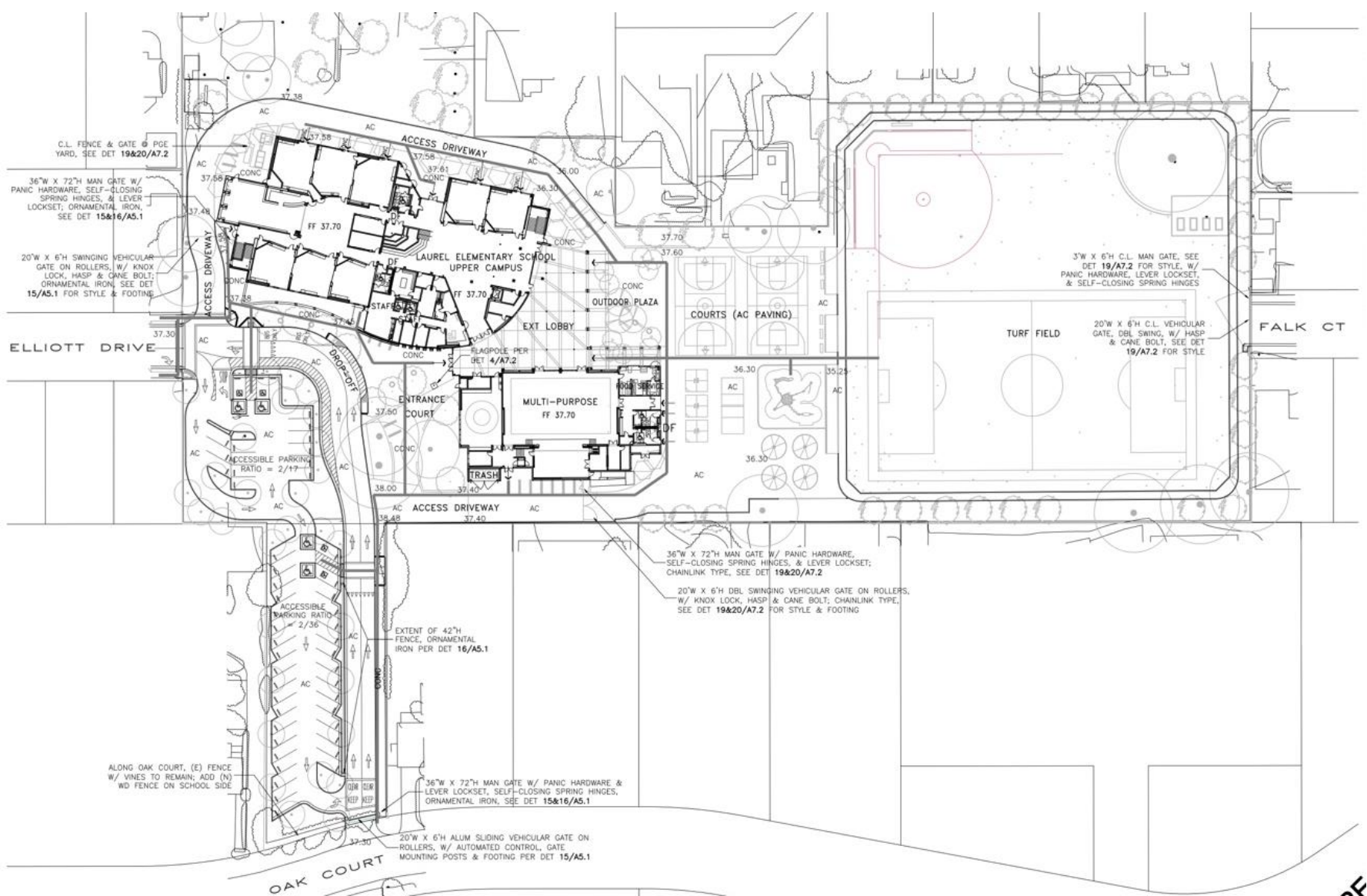

# Site Plan

## Laurel School Upper Campus

March 2015



Laurel School Upper Campus 2/15





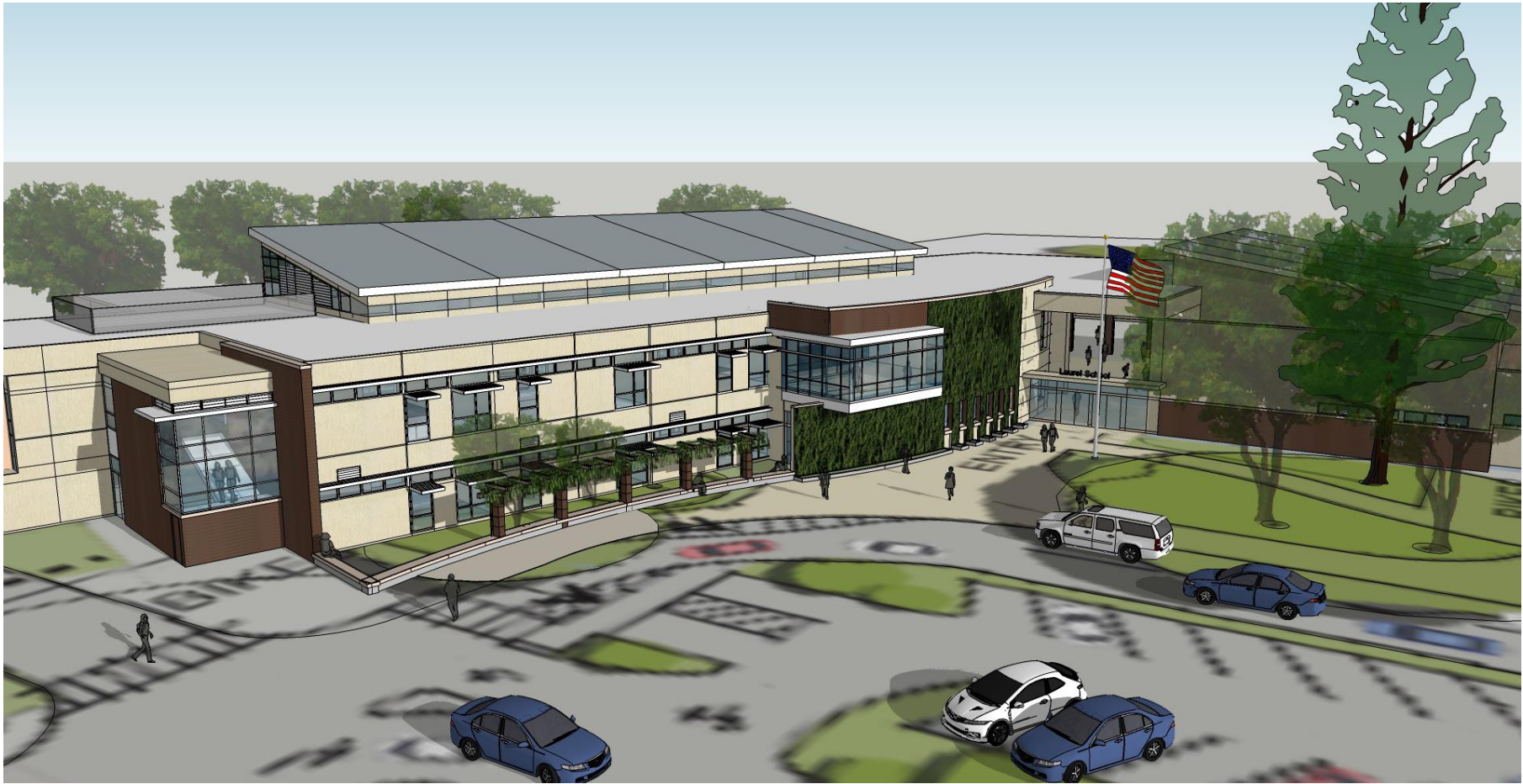

## Laurel School Upper Campus 2/15





## Second Floor Plan

### New 3-5 Grade School (O'Connor Site)





# First Floor Plan Laurel School Upper Campus 11/14

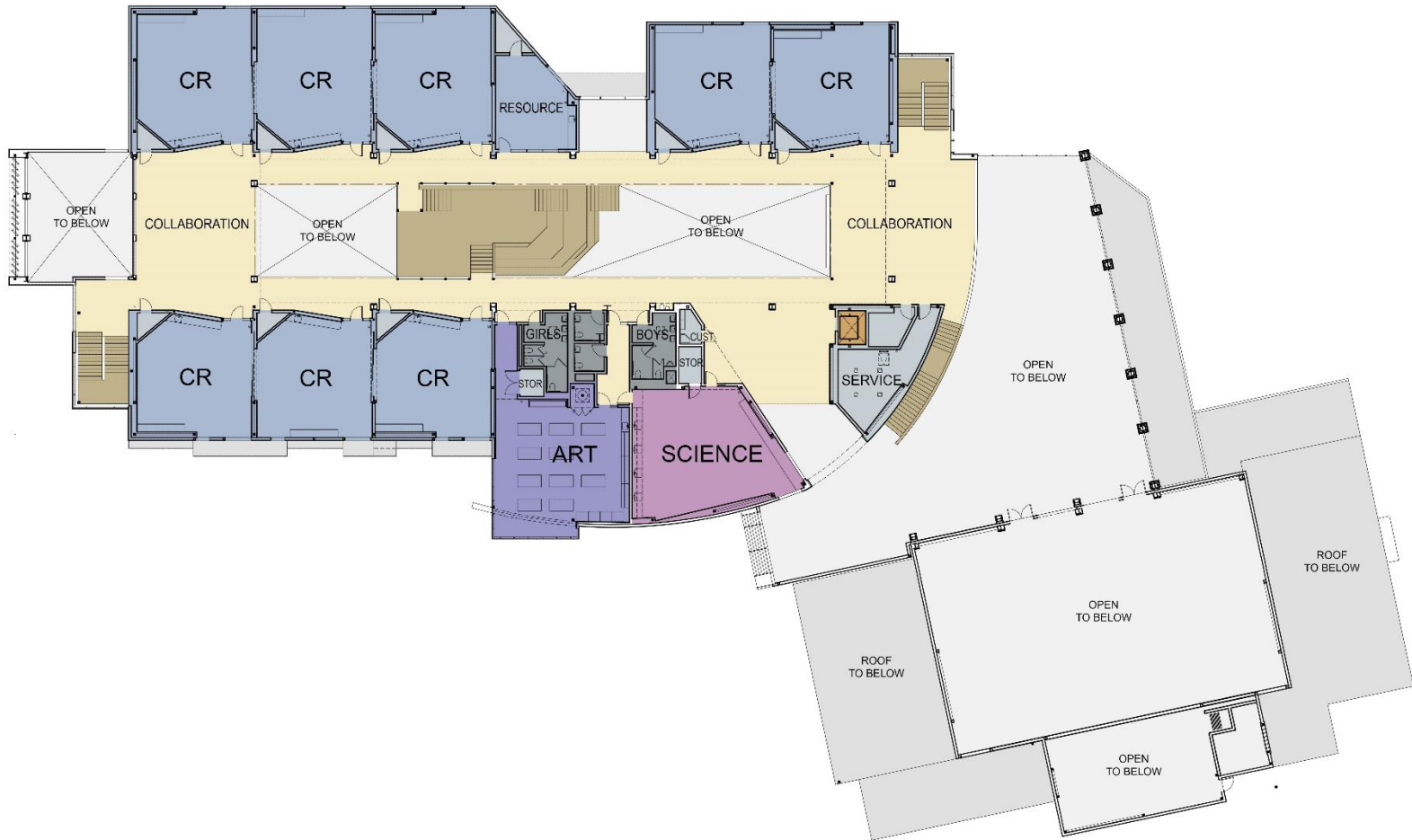

## Second Floor Plan

Laurel School Upper Campus 11/14



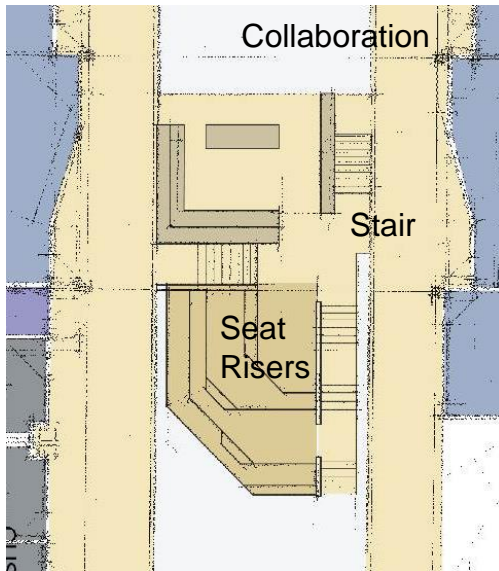
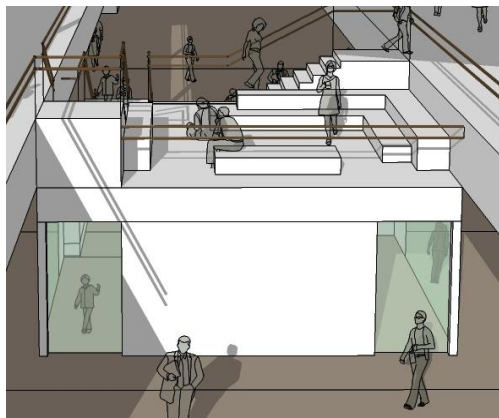

Partial Plan

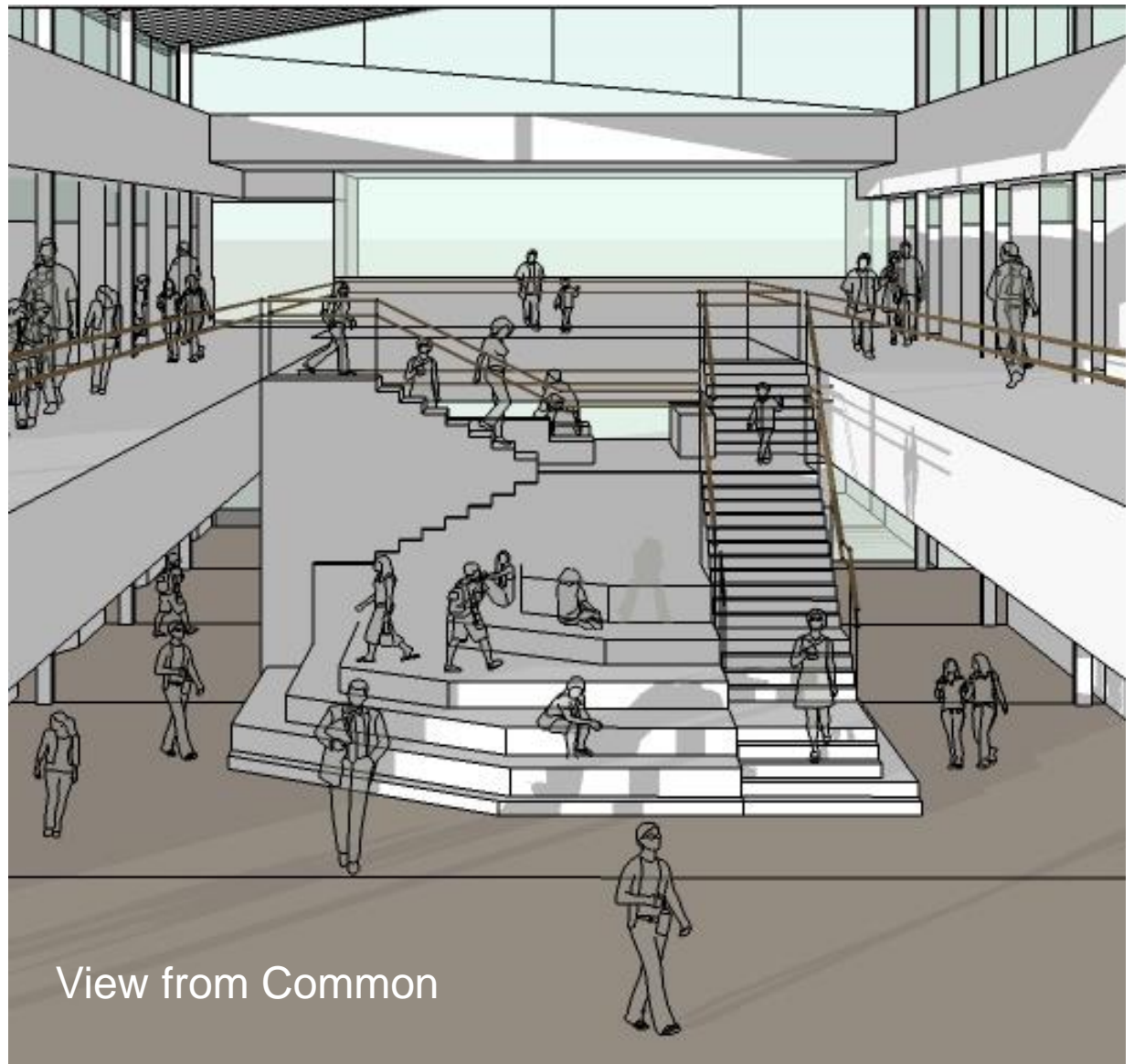

## Main Stair and Seat Risers: New 3-5 Grade School (O'Connor Site)

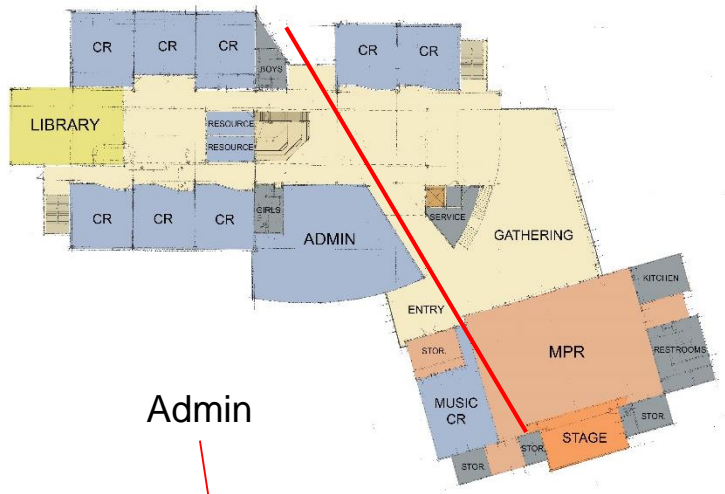

Entry

Admin

Common

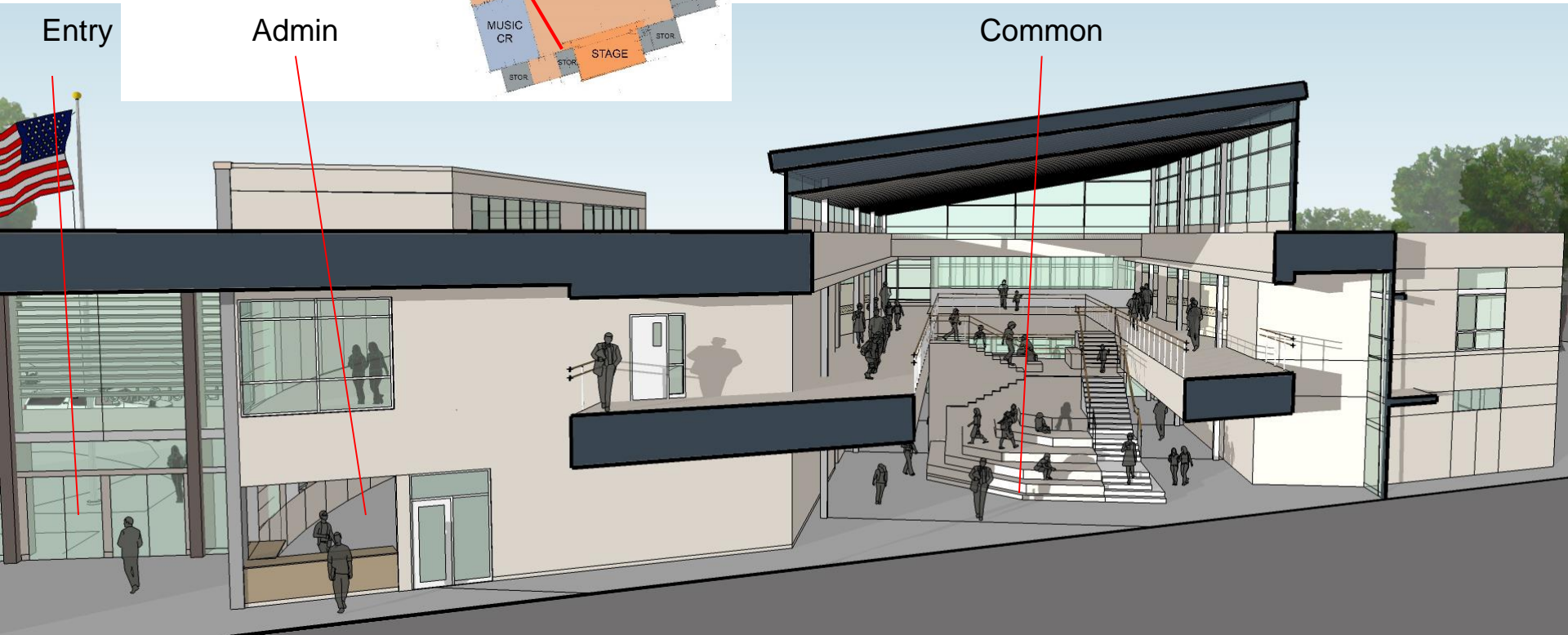

Section through Gathering and Common



New 3-5 Grade School (O'Connor Site)



# Construction Schedule

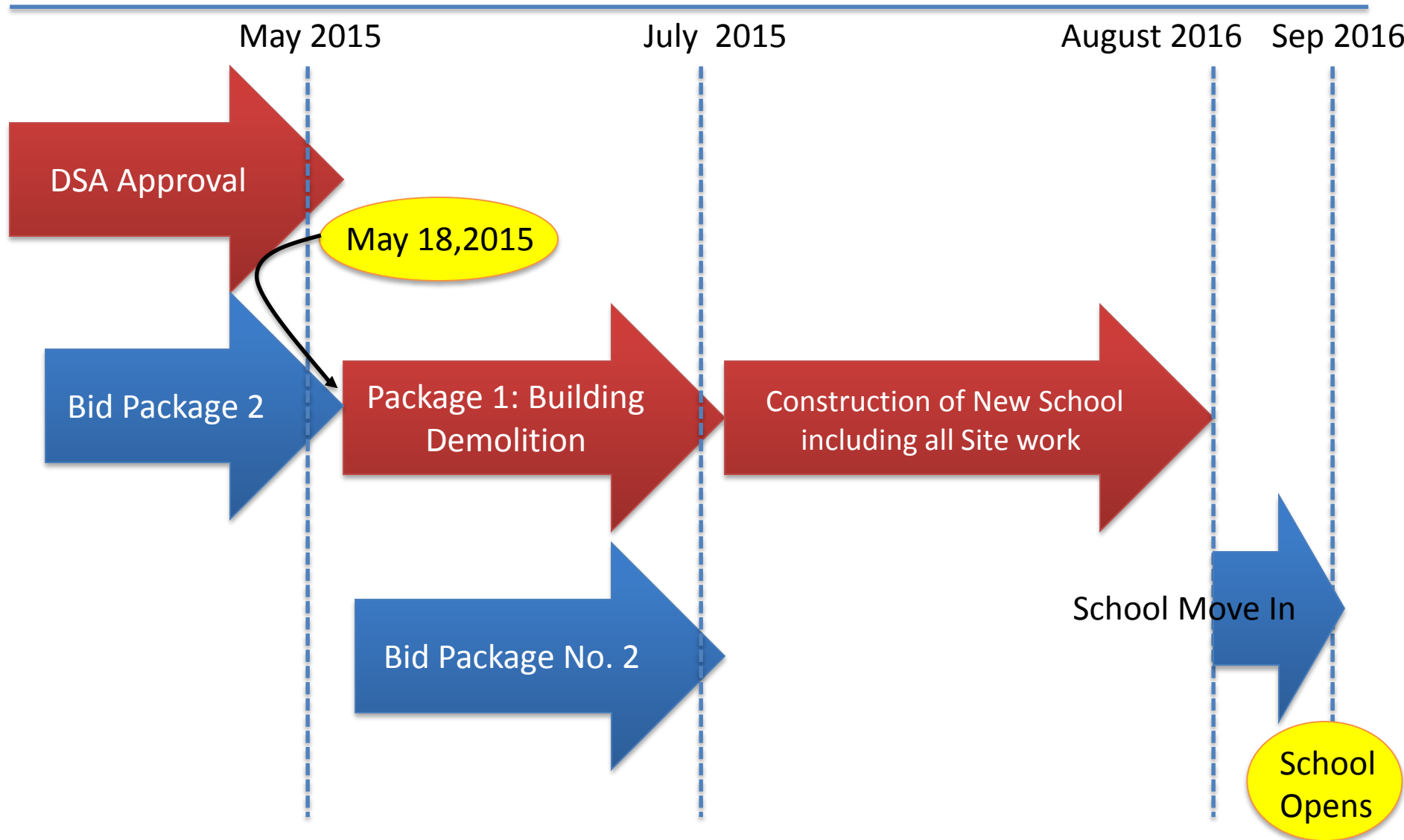

# Construction Schedule and Working Hours

---

- Project start date: May 18, 2015
- Ground Breaking: May 21 at 2:45 PM
- Completion date: August 2016
- Working days: Monday through Friday
- Saturday work: As needed
- Regular working hours: 7am to 4pm
- Saturday: 9am to 5pm
- Project is exempt from local City of Menlo Park ordinances
- Communication: E-mail and website



# Site Access and Fencing Project

---

- Site Access: Main Project access from Elliot Drive
- Auxiliary Access: Falk Drive and Oak Court as needed
- Site Access during construction
  - Oak Ave/Elliot Access will be closed
  - Field will be closed
- Site Fencing Project
  - Eric with RGM will contact residents to work out details
  - Work will start this summer and continue
  - Options:
    - Maintain existing fence and screen / repair as needed
    - Replace with “good neighbor” 6 feet high redwood fence and 2 feet lattice
- Tree removal and trimming

# Question and Answer

---

Thank You

