

**UTILITY PLAN**  
SCALE: 1" = 40'

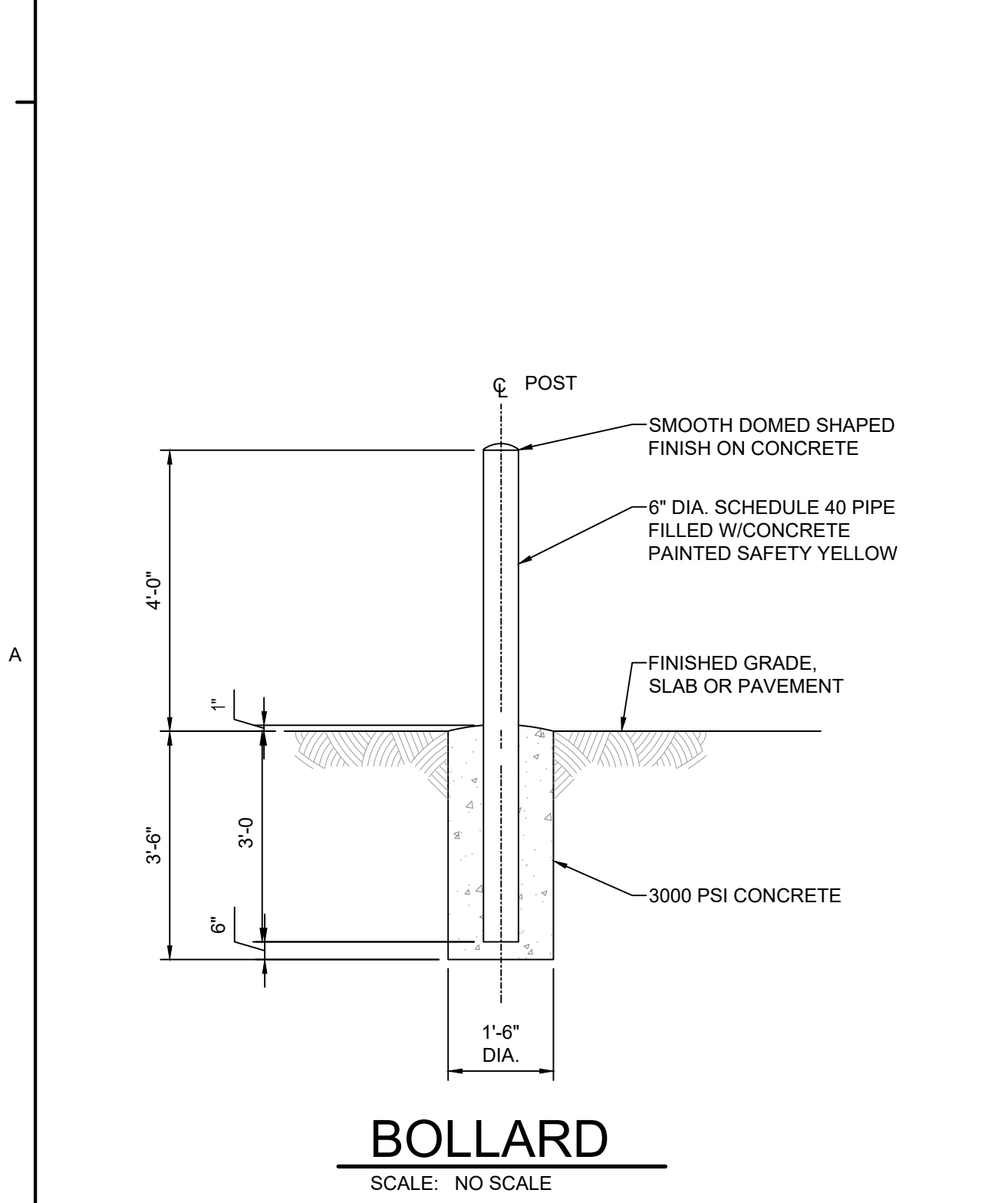

**BOLLARD**  
SCALE: NO SCALE

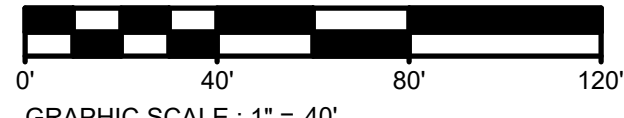
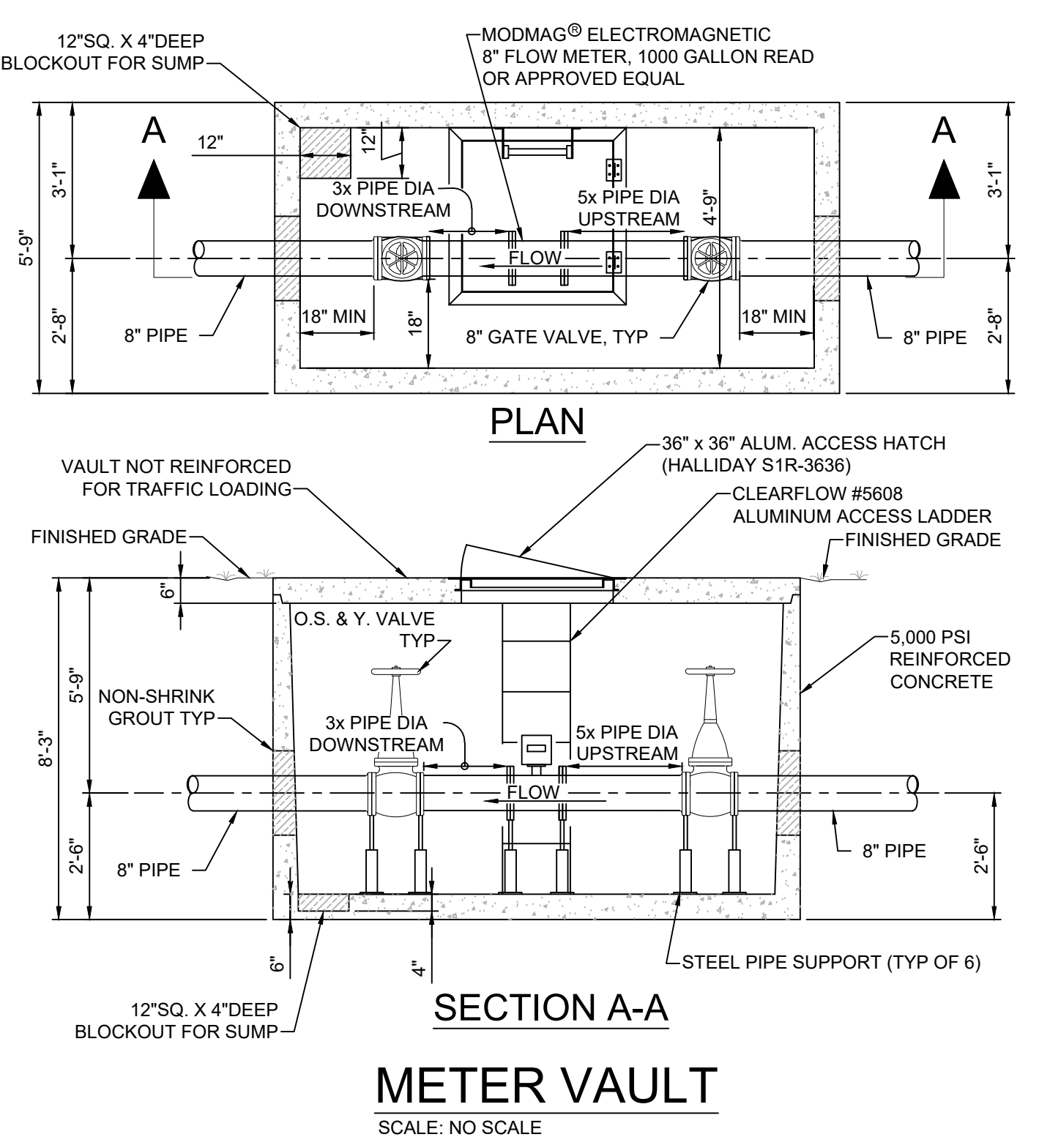

**METER VAULT**  
SCALE: NO SCALE

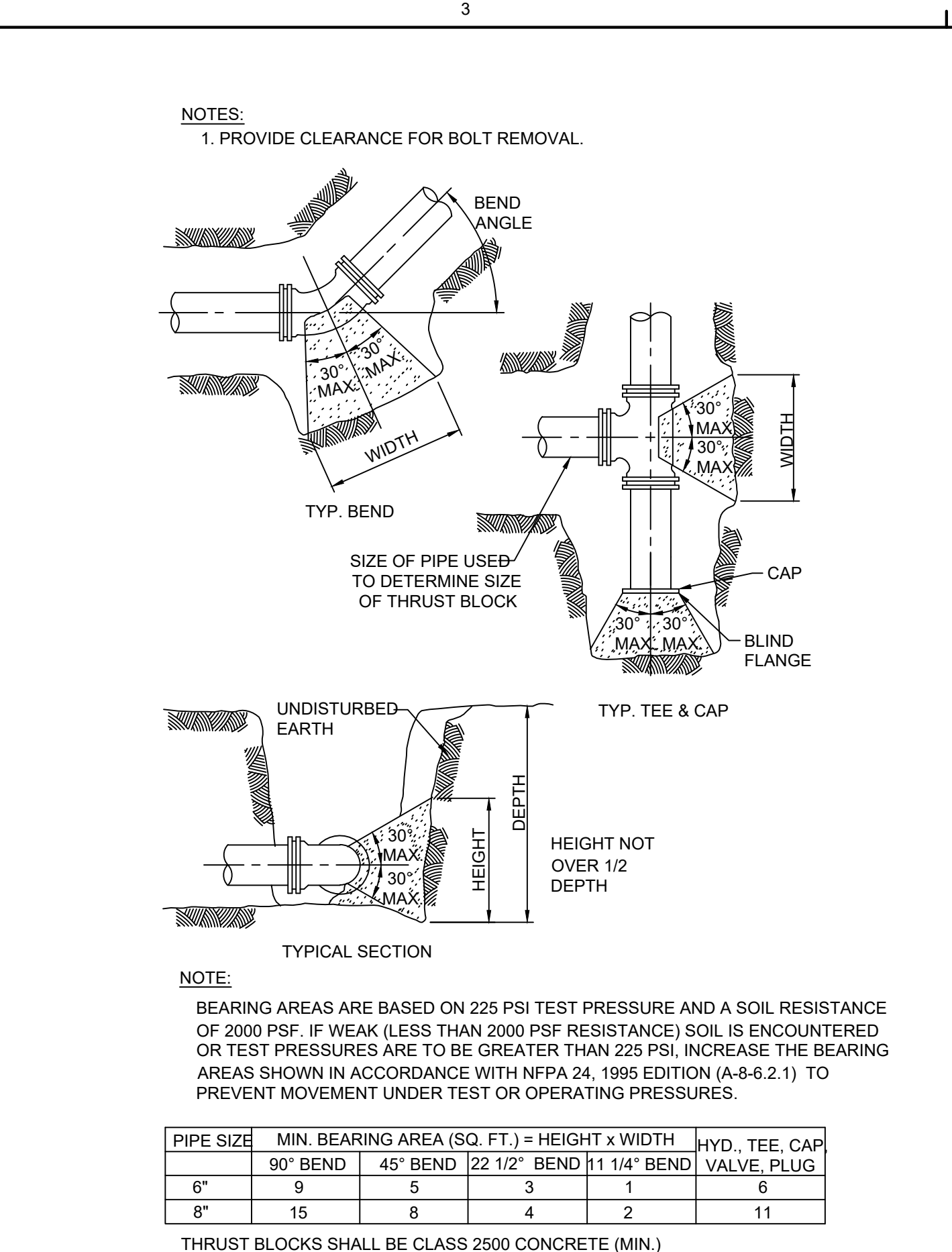

**NOTE:**  
BEARING AREAS ARE BASED ON 225 PSI TEST PRESSURE AND A SOIL RESISTANCE OF 2000 PSF. IF WEAK (LESS THAN 2000 PSF RESISTANCE) SOIL IS ENCOUNTERED OR TEST PRESSURES ARE TO BE GREATER THAN 225 PSI, INCREASE THE BEARING AREAS SHOWN IN ACCORDANCE WITH NFPA 24, 1995 EDITION (A-8-6.2.1) TO PREVENT MOVEMENT UNDER TEST OR OPERATING PRESSURES.

PIPE SIZE	MIN. BEARING AREA (SQ. FT.) = HEIGHT x WIDTH	HYD. TEE, CAP			
90° BEND	45' BEND	22 1/2' BEND	11 1/4' BEND		
6"	9	5	3	1	6
8"	15	8	4	2	11

THRUST BLOCKS SHALL BE CLASS 2500 CONCRETE (MIN.)

**THRUST BLOCK**  
SCALE: NO SCALE

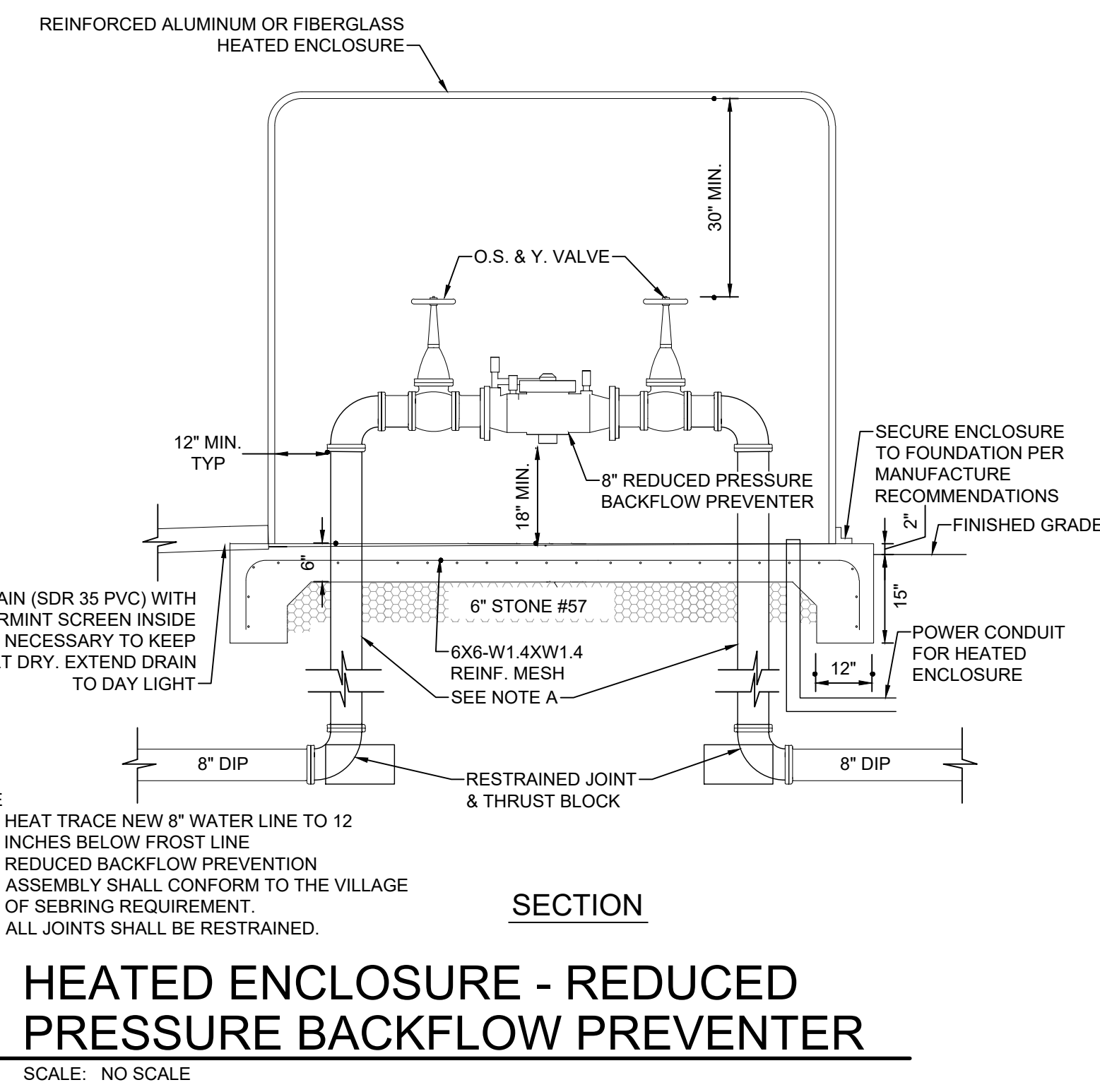
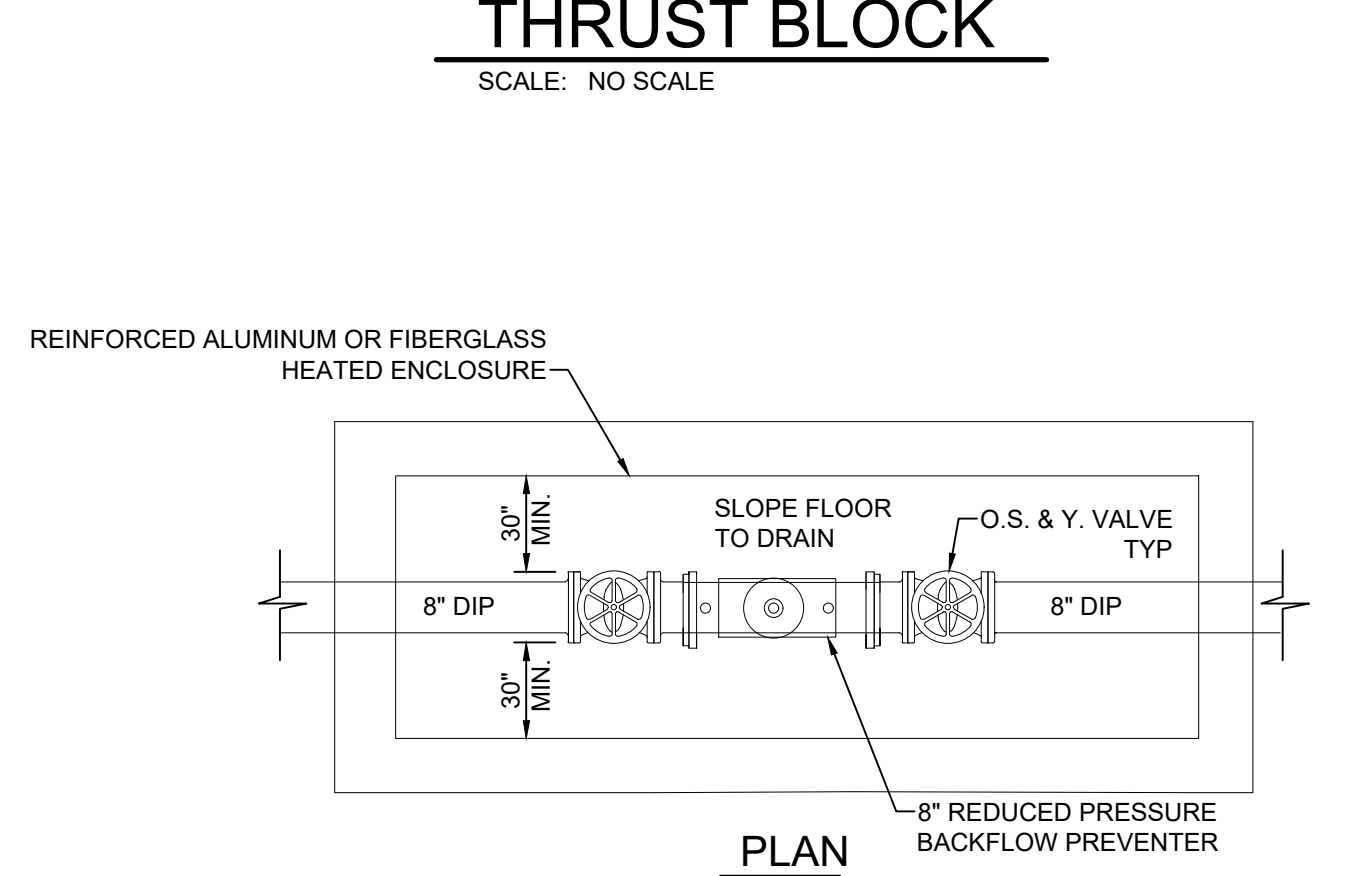

**HEATED ENCLOSURE - REDUCED PRESSURE BACKFLOW PREVENTER**  
SCALE: NO SCALE

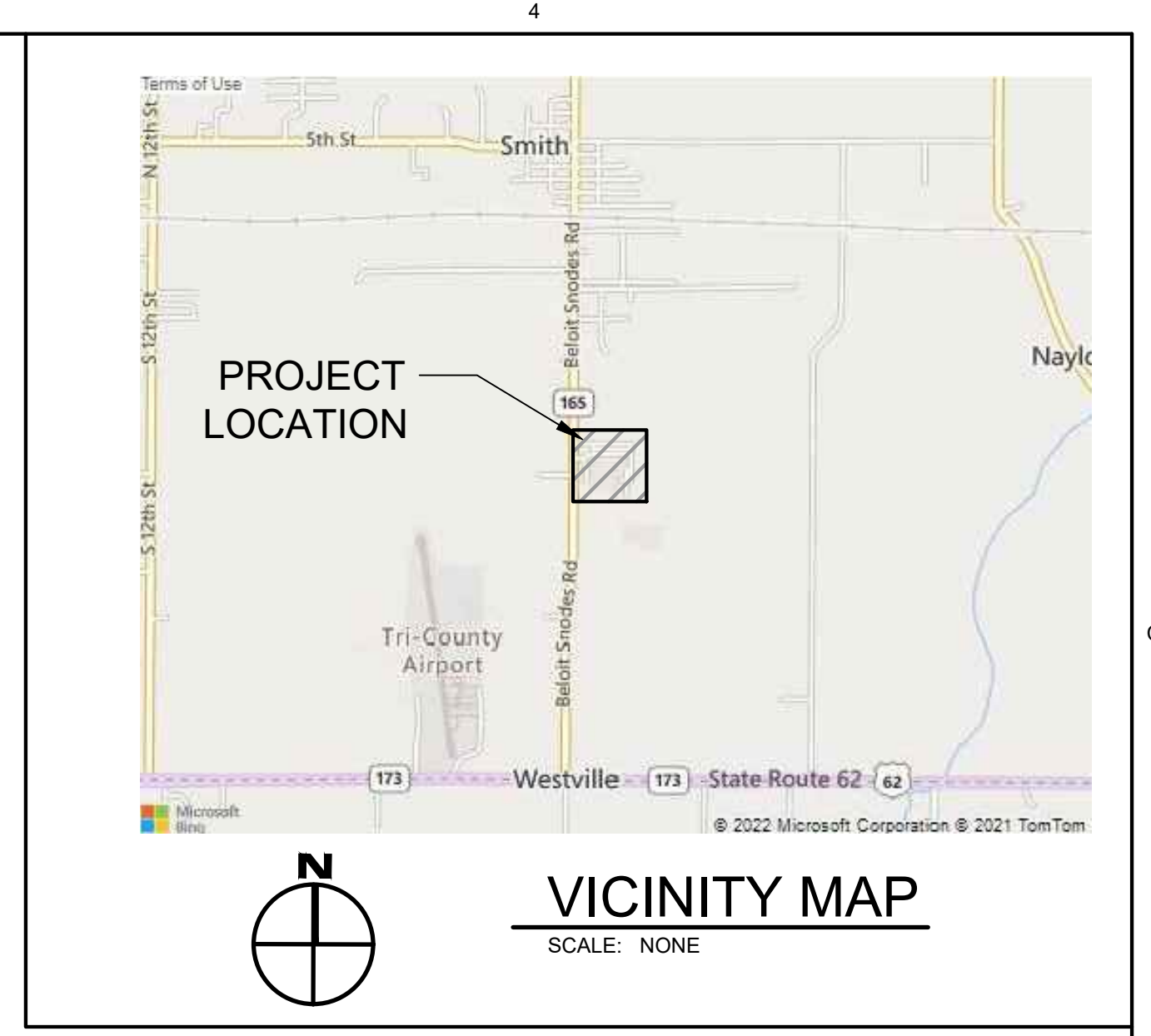

**WATERLINE NOTES:**

- ALL MATERIALS AND CONSTRUCTION SHALL BE IN ACCORDANCE WITH THE CONSTRUCTION STANDARDS AND SPECIFICATIONS OF THE STATE OF OHIO DEPARTMENT OF TRANSPORTATION (ODOT) DATED JANUARY 1, 2019. IN ADDITION, ALL WORK WILL BE IN COMPLIANCE WITH ALL APPLICABLE NATIONAL, STATE, AND LOCAL CODES AND REGULATIONS, UNLESS NOTED OTHERWISE.
- CONTRACTOR IS RESPONSIBLE FOR PROVIDING ALL WATERLINE MATERIALS, VAULTS AND HEATER ABOVE GROUND ENCLOSURE.
- CONTRACTOR SHALL COORDINATE ALL WORK AND WATER MAIN INSTALLATION WITH THE VILLAGE OF SEBRING.
- THE CONTRACTOR SHALL ARRANGE FOR VILLAGE INSPECTION A MINIMUM 3 DAY PRIOR TO PERFORMING ANY EXCAVATION.
- ALL WATER LINES AND APPURTENANCES SHALL BE CONSTRUCTED ACCORDING TO THE VILLAGE OF SEBRING STANDARDS.
- ALL PUBLIC AND PRIVATE UTILITY COMPANIES SHALL BE NOTIFIED BY THE CONTRACTOR, IN WRITING, AT LEAST SEVEN (7) DAYS IN ADVANCE OF BEGINNING ANY CONSTRUCTION OPERATIONS.
- THE SPECIFICATIONS OF THE AMERICAN NATIONAL STANDARDS INSTITUTE (ANSI), AMERICAN WATER WORKS ASSOCIATION (AWWA) AND THE AMERICAN SOCIETY FOR TESTING AND MATERIALS (ASTM) HEREIN REFERRED TO, UNLESS OTHERWISE NOTED, SHALL BE THE LATEST SPECIFICATIONS OF THE RESPECTIVE ORGANIZATIONS.
- ALL PIPE, VALVES AND FITTINGS SHALL BE UL/FM APPROVED.
- ALL PIPE AND FITTINGS SHALL CONFORM TO AWWA C-151, CLASS 52 AND HAVE A CEMENT MORTAR LINING, CONFORMING TO ANSI A21.4 (AWWA C104) AND A BITUMINOUS OUTSIDE COATING PER AWWA C110 AND ENCASED IN A POLYETHYLENE TUBE PER AWWA C105.
- VALVE BOXES SHALL BE THREE (3) PIECE ADJUSTABLE SCREW TYPE, WITH A 5-1/4 INCH SHAFT, WITH CAST IRON FULL FLANGE RING AND LID.
- GATE VALVES 12" AND SMALLER SHALL BE LIMITED TO VALVES MADE BY AMERICAN DARLING, KENNEDY, MUELLER, U.S. PIPE OR CLOW VALVE COMPANIES MEETING AWWA SPECIFICATION C509.
- CONTRACTOR TO PROVIDE CONCRETE TRUST BLOCKS. ALL JOINTS SHALL BE RESTRAINTS IN ACCORDANCE WITH THE CURRENT EDITION OF NFPA 13.
- INSTALLATION AND PRESSURE TESTING SHALL BE AS PER AWWA C-600. DISINFECTION SHALL MEET OR EXCEED AWWA C-651. NO DEVIATIONS FROM THE ABOVE SPECIFICATIONS WILL BE PERMITTED.
- THE OHIO ENVIRONMENTAL PROTECTION AGENCY REQUIRES A CONFORMANCE TO THE 2003 EDITION OF "RECOMMENDED STANDARDS FOR WATER WORKS". THIS STANDARD SHALL BE EQUALED OR EXCEEDED FOR WATER LINES. SPECIAL ATTENTION SHALL BE GIVEN TO THE FOLLOWING SECTIONS OF PART 8:  
 \*MATERIALS CONFORM TO AWWA STANDARDS FIRE PROTECTION  
 \*PRESSURE TESTING AWWA C-600 OR N.F.P.A. 24  
 \*MINIMUM 5'-0" GROUND COVER  
 \*DISINFECTION AWWA C-651  
 \*10' HORIZONTAL SEPARATION WATER MAIN/SEWER  
 \*18" VERTICAL SEPARATION WATER MAIN/SEWER  
 \*NO ENTRY AND/OR CONTACT WITH SEWER MANHOLE.
- ANY DEVIATION FROM THE ABOVE WILL NOT BE PERMITTED UNLESS SPECIFICALLY INCLUDED IN THE GENERAL NOTES OR OTHERWISE SHOWN ON THESE PLANS.
- ALL DISTURBED AREAS NOT DESIGNATED TO RECEIVE A FINISHED SURFACE SHALL BE SEEDED AND MULCHED.

**PROTECTIVE (HEATED) ENCLOSURE**

- FREEZE-PROTECTION ENCLOSURES: DESCRIPTION: INSULATED ENCLOSURE DESIGNED TO PROTECT ABOVEGROUND WATER PIPING, EQUIPMENT, OR SPECIALTIES FROM FREEZING AND DAMAGE, WITH HEAT SOURCE TO MAINTAIN MINIMUM INTERNAL TEMPERATURE OF 40 DEG F ( WHEN EXTERNAL TEMPERATURES REACH AS LOW AS MINUS 34 DEG F.
  - STANDARD: ASSE 1060.
  - CLASS I-V: FOR PRESSURE OR ATMOSPHERIC VACUUM BREAKER EQUIPMENT OR DEVICES. INCLUDE DRAIN OPENING IN HOUSING.
    - HOUSING: REINFORCED ALUMINUM OR FIBERGLASS HOUSING CONSTRUCTION.
    - SIZE: OF DIMENSIONS INDICATED, BUT NOT LESS THAN THOSE REQUIRED FOR ACCESS AND SERVICE OF PROTECTED UNIT.
    - DRAIN OPENING FOR UNITS WITH DRAIN CONNECTION.
    - ACCESS DOORS WITH LOCKING DEVICES.
    - INSULATION INSIDE HOUSING.
    - ANCHORING DEVICES FOR ATTACHING HOUSING TO CONCRETE BASE.
- ENCLOSURE BASES: DESCRIPTION: 6-INCH- MINIMUM THICKNESS PRECAST CONCRETE, OF DIMENSIONS REQUIRED TO EXTEND AT LEAST 6 INCHES BEYOND EDGES OF ENCLOSURE HOUSINGS. INCLUDE OPENINGS FOR PIPING.

**SSOE**

CONSULTANTS:

SEAL ON THIS DOCUMENT AUTHORIZED BY:

PROJECT INFORMATION:

**WEST BRANCH HIGH SCHOOL WATERLINE METER SERVICE**  
BELOIT, OHIO 44609

CLIENT INFORMATION:

**WEST BRANCH LOCAL SCHOOL DISTRICT**  
14277 S. MAIN ST  
BELOIT, OHIO 44609

CLIENT PROJECT NO:

1	10-18-22	REISSUED FOR PERMIT
0	10-10-22	ISSUED FOR PERMIT
NO.	DATE	SUBJECT
REVISION OR ISSUE		

**SSOE, Inc.**  
885 S. Sawburg, Suite 106  
Alliance, OH 44601-9026  
T. (330) 821-7198

PROJECT NO: **022-01411-00**  
PROJECT MANAGER: L. MUSHUNG  
DESIGNED: D. WOLF  
CHECKED: C. HARTMAN

DRAWING TITLE:  
**WATER METER SERVICE**

DRAWING NO:  
**W-1**

C:\Users\13374\OneDrive - SSOE, Inc\FDrive\Projects\West Branch School District\West Branch.dwg  
DATE: Oct 18, 2022 - 8:48am USER: 13374