



## MISSION

Develop Character and Discover One's Unique Potential

# FY20 ANNUAL REPORT

JULY 1, 2019 - JUNE 30, 2020

# TABLE OF CONTENTS

LETTER FROM THE PRESIDENT	2	GIFT LISTS	11
BOARD OF GOVERNORS	3	GIFTS IN KIND	
BY THE NUMBERS	4	CORPORATIONS	
GIVING SUMMARY		ORGANIZATIONS	
FIVE-YEAR COMPARISON		FOUNDATIONS	
OPERATING REVENUE & EXPENSES		A NEW WAY TO ENGAGE STUDENTS ON THE MAINE	12
ENDOWMENT		WATERWAYS!	
THE ROB SCHULLER MEMORIAL FUND FIRE PIT PROJECT	5	IN MEMORY GIFTS	13
SCHOLARSHIPS	6	HAPA ~ ALWAYS A PART OF THE HYDE FAMILY, KEEPING	14
GIVING SOCIETIES	6-10	US STRONG AND MOVING FORWARD. THANK YOU!	
1966 CIRCLE		THE HYDE FAMILY FUND	15
LEADERSHIP CIRCLE		IN HONOR GIFTS	16
CONCERN CIRCLE		SUMNER HAWLEY SOCIETY	17
INTEGRITY CIRCLE		WAYS TO GIVE	20
COURAGE CIRCLE			
CURIOSITY CIRCLE			
WOLFPACK CLUB			
WITH GRATITUDE			

## Hyde Team

Laura D. Gauld '76  
 Malcolm A. Gauld '72  
 Susan Brennan  
 Sarah Clifford  
 Jlynn Frazier  
 Sara Levensohn  
 Lindsay Mischel  
 Sydney Wall

The FY20 Annual Report reflects gifts, activities, and events between July 1, 2019, and June 30, 2020. Every effort is made to ensure accuracy and transparency, however we would sincerely appreciate knowing of any corrections that should be reflected. You may contact the Development Office at 207-386-5200 or [development@hyde.edu](mailto:development@hyde.edu). Thank you.



# LETTER FROM THE PRESIDENT

Dear Hyde Community,

We began the 2019-2020 academic year with the Class of 2020's commitment to leave a legacy of concern and connection. A day at Hyde is filled with our co-curricular program where, simply put, everyone does everything! We all do College Preparatory Academics, Three-Season Competitive Athletics, Performing Arts, Community Service, Discovery Groups, and the Character and Family Programs. Through testing oneself and dedication to striving for excellence, a true sense of grit and confidence is formed.

We had no idea how the Hyde education would be tested when spring break began. When faced with the pandemic, Hyde had to pivot from our normal program and radically change our instructional model. Unlike some schools that focused solely on academic instruction, Hyde reached for excellence in order to deliver synchronized classroom instruction, daily fitness routines, parenting webinars, college counseling workshops, Discovery Group seminars, school meetings, and family fun. We even conducted our first ever virtual Spring Family Weekend, dance performance included! We realized it was possible to adapt to this new format, embrace new attitudes, and find the opportunities in our obstacles.

What inspired us all was the tenacity of our students who had to let go of their disappointment over canceled rites of passage, in-person learning, and the sense of community that builds during the spring of every Hyde school year. They worked through their individual and collective grief to rally one another to finish strong! Our seniors led the virtual senior evaluations and brought depth to this signature process of the Hyde education. Their individual speeches reflected their growth, and, while it was certainly surreal, the faculty had great pride in seeing how their characters had emerged.

On behalf of all of us at Hyde, I cannot fully express our gratitude for the Alumni, HAPA, Parents, Grandparents, Faculty, Staff and Friends whose names fill the following pages. Your support of the Hyde education allows us to build on our foundation of character development, and move boldly ahead to the future vision of Hyde.

Our entire student body's legacy during this time will be about concern and connection, and finding character in challenging times. We have been through something important,



challenging and deep, and we know the world needs more of the character building we have experienced. This growth would not have been possible without each of you, and the many ways in which you inspired us to stay Hyde Strong. We hope to see you soon on this beautiful campus!

With deep respect and gratitude,

A handwritten signature in black ink that reads "Laura D. Gauld". The signature is written in a cursive, flowing style.

Laura D. Gauld '76  
President



# Board of Governors

## BOARD OF GOVERNORS 2019-2020

### **Nancy Brennan, Board Chair**

*Jeffrey Lund '06*

### **Jon '71 and Ann Bell**

*Samuel Bell '15*

### **Scott Bertschy '78**

### **Jeff Black '78/'79**

### **Steve Cary**

*Taylor Cary '05*

### **Jamie Delaney**

*Ryan Delaney '10*

### **Al de Molina**

*Rachel de Molina '11*

### **Barry Freid '75**

*Andrew Freid '06*

### **Malcolm and Dana McAvity**

*Angus McAvity '09*

### **Tom Moore**

*Patrick Moore '03*

*Robert Moore '04*

*Joseph Moore '07*

*Carolyn Moore '14*

### **Jim Silverman '87**

### **Andrew Sylvester '03**

### **Debbie Werner**

*Jason Werner '06*

## BOARD OF GOVERNORS EMERITI

### **Lennox "Bim" Black**

*Christopher Black '76*

*David Black '76*

*Jeff Black '78/'79*

### **David Boone and Jacki Hinton**

*Aaron Hinton '98*

### **Rick and Dee Dee Chesley**

*Nathan Chesley '12*

### **Lloyd "Rusty" and Kristin Day**

*Colin Day '00*

*Jessie Day '03*

### **Ken and Lorrie DeAngelis**

*Ross DeAngelis '04*

*Simone DeAngelis '10*

*Madeline DeAngelis '10*

### **Michael Delaney (deceased)**

*Ryan Delaney '10*

### **Jack and Gini Diskin**

*Brad Diskin '78*

### **Catherine "Nicky" Falck**

*Marc Falck '02*

*Olivia Falck '04*

### **Larry French**

*Todd French '89*

### **James and Marge Freston**

*Cary Freston '79*

*Randal Freston '83*

### **Margo Calvetti Frost '76**

*Mariel Frost '10*

### **Spencer Garrett '81**

### **Joseph Gauld, Founder**

*Malcolm Gauld '72*

*Laurie Gauld Hurd '75*

*Georgia Gauld MacMillan '82*

### **James Grasty '73**

### **Dave and Hobey Hinchman**

*Steve Hinchman '81*

*David Hinchman '87*

*Josephine Hinchman '90*

### **Rob and Anne Krebs**

*Duncan Krebs '97*

### **Ray Koda**

*Taiga Koda '08*

*Haruka Koda '10*

### **Armin "Rick" Kuder**

*Carlyn Kuder '82*

*Keith Kuder '85*

### **Paul MacMahon**

*Timothy MacMahon '95*

*Julia MacMahon '01*

*Lisa Schuchmann '01*

*Kerri Schuchmann '02*

### **Verna Mayo '74**

### **Stuart Ochiltree**

*Molly Ochiltree '95*

### **Gilbert Raff**

*David Raff '81*

### **Ray Smart**

*Archie Smart '90*

### **Matt Snyder '94**

### **Clay and Judee von Seldeneck**

*Roddy von Seldeneck '96*

*Kevin von Seldeneck '97*

### **Joe Werner**

*Jason Werner '06*

### **Chan Wheeler**

*Anne Wheeler '04*



# BY THE NUMBERS

## ***TOTAL GIVING TO HYDE FY20***

- **Hyde Strong Annual Fund**  
\$597,000
- **Capital & Restricted Funds**  
\$415,398
- **Total Giving To Hyde**  
\$1,012,398

## **ENDOWMENT**

Market Value as of 6/30/2020  
\$24,575,068

## **OPERATING REVENUE & EXPENSES**

Student Charges	\$8,224,000
Summer Programs	\$318,000
Annual Fund	\$598,000
Other Income	\$131,000
Endowment Distrib.	\$853,000
<b>Total Revenue</b>	<b>\$10,124,000</b>

Financial Aid	\$2,254,000
Salaries & Benefits	\$5,433,000
Program Services	\$660,000
Fundraising	\$42,000
Plant	\$940,000
G&A	\$751,000
<b>Total Expenses</b>	<b>\$10,080,000</b>



# A Beautiful Way to Honor a Beloved Alumnus ~ Rob Schuller '78

## *The Rob Schuller Memorial Fund Fire Pit Project*

Following the passing of Robert Eliot Schuller on November 30, 2019, members of the Class of 1978 felt compelled to honor Rob's legacy at Hyde, and began discussing how to best honor their friend. Laura Gauld and the Planning Committee Thomas Baez, Scott Bertschy, Jeff Black, and Stu Jones selected a fire pit patio area as their naming opportunity, and initiated the *Rob Schuller Memorial Fund* in January, 2020.

The fire pit project is part of a capital campaign to renovate the performing arts space, and will become the heart of the campus. As of June 30, 2020, gifts and pledges for the memorial fund totaled \$78,000 towards our goal of \$125,000. We are overwhelmed by this outpouring of support from Rob's family, dear friends, and classmates towards creating a special gathering place which students will enjoy for decades to come.

A celebration of Robbie's life will be held on campus on September 18, 2021. Thank you again to the families and friends who have honored his legacy in such a meaningful way.

## Hyde School Fire Pit Project

Made Possible by the Rob Schuller Memorial Fund Donors

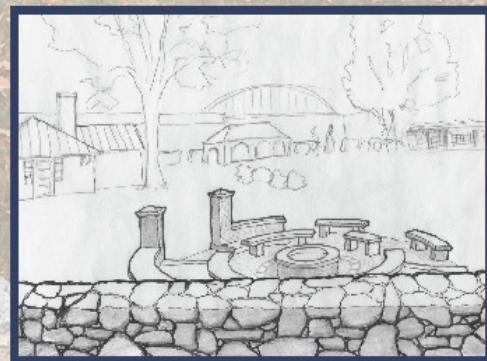
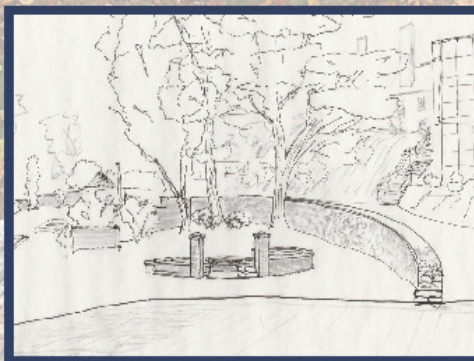
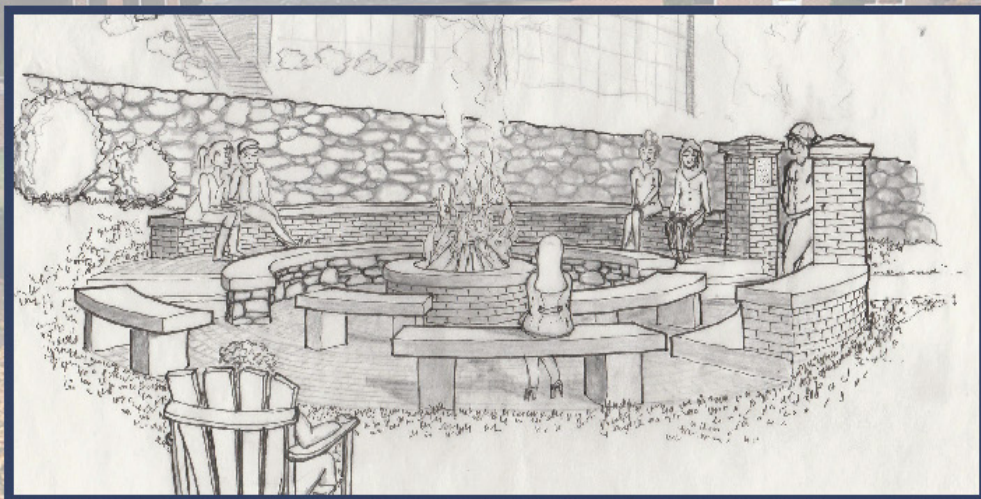



# Giving By Society

INCLUDES ALL GIVING TO HYDE\*

## Scholarships

Scholarships provide need-based financial aid to Hyde Students. We are extremely grateful for our named scholarships and the opportunities they provide to our students.

### **D'Amato Scholarship**

Donor: Armand D'Amato, HAPA  
Dakota '09 Woodstock  
Ross '12 Bath  
Recipient: Warsame Ali '21

### **Silverman Scholarship**

Donor: James Silverman '87  
Board of Governors  
Recipient: Angel Price-Espada  
PG '20

### **von Seldeneck Family Scholarship**

Donor: Judee von Seldeneck,  
HAPA, Former Board of Governor  
Roddy '96, Kevin '97 Bath  
Recipient: Tanae Arnold '20

### **1966 CIRCLE**

#### **\$25,000 or more**

Scott Bertschy '78 and Jeanne Hansen  
Bessemer National Gift Fund  
Jeff '78 and Claire Black +  
Nancy Brennan +  
Steve Cary  
Davis Family Foundation  
Jamie Delaney +  
Joey Gauld ++  
Malcolm and Dana McAvity +  
J.P. Morgan Securities Charitable  
Giving Fund  
TIAA Cref  
Vanguard Chartitable Endowment  
Program  
Clay and Judee von Seldeneck ++  
Maureen Yoder +

### **LEADERSHIP CIRCLE**

#### **\$10,000 to \$24,999**

Jon '71 and Ann Bell +  
Reade and Martha Brower  
Frankel Family Foundation  
Matt Frankel '76 +  
CJ and Jane Fraleigh  
Barry '75 and Evan Freid  
Stu Jones '78  
Nick Karangelen and Kate McPartlan  
Raymond and Miwa Koda  
Rob and Anne Krebs ++  
Tom and Mary Moore ++  
J.P. Morgan Securities Charitable  
Giving Fund  
Gary Podell  
Resnick Family Foundation  
The Trident Foundation  
Bin Wang and Liehong Xiang  
Daniel Weiss and Ilene Resnick  
Joseph Debbie Werner +  
Rod Westmoreland  
Andrew White '03

*Symbols: \* deceased; years of consecutive giving*  
+ = 10+ years    ++ = 20+ years    +++ = 30+ years



## CONCERN CIRCLE

### \$5,000 to \$9,999

Bank of America Matching Gifts  
Jeff Benoliel and Amy Branch  
Zhendong Liu and Xiangling Chen  
Alvaro and Donna de Molina +  
The De Molina Family Foundation  
Bryan Farney and Amanda Poletti  
Read Fleming and Nancy Zacks +  
George and Susan Frost ++  
Malcolm '72 and Laura '76 Gauld +++  
James and Laurie Henderson  
Opaleye Management, Inc.  
Andy and Laura Pastor  
Pechet Foundation  
Taine and Jennifer Pechet  
Carter Perry \*  
Jim Silverman '87 +  
Ross and Kathy Wagner  
Holly White +  
Jiangdong Xu and Yiping Xie  
Guoqing Hu and Yaping Yao

## INTEGRITY CIRCLE

### \$2,500 to \$4,999

Bill and Carol Barrett  
Nancy E. Barton Foundation  
Barry and Stephanie Bricken  
Thomas and Kelly Carey  
Eddo deLang and Terry Mastrucci  
Marsha Farney  
Fidelity Charitable Gift Fund  
Daniel Georges and Rumiko Tsuda  
The Greater Cincinnati Foundation  
James Hawkins  
Dave and Hobey Hinchman ++  
Tripp Holton '89

Holton Surgical Consultancy LLC  
JC Labowitz and Patti Rounsevell +  
Matt Kinney  
Adam and Rachel Paley  
Lucy Patricola  
Israel Plasner  
Princeton Area Community Foundation  
Michael Skunda and Karen Primak  
Andrew Sylvester '03  
Mike Toerge '67

## COURAGE CIRCLE

### \$1,000 to \$2,499

Carolyn Abernethy  
Anonymous (2)  
Deborah Anderson  
Wojtek and Christine Aronski +  
Jane Bartrum  
Christopher and Annie Battista  
Pam Bertschy '81 +++  
Tom Bragg '83  
Matt Candy  
Wright and Deborah Carreau  
Michael Carricarte  
Judith Castor  
Sandy Champagne  
Stu and Lori Constantine  
Lori Cooke '81 ++  
Lynn Dawes  
Lisa Deskovick  
Alan and Joannie Earhart  
Mary Agnes Edsall  
Bob '90 and Brooke Felt ++  
Kyle and Linda Felt ++  
Fidelity Charitable Gift Fund  
Bernard and Jacki Gran +  
Ken '72 and Claire '75 Grant +++  
Michael and Theresa Haggett  
William Hazel

Joseph Horning and Fiona Lovell-Horning  
Steve Mooney and Mary Howard  
Monty and Lucy Humble  
Jeffrey and Catherine Jacobs  
Beckie Jarrett  
Jewish Communal Fund  
J.P. Morgan Securities Charitable Giving Fund  
Seth Lane and Kyle Spencer  
Tong Liu  
Bin Lu and Wenya Wu  
Gigi '82 and Don MacMillan  
Marin Community Foundation  
MELMAC Education Foundation  
Merrill Lynch and Co. Foundation  
Christina Neal  
Jean Noonan  
Nick and Georgette Notias  
Paul and Stephanie Peck  
Helen Pepper  
Perry and Margery Pintzow  
Prince Charitable Trusts  
Kevin and Diana Prince  
Peter and Sarah Proach +  
Avo and Sarah Reid  
Jeff and Ina Rose  
Jacob and Sarah Sargent  
Heidi Schley  
Barbara Schuller  
Schwab Chartiable Fund  
Eric Schwartz +  
Richard Schwartzwald and Jean-Louise Caldwell  
The Searles Family Foundation  
Jeannie Sneed  
Fortney and Deborah Stark  
Michael and Claire Stoner  
Quynn Taylor  
Holly and Jim Thompson  
Richard and Nancy Truluck +++  
Rick and Susan Umbach

United Way of Central and Northeast CT  
Vanguard Charitable Endowment  
Program

Simon and Lilia Vinarsky  
Jun Wan and Aihua Hu  
Ye He and Yahua Wang  
Hongda Ji and Lili Wang  
Roger and Karen Werner  
Meg Whiteford  
Charles Chao and Bicky Wong  
Yuxia Wu  
Jingwei Xu  
David Yale

## CURIOSITY CIRCLE

**\$500 to \$999**

Aegon Transamerica Foundation  
ASD  
Anonymous  
Nelson Arnstein '71  
Michael Austin '84  
Doug Baker '84  
Will and Fiona Baker  
Michael and Deirdre Barone  
Adam Bell and Therese Bosnick  
Alan and Sheri Brooks +  
Jim and JoAnne Capecelatro  
William and Sharon Coale  
Amy Cohen  
Sean Condon  
Susan Dube  
Jenna Field  
Bobbie Flemming++  
Barry and Tamara Free  
Jim and Margie Freston  
Jon Frost '96  
Fidelity Brokerage Services LLC  
Fidelity Charitable Gift Fund  
Samuel Fisher

Geri Goldstein  
Harold and Elizabeth Hagood+  
Kristin Harman  
Ruben Orduna and Elizabeth Hill  
David and Sharon Hirsch  
Rick and Jody Howard  
John and Kathy Huettel

Laurie Gauld Hurd '75++  
Lauren Jennings  
Jewish Communal Fund  
Kent Julye and Tracy Mills  
John Kanik '75  
Scott Kaplan  
Robin Karpf  
Jay and Jane Keenan  
Jeffrey Kent  
William and Sallie Larsen  
Hsiu-Te Mathis +  
Geoff '79 and Renee McConnell  
Michael McDonald  
Lindsay Mischel  
Charles and Sharon Molster  
Sol Mora and Joy Dryer  
Kevin and Eileen Muench  
Ed and Linda Murphy ++  
Rich and Day Newburg  
Bill and Carol Pierskalla  
Pitcairn  
Douglas and Christine Preston +  
David and Susie Reed  
John and Sharon Reed  
John and Kirsten Rigney  
John and Cathy Schleining  
Jonathan and Gail Schorsch  
Steve and Christy Singleton  
Richard Stone  
Mark Thiel  
Francis and Jody Trombetta  
Rich '88 and Kristie Truluck +++  
Rink and Betsy Varian  
Jean Waddill

Thom Williams '69  
Pieter Wolters and Ank Stuyfzand

## WOLFPACK CLUB

**\$250 to \$499**

Anonymous  
Brian '81 and Linda '82 Ashforth  
Austin Community Foundation  
Rich and Carol Barron  
George and Peace Baxter  
Jordan and Catherine Bazant  
Kathleen Bellwoar  
Jennifer Blackstone  
Adele Blong ++  
Patrick and Jennifer Buell  
Margo A. Calvetti '76  
Sarah Carlin '80 and Derek Beckwith  
Bob and Ann Cary  
Sarah Clifford  
Ross and Lisa Dik  
Charles Dodge  
Bill Emanuel  
Fidelity Charitable Gift Fund  
Mario Texeira and Alison Fife  
Mike Folan '80  
Travis Glennon  
Connie Gongaware  
James '73 and Angelina Grasty  
Donald and Deborah Hamer  
Pam and Tom Hardy +  
David Hills and Catherine McLaughlin-  
Hills  
Al-Khaliq and Hassanah Holmes  
Nathan and Kathleen Jean-Jacques  
Stefan Jensen  
Herb and Leah Kaplan +  
Maureen Kenney  
Catherine Lawler



Sara and Luc Levensohn  
 Xiangqun Huang and Zi Liu  
 Tom Lonsdale '71\*  
 LPL Financial Foundation  
 Craig '71 and Dorothy Mael +  
 Brian and Nicole Millard  
 Janna Morgan  
 Joel '68 and Ruth Moses ++  
 Peter and Susan Moskowitz  
 Tom and Traci Nelson +  
 Thomas Nixon '14  
 Kevin and Bonnie O'Brien  
 Peter and Diane Pappas  
 C. Lee Peeler  
 Diana Phillips  
 Karen Platte  
 Gibby and Cynthia Raff  
 Randy Robish  
 Karin Sayegh  
 Michael and Janice Schiffman  
 Schwab Charitable Gift Fund  
 Wanda Smith +  
 Dan and Mimi Sullivan  
 Lauren Torres '03  
 Tricia Uber  
 Brad van Voorhees '04  
 Kathleen Walsh

## WITH GRATITUDE

### Gifts up to \$249

Anonymous (5)  
 Bob Aaronson and Nancy Gropper  
 Alicia Nichols Fundraising Counsel  
 Nadine Alpern  
 Doris Anderson  
 Jon Angus  
 Ale' Atkins '20  
 Wanda Avery  
 Debra Baker

Nichole Barnikow  
 Susan Barron  
 Warren Barter  
 Bob Batky  
 Tim Baustert  
 Melinda Baxter '89 and Walter Gregg  
 John and Jessica Bayreuther  
 Sandra Beauileu  
 Corey Begly  
 Gerald and Cynthia Bell  
 Joan Bellsey  
 Will Bennis '87  
 Mike Berkowitz '98  
 Michel Bezy and Isabelle Geoffroy  
 Zach Birnbaum '11  
 Ted and Barbara Borek  
 Arnie and Linda Borish  
 David and Julie Borsani  
 Suzi Boschan  
 Helen Bosley  
 Jeffrey and Karin Bouvier  
 Mike Box '08  
 Hap Bradley '97  
 Susan Brennan  
 Sarah Bright  
 Isaac Brower '09  
 Sean and Wendy Callahan  
 Michael and Angela Campbell  
 Kirk Campbell  
 Michael Cannon '11  
 Jimmy Carleton ++  
 Valerie Carnevale  
 Letah Carruthers  
 Margaret Cavalli  
 Marna Chamberlain '90 and Adam Carr  
 Audrey Cheetham  
 Marc Chillemi  
 Dennis and Monica Christensen  
 Peter Cion  
 Todd Clauer

Teresa Coffey  
 Susan Craig  
 John Cully  
 Philippa Cully  
 Will Cutrer '04 and Jessica DeAngelis-Cutrer  
 Lavoe Davis  
 Nick Davis '13  
 Lisa DeLessio  
 Heather '82 and Steve DePaola  
 Bill Doe +  
 Bonnie Doll  
 Dottie Dori  
 Murphy Duffy  
 Katherine Ellin and Gilead Tadmor  
 David Epstein  
 Ryan and Casey Ewart  
 Gail Feinstein  
 Thomas Ferrie  
 Dakin Ferris '79  
 Myra Fetzer  
 Fidelity Charitable Gift Fund  
 Nina Fixler  
 Lucy Foerster '03  
 Erin Ford  
 Lisa Fourre  
 Noel Foy  
 Jlynn Frazier  
 Lee Fritz  
 Don Fusco  
 Sean and Mimi Gallagher  
 Mahalia Gauld '08  
 Scout Gauld '10  
 Lisa Geller '93  
 Katie Gillihan  
 Samuel Godin  
 Doug and Sharon Goldhirsch  
 Eleanor Goldman  
 Gail Gormley  
 Ronald Gorsline  
 Bernie Gould +

Minot Granbery '72  
Jesse Grant '03  
Sarah Grant '00  
Lauren Grant '05  
Ian Gray '99  
Stacy Greenberg  
Rebecca Grondin  
Elizabeth Grybko  
Jack F. Gushue  
Tim Gustafson ++  
Kearney Gutierrez  
Sally Haggett  
Evelyn Hammond  
Elinor Hanley  
Matthew Hantzmon  
John and Drusilla Haran  
Doug Harp  
Louise Harpel  
Steve and Shelley Harris  
Jo-Anne Hart  
Allison Henderson  
Judy Hendrickson  
Amy Hennin  
Thomas Heyer and Deborah Odell  
Lori Hobart  
Mary Hobert  
Bill and Janet Hoffman +  
Sven and Sarah Holch  
Will Hood '04  
Ken Hooper  
Justin Hosie  
Craig and Erin Hudson  
Amanda '75 and Brad Hunter +  
Zach Hurd '99  
Meddy Hurd '04  
Georgia Hurd '03  
Joseph Huston  
Shelby Isbart  
Caroline Jackson '10  
Lee Ann James  
Jeff '72 and Maureen Jennings

Kendall Jennings '00  
Fang Jiang  
Shawn Johansen  
Ryan and Elizabeth Johnson  
Judith Jones  
Betsy Jones +  
Pamela Jones  
Jean Joslin  
Eric and Steffi Karp  
Patricia Keene  
Eric Kelly  
Chris Kidger  
Janice King  
Richard and Dana Klepper  
Andrew Koblenz  
Bernie and Susan Kosberg  
Robert Kraftowitz and Janice Gordon  
Tom Lanzarone and Kerri Meredith  
Sarah Lee  
Joyce Leonard  
Barry and Susan Levant  
Christine Leventhal  
Shu and Ping Li  
Curtis Linscott  
Celia Lisman  
Hudson Cook, LLP  
Jennifer Lobozzo +  
Mike and Melissa Lojek  
Robert Loscialpo  
Brian Lowit '93  
Dennis and Elaine Lundgren  
Don and Gigi MacMillan '82 +++  
Anthony and Marilyn Malone  
Robin Markell  
Ari Marom '09  
Lannie Martini '92  
Charles Masse  
Daniel May  
Verna Mayo '74  
Aaron Willey and Kelly McConnell  
Patrick McCrann '05

Medtronic  
Kevin Millman '93  
Kully Mindemann and Wendy Hill  
Mary Mindess  
Alexy Mitchell  
Justine Modek  
Jason and Katherine Mondanaro  
Gisela Moore +++  
Dan Morgan  
Ethan Morrow '13  
Suzanne Munson  
Dan Murphy  
Craig Murray '83  
Tom and Anne Natale +  
New York Life Foundation  
Megan-Mack Nicholson  
Patricia Notarius  
Teresa Nuccio  
John O'Donnell  
Rick Page  
Dave Pappalardo  
Andrew Parasiliti  
Lydia Parnes  
David Patterson  
Marty and Merrill Pavane  
Dan and Ceil Payne  
Thomas Pearce  
Crystal Peltzer  
Aileen Peters  
Leela Pratt  
Susie and Gerald Racine  
Hengameh Rafii  
Sheila Ramer  
Joel Randazza  
Shannon Richards  
Richard Riddell  
Meryl Riscoe-Piserchia  
Rachel Ritvo  
Sarah Romac '04  
Paul and Alice Ronty  
Nancy Rosenfeld '82



Carol Rubenstein  
Barbara Sachs-Freeman  
Alan Saltzman  
Michael and Amy Schneeberger  
Paul Schneider +  
Schwab Charitable Gift Fund

Teresa Schwartz  
Carolyn Shanoff  
Yiren Shao '13  
Dan Sharrow and Lori Knack  
Lindsay Shaw  
Charles Shepard '71  
Ryan and Nirvana Sherman  
Mike and Roie Shields  
Peter and Lauren Showstead  
Diane Sieber  
Justin Siekierski  
Adrienne Skinner and Clay Gordon  
Amazon Smile  
Marc and Cherie Smith  
Randy and Katie Smith  
Barry and Amy Sobel  
Jessica Sofie '96  
Richard and Susan Spence +  
Jerry Stadtmueller and Cathy Luther  
Morgan Stanley  
Jeff and Stephanie Stern  
Greg Stern '00  
Susan Stiker  
Bill and Sara Stockwell  
Paul Stoller  
Brenda Talbot  
Spirit Realty Trust  
James Turman '82  
Sandy Turman '83 and Dot Robinson  
Nora Udell  
Cliff and Kathi van Voorhees  
Marilynn Vander Schaaf  
Lucy Wainaina  
David Wallace  
Pete Wallach '76

Jason Warnick '98 and Colleen  
Warnick ++  
Regina Warren  
David Polito and Maire Lee Webster  
Fern Weis  
Christian Grinschgl and Jennifer  
Wellde  
John Whipple  
Marian White  
Ken Wiegand '71 and Anne Downey  
Jim and Barbara Willey  
Sandra Wilmore  
Robert and Susan Wilson  
Alexandra Wollins  
Peter Wright '85 and Lisa Gill  
Chuck and Cynthia Wright  
Marc Yagjian  
Kate Yates  
Robert and Siobhan Zaniewski

#### **GIFTS IN KIND**

**Gifts of tangible personal property  
(such as artwork, collections,  
decorative items, automobiles,  
boats, etc.)**

Boston Whaler - Maureen Yoder



**In keeping with a long-standing Hyde tradition,  
100% of our faculty and staff gave to the Hyde  
Strong Annual Fund. We are eternally grateful for  
their generosity and the impact that they make  
each day in our community.**

*Symbols: \* deceased; years of consecutive giving*  
+ = 10+ years   ++ = 20+ years   +++ = 30+ years

# A New Way to Engage Students on the Maine Waterways!

*Rich Truluck '88, Associate Head of School*

We wish to extend our deepest gratitude to Dr. Maureen Yoder and the late Dr. John Yoder, who bestowed a 17-foot Boston Whaler to Hyde shortly after John's passing in October, 2019. They have both been long-time Hyde supporters, counting two children and two grandchildren among the alumni ranks.

John and Maureen were frequent participants in the WFLCs and John was a founding member of the Alumni Parent fly-fishing trips to Grand Lake Stream in Downeast Maine. His love for the outdoors, and fishing in particular, lives on in this incredible gift to the school. The boat gives the school maximum versatility to explore the rivers, lakes and oceans that surround the campus.

During the inaugural trips last summer and fall, over 30 students participated in sightseeing and seal watching trips down the Kennebec River to Fort Popham. Students learned about the local ecology and saw firsthand the beauty of the Maine coast; a highlight was fishing the famed Kennebec River striper run and experiencing the thrill of a singing reel! This special gift will enable students to explore the waterways of Maine for years to come and create lifelong memories.





## Corporations, Organizations and Foundations

Aegon Transamerica Foundation  
Alicia Nichols Fundraising Counsel  
Amazon Smile  
ASD  
Austin Community Foundation  
Bessemer National Gift Fund  
Davis Family Foundation  
Fidelity Brokerage Services LLC  
Fidelity Charitable Gift Fund  
Frankel Family Foundation  
Holton Surgical Consultancy LLC  
Hudson Cook, LLP  
J.P. Morgan Securities Charitable Giving Fund  
Jewish Communal Fund  
LPL Financial Foundation  
Marin Community Foundation  
MELMAC Education Foundation  
Morgan Stanley  
Nancy E. Barton Foundation  
Opaleye Management, Inc.  
Pechet Foundation  
Pitcairn  
Prince Charitable Trusts  
Princeton Area Community Foundation  
Resnick Family Foundation  
Schwab Charitable Fund  
Spirit Realty Trust  
The De Molina Family Foundation  
The Greater Cincinnati Foundation  
The Searles Family Foundation  
The Trident Foundation  
TIAA Cref  
United Way of Central and Northeastern Connecticut  
Vanguard Charitable Endowment Program  
William A. Hazel Family Foundation

## In Memory Gifts

### **In Memory of Paul W. Hurd II**

*H. Hunt Bradley III  
Jesse Grant  
Georgia Hurd  
Meredith Hurd  
Zach Hurd*

### **In Memory of Paul and Blanche Gauld**

*Laurie Hurd*

### **In Memory of Michael Noonan**

*Joan Bellsey  
Susan Craig  
Hudson Cook, LLP  
Lisa DeLessio  
Curtis Linscott  
Jean Noonan  
Carolyn Shanoff  
Lindsay Shaw  
Teresa Schwartz*

### **In Memory of Rob Schuller**

*Lavoe Davis  
Dakin Feris  
Alan Saltzman  
Barbara Schuller*

### **In Memory of Adell Turentine**

*Gerald Bell*

### **In Memory of Jennifer K. Buhler**

*Dan Murphy*

### **In Memory of Mike Dawes**

*Will Cutrer*

### **In Memory of Dave Barr**

*Nelson Arnstein*

### **In Memory of Gary Kent**

*Peter Wallach*

### **In Memory of Marissa Borsani**

*David and Julie Borsani*

### **In Memory of John Rogers Jennings**

*Jeffrey Jennings*

### **In Memory of Tom and Margaret Ann Larsen and Quent and Jennette Garman**

*William and Sallie Larsen*

### **In Memory of Aaron, LeliaMae, Gladys, and Stanley**

*Vena Mayo*

### **In Memory of Todd Kern**

*Gregory Stern*

# HAPA ~ Always a part of the Hyde Family, keeping us strong and moving forward. THANK YOU!

We wish to extend our heartfelt gratitude to our current parents and HAPA who gave their precious time and helped our community keep moving forward through our Family Education programs this fall.

We could not create the full Hyde experience without your love and support.

Your impact is immeasurable.

Happy  
To Do It!

## Leadership Parents

Jennifer Blackstone  
Phillipa Cully  
Sharon Goldhirsch  
Jay Hawkins  
Shannon Hirsch  
John Huettel  
Kathy Huettel  
LeeAnn James  
Becky Jarrett  
Scott Kaplan  
Katherine Mondanaro  
Day Newburg  
Karen Primak  
Kirstie Truluck  
Jennifer Welde

## HAPAs

Judith Castor  
Richard Curran  
Earl Geertgens  
Elly Goldman  
Evelyn Hammond  
Pam Hardy  
Luc Levensohn  
Chuck Masse  
Tom Moore  
Ed Murphy  
Linda Murphy  
John Schleining  
Mark Thiel  
Fern Weis  
Maureen Yoder





# WE REACHED OUT. YOUR HEARTS ANSWERED. THANK YOU!

In early spring, **The Hyde Family Fund** was established to provide and opportunity for those families to receive assistance who needed it most. For the last two months of school, Head of School Laura Gauld contributed 20% of her salary, faculty and staff made sacrifices with the elimination of the match to their retirement plans, and the families below went the distance with their generosity!

Each family received a credit proportionate to the net tuition they paid for the 2019-2020 year with a few options, which included giving this amount to support those in our community facing more extreme challenges.

As Johann Wolfgang Von Goethe said, *"Talent is nurtured in solitude; character is formed in the stormy billows of the world."* Through the generosity of the **The Hyde Family Fund Donors**, we were **\$18,844.00** stronger through the storm.

*Barry and Stephanie Bricken  
Tom and Kelly Carey  
Bryan Farney  
Daniel Georges and Rumiko Tsuda  
CJ and Jane Fraleigh  
John and Kathy Huettel  
Beckie Jarrett  
Jason and Katherine Mondanaro  
Christina Neal  
Adam and Rachel Paley  
Paul and Stephanie Peck*



# In Honor Gifts

## **In Honor of Sam Teixeira**

*Alison Fife*

## **In Honor of Ethan Aaronson**

*Robert Aaronson*

## **In Honor of Jackie Alpern**

*Nadine Alpern*

## **In Honor of Mark Duethorn**

*Nick Davis*

## **In Honor of Ashlyn Buell**

*Jennifer Buell*

## **In Honor of Lori Cooke**

*Philippa Cully*

## **In Honor of Laura Leonard**

*Joyce Leonard*

## **In Honor of Michael Barney**

*Mary Hobert*

## **In Honor of Julie & David Samber**

*Adrienne Skinner*

## **In Honor of Zachary Gallagher**

*Sean Gallagher*

## **In Honor of the Hyde Teachers & Staff**

*Valarie Carnevale*

*Alexy Mitchell*

*Karen Platte*

*Peter Proach*

## **In Honor of Catherine Gushue**

*Jack Gushue*

## **In Honor of Nick Pratt Mandelstein & Naomi Morenzoni**

*Leela Pratt*

## **In Honor of Sean Condon**

*Diane Sieber*

## **In Honor of Laura Gauld & Bob Felt**

*Andrew Parasiliti*

## **In Honor of the Stern Family**

*Jeff and Stephanie Stern*

## **In Honor of Paul Fixler**

*Nina Fixler*

## **In Honor of Gerald Herihy**

*Nelson Arnstein*

## **In Honor of Troy Rockrise**

*Debra Baker and Peter Rockrise*

## **In Honor of Christopher “Jake” Foy**

*Noel and Chris Foy*

## **In Honor of Jeannie Most**

*Lannie Martini*

## **In Honor of Jeff Kent**

*Charles & Cynthia Wright*

## **In Honor of Dassou Ndiaye**

*John Rigney*

## **In Honor of Casey Mercer**

*Nanette Taller*

## **In Honor of Joseph Gauld**

*Jeffrey Jennings*

## **In Honor of Stephanie Thiel**

*Mark Thiel*



# Sumner Hawley Society



The Sumner Hawley Society recognizes those forward thinkers who have planned for Hyde's future with gifts in their wills, charitable trusts, real estate and retirement plan assets. These gifts are an expression of confidence both in Hyde's mission and its leadership. We are delighted to honor those who have made Hyde a priority in their estate planning.

**Ann Altman\***

Robert Altman '99 (grandchild)

**Charles and Karen Aring**

Charles Aring '99  
Gretchen Aring '02

**Donald and Nancy Baldwin**

Blake Matheny '98  
Tyler Matheny '00  
Weston Matheny '02

**Michael and Margo Ballew**

Travis Ballew '01\*

**Gloria Barnes****David Boone and Jacki Hinton**

Aaron Hinton '98

**Ron Briggs and Laura Brooks**

Mary Grace Mitchell '14

**Robert J. Buckla****Steven Cole and Adele Blong**

Robert Cole '02

**Nancy Coyne**

Sarah Poloszczak '06

**Lavoe Davis**

Edward Davis '90

**Michael\* and Lynn Dawes**

Michael V. Dawes, Jr. '92

**Kenneth DeAngelis**

Ross DeAngelis '04  
Simone DeAngelis '10  
Madeline Moritz '10

**Paul Downey**

Jessica Downey '03

**Randall Eaton**

Meghan '06

**Bob '90 and Brooke Felt**

Cooper Felt '19  
Eli Felt '22

**Christopher and Noel Foy**

Christopher Foy '06

**Larry French**

Todd French '89\*

**Ron Friedman and Sally Christian**

James Lorenz '01

**George and Susan Frost**

Scott Frost '94  
Jonathan Frost '96

**Joe Gauld**

Malcolm Gauld '72  
Mahalia Gauld '08 (grandchild)  
Scout Gauld '10 (grandchild)  
Laurie Gauld Hurd '75  
Zach Hurd '99 (grandchild)  
Georgia Hurd '03 (grandchild)

**Meddy Hurd '04 (grandchild)**

Georgia Gauld MacMillan '82  
Kayla Berry '07 (grandchild)  
Hannah MacMillan '10 (grandchild)  
Wilson MacMillan '14 (grandchild)

**Tom Gauld\***

Doug Gauld '73  
David Gauld '74  
Pam Eveland '79  
Zachary Eveland '11 (grandchild)

**Ken '72 and Claire '75 Grant**

Sarah Grant '00  
Jesse Grant '03  
Lauren Grant '05

**John Hartman\***

Raymond Hartman '75

**Bob Henson and Melissa Koerner**

Christopher Henson '01

**Rick and Jody Howard**

Katrina Howard '90  
Eben Howard '92  
James Howard '14 (grandchild)

**JC Labowitz and Patti Rounsevell**

Ethan Labowitz '03  
Susanna Labowitz '08

**Peter and Catherine Lawler**

Patrick Lawler '08

**Michael and Melissa Lojek**

Andrei Lojek '05

**Ron Lykins and Joan Perry**

Michael Lykins '98  
Sean Lykins '00

**Paul and Tara MacMahon**

Timothy MacMahon '95  
Julia MacMahon '01  
Lisa Schuchmann '01  
Kerri Porter '02

**Lee Mortenson and Carol Kirkland**

Leia Mortenson '03

**Ann Peden****Robert and Noelle Rainer**

Sara Rainer '09

**Martha Roynon\***

Robin Roynon '68\*

**Mike Rugala and Kathy Sibert**

Andrew Rugala '07

**Michael and Janice Schiffman**

Matt Schiffman '05

**Paul Schneider**

Alexander Schneider '01\*

**Patrick Slattery\***

Joseph Slattery '72\*

\* deceased





we are hyde.

**Dianne Snedaker**

*Jonathan Snedaker '99*

**Gerry Snedaker**

*Jonathan Snedaker '99*

**Daniel and Mimi Sullivan**

*Daniel Sullivan '04*

**Clay and Judee von Seldeneck**

*Roddy von Seldeneck '96*

*Kevin von Seldeneck '97*

**Martin and Sally Weinrich**

*Kimberly Powers Barbee '94*

**Dick and Nancy Wright**

*Rick Wright '79*

**John\* and Maureen Yoder**

*Michael Yoder '95*

*Alison Yoder '99*

*Mary Yoder '14 (grandchild)*

*Eric Yoder '18 (grandchild)*

**Lisa Young**

*Ashley Young '05*

**Sanford Young**

*Ashley Young '05*

**Sam Zolten and Ruth Estrich**

*Dorian de Tappan '05*

*Joshua Zolten '08*

\* deceased







# Ways To Give

The Hyde Strong Annual Fund provides immediate budget relief and supports the areas of greatest need, from athletics, to student activities, community service projects, faculty and staff salaries, materials and supplies, and more. The Hyde experience is fully supported by the Hyde Strong Annual Fund.

Your gift to the Hyde Strong Annual Fund:

- Provides financial aid to support the economic backgrounds of a diverse student body to afford them with the opportunity to experience a Hyde education.
- Supports Hyde's character building and family education programs, providing unique opportunities for personal growth and transformation.
- Ensures that our athletes and performing and visual art students have the supplies, equipment, and materials needed while playing, performing, and creating.
- Maintains and improves campus facilities so that our students and employees are provided with a quality environment in which to live, learn, and play.

[hyde.edu/giving](https://hyde.edu/giving)



## **CASH, CHECKS, AND CREDIT CARD GIFTS**

Hyde accepts gifts made as cash, through a valid checking account or by means of a credit or debit card.

## **MATCHING CORPORATE GIFTS**

Hyde welcomes gifts that are matched by donors' employers. The matching gift will be consistent with the purpose of the Hyde donor's gift (usually the Hyde Strong Annual Fund), and they will be credited to the employer's corporate entity with a soft credit to the generating Hyde donor.

## **GIFTS IN KIND**

Gifts of tangible personal property (such as artwork, collections, decorative items, automobiles, boats, etc.) or other gifts in kind may be accepted by Hyde provided that they meet approved needs of the School and do not place an undue burden on the School in terms of their use or maintenance. Hyde strongly suggests that donors consult with their tax advisors whenever considering a gift of this kind. Hyde reserves the right to dispose of any tangible personal property that has been donated, unless otherwise documented.

## **STOCKS OR SECURITIES**

Gifts of appreciated property in the form of publicly traded stock are accepted by Hyde through one of the School's brokerage accounts. Donors are urged to contact the School ahead of the electronic transfer to assure proper application and recording of their gift. Securities transferred by other means, either through the mail or hand delivered, will be treated as transferred on the date that the School takes possession of the securities.

## **PLANNED GIFTS**

Make a legacy gift commitment. Join the Sumner Hawley giving society by declaring your intention to make a planned gift. You can make a bequest to Hyde in your estate plan. We offer a variety of options and the opportunity to leave a lasting gift to support the sustainability of a Hyde education for generations to come.



**Hyde School  
616 High Street  
Bath, ME 04530  
207.386.5200**

**hyde.edu**