



New Rosemont Elementary

Troup County School System

Southern A&E
architects & engineers LLC



T C S S
Troup County School System
Your Future Starts Today

Floor Plan

116,010 sf Total
56 Full Classrooms
6 Half Classrooms

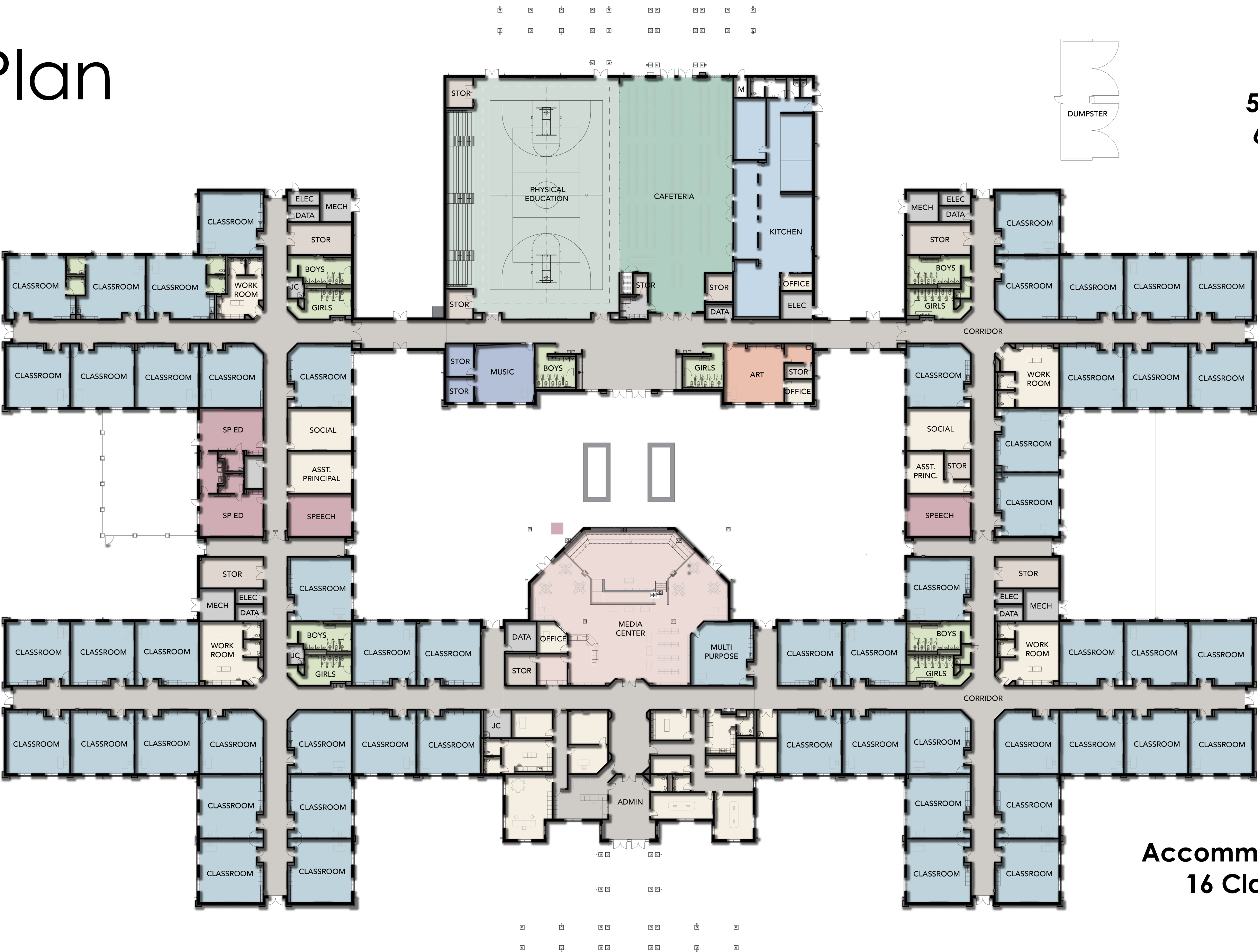

Accommodations for up to
16 Classroom Additions

Site Plan

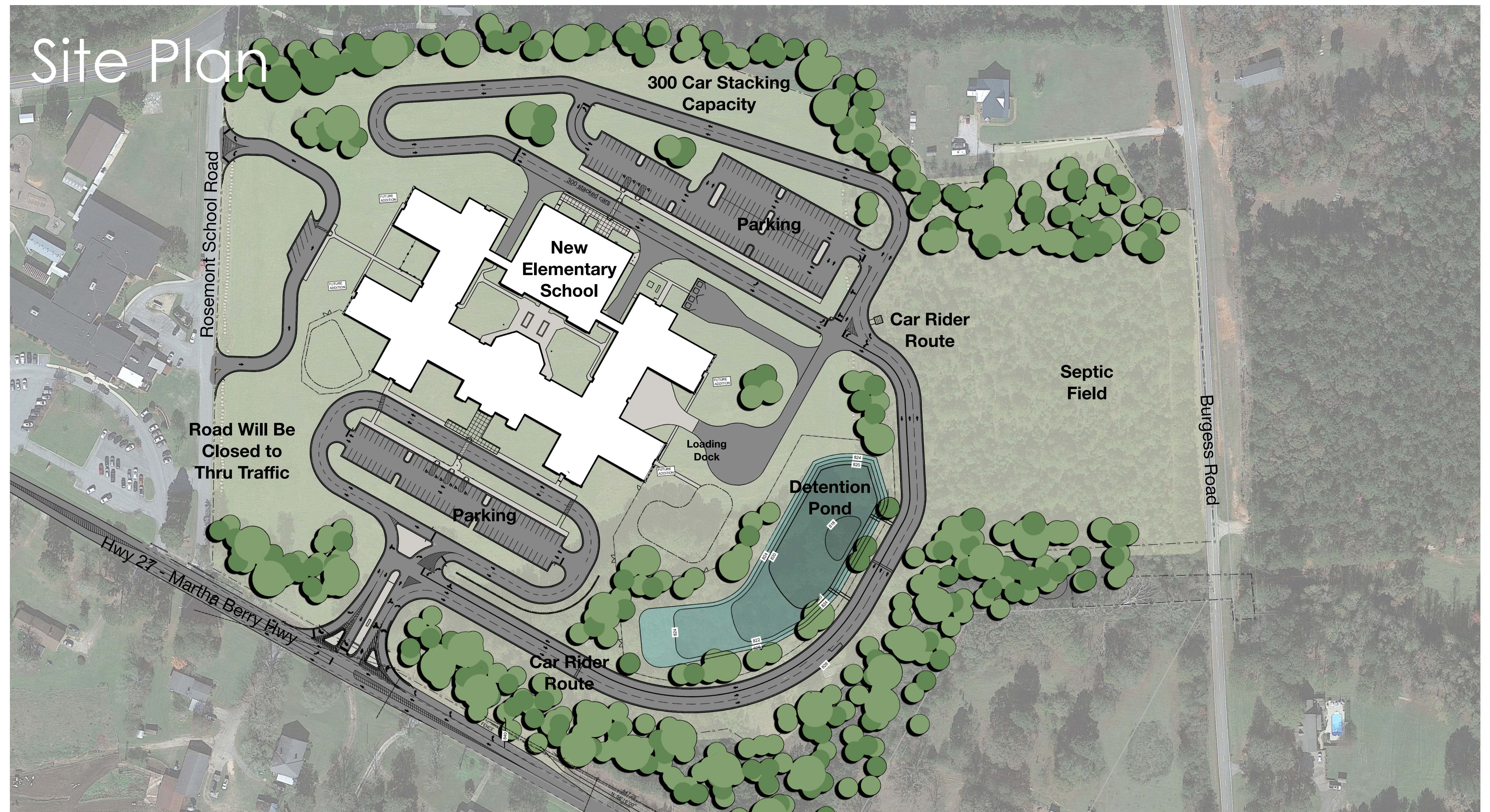

Project Construction Costs

Work Categories Subtotal \$ 32,957,156.68

Project Allowances

Installation of Emergency Radio System	\$ 90,404.25
Septic System	\$ 1,273,000.00
Price Escalation/Inflation	\$ 766,766.00
Owner’s Contingency	\$ 2,500,000.00

Accepted Alternates

HVAC Controls Monitoring & Integration	\$ 80,000.00
--	--------------

Construction Management Fees

General Conditions	\$ 652,537.00
OH&P (1.5%)	\$ 574,797.96

Construction GMP TOTAL \$ 38,894,661.89

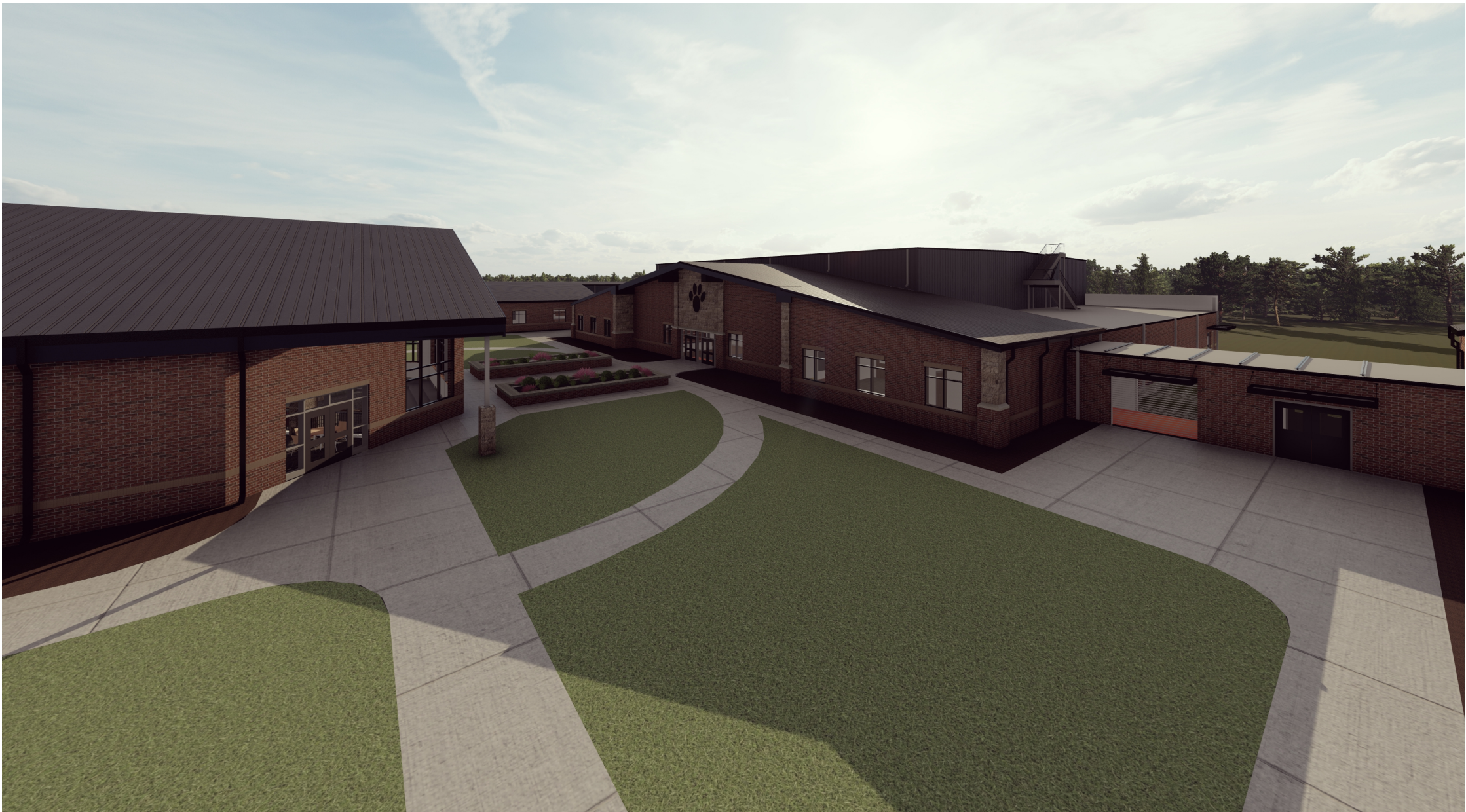

Milestones

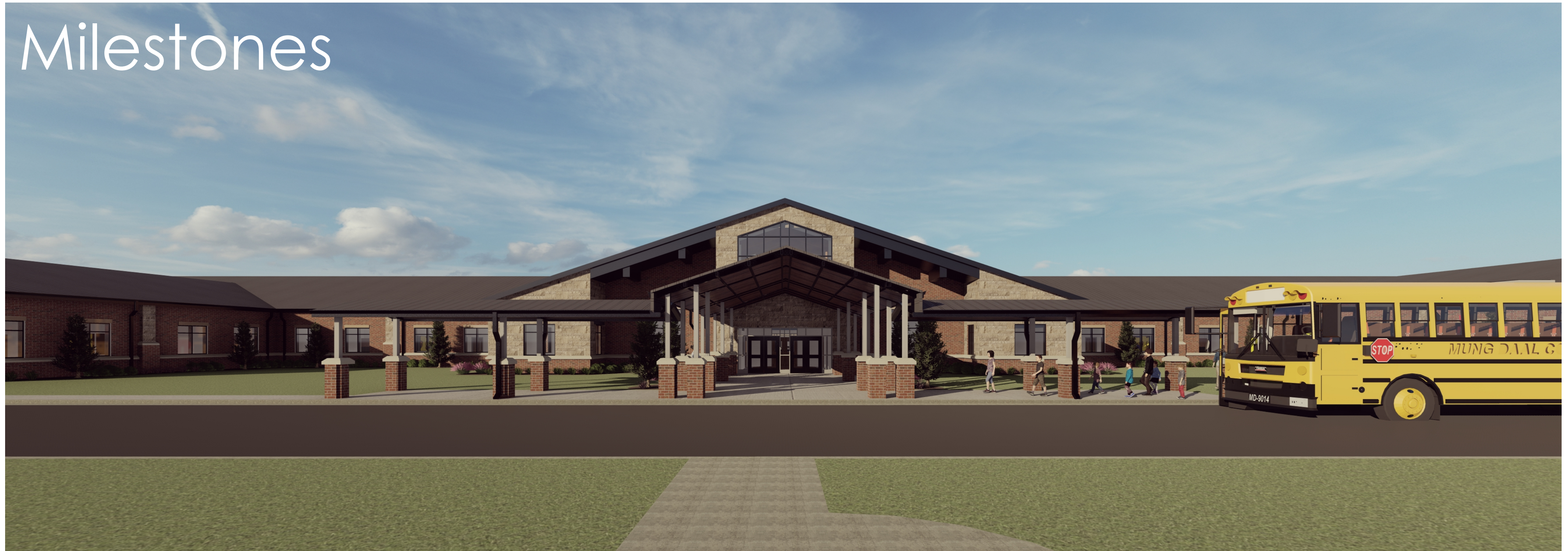

January 2023 - Begin Land Clearing

March 2023 - Begin Building Foundations

May 2023 - Begin Structural Steel Erection

August 2023 - Begin Masonry Walls

October 2023 - Begin Roofing

March 2024 - Begin Asphalt Paving

April 2024 - Begin Landscaping

July 2024 - Substantial Completion



Discussion