



Highline Public Schools Board Action Report

DATE: 2/03/2023

FROM: Dr. Ivan Duran, Superintendent

LEAD STAFF: Scott Logan, Chief Operations Officer; Sidney White, Facilities Director

For Introduction: February 15, 2023

For Action: February 15, 2023

I. TITLE Motion to Approve New Contract and PO for Northwest Playgrounds for 2022-23 SY

Select one: ☒ New Item ☐ Renewed Item ☐ Annual Item ☐ Revised Item

II. WHY BOARD ACTION IS NECESSARY

Pursuant to Procedure 6225 - Approval of Contracts, requires School Board approval for all contracts of \$250,000.00 or more.

III. BACKGROUND INFORMATION

In Fall 2021, 25 members of Highline's community, including students, families, and staff, convened to create Highline's first Committee for Allocating Resources Equitably (CARE). The committee generated recommendations for how the district should spend an allocation of COVID relief funds in Highline Public Schools. One of the recommendations of the committee was that Highline invest in infrastructure improvements to support all students in building relationships, strengthening their social-emotional skills, and developing life-long habits around mindfulness and play.

A part of realizing this recommendation was to replace or upgrade playground equipment to provide all students with ADA accessible, OSHA compliant, and skill enhancing play structures that bring students together to build inclusive communities and ensure that every elementary student has access to a safe, hazard free playing area. In April 2022, the CARE committee initiative was organized into two project phases, Playground Structure Replacement (phase I), and Playground Structure Maintenance (phase II), with a goal completion date of August 2023, and an approval of ESSER funding of up to 1,251,000.00.

In September 2022, Clear Risk Solutions and the Facilities Department assessed all district playgrounds for compliance, needed repair, and replacement. It was determined that Beverly Park, Hilltop, Madrona, and Seahurst ES would receive all new play structures, as Phase I Playground Structure Replacement. Further, it was determined that Bow Lake, Cedar Hurst, Gregory Heights, Hazel Valley, McMicken, Midway, Mount View, Shorewood, and Southern Heights would require repair and maintenance, as Phase II Playground Structure Maintenance.

In November 2022, Facilities began working with Northwest Playgrounds, a KCDA vendor, on quotes to complete Phase I and II of the playground replacement and maintenance project. Final proposals were received by the Facilities Department on February 3rd, 2023, totaling to \$667,062.15 for Phase I, and \$159,327.69 for Phase II. Due to six-month lead times in delivery of playground equipment, the PO must be processed no later than mid-February to receive the playground equipment and begin installation in July 2023.

Procedures have been identified and addressed, that caused delays in assessing playground equipment, and connecting with vendors in a timely manner. Facilities staff are requesting intro and action at the School Board Meeting on February 15, to remain on track for completion of the playground upgrades project before the start of the 2023-24 SY.

IV. RECOMMENDED MOTION

I move that the Highline School Board approve the contract with Northwest Playgrounds and PO for \$826,389.84 for district playground equipment replacement, upgrades, and maintenance, as recommended by the 2021-22 CARE Committee.

V. FISCAL IMPACT/REVENUE SOURCE

Total Fiscal impact of this action is \$826,389.84.

The revenue source for this motion is ESSER - CARE fund, program 1305.

Expenditure: ☒ One-time ☐ Annual

VI. APPLICABLE POLICY(S)

This action is in compliance with the following:

VII. ALTERNATIVES

If this contract is not approved with Northwest Playgrounds, who is a member of a purchasing coop (KCDA), the district will need to spend addition time and money going through the procurement (bid) process. In addition, purchasing through Northwest Playgrounds (KCDA), will expedite the delivery of the purchase and help us meet our goal of installing the equipment before the 2023-24 SY.

VIII. COMMUNITY ENGAGEMENT

Community Engagement Required: ☒ Yes ☐ No

25 members of the Highline Community including students, families, and staff.

IX. ATTACHMENTS

1. Beverly Park ES Playground Replacement - Final Proposal Phase I (for approval)
2. Madrona ES Playground Replacement - Final Proposal Phase I (for approval)
3. Hilltop ES Playground Replacement - Final Proposal Phase I (for approval)
4. Seahurst ES Playground Replacement - Final Proposal Phase I (for approval)
5. Districtwide Playground Structure Maintenance - Final Proposal Phase II (for approval)



Northwest Playground Equipment, Inc.

PO Box 2410, Issaquah, WA 98027-0109

Phone (425) 313-9161 FAX (425)313-9194

Email: sales@nwplayground.com

QUOTE

Quote # AM-1252023-00001608

To: Highline School District.

Date: 01-25-2023

Re: Highline SD - Beverly Park ES (2022)

Quote Name: Highline SD - Beverly Park ES

Bill To: 15675 Ambaum Boulevard Southwest
Burien, WA 98166

Site Address: 1201 S 104th St, Seattle, WA 98168

Name: Sid White
Email: sidney.white@highlineschools.org

Phone: 206 631-3000
Cell:

Item #	Qty	Description	Price	Total Price
--------	-----	-------------	-------	-------------

EQUIPMENT

Playworld

IHD-Playworld	1	NW091219-3 - Playworld Systems Challenger Structure, Equipment Including; Square Coated Deck Assembly, Glide Slide (48in Deck), Find the Way Home Panel, Accessible Driving Panel, Spin Racer Panel, Store Front Panel, CH Panel Frame - Ground Level, Very Buried Insert, Rock Climber, and Transfer Station W/ Approach Step.	\$18,256.00	\$18,256.00
ZZXX0343	1	Balance Trax Dunes	\$1,925.00	\$1,925.00
ZZXX0341	2	Balance Trax Pond	\$475.00	\$950.00

sofSURFACES

Tiles	1	1221 Square Feet of DuraSAFE Premium Plus Safety Surfacing Tiles. Tiles are 2.25" Thick, Good for a Critical Fall Height of 4'. Tiles Quoted are to be Installed on a Asphalt Sub Base (Sub Base Not Included).	\$11,865.00	\$11,865.00
-------	---	---	-------------	-------------

Equipment Subtotal (less tax): \$32,996.00

CONTRACT DISCOUNT

Playworld	KCDA - King County Directors Association Discount: BID #22-315	10%	(\$2,113.10)
SofSurfaces	KCDA - King County Directors Association Discount: BID #22-315	6%	(\$711.90)

FREIGHT

sofSURFACES	Freight	\$5,240.00
Playworld	Freight	\$6,110.00
Equipment Total (less tax):		\$41,521.00

CERTIFIED INSTALLATION

Playground Installation	1	Deluxe Installation of Listed Playworld Systems Equipment <i>Please Note that the Customer is Responsible for Verifying Quantities and Descriptions. Customer is Responsible for all Permits or Fees. Quote doesn't include Site Prep</i>	\$15,300.00	\$15,300.00
-------------------------	---	--	-------------	-------------



Northwest Playground Equipment, Inc.

PO Box 2410, Issaquah, WA 98027-0109

Phone (425) 313-9161 FAX (425)313-9194

Email: sales@nwplayground.com

Tile Installation	1	Deluxe Installation of Above Tile Materials Over Asphalt Sub Base. Includes Compressed Tile Installation, All Required Cutting and Edging, Offloading of Materials On Site and Disposal of Packaging. Sub-Base BY OTHERS	\$6,155.00	\$6,155.00
Site Prep	1	1,829 Square Feet of Area for Site Preparation. Remove and Dispose of Existing Play Equipment in Proposed Area (7 Footings). Remove & Dispose of Existing Border Timbers. Excavate Area to a Depth of 6" Removal of Existing EWF. Asphalt to be Laid by Others. <i>(Please Note: Costing Could Vary Based Upon Site Prep Needs)</i>	\$39,500.00	\$39,500.00
Paving	1	Pave 1,830 SF at 2.5" Asphalt, Up to 28 Tons & 4" Rock, Up to 45 Tons. Subgrade to be Done by Others to A+/- 1/10% Grade. Finish Grate with 4" Crushed Rock, Compact, Pave with 2.5" of Class 1/2" HMA. Tamp Edges As Needed.	\$54,870.00	\$54,870.00
Fencing	1	Installation and Materials for 118' of 3' Tall All Black Chainlink Fencing with Gates	\$16,125.00	\$16,125.00

			Installation Total:	<u>\$131,950.00</u>
Performance Bond (If Required):			3.0%	
Credit Card Fee (If Required):			3.5%	
Location Code: 1700	Resale Certificate Required for Tax Exemption:	Tax:	10.10%	<u>\$17,520.57</u>
			ORDER TOTAL:	<u><u>\$190,991.57</u></u>

Acceptance of Proposal:

(Please be sure you have read, signed, initialed and understand the Terms and Conditions on Page 2 of this Quote)

The items, prices and conditions listed herein are satisfactory and are hereby accepted.

Alexis Madrigal
Sales Rep

Customer Signature

Date



Northwest Playground Equipment, Inc.

PO Box 2410, Issaquah, WA 98027-0109

Phone (425) 313-9161 FAX (425)313-9194

Email: sales@nwplayground.com

Project Name: Highline SD - Beverly Park ES (2022)

Quote # AM-1252023-00001608

TERMS AND CONDITIONS

QUOTE CONDITIONS AND ACCEPTANCE:

This quote is only valid for 10 days.

Orders placed or requested for delivery after 10 days are subject to Steel and Material price increases and Surcharges.

*** (Pls Initial) It is the Buyer's responsibility to verify quantities and description of items quoted.

Once your order has been placed, any changes including additions, deletions or color changes, will delay your shipment.

EXCLUSIONS: Unless specified, this quote specifically **excludes** all of the following:

Required Permits; Davis Bacon, Certified Payroll or Prevailing Wage fees

Performance/Payment Bonds

Site work and landscaping

Removal of existing equipment

Unloading; Receiving of inventory or equipment; Storage of equipment

Equipment assembly and/or installation

Safety surfacing; Borders or drainage requirements

Landscaping Repairs DUE to poor access or in climatic weather

FREIGHT AND DELIVERY:

Shipping is FOB Origin. A 24-hr Call Ahead is available at additional cost.

Delivery is currently 5+ weeks after order submittal. Unless otherwise noted, all equipment is delivered unassembled.

*** (Pls Initial) **Buyer is responsible to meet and provide a minimum of 2 ADULTS to unload truck**

A Check List, detailing all items shipped, will be mailed to you and a copy will be included with the shipment.

Buyer is responsible for ensuring the Sales Order and Item Numbers on all boxes and pieces match the Check List.

*** (Pls Initial) Shortages or damages must be noted on the driver's delivery receipt. Shortages or damages not noted become the buyers financial responsibility.

Damaged Freight must be refused. Please notify Northwest Playground Equipment immediately of any damages.

Shortages and Concealed Damage must be reported to Northwest Playground Equipment within 10 days of delivery.

A reconsignment fee will be charged for any changes made to delivery address after order has been placed.

TAXES:

All orders delivering in Washington are subject to applicable sales tax unless a tax exemption or Reseller Permit is on file at the time the order is placed.

PAYMENT TERMS: An approved Credit Application is required for new customers. 50% down payment is due at time of order with balance due upon delivery, unless other credit terms have been approved. Interest may be charged on past due balances at an annual rate of 18%. A 3% charge will be added to all credit card orders.

RESTOCKING: Items canceled, returned or refused will be subject to a minimum 25% restocking fee. All return freight charges are the responsibility of the Buyer.

MAINTENANCE/WARRANTY:

Manufacturer's standard product warranties apply and cover equipment replacement and freight costs only; labor is not included. Northwest Playground Equipment offers no additional warranties.

Maintenance of the equipment and safety surfacing is the responsibility of the customer.

Any unauthorized alterations or modifications to the equipment (including layout) will void your warranty.

INSTALLATION: (if applicable)

A private locate service for underground utilities must be completed before your scheduled installation.

Site must be level and free of loose debris (this includes ground cover/chips).

A minimum 6 foot opening with good access must be available to the site for delivery trucks and tractor.

An onsite dumpster must be provided for disposal of packaging materials.

Arrangements must be made in advance for the disposal of dirt/rocks from within the installation area.

Arrangements must be made in advance for the removal/disposal of existing equipment.

Additional charges may apply if large rocks or concrete are found beneath the surface.

Access to power and water must be available.

Site supervision is quoted in 8-hour days.

Acceptance of Terms & Conditions:

Acceptance of this proposal, made by an authorized agent of your company, indicates agreement to the above terms and conditions.

Alexis Madrigal

Sales Rep

Customer Signature

Date



MADRONA ES



HD_303_22R1 Color Option : A

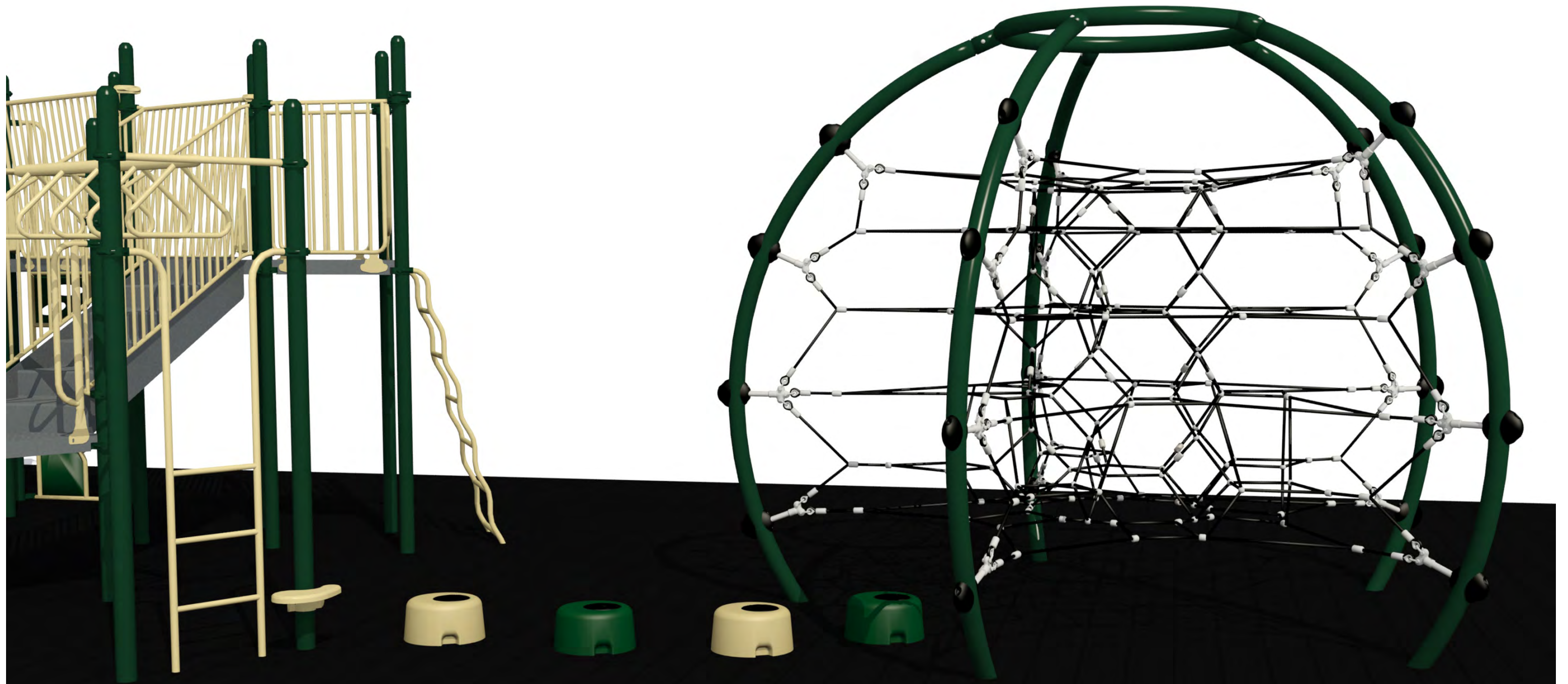

MADRONA ES

 Northwest Playground
EQUIPMENT INC.

 **PLAYWORLD**
The world needs play.

HD_303_22R1

Color Option : A



MADRONA ES

 Northwest Playground
EQUIPMENT INC.

 **PLAYWORLD**
The world needs play.

HD_303_22R1

Color Option : A

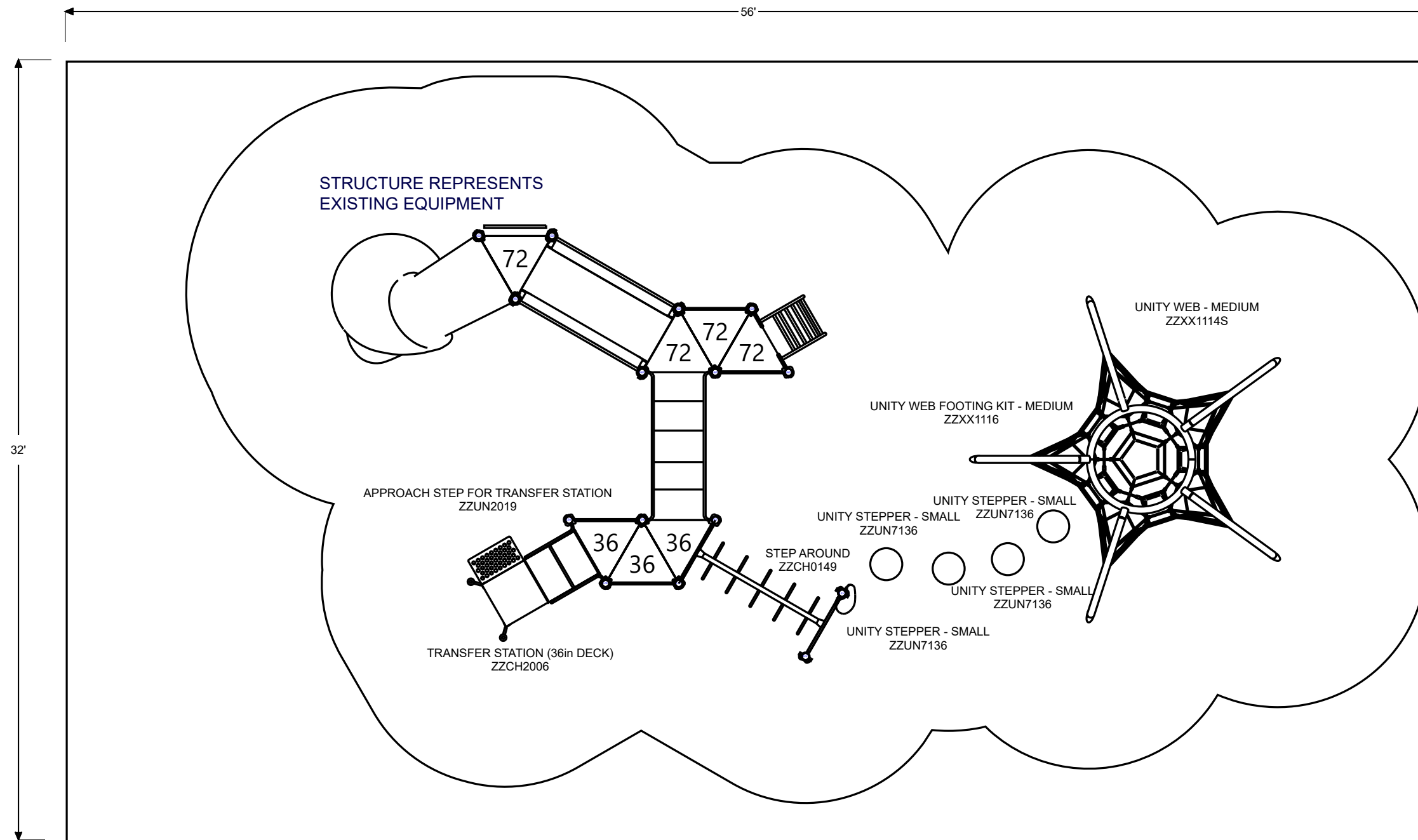

TILE AREA = 1,792 sq. ft

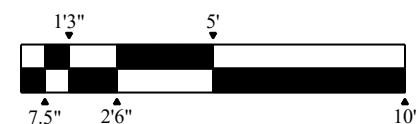

ASTM
F1487-

USERS: 57

AGES
5-12

PLAYWORLD
The world needs play.

51'-0" x 30'-0" 40'-0" x 20'-0"

Madrona ES

PROJECT NO: W-NW_44734593228	REV:	DATE: 6/21/2022
SYSTEM: IHD_303_22R1		SCALE: 1"=5'0"
STRUCTURE PLAN		DRAWN BY: Zach Morgan

**Northwest Playground
Equipment, Inc.**

BUILDING COMMUNITY THROUGH PLAY

P.O. Box 2410 Issaquah, WA 98027
Toll Free: 1.800.726.0031
www.nwplayground.com
sales@nwplayground.com



Northwest Playground Equipment, Inc.

PO Box 2410, Issaquah, WA 98027-0109

Phone (425) 313-9161 FAX (425)313-9194

Email: sales@nwplayground.com

QUOTE

Quote # AM-1252023-00001609

To: Highline School District.

Date: 01-25-2023

Re: Highline SD - Madrona ES (2022)

Quote Name: Highline SD - Madrona ES

Bill To: 15675 Ambaum Boulevard Southwest
Burien, WA 98166

Site Address: 20301 32nd Ave S, SeaTac, WA
98198

Name: Sid White
Email: sidney.white@highlineschools.org

Phone: 206 631-3000
Cell:

Item #	Qty	Description	Price	Total Price
--------	-----	-------------	-------	-------------

EQUIPMENT

Playworld

ZZXX1114S	1	Unity Web - Medium	\$20,829.00	\$20,829.00
IHD-Playworld	1	IHD_303_22R1 - Playworld Equipment Including: Stepper Around, Unity Steppers and Transfer Station with Step.	\$5,153.00	\$5,153.00
ZZXX1116	1	Unity Web Footing Kit - Medium	\$1,169.00	\$1,169.00

sofSURFACES

Tiles	1	10 DuraSAFE Premium Plus Safety Surfacing Tiles. Tiles are 2.25" Thick, Good for a Critical Fall Height of 4'. Tiles Quoted are to be Installed on an Asphalt Sub Base (Sub Base Not Included).	\$300.00	\$300.00
-------	---	---	----------	----------

Equipment Subtotal (less tax): \$27,451.00

CONTRACT DISCOUNT

Playworld	KCDA - King County Directors Association Discount: BID #22-315	10%	(\$2,715.10)
SofSurfaces	KCDA - King County Directors Association Discount: BID #22-315	6%	(\$18.00)

FREIGHT

Playworld	Freight	\$2,355.00
sofSURFACES	Freight	\$660.00

Equipment Total (less tax): \$27,732.90

CERTIFIED INSTALLATION

Playground Installation	1	Deluxe Installation of Listed Playworld Systems Equipment and Sofsurfaces Safety Tile.	\$14,850.00	\$14,850.00
-------------------------	---	--	-------------	-------------

Please Note that the Customer is Responsible for Verifying Quantities and Descriptions.

Customer is Responsible for all Permits or Fees.

Quote doesn't include Site Prep

Installation Total: \$14,850.00

Performance Bond (If Required): 3.0%
Credit Card Fee (If Required): 3.5%



Northwest Playground Equipment, Inc.

PO Box 2410, Issaquah, WA 98027-0109

Phone (425) 313-9161 FAX (425)313-9194

Email: sales@nwplayground.com

Location Code: 1733

Resale Certificate Required for Tax Exemption:

Tax:

10.10%

\$4,300.87

ORDER TOTAL:

\$46,883.77

Acceptance of Proposal:

(Please be sure you have read, signed, initialed and understand the Terms and Conditions on Page 2 of this Quote)

The items, prices and conditions listed herein are satisfactory and are hereby accepted.

Alexis Madrigal

Sales Rep

Customer Signature

Date



Northwest Playground Equipment, Inc.

PO Box 2410, Issaquah, WA 98027-0109

Phone (425) 313-9161 FAX (425)313-9194

Email: sales@nwplayground.com

Project Name: Highline SD - Madrona ES (2022)

Quote # AM-1252023-00001609

TERMS AND CONDITIONS

QUOTE CONDITIONS AND ACCEPTANCE:

This quote is only valid for 10 days.

Orders placed or requested for delivery after 10 days are subject to Steel and Material price increases and Surcharges.

*** (Pls Initial) It is the Buyer's responsibility to verify quantities and description of items quoted.

Once your order has been placed, any changes including additions, deletions or color changes, will delay your shipment.

EXCLUSIONS: Unless specified, this quote specifically **excludes** all of the following:

Required Permits; Davis Bacon, Certified Payroll or Prevailing Wage fees

Performance/Payment Bonds

Site work and landscaping

Removal of existing equipment

Unloading; Receiving of inventory or equipment; Storage of equipment

Equipment assembly and/or installation

Safety surfacing; Borders or drainage requirements

Landscaping Repairs DUE to poor access or in climatic weather

FREIGHT AND DELIVERY:

Shipping is FOB Origin. A 24-hr Call Ahead is available at additional cost.

Delivery is currently 5+ weeks after order submittal. Unless otherwise noted, all equipment is delivered unassembled.

*** (Pls Initial) **Buyer is responsible to meet and provide a minimum of 2 ADULTS to unload truck**

A Check List, detailing all items shipped, will be mailed to you and a copy will be included with the shipment.

Buyer is responsible for ensuring the Sales Order and Item Numbers on all boxes and pieces match the Check List.

*** (Pls Initial) Shortages or damages must be noted on the driver's delivery receipt. Shortages or damages not noted become the buyers financial responsibility.

Damaged Freight must be refused. Please notify Northwest Playground Equipment immediately of any damages.

Shortages and Concealed Damage must be reported to Northwest Playground Equipment within 10 days of delivery.

A reconsignment fee will be charged for any changes made to delivery address after order has been placed.

TAXES:

All orders delivering in Washington are subject to applicable sales tax unless a tax exemption or Reseller Permit is on file at the time the order is placed.

PAYMENT TERMS: An approved Credit Application is required for new customers. 50% down payment is due at time of order with balance due upon delivery, unless other credit terms have been approved. Interest may be charged on past due balances at an annual rate of 18%. A 3% charge will be added to all credit card orders.

RESTOCKING: Items canceled, returned or refused will be subject to a minimum 25% restocking fee. All return freight charges are the responsibility of the Buyer.

MAINTENANCE/WARRANTY:

Manufacturer's standard product warranties apply and cover equipment replacement and freight costs only; labor is not included. Northwest Playground Equipment offers no additional warranties.

Maintenance of the equipment and safety surfacing is the responsibility of the customer.

Any unauthorized alterations or modifications to the equipment (including layout) will void your warranty.

INSTALLATION: (if applicable)

A private locate service for underground utilities must be completed before your scheduled installation.

Site must be level and free of loose debris (this includes ground cover/chips).

A minimum 6 foot opening with good access must be available to the site for delivery trucks and tractor.

An onsite dumpster must be provided for disposal of packaging materials.

Arrangements must be made in advance for the disposal of dirt/rocks from within the installation area.

Arrangements must be made in advance for the removal/disposal of existing equipment.

Additional charges may apply if large rocks or concrete are found beneath the surface.

Access to power and water must be available.

Site supervision is quoted in 8-hour days.

Acceptance of Terms & Conditions:

Acceptance of this proposal, made by an authorized agent of your company, indicates agreement to the above terms and conditions.

Alexis Madrigal

Sales Rep

Customer Signature

Date



HILLTOP ELEMENTARY
SCHOOL





HILLTOP ELEMENTARY
SCHOOL





HILLTOP ELEMENTARY
SCHOOL





HILLTOP ELEMENTARY
SCHOOL





HILLTOP ELEMENTARY
SCHOOL





HILLTOP ELEMENTARY
SCHOOL





Northwest Playground Equipment, Inc.

PO Box 2410, Issaquah, WA 98027-0109

Phone (425) 313-9161 FAX (425)313-9194

Email: sales@nwplayground.com

QUOTE

Quote # AM-1252023-00001610

To: Highline School District.

Date: 01-25-2023

Re: Highline SD - Hilltop ES (2022)

Quote Name: Highline SD - Hilltop ES

Bill To: 15675 Ambaum Boulevard Southwest
Burien, WA 98166

Site Address: 12250 24th Ave S, Seattle, WA 98168

Name: Sid White
Email: sidney.white@highlineschools.org

Phone: 206 631-3000
Cell:

Item #	Qty	Description	Price	Total Price
--------	-----	-------------	-------	-------------

EQUIPMENT

Playworld

IHD-Playworld	1	IHD_302_22 - Playworld Structure Including: Glide Slide, Nuvo 360 Slide, Spin Racer Panel, Telescope Pipe Wall Mount, A-MAZE-ING Insert, Step Around, Unity Steppers, Centerline Pipe Wall Barrier, Access Gate, Inclined Cliff Hanger, Silo Climber, Ribbon Climber, ModPods, The Vertical Wave, Chinning- Turning Bar, Leg Lift, 6' Horizontal Loop Ladder, Overhead Event Access Ladder and Transfer Station with Tall Guardrail and Step.	\$65,669.00	\$65,669.00
ZZXX1114S	1	Unity Web - Medium	\$20,829.00	\$20,829.00
ZZUN8731	1	Plastic Elevated Playcube	\$3,975.00	\$3,975.00
ZZXX0343	1	Balance Trax Dunes	\$1,925.00	\$1,925.00
ZZXX0345	2	Balance Trax Boomerang	\$1,589.00	\$3,178.00
ZZUN8762	3	Poly Climber - Large	\$1,299.00	\$3,897.00
ZZXX1116	1	Unity Web Footing Kit - Medium	\$1,169.00	\$1,169.00
ZZXX1020	1	Curved Balance Beam	\$765.00	\$765.00
ZZUN6854	1	Modpods Connector - 90 Degree	\$205.00	\$205.00
ZZUN6853	1	Modpods Connector - Quad To Tri Right	\$195.00	\$195.00

Zeager

Zeager Bros. EWF Supply	1	230 Cubic Yards of Zeager Bros. Certified Engineered Wood Fiber Safety Surfacing (12in After Compaction) for 4096 Square Feet. Price Includes Blower Installation. <i>NOTE: Semi-Truck Must Have Access to Unload Material On-Site. Typical Truck Size is 53' or Additional Charges May Apply</i>	\$10,180.00	\$10,180.00
----------------------------	---	--	-------------	-------------

Equipment Subtotal (less tax): \$158,952.00

CONTRACT DISCOUNT

Playworld	KCDA – King County Directors Association Discount: BID #22-315	10%	(\$10,180.70)
Zeager	KCDA – King County Directors Association Discount: BID #22-315	5%	(\$509.00)

FREIGHT

Zeager	Freight	\$3,170.00
Playworld	Freight	\$9,265.00

Equipment Total (less tax): \$160,697.30



Northwest Playground Equipment, Inc.

PO Box 2410, Issaquah, WA 98027-0109

Phone (425) 313-9161 FAX (425)313-9194

Email: sales@nwplayground.com

CERTIFIED INSTALLATION

Playground Installation	1	Deluxe Installation of Listed Playworld Systems Equipment <i>Please Note that the Customer is Responsible for Verifying Quantities and Descriptions. Customer is Responsible for all Permits or Fees. Quote doesn't include Site Prep</i>	\$43,510.00	\$43,510.00
Site Prep	1	Site Work to Include: Removal/ Disposal of Existing Equipment Removal/ Disposal of Existing EWF (12" Depth Estimated) <i>(Please Note: Costing Could Vary Based Upon Site Prep Needs)</i>	\$24,040.00	\$24,040.00
Site Prep	1	Installing Treated Lumber Borders around Perimeter of Site – 260 FT of Borders at 6" x 12"	\$22,925.00	\$22,925.00

			Installation Total:	<u>\$90,475.00</u>
Performance Bond (If Required):			3.0%	
Credit Card Fee (If Required):			3.5%	
Resale Certificate Required for Tax Exemption:	Tax:	10.10%	<u>\$20,624.94</u>	
			ORDER TOTAL:	<u><u>\$224,832.24</u></u>

Customer Signature

Date



Northwest Playground Equipment, Inc.

PO Box 2410, Issaquah, WA 98027-0109
Phone (425) 313-9161 FAX (425)313-9194
Email: sales@nwplayground.com

Project Name: Highline SD - Hilltop ES (2022)

Quote # AM-1252023-00001610

TERMS AND CONDITIONS

QUOTE CONDITIONS AND ACCEPTANCE:

This quote is only valid for 10 days.

Orders placed or requested for delivery after 10 days are subject to Steel and Material price increases and Surcharges.

*** (Pls Initial) It is the Buyer's responsibility to verify quantities and description of items quoted.

Once your order has been placed, any changes including additions, deletions or color changes, will delay your shipment.

EXCLUSIONS: Unless specified, this quote specifically **excludes** all of the following:

Required Permits; Davis Bacon, Certified Payroll or Prevailing Wage fees

Performance/Payment Bonds

Site work and landscaping

Removal of existing equipment

Unloading; Receiving of inventory or equipment; Storage of equipment

Equipment assembly and/or installation

Safety surfacing; Borders or drainage requirements

Landscaping Repairs DUE to poor access or in climatic weather

FREIGHT AND DELIVERY:

Shipping is FOB Origin. A 24-hr Call Ahead is available at additional cost.

Delivery is currently 5+ weeks after order submittal. Unless otherwise noted, all equipment is delivered unassembled.

*** (Pls Initial) **Buyer is responsible to meet and provide a minimum of 2 ADULTS to unload truck**

A Check List, detailing all items shipped, will be mailed to you and a copy will be included with the shipment.

Buyer is responsible for ensuring the Sales Order and Item Numbers on all boxes and pieces match the Check List.

*** (Pls Initial) Shortages or damages must be noted on the driver's delivery receipt. Shortages or damages not noted become the buyers financial responsibility.

Damaged Freight must be refused. Please notify Northwest Playground Equipment immediately of any damages.

Shortages and Concealed Damage must be reported to Northwest Playground Equipment within 10 days of delivery.

A reconsignment fee will be charged for any changes made to delivery address after order has been placed.

TAXES:

All orders delivering in Washington are subject to applicable sales tax unless a tax exemption or Reseller Permit is on file at the time the order is placed.

PAYMENT TERMS: An approved Credit Application is required for new customers. 50% down payment is due at time of order with balance due upon delivery, unless other credit terms have been approved. Interest may be charged on past due balances at an annual rate of 18%. A 3% charge will be added to all credit card orders.

RESTOCKING: Items canceled, returned or refused will be subject to a minimum 25% restocking fee. All return freight charges are the responsibility of the Buyer.

MAINTENANCE/WARRANTY:

Manufacturer's standard product warranties apply and cover equipment replacement and freight costs only; labor is not included. Northwest Playground Equipment offers no additional warranties.

Maintenance of the equipment and safety surfacing is the responsibility of the customer.

Any unauthorized alterations or modifications to the equipment (including layout) will void your warranty.

INSTALLATION: (if applicable)

A private locate service for underground utilities must be completed before your scheduled installation.

Site must be level and free of loose debris (this includes ground cover/chips).

A minimum 6 foot opening with good access must be available to the site for delivery trucks and tractor.

An onsite dumpster must be provided for disposal of packaging materials.

Arrangements must be made in advance for the disposal of dirt/rocks from within the installation area.

Arrangements must be made in advance for the removal/disposal of existing equipment.

Additional charges may apply if large rocks or concrete are found beneath the surface.

Access to power and water must be available.

Site supervision is quoted in 8-hour days.

Acceptance of Terms & Conditions:

Acceptance of this proposal, made by an authorized agent of your company, indicates agreement to the above terms and conditions.

Alexis Madrigal

Sales Rep

Customer Signature

Date



SEAHURST ELC

REV 1

HD 426 22R1 Color Option : A



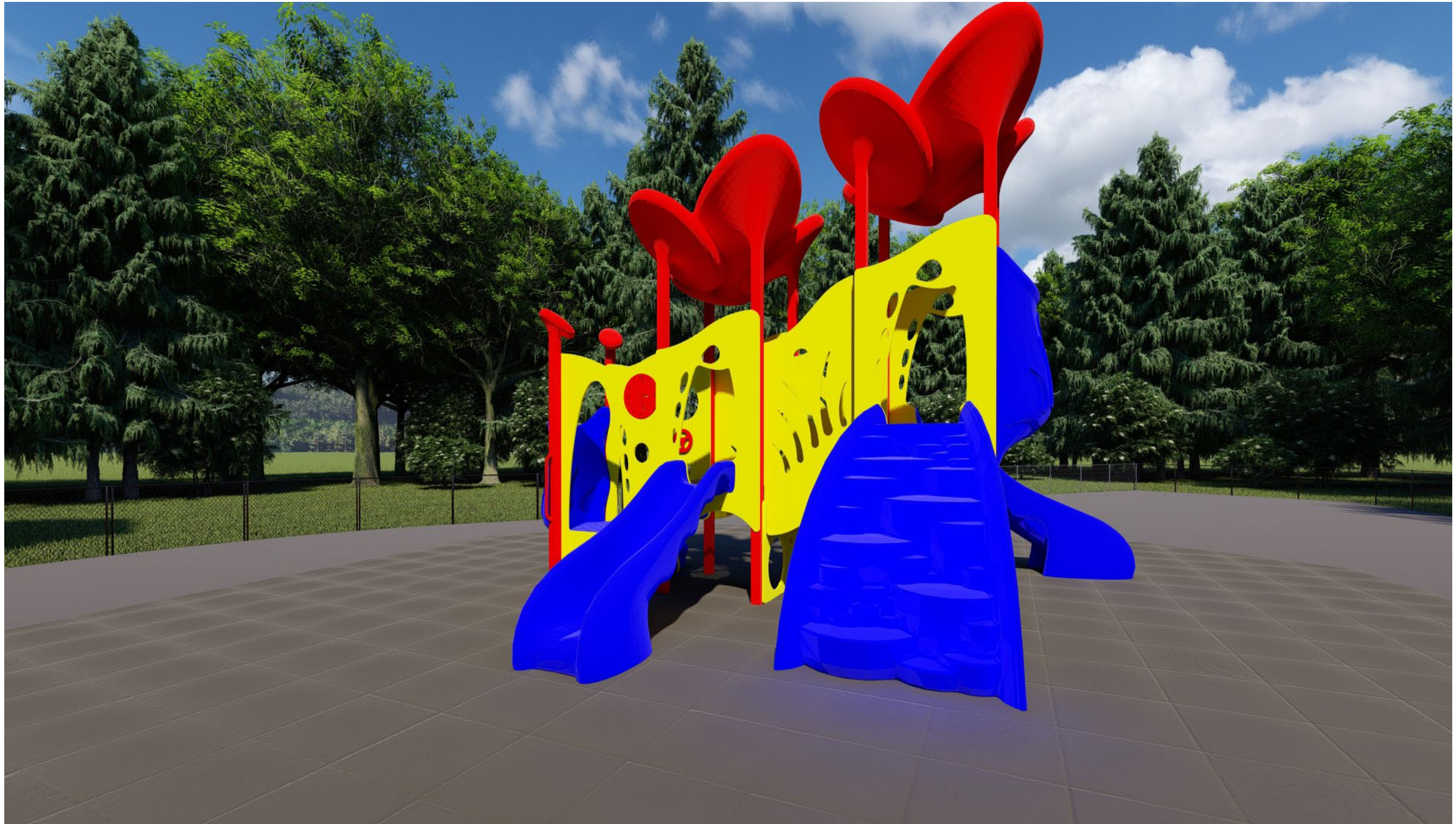



SEAHURST ELC

REV 1

HD 426 22R1 Color Option : A



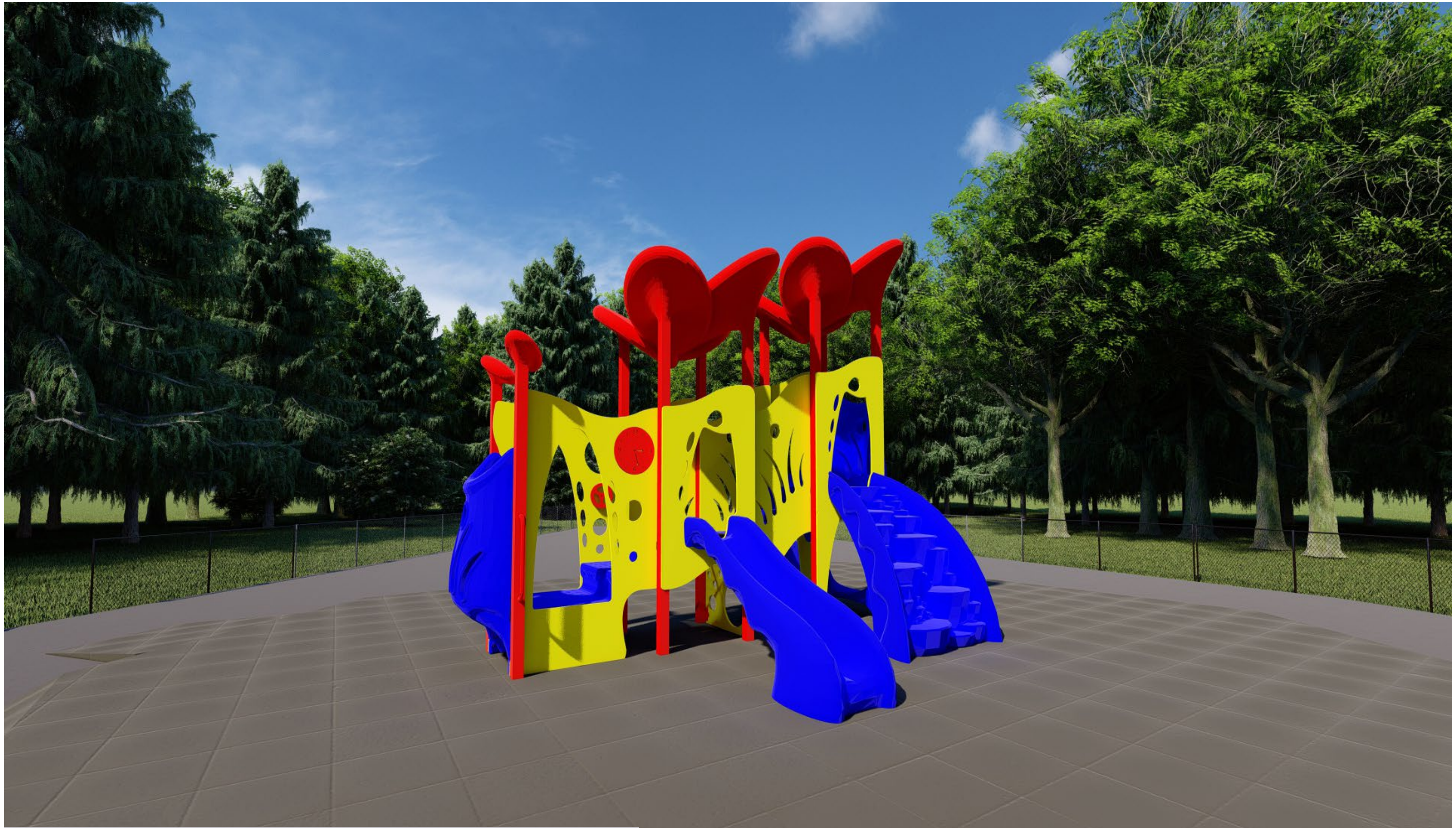

SEAHURST ELC

REV 1

HD 426 22R1 Color Option : A



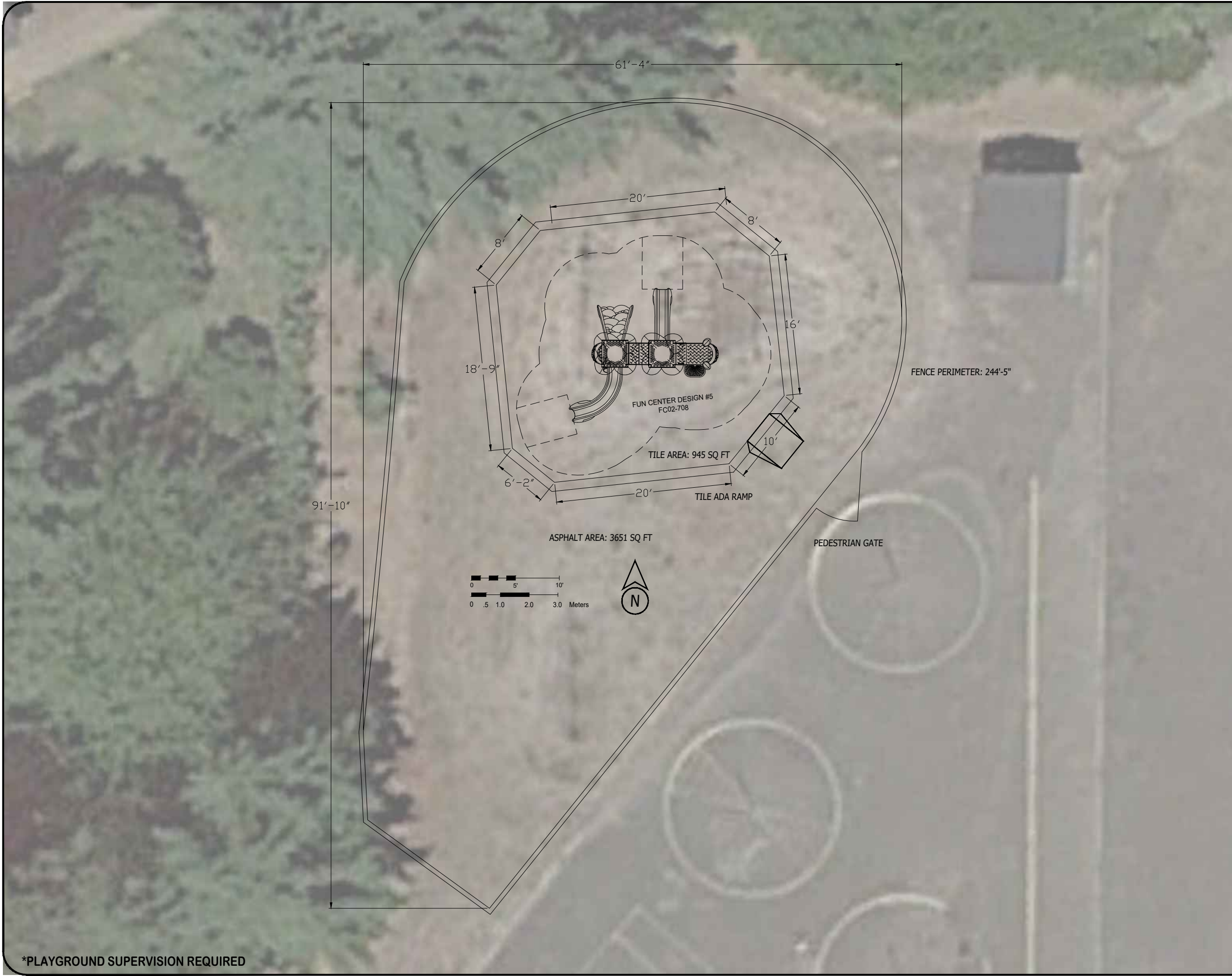

*PLAYGROUND SUPERVISION REQUIRED



BUILDING COMMUNITY THROUGH PLAY

P.O. Box 2410 Issaquah, WA 98027
Toll Free: 1.800.726.0031
www.nwplayground.com
sales@nwplayground.com

EQUIPMENT SIZE:

USE ZONE:

AREA: PERIMETER:
SEE PLAN

FALL HEIGHT:
4 Ft.

USER CAPACITY: AGE GROUP:
20 2-5

ADA SCHEDULE	Total Elevated Play Activities: 5		
	Total Ground-Level Play Activities: 2		
	Accessible Elevated Activities	Accessible Ground-Level Activities	Accessible Ground-Level Play Types
Required	3	2	2
Provided	5	0	0

- ✓ ASTM F1487-17
- ✓ CPSC #325



PROJECT NO: IHD_426_22R1	SCALE: 3/32" = 1'-0"
DRAWN BY: ZTM	Paper Size B
DATE: 9-Sep-22	

SEAHRST ELC

REV 1



Northwest Playground Equipment, Inc.

PO Box 2410, Issaquah, WA 98027-0109

Phone (425) 313-9161 FAX (425)313-9194

Email: sales@nwplayground.com

QUOTE

Quote # AM-1272023-00001607

To: Highline School District.

Date: 01-27-2023

Re: Highline SD - Seahurst ES (2023)

Quote Name: Highline SD - Seahurst ES

Bill To: 15675 Ambaum Boulevard Southwest
Burien, WA 98166

Site Address: 14603 14th Ave SW, Burien, WA
98166

Name: Sid White

Email:

Phone: 206 631-3000

Cell:

Item #	Qty	Description	Price	Total Price
--------	-----	-------------	-------	-------------

EQUIPMENT

Playworld

IHD-Playworld	1	Playworld Systems Challenger Structure, Equipment Including: Glide Slide (48in Deck), Find the Way Home Panel, Accessible Driving Panel, Spin Racer Panel, Store Front Panel ,CH Panel Frame - Ground Level, Very Buried Insert, Rock Climber, and Transfer Station W/ Approach Step.	\$18,256.00	\$18,256.00
ZZXX0341	2	Balance Trax Pond	\$475.00	\$950.00
ZZXX0343	1	Balance Trax Dunes	\$1,925.00	\$1,925.00

sofSURFACES

Tiles	1	1221 Square Feet of DuraSAFE Premium Plus Safety Surfacing Tiles. Tiles are 2.25" Thick, Good for a Critical Fall Height of 4'. Tiles Quoted are to be Installed on a Asphalt Sub Base (Sub Base Not Included).	\$10,750.00	\$10,750.00
-------	---	---	-------------	-------------

Equipment Subtotal (less tax): \$31,406.00

CONTRACT DISCOUNT

Playworld	KCDA - King County Directors Association Discount: BID #22-315	10%	(\$2,113.10)
SofSurfaces	KCDA - King County Directors Association Discount: BID #22-315	6%	(\$645.00)

FREIGHT

Playworld	Freight	\$1,920.25
sofSURFACES	Freight	\$5,240.00

Equipment Total (less tax): \$35,808.15

CERTIFIED INSTALLATION

Playground Installation	1	Deluxe Installation of Listed Playworld Systems Equipment <i>Please Note that the Customer is Responsible for Verifying Quantities and Descriptions. Customer is Responsible for all Permits or Fees. Quote doesn't include Site Prep</i>	\$15,300.00	\$15,300.00
-------------------------	---	--	-------------	-------------



Northwest Playground Equipment, Inc.

PO Box 2410, Issaquah, WA 98027-0109

Phone (425) 313-9161 FAX (425)313-9194

Email: sales@nwplayground.com

Tile Installation	1	Deluxe Installation of Above SofSURFACES Tiles and Materials Over Asphalt Sub Base. Includes Compressed Installation of SofTILE including Prevailing Wage. Sub-Base BY OTHERS <i>Please Note that the Customer is Responsible for Verifying Quantities and Descriptions. Customer is Responsible for all Permits or Fees. Quote doesn't include Site Prep</i>	\$5,135.00	\$5,135.00
Site Prep	1	6,912 Square Feet of Area for Site Preparation. Remove and Dispose of Existing Play Equipment in Proposed Area (38 Footings). Remove & Dispose of Existing Border Timbers. Excavate Area to a Depth of 6". Asphalt to be Laid by Others.	\$44,900.00	\$44,900.00
Paving	1	3,651 SF at 2.5" Asphalt, Up to 28 Tons & 4" Rock, Up to 45 Tons. Subgrade to be Done by Others to A+/- 1/10% Grade. Finish Grate with 4" Crushed Rock, Compact, Pave with 2.5" of Class 1/2" HMA. Tamp Edges As Needed. <i>(Please Note Costing Could Vary Based Upon Site Prep Needs.)</i>	\$68,545.00	\$68,545.00
Fencing	1	Installation and Materials for 194' of 3' Tall All Black Chainlink Fencing with Walk Gates	\$15,445.00	\$15,445.00
			Installation Total:	\$149,325.00
			Performance Bond (If Required):	3.0%
			Credit Card Fee (If Required):	3.5%
Location Code:	Resale Certificate Required for Tax Exemption:	Tax:	10.10%	\$18,746.42
			ORDER TOTAL:	\$204,354.57

Acceptance of Proposal:

(Please be sure you have read, signed, initialed and understand the Terms and Conditions on Page 2 of this Quote)

The items, prices and conditions listed herein are satisfactory and are hereby accepted.

Alexis Madrigal
Sales Rep

Customer Signature

Date



Northwest Playground Equipment, Inc.

PO Box 2410, Issaquah, WA 98027-0109
Phone (425) 313-9161 FAX (425)313-9194
Email: sales@nwplayground.com

Project Name: Highline SD - Seahurst ES (2023)

Quote # AM-1272023-00001607

TERMS AND CONDITIONS

QUOTE CONDITIONS AND ACCEPTANCE:

This quote is only valid for 10 days.

Orders placed or requested for delivery after 10 days are subject to Steel and Material price increases and Surcharges.

*** (Pls Initial) It is the Buyer's responsibility to verify quantities and description of items quoted.

Once your order has been placed, any changes including additions, deletions or color changes, will delay your shipment.

EXCLUSIONS: Unless specified, this quote specifically **excludes** all of the following:

Required Permits; Davis Bacon, Certified Payroll or Prevailing Wage fees

Performance/Payment Bonds

Site work and landscaping

Removal of existing equipment

Unloading; Receiving of inventory or equipment; Storage of equipment

Equipment assembly and/or installation

Safety surfacing; Borders or drainage requirements

Landscaping Repairs DUE to poor access or in climatic weather

FREIGHT AND DELIVERY:

Shipping is FOB Origin. A 24-hr Call Ahead is available at additional cost.

Delivery is currently 5+ weeks after order submittal. Unless otherwise noted, all equipment is delivered unassembled.

*** (Pls Initial) **Buyer is responsible to meet and provide a minimum of 2 ADULTS to unload truck**

A Check List, detailing all items shipped, will be mailed to you and a copy will be included with the shipment.

Buyer is responsible for ensuring the Sales Order and Item Numbers on all boxes and pieces match the Check List.

*** (Pls Initial) Shortages or damages must be noted on the driver's delivery receipt. Shortages or damages not noted become the buyers financial responsibility.

Damaged Freight must be refused. Please notify Northwest Playground Equipment immediately of any damages.

Shortages and Concealed Damage must be reported to Northwest Playground Equipment within 10 days of delivery.

A reconsignment fee will be charged for any changes made to delivery address after order has been placed.

TAXES:

All orders delivering in Washington are subject to applicable sales tax unless a tax exemption or Reseller Permit is on file at the time the order is placed.

PAYMENT TERMS: An approved Credit Application is required for new customers. 50% down payment is due at time of order with balance due upon delivery, unless other credit terms have been approved. Interest may be charged on past due balances at an annual rate of 18%. A 3% charge will be added to all credit card orders.

RESTOCKING: Items canceled, returned or refused will be subject to a minimum 25% restocking fee. All return freight charges are the responsibility of the Buyer.

MAINTENANCE/WARRANTY:

Manufacturer's standard product warranties apply and cover equipment replacement and freight costs only; labor is not included. Northwest Playground Equipment offers no additional warranties.

Maintenance of the equipment and safety surfacing is the responsibility of the customer.

Any unauthorized alterations or modifications to the equipment (including layout) will void your warranty.

INSTALLATION: (if applicable)

A private locate service for underground utilities must be completed before your scheduled installation.

Site must be level and free of loose debris (this includes ground cover/chips).

A minimum 6 foot opening with good access must be available to the site for delivery trucks and tractor.

An onsite dumpster must be provided for disposal of packaging materials.

Arrangements must be made in advance for the disposal of dirt/rocks from within the installation area.

Arrangements must be made in advance for the removal/disposal of existing equipment.

Additional charges may apply if large rocks or concrete are found beneath the surface.

Access to power and water must be available.

Site supervision is quoted in 8-hour days.

Acceptance of Terms & Conditions:

Acceptance of this proposal, made by an authorized agent of your company, indicates agreement to the above terms and conditions.

Alexis Madrigal

Sales Rep

Customer Signature

Date



Northwest Playground Equipment, Inc.

PO Box 2410, Issaquah, WA 98027-0109
Phone (425) 313-9161 FAX (425)313-9194
Email: sales@nwplayground.com

QUOTE

Quote # AM-232023-00001854

To: Highline School District.

Date: 02-03-2023

Re: Highline SD - Misc Play Equipment

Quote Name: Highline SD - Misc Play Equipment

Bill To: 15675 Ambaum Boulevard Southwest
Burien, WA 98166

Site Address:

Name: Jon Youngblood
Email: jon.youngblood@highlineschools.org

Phone: 206-348-8500
Cell:

Item #	Qty	Description	Price	Total Price
EQUIPMENT				
Playworld				
ZZXX0349	1	Unity Spinr - W/ 2 Accessible Seats	\$14,319.00	\$14,319.00
ZZUN2019	1	Approach Step For Transferstation	\$479.00	\$479.00
ZZUN7137	3	Unity Stepper - Medium	\$1,139.00	\$3,417.00
ZZXX0344	1	Balance Trax Snake	\$2,299.00	\$2,299.00
ZZXX0345	1	Balance Trax Boomerang	\$1,589.00	\$1,589.00
ZZUN7136	3	Unity Stepper - Small	\$649.00	\$1,947.00
ZZXX0667	1	Concerto Chimes	\$5,391.00	\$5,391.00
ZZCH4808	1	Oval Insert Panel(Ground Level)	\$945.00	\$945.00
ZZXX0664	1	Concerto 3 Congas	\$2,629.00	\$2,629.00
ZZCH4350	1	Tic-Tac-Toe Activity Wall	\$1,809.00	\$1,809.00
ZZCH4406	1	Accessible Driving Panel	\$999.00	\$999.00
ZZUN4806	1	Shifting Sands Panel Insert	\$1,055.00	\$1,055.00
350-1431	1	Rhythm Wall	\$9,991.00	\$9,991.00
ZZCH0616	1	Square Coated Deck Assembly	\$1,235.00	\$1,235.00
ZZCH0619	1	Full Hex Coated Deck Assembly	\$2,629.00	\$2,629.00
ZZCH0683	1	Nuvo - 36In Transfer Station	\$3,055.00	\$3,055.00
ZZPM0618	1	1/2 Hex Coated Deck Assembly	\$2,009.00	\$2,009.00
ZZCH2006	1	Transfer Station (36In Deck)	\$2,045.00	\$2,045.00
ZZUN7138	3	Unity Stepper - Large	\$1,795.00	\$5,385.00

Equipment Subtotal (less tax): \$63,227.00

FREIGHT

Playworld	Freight	\$15,445.00
Equipment Total (less tax):		\$78,672.00

CERTIFIED INSTALLATION

Deluxe Install	1	Deluxe Installation of Listed Playworld Systems Equipment Price Includes Receiving Equipment and Offloading Onsite, Installation Through Disposal of Dirt from Holes and Debris Offsite. <i>Customer is Responsible for all Permits or Fees.</i> <i>Quote doesn't include Site Prep</i> <i>(Costing Will Vary Based Upon Individual Site Needs)</i>	\$66,025.80	\$66,025.80
----------------	---	--	-------------	-------------



Northwest Playground Equipment, Inc.

PO Box 2410, Issaquah, WA 98027-0109

Phone (425) 313-9161 FAX (425)313-9194

Email: sales@nwplayground.com

Deluxe Tile Installation	1	Deluxe Installation of Above Tile Materials Over Crushed Rock - Concrete- Asphalt Sub Base. Includes Compressed Tile Installation, All Required Cutting and Edging, Offloading of Materials On Site and Disposal of Packaging. Sub-Base BY OTHERS <i>Customer is Responsible for all Permits or Fees.</i> <i>Quote doesn't include Site Prep</i> <i>(Pricing Adjusted to Square Footage)</i>	\$7.00	\$7.00
Tile Removal/ Disposal	1	Removal and Disposal of Tiles <i>(Pricing Adjusted to Square Footage)</i>	\$7.00	\$7.00

Prevailing Wage

	Performance Bond (If Required):	3.0%	Installation Total:	\$66,039.80
	Credit Card Fee (If Required):	3.5%		
Location Code: 1734	Resale Certificate Required for Tax Exemption:	Tax: 10.10%		\$14,615.89
			ORDER TOTAL:	\$159,327.69

Acceptance of Proposal:

(Please be sure you have read, signed, initialed and understand the Terms and Conditions on Page 2 of this Quote)

The items, prices and conditions listed herein are satisfactory and are hereby accepted.

Alexis Madrigal
Sales Rep

Customer Signature

Date



Northwest Playground Equipment, Inc.

PO Box 2410, Issaquah, WA 98027-0109
Phone (425) 313-9161 FAX (425)313-9194
Email: sales@nwplayground.com

Project Name: Highline SD - Misc Play Equipment

Quote # AM-232023-00001854

TERMS AND CONDITIONS

QUOTE CONDITIONS AND ACCEPTANCE:

This quote is only valid for 10 days.

Orders placed or requested for delivery after 10 days are subject to Steel and Material price increases and Surcharges.

*** (Pls Initial) It is the Buyer's responsibility to verify quantities and description of items quoted.

Once your order has been placed, any changes including additions, deletions or color changes, will delay your shipment.

EXCLUSIONS: Unless specified, this quote specifically **excludes** all of the following:

Required Permits; Davis Bacon, Certified Payroll or Prevailing Wage fees

Performance/Payment Bonds

Site work and landscaping

Removal of existing equipment

Unloading; Receiving of inventory or equipment; Storage of equipment

Equipment assembly and/or installation

Safety surfacing; Borders or drainage requirements

Landscaping Repairs DUE to poor access or in climatic weather

FREIGHT AND DELIVERY:

Shipping is FOB Origin. A 24-hr Call Ahead is available at additional cost.

Delivery is currently 5+ weeks after order submittal. Unless otherwise noted, all equipment is delivered unassembled.

*** (Pls Initial) **Buyer is responsible to meet and provide a minimum of 2 ADULTS to unload truck**

A Check List, detailing all items shipped, will be mailed to you and a copy will be included with the shipment.

Buyer is responsible for ensuring the Sales Order and Item Numbers on all boxes and pieces match the Check List.

*** (Pls Initial) Shortages or damages must be noted on the driver's delivery receipt. Shortages or damages not noted become the buyers financial responsibility.

Damaged Freight must be refused. Please notify Northwest Playground Equipment immediately of any damages.

Shortages and Concealed Damage must be reported to Northwest Playground Equipment within 10 days of delivery.

A reconsignment fee will be charged for any changes made to delivery address after order has been placed.

TAXES:

All orders delivering in Washington are subject to applicable sales tax unless a tax exemption or Reseller Permit is on file at the time the order is placed.

PAYMENT TERMS: An approved Credit Application is required for new customers. 50% down payment is due at time of order with balance due upon delivery, unless other credit terms have been approved. Interest may be charged on past due balances at an annual rate of 18%. A 3% charge will be added to all credit card orders.

RESTOCKING: Items canceled, returned or refused will be subject to a minimum 25% restocking fee. All return freight charges are the responsibility of the Buyer.

MAINTENANCE/WARRANTY:

Manufacturer's standard product warranties apply and cover equipment replacement and freight costs only; labor is not included. Northwest Playground Equipment offers no additional warranties.

Maintenance of the equipment and safety surfacing is the responsibility of the customer.

Any unauthorized alterations or modifications to the equipment (including layout) will void your warranty.

INSTALLATION: (if applicable)

A private locate service for underground utilities must be completed before your scheduled installation.

Site must be level and free of loose debris (this includes ground cover/chips).

A minimum 6 foot opening with good access must be available to the site for delivery trucks and tractor.

An onsite dumpster must be provided for disposal of packaging materials.

Arrangements must be made in advance for the disposal of dirt/rocks from within the installation area.

Arrangements must be made in advance for the removal/disposal of existing equipment.

Additional charges may apply if large rocks or concrete are found beneath the surface.

Access to power and water must be available.

Site supervision is quoted in 8-hour days.

Acceptance of Terms & Conditions:

Acceptance of this proposal, made by an authorized agent of your company, indicates agreement to the above terms and conditions.

Alexis Madrigal

Sales Rep

Customer Signature

Date