

# COMMUNITY SCHOOLYARDS



TRUST FOR  
PUBLIC  
LAND™

From vacant...



...to vibrant!



## Park-like Places

Community Schoolyards function like parks. They are packed with trees, landscaping, play structures, gathering spaces, athletic facilities, public art, and green infrastructure.



## Designed by the Community

Community Schoolyards are designed by the community, for the community, through a dynamic participatory design process.



## Designed with Intention

Community Schoolyards are designed in a manner that improves health, combats inequities, and mitigates the impacts of climate change.



## Welcoming to Everyone

Community Schoolyards are shared spaces that are open and welcoming to the public.

No one Community Schoolyard is alike. Each is uniquely designed by the community, for the community, taking into account site context, history, culture, priorities, and needs.



CLASSROOMS



ATHLETICS



PLAY



ART



GARDENS



WATER

UNDERINVESTMENT IN OUR  
SCHOOLS' OUTDOOR SPACES -  
PARTICULARLY IN LOW INCOME  
AND COMMUNITIES OF COLOR -  
HAS BEEN THE STATUS QUO FOR  
FAR TOO LONG.

THAT NEEDS TO CHANGE.

AND WE'RE GOING TO  
DO IT.

## OUR VISION

Every child has access to a park-like schoolyard space, designed by the community to improve health, equity, climate, and education. Community Schoolyards is adopted as the standard approach to schoolyard design, programming, and stewardship in Minnesota.

## CONTACT US

[HTTPS://WWW.TPL.ORG/OUR-  
WORK/MINNESOTA-HEALTHY-  
COMMUNITY-SCHOOLYARDS](https://www.tpl.org/our-work/minnesota-healthy-community-schoolyards)

[ERIC.WEISS@TPL.ORG](mailto:ERIC.WEISS@TPL.ORG)





# JEFFERSON ELEMENTARY COMMUNITY SCHOOLYARD

Our school’s outdoor space serves many purposes – a place to play, learn, gather, and celebrate. Over 25 years old and showing its age, our playground needs some love and attention. And, we know that our schoolyard can be so much more than what currently exists.

For the past year, Jefferson Elementary has been partnering with Trust for Public Land (TPL) to imagine the future possibilities of the schoolyard. At this time, our focus is on the front playground, but we are exploring ways to improve the entire schoolyard.

## YOUR QUESTIONS ANSWERED

### WHAT WILL THE NEW SCHOOLYARD LOOK LIKE?

Simple answer is that we don't full know yet!

Currently, we have a concept - or basic idea - of what we want the schoolyard to look like. Over the next few months, we'll continue to refine these plans. There is still plenty of time for you to help shape this project.

On the next board, we highlight the early concept plan. Know that this plan is not finalized! It is just one early idea of what the schoolyard could look like. The actual project design will depend on community feedback, budget, and site logistics.

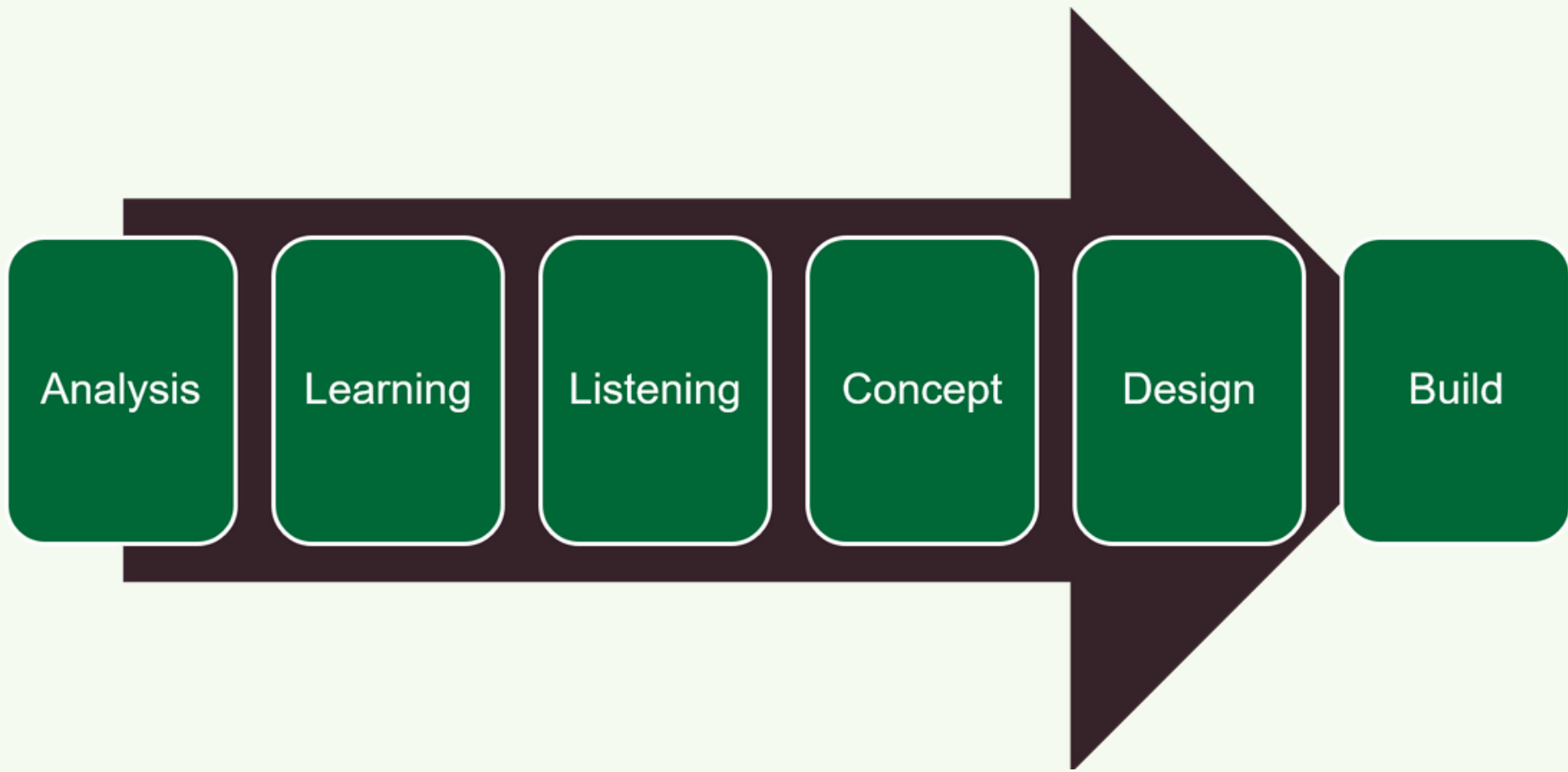

### WHAT IDEAS HAVE BEEN SHARED SO FAR?

Students, parents, and teachers have shared great ideas for the playground. The general theme of feedback include:

- Play: space needs new play equipment
- Shade: more trees and shade for when it's hot
- Accessibility: ensure everyone can use the space, including those with different abilities
- A place to sit: everyone, from kids to grandparents, needs a break at some point
- Outdoor learning: a new space so class can be taken outdoors
- Soccer: the community would like a place to play soccer
- Habitat: the schoolyard could be a place for plants and animals
- Art: new pops of color would add vibrancy to the schoolyard

### WHEN WILL THIS WORK TAKE PLACE?

The reimagining of the front schoolyard space will take place in three distinct projects.

- Project 1 - Site circulation and parking  
Status: Complete
- Project 2 - Nature-centered improvements to eastern third of front playground  
Status: In planning. Construction Summer 2023
- Project 3 - Replacement of playground equipment adjacent to school building  
Status: Dependent on success fundraising



### WHAT ABOUT IMPROVEMENTS TO THE BACK PLAYGROUND?

Currently, we are focusing efforts on the older, front playground. If funding becomes available, it is possible some improvements may occur in the back playground.

### HOW CAN I GET INVOLVED IN THE SCHOOLYARD PROJECT?

- There are several ways to support the schoolyard project
- Serve as a Schoolyard Champion. You can even sign up to serve now!
  - Participate in workshops, events, and meetings
  - Complete a survey
  - Help fundraise, apply for grants, and secure project funding
  - Tell your neighbors and friends about the exciting work!

For more information contact:  
Eric Weiss, Trust for Public Land, [eric.weiss@tpl.org](mailto:eric.weiss@tpl.org)  
Principal Jurrens, Jefferson Elementary,



TRUST FOR  
PUBLIC  
LAND™



# JEFFERSON ELEMENTARY COMMUNITY SCHOOLYARD CONCEPT PLANS

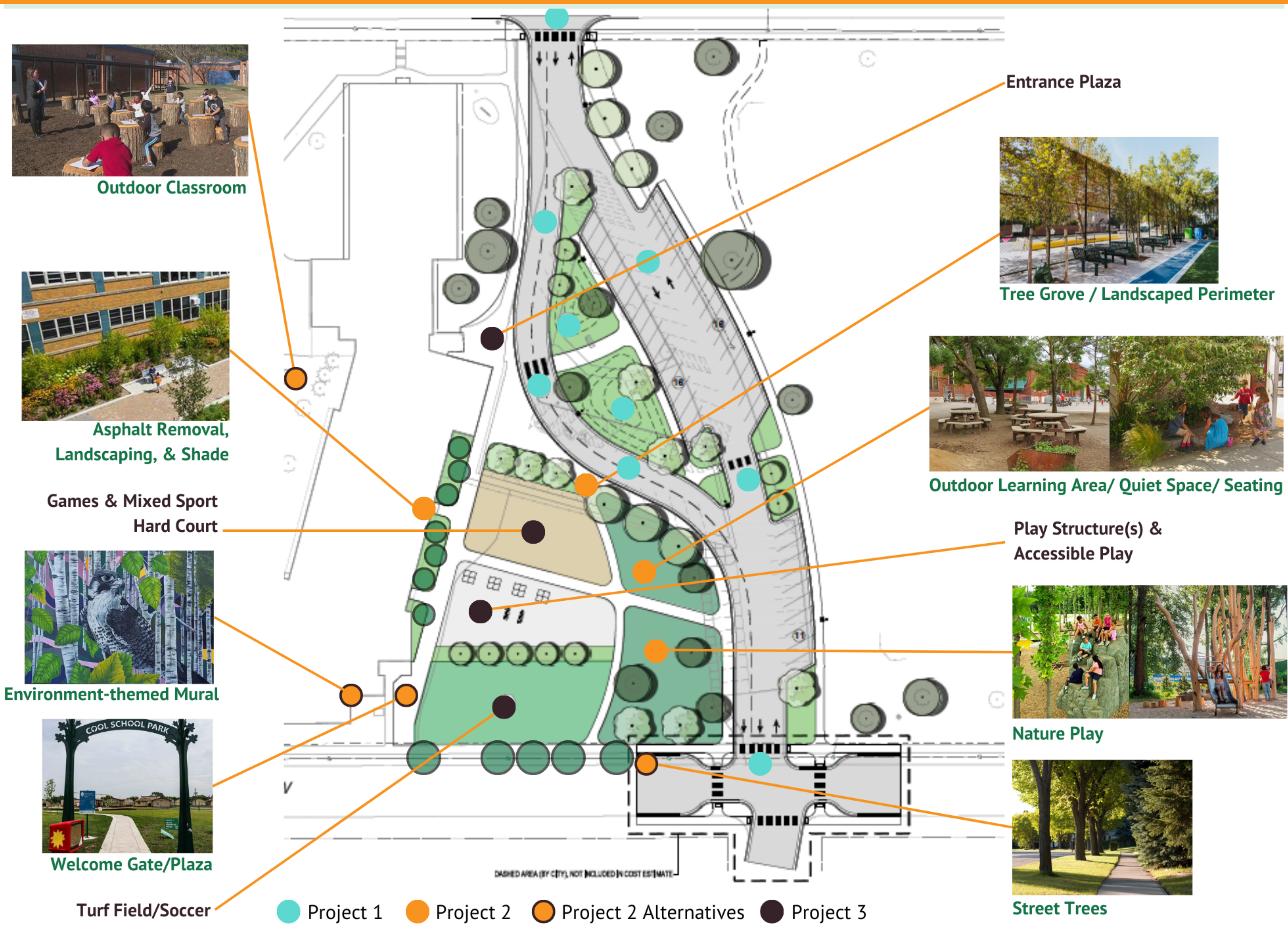

**WHAT DO YOU THINK OF THE CONCEPT PLAN?  
LEAVE YOUR THOUGHTS BELOW.**