

DRAFT

White Plains Public Schools

A Guide for Parents/Guardians for Setting up Screen Time Monitoring for iPads

Courtesy of PC Magazine:

<https://www.pcmag.com/feature/363837/how-to-use-screen-time-in-apple-s-ios-12/11>

On the iPad

Tap on Settings App



Tap Screen Time

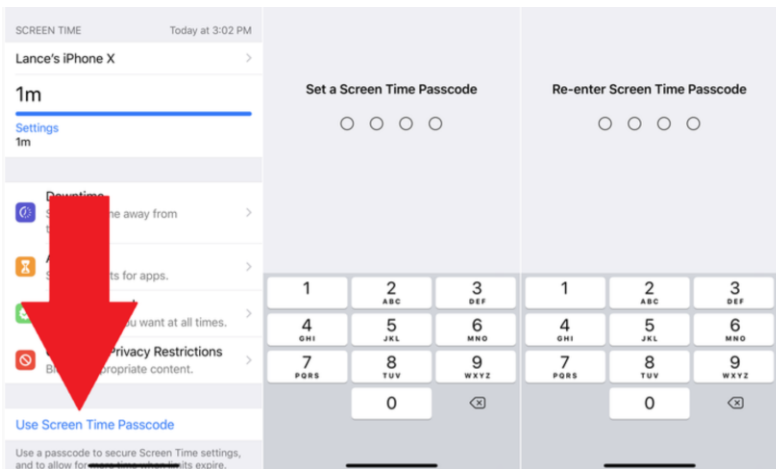

Set Screen Time Passcode

Screen Time will now monitor how much time is spent on individual apps, features, and settings on the iPad.

Parents/Guardians - Tap the link to Use Screen Time Passcode to secure the Screen Time settings. Type and retype a passcode.
Do not share the code with your child.

Screen Time Options

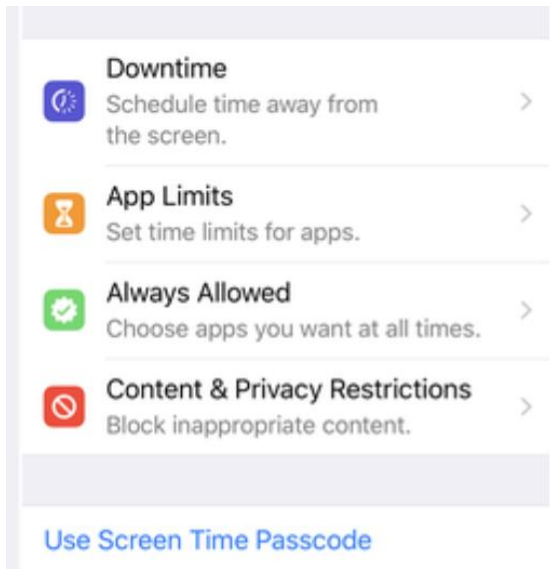

Downtime

Parents can set limits on which apps and features you can access and for how long. Tap the entry for Downtime and turn on the switch.

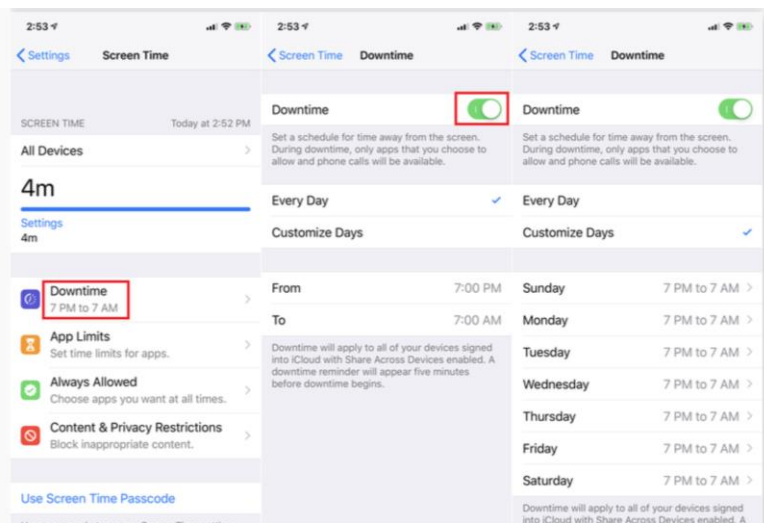

You can create a time frame during which only certain apps will be allowed. Tap the From time and then the To time to set both for all days. Or tap Customize Days to schedule different times for each day of the week.

App Limits

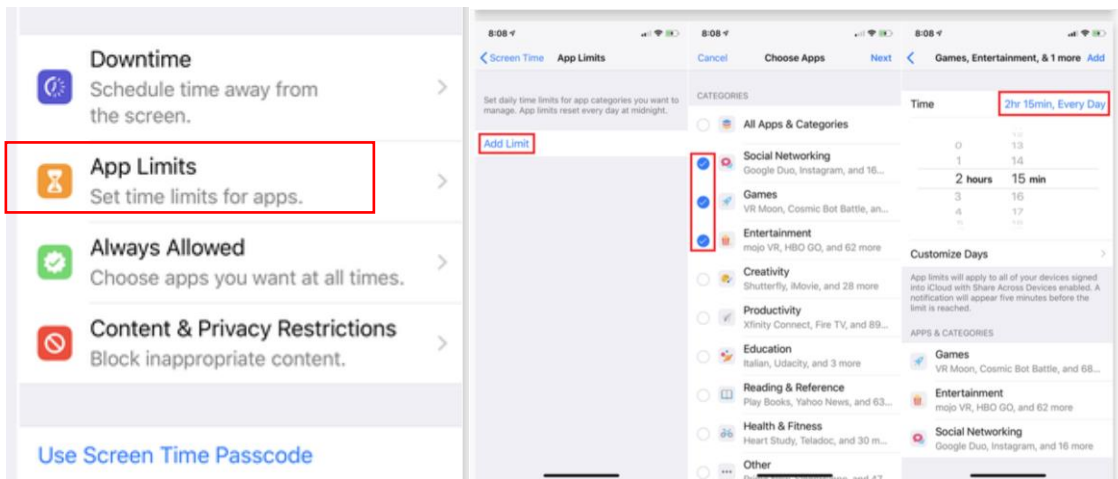

Tap **App Limits** > **Add Limit**. At the Categories screen, you can either leave the default setting for All Apps & Categories, or select individual apps to limit.

After your desired apps are selected, tap Next. At the Time screen, set the number of hours and/or minutes after which the apps in the categories you chose will be blocked from further use.

You can choose a different duration for each day by tapping the option for Customize Days. Create different limits for different categories by setting them up separately. Tap Add to finish and view your settings.

Always Allowed

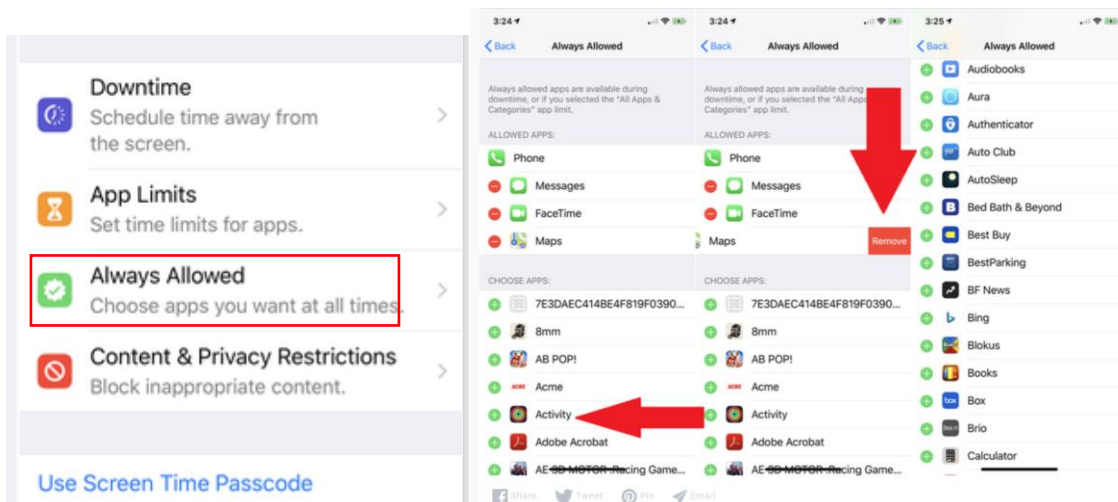

Tap Always Allowed. To add an app to the allowed list, tap its plus sign. If you want to remove an app from the Always Allow list, tap the minus sign and tap Remove.

Content and Privacy Restrictions

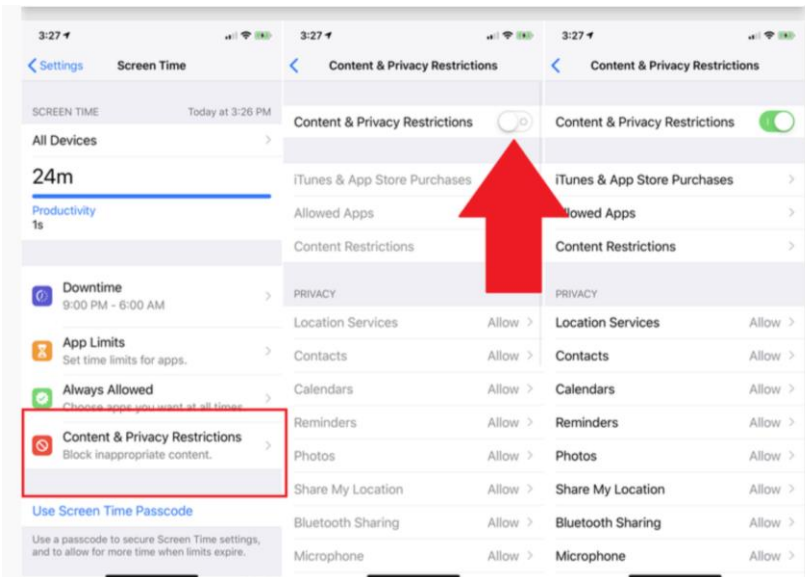

Content and Privacy Restrictions

(please proceed carefully, as there are a lot of settings in this feature)

Tap the entry for Content & Privacy Restrictions. Here, you can allow or disallow specific content, privacy settings, and other changes. Turn on the switch for Content & Privacy Restrictions.

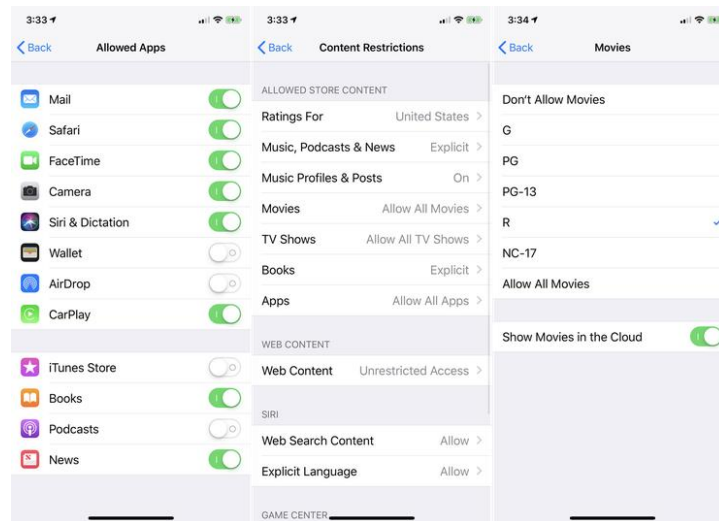

If you want to enable or disable specific apps, tap **Content & Privacy Restrictions > Allowed Apps** and toggle apps on or off. If you want to allow or ban specific content from the App Store, the web, and other sources, tap **Content & Privacy Restrictions > Content Restrictions** and pick what you'd like to allow or block.

Privacy Settings

If you want to limit the data that is shared on certain apps, you can control your settings in the Content & Privacy Restrictions menu under the Privacy section. Tap each entry to allow or disallow it.

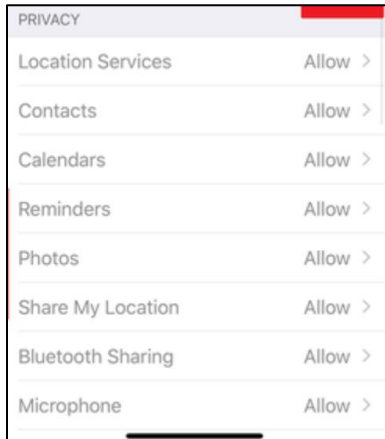

Once you make changes on the Content & Privacy Restrictions, those changes must be approved before they go into effect. In the Allow changes section, tap each change to allow or disallow it, and you're done.

