

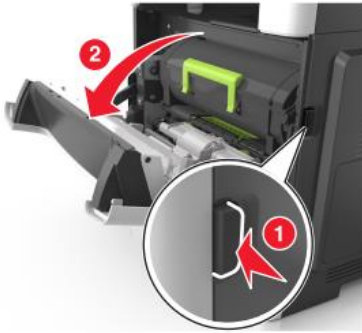

How to Replace Toner Cartridge on Lexmark MS310\312

1. Turn the printer off.
2. Press the button on the right side of the printer, and then open the front door.



3. Pull the toner cartridge out using the handle.

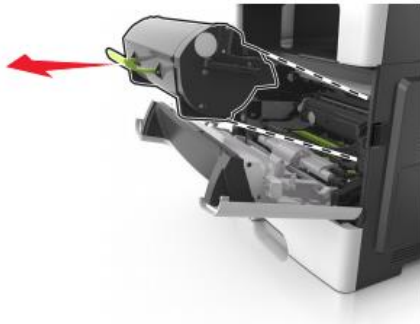

4. Unpack the new toner cartridge. (Rotate the new cartridge from end to end 4 or 5 times)

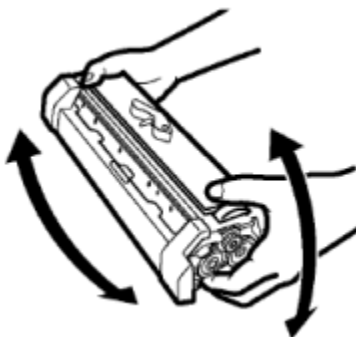



5. Insert the toner cartridge into the printer by aligning the side rails of the cartridge with the arrows on the side rails inside the printer.

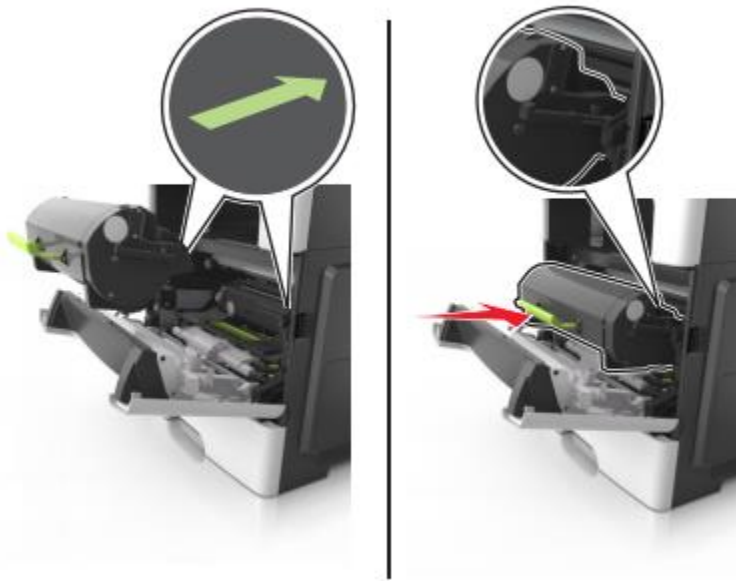

6. Close the front cover, power the unit on and you are ready to print.

