



Scranton School District Environmental Update

Environmental Task Force

March 3, 2021

Updates

- COVID-19 Reopening HVAC
- Northeast Intermediate
- 3 Year Reinspection Plan
- 2021 Summer Abatement Project
- Lead in Drinking Water
- Mercury Issue

Executive Summary of Draft GPI Ventilation Study

The Scranton School District (SSD) is currently in the early planning stages of a Facilities Improvement Plan that is focused on prioritizing, budgeting, and implementing Capital Improvements to improve the District's aging facilities and replace infrastructure that is at the end of its life cycle.

The District recognizes that current COVID-19 guidelines provide additional facilities challenges including cleaning, sanitizing, social distancing, and other parameters that are required to be implemented in accordance with safe health practices. One area that is especially important for buildings is air quality, and in particular, fresh air to reduce the potential for COVID-19 transmission.

Greenman-Pedersen, Inc. (GPI) recommendations for improving building HVAC system ventilation performance:

1. Identify any areas where mechanical ventilation is not functioning as designed or is not available.
2. Perform repairs where feasible and/or identify temporary measures until repairs are implemented.
3. Determine where MERV 13 filtration is feasible.
4. Assess a long-term solution to incorporate bipolar ionization where MERV 13 filtration is not feasible.
5. After the above is complete, consider Measurement and Verification of the systems in order to verify that the mechanical ventilation is operating as originally intended.

Ventilation Improvements Summary

SCRANTON SCHOOL DISTRICT	DRAFT GPI Ventilation Study								
	Built	Reno	Maintain HVAC System Functionality and Cleanliness	Perform Systems Flush Out	Open Operable Windows Whenever Practical	Upgrade Filters	Add Portable Air Purifiers	Schools With No Mechanical Ventilation	Verify Ventilation Airflow Rates
HIGH SCHOOLS									
Scranton HS	2001	none	X	X	X	18 AHUs	59	N/A	X
W. Scranton HS	1927	none	X	X	X	N/A	N/A	Locker Rooms & Vice Principal's Office near Room 117	X
INTERMEDIATE SCHOOLS									
W. Scranton IS	1975	none	X	X		15 AHUs	N/A	N/A	X
S. Scranton IS	1937	none	X	X	X	N/A	N/A	N/A	X
NE Scranton IS*	1904	1930, 1999	X	X	X			IN PROGRESS*	X
ELEMENTARY SCHOOLS									
John Adams ES	1931	1965+/-	X	X	X	N/A	N/A	Cafeteria & Library, Computer CR, Art CR, and Teacher's Lounge in Basement	X
Neil Armstrong ES	1969		X	X		Multipurpose	33	N/A	
George Bancroft ES	1928	1960's	X	X	X	N/A	20	Lunchroom and rooms on 1st & 2nd Floors	X
John F Kennedy ES	1964	1983	X	X	X	AHUs	21	N/A	X
McNichols Plaza Building	1977		X	X		AHUs	N/A	N/A	X
Monticello	Leased		X	X		AHUs	N/A	N/A	X
Robert Morris ES	1895	1966	X	X	X	Multipurpose	20	Secretary & Principal's office (1st Flr) Art CR, Counseling room, Teacher workroom in Basement	X
William Prescott ES	1966	none	X	X	X	Multipurpose	16	Basement, Principal & Secretary's office (1st Flr), Teacher's lounge (2nd Flr)	X
Charles Sumner ES	1968		X	X	X	Multipurpose	15	Speech Therapy Rooms (3) and Reading specialist in main corridor. Nurse, Secretary, Principal, & Teacher's Lounge near main office.	X
Isaac Tripp ES	2011	none	X	X	X	AHUs	N/A	N/A	X
Whittier Annex	Leased				X	N/A	15	Building	
John Greenleaf Whittier ES	1896	1966	X	X	X	AHUs	N/A	N/A	X
Frances Willard ES	1928	1960	X	X	X	N/A	N/A	Nurse's Office	X
MISC.									
Memorial Stadium	1949	2010 +/-	IN PROGRESS						
Administration Building	1910	1966			X	N/A	N/A	Building	
SCRANTON SCHOOL DISTRICT	Built	Reno	Maintain HVAC System Functionality and Cleanliness	Perform Systems Flush Out	Open Operable Windows Whenever Practical	Upgrade Filters	Add Portable Air Purifiers	Schools With No Mechanical Ventilation	Verify Ventilation Airflow Rates
SCRANTON SCHOOL DISTRICT	DRAFT GPI Ventilation Study								

*Northeast Scranton IS Ventilation System is included in Summer 2021 Priority Projects.

Northeast Intermediate

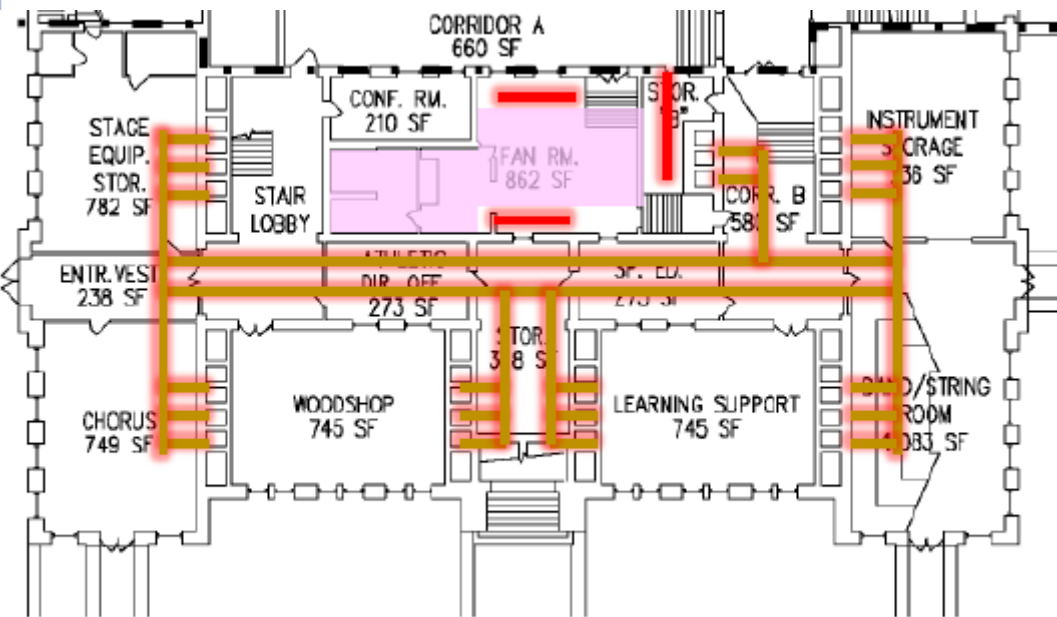

- Plan is to open the “old side” of NEIS by completing the required abatement and HVAC upgrades
- March 8th Pre-Bid
- March 23rd Bids Due
- Abatement
 - April 12-May 21
- HVAC Upgrades
 - June 1-August 2

OLD - 1904

TSI = 825 LF

Surfacing = 12 SF

Miscellaneous = 4,740 SF

NEW - 1931

TSI = 2,205 LF

Surfacing = 0 SF

Miscellaneous = 4,035 SF

(b) *Reinspection.* (1) At least once every 3 years after a management plan is in effect, each local education agency shall conduct a reinspection of all friable and nonfriable known or assumed ACBM in each school building that they lease, own, or otherwise use as a school building.

3 Year Reinspection

- All schools complete except for:
 - West High School
 - Memorial Stadium
 - Admin Building
- Reports scheduled to be completed in March
- Management Plans following inspections

Zone	FTE	School Name	October 2020				November 2020				December 2020				January 2021			
			5th	12th	19th	26th	2nd	9th	16th	23rd	30th	7th	14th	21st	28th	4th	11th	18th
ES	6	John Adams	█				█					█						
ES	6	Neil Armstrong		█				█					█					
ES	6	George Bancroft	█				█						█					
ES	2	John F. Kennedy						█			█							
ES	1	Lincon-Jackson Academy							█		█							
ES	6	McNichols Plaza		█					█			█						
ES	1	Monticello School							█				█					
ES	6	Robert Morris			█				█									█
ES	6	William Prescott				█					█							█
ES	4	Charles Sumner					█					█						█
ES	2	Isaac Tripp		█				█										█
ES	2	John G. Whittier			█				█									█
ES	4	Whittier Annex				█				█								█
ES	6	Frances Willard					█				█							█
IS	4	Northeast										█						█
IS	10	South										█						█
IS	8	West										█						█
HS	2	Scranton											█					█
HS	8	West											█					█
AD	8	Administration Building												█				█
AD	2	Memorial Stadium																█

█	3 Year Reinspection
█	Reinspection Report
█	Management Plan Development

2021 Summer Abatement

Based on the results of the new inspections, priority planning for abatement includes:

1. Damaged or Significant Damaged ACM
2. ACM in Student Contact Areas
3. Buildings with limited ACM in any condition



Lead in Drinking Water

- Completed annual sampling in fall of 2020
- 324 Samples (some 2nd or pre/post flush)
- 75 >AL
- All distribution points outfitted with NSF/ANSI compliant filters (POU)
- Retesting in March for all (+)





Sampled Schools (Bulk)

1. West Scranton High School – Girls Gymnasium
2. Willard Elementary – Gymnasium/Cafeteria
3. Kennedy Elementary School - Gymnasium
4. Whittier Elementary School - Gymnasium

All NEGATIVE for any levels of Mercury

HIDDEN HAZARD IN
PLAIN SIGHT: MANY
SCHOOL GYM FLOORS
CONTAIN ELEMENTAL
MERCURY

1. Visual Assessment
2. Records Review
3. Bulk Sampling
4. Air Testing