

# Scranton School District

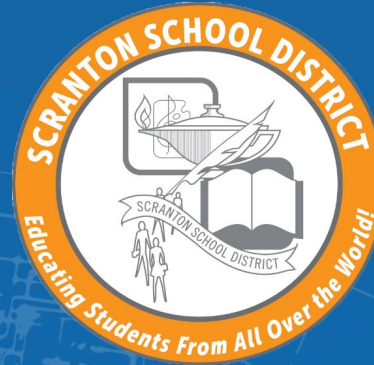

## Summary of West Scranton Intermediate School Modular Classroom Scope February 2, 2022



# Modular Classrooms – Summary of Scope



D'HUY Engineering, Inc.

- Newly fabricated modular units will be installed on foundations secured to the ground.
- Modulares have two exits; one is connected to the main building by a canopy-covered walkway and the secondary exit is at the opposite end of the modulares.
- The entrance to the modulares and building are secured with lockable doors and card access.
- Security cameras are located at the modular entrances and corridor.
- Modulares have integrated bathrooms for student and staff use.
- Modulares contain a fire alarm system, internet, intercom, and technology connected to the existing building.
- Modulares contain HVAC units for each classroom that provide heating, cooling and ventilation air. Each classroom has its own controls for comfort.



## How will children leaving the trailers to go to the bathroom/nurse/office, etc. be handled?

**Bathrooms:** Student bathrooms are located inside of the Modulares.

**Nursing, Office, etc.:** There are Hall Monitors stationed at the building now. When students are taken to other services such as a nurse or report to the office, the procedure is for the Hall Monitor to escort the student to those locations.

## What happens if a fire breaks out in trailer? How will students evacuate? Are there 2 exits as per fire code?

The modular classrooms will conform to all local and National Fire Codes for egress and signaling. We follow the standard outlined in NFPA 101, Life Safety Code for evacuation. There will be fire annunciation systems installed in all locations of the modulares and pull stations will be spaced to the standard called out in NFPA 72, National Fire Alarm and Signaling Code. There are two exits provided.

We have obtained the building permit from the City of Scranton. They will perform code inspections prior to issuing a Certificate of Occupancy.

# Modular Classrooms - Floor Plan



D'HUY Engineering, Inc.

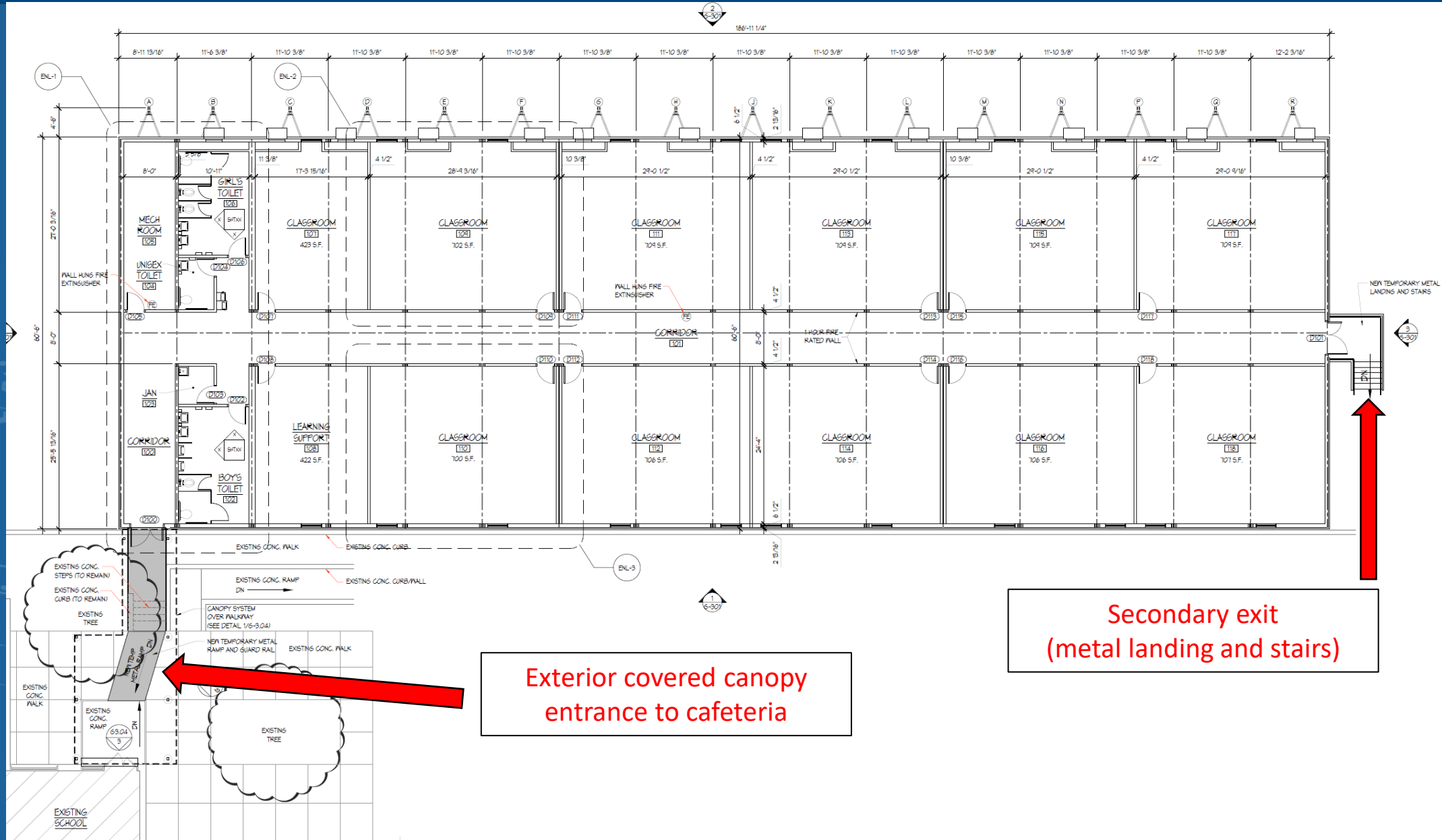

Exterior covered canopy entrance to cafeteria

Secondary exit (metal landing and stairs)

# Modular Classrooms - Typical Classroom Layout



D'HUY Engineering, Inc.

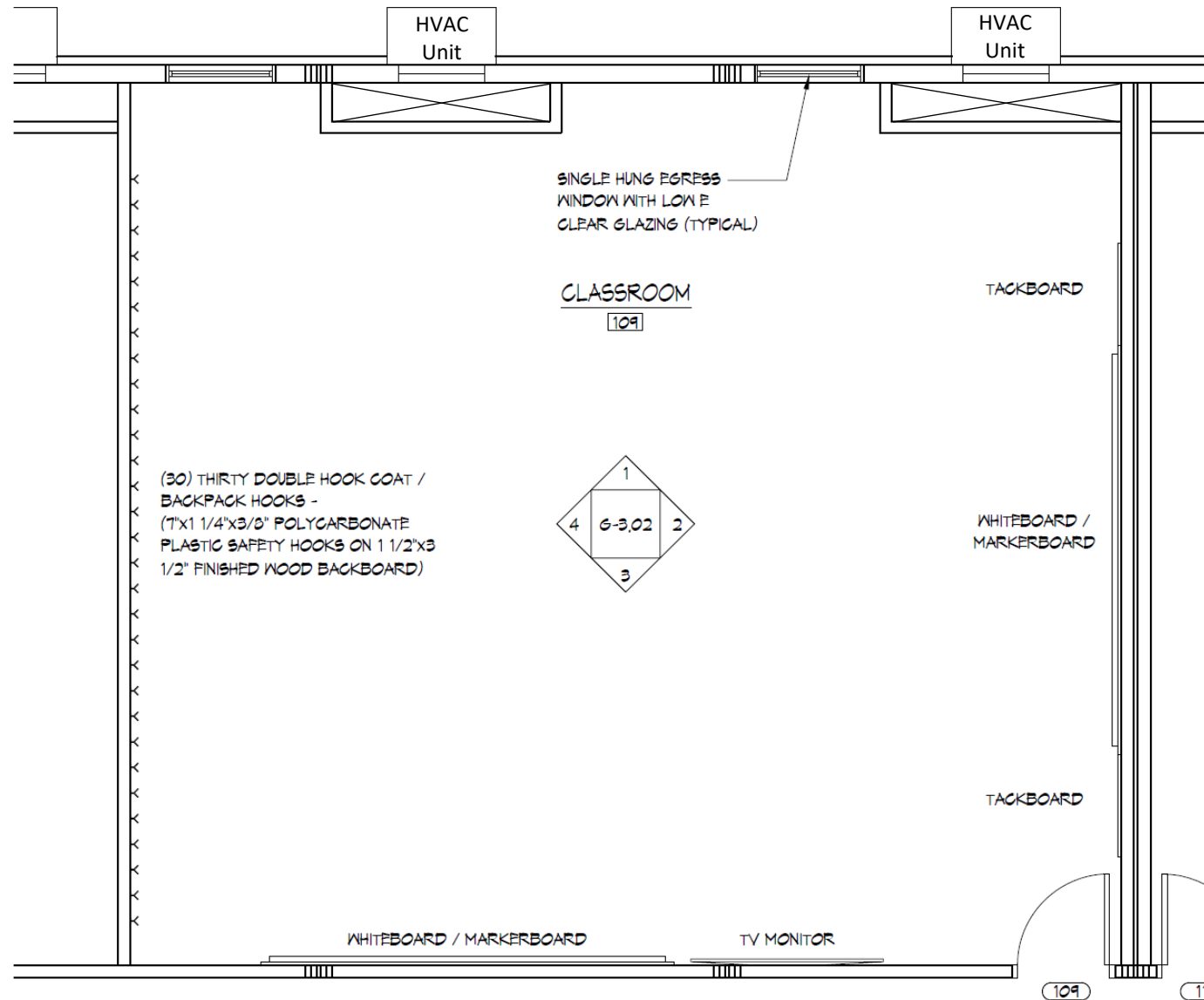



# Modular Classrooms – Aerial View of Similar Installation



D'HUY Engineering, Inc.



Modular  
Classrooms



*Sandy Run Middle School, Upper Dublin School District*



# Modular Classrooms – Typical Exterior



D'HUY Engineering, Inc.



Elevation View

*Sandy Run Middle School,  
Upper Dublin School District*



Elevation View with HVAC Units



Exterior Building Connector



# Modular Classrooms – Typical Interior



D'HUY Engineering, Inc.



Typical Classroom

*Sandy Run Middle School, Upper Dublin School District*