



**AGENDA FOR THE REGULAR BOARD MEETING**  
**Monday, November 21, 2022 - 6 pm**  
**Union Event Center, 12509 N. Market St., Bldg. D, Mead, WA 99021**

**Webinar Link: [mead354-org.zoom.us/j/87924839896](https://mead354-org.zoom.us/j/87924839896)**  
**Or Call 669-900-6833 Webinar ID 879 2483 9896**

- I. PLEDGE OF ALLEGIANCE**
- II. APPROVAL OF AGENDA** (Action)
- III. APPROVAL OF MINUTES** (Action)  
Approval of the Minutes of the Regular Board Meeting of November 7, 2022
- IV. REMARKS FOR THE GOOD OF THE SCHOOLS - Public Comment**
- V. CONTINUING BUSINESS - none**
- VI. NEW BUSINESS**
  - A. Consent Agenda**  
Vouchers, Personnel Actions, Extra-Curricular and Supplemental Contracts (Action) 1
  - B. Highly Capable Program Update & Grant Renewal Authorization** (Action) 2  
(Presented by: *Rob Haugen, Director Elementary Education*)
- VII. REPORTS**
  - A. Financial Report for the month of October 2022** 3  
(Presented by: *Heather Ellingson, Chief Financial Officer*)
  - B. Superintendent's Report**
- VIII. ADJOURN**

**Public Participation – Policy 1430**

The Board recognizes the value of public comment on educational issues and the importance of involving members of the public in its meetings. Therefore, the opportunity for individuals (staff, guests and/or district residents) to express an opinion is provided at the beginning of School Board meetings. Per Policy 1430 public comment should relate to agenda items. Those wishing to speak must sign-in with: name, address, phone number and topic being addressed. Sign-in must be done prior to the beginning of the meeting before the gavel has dropped. If a group wishes to speak, it is recommended they choose a spokesperson to speak on behalf of the group. The Board President will recognize each speaker and invite him/her to step up to the podium. Comment time is limited to three (3) minutes. Individuals making public comments are asked to refrain from any inappropriate behavior, including but not limited to: clapping, shouting and/or sarcastic, vulgar or disrespectful language or actions. The School Board will not respond to public comments during the meeting. The board may express regret regarding the speaker's concerns and thank them for their contribution. This allows the Board time to confer with district staff and gain valuable knowledge before determining whether or not to more fully respond to a speaker's comments.

**Individuals with disabilities who may need a modification to participate in a meeting should contact the Superintendent's office no later than three days before a regular meeting and as soon as possible in advance of a special meeting so that arrangements for the modification can be made.**



**Minutes from the Regular Meeting of the Board of Directors  
Monday, November 7, 2022**

---

The Board of Directors held a Regular Board Meeting on Monday, November 7, 2022. This meeting was held in-person and virtually via a Zoom link posted on the Mead School District website. Directors Burchard, Denholm, Olson, Cannon and Gray were present. Also attending were Superintendent Shawn Woodward, Chief Financial Officer Heather Ellingson and Assistant Superintendents Heather Havens and Jared Hoadley.

**I. Pledge of Allegiance**

The meeting began with President Burchard asking all to rise for the Pledge of Allegiance.

**II. Approval of Agenda**

Director Cannon made a motion to approve the meeting agenda, as amended (Executive Session to review the performance of a public employee was added). Director Gray seconded the motion. The motion carried unanimously.

**III. Approval of Minutes**

Director Olson made a motion to approve the minutes of the October 24, 2022, Regular Board Meeting, as presented. Director Cannon seconded the motion. The motion carried. (President Burchard abstained as he was excused from the October 24<sup>th</sup> board meeting.)

**IV. Remarks for the Good of the Schools – Public Comment**

Noting there were no community members/individuals present who signed-up to speak on agenda topics, President Burchard opened the floor for board/staff comments.

*Board/Staff Comments*

Director Denholm was very complimentary of the *Battle of the Bell* football game between Mead High School and Mt. Spokane High School that took place at Union Stadium on October 28, 2022. Director Olson added his thanks to the community for attending noting “the stadium was packed!” The concession stand was very busy all evening and it was perfect football weather. Director Cannon also noted it was a great night for the Mead School District community.

Director Cannon, who had the opportunity to attend two recent soccer matches, noted both events were very competitive and the atmosphere was “electric.” He added his congratulations to the Mead High School soccer team who qualified for State. Director Cannon additionally positively commented on the Jazz Band Concert he attended at Mt. Spokane High School where nine different jazz bands performed.

Director Gray, who was able to tour both the Maintenance Department and Transportation Department on Friday, November 4<sup>th</sup>, shared how impressed she was with how well both staffs handled the first snow event of the year and expressed her thanks for their outstanding “behind the scenes” work.

Darren Nelson, Director of Secondary Education, shared the following upcoming and recently completed events/contests for high school and middle school athletics and activities:

### **Marching Band**

Mead High School completed their season with a 3<sup>rd</sup> place overall finish (just behind Ridgeline & West Salem) at the NW Association of Performing Arts Century Challenge held in Hillsboro, Oregon. The Mt. Spokane Marching Band had the unique opportunity to open for CMT winner Chris Young at the Spokane Pavilion the weekend before Halloween. Mr. Nelson extended special thanks to Marching Band Directors Sy Hovik & Andrew Savage (Mt. Spokane) and Brandon Campbell & Rob Lewis (Mead High) on outstanding Marching Band seasons.

### **Fall Theatre Productions**

The Mt. Spokane High School Theatre Arts Department will perform *A Christmas Carol*, November 17-19 & December 1-3. The Mead High School Theatre Arts Department will perform *Leaving Iowa*, November 9, 10 & 16-19. All performances start at 7 pm.

### **Choir**

Highland Middle School is hosting a Veteran's Day Concert on November 8<sup>th</sup> at 6 pm.

### **Band**

Highland Middle School is hosting a Jazz Band Concert on November 15<sup>th</sup> at 7 pm.

### **Math Is Cool**

At the 2022 *High School Math Is Cool* competition the Mt. Spokane 9<sup>th</sup> and 10<sup>th</sup> grade teams placed 1<sup>st</sup> with the 12<sup>th</sup> grade team placing 2<sup>nd</sup>.

### **State Cross-Country**

Mead Girls placed 7<sup>th</sup>, Mt. Spokane Girls were 11<sup>th</sup>, Mead Boys placed 6<sup>th</sup> and Mt. Spokane Boys earned the 3<sup>rd</sup> place trophy.

### **Slowpitch Softball**

Mead High School earned a trip to the State Championship Game and took home the 2<sup>nd</sup> place trophy. Mt. Spokane placed 3<sup>rd</sup> at State.

### **Volleyball**

Both the Mead High and Mt. Spokane teams are vying for the opportunity to qualify for the upcoming State tournament. Mt. Spokane plays in a "loser out" match against Cheney on November 8<sup>th</sup>, with Mead High School taking on Ridgeline on November 8<sup>th</sup> with the winner qualifying for State. If Mead were to lose they would take part in a "play in" match on Saturday, November 12<sup>th</sup>.

### **Girls Soccer**

Both Mt. Spokane and Mead High qualified for Districts where Mt. Spokane defeated Walla Walla in Round 1, lost to Mead in Round 2 and, in Round 3, lost to Southridge ending their season. Mead High defeated Cheney in Round 1, defeated Mt. Spokane in Round 2, lost to Ridgeline in Round 3, then bounced back to defeat Southridge earning them the #10 seed into the Round of 16 State tournament. Mead will play #7 Roosevelt High School at Auburn Mountainview on Friday, November 11<sup>th</sup>.

### **Football**

Mt. Spokane, the undefeated GSL champions, defeated Lake Washington in the Round of 32 to qualify for the Sweet 16 as a #6 seed. They will play Stanwood (#11 seed) at Union Stadium on Friday, November 11<sup>th</sup>, 6 pm kickoff. Mead High, who placed 3<sup>rd</sup> in the GSL, defeated Timberline in the Round of 32 and also qualified for

the Sweet 16 as a #12 seed. They will play at #5 Bellevue on Saturday, November 12<sup>th</sup> at noon (tentative kickoff time).

**V. Continuing Business - none**

**VI. New Business**

**A. Consent Agenda**

In response to a question from Director Olson, who noted the sizeable monetary and in-kind (books) donations to the Mead Student Resource Hub, Public Information Officer Todd Zeidler explained the Mead Student Resource Hub, run by Student Services Coordinator Kelly Schultz, is located at the old Northwood site and provides basic schools supplies, hygiene products and clothing for students in need. President Burchard noted, in particular, the \$750 donation to the Mead Student Resource Hub from the Mead Bus Driver's union.

Director Cannon made a motion to approve the Consent Agenda, as presented. Director Olson seconded the motion. The motion carried unanimously.

**Consent Agenda**

**1. Hired Certificated Personnel:**

Karly Wittkopp	Mead High	Cert	.8 FTE Continuing Math teacher effective 9/28/22
Cheyenne Wolf	Mead High	Cert	1.0 FTE Continuing ELA/SS teacher effective 10/17/22
Angela Thedens	Creekside	Cert	.2 FTE Leave Replacement Music Teacher (in addition to .5 FTE Continuing) 22/23 school year effective 10/17/22

**2. Hired Classified Personnel:**

Carter VandenDriessche	Custodial Services	Class	8 hrs/day Custodian II effective 10/20/22
David Hutson	Transportation	Class	4 hrs/day Bus Driver effective 9/19/22
Heather Ruiz	Evergreen	Class	6.25 hrs/day Para Ed effective 10/18/22
Angel Baumann	Colbert	Class	6.10 hrs/day Para Ed effective 10/12/22
Jennifer Noonan	Colbert	Class	6.10 hrs/day Para Ed effective 10/13/22
Jennifer Thomas	Mt. Spokane	Class	8 hrs/day Data Processor effective 10/20/22
Naysha Richmond	Mead High	Class	6.15 hrs/day Para Ed effective 10/17/22
Tasha Marchand	Student Services	Class	6.25 hrs/day Classified Nurse effective 10/25/22

**3. Hired Certificated Substitutes:**

Jennifer Tourgee | Jessica Scruggs | Jacobe Valenzuela |

**4. Hired Classified Substitutes:**

Heidi Hogan | Michael Ferrell | Shirley Schrawyer | Alexandria Wiltse  
 Mari Heaton | Danika Enfield | Robert Meilke | Charles Oliver

**5. Approved AP Vouchers for General Fund, Capitol Projects, Private Purpose Trust & ASB.**

Vouchers audited and certified by auditing officers as required by RCW 42.24.080, and those expense reimbursement claims certified as required by RCW 42.24.090, have been recorded on a listing which has been made available to the Board. As of this day, **November 7, 2022**, the Board, by a unanimous vote does approve for payment the vouchers included in the above referenced list and further described as **Warrant Numbers 108584 to 108841** in the following amounts:

<u>Fund</u>	<u>Amount</u>
General Fund - AP	\$ 730,093.89
General Fund - PR	11,154,985.90
ASB Fund	88,999.74
Capital Projects Fund	16,403.04

**6. Declared Items as Surplus.**

**7. Accepted the Following Donation:**

- \$750 from Bloomsday Road Runners to Mead High School Cheerleaders
- \$300 from Schweitzer Engineering Labs to Prairie View Elementary
- 750 reading books (approx. value \$4,500) from Ella Fitzgerald Charitable Foundation to Mead Student Resource Hub
- \$1,500 from CBRE Project Management to Mead Student Resource Hub
- \$3,000 from Dorian Photography to Mead Student Resource Hub
- \$750 from Mead Bus Driver Union to Mead Student Resource Hub

**8. Approved Request for Unpaid Leave (i.e., parenting, medical Good of the District, etc.):**

Tasha Marchand	Colbert	Class	Jan 5-6, 2023
Katie Patry	Special Services	Cert	2 <sup>nd</sup> Semester 22/23
Melissa Kehr	Special Services	Cert	2 <sup>nd</sup> Semester 22/23

**9. Approved Requests for Retirement/Resignation:**

Carter VandenDriessche	Custodial Services	Class	Resignation effective 11/9/22 (Custodian II)
Colleen Ferguson	Northwood	Class	Resignation effective 10/31/22 (Cook III)
Robert Hess	Transportation	Class	Retirement effective 12/31/22 (Bus Driver)
Angela Puri	Mountainside	Class	Resignation effective 12/16/22 (Para Ed)

**B. Resolution 22-10  
Transferring Territories in Director Districts**

Chief Financial Officer Heather Ellingson presented Resolution 22-10, Transferring Territories in Director Districts, for board consideration. RCW 29A.76.010 requires school districts in the state of Washington to review, and if necessary, make changes to Director District Boundaries from time to time as the population of the district changes. This process takes place every ten years after census data is collected.

Sammamish Data Systems has assisted the district in modifying the current boundaries so that each Director District has essentially the same population. The ideal population for each Director District, based on a total population of 61,433 is 12,287. In the presented resolution boundary totals range from a high of 12,336 (District #3) to a low of 12,226 (District #1).

A public hearing on the proposed boundary changes was held on October 24, 2022, at the regularly scheduled board meeting. There were no public comments made on the proposed boundaries at that meeting. The proposed boundaries have also been posted on the Mead School District homepage since October 4, 2022.

Director Cannon made a motion to adopt Resolution 22-10, Transferring Territories in Director Districts, as presented. Director Denholm seconded the motion. The motion carried unanimously. A copy of the resolution is attached.

**C. Student Travel Proposal  
Mead High School Girls Basketball**

Darren Nelson, Secondary Education Director, presented a request from the Mead High School Girls Basketball team to travel to Phoenix/Tempe, Arizona, December 26-31, 2022, to compete in the *Cactus Jam* basketball tournament where they are guaranteed three games against high caliber competition.

It is estimated twelve student athletes will participate, accompanied by three chaperones/coaches including Head Coach Quantae Anderson. The proposed trip takes place during Winter Break so no school will be missed.

The estimated per student cost of the trip is \$1,360 with fundraising opportunities available. Coaches/chaperones will cover their own travel expenses. Mr. Nelson additionally noted the proposal takes into consideration House Bill 1660 and that money will not be an attendance issue for any student who qualifies under the provisions of this bill.

In response to a question from Director Gray, Mr. Nelson shared the team took a similar trip a few years ago and that the trip is comparable in nature to the Phoenix trip taken this fall by the Mead High School Volleyball team. Mr. Nelson is unaware of a similar trip planned for this year by Mt. Spokane's team.

Director Olson made a motion to approve the request from the Mead High School Girls Basketball team to travel to Phoenix/Tempe, Arizona, to participate in the *Cactus Jam* basketball

tournament December 26-31, 2022, as presented. Director Gray seconded the motion. The motion carried unanimously.

**D. Resolution 22-07 Revision  
2022/23 School Nutrition Fees**

Nutrition Services Director Kim Elkins presented a revision to Resolution 22-07, 2022/23 School Nutrition Fees, for board consideration. On August 15, 2022, the board approved school nutrition fees for the 2022/23 school year, which included no change in the amount charged for an adult breakfast.

Since approval on August 15<sup>th</sup>, a new price calculator has been released by the U.S. Department of Agriculture resulting in the need to increase the price of an adult breakfast from \$3.00 to a minimum of \$3.10. Nutrition Services recommends increasing the price to \$3.25. It is hoped the \$3.25 price will be able to remain the same through 2023/24.

While not directly related to the presented resolution revision, Director Gray inquired about scratch cooking versus serving pre-prepared, processed items. She noted in particular parent concerns shared with her about the serving of *Trix* yogurt and cereal bars at breakfast.

While a cost analysis to transition to primarily scratch cooking would involve a big study, Ms. Elkins estimated it would result in additional expenditures of \$300,000 - \$400,000, primarily due to increased labor costs. Currently the district provides both scratch and pre-prepared items. Other considerations/items of note shared by Ms. Elkins included the following:

- In Mead, Nutrition Services operates on a balanced budget. That is not the case in all school districts.
- Student food preferences matter. If they don't/won't purchase what is served it is counterproductive.
- Time is a consideration as there is not a lot of time after breakfast to get lunch ready.
- Nutrition Services is always looking to spend the money it receives in the best possible way. Whenever feasible they buy local including fresh fruits and vegetables that are purchased with grant dollars.
- In Spokane, where approximately 50% of students receive free or reduced lunch, they experimented with serving minimally processed foods but ended up removing many labor intensive items because of the cost.
- In the past few years food manufacturers have greatly improved the quality of pre-prepared items.

Director Cannon made a motion to approve the revision/amendment to Resolution 22-07, 2022/23 School Nutrition Fees, as presented. Director Denholm seconded the motion. The motion carried unanimously. A copy of the amended resolution is attached.

**E. Award of Supplemental Prime Vendor Contract**

Nutrition Services Director Kim Elkins presented a Supplemental Prime Vendor Contract with Good Source Solutions/Gold Star Foods for board consideration. Access to RFP 7-2122, Supplemental Prime Vendor, is available through the district's interlocal agreement with Spokane Public Schools.

The district's Prime Vendor is US Foods who partners well with the district. However, issues with distribution and manufacturing shortages continue to disrupt the supply chain and product availability across the United States. In an effort to minimize unexpected issues and provide a stable supply of core menu products, Nutrition Services recommends awarding a Supplemental Prime Vendor Contract to Good Source Solutions/Gold Star Foods.

Nutrition Services has previously used this distributor as a sole source supplier of some menu products and has been please with their customer service and product quality. Overall pricing is consistent with similar products at US Foods.

Director Cannon made a motion to award SPS RFP 7-2122, Supplemental Prime Vendor contract, for the 2022/2023 school year to Good Source Solutions/Gold Star Foods, as presented. Director Olson seconded the motion. The motion carried unanimously.

## **VIII. Reports**

### **A. 2021/2022 Year End Financial Report**

Chief Financial Officer Heather Ellingson presented the 2021/2022 Year-End Financial Report, which covers September 1, 2021 through August 31, 2022. At the conclusion of any fiscal year it typically takes 6-8 weeks to close out the books. Report highlights included the following:

- The net change in fund balance, budgeted to be a reduction of \$7,216,319, ending up being much less . . . only \$1,529,372.
- The year-end fund balance is \$13,524,316, which is 9.01% of budgeted expenditures. This is below the targeted percentage set forth in the district's fund balance policy.
- Included in the fund balance are restricted monies. Restricted funds include approximately \$1.5 million that must be spent on Nutrition Services related items, as well as monies set aside to cover compensated absences.
- In reviewing revenue sources, it was noted the vast majority of one-time COVID related federal stimulus money has been spent.
- Revenues and expenditures, broken out by Sub-Fund 10 (state) and Sub-Fund 11 (local), were reviewed.
- Year-end, long-term liabilities were reviewed. These include voted bonds, Chromebook leases, compensated absences and pension liabilities.
- A breakdown of expenditures by Program, Activity and Object was reviewed.

President Burchard thanked Ms. Ellingson and her team for an excellent presentation. He knows, from a financial standpoint, the last few years have not been easy.

Recognizing the fund balance goal as set forth in policy was not achieved, President Burchard noted the need to come up with a plan/process to achieve the goal of having one month's payroll in reserve. Ms. Ellingson shared the district will not be in a position to attain the stated fund balance goal in the near future as expenditures are expected to exceed revenues again in the 2022/23 school year. Superintendent Woodward reminded this is not a surprise. The district declared a "financial emergency" last spring for the 2022/23 school year and made reductions totaling \$2.8 million. Further reductions will need to be made again this spring that will impact the 2023/24 school year. Superintendent Woodward additionally noted the importance of having levy rate discussions by early summer along with the development of a communication plan to share financial information with stakeholders.

Director Olson expressed his appreciation that a predicted reduction in fund balance for 21/22 of \$7.2 million only ended up being \$1.5 million.

In response to questions from Director Cannon, Ms. Ellingson shared there is no expenditure listed for Skills Center as Spokane Public Schools, who operates the program, rather than charging Mead claims the FTE for the periods students attend. Regarding COVID related revenue of \$4.7 million in 2021/22, and whether expenses this stimulus money was used for no longer exist, Ms. Ellingson shared there will no longer be a need for PPE but noted the majority of the monies received were used to cover staffing costs.

Regarding the amount of money the district receives from the state, Director Denholm noted it would be very impactful if that money was ever withheld.

## **B. Financial Report for the Month of September 2022**

Chief Financial Officer Heather Ellingson presented a brief financial report for the month of September 2022. As shared earlier in the 2021/22 Year End Financial Report, it is projected that in the 2022/23 school year expenses will exceed revenues by approximately \$5 million. Even though enrollment is higher than budgeted the additional revenue generated from this increase (approximately \$1 million) will be offset by a loss in LEA funding (approximately \$1.5 million). The decrease in LEA funding is a result of the 30% increase in assessed values throughout Spokane County. This substantial increase has, unfortunately, thrown state funding formulas "out of whack" resulting in less money for the district.

## **C. Superintendent's Report**

Topics covered in Superintendent Woodward's report included the following:

#1 - An enrollment table was shared that included K-12 enrollment by grade level for the past six years. Prior to the pandemic total enrollment was 10,530 (October 2019). That dropped to 10,072 in 2020 and, while improved, October 2022 enrollment of 10,266 is still below pre-pandemic levels. The loss of revenue associated with this decline in enrollment, coupled with the overhead associated with opening three new schools (Creekside, Highland & Skyline) that were built assuming continuing growth, as well as Union Stadium operating costs, an IPD of 5% in 2022/23 that is not fully-funded by the state, and an anticipated IPD of 5-6% next year, have resulted in a "perfect storm" from a financial standpoint for the district. The loss in revenue, based on decreased enrollment from 2019 to 2022, is \$2.5 million (245 FTE).

Superintendent Woodward invited board members to take some time to look over the information provided and email him with questions. In the meantime, the district will be looking more closely at the number of students enrolled in Running Start and Skills Center. President Burchard noted some of the grade level enrollment fluctuations from year-to-year seem irrational and Director Cannon shared he would like to see Running Start enrollment data. Director Denholm is interested in seeing out-of-district enrollment information.

#2 - Regarding the Facilities Planning Committee that was authorized to begin meeting this fall to make a recommendation on future facility needs in the district, Superintendent Woodward shared a temporary hold has been placed on that work due to the fact that enrollment has not increased in line with projections. Additionally, inflation and higher interest rates have impacted residential construction.

#3 - Superintendent Woodward reminded board members about the upcoming Future Ready event taking place at Union Event Center on November 9<sup>th</sup> from 3:30-5 pm. It is anticipated 60-80 individuals will be in attendance. This will be the first of many conversations on the topic of future readiness.

## **VIII. Executive Session**

At 7:15 pm President Burchard called for an Executive Session of approximately 15 minutes for the purpose of reviewing the performance of a public employee.

At 7:30 pm President Burchard returned the meeting to Open Session. No other business was discussed and no action was taken.

## **IX. Adjourn**

The meeting was adjourned at 7:30 pm.

---

President

---

Secretary





**RESOLUTION 22-10**  
**Transferring Territories in Director Districts**

**WHEREAS**, RCW 29A.76.010 requires the Mead School District Board of Directors to review and, if necessary, make changes to the boundaries of Board Member Director Districts so as to provide, so far as practicable, equal representation according to population, and

**WHEREAS**, the data compiled from the 2020 U.S. Census illustrates a population imbalance in most Director Districts.

**NOW THEREFORE BE IT RESOLVED**, that the Mead School District Director Districts have been revised per the attached Director District Boundary Proposal dated September 22, 2022 in order to provide, as far as practicable, equal representation according to population.

**ADOPTED** by the Board of Directors of Mead School District No. 354, Spokane County, Washington and authenticated by the signatures affixed below.

Dated this 7<sup>th</sup> day of November, 2022.

Attest:

Secretary to the Board

Mead School District No. 354  
Board of Directors

**Mead School District -  
Proposed Board Districts  
as Approximated Using  
Census 2020 Geography**

1st District



2nd District



3rd District



4th District



5th District

City Limits

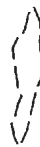

District Outline



Sectional  
Centers



Townships

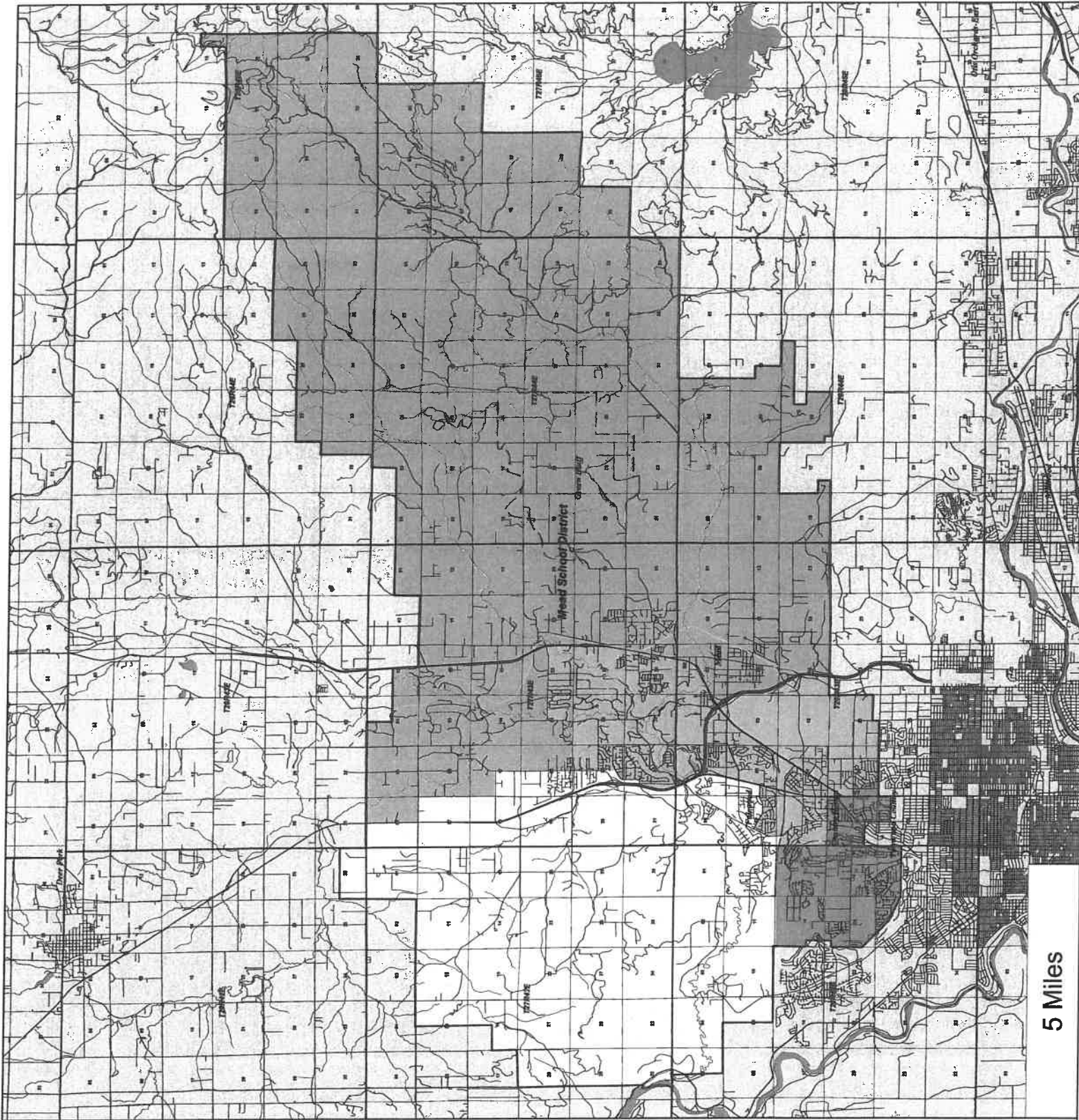

5 Miles

Summary of Population by Race and Hispanic Origin

District Number	Total Population	Total Population by Race										Two or More Races		Hispanic Origin (of any race)
		Single Race										Total	Total	
		Total	White	Black African American	American Indian and Alaska Native	Asian	Hawaiian and Other Pacific Islander	Native Hawaiian and Other Pacific Islander	Other Race					
1st	12,226	11,286	10,581	137	120	214	83	151	940	606				
2nd	12,310	11,339	10,742	120	91	220	18	148	971	642				
3rd	12,336	11,020	9,607	337	178	423	187	288	1,316	774				
4th	12,271	11,234	10,130	178	142	507	91	186	1,037	700				
5th	12,290	11,284	10,836	59	115	106	22	146	1,006	491				
Totals.....	61,433	56,163	51,896	831	646	1,470	401	919	5,270	3,213				

## Mead School District District Summary Report

Director District Number	Ideal Population	Total Population	Deviation from Ideal	% Deviation from Ideal	White Population	Hispanic Origin (of any race)	Non White & Mixed
1st	12,287	12,226	-61	-0.50	10,581	606	1,645
2nd	12,287	12,310	23	0.19	10,742	642	1,568
3rd	12,287	12,336	49	0.40	9,607	774	2,729
4th	12,287	12,271	-16	-0.13	10,130	700	2,141
5th	12,287	12,290	3	0.02	10,836	491	1,454
Totals.....		<u>61,433</u>	<u>-2</u>		<u>51,896</u>	<u>3,213</u>	<u>9,537</u>

**Mead School District -  
Proposed Board Districts  
as Approximated Using  
Census 2020 Geography**

- 1st District
- 2nd District
- 3rd District
- 4th District
- 5th District



**City Limits**

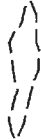

**District Outline**



**Sectional Centers**



**Townships**

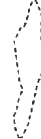

**2 Miles**

**Mead School District -  
Proposed Board Districts  
as Approximated Using  
Census 2020 Geography**

1st District



2nd District



3rd District



5th District

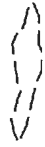

City Limits



District Outline



Sectional  
Centers

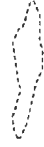

Townships

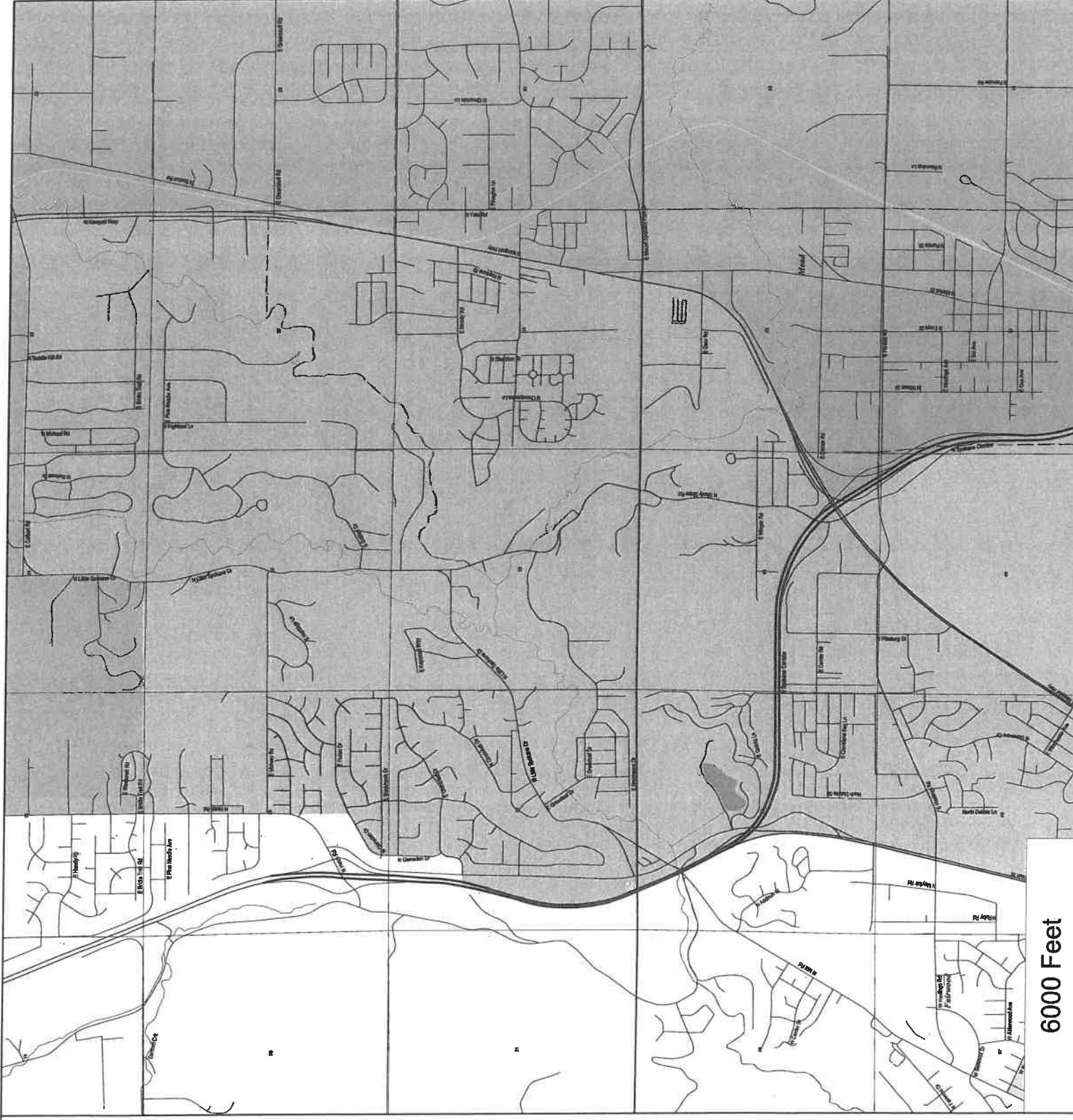

6000 Feet

**Mead School District -  
Proposed Board Districts  
as Approximated Using  
Census 2020 Geography**

1st District



2nd District



3rd District



4th District



5th District

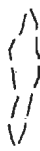

City Limits



District Outline



Sectional  
Centers

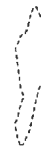

Townships

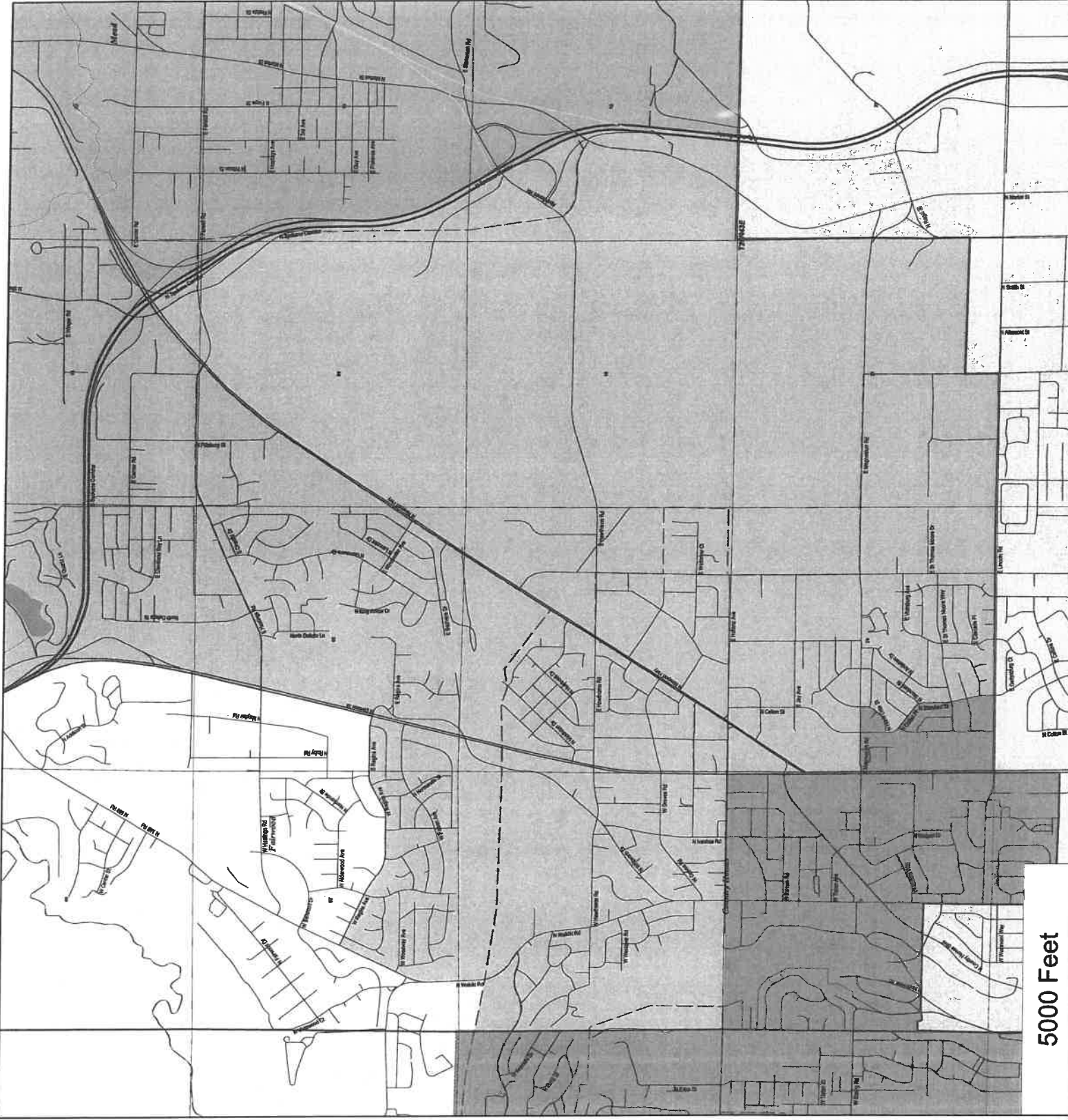

5000 Feet

**Mead School District -  
Proposed Board Districts  
as Approximated Using  
Census 2020 Geography**

1st District



2nd District



3rd District



4th District

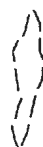

City Limits



District Outline



Sectional  
Centers

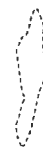

Townships



5000 Feet



**Mead School District -  
Proposed Board Districts  
as Approximated Using  
Census 2020 Geography**

1st District



2nd District



3rd District



4th District



5th District

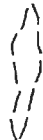

City Limits



District Outline



Sectional  
Centers



Townships

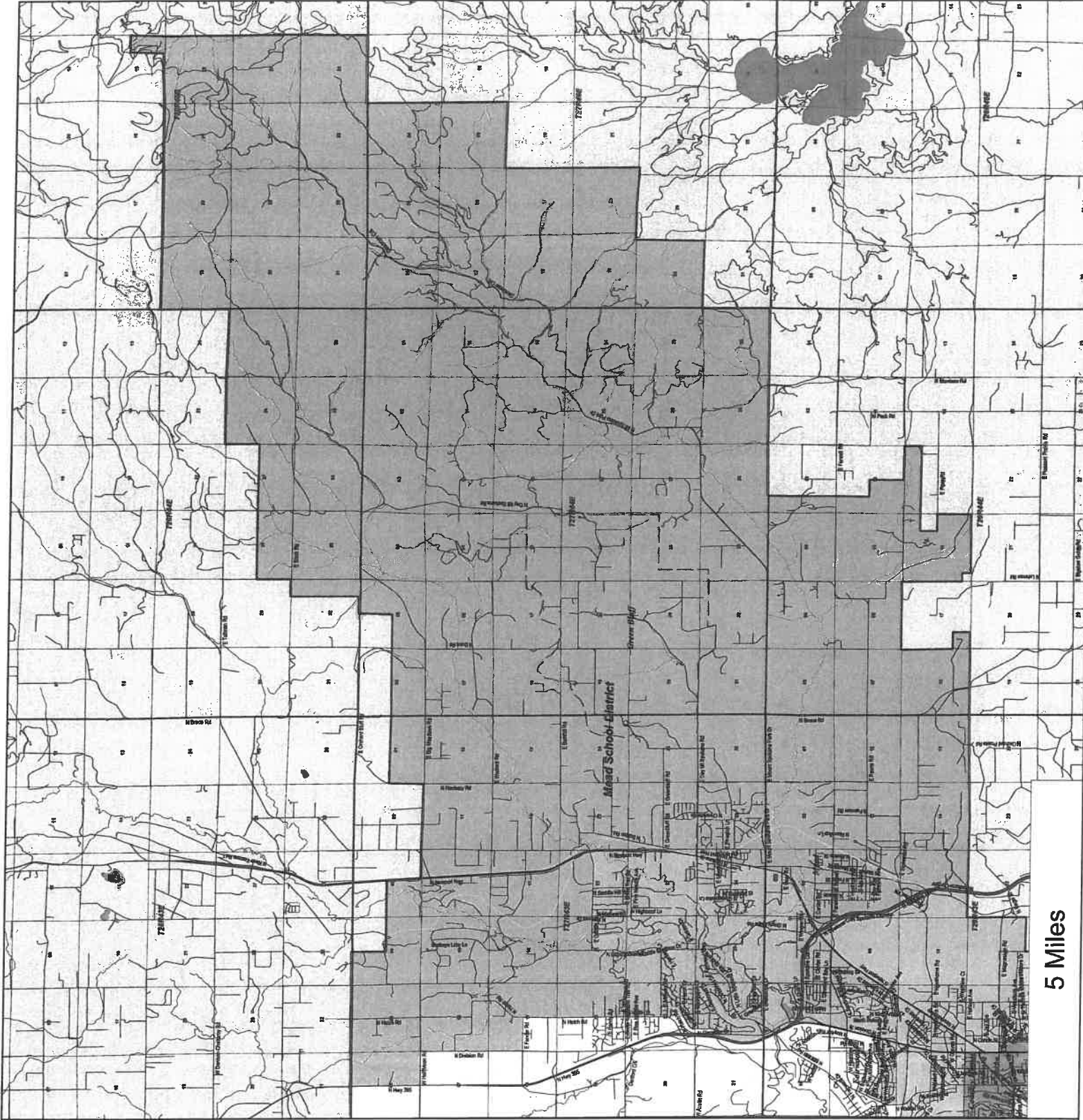

5 Miles



**RESOLUTION 22-07 - AMENDED  
2022/23 School Nutrition Fees**

**WHEREAS**, fees and budget policies for school nutrition fees are incorporated into the operations of the school budget,

**NOW, THEREFORE BE IT RESOLVED** by the Board of Directors that the amounts set forth on the attached 2022/2023 Meal Price Recommendation be established and administered in the 2022/2023 operating budget.

**ADOPTED** by the Board of Directors of Mead School District No. 354, Spokane County, Washington and authenticated by the signatures affixed below.

Dated this 7<sup>th</sup> day of November, 2022.

Attest:

Secretary to the Board

Mead School District No. 354  
Board of Directors



Nutrition Services  
12509 N. Market St. Bldg E, Mead, WA 99021  
Telephone (509) 465-6100 FAX (509) 461-5111

### 2022-2023 Meal Price Recommendation

	<b>Current Breakfast</b>	<b>Proposed Breakfast</b>	<b>Current Lunch</b>	<b>Proposed Lunch</b>
<b>Elementary</b>	<b>1.60</b>	<b>1.85</b>	<b>2.85</b>	<b>2.95</b>
<b>Middle</b>	<b>1.85</b>	<b>2.00</b>	<b>3.40</b>	<b>3.50</b>
<b>High</b>	<b>1.85</b>	<b>2.00</b>	<b>3.40</b>	<b>3.50</b>
<b>Adult</b>	<b>3.00</b>	<b>3.25</b>	<b>5.00</b>	<b>No change</b>
<b>Milk</b>	<b>.65</b>	<b>No change</b>	<b>.65</b>	<b>No change</b>

## MEAD SCHOOL DISTRICT

Board Meeting of November 21, 2022

**New Business**

**VI.A.**

**Agenda Item: Consent Agenda**

**Background:**

The Consent Agenda contains items that are normal and customary in the operation of the school district.

**Fiscal Impact:**

The Consent Agenda items have no significant impact beyond the adopted budget. Expenditure or employment requests that exceed budget authorization should not appear as a consent item.

**Staffing Implications:**

None, other than the personnel recommendations, as presented.

**Other Considerations:**

None

**Recommendation:**

Approval of the Consent Agenda, as presented, is recommended.

**Consent Agenda**  
**Regular Board Meeting of November 21, 2022**

**1. Hire Certificated Personnel:**

Emily Glutting	Special Services	Cert	1.0 FTE Continuing Elementary Compass teacher effective 10/17/22
Jessica Yates	Special Services	Cert	.6 FTE Leave Replacement SLP 2 <sup>nd</sup> semester 22/23 in addition to .6 FTE Leave Replacement SLP 1 <sup>st</sup> semester 22/23

**2. Hire Classified Personnel:**

Brenda Chappell | Colbert | Class | 6.1 hrs/day DLC Para Ed effective 10/17/22

**3. Hire Certificated Substitutes:**

Benjamin Alva	Aaron Bagnall	Gareth Goans	Amanda Long
Kimberly Smith	Michael Bartlett	McKinlee Baum	Jason Wortmann
Brianna Bazaldua			

**4. Hire Classified Substitutes:**

Kyler Kanzler	Micah Johnson	Michell Sicilia	Hailey Johnson
Samantha Rose			

**5. Approve AP Vouchers for General Fund, Capitol Projects, Private Purpose Trust and ASB, as attached.**

**6. Approve Co-Curricular, Extra-Curricular and Supplemental Contracts (attached).**

**7. Approve Request for Unpaid Leave (i.e. parenting, medical, Good of the District, Etc.):**

Kaprina Reed	Mt. Spokane	Cert	.2 FTE 2 <sup>nd</sup> Semester 22/23
Marcella Lybbert	Mead Learning Options	Cert	.4 FTE 2 <sup>nd</sup> Semester 22/23
Andrea Anderson	Mountainside	Cert	2 <sup>nd</sup> semester 22/23

**8. Approve Retirements and Resignations:**

Stephanie Kuest	Mead High	Class	Resignation effective 11/18/22 (Para Ed)
Marcus Peschel	Transportation	Class	Resignation effective 11/25/22 (Bus Driver)



# General Fund

## Mead School District No 354

### Payee Listing

Fiscal Year: 2022-2023

**Criteria:**

**Bank Account:** SPOKANE COUNTY TREASURER  
153607390207

**Voucher:** 1058

**Starting Check Number:** 108842

Check #	Date	Payee	Amount
108842	11/11/2022	A&D FIRE	\$260.00
108843	11/11/2022	ACE HARDWARE	\$43.56
108844	11/11/2022	ADVANCED PAGING & COMMUNICATIONS INC	\$219.65
108845	11/11/2022	AI-MEDIA TECHNOLOGIES LLC	\$2,277.00
108846	11/11/2022	ALLIANT INSURANCE SERVICE INC	\$30.00
108847	11/11/2022	AMAZON	\$580.50
108848	11/11/2022	AMERICAN ON SITE SERVICES	\$1,532.93
108849	11/11/2022	AMERICAN PRODUCE EXPRESS LLC	\$1,044.00
108850	11/11/2022	AMERIGAS PROPANE LP	\$1,280.55
108851	11/11/2022	ARTREACH CHILDREN'S THEATRE PLAYS	\$150.95
108852	11/11/2022	AVAIL HOME HEALTH INC	\$2,887.50
108853	11/11/2022	BLUUM OF TEXAS LLC	\$226.40
108854	11/11/2022	CAMP FIRE INLAND NORTHWEST	\$3,200.00
108855	11/11/2022	CENTURY LINK - SEATTLE	\$14.14
108856	11/11/2022	CITY OF SPOKANE - UTILITIES DIVISION	\$13,038.11
108857	11/11/2022	CO ENERGY	\$412.72
108858	11/11/2022	CONCESSIONS SUPPLY	\$575.45
108859	11/11/2022	CUSTOM MECHANICAL SOLUTIONS INC	\$2,395.80
108860	11/11/2022	DORIAN STUDIO	\$1,199.00
108861	11/11/2022	DUFFY, BRIDGET	\$5.95
108862	11/11/2022	EDUCATIONAL PRODUCTS, INC.	\$103,440.80
108863	11/11/2022	ESD 101	\$600.00
108864	11/11/2022	FIRST CHOICE SERVICES	\$69.76
108865	11/11/2022	FISHER'S TECHNOLOGY	\$1,527.38
108866	11/11/2022	FRED MEYER KROGER	\$44.52
108867	11/11/2022	GRADUATION ALLIANCE	\$62,273.42
108868	11/11/2022	GREATAMERICA FINANCIAL SERVICES	\$2,727.87
108869	11/11/2022	HAMPTON INN - WALLA WALLA	\$1,883.10
108870	11/11/2022	HARTER-LUPESOLIAI, DAELA	\$50.00
108871	11/11/2022	HENRY SCHEIN INC	\$88.97
108872	11/11/2022	HOFFMAN MUSIC CO	\$218.00
108873	11/11/2022	HOME DEPOT CREDIT SERVICES	\$173.44
108874	11/11/2022	HOME DEPOT PRO	\$447.70
108875	11/11/2022	HORIZON AUTOMATIC RAIN COMPANY DBA	\$4,624.24
108876	11/11/2022	INTERSTATE ALL BATTERY CENTER	\$629.38
108877	11/11/2022	JAE ENTERPRISES LLC	\$158.99
108878	11/11/2022	JOHNSON, KIMMERLY	\$237.50
108879	11/11/2022	JORDAN, JEREMY	\$57.00



# Mead School District No 354

## Payee Listing

Fiscal Year: 2022-2023

**Criteria:**

**Bank Account:** SPOKANE COUNTY TREASURER  
153607390207

**Voucher:** 1058

**Starting Check Number:** 108842

Check #	Date	Payee	Amount
108880	11/11/2022	JW PEPPER	\$666.45
108881	11/11/2022	KCDA	\$516.78
108882	11/11/2022	KENWORTH SALES SPOKANE	\$4,787.38
108883	11/11/2022	LANGUAGE LINE SERVICES INC	\$46.65
108884	11/11/2022	LAWSON PRODUCTS INC	\$500.98
108885	11/11/2022	LAYERS OF LEARNING	\$31.95
108886	11/11/2022	LEARNING A-Z	\$278.78
108887	11/11/2022	LEARNING WITHOUT TEARS	\$4.90
108888	11/11/2022	LINC FOODS	\$803.25
108889	11/11/2022	M & L SUPPLY	\$354.52
108890	11/11/2022	MAXIM STAFFING SOLUTIONS	\$1,214.95
108891	11/11/2022	NORTHWEST DISTRIBUTION	\$9,412.25
108892	11/11/2022	OTIS ELEVATOR	\$2,457.52
108893	11/11/2022	OXARC	\$22.40
108894	11/11/2022	PARK, JESSICA	\$6.85
108895	11/11/2022	PATRIOT FIRE PROTECTION INC	\$2,054.95
108896	11/11/2022	Peone, Grey Joseph	\$82.00
108897	11/11/2022	PETROCARD SYSTEMS INC	\$88,182.40
108898	11/11/2022	PICKA TIME	\$520.00
108899	11/11/2022	PROVIDENCE HEALTH CARE FOUNDATION	\$60.00
108900	11/11/2022	PTERA INC	\$255.00
108901	11/11/2022	PTM DOCUMENT SYSTEMS	\$658.10
108902	11/11/2022	RAINBOW RESOURCES	\$2,739.96
108903	11/11/2022	RIFTON EQUIPMENT	\$1,138.55
108904	11/11/2022	RWC INTERNATIONAL	\$1,531.83
108905	11/11/2022	SAFEGUARD BUSINESS SYSTEMS	\$107.30
108906	11/11/2022	SAFETY-KLEEN	\$255.65
108907	11/11/2022	SALT DISTRIBUTORS INC	\$6,020.45
108908	11/11/2022	SCHOOL SPECIALTY	\$59.29
108909	11/11/2022	SOLUTION TREE	\$2,600.00
108910	11/11/2022	SPELLING SUCCESS	\$41.67
108911	11/11/2022	SPOKANE CO ENVIRONMENTAL SERVICES	\$2,697.95
108912	11/11/2022	SPOKANE CO SOLID WASTE	\$401.52
108913	11/11/2022	SPOKANE TESTING SOLUTIONS	\$110.00
108914	11/11/2022	STARPLEX CORPORATION	\$3,619.00
108915	11/11/2022	STONEWAY ELECTRIC	\$219.56
108916	11/11/2022	SUN RENTAL	\$131.77
108917	11/11/2022	SUNSHINE DISPOSAL & RECYCLING	\$3,042.08

**Mead School District No 354**

**Payee Listing**

Fiscal Year: 2022-2023

**Criteria:**

**Bank Account:** SPOKANE COUNTY TREASURER  
153607390207

**Voucher:** 1058

**Starting Check Number:** 108842

Check #	Date	Payee	Amount
108918	11/11/2022	UNITED DATA SECURITY INC	\$90.00
108919	11/11/2022	US FOODS INC	\$6,027.41
108920	11/11/2022	US LINEN & UNIFORM INC	\$91.04
108921	11/11/2022	VENTRIS LEARNING LLC	\$324.92
108922	11/11/2022	WALTER E NELSON CO	\$54.54
108923	11/11/2022	WASA	\$2,020.65
108924	11/11/2022	WASTE MANAGEMENT OF SPOKANE	\$21,846.60
108925	11/11/2022	WEATHERNET	\$1,375.00
108926	11/11/2022	WHITWORTH WATER DIST 2	\$13,804.77
108927	11/11/2022	WSDOT	\$4,221.31
108928	11/11/2022	YOUNG, SHENEA	\$1,141.88
108929	11/11/2022	ZAYO ENTERPRISE NETWORKS	\$6,514.92
<b>Total Amount:</b>			<b>\$405,773.96</b>

End of Report

**Mead School District No. 354**

**Voucher Supplement Account Summary**

Fiscal Year: 2022-2023

Voucher Batch Number: 1059

11/11/2022

Vendor Remit Name	Vendor #	Account	Description	Amount
Ausband, Dorsey M		1.0.530.2130.27.8581.01.09.000.0000	TRAVEL-IN DISTRICT	\$42.50
			Vendor Total:	\$42.50
Balcheva, Petronia A		1.0.530.0100.27.8581.01.05.000.0000	TRAVEL-IN DISTRICT	\$30.00
			Vendor Total:	\$30.00
Baldwin, Rebecca L		1.0.530.0100.27.8581.01.05.000.0000	TRAVEL-IN DISTRICT	\$49.13
			Vendor Total:	\$49.13
Barville, Curtis M		1.1.530.0128.28.8582.28.03.000.0000	AD/SPORTS TRAVEL-OUT OF DISTRICT	\$82.00
			Vendor Total:	\$82.00
Beeman, Deann C		1.0.530.2133.26.8581.01.09.000.0000	TRAVEL-IN DISTRICT	\$74.50
			Vendor Total:	\$74.50
Belding-Wilson, Dawn		1.0.530.2133.26.8581.01.09.000.0000	TRAVEL-IN DISTRICT	\$31.88
			Vendor Total:	\$31.88
Bigelow, Rebecca Jean		1.0.530.2133.26.8581.01.09.000.0000	TRAVEL-IN DISTRICT	\$31.94
			Vendor Total:	\$31.94
Bone, Deborah J		1.0.530.2133.26.8581.01.09.000.0000	TRAVEL-IN DISTRICT	\$8.50
			Vendor Total:	\$8.50
Burke, John Joseph		1.0.530.9900.52.5190.09.36.000.0000	UNIFORM REPLACEMENT	\$100.00
			Vendor Total:	\$100.00
Carrell, Julia		1.0.530.2102.26.8581.01.09.000.0000	TRAVEL-IN DISTRICT	\$14.50

# Mead School District No 354

## Voucher Supplement Account Summary

Fiscal Year: 2022-2023

Voucher Batch Number: 1059

11/11/2022

Vendor Remit Name	Vendor #	Account	Description	Amount
Casedy, Tiffany			Vendor Total:	\$14.50
		1.1.530.0128.28.8582.28.03.000.0000	AD/SPORTS TRAVEL-OUT OF DISTRICT	\$123.00
			Vendor Total:	\$123.00
Cole, Christopher Scott				
		1.0.530.9900.52.5626.09.36.000.0000	GAS/DIESEL	\$134.39
			Vendor Total:	\$134.39
Daratha, Irvin Scott				
		1.1.530.0128.28.8582.27.27.000.0000	AD/SPORTS TRAVEL-OUT OF DISTRICT	\$112.00
			Vendor Total:	\$112.00
Delgadillo, Ana Maria				
		1.0.530.2102.26.8581.01.09.000.0000	TRAVEL-IN DISTRICT	\$33.64
			Vendor Total:	\$33.64
Elkins, Kimberly				
		1.0.530.9800.41.8581.07.07.000.0000	TRAVEL-IN DISTRICT	\$147.83
			Vendor Total:	\$147.83
Englehart, Vanessa Rivera				
		1.0.530.2102.26.8581.01.09.000.0000	TRAVEL-IN DISTRICT	\$29.38
			Vendor Total:	\$29.38
Finch, Mary Ellen Robeson				
		1.0.530.9800.41.8581.07.07.000.0000	TRAVEL-IN DISTRICT	\$12.75
			Vendor Total:	\$12.75
Fry, Jacob Christian				
		1.1.530.0128.28.8582.27.27.000.0000	AD/SPORTS TRAVEL-OUT OF DISTRICT	\$112.00
			Vendor Total:	\$112.00
Grieve, Marie				
		1.0.530.0100.27.5100.17.17.000.0000	TEACHING SUPPLIES	\$100.00
			Vendor Total:	\$100.00
Hancock, Maud Robin				
			Vendor Total:	\$100.00

# Mead School District No 354

## Voucher Supplement Account Summary

Voucher Batch Number: 1059

11/11/2022

Fiscal Year: 2022-2023

Vendor Remit Name	Vendor #	Account	Description	Amount
Helper, Jeanne Eggart		1.0.530.0100.27.8581.01.05.000.0000	TRAVEL-IN DISTRICT	\$45.94
			Vendor Total:	\$45.94
Hill, Alan Kirby		1.1.530.0128.28.8582.27.27.000.0000	AD/SPORTS TRAVEL-OUT OF DISTRICT	\$112.00
			Vendor Total:	\$112.00
Jaecks, Meredith Madeline		1.0.530.9900.52.5190.09.36.000.0000	UNIFORM REPLACEMENT	\$100.00
		1.0.530.9900.52.5370.09.36.000.0000	LICENSES & PERMITS	\$136.00
			Vendor Total:	\$236.00
Knutson, Olivia Stonewall		1.0.530.2109.27.8581.01.09.000.0000	TRAVEL-IN DISTRICT	\$99.94
			Vendor Total:	\$99.94
KUETER, RANDALL	V002220	1.0.530.2101.26.8581.01.09.000.0000	TRAVEL-IN DISTRICT	\$11.94
			Vendor Total:	\$11.94
Kuntz, Wayne Daniel		1.0.530.9700.65.7340.26.03.000.0000	OTHER PROFESSIONAL PURCHASED SERVICES	\$2,775.00
			Vendor Total:	\$2,775.00
Le, Sharla Lorraine		1.0.530.9900.52.5190.09.36.000.0000	UNIFORM REPLACEMENT	\$81.64
			Vendor Total:	\$81.64
Lehrman, Jennifer True		1.0.530.0100.27.8581.01.05.000.0000	TRAVEL-IN DISTRICT	\$11.00
			Vendor Total:	\$11.00
Madel, Susan S		1.0.530.2133.26.8581.01.09.000.0000	TRAVEL-IN DISTRICT	\$64.57
			Vendor Total:	\$64.57
		1.0.530.9800.41.8581.07.07.000.0000	TRAVEL-IN DISTRICT	\$4.13

# Mead School District No 354

## Voucher Supplement Account Summary

Fiscal Year: 2022-2023

Voucher Batch Number: 1059

11/11/2022

Vendor Remit Name	Vendor #	Account	Description	Vendor Total:	Amount
Martinsen, Jennifer L		1.0.530.2101.26.8581.01.09.000.0000	TRAVEL-IN DISTRICT	\$4.13	\$4.13
Mason, Bethany Ruth		1.0.530.2133.26.8581.01.09.000.0000	TRAVEL-IN DISTRICT	\$19.38	\$19.38
Minter, Nicole Kathryn		1.0.530.2101.26.8581.01.09.000.0000	TRAVEL-IN DISTRICT	\$27.13	\$27.13
Murphy, Cheyeanne S		1.0.530.2101.26.8581.01.09.000.0000	TRAVEL-IN DISTRICT	\$60.63	\$60.63
O'Donnal, Charmaine Coleman		1.0.530.9700.63.8581.07.35.000.0000	TRAVEL-IN DISTRICT	\$28.75	\$28.75
Osborn, Cooper Todd		1.0.530.2100.27.8581.01.09.000.0000	TRAVEL-IN DISTRICT	\$104.94	\$104.94
Overhauser, Johanna Marie		1.1.530.0128.28.8582.28.03.000.0000	AD/SPORTS TRAVEL-OUT OF DISTRICT	\$82.00	\$82.00
Palpant, Kristen A		1.0.530.2133.26.8581.01.09.000.0000	TRAVEL-IN DISTRICT	\$49.94	\$49.94
Patry, Katherine Sarah		1.0.530.0129.26.8581.01.08.000.0000	TRAVEL-IN DISTRICT	\$38.82	\$38.82
Paul, Larry G		1.0.530.2133.26.8581.01.09.000.0000	TRAVEL-IN DISTRICT	\$12.13	\$12.13

**Mead School District No 354**

**Voucher Supplement Account Summary**

Voucher Batch Number: 1059

11/11/2022

Fiscal Year: 2022-2023

Vendor Remit Name	Vendor #	Account	Description	Amount
Pfannenstiel-Wilner, Mary Lou		1.0.530.9900.52.8582.09.36.000.0000	TRAVEL-OUT OF DISTRICT	\$162.00
			Vendor Total:	\$162.00
Poliakova, Anastasia Vladimirovna		1.0.530.2130.27.8581.01.09.000.0000	TRAVEL-IN DISTRICT	\$89.50
			Vendor Total:	\$89.50
Regalado, Breanna M		1.0.530.0100.27.8581.01.05.000.0000	TRAVEL-IN DISTRICT	\$51.75
			Vendor Total:	\$51.75
Schafer, Joseph Harold		1.1.530.0128.28.8582.28.03.000.0000	AD/SPORTS TRAVEL-OUT OF DISTRICT	\$123.00
			Vendor Total:	\$123.00
Scott, Carla J		1.0.530.2102.26.8581.01.09.000.0000	TRAVEL-IN DISTRICT	\$74.75
			Vendor Total:	\$74.75
Spring, Claire Sharon		1.0.530.9700.13.5100.01.03.000.0000	BUSINESS FINANCE SUPPLIES	\$84.45
			Vendor Total:	\$84.45
Strate, Carolyn Ann		1.1.530.0128.28.8582.28.03.000.0000	AD/SPORTS TRAVEL-OUT OF DISTRICT	\$82.00
			Vendor Total:	\$82.00
Stuchell, Austin E		1.0.530.2133.26.8581.01.09.000.0000	TRAVEL-IN DISTRICT	\$58.32
			Vendor Total:	\$58.32
Thomas, Lori A		1.1.530.0128.28.8582.28.03.000.0000	AD/SPORTS TRAVEL-OUT OF DISTRICT	\$82.00
			Vendor Total:	\$82.00
		1.0.530.2100.27.8581.01.09.000.0000	TRAVEL-IN DISTRICT	\$122.88
			Vendor Total:	\$122.88

**Mead School District No 354**

**Voucher Supplement Account Summary**

Fiscal Year: 2022-2023

Voucher Batch Number: 1059

11/11/2022

Vendor Remit Name	Vendor #	Account	Description	Amount
Thompson, Roger W Jr				
		1.1.530.0128.28.8582.28.03.000.0000	AD/SPORTS TRAVEL-OUT OF DISTRICT	\$82.00
Villa, David			Vendor Total:	\$82.00
		1.0.530.9900.52.5190.09.36.000.0000	UNIFORM REPLACEMENT	\$100.00
Whitford, Dori K			Vendor Total:	\$100.00
		1.1.530.0128.28.8582.28.03.000.0000	AD/SPORTS TRAVEL-OUT OF DISTRICT	\$82.00
Wiemers, Russell Lloyd			Vendor Total:	\$82.00
		1.0.530.2109.27.8581.01.09.000.0000	TRAVEL-IN DISTRICT	\$31.88
Wurst, Danette K			Vendor Total:	\$31.88
		1.0.530.2133.26.8581.01.09.000.0000	TRAVEL-IN DISTRICT	\$50.69
			Vendor Total:	\$50.69
			Grand Total:	\$6,413.04

End of Report



# Mead School District No 354

## Payee Listing

Fiscal Year: 2022-2023

Criteria:

Bank Account: SPOKANE COUNTY TREASURER  
153607390207

Voucher: 1067

Starting Check Number: 108974

Check #	Date	Payee	Amount
108974	11/18/2022	ACCESS INFORMATION PROTECTED	\$56.00
108975	11/18/2022	ADVANCED PAGING & COMMUNICATIONS INC	\$74.05
108976	11/18/2022	AGPARTS WORLDWIDE INC	\$5,163.75
108977	11/18/2022	ALLSTREAM	\$4,198.87
108978	11/18/2022	AMAZON	\$637.08
108979	11/18/2022	APS INC	\$362.81
108980	11/18/2022	BLUUM OF TEXAS LLC	\$1,132.02
108981	11/18/2022	BOYS & GIRLS CLUBS OF SPOKANE CITY	\$10,281.33
108982	11/18/2022	BSN SPORTS	\$1,288.66
108983	11/18/2022	CARNEGIE LEARNING INC	\$3,833.28
108984	11/18/2022	CLEARWATER MUSIC	\$38.12
108985	11/18/2022	COPPER CREEK INC	\$18,546.35
108986	11/18/2022	COSTIGAN, BEN	\$53.35
108987	11/18/2022	CULLIGAN SOFT WATER SERVICE	\$724.63
108988	11/18/2022	CUMMINGS, LAURIE	\$32.40
108989	11/18/2022	DOYLE, MARY	\$28.40
108990	11/18/2022	EMPLOYMENT SECURITY DEPART	\$6,864.23
108991	11/18/2022	ESD 113	\$2,217.25
108992	11/18/2022	FIRST CHOICE SERVICES	\$163.79
108993	11/18/2022	FISHER'S TECHNOLOGY	\$605.36
108994	11/18/2022	HAMPTON INN - SEATTLE	\$1,433.41
108995	11/18/2022	HENRY SCHEIN INC	\$698.20
108996	11/18/2022	HIGHLAND MIDDLE SCHOOL	\$85.00
108997	11/18/2022	HOME DEPOT CREDIT SERVICES	\$250.94
108998	11/18/2022	HOME DEPOT PRO	\$3,695.94
108999	11/18/2022	HORIZON AUTOMATIC RAIN COMPANY DBA	\$354.69
109000	11/18/2022	INLAND POWER & LIGHT CO	\$7,470.95
109001	11/18/2022	INTEGRATED REGISTER SYSTEMS INC	\$10,413.02
109002	11/18/2022	INTERMAX NETWORKS	\$72.05
109003	11/18/2022	JAMISON, JENNIFER	\$21.00
109004	11/18/2022	JOHNSTONE SUPPLY	\$298.03
109005	11/18/2022	JOSTENS	\$149.66
109006	11/18/2022	KCDA	\$2,033.68
109007	11/18/2022	LANGUAGE LINE SERVICES INC	\$36.95
109008	11/18/2022	M & L SUPPLY	\$368.23
109009	11/18/2022	NATIONAL COLOR GRAPHICS, INC	\$247.43
109010	11/18/2022	NELSON, KRISTINE	\$11.95
109011	11/18/2022	NORTH 40 OUTFITTERS	\$312.57

# Mead School District No 354

## Payee Listing

Fiscal Year: 2022-2023

**Criteria:**

Bank Account: SPOKANE COUNTY TREASURER  
153607390207

Voucher: 1067

Starting Check Number: 108974

Check #	Date	Payee	Amount
109012	11/18/2022	NORTHWEST FENCE COMPANY	\$9,995.93
109013	11/18/2022	NORTHWEST TEXTBOOK DEPOSITORY	\$669.60
109014	11/18/2022	OTIS ELEVATOR	\$941.76
109015	11/18/2022	PHONAK INC	\$290.99
109016	11/18/2022	PICKA TIME	\$275.00
109017	11/18/2022	POSTMASTER	\$275.00
109018	11/18/2022	POWELL, BRITTANY	\$44.00
109019	11/18/2022	PPC SOLUTIONS, INC	\$1,547.00
109020	11/18/2022	REALLY GREAT READING	\$3,545.44
109021	11/18/2022	RED LION - PASCO	\$1,779.10
109022	11/18/2022	ROUNDY FAMILY LLC	\$12,620.00
109023	11/18/2022	SAFEGUARD BUSINESS SYSTEMS	\$107.30
109024	11/18/2022	SCHOOL SPECIALTY	\$195.36
109025	11/18/2022	SHERWIN WILLIAMS	\$450.17
109026	11/18/2022	SHRINERS HOSPITAL	\$15,594.66
109027	11/18/2022	SITEONE LANDSCAPE SUPPLY LLC	\$259.40
109028	11/18/2022	SPOKANE INTERNATIONAL TRANSLATION	\$990.00
109029	11/18/2022	STALLINGS, DONNA	\$6.85
109030	11/18/2022	STANDARD PLUMBING & HEATING	\$2,508.94
109031	11/18/2022	STONEWAY ELECTRIC	\$627.56
109032	11/18/2022	SWANSON, SHAUNA	\$66.95
109033	11/18/2022	TALX UC EXPRESS	\$479.64
109034	11/18/2022	TERNOVETS, KATERINA	\$67.25
109035	11/18/2022	THINKWELL CORP	\$159.00
109036	11/18/2022	US BANK CORPORATE PYMT SYSTEM	\$110,426.46
109037	11/18/2022	VERIZON..	\$503.95
109038	11/18/2022	WAMOA REGION 1	\$80.00
109039	11/18/2022	WASA	\$928.09
109040	11/18/2022	WASBO	\$400.00
109041	11/18/2022	WATSON, TRISTA	\$58.40
109042	11/18/2022	WCP SOLUTIONS	\$248.29
109043	11/18/2022	WSPA	\$875.00
Total Amount:			\$251,272.52

End of Report

# Mead School District No 354

## Voucher Supplement Account Summary

Fiscal Year: 2022-2023

Voucher Batch Number: 1068

11/18/2022

Vendor Remit Name	Vendor #	Account	Description	Amount
Breitenbach, Karen T				
		1.0.530.2133.26.8581.01.09.000.0000	TRAVEL-IN DISTRICT	\$69.25
Granado, Katie			Vendor Total:	\$69.25
		1.0.530.9700.61.8581.07.34.000.0000	TRAVEL-IN DISTRICT	\$87.69
Hill, Amelia Louise			Vendor Total:	\$87.69
		1.0.530.2100.27.8581.01.09.000.0000	TRAVEL-IN DISTRICT	\$36.63
		1.0.530.2133.26.8581.01.09.000.0000	TRAVEL-IN DISTRICT	\$10.94
Masiarek, Lindsey Johanna			Vendor Total:	\$47.57
		1.0.530.2133.26.8581.01.09.000.0000	TRAVEL-IN DISTRICT	\$33.13
Oswalt, Mark Philo			Vendor Total:	\$33.13
		1.0.530.9800.41.8581.07.07.000.0000	TRAVEL-IN DISTRICT	\$35.51
Smith-Wallis, Tija Winslow			Vendor Total:	\$35.51
		1.0.530.0100.27.8581.22.03.000.0000	TRAVEL-IN DISTRICT	\$21.87
		1.0.530.0100.27.8581.26.03.000.0000	TRAVEL-IN DISTRICT	\$21.88
Vahlstrom, Maria Thereza			Vendor Total:	\$43.75
		1.0.530.0100.27.8581.01.05.000.0000	TRAVEL-IN DISTRICT	\$29.44
			Vendor Total:	\$29.44
			Grand Total:	\$346.34

End of Report

# Capital Projects Fund

---

# Mead School District No 354

## Payee Listing

Fiscal Year: 2022-2023

**Criteria:**

Bank Account: SPOKANE COUNTY TREASURER  
153607390207

Voucher: 1060

Starting Check Number: 108930

Check #	Date	Payee	Amount
108930	11/11/2022	MSI ENGINEERS INC	\$91,420.00
108931	11/11/2022	THE CREATIVE OFFICE	\$7,840.17
Total Amount:			\$99,260.17

End of Report

**Mead School District No 354**

**Payee Listing**

Fiscal Year: 2022-2023

**Criteria:**

**Bank Account:** SPOKANE COUNTY TREASURER  
153607390207

**Voucher:** 1069

**Starting Check Number:** 109044

Check #	Date	Payee	Amount
109044	11/18/2022	STANDARD PLUMBING & HEATING	\$27,878.40
<b>Total Amount:</b>			<u>\$27,878.40</u>

**End of Report**

ASB

## Mead School District No 354

### Payee Listing

Fiscal Year: 2022-2023

**Criteria:**

Bank Account: SPOKANE COUNTY TREASURER  
153607390207

Voucher: 1061

Starting Check Number: 108932

Check #	Date	Payee	Amount
108932	11/11/2022	A-L COMPRESSED GASES	\$8.04
108933	11/11/2022	AWARDMASTERS	\$76.23
108934	11/11/2022	BROOKS, THOMAS	\$25.00
108935	11/11/2022	BSN SPORTS	\$4,096.64
108936	11/11/2022	FERRIS HIGH SCHOOL	\$100.00
108937	11/11/2022	FLANIGAN FOUNDATION	\$2,901.50
108938	11/11/2022	FROST, ROBYN	\$25.00
108939	11/11/2022	GODSILL, JENNIFER	\$25.00
108940	11/11/2022	GONZAGA PREP HIGH SCHOOL	\$417.00
108941	11/11/2022	GSL DISTRICT #8 SCHOOLS	\$150.00
108942	11/11/2022	HIGH-EDWARD, JACKIE	\$90.00
108943	11/11/2022	KCDA	\$18.93
108944	11/11/2022	KNIGHTEN, SHAWNA	\$25.00
108945	11/11/2022	KOELLER, AMY	\$25.00
108946	11/11/2022	LAGROU, AMY	\$25.00
108947	11/11/2022	LAKE CITY HIGH SCHOOL	\$371.00
108948	11/11/2022	LAKELAND TOURS, LLC DBA WORLDSTRIDES	\$11,910.00
108949	11/11/2022	LEWIS & CLARK HS	\$275.00
108950	11/11/2022	LIONEL HAMPTON JAZZ FESTIVAL U OF I	\$450.00
108951	11/11/2022	MARYSVILLE SCHOOL DISTRICT	\$1,120.00
108952	11/11/2022	MCGOWAN, PHILOMENA	\$25.00
108953	11/11/2022	MEAD SCHOOL DISTRICT	\$75.00
108954	11/11/2022	MOMENTUM INC	\$37.84
108955	11/11/2022	MUNDEL, CHRISTINE	\$100.00
108956	11/11/2022	NEVCO SPORTS LLC	\$318.03
108957	11/11/2022	PADGHAM, JENNIFER	\$25.00
108958	11/11/2022	PENSKE TRUCK LEASING CO	\$1,609.59
108959	11/11/2022	SFMEA	\$625.00
108960	11/11/2022	SPEED STACKS INC	\$1,140.00
108961	11/11/2022	STARPLEX CORPORATION	\$384.00
108962	11/11/2022	SZYMAREK, DIANA	\$25.00
108963	11/11/2022	UNIVERSAL ATHLETIC	\$2,063.66
108964	11/11/2022	WASHINGTON JOURNALISM EDUCATION ASSOCIAT	\$412.00
108965	11/11/2022	WEST VALLEY SCHOOL DIST #208	\$200.00
108966	11/11/2022	WITHERS-TAYLOR, TODD	\$15.00
108967	11/11/2022	WORLDS FINEST CHOCOLATE INC	\$4,670.00
108968	11/11/2022	WSU SCHOOL OF MUSIC	\$300.00
108969	11/11/2022	WYNIA, PETER	\$100.00



Mead School District No 354

**Payee Listing**

Fiscal Year: 2022-2023

**Criteria:**

**Bank Account:** SPOKANE COUNTY TREASURER  
153607390207

**Voucher:** 1061

**Starting Check Number:** 108932

Check #	Date	Payee	Amount
108970	11/11/2022	ZIEGLER, TERRY	\$25.00
Total Amount:			<u>\$34,284.46</u>

End of Report

# Mead School District No 354

## Voucher Supplement Account Summary

Fiscal Year: 2022-2023

Voucher Batch Number: 1062

11/11/2022

Vendor Remit Name	Vendor #	Account	Description	Amount
Bertsch, Gregory Alan				
		4.0.530.3450.00.0000.28.00.000.0000	DRAMA	\$149.00
			<b>Vendor Total:</b>	<b>\$149.00</b>
Butz, Nancy M				
		4.0.530.3200.00.0000.27.00.000.0000	CHEERLEADING	\$50.69
			<b>Vendor Total:</b>	<b>\$50.69</b>
			<b>Grand Total:</b>	<b>\$199.69</b>

End of Report

# Mead School District No 354

## Payee Listing

Fiscal Year: 2022-2023

**Criteria:**

**Bank Account:** SPOKANE COUNTY TREASURER  
153607390207

**Voucher:** 1070

**Starting Check Number:** 109045

Check #	Date	Payee	Amount
109045	11/18/2022	ALPHA OMEGA TOURS & CHARTERS	\$1,680.00
109046	11/18/2022	BSN SPORTS	\$280.35
109047	11/18/2022	CENTRAL VALLEY SCHOOL DIST 356	\$322.82
109048	11/18/2022	CURTIS HIGH SCHOOL	\$500.00
109049	11/18/2022	FERRIS HIGH SCHOOL	\$100.00
109050	11/18/2022	FITZPATRICK, KRISTA	\$200.00
109051	11/18/2022	JAE ENTERPRISES LLC	\$2,836.04
109052	11/18/2022	MEAD SCHOOL DISTRICT	\$2,262.18
109053	11/18/2022	MOSES LAKE HIGH SCHOOL	\$150.00
109054	11/18/2022	MTR WESTERN LLC	\$1,247.40
109055	11/18/2022	NORTHWEST ASSOCIATION PERFORMING ARTS	\$2,500.00
109056	11/18/2022	PENSKE TRUCK LEASING CO	\$1,871.91
109057	11/18/2022	ROGERS HIGH SCHOOL	\$125.00
109058	11/18/2022	ROSS POINT	\$4,225.50
109059	11/18/2022	SFMEA	\$600.00
109060	11/18/2022	SHADLE PARK HIGH SCHOOL	\$125.00
109061	11/18/2022	TROPHIES UNLIMITED	\$264.87
109062	11/18/2022	US AWARDS INC	\$496.25
109063	11/18/2022	US BANK CORPORATE PYMT SYSTEM	\$52,091.29
109064	11/18/2022	WASHINGTON OFFICIALS ASSOCIATION	\$2,856.50
109065	11/18/2022	WILDROSE GRAPHICS	\$718.53
Total Amount:			\$75,453.64

End of Report

## EXTRA CURRICULAR CONTRACTS

November 21, 2022

Location	First Name	Last Name	Activity	Amount
Highland Middle	Krystal	Metzger	Math Club	\$ 840.00
Highland Middle	Anna	Conner	Volleyball	\$ 3,482.00
Highland Middle	Heather	Wilson	Volleyball	\$ 4,194.00
Highland Middle	Jillian	Berg	Volleyball	\$ 2,718.00
Highland Middle	Leonard	Vargas	Volleyball	\$ 3,075.00
Highland Middle	Micah	Erdman	Volleyball	\$ 2,718.00
Highland Middle	Shawn	Wilson	Volleyball	\$ 4,807.00
Highland Middle	Steve	Rupe	Volleyball	\$ 4,807.00
Highland Middle	Bryan	Smith	Wrestling	\$ 3,525.00
Highland Middle	Mark	Shulkin	Wrestling	\$ 2,891.00
Highland Middle	Michael	Bartlett	Wrestling	\$ 2,718.00
Mead High	DeVonte	Gorman	Basketball	\$ 4,387.00
Mead High	Donny	Hodgson	Basketball	\$ 7,254.00
Mead High	Ivan	Gustafson	Basketball	\$ 2,465.00
Mead High	Luke	Jordan	Basketball	\$ 7,380.00
Mead High	Orom	Opiew	Basketball	\$ 3,070.90
Mead High	Pat	Deubel	Basketball	\$ 4,667.00
Mead High	Quantae	Anderson	Basketball	\$ 9,197.00
Mead High	Tessa	Hodgson	Basketball	\$ 7,254.00
Mead High	Daniel	Kenagy	Gymnastics	\$ 337.30
Mead High	Hanna	Bjerkestrand	Gymnastics	\$ 5,712.00
Mead High	Jenna	Schlosser	Gymnastics	\$ 3,560.40
Mead High	Laurie	Chadwick	Gymnastics	\$ 558.30
Mead High	Austin	Stuchell	Post Season Boys Cross Country	\$ 564.48
Mead High	Cooper	Osborn	Post Season Boys Cross Country	\$ 121.80
Mead High	Curtis	Barville	Post Season Boys Cross Country	\$ 210.45
Mead High	Brett	Ogata	Post Season Football	\$ 853.44
Mead High	Gunnar	Drew	Post Season Football	\$ 919.20
Mead High	Ivan	Gustafson	Post Season Football	\$ 853.44
Mead High	Jacob	Hernandez	Post Season Football	\$ 200.08
Mead High	Jared	Thomas	Post Season Football	\$ 651.68
Mead High	Jesse	McCorkle	Post Season Football	\$ 827.44
Mead High	Jesse	Wilhelm	Post Season Football	\$ 624.24
Mead High	Keith	Stamps	Post Season Football	\$ 1,145.76
Mead High	Nate	Miller	Post Season Football	\$ 532.24
Mead High	Tevin	Duke	Post Season Football	\$ 225.12
Mead High	Claire	Spring	Post Season Girls Cross Country	\$ 139.20
Mead High	Dori	Whitford	Post Season Girls Cross Country	\$ 725.40
Mead High	Roger	Thompson	Post Season Girls Cross Country	\$ 162.36
Mead High	Casey	Curtis	Post Season Soccer	\$ 2,557.80
Mead High	Keith	Ross	Post Season Soccer	\$ 1,959.51
Mead High	Breanna	Regalado	Post Season SP Softball	\$ 1,077.12
Mead High	Tiffany	Casedy	Post Season SP Softball	\$ 2,360.80
Mead High	Heather	Wilson	Post Season Volleyball	\$ 1,679.58
Mead High	Shawn	Wilson	Post Season Volleyball	\$ 2,424.78
Mead High	Brandon	Butler	Unified Basketball	\$ 2,097.00

## EXTRA CURRICULAR CONTRACTS

November 21, 2022

Location	First Name	Last Name	Activity	Amount
Mead High	Deanna	Ganea	Unified Basketball	\$ 2,097.00
Mead High	Nicole	Leslie	Unified Basketball	\$ 2,097.00
Mead High	Bryan	Smith	Wrestling	\$ 3,561.00
Mead High	Drew	Comito	Wrestling	\$ 2,374.00
Mead High	Jeremy	Golding	Wrestling	\$ 4,104.75
Mead High	Mitch	Whetzel	Wrestling	\$ 6,697.00
Mead High	Phil	McLean	Wrestling	\$ 10,046.00
Mead High	Tyler	McLean	Wrestling	\$ 4,814.00
Mountainside	Jolynn	Watson-Thomas	Math is Cool	\$ 1,260.00
Mountainside	Erin	Glasser	Volleyball	\$ 3,991.00
Mountainside	Hailee	Muller	Volleyball	\$ 2,355.60
Mountainside	James	Tucker	Volleyball	\$ 3,172.00
Mountainside	Katie	Fitzgerald	Volleyball	\$ 2,355.60
Mountainside	Kim	Ralston	Volleyball	\$ 4,194.00
Mountainside	Melissa	Mather	Volleyball	\$ 3,705.00
Mountainside	Natalie	King	Volleyball	\$ 3,417.00
Mountainside	Shawn	Clegg	Volleyball	\$ 4,326.00
Mt. Spokane	Caleb	Countryman	Boys Basketball	\$ 1,077.00
Mt. Spokane	David	Waggenblast	Boys Basketball	\$ 9,488.00
Mt. Spokane	George	Petticrew	Boys Basketball	\$ 1,392.00
Mt. Spokane	Jordan	Poynor	Boys Basketball	\$ 4,387.00
Mt. Spokane	Kevin	Oglesbee	Boys Basketball	\$ 7,033.00
Mt. Spokane	Mark	Bjerkestrand	Boys Basketball	\$ 1,116.60
Mt. Spokane	Trek	Davis	Boys Basketball	\$ 2,258.00
Mt. Spokane	Jacob	Fry	Boys Cross Country	\$ 358.98
Mt. Spokane	Scott	Daratha	Boys Cross Country	\$ 725.40
Mt. Spokane	Daniel	Smith	Girls Basketball	\$ 5,583.00
Mt. Spokane	David	Pratt	Girls Basketball	\$ 9,488.00
Mt. Spokane	Lance	Marquart	Girls Basketball	\$ 7,033.00
Mt. Spokane	Andy	Sonneland	Girls Cross Country	\$ 725.40
Mt. Spokane	Katie	Mann	Girls Cross Country	\$ 101.72
Mt. Spokane	Summer	Clegg	Girls Cross Country	\$ 203.44
Mt. Spokane	Shannon	Stiles	Girls Soccer	\$ 1,103.20
Mt. Spokane	Steve	Del Pizzo	Girls Soccer	\$ 742.84
Mt. Spokane	Terra	Davidson	Girls Soccer	\$ 766.29
Mt. Spokane	Adrien	Plummer	Gymnastics Pooled	\$ 4,400.00
Mt. Spokane	Dana	Trantum	Gymnastics Pooled	\$ 5,400.00
Mt. Spokane	Jordyn	Andrade	Gymnastics Pooled	\$ 2,140.00
Mt. Spokane	Kelly	Leaf	Gymnastics Pooled	\$ 3,688.90
Mt. Spokane	Alex	Schuerman	Slow Pitch Softball	\$ 1,623.20
Mt. Spokane	Amber	Helbling	Slow Pitch Softball	\$ 202.86
Mt. Spokane	Carl	Adams	Slow Pitch Softball	\$ 1,978.60
Mt. Spokane	Jacob	Fry	Wrestling	\$ 3,500.25
Mt. Spokane	Logan	Sundheim	Wrestling	\$ 2,834.30
Mt. Spokane	Rob	Renner	Wrestling	\$ 3,627.00
Mt. Spokane	Todd	Slatter	Wrestling	\$ 9,739.00

## EXTRA CURRICULAR CONTRACTS

November 21, 2022

<b>Location</b>	<b>First Name</b>	<b>Last Name</b>	<b>Activity</b>	<b>Amount</b>
Mt. Spokane	Travis	Hughes	Wrestling	\$ 6,697.00
Northwood	Julie	Aton	Art Club	\$ 1,050.00
Northwood	Tannea	Zollinger	Art Club	\$ 1,050.00
Northwood	Emily	Schick	Drama Club	\$ 840.00
Northwood	David	Riggs	Volleyball	\$ 4,807.00
Northwood	Janna	O'Leary	Volleyball	\$ 3,821.00
Northwood	Jeanne	Helfer	Volleyball	\$ 4,194.00
Northwood	Jill	Ellingson	Volleyball	\$ 4,066.00
Northwood	Kyle	Smith	Volleyball	\$ 3,172.00
Northwood	Rebecca	Whitaker	Volleyball	\$ 3,212.00
Northwood	Robin	Haws	Volleyball	\$ 4,194.00
Northwood	Ryan	Miciak	Volleyball	\$ 4,066.00
Northwood	Tallie	Carlson	Volleyball Coach	\$ 877.82
Northwood	Jeff	Allen	Wrestling	\$ 2,280.70
Northwood	Jeremy	Golding	Wrestling	\$ 628.09
Northwood	Mike	Divelbiss	Wrestling	\$ 2,891.00
Northwood	Tony	Umbach	Wrestling	\$ 487.00
Northwood	Zac	Franklin	Wrestling	\$ 3,075.00

## CO CURRICULAR CONTRACTS

November 21, 2022

<b>Location</b>	<b>First Name</b>	<b>Last Name</b>	<b>Activity</b>	<b>Amount</b>
Mt. Spokane	Andrew	Sauve	Marching Band	\$ 500.00
Mt. Spokane	Bryan	Swenland	Marching Band	\$ 1,200.00
Mt. Spokane	Francis	Sefton	Marching Band	\$ 300.00
Mt. Spokane	Jordan	Binder	Marching Band	\$ 1,100.00
Mt. Spokane	Kaity	Savage	Marching Band	\$ 900.00
Mt. Spokane	Kyle	Schaal	Marching Band	\$ 250.00
Mt. Spokane	Minnie	Blisner	Marching Band	\$ 1,750.00
Mt. Spokane	Nancy	Butz	Marching Band	\$ 800.00
Mt. Spokane	T'Lacy	Amburgey	Marching Band	\$ 1,500.00
Mt. Spokane	Zac	Ziegler	Marching Band	\$ 1,500.00

SUPPLEMENTAL CONTRACTS

November 21, 2022

<b>Location</b>	<b>First Name</b>	<b>Last Name</b>	<b>Activity</b>	<b>Amount</b>
Business & Operations	Trish	Henry	Chromebook Add'l Resp Stipend	\$ 300.00
Highland	Tammy	Rogers	Ext. Days Increase change in salary	\$ 751.71
Mt. Spokane	Alex	Schuerman	LOA Coaches Driving - 4 trips	\$ 100.00
Mt. Spokane	Carl	Adams	LOA Coaches Driving - 4 trips	\$ 100.00
Mt. Spokane	Jessica	Rempel	Theatre Manager Stipend	\$ 5,000.00
Mead High	Greg	Bertsch	Theatre Manager Stipend	\$ 5,000.00
Special Services	Kim	Gortsema	Overload	\$ 1,447.04
Special Services	Heidi	Kieper	Overload	\$ 976.57



## MEAD SCHOOL DISTRICT

Board Meeting of November 21, 2022

**New Business**

**VI.B.**

**Agenda Item:** **Highly Capable Program Renewal Authorization**

**Background:** Each year the Mead School District submits a Highly Capable Program grant renewal application. These state funds support program options for students who perform, or show the potential to perform, at a remarkably high level when compared to students of similar age, experience or environment. Submission of the request to continue receiving grant funds requires school board authorization.

**Fiscal Impact:** The amount of funding anticipated for Highly Capable programming for 2022-2023 is approximately \$311,000, which is roughly 5.5% more than last year. These programming funds help cover the costs related to the daily provision of appropriate instructional support for students with the highly capable designation. Besides instructional resources within the district's MTSS framework, the grant covers professional development for general education staff so that identified students are receiving support as part of their daily school experience. These funds additionally support Mead's full-time gifted classes and the cost of a HiCap coordinator at each elementary building.

**Other Considerations:** The Mead School District Highly Capable Plan for 2022-2023 has been adjusted to reflect changes that provide daily support of students with the highly capable designation. It addresses options for students in grades K-12, as well as referral, nomination and qualification criteria.

**Recommendation:** School Board authorization to submit the Highly Capable Program Grant renewal paperwork for the 2022-2023 school year is recommended.

**Mead School District**  
 Budget Status Summary  
 as of 10/31/2022

	Annual Budget (original)	YTD Actual	
<b>Enrollment</b>	10,181.00	10,255.23	74.23 0.73%

**Revenues & Expenditures**

Revenues & Other Financing Sources	\$ 153,395,502	\$ 27,661,446	18.0%
Expenditures & Other Financing Uses	\$ 158,614,853	\$ 26,139,026	16.5%

Transfers (to)/from other Funds	\$ -	\$ -	
---------------------------------	------	------	--

---

<b>Net Change in Fund Balance</b>	<b>\$ (5,219,351)</b>	<b>\$ 1,522,420</b>	
-----------------------------------	-----------------------	---------------------	--

---

**Fund Balance**

Beginning Fund Balance	\$ 13,524,316
Current Fund Balance	\$ 15,046,736
% of budgeted Expenditures	9.49%

FTE Enrollment Report  
November 1, 2022

	Brentwood Elem	Colbert Elem	Creekside Elem	Evergreen Elem	Farwell	Meadow Ridge Elem	Midway Elem	Prairie View Elem	Shiloh Hills Elem	Skyline Elem	Highland Middle	Northwood Middle	Mountainside Middle	Mead High	Mt Spokane High	Total October 2022 Less AL	Budgeted #'s 22/23 Less AL	Mead Learning Options	Difference
K Full Day	79.00	49.00	39.00	79.00	60.00	60.00	74.00	56.00	104.00	55.00						655.00	622.00	32.60	33.00
Grade 1	83.00	69.00	37.60	70.00	72.00	68.00	57.00	65.00	60.00	62.00						643.60	602.00	34.40	41.60
Grade 2	83.00	70.00	41.00	75.00	67.00	61.00	61.00	72.00	78.00	68.00						676.00	644.00	37.00	32.00
Grade 3	87.00	70.00	43.49	77.00	82.00	58.00	69.00	64.00	52.00	52.00						654.49	639.00	46.40	15.49
Grade 4	91.00	78.00	27.00	93.00	101.00	76.00	78.00	73.00	68.00	71.00						756.00	734.00	49.20	22.00
Grade 5	85.00	73.00	27.00	85.00	89.00	71.00	79.00	78.00	56.00	59.00						702.00	671.00	38.80	31.00
Grade 6											221.57	263.00	258.42			742.99	724.00	54.20	18.99
Grade 7											250.59	256.54	238.96			746.09	716.00	51.00	30.09
Grade 8											266.75	279.55	284.74			831.04	821.00	45.80	10.04
Grade 9														452.04	341.68	793.72	753.00	45.80	40.72
Grade 10														462.17	393.37	855.54	862.00	47.10	-6.46
Grade 11														370.77	297.64	668.41	836.00	36.00	-167.59
Grade 12														350.50	290.99	641.49	645.00	41.80	-3.51
Total 11/2022	508.00	409.00	215.09	479.00	471.00	394.00	418.00	408.00	418.00	367.00	738.91	799.09	782.12	1635.48	1323.68	9366.37	9269.00	559.70	97.37

\*Includes Open Doors & Gateway to College  
22/23 Budgetec 10.00

HC	Nov Voc	Voc
19	17.66	0

TBIP	
7-12 HC	EXITED HC
213	44

Vocational	
Northwood	131.58
Mountainside	89.59
Highland MS	117.90
Total	339.07
Mead High School	199.69
Mt. Spokane HS	159.72
Total	359.41

RADIATION ALLIANCE

ALE	MLO		RAD		TOTAL FTE
	FTE	MHS	FTE	MSHS	
k	32.60				32.60
1	34.40				34.40
2	37.00				37.00
3	46.40				46.40
4	49.20				49.20
5	38.80				38.80
6	54.20				54.20
7	51.00				51.00
8	45.40				45.40
9	45.80	1.00			46.80
10	47.10	2.00			49.10
11	36.00	3.00			39.00
12	41.80	14.00			55.80
	559.70	20.00			605.70

FTE Summary-Monthly

Kindergarten	687.60
Grades 1-3	2,091.89
Grade 4	805.20
Grades 5-6	1,537.99
Grades 7-8	1,673.53
Grades 9-12	3,129.86
<b>K-12 Total</b>	<b>9,926.07</b>
Running Start	311.50
Open Doors	17.66
<b>Grand Total</b>	<b>10,255.23</b>

Running Start

Running Start	Total HC	Non-Voc FTE	Voc FTE
October - June	140.00	65.00	119.85
Mead High School	146.00	74.00	130.44
Mt. Spokane	58.00	10.00	45.41
Five Mile - MEPP	344.00	149.00	295.70
<b>Total</b>	<b>588.00</b>	<b>298.00</b>	<b>691.39</b>

22/23 Budgeted Running Start 302.00

22/23 Budgeted FTE 600

**Headcount Enrollment  
11/1/2022**

	Brentwood Elem	Colbert Elem	Creekside Elem	Evergreen Elem	Farwell Elem	Meadow Ridge Elem	Midway Elem	Prairie View Elem	Shiloh Hills Elem	Skyline Elem	Highland Middle	Northwood Middle	Mountainside Middle	Mead Learning Options	Mead High School	Mt Spokane High	Total October 2022
K Full Day	79	49	39	79	60	60	74	56	104	55				33			688
Grade 1	83	69	38	70	72	68	57	65	60	62				35			679
Grade 2	83	70	41	75	67	61	61	72	78	68				38			714
Grade 3	87	70	44	77	82	58	69	64	52	52				47			702
Grade 4	91	78	27	93	101	76	78	73	68	71				50			806
Grade 5	85	73	27	85	89	71	79	78	56	59				40			742
Grade 6											222	263	262	56			803
Grade 7											251	260	242	52			805
Grade 8											267	283	288	46			884
Grade 9														46	453	343	842
Grade 10														48	465	397	910
Grade 11														56	420	382	858
Grade 12														62	388	379	829
<b>Total 11/1/2022</b>	<b>508</b>	<b>409</b>	<b>216</b>	<b>479</b>	<b>471</b>	<b>394</b>	<b>418</b>	<b>408</b>	<b>418</b>	<b>367</b>	<b>740</b>	<b>806</b>	<b>792</b>	<b>609</b>	<b>1726</b>	<b>1501</b>	<b>10262</b>

	GRADUATION ALLIANCE				TOTAL HC
	MLO	MHS	HC	MSHS HC	
ALE	HC	HC	HC	HC	
k	33				33
1	35				35
2	38				38
3	47				47
4	50				50
5	40				40
6	56				56
7	52				52
8	46				46
9	46	1			47
10	48	2		3	53
11	56	3		5	64
12	62	14		18	94
<b>TOTAL</b>					
<b>ALE</b>	<b>609</b>	<b>20</b>	<b>26</b>	<b>655</b>	

MEAD SCHOOL DISTRICT #354  
GENERAL FUND

CASH FLOW SCHEDULE

SEPTEMBER 1, 2022 TO AUGUST 31, 2023

MONTH	TAX COLLECTIONS	STATE APPORTIONMENT	OTHER REVENUE	TOTAL RECEIPTS	ACCOUNTS PAYABLE	PAYROLL	TOTAL DISBURSEMENT	TRANSFER OTHER FUND	INTER-FUND LOAN	CASH & INVESTMENT BALANCE
Beginning Cash 9/1/2022										
9/30/2022										13,259,417
Estimate:	307,388	11,629,880	531,726	12,468,994	3,805,504	11,226,700	15,032,203			10,696,208
ACTUAL:	5,639,367	10,444,125	312,287	16,395,778	1,359,414	11,251,920	12,611,335			14,480,652
11/30/2022										14,480,652
Estimate:				0						
ACTUAL:				0						
12/31/2022										14,480,652
Estimate:				0						
ACTUAL:				0						
1/31/2023										14,480,652
Estimate:				0						
ACTUAL:				0						
2/28/2023										14,480,652
Estimate:				0						
ACTUAL:				0						
3/31/2023										14,480,652
Estimate:				0						
ACTUAL:				0						
4/30/2023										14,480,652
Estimate:				0						
ACTUAL:				0						
5/31/2023										14,480,652
Estimate:				0						
ACTUAL:				0						
6/30/2023										14,480,652
Estimate:				0						
ACTUAL:				0						
7/31/2023										14,480,652
Estimate:				0						
ACTUAL:				0						
8/31/2023										14,480,652
Estimate:				0						
ACTUAL:				0						
Total Actual	\$5,946,755	\$22,074,005	\$844,013	\$28,864,773	\$5,164,918	\$22,478,620	\$27,643,538		\$0	\$0

**Revised Year-to-Year Comparison of Net Cash Balance  
Less Assigned Fund Balance**

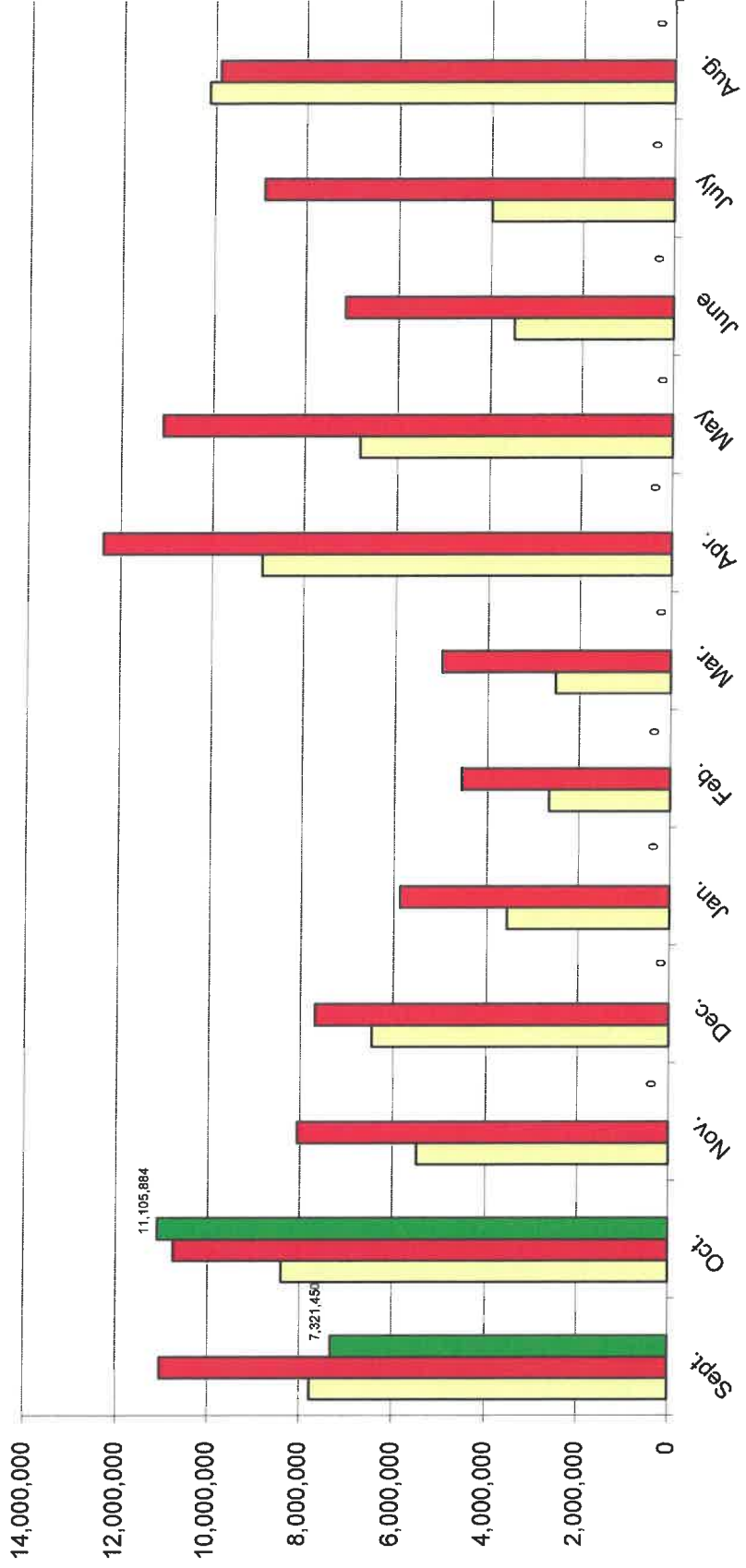

**Projection of Year-End Net Cash Balance**

14000000

**Mead School District No 354**  
**Budget Status Report**  
**Fiscal Year 2022-23**  
**September 01, 2022 through October 31, 2022**

**General Fund**

Include Pre Encumbrance

	<u>ANNUAL BUDGET</u>	<u>ACTUAL FOR DATE RANGE</u>	<u>ACTUAL FOR YEAR</u>	<u>ENCUMB</u>	<u>BALANCE</u>	<u>% USED</u>
<b>A. Revenue</b>						
1000 Local Taxes (+)	16,862,540.00	5,946,755.10	5,946,755.10		10,915,784.90	35.3%
2000 Local Support Nontax (+)	1,176,025.00	635,518.34	635,518.34		540,506.66	54.0%
3000 State, General Purpose (+)	101,033,242.00	16,819,131.41	16,819,131.41		84,214,110.59	16.6%
4000 State, Special Purpose (+)	23,448,575.00	3,772,856.05	3,772,856.05		19,675,718.95	16.1%
5000 Federal, General Purpose (+)	0.00	0.00	0.00		0.00	0.0%
6000 Federal, Special Purpose (+)	10,825,120.00	482,785.04	482,785.04		10,342,334.96	4.5%
7000 Revenues Fr Oth Sch Dist (+)	50,000.00	900.00	900.00		49,100.00	1.8%
8000 Other Agencies & Associates (+)	0.00	0.00	0.00		0.00	0.0%
9000 Other Financing Sources (+)	0.00	3,500.00	3,500.00		(3,500.00)	0.0%
<b>TOTAL Revenue</b>	<b>153,395,502.00</b>	<b>27,661,445.94</b>	<b>27,661,445.94</b>		<b>125,734,056.06</b>	<b>18.0%</b>
<b>B. Expenses</b>						
00 Regular Instruction (-)	88,594,193.00	14,218,671.83	14,218,671.83	65,471,707.26	8,903,813.91	89.9%
10 Federal Stimulus (-)	1,468,821.00	113,870.47	113,870.47	626,769.78	728,180.75	50.4%
20 Special Ed Instruction (-)	21,254,344.00	3,594,037.99	3,594,037.99	17,076,903.68	583,402.33	97.3%
30 Vocational Ed Instruction (-)	6,347,208.00	798,935.20	798,935.20	3,581,800.32	1,966,472.48	69.0%
40 Skills Center Instruction (-)	0.00	0.00	0.00	0.00	0.00	0.0%
50 & 60 Compensatory Ed Instruction (-)	6,874,287.00	893,988.68	893,988.68	3,702,070.50	2,278,227.82	66.9%
70 Other Instructional Programs (-)	1,342,842.00	56,242.75	56,242.75	276,911.05	1,009,688.20	24.8%
80 Community Services (-)	255,227.00	49,325.13	49,325.13	140,226.19	65,675.68	74.3%
90 Support Services (-)	32,477,931.00	6,413,953.59	6,413,953.59	16,041,455.72	10,022,521.69	69.1%
<b>TOTAL Expenses</b>	<b>158,614,853.00</b>	<b>26,139,025.64</b>	<b>26,139,025.64</b>	<b>106,917,844.50</b>	<b>25,557,982.86</b>	<b>83.9%</b>
<b>C. Other Fin Uses Trans Out</b>	<b>0.00</b>	<b>0.00</b>	<b>0.00</b>	<b>0.00</b>	<b>0.00</b>	<b>0.0%</b>
<b>D. Other Fin Uses</b>	<b>0.00</b>	<b>0.00</b>	<b>0.00</b>	<b>0.00</b>	<b>0.00</b>	<b>0.0%</b>
<b>E. EXCESS OF REVENUES/OTHER FIN. SOURCES OVER(UNDER) EXP/OTHER FIN USES (A-B-C-D)</b>	<b>(5,219,351.00)</b>	<b>1,522,420.30</b>	<b>1,522,420.30</b>		<b>100,176,073.20</b>	<b>(65.9%)</b>
<b>F. TOTAL BEGINNING FUND BALANCES</b>	<b>0.00</b>		<b>13,524,315.90</b>			
<b>G. G/L 898 PRIOR YEAR ADJUSTMENTS (+OR-)</b>	<b>XXXXXX</b>		<b>0.00</b>			
<b>H. TOTAL ENDING FUND BALANCE (E+F+/-G)</b>	<b>(5,219,351.00)</b>		<b>15,046,736.20</b>			
<b>I. ENDING FUND BALANCE ACCOUNTS</b>						
G/L 810 Restricted for Other Items (-)	0.00		0.00			
G/L 821 Restricted for CO of Restricted Rev (-)	0.00		383,965.99			
G/L 828 Restricted for CO of F/S Rev (-)	0.00		1,678,236.05			
G/L 830 Restricted for Debt Service (-)	0.00		0.00			
G/L 835 Restricted For Arbitrage Rebate (-)	0.00		0.00			
G/L 840 Nonspnd FB - Inventory & Prepaid (-)	0.00		542,205.47			
G/L 870 Committed to Other Purposes (-)	0.00		0.00			
G/L 875 Assigned to Contingencies (-)	0.00		0.00			
G/L 888 Assigned to Other Purposes (-)	0.00		3,546,979.91			
G/L 891 Unassigned to Minimum FB Policy (-)	0.00		7,372,928.48			
G/L 898 PY Corrections or Restatements (-)	0.00		0.00			
G/L 890 Unassigned Fund Balance (H - I)	(5,219,351.00)		1,522,420.30			
<b>TOTALS</b>	<b>(5,219,351.00)</b>		<b>15,046,736.20</b>			

26,139,025.64	= .1647%
158,614,853.00	

**Mead School District No 354**  
**Budget Status Report**  
**Fiscal Year 2022-23**  
**September 01, 2022 through October 31, 2022**

**Capital Projects Fund**

<input type="checkbox"/> Include Pre Encumbrance	<b>ANNUAL BUDGET</b>	<b>ACTUAL FOR DATE RANGE</b>	<b>ACTUAL FOR YEAR</b>	<b>ENCUMB</b>	<b>BALANCE</b>	<b>% USED</b>
<b>A. Revenue</b>						
1000 Local Taxes (+)	0.00	0.00	0.00		0.00	0.0%
2000 Local Support Nontax (+)	60,000.00	23,470.13	23,470.13		36,529.87	39.1%
3000 State, General Purpose (+)	0.00	0.00	0.00		0.00	0.0%
4000 State, Special Purpose (+)	0.00	0.00	0.00		0.00	0.0%
5000 Federal, General Purpose (+)	0.00	0.00	0.00		0.00	0.0%
6000 Federal, Special Purpose (+)	0.00	0.00	0.00		0.00	0.0%
7000 Revenues Fr Oth Sch Districts (+)	0.00	0.00	0.00		0.00	0.0%
8000 Other Agencies & Associates (+)	0.00	0.00	0.00		0.00	0.0%
9000 Other Financing Sources (+)	0.00	0.00	0.00		0.00	0.0%
<b>TOTAL Revenue</b>	<b>60,000.00</b>	<b>23,470.13</b>	<b>23,470.13</b>		<b>36,529.87</b>	<b>39.1%</b>
<b>B. Expenses</b>						
10 Sites (-)	2,675,664.63	0.00	0.00	0.00	2,675,664.63	0.0%
20 Buildings (-)	2,398,977.00	(22,007.66)	(22,007.66)	288,228.18	2,132,756.48	11.1%
30 Equipment (-)	381,130.37	16,455.76	16,455.76	95,271.63	269,402.98	29.3%
40 Energy (-)	0.00	0.00	0.00	0.00	0.00	0.0%
50 Sale and Lease Expenditures (-)	0.00	0.00	0.00	0.00	0.00	0.0%
60 Bond/Levy Issuance (-)	0.00	0.00	0.00	0.00	0.00	0.0%
90 Debt (-)	0.00	0.00	0.00	0.00	0.00	0.0%
<b>TOTAL Expenses</b>	<b>5,455,772.00</b>	<b>(5,551.90)</b>	<b>(5,551.90)</b>	<b>383,499.81</b>	<b>5,077,824.09</b>	<b>6.9%</b>
<b>C. Other Fin Uses Trans Out</b>	<b>0.00</b>	<b>0.00</b>	<b>0.00</b>	<b>0.00</b>	<b>0.00</b>	<b>0.0%</b>
<b>D. Other Fin Uses</b>	<b>0.00</b>	<b>0.00</b>	<b>0.00</b>	<b>0.00</b>	<b>0.00</b>	<b>0.0%</b>
<b>E. EXCESS OF REVENUES/OTHER FIN. SOURCES</b>						
<b>OVER(UNDER) EXP/OTHER FIN USES (A-B-C-D)</b>	<b>(5,395,772.00)</b>	<b>29,022.03</b>	<b>29,022.03</b>		<b>(5,041,294.22)</b>	<b>32.2%</b>
<b>F. TOTAL BEGINNING FUND BALANCES</b>						
	<b>7,845,821.00</b>		<b>9,642,490.44</b>			
<b>G. G/L 898 PRIOR YEAR ADJUSTMENTS (+OR-)</b>						
	<b>XXXXXX</b>		<b>0.00</b>			
<b>H. TOTAL ENDING FUND BALANCE (E+F+/-G)</b>						
	<b>2,450,049.00</b>		<b>9,671,512.47</b>			
<b>I. ENDING FUND BALANCE ACCOUNTS</b>						
G/L 810 Restricted For Other items (-)	0.00		0.00			
G/L 830 Restricted For Debt Service (-)	0.00		0.00			
G/L 835 Restricted For Arbitrage Rebate (-)	0.00		0.00			
G/L 861 Restricted From Bond Proceeds (H-I)	(5,455,772.00)		7,833,533.03			
G/L 863 Restricted From State Proceeds (H-I)	0.00		0.00			
G/L 870 Committed to Other Purposes (-)	0.00		0.00			
G/L 889 Assigned to Fund Purposes (H-I)	7,905,821.00		1,837,979.44			
G/L 890 Unassigned Fund Balance (H - I)	0.00		0.00			
<b>TOTALS</b>	<b>2,450,049.00</b>		<b>9,671,512.47</b>			



**Mead School District No 354**  
**Budget Status Report**  
**Fiscal Year 2022-23**  
**September 01, 2022 through October 31, 2022**

**Debt Service Fund**

<input type="checkbox"/> Include Pre Encumbrance	<b>ANNUAL BUDGET</b>	<b>ACTUAL FOR DATE RANGE</b>	<b>ACTUAL FOR YEAR</b>	<b>ENCUMB</b>	<b>BALANCE</b>	<b>% USED</b>
<b>A. Revenue</b>						
1000 Local Taxes (+)	14,063,760.00	4,909,896.31	4,909,896.31		9,153,863.69	34.9%
2000 Local Support Nontax (+)	0.00	0.00	0.00		0.00	0.0%
3000 State, General Purpose (+)	0.00	0.00	0.00		0.00	0.0%
5000 Federal, General Purpose (+)	0.00	0.00	0.00		0.00	0.0%
6000 Federal, Special Purpose (+)	0.00	0.00	0.00		0.00	0.0%
9000 Other Financing Sources (+)	0.00	0.00	0.00		0.00	0.0%
<b>TOTAL Revenue</b>	<b>14,063,760.00</b>	<b>4,909,896.31</b>	<b>4,909,896.31</b>		<b>9,153,863.69</b>	<b>34.9%</b>
<b>B. Expenses</b>						
Matured Bond Expenditures (-)	5,700,000.00	0.00	0.00	0.00	5,700,000.00	0.0%
Interest on Bonds (-)	7,656,888.00	0.00	0.00	0.00	7,656,888.00	0.0%
Interest on Interfund Loan (-)	0.00	0.00	0.00	0.00	0.00	0.0%
Bond Transfer Fees (-)	15,000.00	1,500.00	1,500.00	0.00	13,500.00	10.0%
<b>TOTAL Expenses</b>	<b>13,371,888.00</b>	<b>1,500.00</b>	<b>1,500.00</b>	<b>0.00</b>	<b>13,370,388.00</b>	<b>0.0%</b>
<b>C. Other Fin Uses Trans Out</b>	<b>0.00</b>	<b>0.00</b>	<b>0.00</b>	<b>0.00</b>	<b>0.00</b>	<b>0.0%</b>
<b>D. Other Fin Uses</b>	<b>0.00</b>	<b>0.00</b>	<b>0.00</b>	<b>0.00</b>	<b>0.00</b>	<b>0.0%</b>
<b>E. EXCESS OF REVENUES/OTHER FIN. SOURCES OVER(UNDER) EXP/OTHER FIN USES (A-B-C-D)</b>	<b>691,872.00</b>	<b>4,908,396.31</b>	<b>4,908,396.31</b>		<b>(4,216,524.31)</b>	<b>34.9%</b>
<b>F. TOTAL BEGINNING FUND BALANCES</b>	<b>0.00</b>		<b>3,884,495.21</b>			
<b>G. G/L 898 PRIOR YEAR ADJUSTMENTS (+OR-)</b>	<b>XXXXXX</b>		<b>0.00</b>			
<b>H. TOTAL ENDING FUND BALANCE (E+F+/-G)</b>	<b>691,872.00</b>		<b>8,792,891.52</b>			
<b>I. ENDING FUND BALANCE ACCOUNTS</b>						
G/L 810 Restricted For Other Items (-)	0.00		0.00			
G/L 835 Restricted For Arbitrage Rebate (-)	0.00		0.00			
G/L 870 Committed to Other Purposes (-)	0.00		0.00			
G/L 889 Assigned to Fund Purposes (-)	0.00		0.00			
G/L 890 Unassigned Fund Balance (-)	0.00		0.00			
G/L 830 Restricted For Debt Service (H - I)	691,872.00		8,792,891.52			
<b>TOTALS</b>	<b>691,872.00</b>		<b>8,792,891.52</b>			

**Mead School District No 354**  
**Budget Status Report**  
**Fiscal Year 2022-23**  
**September 01, 2022 through October 31, 2022**

**Associated Student Body Fund**

	<b>ANNUAL BUDGET</b>	<b>ACTUAL FOR DATE RANGE</b>	<b>ACTUAL FOR YEAR</b>	<b>ENCUMB</b>	<b>BALANCE</b>	<b>% USED</b>
<input type="checkbox"/> Include Pre Encumbrance						
<b>A. Revenue</b>						
1000 General Student Body (+)	728,525.00	147,354.86	147,354.86		581,220.14	20.2%
2000 Athletics (+)	515,590.00	142,963.05	142,963.05		372,626.95	27.7%
3000 Classes (+)	542,670.00	208,435.97	208,435.97		334,734.03	38.3%
4000 Clubs (+)	96,025.00	6,683.35	6,683.35		89,341.65	7.0%
6000 Private Moneys (+)	151,300.00	2,901.22	2,901.22		148,398.78	1.9%
<b>TOTAL Revenue</b>	<b>2,034,110.00</b>	<b>508,338.45</b>	<b>508,338.45</b>		<b>1,526,321.55</b>	<b>25.0%</b>
<b>B. Expenses</b>						
1000 General Student Body (-)	663,973.00	95,271.86	95,271.86	2,948.77	565,752.37	14.8%
2000 Athletics (-)	911,000.00	96,590.28	96,590.28	27,395.78	787,013.94	13.6%
3000 Classes (-)	665,100.00	120,354.54	120,354.54	18,266.48	526,478.98	20.8%
4000 Clubs (-)	128,442.00	5,268.11	5,268.11	638.00	122,535.89	4.6%
6000 Private Moneys (-)	156,947.00	824.88	824.88	115.12	156,007.00	0.6%
<b>TOTAL Expenses</b>	<b>2,525,462.00</b>	<b>318,309.67</b>	<b>318,309.67</b>	<b>49,364.15</b>	<b>2,157,788.18</b>	<b>14.6%</b>
<b>C. Other Fin Uses Trans Out</b>	<b>0.00</b>	<b>0.00</b>	<b>0.00</b>	<b>0.00</b>	<b>0.00</b>	<b>0.0%</b>
<b>D. Other Fin Uses</b>	<b>0.00</b>	<b>0.00</b>	<b>0.00</b>	<b>0.00</b>	<b>0.00</b>	<b>0.0%</b>
<b>E. EXCESS OF REVENUES/OTHER FIN. SOURCES</b>						
OVER(UNDER) EXP/OTHER FIN USES (A-B-C-D)	(491,352.00)	190,028.78	190,028.78		(631,466.63)	10.4%
<b>F. TOTAL BEGINNING FUND BALANCES</b>	<b>987,601.00</b>		<b>1,137,468.49</b>			
<b>G. G/L 898 PRIOR YEAR ADJUSTMENTS (+OR-)</b>	<b>XXXXXX</b>		<b>0.00</b>			
<b>H. TOTAL ENDING FUND BALANCE (E+F+/-G)</b>	<b>496,249.00</b>		<b>1,327,497.27</b>			
<b>I. ENDING FUND BALANCE ACCOUNTS</b>						
G/L 810 Restricted For Other Items (-)	0.00		0.00			
G/L 840 Nonspnd FB - Invent/Prepd Itms (-)	0.00		0.00			
G/L 850 Restricted For Uninsured Risks (-)	0.00		0.00			
G/L 870 Committed to Other Purposes (-)	0.00		0.00			
G/L 889 Assigned to Fund Purposes (-)	0.00		0.00			
G/L 890 Unassigned Fund Balance (-)	0.00		0.00			
G/L 819 Restricted For Fund Purposes (H - I)	496,249.00		1,327,497.27			
<b>TOTALS</b>	<b>496,249.00</b>		<b>1,327,497.27</b>			

**Mead School District No 354**  
**Budget Status Report**  
**Fiscal Year 2022-23**  
**September 01, 2022 through October 31, 2022**

**Transportation Vehicle Fund**

<input type="checkbox"/> Include Pre Encumbrance	<b>ANNUAL BUDGET</b>	<b>ACTUAL FOR DATE RANGE</b>	<b>ACTUAL FOR YEAR</b>	<b>ENCUMB</b>	<b>BALANCE</b>	<b>% USED</b>
<b>A. Revenue</b>						
1000 Local Taxes (+)	0.00	0.00	0.00		0.00	0.0%
2000 Local Support Nontax (+)	2,500.00	1,458.25	1,458.25		1,041.75	58.3%
3000 State, General Purpose (+)	0.00	0.00	0.00		0.00	0.0%
4000 State, Special Purpose (+)	594,937.00	0.00	0.00		594,937.00	0.0%
5000 Federal, General Purpose (+)	0.00	0.00	0.00		0.00	0.0%
8000 Other Agencies and Assoc. (+)	0.00	0.00	0.00		0.00	0.0%
9000 Other Financing Sources (+)	0.00	0.00	0.00		0.00	0.0%
<b>TOTAL Revenue</b>	<b>597,437.00</b>	<b>1,458.25</b>	<b>1,458.25</b>		<b>595,978.75</b>	<b>0.2%</b>
<b>B. Expenses</b>						
Type 30 Equipment (-)	1,100,000.00	0.00	0.00	0.00	1,100,000.00	0.0%
Type 60 Bond Levy Issuance (-)	0.00	0.00	0.00	0.00	0.00	0.0%
Type 90 Debt (-)	0.00	0.00	0.00	0.00	0.00	0.0%
<b>TOTAL Expenses</b>	<b>1,100,000.00</b>	<b>0.00</b>	<b>0.00</b>	<b>0.00</b>	<b>1,100,000.00</b>	<b>0.0%</b>
<b>C. Other Fin Uses Trans Out</b>	<b>0.00</b>	<b>0.00</b>	<b>0.00</b>	<b>0.00</b>	<b>0.00</b>	<b>0.0%</b>
<b>D. Other Fin Uses</b>	<b>0.00</b>	<b>0.00</b>	<b>0.00</b>	<b>0.00</b>	<b>0.00</b>	<b>0.0%</b>
<b>E. EXCESS OF REVENUES/OTHER FIN. SOURCES OVER(UNDER) EXP/OTHER FIN USES (A-B-C-D)</b>						
	<b>(502,563.00)</b>	<b>1,458.25</b>	<b>1,458.25</b>		<b>(504,021.25)</b>	<b>0.2%</b>
<b>F. TOTAL BEGINNING FUND BALANCES</b>						
	<b>592,633.00</b>		<b>609,639.85</b>			
<b>G. G/L 898 PRIOR YEAR ADJUSTMENTS (+OR-)</b>						
	<b>XXXXXX</b>		<b>0.00</b>			
<b>H. TOTAL ENDING FUND BALANCE (E+F+/-G)</b>						
	<b>90,070.00</b>		<b>611,098.10</b>			
<b>I. ENDING FUND BALANCE ACCOUNTS</b>						
G/L 810 Restricted For Other Items (-)	0.00		0.00			
G/L 830 Reserved For Debt Service (-)	0.00		0.00			
G/L 889 Assigned to Fund Purposes (-)	0.00		0.00			
G/L 890 Unassigned Fund Balance (-)	0.00		0.00			
G/L 819 Restricted For Fund Purposes (H - I)	90,070.00		611,098.10			
<b>TOTALS</b>	<b>90,070.00</b>		<b>611,098.10</b>			