

Connecting your SMART Board to display and activate interactivity;

1. Before checking/changing your display settings: If your SMART Board is connecting with a bluetooth dongle make sure that you have it plugged into a USB port on your docking station

Follow the instructions below to display from your laptop to your Interactive SMART Board. There are 2 options.

Option 1: <Recommended> Duplicating your SMART Board and Laptop (Works for all model SMART Boards)

1. On your Laptop:

- Right click on your Laptop screen and select Display Settings

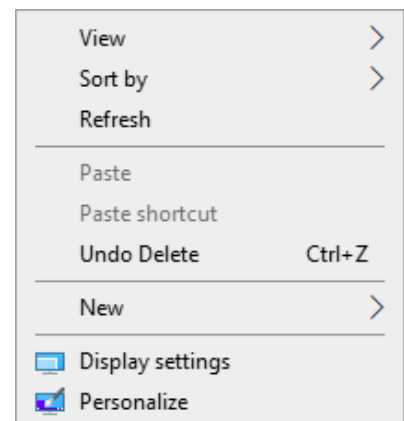

- On the Display Settings screen- Click the Identify button to determine which numbers (1,2, & 3) are associated with your displays;
 - Laptop
 - Monitor
 - SMART Board (Projector)

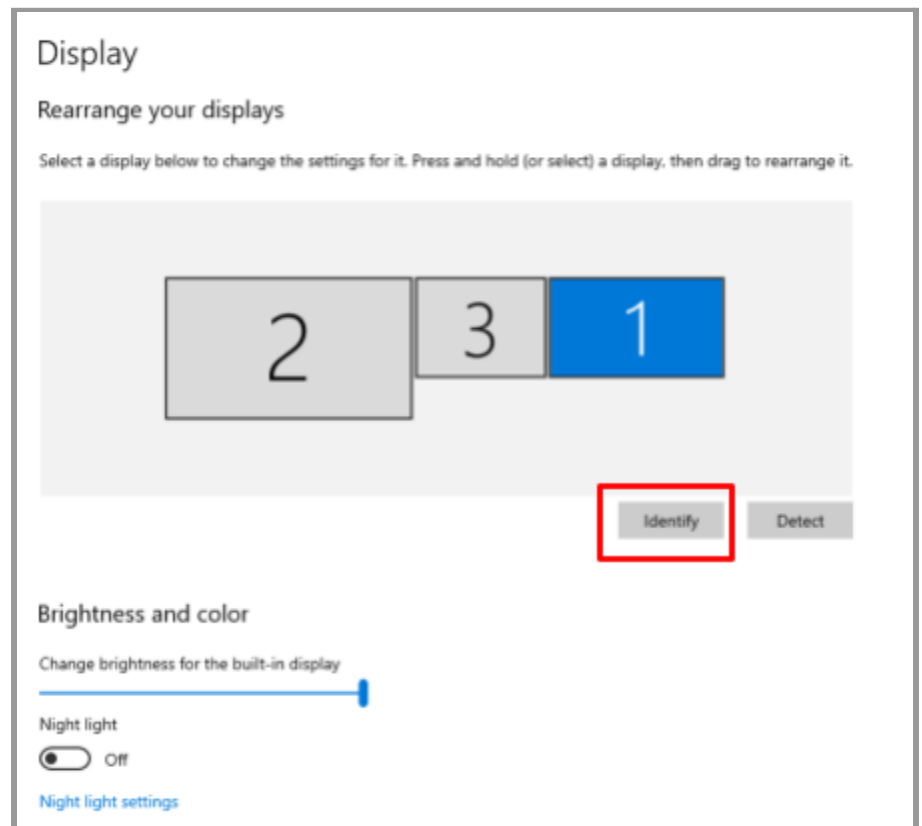

- Scroll down to **Multiple Displays** and select the down arrow;

- Select Duplicate desktop on 1 and 2 - If your laptop is 1 and your SMART Board is 2 (Use the Identify button above to determine)
- Select Duplicate desktop on 1 and 3 - If your laptop is 1 and your SMART Board is 3 (Use the Identify button above to determine)

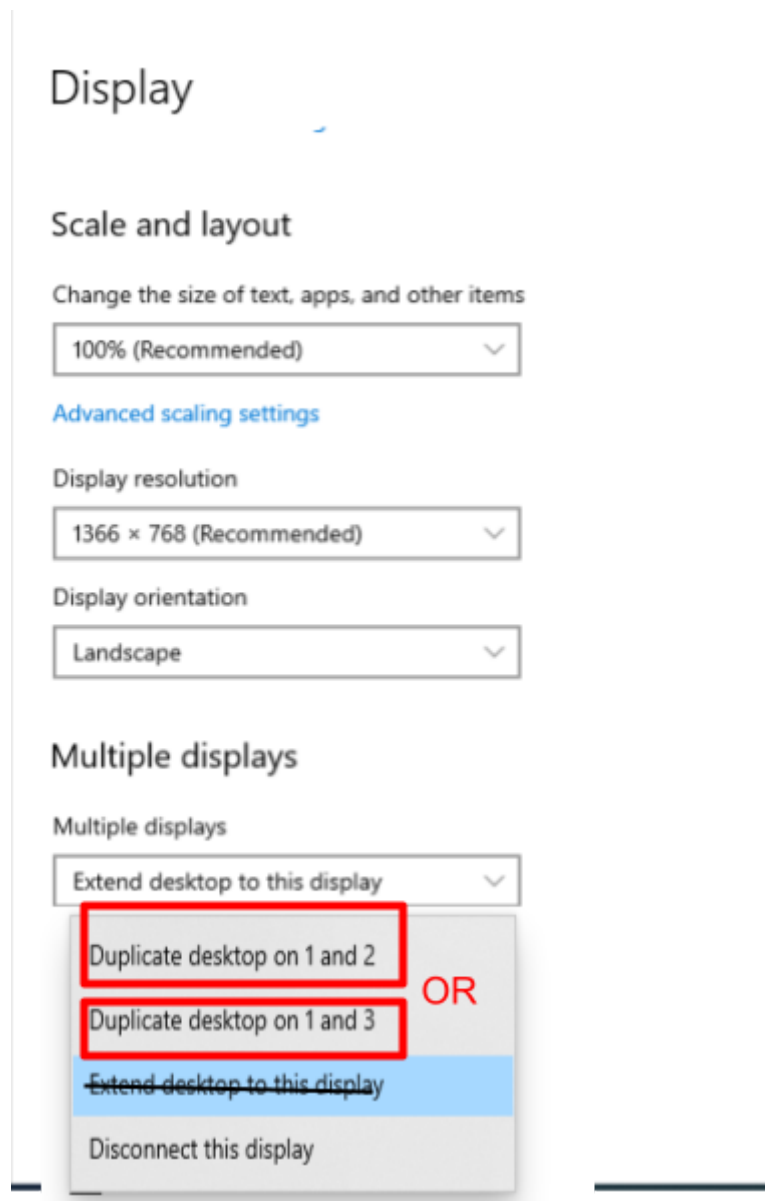

- Select “**Keep Changes**” when prompted
- Scroll to **Display Resolution** and select 1280 x 768

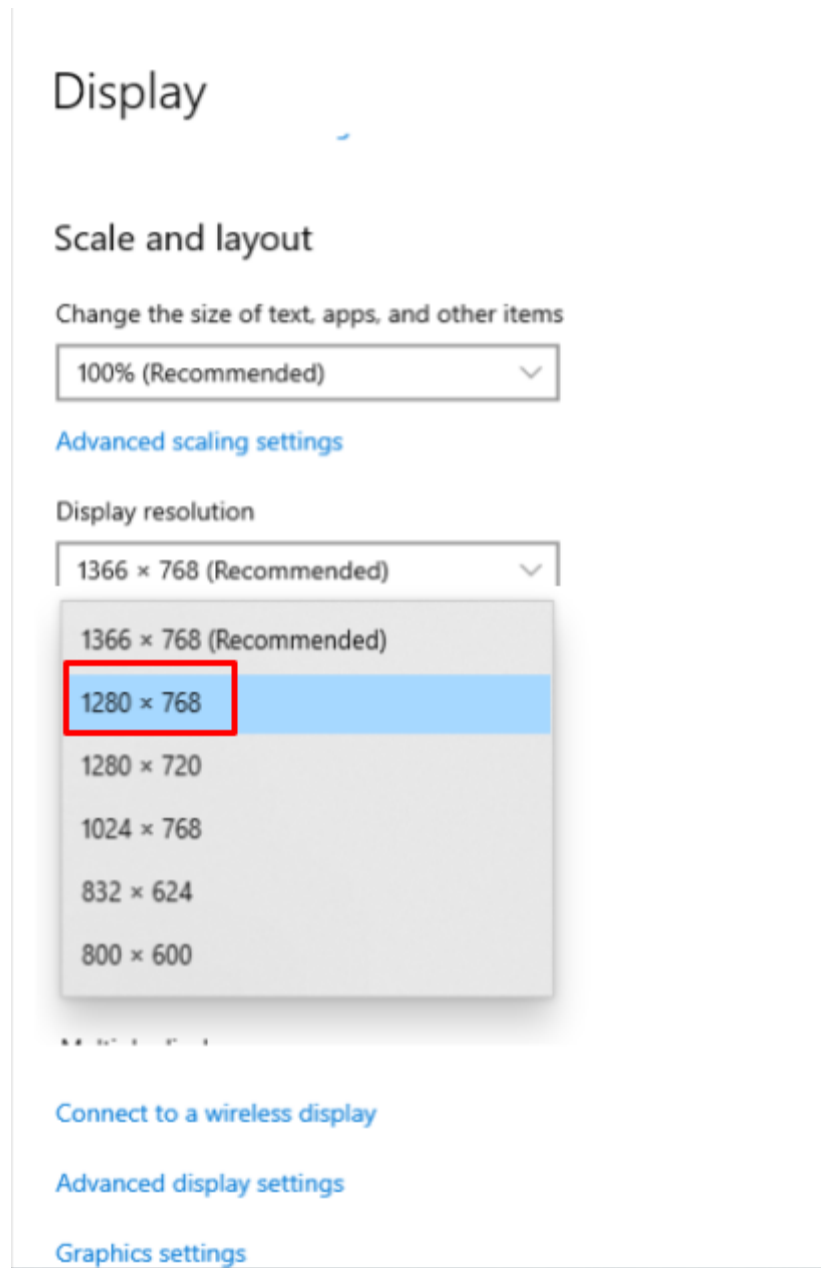

- Select “**Keep Changes**” when prompted

2. On your Projector:

- Select the **Aspect button** on the bottom of your remote
 - Change to 4:3

OR

- Select Menu on your projector remote, then select Adjust>Image Option>Aspect Ratio
 - Select the right arrow to select 4:3 then Enter to save your settings
 - Click Menu button to exit

Option 2: Making Your SMARTBoard Work in Extended Desktop (if you have a two button orienting SMART Board model)

While your laptop is in extended mode, push the orientation buttons on your SMARTBoard.



The orientation will show up on your monitor. That's ok!

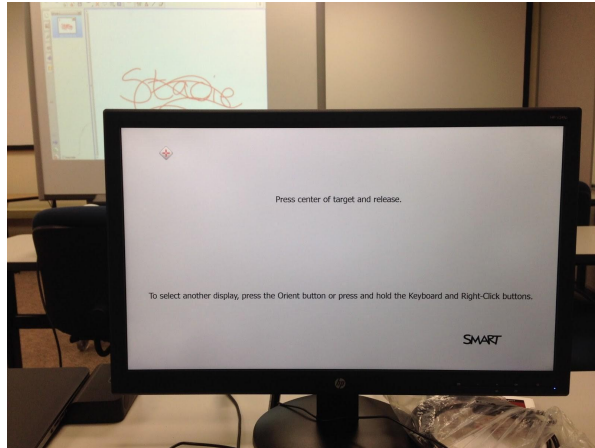

Hover over the desktop orientation with your mouse (don't click yet) Push the SPACE Bar on your keyboard and RIGHT CLICK your mouse AT THE SAME TIME. It will switch the orientation to the extended desktop on your SMARTBoard.

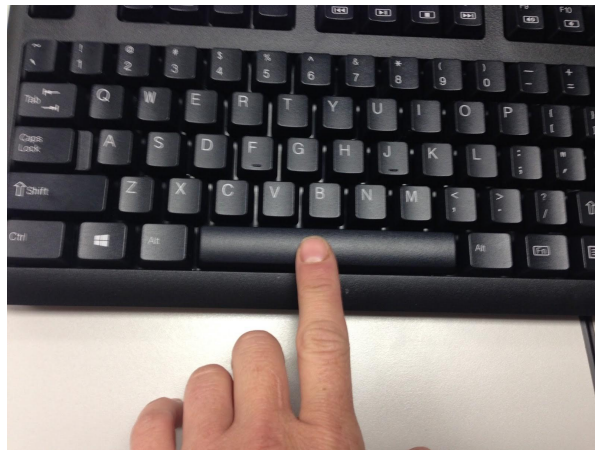

This is what it will look like. Note the monitor shows your desktop while the SMARTBoard in the background shows the orientation.



Go ahead and orient your SMARTBoard by pushing the center of the red plus signs. There are usually 9 total.



Drag your files or browser tabs from the laptop across the monitor to the SMARTBoard to display for students. NOTE: This will take some practice!!

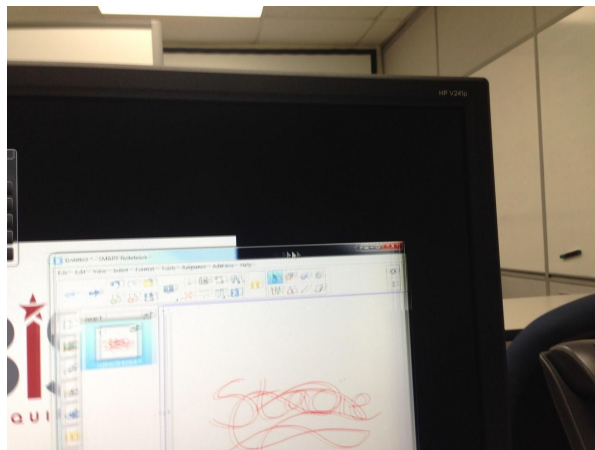

As you drag, you'll see it show up on the SMARTBoard as shown in this picture.



Your SMARTBoard now functions in extended desktop.

