

Instruction Packet for Lead and Copper Tap Sample Site Location Plan

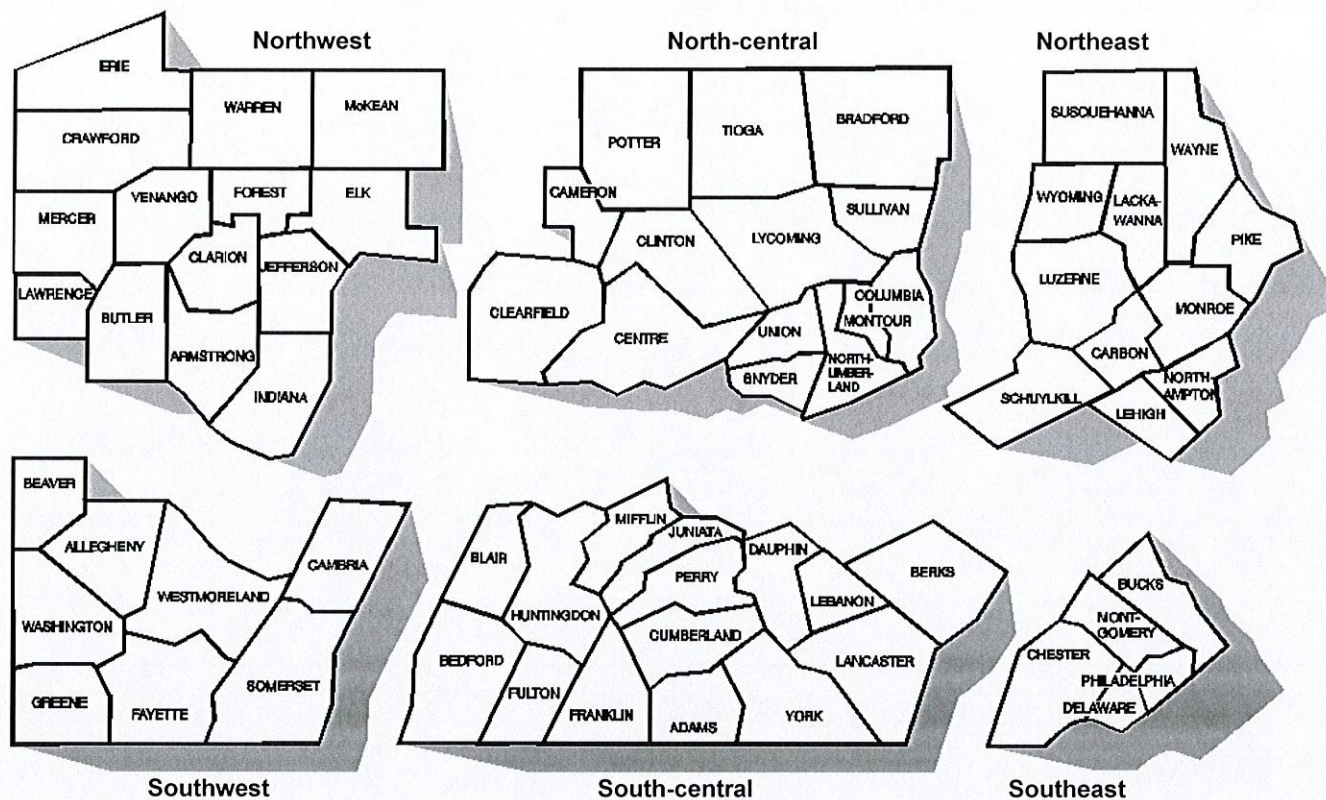

pennsylvania
DEPARTMENT OF ENVIRONMENTAL
PROTECTION
BUREAU OF SAFE DRINKING WATER

DEPARTMENT OF ENVIRONMENTAL PROTECTION FIELD OPERATIONS REGIONAL OFFICES



DEP Regional Offices

PA DEP-SDW Program Northwest Region

230 Chestnut St.
Meadville, PA 16335-3481
Main Telephone: 814-332-6945
24-Hour Emergency: 1-800-373-3398

Counties: Armstrong, Butler, Clarion, Crawford, Elk, Erie, Forest, Indiana, Jefferson, Lawrence, McKean, Mercer, Venango, and Warren

PA DEP-SDW Program Southwest Region

400 Waterfront Drive
Pittsburgh, PA 15222-4745
Main Telephone: 412-442-4000
24-Hour Emergency: 412-442-4000

Counties: Allegheny, Beaver, Cambria, Fayette, Greene, Somerset, Washington, and Westmoreland

PA DEP-SDW Program North-central Region

208 W. Third St., Suite 101
Williamsport, PA 17701-6448
Main Telephone: 570-327-3636
24-Hour Emergency: 570-327-3636

Counties: Bradford, Cameron, Clearfield, Centre, Clinton, Columbia, Lycoming, Montour, Northumberland, Potter, Snyder, Sullivan, Tioga and Union

PA DEP-SDW Program South-central Region

909 Elmerton Ave.
Harrisburg, PA 17110-8220
Main Telephone: 717-705-4700
24-Hour Emergency: 1-877-333-1904

Counties: Adams, Bedford, Berks, Blair, Cumberland, Dauphin, Franklin, Fulton, Huntingdon, Juniata, Lancaster, Lebanon, Mifflin, Perry and York

PA DEP-SDW Program Northeast Region

2 Public Square
Wilkes-Barre, PA 18701-1915
Main Telephone: 570-826-2511
24-Hour Emergency: 570-826-2511

Counties: Carbon, Lackawanna, Lehigh, Luzerne, Monroe, Northampton, Pike, Schuylkill, Susquehanna, Wayne and Wyoming

PA DEP-SDW Program Southeast Region

2 E. Main St.
Norristown, PA 19401-4915
Main Telephone: 484-250-5900
24-Hour Emergency: 484-250-5900

Counties: Bucks, Chester, Delaware, Montgomery and Philadelphia



pennsylvania
DEPARTMENT OF ENVIRONMENTAL
PROTECTION

COMMONWEALTH OF PENNSYLVANIA
DEPARTMENT OF ENVIRONMENTAL PROTECTION
BUREAU OF SAFE DRINKING WATER

CONSUMER NOTICE OF TAP WATER RESULTS

Dear Consumer,

MAPLEWOOD ELEMENTARY SCHOOL is a public water system, because we are responsible for providing you with water at this location and ensuring that the drinking water we provide to you meets state and federal standards. The following table provides information on the tap location, date, and water sample result.

DRINKING WATER SAMPLE FOR LEAD		
Location	Date	Result (ppb)
SEE ATTACHED PLAN		

The 90th percentile value for our water system is **below the lead action level of 15 parts per billion.**

What Does This Mean?

Under the authority of the Safe Drinking Water Act, EPA set the action level for lead in drinking water at 15 ppb. This means utilities must ensure the water from the taps used for human consumption do not exceed this level in at least 90 percent of the sites samples (90th percentile value). The action level is *the concentration of a contaminant which, if exceeded, triggers treatment or other requirements which a water system must follow.* If water from the tap exceeds this limit, then the utility must take certain steps to correct the problem. Because lead may pose serious health risks, the EPA set a Maximum Contaminant Level Goal (MCLG) of zero for lead. The MCLG is *the level of a contaminant in drinking water below which there is a no known or expected risk to health.* MCLGs allow for a margin of safety.

What Are The Health Effects of Lead?

Lead can cause serious health problems if too much enters your body from drinking water or other sources. It can cause damage to the brain and kidneys, and can interfere with the production of red blood cells that carry oxygen to all parts of your body. The greatest risk of lead exposure is to infants, young children, and pregnant women. Scientists have linked the effects of lead on the brain with lowered IQ in children. Adults with kidney problems and high blood pressure can be affected by low levels of lead more than healthy adults. Lead is stored in the bones, and it can be released later in life. During pregnancy, the child receives lead from the mother's bones, which may affect brain development.

What are The Sources of Lead?

The primary sources of lead exposure for most children are deteriorating lead-based paint, lead-contaminated dust and lead-contaminated residential soil. Exposure to lead is a significant health concern, especially for young children and infants whose growing bodies tend to absorb more lead than the average adult. Although our facility's drinking water lead levels were below the action level, if you are concerned about lead exposure in your home, you should ask your health care provider about testing your children to determine levels of lead in their blood.

What Can I Do to Reduce Exposure to Lead in Drinking Water?

Although the test results were below EPA's action level, you may still want to take steps to further reduce your exposure.

- **Run your water to flush out lead.** If water hasn't been used for several hours, run water for 15-30 seconds to flush out interior plumbing or until it becomes cold or reaches a steady temperature before using it for drinking or cooking.
- **Use cold water for cooking and preparing baby formula.**
- **Do not boil water to remove lead.**

For More Information

Call us at 814-337-1600 For more information on reducing lead exposure around your home and the health effects of lead, visit EPA's website at: www.epa.gov/lead, call the National Lead Information Center at 800-424-LEAD, or contact your health care provider.



COMMONWEALTH OF PENNSYLVANIA
DEPARTMENT OF ENVIRONMENTAL PROTECTION
BUREAU OF SAFE DRINKING WATER

Consumer Tap Notice for Lead Results Certification Form

Name of PWS: Maplewood Elementary School PWSID Number: 6200309

Monitoring period to which the notice applies (e.g., June – Sept. 2010): June 2022 - Sept 2022

Date(s) results were received from laboratory: June 16, 2022

Date(s) Notices were provided to consumers: July 14, 2022

The water system named above hereby certifies that its lead consumer notice has been provided to each person it serves at the specific sampling site from which the sample was tested. The water system also certifies that these results and the following information were provided to such persons within 30 days of receiving the test results from the laboratory:

- 1) Individual tap results from the lead tap water monitoring carried out under the requirements of §109.1103
- 2) An explanation of the health effects of lead.
- 3) Steps that consumers can take to reduce exposure to lead in drinking water.
- 4) The maximum contaminant level goals and action levels for lead, and the definitions of these two terms from §141.153(c).
- 5) Water system contact information.

Notices were distributed using the delivery methods indicated below. **Check all that apply.**

- ☐ Mail or other direct delivery. Specify other direct delivery methods: _____
- ☐ Electronic mail.
- ☐ Posting the notice on the Internet at www.penncrest.org
- ☒ Posting the notice in public places (attach a list of locations).
- ☐ Delivery of multiple copies to single bill addresses serving several person such as: apartments, business, and large private employers.
- ☐ Other methods. Specify: District Safety Committee Meeting

Certified by: Signature: David E Dickson

Print Name: David E Dickson

Title: Director of Facilities and Transportation

Phone # 814-337-1600 Date: October 14, 2022

Complete this form, **attach a copy of the notice(s)** and submit this form to your local DEP office.

(See a list of DEP's regional office on the back of this form).

2012/2016/ update
2021

LEAD & COPPER TAP SAMPLE SITE LOCATION PLAN

GENERAL SYSTEM INFORMATION

Water System Name:	Maplewood Elementary School			PWSID:	6200309
Mailing Address:	32659 Route 408 Townville, PA. 16360				
Contact Person Name:	David Dickson	Phone:	814-337-1600	E-mail:	ddickson@penncrest.org
System Type: (CWS or NTCWS)	Non-transient	Population Served:	500		

LEAD AND COPPER TAP SAMPLE SITE LISTING

3 Digit Location ID#	Sample Site Address / Room #	Site Location Tier Assignment and LSL status
001	Kitchen Sink	Tier 2
002	Nurse's Office Sink	Tier 2
003	Auditorium Restroom Sink	Tier 2
004	Art Room Sink Room 146	Tier 2
005	2 nd Floor Hall Drinking Fountain (next to Rm 214)	Tier 2
006	2 nd Floor Restroom Sink (next to Rm 225)	Tier 2

[illegible]



1803 Philadelphia Street
Indiana, PA 15701
P: (724) 463-8378
F: (724) 465-4209
PADEP: 32-00382

1276 Bentleyville Road
Van Voorhis, PA 15366
P: (724) 258-8378
F: (724) 258-8376
PADEP: 63-04247

435 Broad Street
Montoursville, PA 17754
P: (570) 321-9002
F: (570) 321-1957
PADEP: 41-04880

950 West Main Street
Sharpsville, PA 16150
P: (724) 463-8378 x 500
F: (724) 465-4209
PADEP: 43-04934

13 June 2022

Maplewood Elementary School
Attn: Dave Dickson
32695 State Highway 408
Townville, PA 16360

Work Order: 2060879
Project: Drinking Water - Lead and Copper

Report of Analysis

Client Sample ID	Lab Sample ID	Matrix	Date Sampled	Date Received	Sample Notes
Distribution 001	2060879-01	Drinking Water	06/08/2022 06:34	6/8/22 15:00	
Distribution 002	2060879-02	Drinking Water	06/08/2022 06:28	6/8/22 15:00	
Distribution 003	2060879-03	Drinking Water	06/08/2022 06:38	6/8/22 15:00	
Distribution 004	2060879-04	Drinking Water	06/08/2022 06:30	6/8/22 15:00	
Distribution 005	2060879-05	Drinking Water	06/08/2022 06:22	6/8/22 15:00	
Distribution 006	2060879-06	Drinking Water	06/08/2022 06:20	6/8/22 15:00	
Distribution 007	2060879-07	Drinking Water	06/08/2022 06:25	6/8/22 15:00	
Distribution 008	2060879-08	Drinking Water	06/08/2022 06:50	6/8/22 15:00	
Distribution 009	2060879-09	Drinking Water	06/08/2022 06:32	6/8/22 15:00	
Distribution 010	2060879-10	Drinking Water	06/08/2022 06:45	6/8/22 15:00	

Report Narrative

The results contained in this report are only representative of the samples received. Environmental Service Laboratories, Inc. is not responsible for use or interpretation of the data included herein.

Definitions

RL Reporting Limit

Certifications

Analyses performed by Environmental Service Laboratories, Inc., Indiana PA unless otherwise specified.

Environmental Service Laboratories, Inc., Indiana, PA/TNI Certification #32-00382

Approved By

Carrie G. Sutton-White

Carrie Sutton-White
Project Manager





1803 Philadelphia Street
Indiana, PA 15701
P: (724) 463-8378
F: (724) 465-4209
PADEP: 32-00382

1276 Bentleyville Road
Van Voorhis, PA 15366
P: (724) 258-8378
F: (724) 258-8376
PADEP: 63-04247

435 Broad Street
Montoursville, PA 17754
P: (570) 321-9002
F: (570) 321-1957
PADEP: 41-04880

950 West Main Street
Sharpsville, PA 16150
P: (724) 463-8378 x 500
F: (724) 465-4209
PADEP: 43-04934

Maplewood Elementary School
32695 State Highway 408
Townville, PA 16360

Reported: 06/13/2022 15:50

Lab Sample ID#: 2060879-01
Sample Type: Drinking Water
Sample Source: Grab
Sampler: Client
Client Sample ID: Distribution 001

Sample Date: 06/08/2022 06:34
Receipt Date: 06/08/2022 15:00

Analyte	Sample Result	Units	Data Qualifier	RL	Analyst/ Certification	Prep Date/Time	Analysis Date/Time
Total Metals		Analytical Method: EPA200.5 4.2			Prep Method: EPA 200.5 4.2		
Copper	0.029	mg/L		0.002	ANO	06/10/22 09:46	06/13/22 10:45
Lead	0.0030	mg/L		0.0025	ANO	06/10/22 09:46	06/13/22 10:45

Lab Sample ID#: 2060879-02
Sample Type: Drinking Water
Sample Source: Grab
Sampler: Client
Client Sample ID: Distribution 002

Sample Date: 06/08/2022 06:28
Receipt Date: 06/08/2022 15:00

Analyte	Sample Result	Units	Data Qualifier	RL	Analyst/ Certification	Prep Date/Time	Analysis Date/Time
Total Metals		Analytical Method: EPA200.5 4.2			Prep Method: EPA 200.5 4.2		
Copper	0.046	mg/L		0.002	ANO	06/10/22 09:46	06/13/22 10:47
Lead	<0.0025	mg/L		0.0025	ANO	06/10/22 09:46	06/13/22 10:47

Lab Sample ID#: 2060879-03
Sample Type: Drinking Water
Sample Source: Grab
Sampler: Client
Client Sample ID: Distribution 003

Sample Date: 06/08/2022 06:38
Receipt Date: 06/08/2022 15:00

Analyte	Sample Result	Units	Data Qualifier	RL	Analyst/ Certification	Prep Date/Time	Analysis Date/Time
Total Metals		Analytical Method: EPA200.5 4.2			Prep Method: EPA 200.5 4.2		
Copper	0.12	mg/L		0.002	ANO	06/10/22 09:46	06/13/22 10:50
Lead	<0.0025	mg/L		0.0025	ANO	06/10/22 09:46	06/13/22 10:50



1803 Philadelphia Street
Indiana, PA 15701
P: (724) 463-8378
F: (724) 465-4209
PADEP: 32-00382

1276 Bentleyville Road
Van Voorhis, PA 15366
P: (724) 258-8378
F: (724) 258-8376
PADEP: 63-04247

435 Broad Street
Montoursville, PA 17754
P: (570) 321-9002
F: (570) 321-1957
PADEP: 41-04880

950 West Main Street
Sharpsville, PA 16150
P: (724) 463-8378 x 500
F: (724) 465-4209
PADEP: 43-04934

Maplewood Elementary School
32695 State Highway 408
Townville, PA 16360

Reported: 06/13/2022 15:50

Lab Sample ID#: 2060879-04
Sample Type: Drinking Water
Sample Source: Grab
Sampler: Client
Client Sample ID: Distribution 004

Sample Date: 06/08/2022 06:30
Receipt Date: 06/08/2022 15:00

Analyte	Sample Result	Units	Data Qualifier	RL	Analyst/ Certification	Prep Date/Time	Analysis Date/Time
Total Metals		Analytical Method: EPA200.5 4.2			Prep Method: EPA 200.5 4.2		
Copper	0.065	mg/L		0.002	ANO	06/10/22 09:49	06/13/22 12:32
Lead	<0.0025	mg/L		0.0025	ANO	06/10/22 09:49	06/13/22 12:32

Lab Sample ID#: 2060879-05
Sample Type: Drinking Water
Sample Source: Grab
Sampler: Client
Client Sample ID: Distribution 005

Sample Date: 06/08/2022 06:22
Receipt Date: 06/08/2022 15:00

Analyte	Sample Result	Units	Data Qualifier	RL	Analyst/ Certification	Prep Date/Time	Analysis Date/Time
Total Metals		Analytical Method: EPA200.5 4.2			Prep Method: EPA 200.5 4.2		
Copper	0.10	mg/L		0.002	ANO	06/10/22 09:49	06/13/22 13:04
Lead	0.0034	mg/L		0.0025	ANO	06/10/22 09:49	06/13/22 13:04

Lab Sample ID#: 2060879-06
Sample Type: Drinking Water
Sample Source: Grab
Sampler: Client
Client Sample ID: Distribution 006

Sample Date: 06/08/2022 06:20
Receipt Date: 06/08/2022 15:00

Analyte	Sample Result	Units	Data Qualifier	RL	Analyst/ Certification	Prep Date/Time	Analysis Date/Time
Total Metals		Analytical Method: EPA200.5 4.2			Prep Method: EPA 200.5 4.2		
Copper	0.11	mg/L		0.002	ANO	06/10/22 09:49	06/13/22 12:15
Lead	<0.0025	mg/L		0.0025	ANO	06/10/22 09:49	06/13/22 12:15



1803 Philadelphia Street
Indiana, PA 15701
P: (724) 463-8378
F: (724) 465-4209
PADEP: 32-00382

1276 Bentleyville Road
Van Voorhis, PA 15366
P: (724) 258-8378
F: (724) 258-8376
PADEP: 63-04247

435 Broad Street
Montoursville, PA 17754
P: (570) 321-9002
F: (570) 321-1957
PADEP: 41-04880

950 West Main Street
Sharpsville, PA 16150
P: (724) 463-8378 x 500
F: (724) 465-4209
PADEP: 43-04934

Maplewood Elementary School
32695 State Highway 408
Townville, PA 16360

Reported: 06/13/2022 15:50

Lab Sample ID#: 2060879-07
Sample Type: Drinking Water
Sample Source: Grab
Sampler: Client
Client Sample ID: Distribution 007

Sample Date: 06/08/2022 06:25
Receipt Date: 06/08/2022 15:00

Analyte	Sample Result	Units	Data Qualifier	RL	Analyst/ Certification	Prep Date/Time	Analysis Date/Time
Total Metals		Analytical Method: EPA200.5 4.2			Prep Method: EPA 200.5 4.2		
Copper	0.13	mg/L		0.002	ANO	06/10/22 09:49	06/13/22 12:18
Lead	<0.0025	mg/L		0.0025	ANO	06/10/22 09:49	06/13/22 12:18

Lab Sample ID#: 2060879-08
Sample Type: Drinking Water
Sample Source: Grab
Sampler: Client
Client Sample ID: Distribution 008

Sample Date: 06/08/2022 06:50
Receipt Date: 06/08/2022 15:00

Analyte	Sample Result	Units	Data Qualifier	RL	Analyst/ Certification	Prep Date/Time	Analysis Date/Time
Total Metals		Analytical Method: EPA200.5 4.2			Prep Method: EPA 200.5 4.2		
Copper	0.022	mg/L		0.002	ANO	06/10/22 09:49	06/13/22 12:20
Lead	<0.0025	mg/L		0.0025	ANO	06/10/22 09:49	06/13/22 12:20

Lab Sample ID#: 2060879-09
Sample Type: Drinking Water
Sample Source: Grab
Sampler: Client
Client Sample ID: Distribution 009

Sample Date: 06/08/2022 06:32
Receipt Date: 06/08/2022 15:00

Analyte	Sample Result	Units	Data Qualifier	RL	Analyst/ Certification	Prep Date/Time	Analysis Date/Time
Total Metals		Analytical Method: EPA200.5 4.2			Prep Method: EPA 200.5 4.2		
Copper	0.081	mg/L		0.002	ANO	06/10/22 09:49	06/13/22 12:23
Lead	<0.0025	mg/L		0.0025	ANO	06/10/22 09:49	06/13/22 12:23



1803 Philadelphia Street
Indiana, PA 15701
P: (724) 463-8378
F: (724) 465-4209
PADEP: 32-00382

1276 Bentleyville Road
Van Voorhis, PA 15366
P: (724) 258-8378
F: (724) 258-8376
PADEP: 63-04247

435 Broad Street
Montoursville, PA 17754
P: (570) 321-9002
F: (570) 321-1957
PADEP: 41-04880

950 West Main Street
Sharpsville, PA 16150
P: (724) 463-8378 x 500
F: (724) 465-4209
PADEP: 43-04934

Maplewood Elementary School
32695 State Highway 408
Townville, PA 16360

Reported: 06/13/2022 15:50

Lab Sample ID#: 2060879-10
Sample Type: Drinking Water
Sample Source: Grab
Sampler: Client
Client Sample ID: Distribution 010

Sample Date: 06/08/2022 06:45
Receipt Date: 06/08/2022 15:00

Analyte	Sample Result	Units	Data Qualifier	RL	Analyst/ Certification	Prep Date/Time	Analysis Date/Time
Total Metals		Analytical Method: EPA200.5 4.2			Prep Method: EPA 200.5 4.2		
Copper	0.27	mg/L		0.002	ANO	06/10/22 09:49	06/13/22 12:25
Lead	0.0044	mg/L		0.0025	ANO	06/10/22 09:49	06/13/22 12:25

PENNSYLVANIA Department of Environmental Protection

E-Government Application for Drinking Water
Program

SAFE DRINKING WATER ACT
VIEW/EDIT RECORDS

6200309: MAPLEWOOD ELEMENTARY SCHOOL

SDWA1

PWSID	Contam ID	Contam	Analysis Method	Result	Analysis Date	Location ID 1	Location ID 2	Sample Date	Sample Type	Sample Time	Lab ID	Sample ID	Record ID
6200309	1022	COPPER	171	0.029	061322	001		060822	D	0634	32382	2060879-01	BROWNKA_983
6200309	1030	LEAD	171	0.0030	061322	001		060822	D	0634	32382	2060879-01	BROWNKA_999
6200309	1022	COPPER	171	0.046	061322	002		060822	D	0628	32382	2060879-02	BROWNKA_984
6200309	1030	LEAD	171	0.0	061322	002		060822	D	0628	32382	2060879-02	BROWNKA_992
6200309	1022	COPPER	171	0.12	061322	003		060822	D	0638	32382	2060879-03	BROWNKA_989
6200309	1030	LEAD	171	0.0	061322	003		060822	D	0638	32382	2060879-03	BROWNKA_993
6200309	1022	COPPER	171	0.065	061322	004		060822	D	0630	32382	2060879-04	BROWNKA_985
6200309	1030	LEAD	171	0.0	061322	004		060822	D	0630	32382	2060879-04	BROWNKA_994
6200309	1022	COPPER	171	0.1	061322	005		060822	D	0622	32382	2060879-05	BROWNKA_987
6200309	1030	LEAD	171	0.0034	061322	005		060822	D	0622	32382	2060879-05	BROWNKA_1000
6200309	1022	COPPER	171	0.11	061322	006		060822	D	0620	32382	2060879-06	BROWNKA_988
6200309	1030	LEAD	171	0.0	061322	006		060822	D	0620	32382	2060879-06	BROWNKA_995
6200309	1022	COPPER	171	0.13	061322	007		060822	D	0625	32382	2060879-07	BROWNKA_990
6200309	1030	LEAD	171	0.0	061322	007		060822	D	0625	32382	2060879-07	BROWNKA_996
6200309	1022	COPPER	171	0.022	061322	008		060822	D	0650	32382	2060879-08	BROWNKA_982
6200309	1030	LEAD	171	0.0	061322	008		060822	D	0650	32382	2060879-08	BROWNKA_997
6200309	1022	COPPER	171	0.081	061322	009		060822	D	0632	32382	2060879-09	BROWNKA_986
6200309	1030	LEAD	171	0.0	061322	009		060822	D	0632	32382	2060879-09	BROWNKA_998
6200309	1022	COPPER	171	0.27	061322	010		060822	D	0645	32382	2060879-10	BROWNKA_991



E-Government Application for Drinking Water
Program

SAFE DRINKING WATER ACT
VIEW/EDIT RECORDS

6200309: MAPLEWOOD ELEMENTARY SCHOOL

SDWA1

PWSID	Contam ID	Contam	Analysis Method	Result	Analysis Date	Location ID 1	Location ID 2	Sample Date	Sample Type	Sample Time	Lab ID	Sample ID	Record ID
6200309	1030	LEAD	171	0.0044	061322	010		060822	D	0645	32382	2060879-10	BROWNKA_1001
6200309	1013	FREE CHLORINE	301	0.22	060122	711		060122	D	1001	32382	2060132-01	BROWNKA_396
6200309	3100	TOTAL COLIFORM PRESENCE	331	0.0	060222	711		060122	D	1001	32382	2060132-01	BROWNKA_397
6200309	1013	FREE CHLORINE	301	2.2	060822	810		060822	D	1143	32382	2060972-01	BROWNKA_398

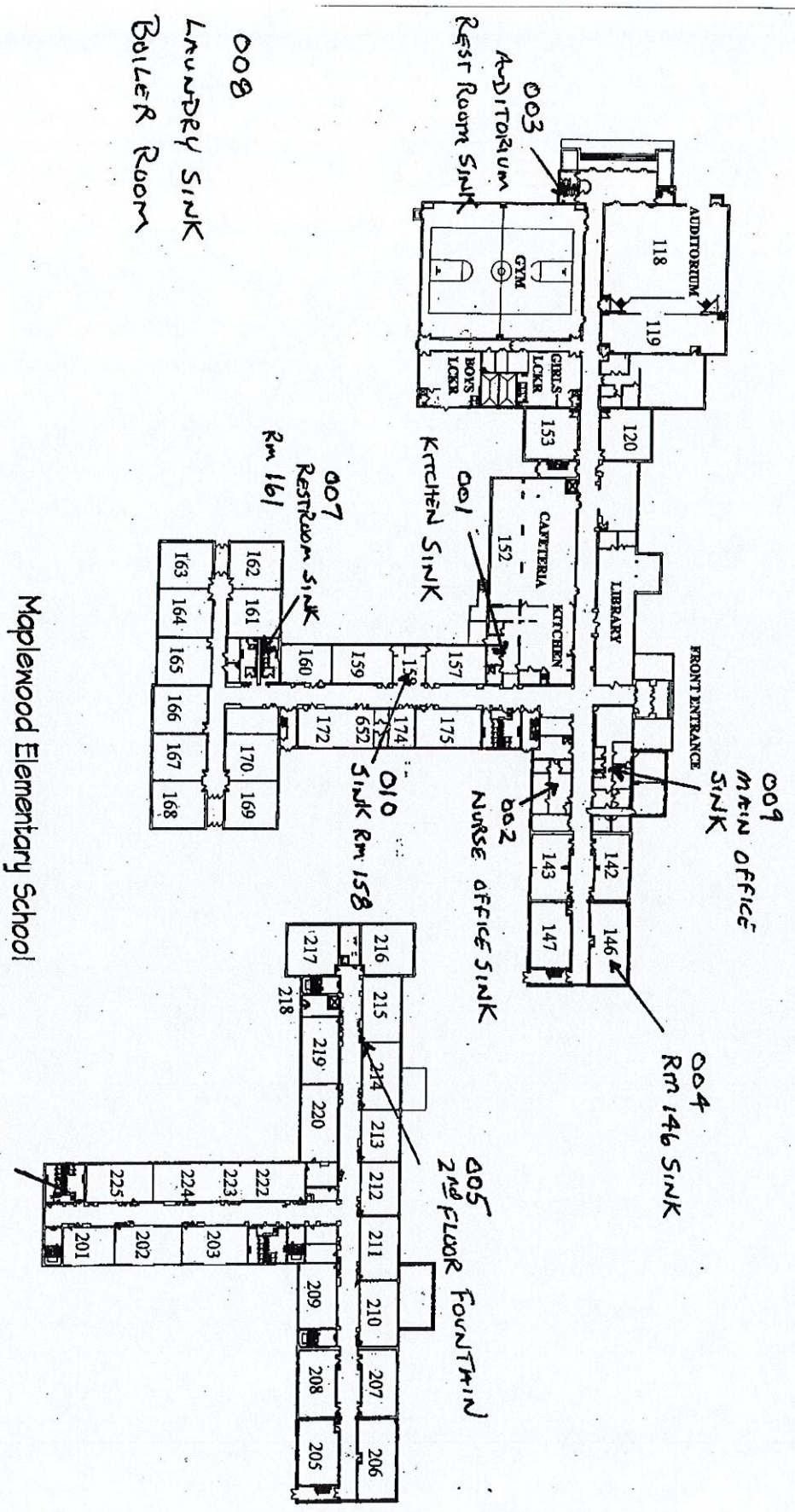

2016 REVISED SUGGESTED DIRECTIONS TAP SAMPLE COLLECTION PROCEDURES

These samples are being collected to determine the lead and copper levels in your tap water. This sampling effort is required by the U.S. Environmental Protection Agency and the Pennsylvania Department of Environmental Protection, and is being accomplished through the cooperation of homeowners and residents.

A sample is to be collected after water has been sitting in the pipes for an extended period of time (i.e., no water use during this period). Due to this requirement, either early mornings or evenings upon returning home from work are the best times for collecting samples. The collection procedure is described in more detail below:

1. Prior arrangements will be made with the customer to coordinate the sample collection event. Dates will be set for sample kit delivery and pick-up by water department staff.
2. **A minimum six (6) hour period during which there is no water use throughout the house must be achieved prior to sampling. Do not intentionally flush the water line before the start of the 6 hour period.** The water department recommends that either early mornings or evenings upon returning home are the best sampling times to ensure that the necessary stagnant water conditions exist.
3. **A kitchen or bathroom cold-water faucet** is to be used for sampling. **Do not remove the aerator prior to sampling.** If you have water softeners on your kitchen taps, collect your sample from the bathroom tap that is not attached to a water softener, or a point of use filter, if possible. **Place the sample bottle (open) below the faucet and open the cold water tap as you would do to fill a glass of water.** Fill the sample bottle to the line marked "1,000-ml" and turn off the water.
4. Tightly cap the sample bottle and place it in the sample kit provided. Please review the sample kit label at this time to ensure that all information contained on the label is correct.
5. If any plumbing repairs or replacement has been done in the home since the previous sampling event, note this information on the label as provided. Also if your sample was collected from a tap with a water softener, note this as well.
6. Place the sample kit outside of the residence in the location of the kit's delivery so that department staff may pick up the sample kit.
7. Results from this monitoring effort and information about lead will be provided to you as soon as practical but no later than 30 days after the system learns of the tap monitoring results. However, if excessive lead and/or copper levels are found, immediate notification will be provided (usually 1-2 working days after the system learns of the tap monitoring results).

Call _____ at _____ if you have any questions regarding these instructions.

I certify that each resident or sample collector has been instructed in the proper methods for collecting lead and copper tap samples.

Water Supplier Signature:



Date:

1-14-21