



KITCHEN EQUIPMENT AT VARIOUS SITES, PHASE II

10/19/2022

Addendum # 2

This addendum is hereby a part of those documents and contracts, the same as if bound therein and it shall supersede anything contained in the original bid manual with which it might conflict.

- Please see attached files.

The end

10/21/2022

Chris Hudgins
Tulsa Public Schools
3027 South New Haven Avenue
Tulsa, Oklahoma 74114

Re: Bell Elementary School

Dear Chris,

The following are items for Addendum #2.

The following are clarifications to the items specified:

ITEM NO. 07 - TRASH CAN (4 REQUIRED)

Carlisle Foodservice Products model 341032 trash can in a gray color. NSF listed.

Accessories

4 ea. Model 341033 GY lid for in a gray color. NSF listed.
4 ea. Model 3691003 dolly in a black color.

The following are changes to the drawings:

There are no revisions at this time.

The following items are acceptable as substitutions to the items specified:

There none submitted or approved. The bid will be as specified.

Sincerely,

Rocky Sturm, CFSP

10/21/2022

Chris Hudgins
Tulsa Public Schools
3027 South New Haven Avenue
Tulsa, Oklahoma 74114

Re: Memorial High School

Dear Chris,

The following are items for Addendum #2.

The following are clarifications to the items specified:

ITEM NO. 25 - MOBILE PAN RACK (2 REQUIRED)

Eagle Group Model QUADPLUS mobile pan rack. Provide each unit four (4) shelves with 74" high posts. Mount the bottom shelf at 10" above the finish floor. Mount the remaining shelves at 17" on center.

Accessories

- 8 ea. Model QPF-2436E-GL shelves.
- 8 ea. Model CP74-E posts.
- 8 ea. Model CSB5P-300 casters with brakes.

ITEM NO. 60 - ROLL-IN RACK (2 REQUIRED)

New Age model 1637 with all the standard features. Only one (1) shown on the plan.

ITEM NO. 68 - DROP-IN HOT FOOD WELLS (2 REQUIRED)

Low Temp Industries model TW-DW-5 with all the standard features.

Accessories

- 2 ea. 208 volts, single phase.

The following are changes to the drawings:

There are no revisions at this time.

The following items are acceptable as substitutions to the items specified:

There none submitted or approved. The bid will be as specified.

Sincerely,

Rocky Sturm, CFSP

10/21/2022

Chris Hudgins
Tulsa Public Schools
3027 South New Haven Avenue
Tulsa, Oklahoma 74114

Re: Hale High School

Dear Chris,

The following are items for Addendum #2.

The following are clarifications to the items specified:

ITEM NO. 03 - STORAGE SHELVING (1 LOT REQUIRED)

Eagle Group model Quad TRUSS storage shelves. Locate the bottom shelf at 10" above the finish floor and the remaining four (4) shelves at 17" O.C. at the balance of the shelving. Provide units of three (3) shelves with 86" high posts and footplates at the dunnage racks. Mount the bottom shelf at 44" above the finish floor. Mount the remaining shelves at 17" on center.

Accessories

- 6 ea. Model 2136C shelves. Locate at the top and the bottom of the units.
- 9 ea. Model QA2136C shelves.
- 2 ea. Model 2142C shelves. Locate at the top and the bottom of the units.
- 3 ea. Model QA2142C shelves.
- 6 ea. Model 2148C shelves. Locate at the top and the bottom of the units.
- 8 ea. Model 2154C shelves. Locate at the top and the bottom of the units.
- 11 ea. Model QA2154C shelves.
- 7 ea. Model 2160C shelves. Locate at the top and the bottom of the units.
- 6 ea. Model QA2160C shelves.
- 4 ea. Model 74C posts.
- 48 ea. Model 86C posts.
- 12 ea. Model FOOT-PLATE-S foot plates. Mount the foot plates to the floor with stainless steel fasteners. Locate the foot plates on the units at the dunnage racks.

ITEM NO. 11 - CHEMICAL STORAGE SHELVING (1 LOT REQUIRED)

Eagle Group model Quad TRUSS chemical storage shelves. Locate the bottom shelf at 10" above the finish floor and the remaining four (4) shelves at 17" O.C. at the balance of the shelving.

Accessories

- 2 ea. Model 1430C shelves. Locate at the top and the bottom of the units.
- 3 ea. Model QA1430C shelves.
- 4 ea. Model P86-C posts.

ITEM NO. 12 - LINEN STORAGE SHELVING (1 LOT REQUIRED)

Eagle Group model Quad TRUSS linen storage shelves. Locate the bottom shelf at 10" above the finish floor and the remaining four (4) shelves at 17" O.C. at the balance of the shelving.

Accessories

- 2 ea. Model 1430C shelves. Locate at the top and the bottom of the units.
- 3 ea. Model QA1430C shelves.
- 4 ea. Model P86-C posts.

ITEM NO. 73 - POT SINK (1 REQUIRED)

Eagle Group model 310-10-3-12 with all the standard features.

Accessories

- 1 ea. Model SL stainless steel legs and crossrails.
- 1 ea. T & S model B-0230 faucet.
- 3 ea. Component Hardware model DBN-8000 twist waste valve. Shorten the handle to be flush with the front of the sink bowl. Provide 14 gauge type 304 stainless steel brackets to support the handles. Attach to the sink bottom with stainless steel anchors.

ITEM NO. 82 - DROP-IN COLD FOOD WELLS (1 REQUIRED)

Low Temp Industries model DI-2050TA with all the standard features.

Accessories

- 1 ea. 120 volts, single phase.

ITEM NO. 87 - CASHIER COUNTER (1 REQUIRED)

Custom fabricated cashier serving counter to be constructed with a Corian Artic Ice top. Provide 12 gauge fully welded type 304 stainless steel channel underbracing under the top.

Features

- 01 Provide with a 2" turn down with a tight hem at the exposed sides.
- 02 Provide a 16 gauge type 304 stainless steel fully welded counter body per the drawing elevations.
- 03 Provide a 16 gauge type 304 stainless steel fully welded foot rest per the drawing elevations. Provide 12 gauge type 304 stainless steel fully welded channel underbracing under the foot rest. Sound deadened between the undershelves and the underbracing.
- 04 Provide a 16 gauge type 304 stainless steel fully welded cash drawer per the elevations. Provide a 16 gauge type 304 stainless steel fully welded drawer face. Provide Component Hardware S52 series drawer slides. Weld the slides to the drawer assembly. Provide Component Hardware model P62-1010 pulls. Weld the pulls to the drawer face from the inside of the face.
- 05 Provide removable 18 gauge stainless steel panels on the counter fronts and side per the elevations. Provide a 6" x 6" one piece panel at the corners. Attach the panels to the counter with 14 gauge stainless steel Z-clips at the bottom of the panels.
- 06 Provide polyurethane tired casters with brakes.

The following are changes to the drawings:

Drawing Addendum Number 2 - FS1.1.2.

The panini grill number changed to 83.

The following items are acceptable as substitutions to the items specified:

There none submitted or approved. The bid will be as specified.

Sincerely,

Rocky Sturm, CFSP

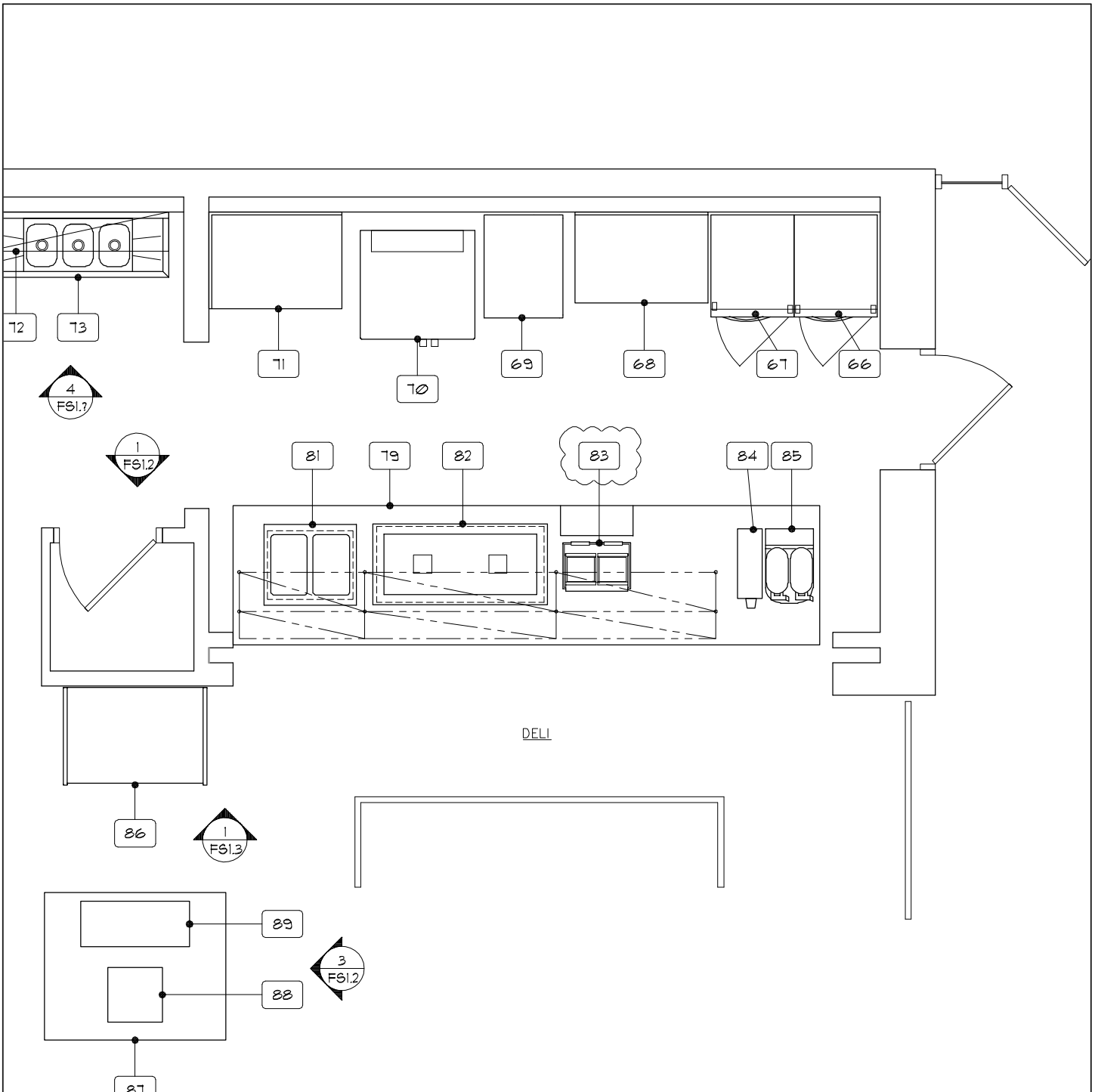

1 FOODSERVICE EQUIPMENT ARRANGEMENT PLAN

1/4" = 1'-0"

HALE HIGH SCHOOL

6960 E. 21ST STREET, TULSA, OKLAHOMA

PROJECT NUMBER 2022.15

SHEET NUMBER FS1.1.2

ADDENDUM NUMBER 2

DATE: 10/21/2022

STURM CONSULTING, INC. FOODSERVICE DESIGN & PLANNING

5838 SOUTH HUDSON PLACE
TULSA, OKLAHOMA 74135
PHONE (918) 260-0887
FAX (918) 489-3933
rockysturm@cox.net



10/21/2022

Chris Hudgins
Tulsa Public Schools
3027 South New Haven Avenue
Tulsa, Oklahoma 74114

Re: Hale High School

Dear Chris,

The following are items for Addendum #2.

The following are clarifications to the items specified:

ITEM NO. 03 - STORAGE SHELVING (1 LOT REQUIRED)

Eagle Group model Quad TRUSS storage shelves. Locate the bottom shelf at 10" above the finish floor and the remaining four (4) shelves at 17" O.C. at the balance of the shelving. Provide units of three (3) shelves with 86" high posts and footplates at the dunnage racks. Mount the bottom shelf at 44" above the finish floor. Mount the remaining shelves at 17" on center.

Accessories

- 6 ea. Model 2136C shelves. Locate at the top and the bottom of the units.
- 9 ea. Model QA2136C shelves.
- 2 ea. Model 2142C shelves. Locate at the top and the bottom of the units.
- 3 ea. Model QA2142C shelves.
- 6 ea. Model 2148C shelves. Locate at the top and the bottom of the units.
- 8 ea. Model 2154C shelves. Locate at the top and the bottom of the units.
- 11 ea. Model QA2154C shelves.
- 7 ea. Model 2160C shelves. Locate at the top and the bottom of the units.
- 6 ea. Model QA2160C shelves.
- 4 ea. Model 74C posts.
- 48 ea. Model 86C posts.
- 12 ea. Model FOOT-PLATE-S foot plates. Mount the foot plates to the floor with stainless steel fasteners. Locate the foot plates on the units at the dunnage racks.

ITEM NO. 11 - CHEMICAL STORAGE SHELVING (1 LOT REQUIRED)

Eagle Group model Quad TRUSS chemical storage shelves. Locate the bottom shelf at 10" above the finish floor and the remaining four (4) shelves at 17" O.C. at the balance of the shelving.

Accessories

- 2 ea. Model 1430C shelves. Locate at the top and the bottom of the units.
- 3 ea. Model QA1430C shelves.
- 4 ea. Model P86-C posts.

ITEM NO. 12 - LINEN STORAGE SHELVING (1 LOT REQUIRED)

Eagle Group model Quad TRUSS linen storage shelves. Locate the bottom shelf at 10" above the finish floor and the remaining four (4) shelves at 17" O.C. at the balance of the shelving.

Accessories

- 2 ea. Model 1430C shelves. Locate at the top and the bottom of the units.
- 3 ea. Model QA1430C shelves.
- 4 ea. Model P86-C posts.

ITEM NO. 57 - DROP-IN PIZZA WARMERS (1 REQUIRED)

Hatco model GRSB-66I with all the standard features.

Accessories

- 1 ea. 120 volts, single phase.
- 1 ea. Model GRSB-FLUSH-ITC flush mount electronic control box. Mount in the counter face per the drawings.
- 1 ea. Model STANDARD flush mounted bezel with a stainless steel finish.

ITEM NO. 73 - POT SINK (1 REQUIRED)

Eagle Group model 310-10-3-12 with all the standard features.

Accessories

- 1 ea. Model SL stainless steel legs and crossrails.
- 1 ea. T & S model B-0230 faucet.
- 3 ea. Component Hardware model DBN-8000 twist waste valve. Shorten the handle to be flush with the front of the sink bowl. Provide 14 gauge type 304 stainless steel brackets to support the handles. Attach to the sink bottom with stainless steel anchors.

ITEM NO. 82 - DROP-IN COLD FOOD WELLS (1 REQUIRED)

Low Temp Industries model DI-2050TA with all the standard features.

Accessories

- 1 ea. 120 volts, single phase.

ITEM NO. 87 - CASHIER COUNTER (1 REQUIRED)

Custom fabricated cashier serving counter to be constructed with a Corian Artic Ice top. Provide 12 gauge fully welded type 304 stainless steel channel underbracing under the top.

Features

- 01 Provide with a 2" turn down with a tight hem at the exposed sides.
- 02 Provide a 16 gauge type 304 stainless steel fully welded counter body per the drawing elevations.
- 03 Provide a 16 gauge type 304 stainless steel fully welded foot rest per the drawing elevations. Provide 12 gauge type 304 stainless steel fully welded channel underbracing under the foot rest. Sound deadened between the undershelves and the underbracing.
- 04 Provide a 16 gauge type 304 stainless steel fully welded cash drawer per the elevations. Provide a 16 gauge type 304 stainless steel fully welded drawer face. Provide Component Hardware S52 series drawer slides. Weld the slides to the drawer assembly. Provide Component Hardware model P62-1010 pulls. Weld the pulls to the drawer face from the inside of the face.
- 05 Provide removable 18 gauge stainless steel panels on the counter fronts and side per the elevations. Provide a 6" x 6" one piece panel at the

06 corners. Attach the panels to the counter with 14 gauge stainless steel Z-clips at the bottom of the panels.
Provide polyurethane tired casters with brakes.

The following are changes to the drawings:

Drawing Addendum Number 2 - FS1.1.2.

The panini grill number changed to 83.

The following items are acceptable as substitutions to the items specified:

There none submitted or approved. The bid will be as specified.

Sincerely,

Rocky Sturm, CFSP