



STUDENT PARKING INSTRUCTIONS

2022-2023 AMY BULL CRIST CAMPUS (Gibson Road)

All students who wish to drive to and from Career and Technical Education at the Orange-Ulster BOCES are required to obtain a Permanent Parking Permit Application.

The permanent parking permit will allow access to designated student parking areas only. Student parking is located on the Greenhouse side of the building. *Under no circumstances are students permitted to park outside of designated areas.*

To obtain an Orange-Ulster BOCES Career and Technical Education permanent parking permit, students must complete the Permanent Parking Permit Application, sign and return the Student Driving and Parking Regulations Compliance Form, obtain all required signatures, and submit supporting documentation (i.e., copies of Driver's License, Registration Card and Insurance Card).

Please note that permanent parking permits are extremely limited and will be issued first to students who have extenuating circumstance. Permits will then be given to students on a first come/first serve basis. Once capacity is reached, a wait-list will be established. This will be strictly enforced for the safety of our campus.

STUDENT DRIVING TRAFFIC FLOW MAP

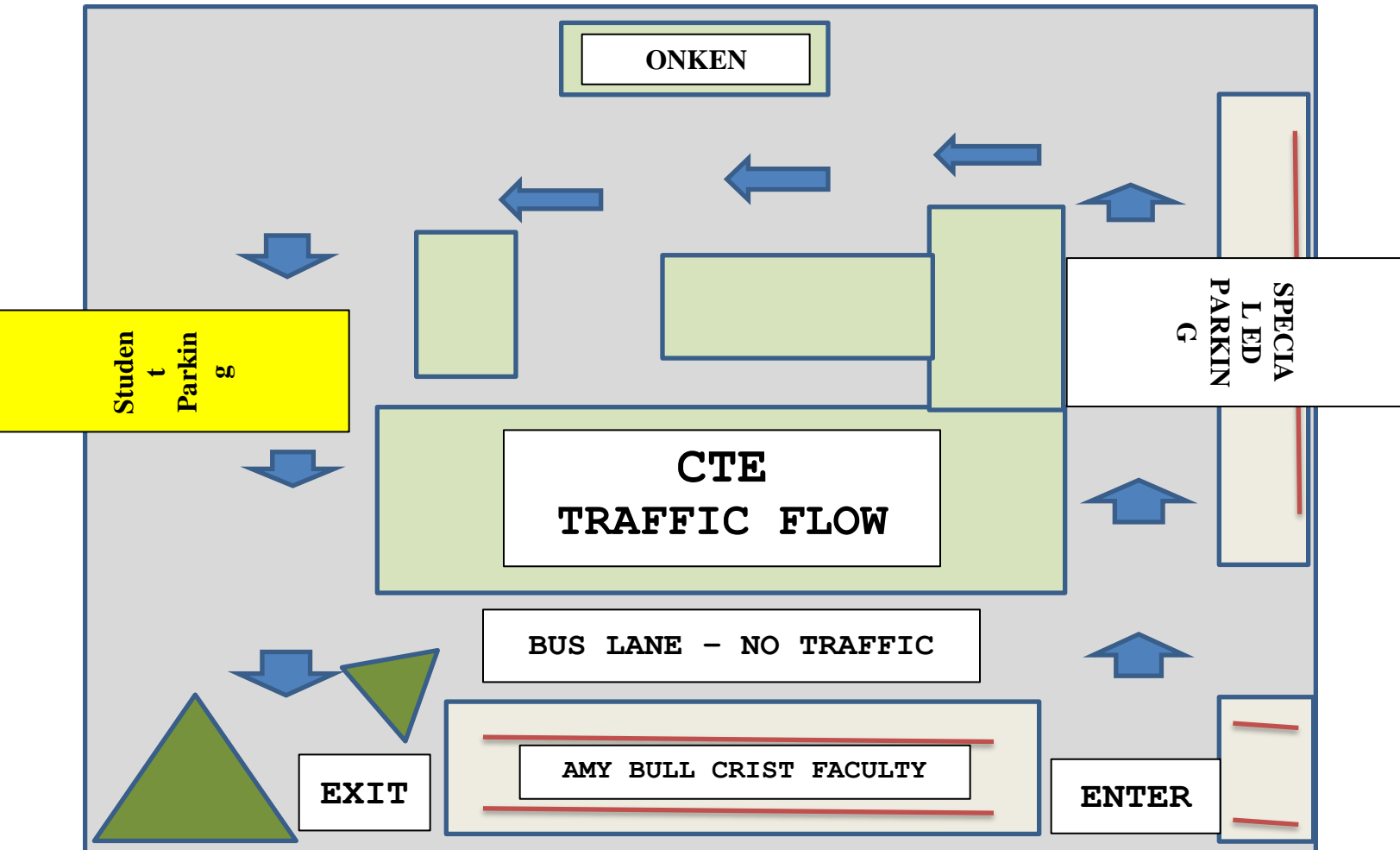

**ORANGE-ULSTER BOCES
CAREER AND TECHNICAL EDUCATION (CTE)
GOSHEN, NEW YORK
STUDENT DRIVING AND PARKING REGULATIONS
COMPLIANCE FORM
2022-2023 AMY BULL CRIST CAMPUS**

Parking on campus is a privilege. Students who obtain parking privileges are expected to exhibit responsible behavior. *Students who violate the Orange-Ulster BOCES Career and Technical Education Driving and Parking regulations are subject to the temporary or permanent revocation of their parking permit, administrative disciplinary action, the towing of their car at the owner's expense, and/or police intervention. Orange-Ulster BOCES does not recommend any student driver transport other individuals.*

1. Students must adhere to all New York State and local traffic laws.
2. Safe and courteous driving is expected in the parking lots and on school grounds. Student drivers must be courteous to staff on bus duty and are required to readily present identification or permits upon request.
3. Permanent parking stickers issued to drivers must be affixed to the windshield and clearly visible on the windshield. Only **one (1)** sticker will be issued per student.
4. All cars parked on campus must be registered with the Main Office. Any vehicle parked on campus that is not registered with the Main Office and is parked in an undesignated area may be towed at the owner's expense. Student parking is located on the Greenhouse side of the building (see map).
5. The Orange-Ulster BOCES assumes no responsibility for any vehicle or its contents.
6. Cars must be parked between the lines and must be clear of all exits and emergency vehicle lanes.
7. Vehicles must be taken home from the parking lot at the end of the school day.
8. Student drivers are responsible for arriving on time. Morning sessions will start at 8:05 a.m. and afternoon sessions will start at 12:30 p.m. Student drivers arriving after these times will be considered late, given a late pass, and have their attendance marked accordingly.
9. All students are to exit BOCES property via the Greenhouse exit **ONLY** during morning or afternoon dismissal. Students are not permitted to exit the property via any alternate egress.
10. **Students obtaining a live-work permit (students must show their permit to staff upon departure) may park adjacent to the transportation academy.**
11. Students are not allowed to rev their engines, honk their horns, spin their tires, or blast loud music or noises of any kind during dismissal. Any noise during dismissal interferes with the safety protocols for ensuring a smooth departure from school.
12. All instances of property damage related to motor vehicle use must be reported immediately following the occurrence to an administrator.
13. **If a student's vehicle is temporarily not able to be driven, the student must take the bus from their home school to CTE.**
14. **If a student must drive a different vehicle to CTE other than the vehicle documented on this form, the student must inform the Assistant Principal, Mr. D'Ambrosio. If there are extenuating circumstances, the student will have to obtain the appropriate document to be able to park on campus.**

NOTE: Any violations of the foregoing may jeopardize driving privileges.

I have read, fully understand, and will comply with the Student Driver and Rider Rules listed above.

Student Signature: _____ Date: _____

Parent Signature: _____ Date: _____

**CAREER AND TECHNICAL EDUCATION
PERMANENT PARKING PERMIT APPLICATION
 2022-2023 AMY BULL CRIST CAMPUS**

Last Name:	First Name:
Program:	Teacher:
Address:	A.M. P.M.
City:	Cell Phone:
State: Zip:	Home Phone:
Vehicle Make:	Model:
Color:	License Plate #:
District:	Reason:

By signing below I understand and accept the following:

- The Orange-Ulster Board of Cooperative Educational Services (BOCES) regards the use of personal motor vehicles for travel to and from school as an assumption of responsibility by parents/guardians and students. Specifically, automotive liability and bodily injury insurance is the responsibility of the owner of the vehicle used; the BOCES does not carry any automotive liability or injury insurance covering student drivers/passengers. **Orange-Ulster BOCES does not recommend any student driver transport other individuals.**
- **PARKING ON CAMPUS IS A PRIVILEGE!.** Students who obtain a permit and privilege are expected to exhibit responsible behavior. Students who violate the Orange-Ulster BOCES Career and Technical Education parking regulations are subject to the temporary or permanent revocation of their parking permit, administrative disciplinary action, the towing of their car at the owner's expense, and/or police intervention.

DRIVER (Signature): _____ DATE: _____

PARENT/GUARDIAN: _____ DATE: _____

CTEC ASSISTANT PRINCIPAL: _____ DATE: _____

CTE Office Use Only:

Date Received: _____ Time: _____

Parking Permit #: _____ **Issuance Date:** _____