

# MSDA Drop-Off & Parking Map Guide

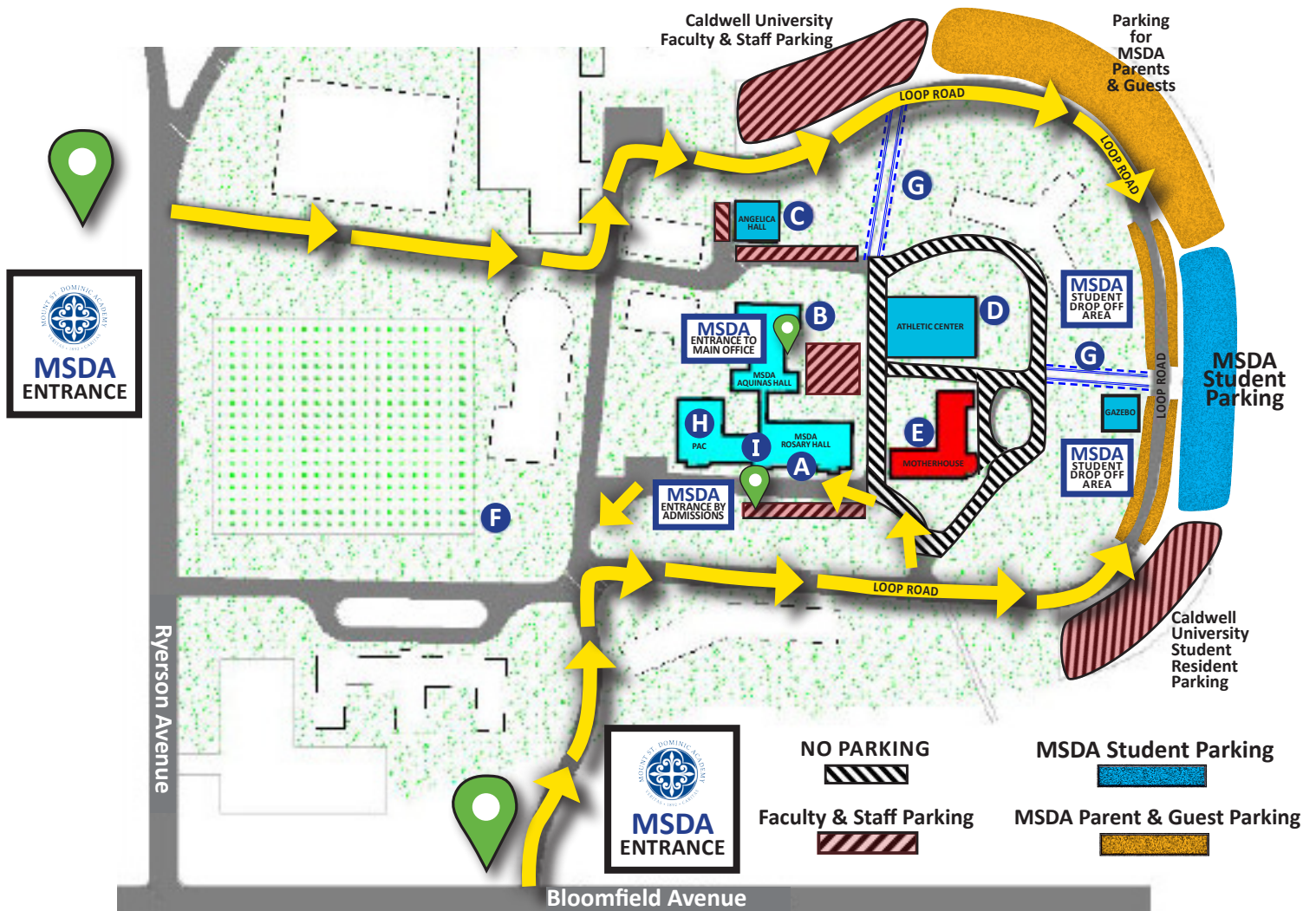

## Drop Off/Pick Up GUIDELINES - [www.msdacademy.org/campus](http://www.msdacademy.org/campus)

- There are **TWO** main entrances to Mount St. Dominic Academy:
  - Enter at the **Bloomfield Avenue** Entrance, then turn right at the 4-way stop sign. Proceed on the lower loop road to the parking areas and student drop off/pick up area.
  - Enter from **Ryerson Avenue**, then turn left at the intersection. Proceed on the loop road to parking areas and student drop off/pick up area.
- **Morning Drop Off** is in front of Rosary Hall. **Afternoon Pick Up** is by the gazebo.
- **Parking in handicap or fire/emergency vehicle spaces and double parking IS PROHIBITED.**
- **Absolutely NO PARKING** in spaces marked for the Motherhouse/Convent and St. Catherine of Siena Infirmary.
  - If a space is not available, drivers may not pull over in illegal spaces to wait for students. Park in the designated areas (see map) and wait there for student to be ready to be picked up. Caldwell University and the Sisters of St. Dominic will strictly enforce this guideline and disciplinary action will follow. See [Caldwell University Safety](#).
- Parking for students, parents, faculty, and staff are in the areas indicated on the map.
- Parents may use the gravel spaces on the sides of the loop road near the Gazebo to pull off and wait for students.
- Students with a medical excuse provided by the school nurse may be dropped off and picked up in front of the school.

## MAP KEY

- A** MSDA Building - Rosary Hall
- B** MSDA Building - Aquinas Hall / Main Office Entrance
- C** MSDA Building - Angelica Hall
- D** MSDA Athletic Center
- E** Sisters of St. Dominic Motherhouse
- F** Athletic Field
- G** Walkway to/from Gazebo and/or Parking
- H** Doris M. Byrne Performing Arts Center
- I** MSDA Building - Rosary Hall / Admissions Entrance
- J** Gazebo