

Finn Hill Middle School (FHMS) Modified Site Circulation as of September 2022

EAS vehicles entering drop-off/pick-up loop should yield to FHMS exiting traffic.

FHMS On-Site Drop-off/Pick-up Loop
Vehicles entering from 132nd St will proceed left to navigate the parking lot loop. After pick-up/drop-off, vehicles will exit through the fire lane towards 84th Ave. Vehicles will not be allowed to exit to 132nd St. All loading/unloading of students should occur in the Active drop-off/pick-up zone and not in the parking lot drive aisles.





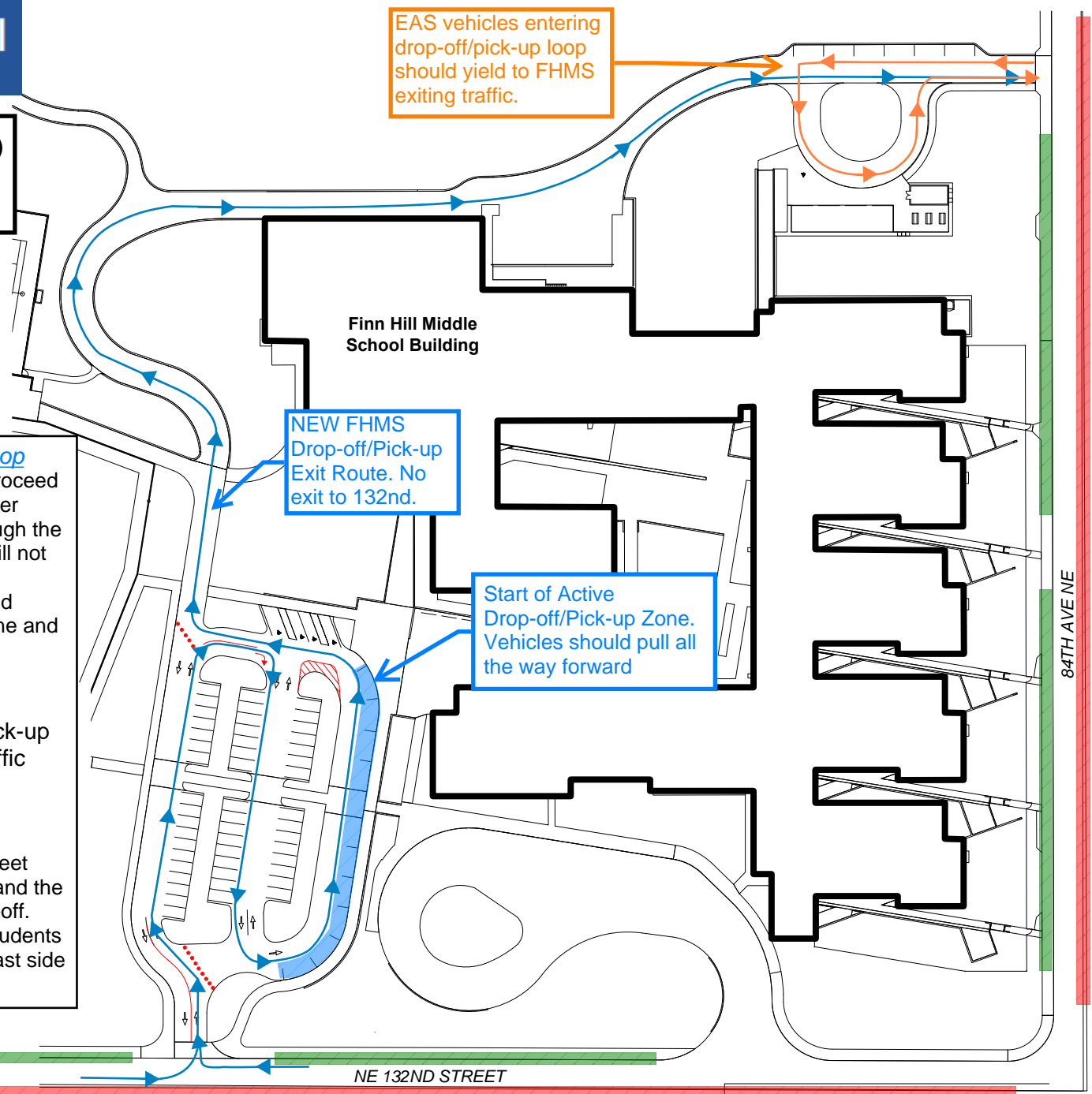

EAS Drop-off/Pick-up Loop
Vehicles using the EAS drop-off/pick-up loop should yield to new exiting traffic from FHMS fire lane to 84th Ave.

On-Street Drop-off/Pick-up
Vehicles may utilize the existing on-street parking on the north side of 132nd St and the west side of 84th Ave for pick-up/drop-off. Vehicles should not pick-up/drop-off students on the south side of 132nd St or the east side of 84th Ave.



NEW FHMS Drop-off/Pick-up Exit Route. No exit to 132nd.

Start of Active Drop-off/Pick-up Zone. Vehicles should pull all the way forward

	NEW FHMS drop-off/pick-up route		Active Drop-off/Pick-up Zone (load/unload students in this area ONLY)
	EAS drop-off/pick-up route		Drop-off/pick-up allowed in on-street parking
	Access prohibited during drop-off/pick-up		Drop-off/pick-up prohibited