

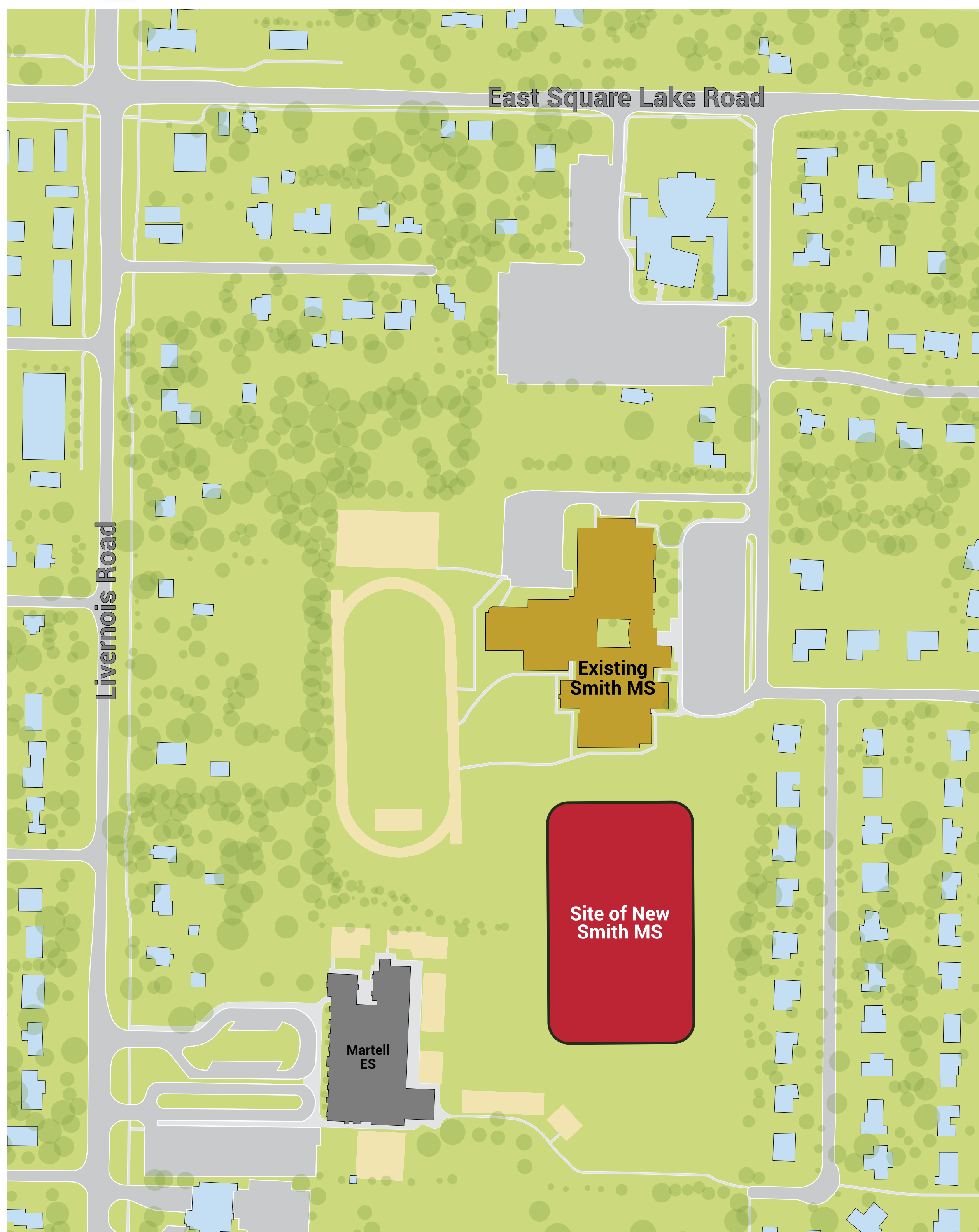

SMITH MIDDLE SCHOOL



Conceptual Site Layout

Features at Smith

- Build new innovative Smith Middle School
- New flexible, adaptable furniture
- Infrastructure upgrades (at existing Smith Middle School)

The existing Smith building will be used as a temporary learning space for students when construction requires relocation. Infrastructure upgrades would occur only as needed.

SMITH WAS BUILT **55** YEARS AGO

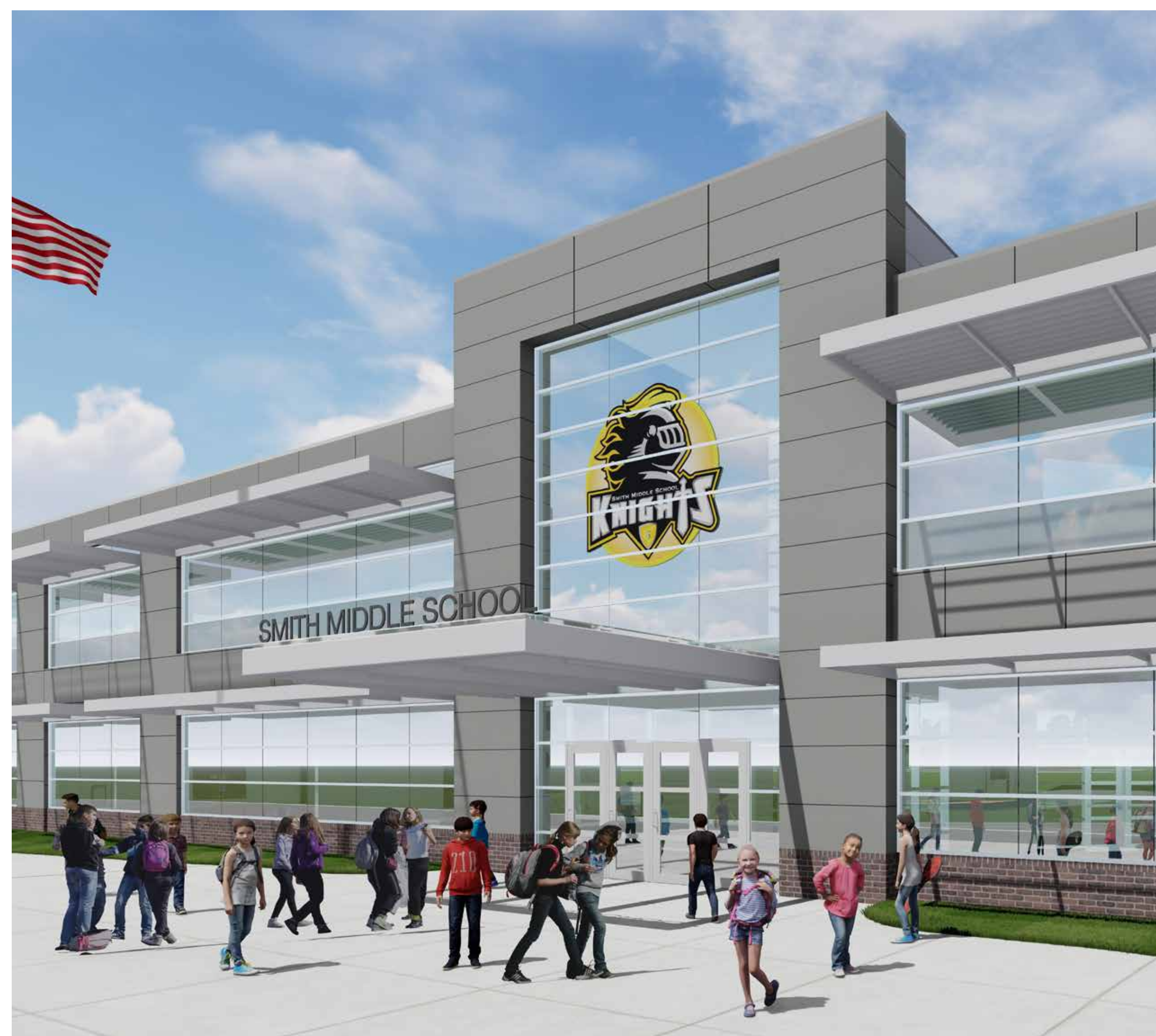

Artist's rendering of entrance at new Smith Middle School

Bond 2022 Highlights

Future-Ready Learning Environments

- Create innovative and engaging educational spaces
- Foster collaboration and critical thinking
- Continue academic excellence and community engagement

Infrastructure & Sustainability

- Improve aging and outdated facilities
- Focus on increased operational efficiency and healthy environments

Program Enhancements

- Upgrade spaces for community and student programming
- Emphasize STEM-based learning, robotics, athletics, recreation, and arts
- Build on partnerships with businesses

Safety & Technology

- Enhance security measures
- Upgrade network/phone/technology
- Connect to advanced tools for research and innovation

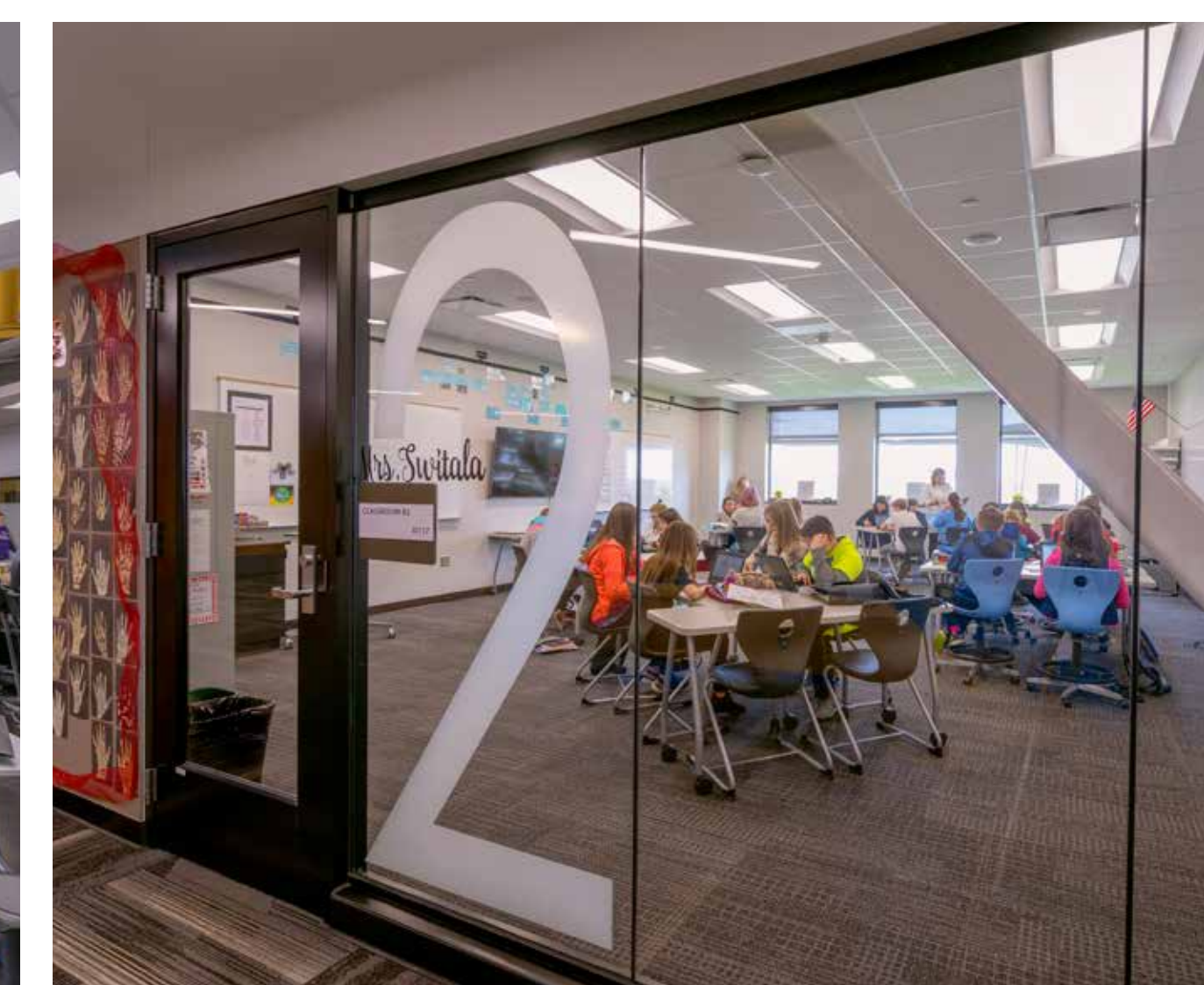
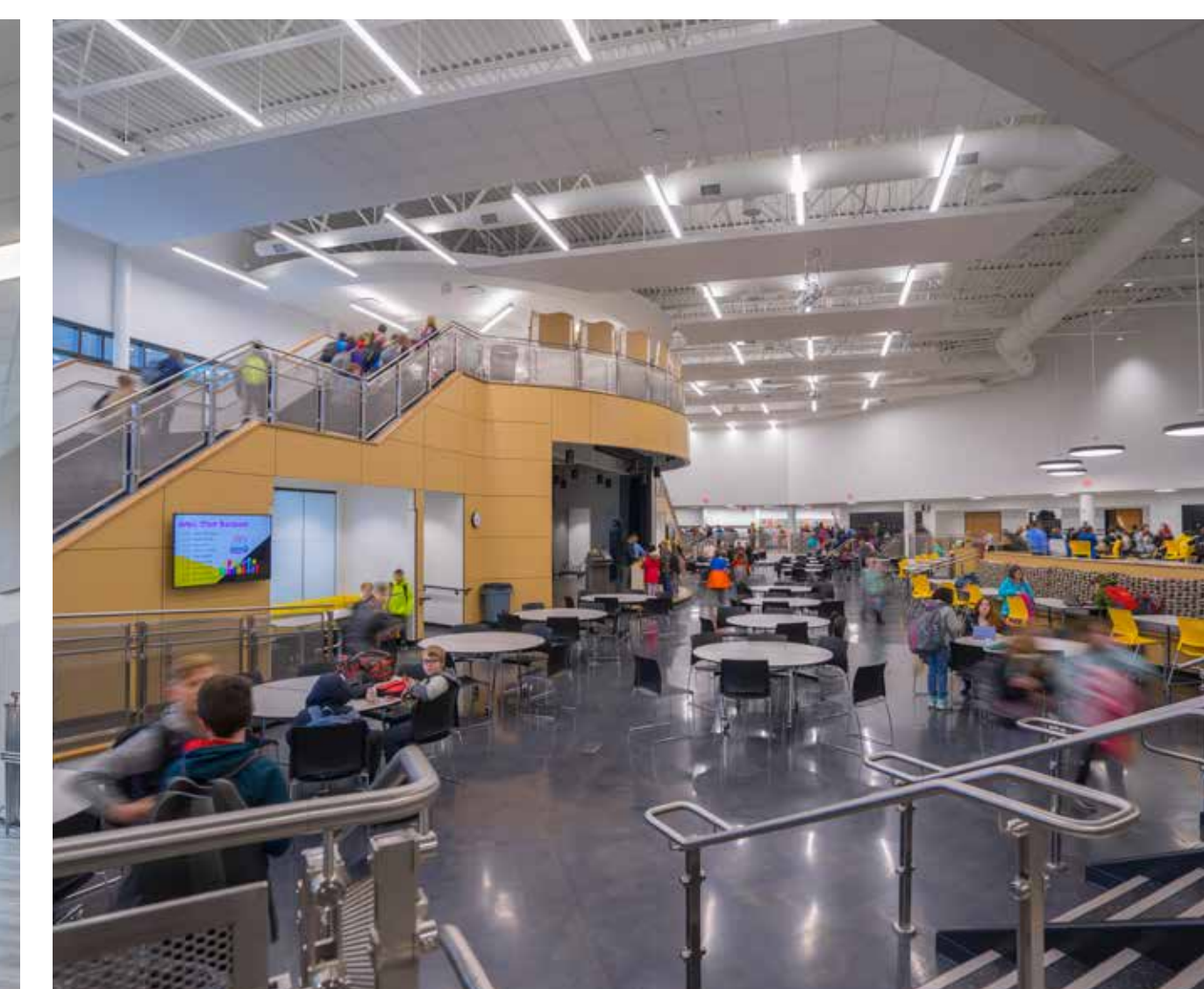

Pictures depict spaces that could be achieved in Bond 2022

Check out the latest Bond Info



VOTE NOV 8

For more info visit troy.k12.mi.us or email bond2022@troy.k12.mi.us