



INFRASTRUCTURE IMPROVEMENTS START OF PHASE ONE

Committee of the Whole Meeting

UPDATE 6/28/22



USA ARCHITECTS' PROPOSALS

2

3

4

5

JOHN ADAMS MIDDLE SCHOOL AUXILIARY GYM

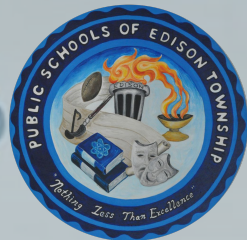

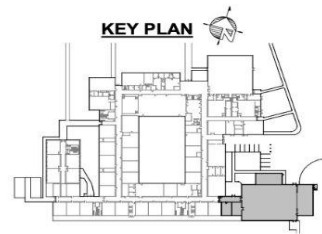
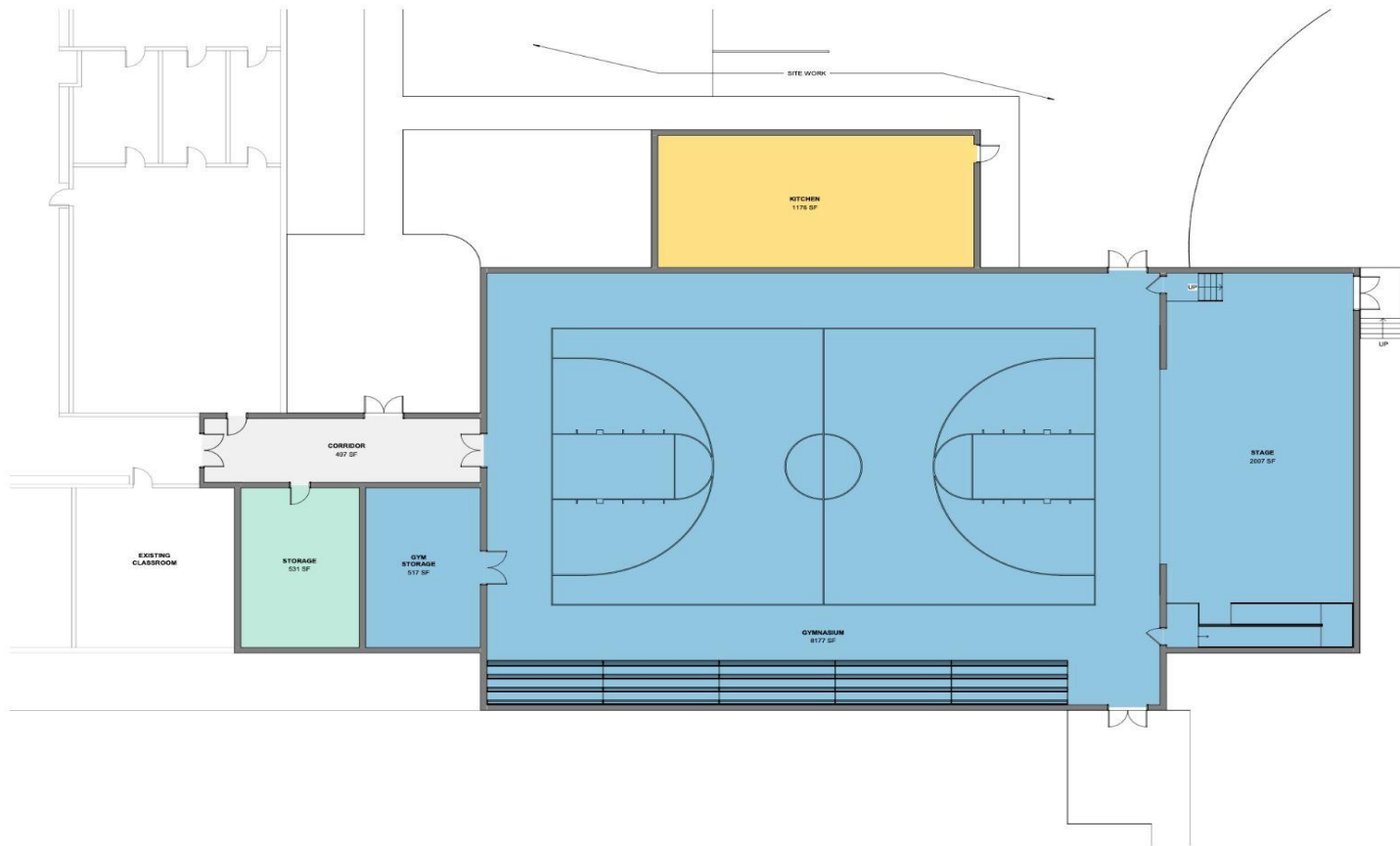

JOHN ADAMS MIDDLE SCHOOL AUXILIARY GYM

Construction Costs



\$5.75 Million

Total Costs



\$6.9 Million



WOODROW WILSON MIDDLE SCHOOL AUXILIARY GYM

Teacher Appreciation
Week

Donated by the
2015-2016 PTA

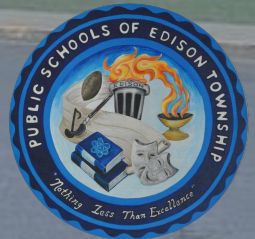

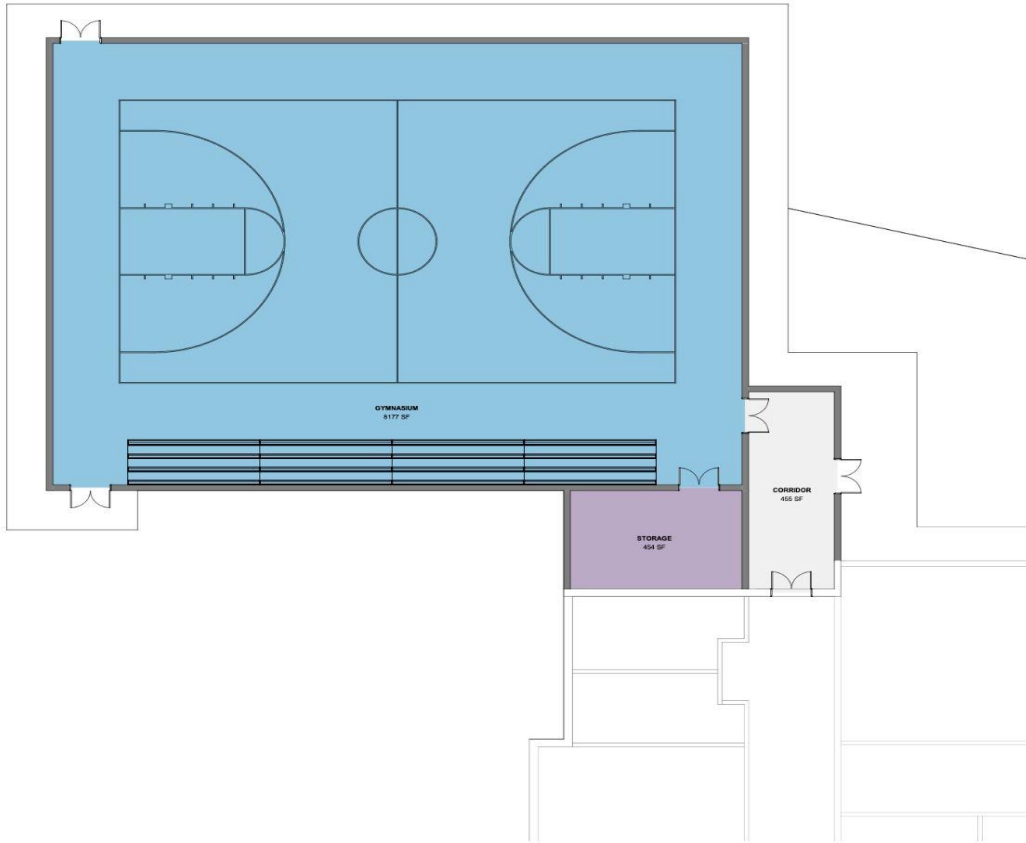

Department Legend

- CIRCULATION
- GYMNASIUM + ACCESSORY SPACE
- SUPPORT

TOTAL ADDITION = 9,550 SF

KEY PLAN

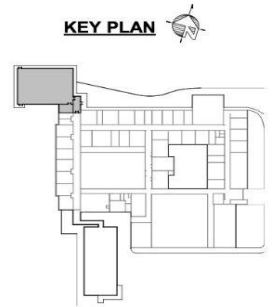

WOODROW WILSON MIDDLE SCHOOL AUXILIARY GYM

Construction Costs



\$3.7 Million

Total Costs



\$4.4 Million





DMR ARCHITECTS' PROPOSALS

JOHN P. STEVENS HIGH SCHOOL

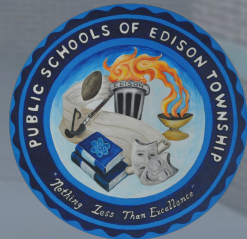

JOHN P. STEVENS HIGH SCHOOL

CLASSROOM ADDITION COSTS

Thirty (30) classrooms

48,000 Square Feet

Total Costs:

Low \$24,300,000

High \$25,700,000



HERBERT HOOVER MIDDLE SCHOOL AUXILIARY GYM

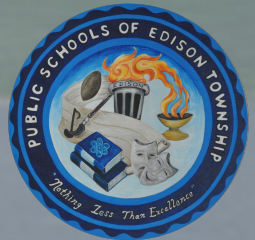

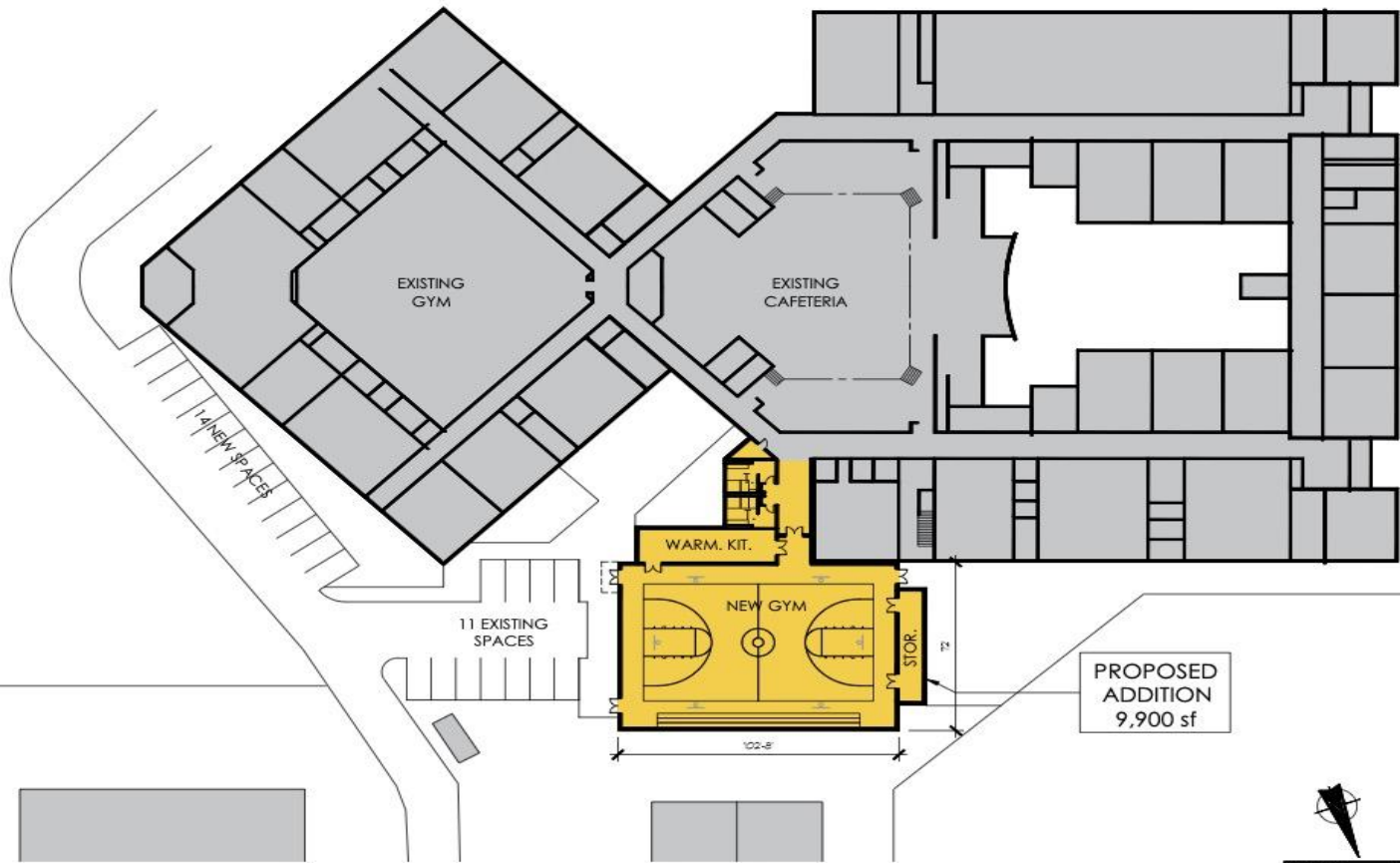

1 FIRST FLOOR PLAN
SCALE: 1"=40'-0"

NEW GYMNASIUM
HERBERT HOOVER MIDDLE SCHOOL



DATE: 5-12-22
REV: 6-1-22
SCALE: 1"=40'-0"
DRAWN BY: A1
PROJECT #: 5088

DMR

DESIGN MANAGEMENT
ARCHITECTURE
PLANNING
CONSULTING
INC.

2701 HARRISON AVENUE, SUITE 100
PACIFIC PALMS, CALIFORNIA 92652
TEL: 949.440.0000
WWW.DMR-ARCH.COM

HERBERT HOOVER MIDDLE SCHOOL AUXILIARY GYM COSTS

7,700 Square Feet

For Gym Area,

Bleachers, and

Warming Kitchen

Total Costs:

Low \$5.1 Million

High \$5.5 Million





THOMAS JEFFERSON MIDDLE SCHOOL ADDITIONS

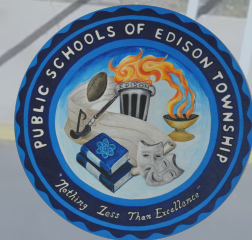

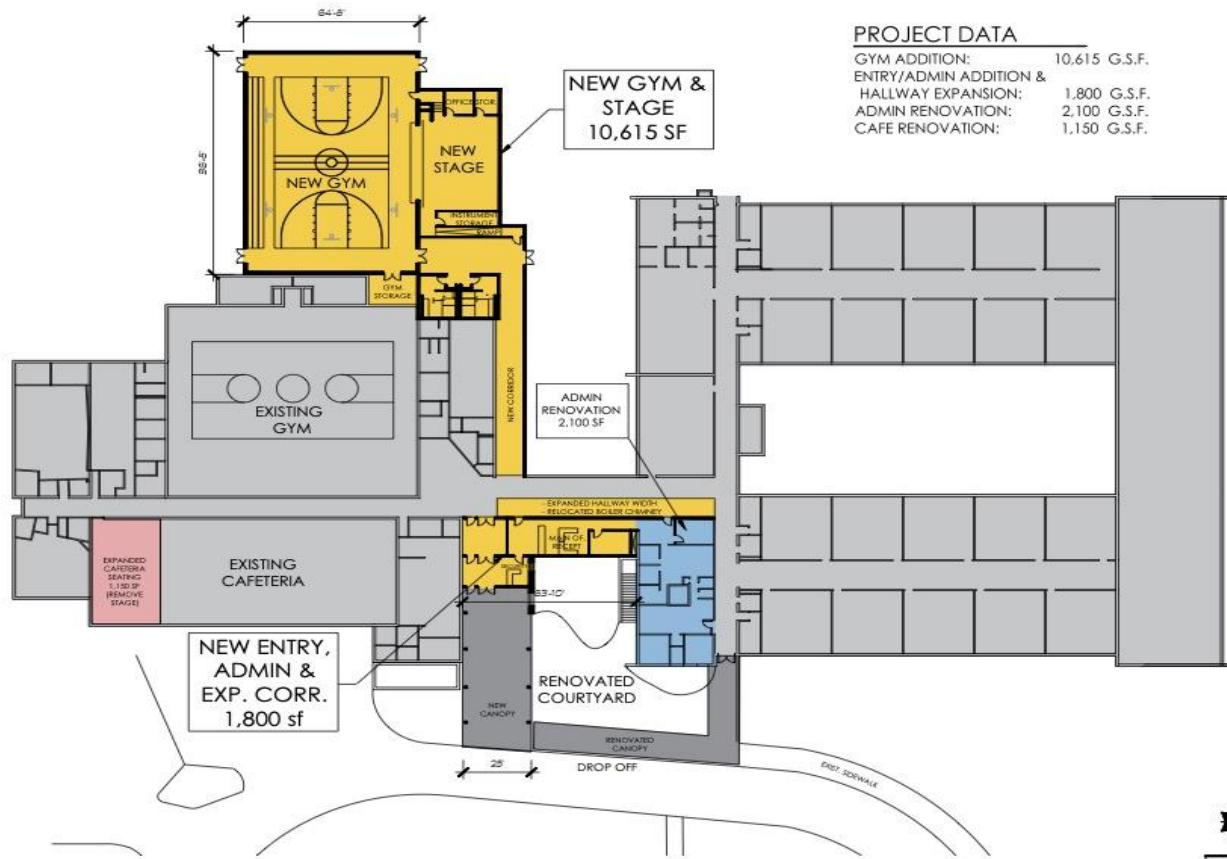

1 FIRST FLOOR PLAN
SCALE: 1"=40'-0"

NEW GYMNASIUM, LOBBY, & RENOVATION
THOMAS JEFFERSON MIDDLE SCHOOL



DATE: 5-12-22
REV: 6-15-22
SCALE: 1"=40'-0"
SHEET #
A2
PROJECT # 5089

DMR

DESIGNED BY: DMR
DRAWN BY: DMR
CHECKED BY: DMR
DATE: 5-12-22

PROJECT: NEW GYMNASIUM, LOBBY, & RENOVATION
THOMAS JEFFERSON MIDDLE SCHOOL
11.000.0000.0000

THOMAS JEFFERSON MIDDLE SCHOOL ADDITIONS

COSTS

Gym/Auditorium Addition	10,615 Square Feet
New Entrance and Security Vestibule	1,800 Square Feet
Renovation of Existing Cafeteria	1,150 Square Feet
Renovation of Existing Admin. Office	2,100 Square Feet
Total Square Footage	15,665 Square Feet

Total Costs:
Low \$7.5 Million
High \$8.3 Million



PROJECTED PROJECT COSTS

John P. Stevens:

Budgeted Amount

DMR:

\$25.7 Million

(17 M)

JAMS

\$6.9 Million

(3.5 M)

WWMS

\$4.4 Million

(3.5 M)

HHMS

\$5.5 Million

(3.5 M)

TJMS

\$8.3 Million

(5.5 M)

Total Costs for Projects:

\$ 50.8 Million

(\$33 M)



FUTURE PHASE ONE PROJECTS IN DEVELOPMENT

Project

Cost

10 Classroom Addition at JMI

→ **\$11.5 Million**

10 Classroom Addition at John Marshall

→ **\$11.5 Million**

19,000 Square Feet (approx \$600/sq.ft)

These are still in the developmentally stages





QUESTIONS?

