



# The Hawk Herald

## Prairie View Elementary



Dr. Irene Gonzales, Principal

September 2, 2021

### A Note From the Office

Dear Prairie View Families,

I am so looking forward to welcoming back our returning students and meeting our new kids. We had a terrific school year last year and with all of the positive energy in our school right now, I know we will have an awesome year this year also. By now, I am sure you have heard that students do not have to wear masks outdoors. This will be a welcome relief to kids as they play, because somedays when the temperatures were high kids were very uncomfortable. All staff and students will be required to put on their mask before entering the school and to keep a mask on when indoors except while eating or drinking during lunch or designated snack time. Students will clip their mask to their lanyard once outdoors or put their mask on their wrist. You may wish to have this conversation with your child.

We are so fortunate to have such excellent and professional educators at PV who cannot wait for school to begin.

In partnership,  
Irene



### Important dates in September

- September 2** Email home regarding student placement in classes
- September 6** Labor Day
- September 7** First Day of School Grades 1-5
- September 7-9** Kinder conferences
- September 10** First Day of School for Kinders
- September 11** Patriot Day
- September 13** APEX Fundraiser kick-off
- September 13** PTO Meeting @ 6pm
- September 23** APEX Run Day
- September 29** Picture Day

### PARKING LOT SAFETY



For the safety of our students, please pull alongside the curb to drop off and pick your children up. If you are in this "pick-up/drop off lane" please remain with your car and pull forward as space allows. DO NOT double park, as this causes congestion of the parking lot. If you park your car in a parking space, please remember to get out and walk across the parking lot to get your children. Staff cannot and will not allow them to run into the parking lot to you. Thank you!

### WELCOME TO PRAIRIE VIEW!!!

Join Mr. Wiser and Ms. Martin as they take you on a virtual tour through the halls of PV! [Click Here](#) to see some of the staff they meet along the way as they peek inside classrooms, wander down halls and take a look at our gym, library and music room. We can't wait to see you in person on Tuesday September 7th!

### Counselors Corner

Prairie View recently welcomed our new counselor, Mrs. Toth! She will update this section of the newsletter every month with helpful advice. For now, settle back and meet her in this [introduction letter](#) to you and your family!

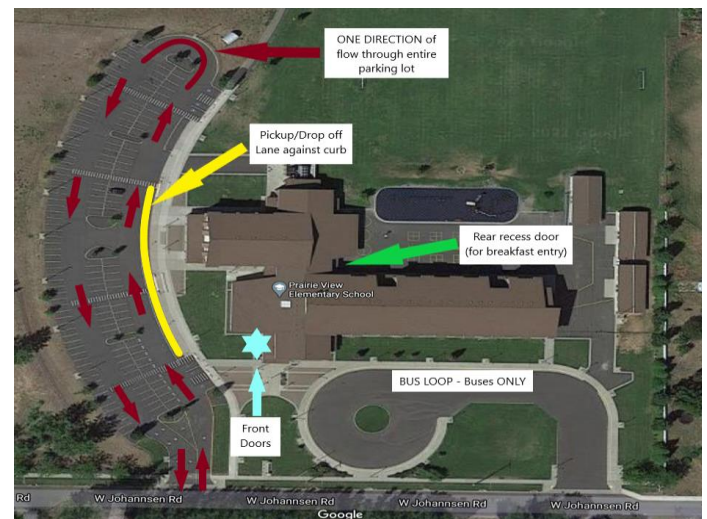

# Classroom Lineup Map

It's the first day of school and your child knows who their teacher will be. Now what???

Look at the map to the left, find the teacher name and you will see where they will be lining up in the morning. This is where your child will go every morning to wait in line until the start of school.

Please do NOT bring your child(ren) before 9am, we have no supervision prior to this and a call home will be made.

If your child will be eating breakfast in the morning, they can come through the rear recess door starting at 8:50 am. There will be an adult there to greet and let them in each morning.

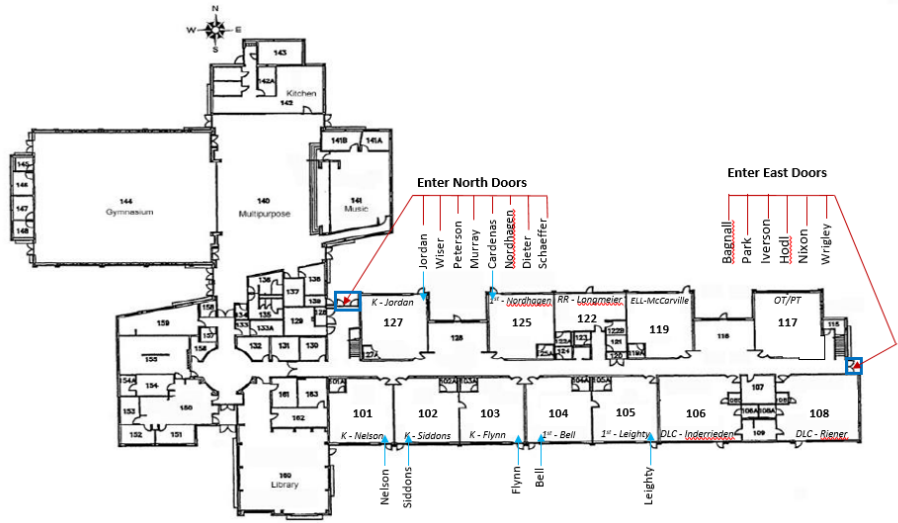
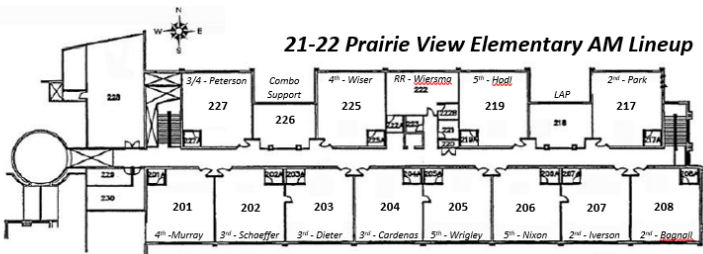

# Prairie View ❤️ Cares

We're all facing difficult times right now. PV knows and acknowledges the challenges in our community during these times. We continue to support our students, families and staff. We have resources available to help. We will get through this; and we will come out stronger and more connected!

## Attendance Matters

Many parents underestimate the importance of good school attendance, especially during the elementary years. Showing up for school has a huge impact on a student's academic success starting in kindergarten and continuing through high school. Studies show many children who miss too many days in kindergarten and first grade can struggle academically in later years. They often have trouble mastering reading by the end of third grade.

While missing school a day here and a day there may not seem like much, missing just two days a month can drastically affect a student's academic success. Those two days a month means your child is missing 10 percent of the entire school year. Unexcused and excused absences easily add up to too much time lost in the classroom.

Even as children grow older and more independent, parents and families play a key role in making sure students get to school safely every day. It is essential that students understand why attendance is so important for success in school. Thank you for your help!

### Prairie View Daily Schedule

- 8:50 AM** Breakfast served
- 9:10 AM** School Starts
- 11:05-**
- 12:50 AM** Grade level lunches

### Dismissal Schedule

- 3:13 PM** Kindergarten
- 3:15 PM** 1<sup>st</sup> Grade
- Bus Dismissal
- 3:17 AM** 3<sup>rd</sup> Grade
- 3:18 AM** 2<sup>nd</sup> Grade
- 3:19 AM** 4<sup>th</sup> & 3 / 4 Grade
- 3:20 AM** 5<sup>th</sup> Grade

**NO COST**  
**Full Breakfast**  
**Full Lunch**

For the 2021-2022 School year



Milk without a meal and ala cart items must be purchased. Breakfast will be served before starting at 8:50 AM

[September BREAKFAST Menu](#)

[September LUNCH Menu](#)



## Transportation



Bus transportation is available to all students. In order for transportation to be successful, parents, staff and students need to work together to ensure students wear their mask on the bus and keep their personal items, including food or drink, to themselves. Important factors to successful transportation:

- \*Students must ride their assigned bus. No Bus Passes will be allowed.
- \*Students must be signed up to ride the bus through the transportation link prior to getting on. You can access that link [HERE](#). Please give 1-2 full business days for the driver to be notified that your child was added to their route. \*Kinders must have an adult present at the bus stop in order for the driver to let your child off. If an adult is not present when the bus arrives, the driver will return the student to the school office and parent must arrange prompt pick up from the school