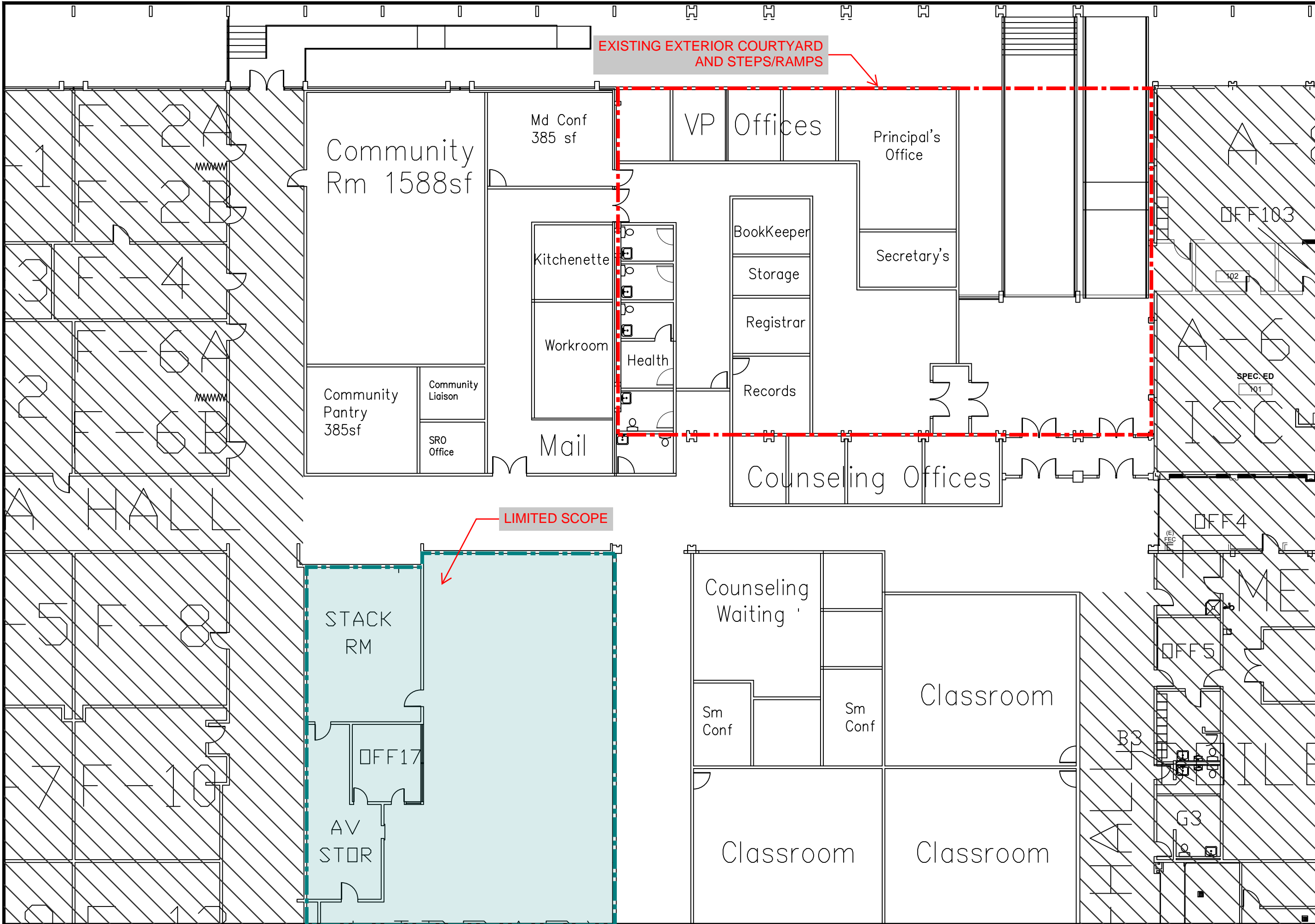

**EXHIBIT "B" // SCOPE DIAGRAM AND CONCEPTUAL PLAN**



**BEAVERTON**  
**SCHOOL DISTRICT**  
 FACILITIES DEVELOPMENT P (503) 356-4500  
 16550 SW MERLO RD F (503) 591-4475  
 BEAVERTON, OR 97003 www.beaverton.k12.or.us

**STAMP**

**APPROVED BY**

**DATE**  
11/05/2019

**PROJECT NAME**  
AHS Office Remodel

**PROJECT NO**

**BSD PROJECT LEAD**

**BSD PROJ COORDINATOR**

**DRAFTER**  
Megan Finch

**REVISION**

**AHS Office Remodel**  
**2020 Bond Planning**