



LOCATION: LYNNWOOD, WASHINGTON  
 PHASE 1 COMPLETION DATE: 2019

CAPACITY: 625 STUDENTS  
 CLASSROOMS: 28  
 SITE AREA: 9.06 ACRES

BUILDING AREA:  
 PHASE 1: 28,720 SF  
 PHASE 2: 52,280 SF

# SPRUCE ELEMENTARY SCHOOL

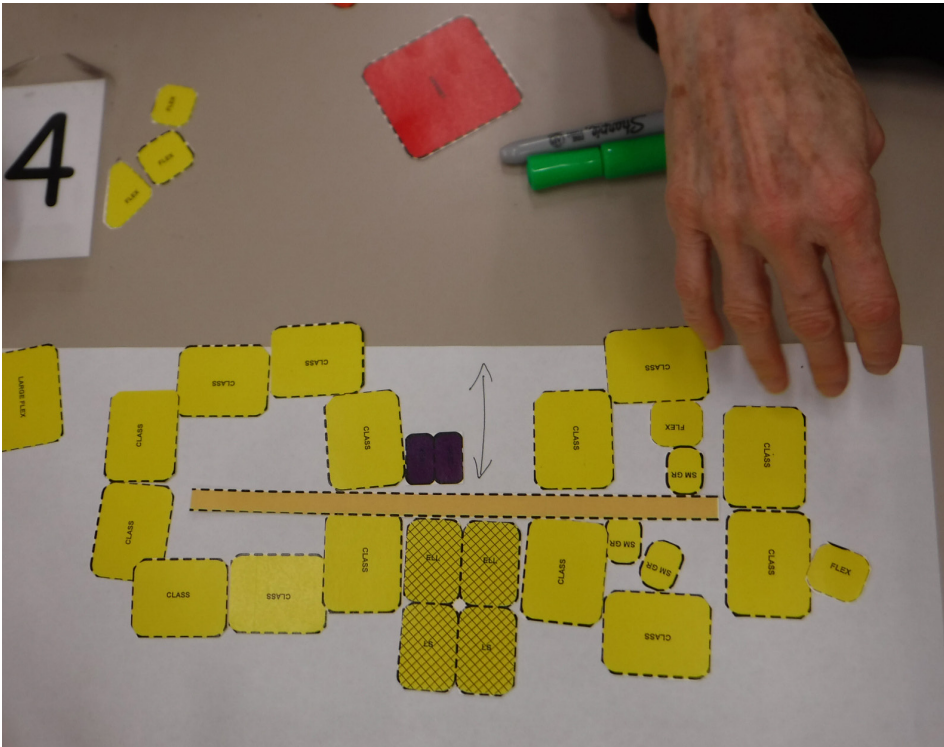

Photos: Spruce Elementary School  
 Design Review Committee meetings



THE DESIGN INTENT FOR SPRUCE ELEMENTARY SCHOOL

is to connect to nature while offering a safe and flexible learning environment for its diverse community. A key component of the overall design is for the second floor library to stand-out as a safe and welcoming haven to both encourage reading and provide a protected, covered student entry below. With Phase 1 currently under construction, the approximately 81,000 total sf facility will include a new gymnasium, commons, library and two-story classroom wing. The new school will address the necessity to accommodate capacity needs, increase safety and resolve traffic concerns.

The new Phase 1 building includes a gymnasium, commons, stage, music room, administrative offices, kitchen, and new learning support offices. This 28,720 sf building will offer a connection with nature through a large south-facing window in the commons and daylit corridors. The entry is designed to be a welcoming environment and will be the arterial connector to every room. Construction of Phase 1 is anticipated to be complete in time for the 2019-2020 school year.

Phase 2 adds a two-story main building that will increase the school’s square footage by 51,700 sf, and will include 28 classrooms. Also included in Phase 2 will be the addition of a library to the north side of the Phase 1 building on the second floor. The library’s wall of windows facing west will act as a beacon of welcoming light to students and the community. This phase will also involve of the demolition of the existing building, as well as construction of a new parking lot and a separate bus circulation route to resolve current traffic issues.

Spruce Elementary School staff and volunteer parents have been heavily involved in a rigorous design process to assess the specific needs of the Spruce community. The end result will be a new school that provides a safe, inspiring place to learn and readily available to accommodate the influx of student enrollment.

BUILDING SECTION / PERSPECTIVE



OWNER

Edmonds School District

DESIGN TEAM

Architect: Bassetti Architects

Structural Engineer: Coughlin Porter Lundeen

Mechanical Engineer: Metrix Engineers

Electrical Engineer: Hargis Engineers

Civil Engineer: AHBL

Landscape Architect: Site Workshop

Acoustic Consultant: SSA Acoustics

Food Service: Halliday Associates, Inc.

Hardware: Adams Consulting & Estimating

CONTRACTOR

GC/CM: BNBuilders

PHASE 1 SITE PLAN



MASTER PLAN

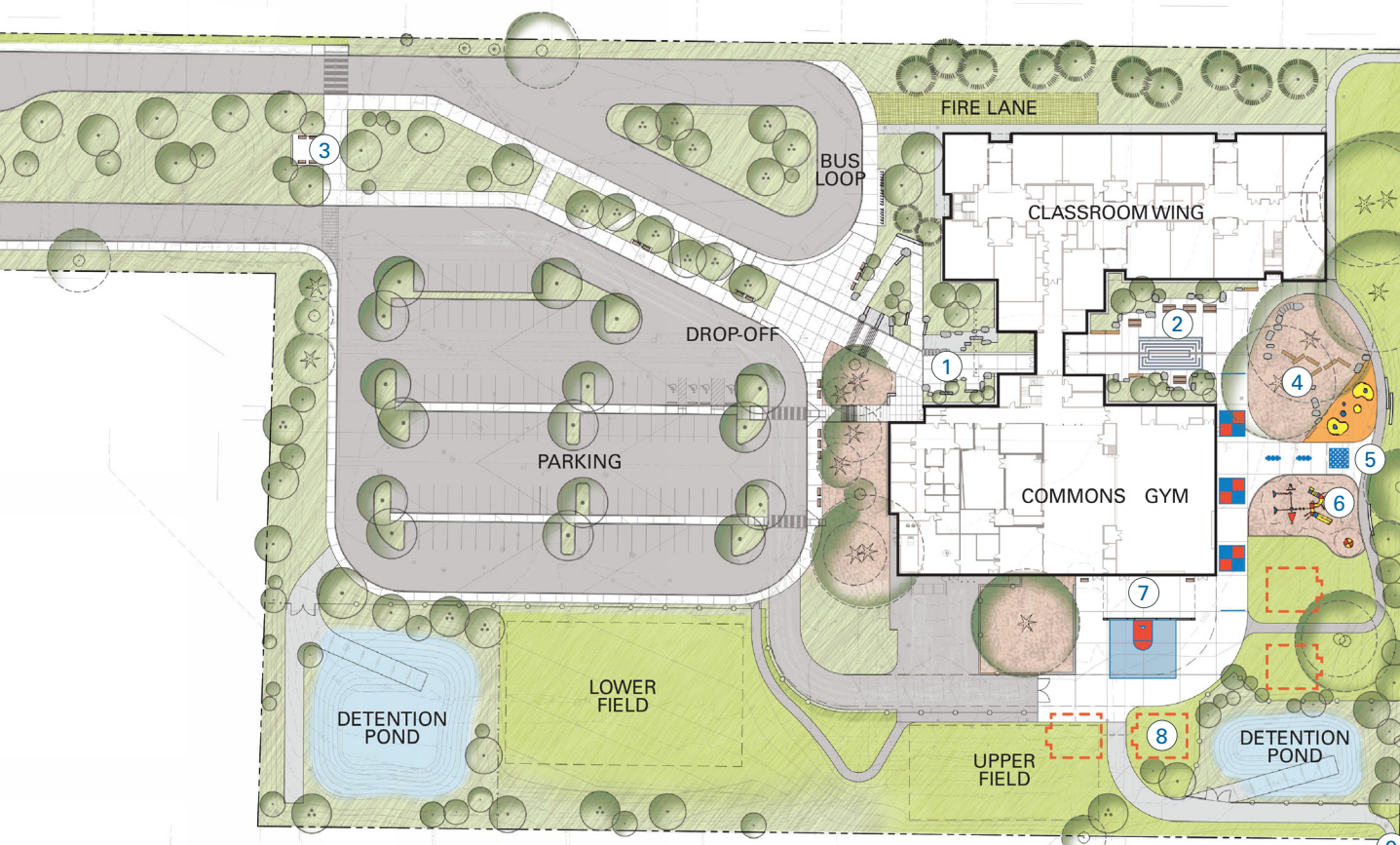

- 1 ENTRY COURT
- 2 CLASSROOM COURTYARD
- 3 OUTDOOR LEARNING AREA
- 4 NATURE PLAY
- 5 1/10TH MILE LOOP PATH
- 6 RELOCATED PLAY STRUCTURE
- 7 COVERED PLAY AREA
- 8 POTENTIAL PORTABLE LOCATIONS
- 9 NEIGHBORHOOD ENTRY

