



**FUTURE
READY
D36**

Honoring our past.
Planning our future.

Opening Remarks

Enrollment

Elementary Enrollment 2006-2016

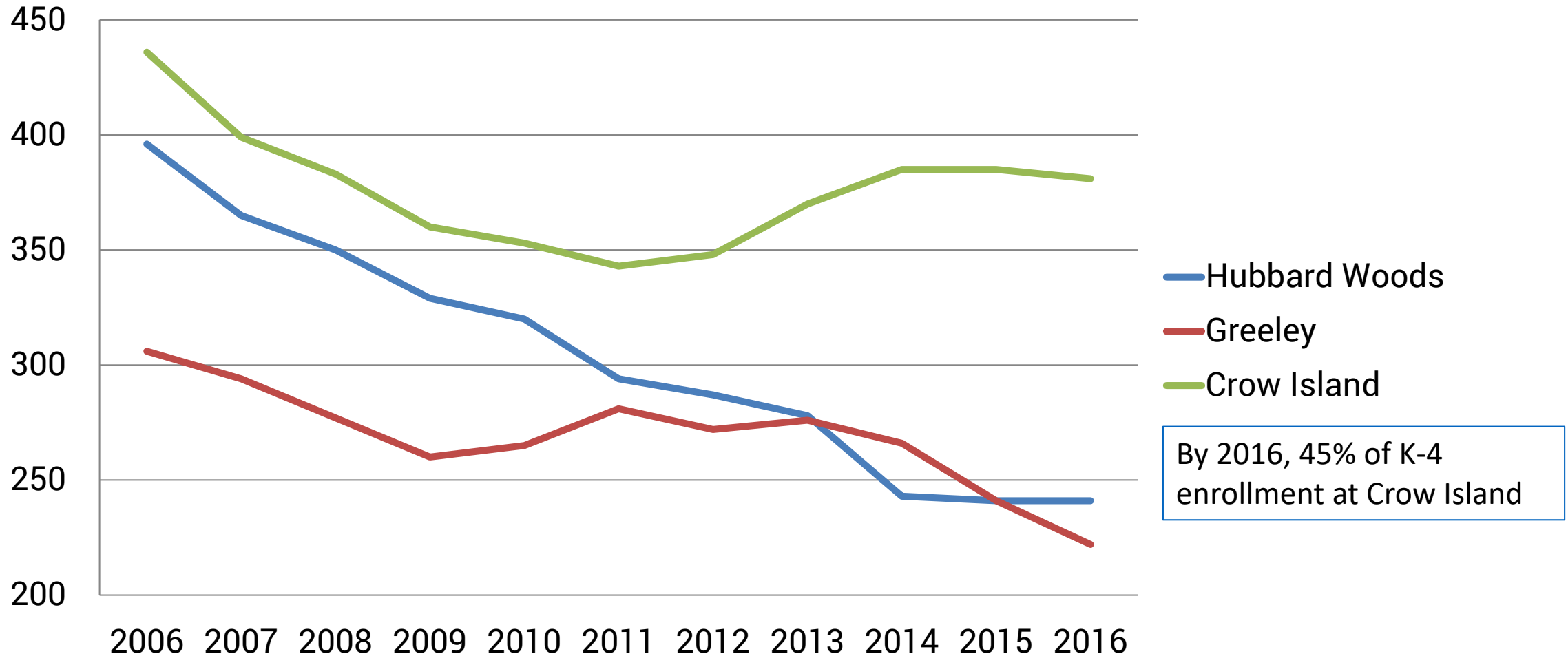

The **2016-17** elementary school enrollment represented the **greatest discrepancy among schools** in the last ***50 years.***

ENROLLMENT

Overall **declining** enrollment
Imbalance among 3 elementary schools' enrollments
Commitment to class size & **consistent** programming
Short-term solution: all Kindergarteners at Greeley & Hubbard Woods

FACILITIES

Cost/benefit of **maintaining** aging infrastructure
Greeley School, Hubbard Woods School, and the Skokie School are at or near **100 years old**
Updates, repairs, and replacements needed at all schools

VISION FOR TEACHING & LEARNING

Congruency with current needs of education
Forward thinking for the future needs
Continue to provide **engaging, progressive approach** to meet the needs of the current and **future generations of learners**

Past & Projected Enrollment

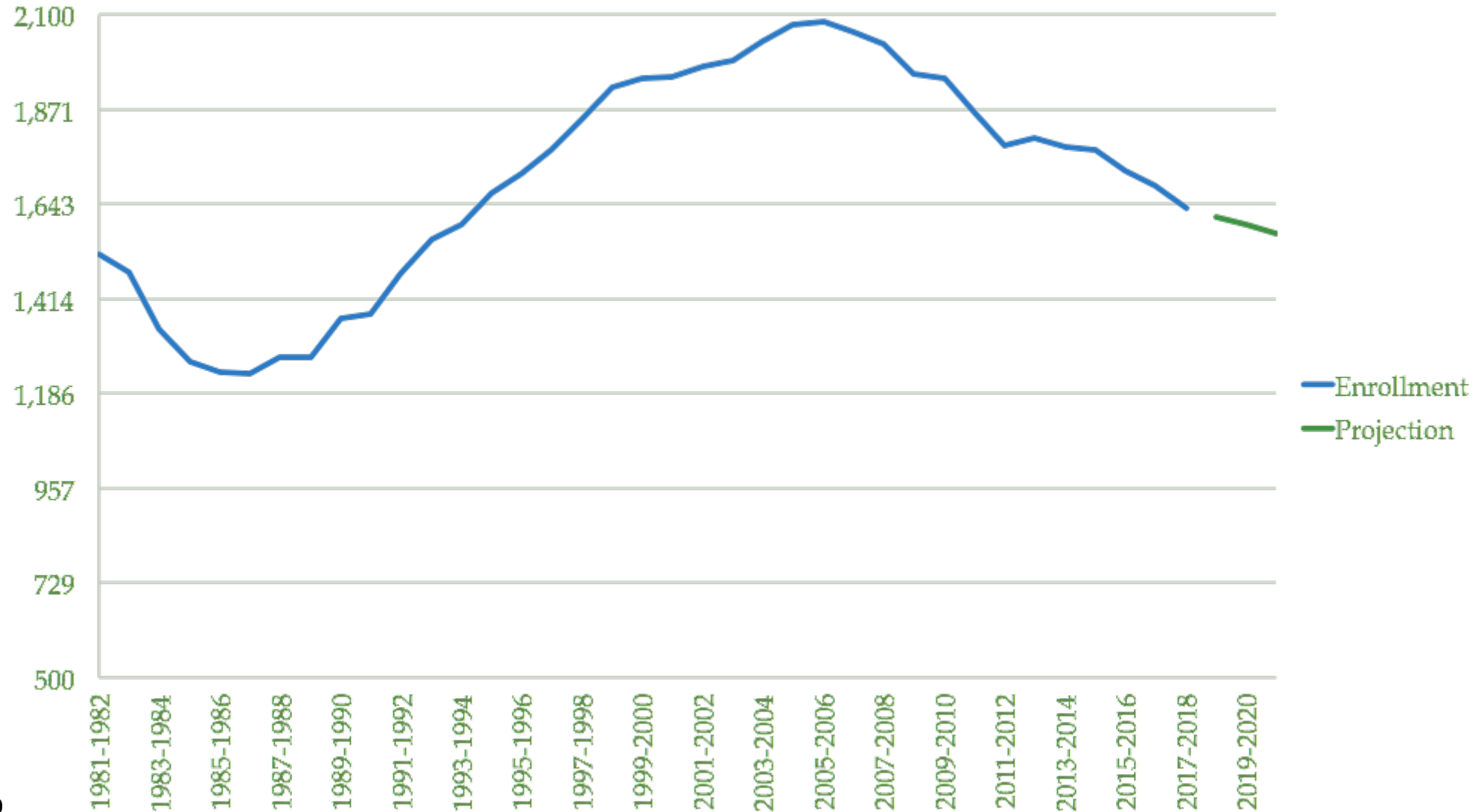

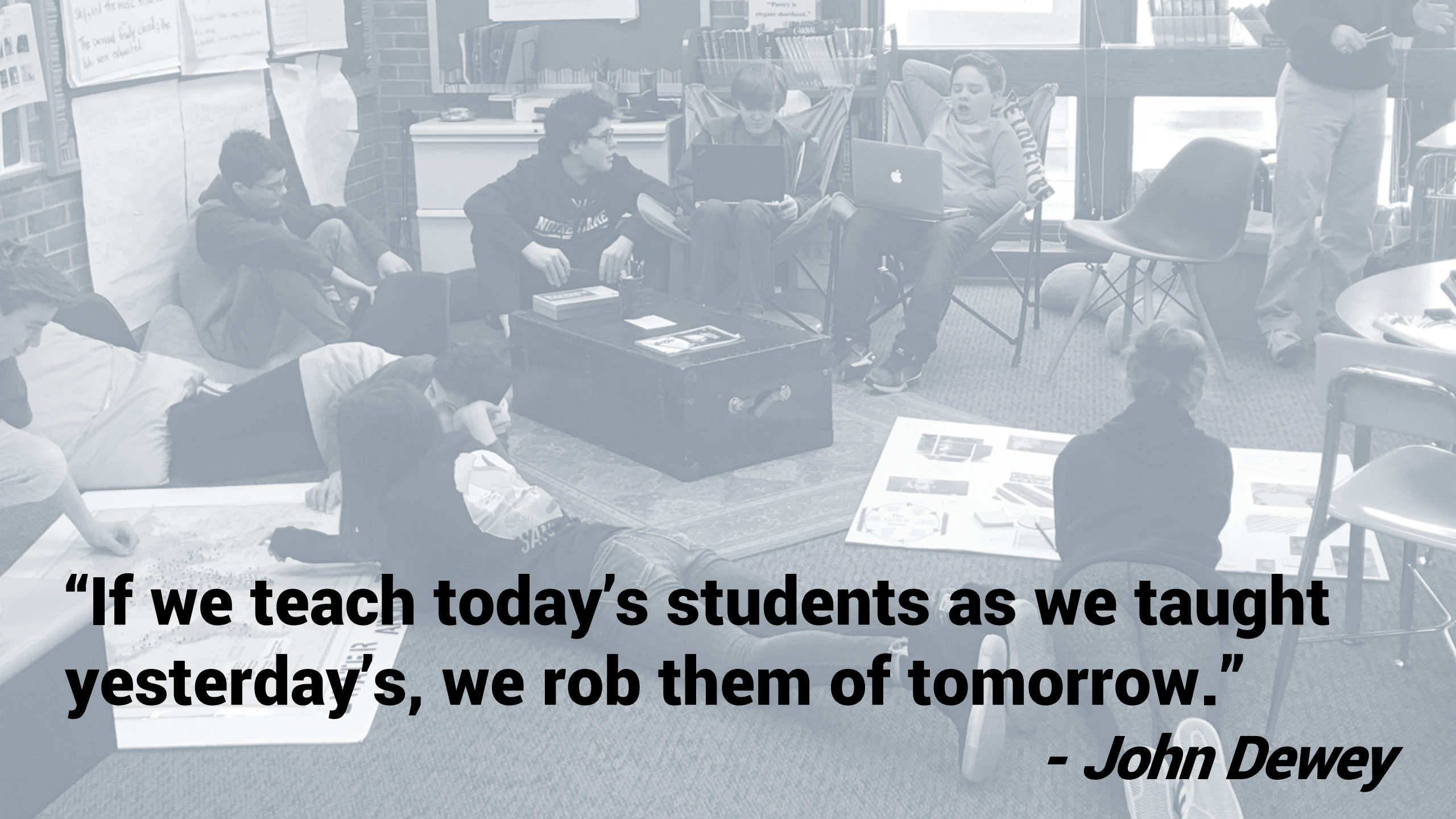

“If we teach today’s students as we taught yesterday’s, we rob them of tomorrow.”

- John Dewey

Aspirational Culture

The Winnetka Public School District

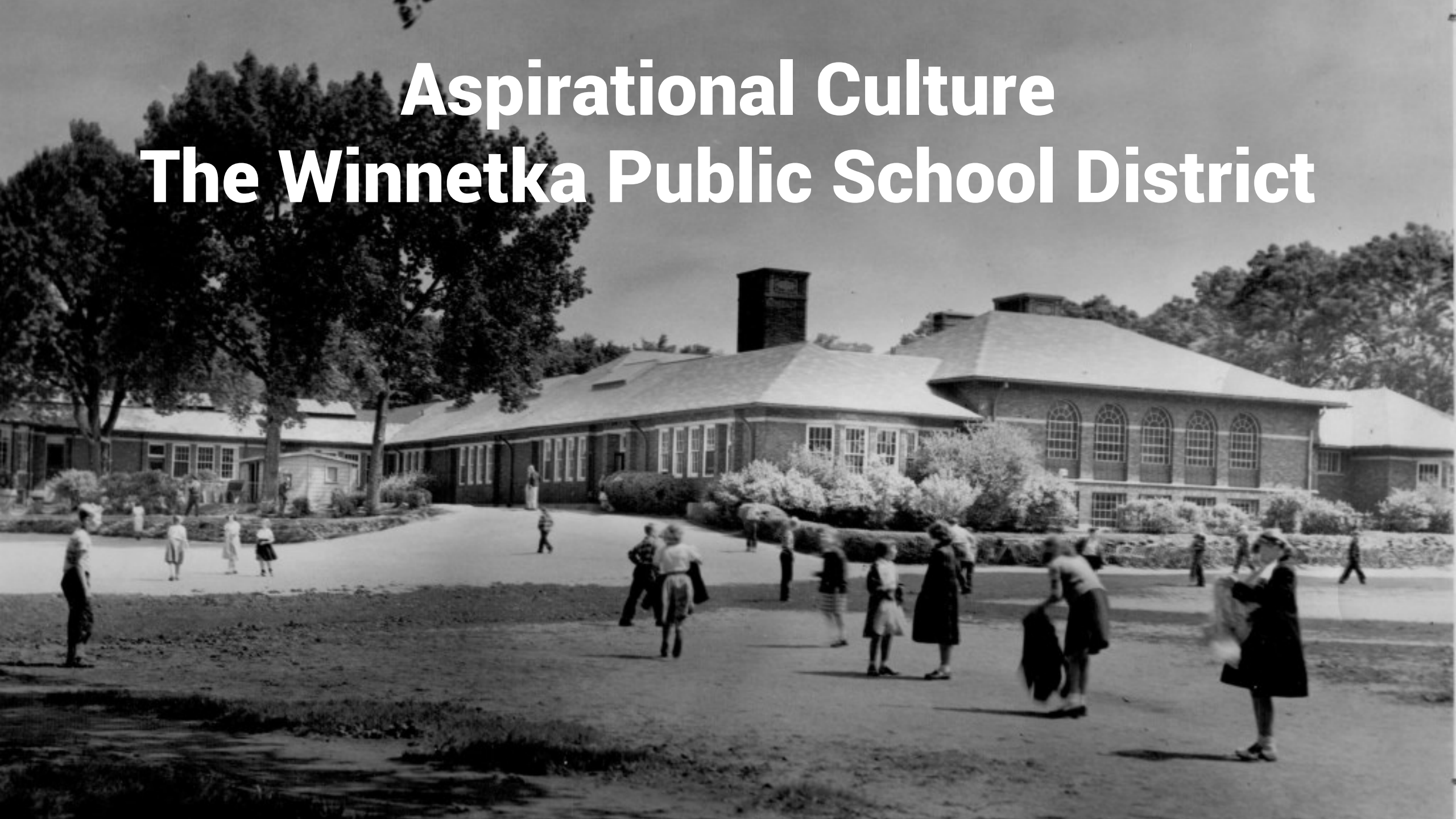

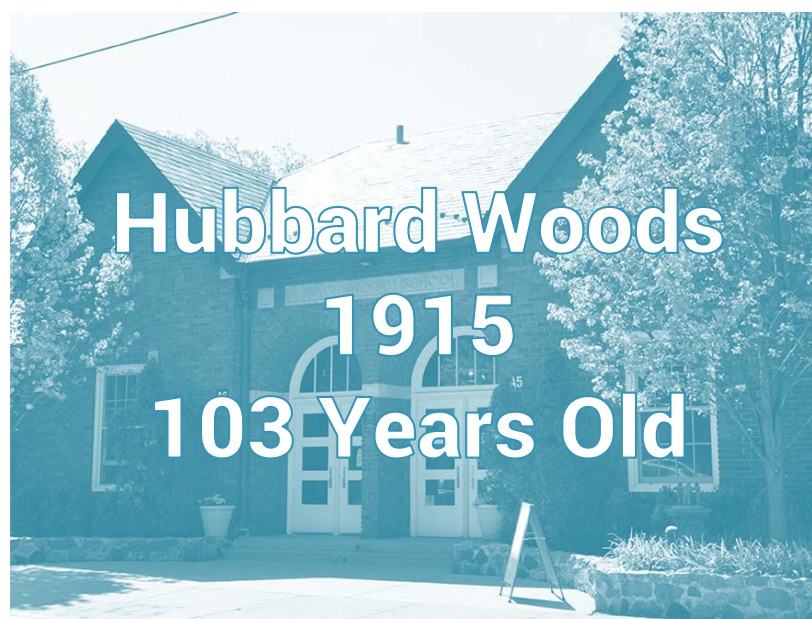

We have older buildings – does it matter?

How much does it cost to repair our five buildings?

Phase I

A physical assessment of all District 36 facilities took place in July 2017

- Health Life Safety Items \$13,559,974
- HVAC (exclusive of A/C) \$3,099,137
- Accessibility \$4,447,383
- Cosmetic \$1,314,275

Total: \$22.4M (1,364 items, minor to major)

Total with A/C: \$33.7M-\$38.2M

Facilities - Baseline Costs

2006-2017

\$28.9M*

Expected 2019-2023 (w/AC)

up to \$38.2M

2018

Expected 2019-2023 (w/o AC)

\$22.4M



Total 2006-2023

\$51.3M to \$67.1M

**Includes building improvements. Excludes additions and remodeling work.*

We have older buildings – does it matter?

How much does it cost to repair our five buildings?

How well do our buildings meet our current needs and aspirations?

Building Limitations

**Increased Lunch /
Before & After
School Care**

**Lack of ADA
Accessibility**

**Inadequate Thermal
Comfort**

**High Demand for
Community Use**

Building Limitations

Educational Limitations

**Mobile
Technology**

**Makerspaces &
STEAM**

**Kinesthetic
Learning**

**Personalized
Learning**

Collaboration

**Common
Educational
Programming**

**Increased
Specialized
Services**

**More Inquiry-
Based Learning**

**Safety &
Security**

**More
Accountability
& Assessments**

**Response to
Intervention**

**Technology
Infusion**

**More Student
Choice &
Electives**

**20% Time &
Inquiry Periods**

**Least
Restrictive
Environments**

**Sustainability
Expectations**

**Nature-Based
Learning**

**Health &
Wellness**

**More After
School Clubs &
Options**

**Instructional
Coaching**

**Integrated
Learning**

**Whole School &
Community
Gatherings**

Lunch

**World
Languages**

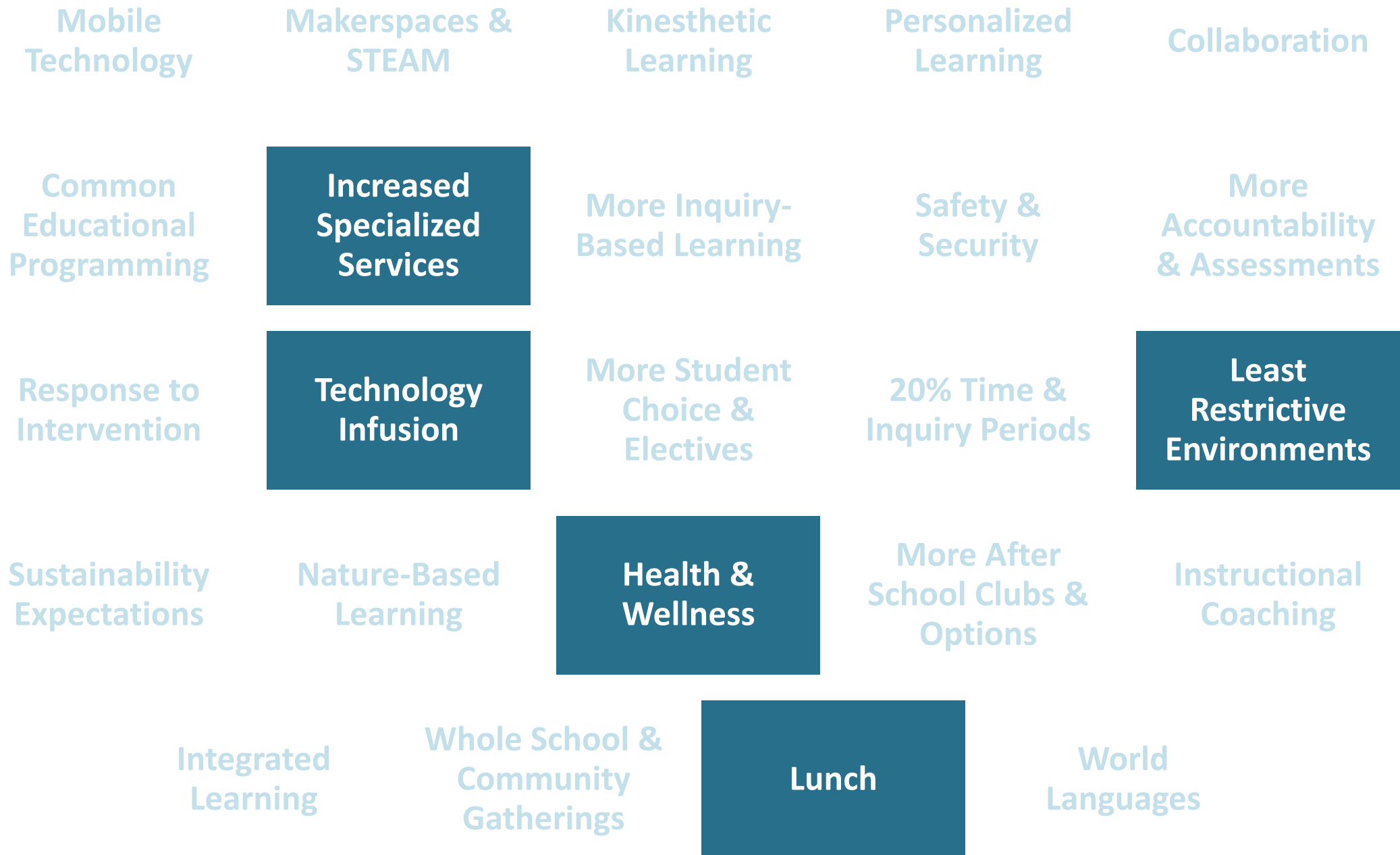

“With the exception of Crow Island, all existing schools are **over forty years old**. Their original designs ***do not lend themselves*** to expansion in accordance with present day **student groupings and learning activities.**”

- 1965 “Design with Excellence” report for
The Winnetka Public Schools Board



Sunset Ridge (Northfield)



Westmoor Elementary (Northbrook)

Future Ready

A learning environment that allows for **student leadership, collaboration and independence** while providing equitable opportunity and resources to **multiple learning types in multiple subject areas**.

This requires **flexible, adaptable** space that can mold to the needs of a classroom in a **timely, accessible and quiet way**, without compromising a teacher's ability to supervise, facilitate and support students.

What would our learning spaces look like if they were designed to **meet the needs** of today's ***learners and teachers?***

Vision for Teaching & Learning

Child-Centered Education

- Academic excellence
- Social-emotional learning

Progressive 2.0

- Lead the way
- Expand experiential opportunities
- Infuse relevant, real-world, hands-on work
- Harness 21st Century technology, tools, and knowledge
- Prepare students for lifelong success

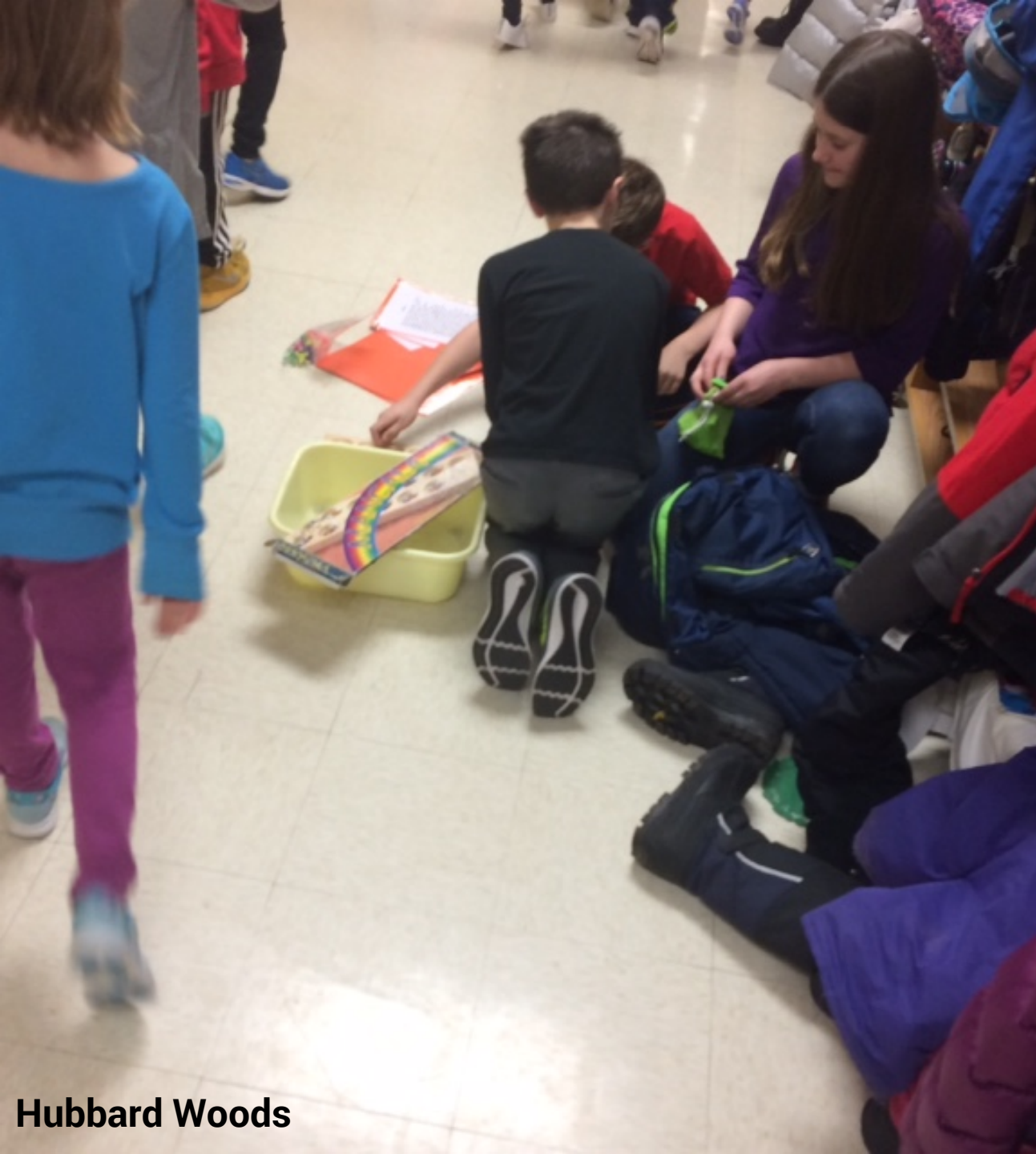

Hubbard Woods



Discovery Elementary (VA)

Who is affected?
What caused this to happen?
What are the effects?
How can we solve the problem?
What's the Problem?
Why is this a problem?
Why must we solve it?
How much will it cost to fix it?
Where & When did the problem emerge?
How many people or animals are affected?



Washburne



Crow Island



Panther Lake Elementary (WA)

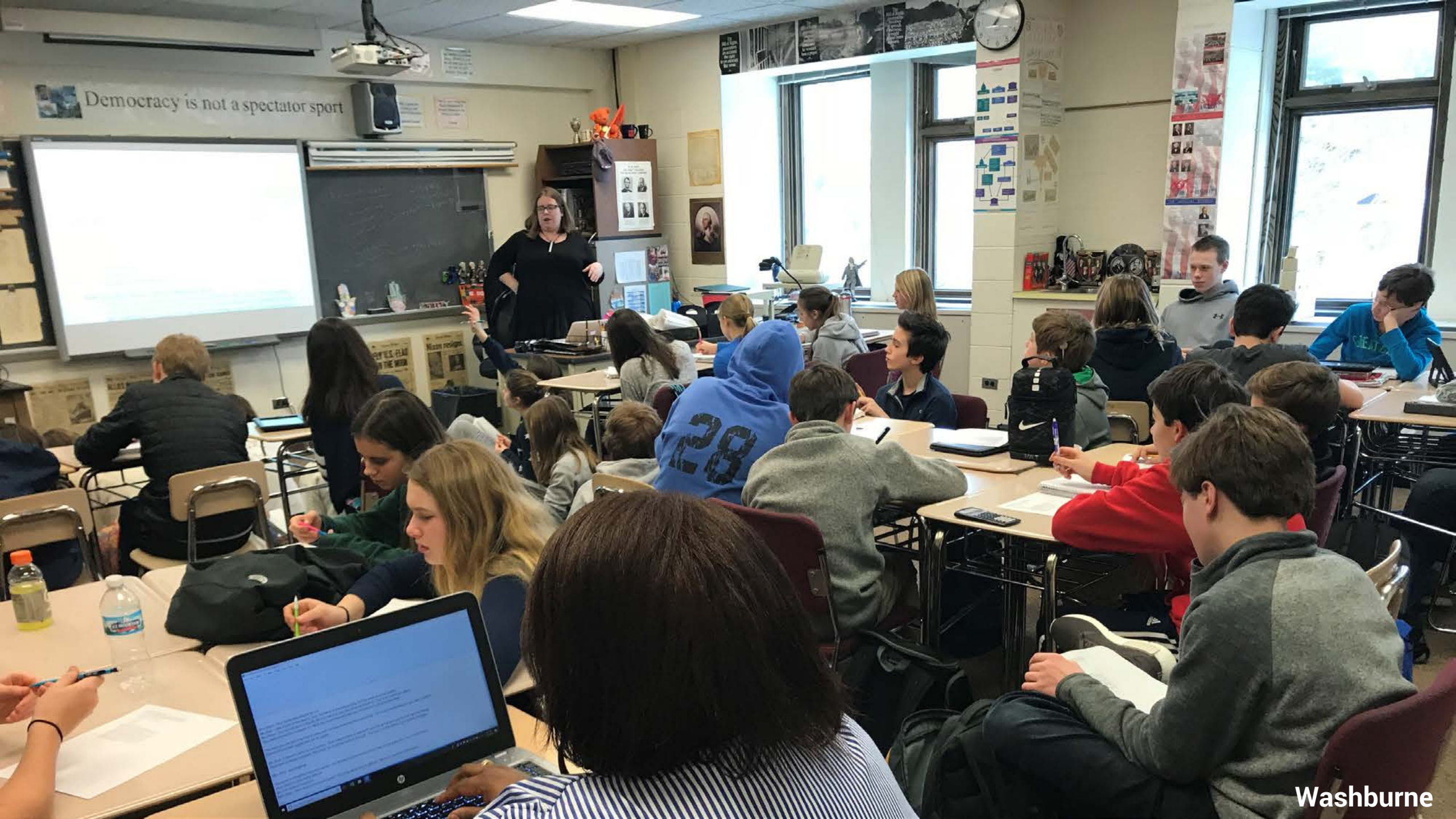



Dickinson Middle School (ND)





Grade Configuration Research

Major Themes

**Vulnerability of
Middle School
Years**

**Perception of
Transition**

**Identity of School
Community**

**Parity of
Environment &
Developmental
Needs**



Neighboring District Configurations

Wilmette (District 39)



Glencoe (District 35)



Sunset Ridge (District 29)



Glenview (District 34)



Avoca (District 37)



Kenilworth (District 38)



New Trier High School



Based on the January 2018 “Initial Planning Survey” the top priorities for Staff are:

STAFF PRIORITIES

1. Class Size Guidelines (58%)
2. Future-Focused Educational Design (46%)
3. Thermal Comfort (44%)

(228 staff respondents)

Based on the January 2018 “Initial Planning Survey” the top priorities for Community are:

COMMUNITY PRIORITIES

- 1.Future-Focused Educational Design (64%)
- 2.Class Size Guidelines (61%)
- 3.School Safety & Security (36%)

(724 community respondents)



Safety & Security

We continue to find ways to improve and enhance safety in partnership with Winnetka Police and Fire Departments.

Police and Fire Departments are already actively involved in the Future Ready D36 planning process.

All concepts presented tonight have been shared and discussed with the Police and Fire Departments.



**FUTURE
READY
D36**

Honoring our past.
Planning our future.

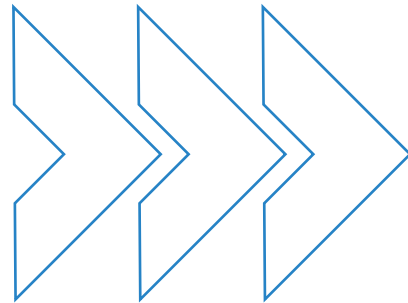

Concepts

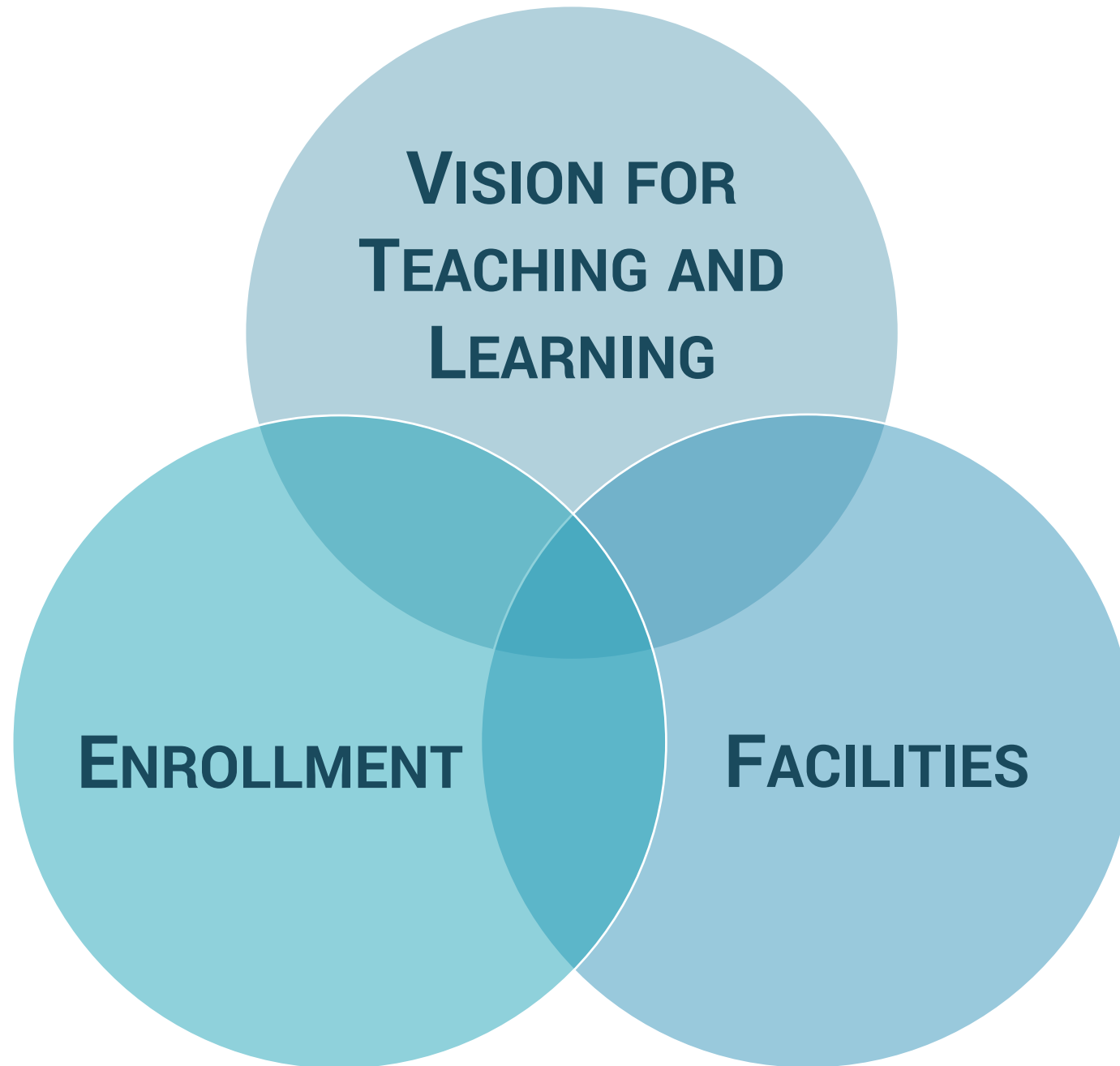

Continuum of Concepts



Continuum of Concepts



Maintain

How can our current facilities be updated in a way that accommodates enrollment balancing?

This represents a concept to strictly balance enrollment with adequate facilities.

Enhance

How can our current facilities be updated in a way that has neighborhood schools and includes some Future Ready space?

This represents a concept to balance enrollment and introduce Future Ready spaces in the District.

Transform

How can we transform our facilities to maximize access to Future Ready space and minimize future enrollment issues?

This represents a complete reconfiguration of the District.



**FUTURE
READY
D36**

Honoring our past.
Planning our future.



Maintain, Enhance or Transform?

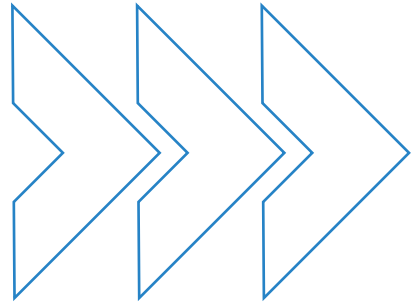

All Concepts Include:



Facilities

- *Physical Condition Items Addressed*
- *Safety & Security Enhancements to Existing Schools*
- *Improved ADA Accessibility*
- *Reduced Number of Facilities*



Enrollment

- *Attendance Boundaries: A shift from current boundaries is required*



Vision for Teaching and Learning

- *Transitions: Reduced transitions between schools during a child's K-8 experience*
- *Grade Level Reconfiguration*



**FUTURE
READY
D36**

Honoring our past.
Planning our future.

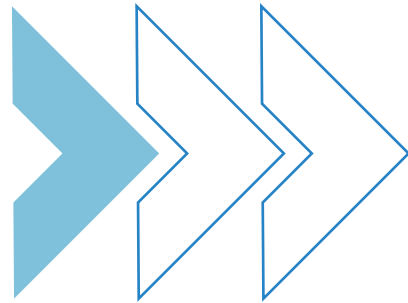

Maintain



Maintain

Four Schools; One Transition

- Three K-4 elementary schools
 - *Crow Island: ~300 students*
 - *Greeley: ~250 students*
 - *Hubbard Woods: ~275 students*
- Washburne becomes 5-8
 - *~790 students*
- Decommission Skokie
 - *Rent or repurpose*



Facilities

- Decommissioning The Skokie School (rent or repurpose)
- Cafeterias and/or Kitchens at elementary schools



Enrollment

- Neighborhood Schools: Neighborhood elementary schools are maintained



Vision for Teaching and Learning

- Future Ready: No
- Class Sizes: Current class size guidelines cannot be guaranteed at Elementary Schools
- Transitions: Grade level reconfiguration results in one transition
- Thermal Comfort: Thermal comfort addressed by upgrading existing systems (adding AC)
- Expanded Kinetic Wellness spaces at Crow Island and Washburne

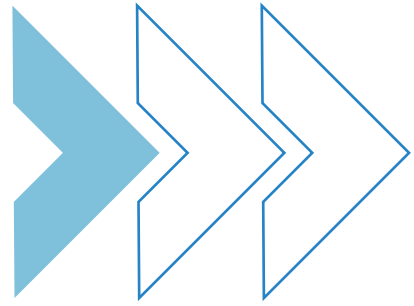

Maintain: Washburne

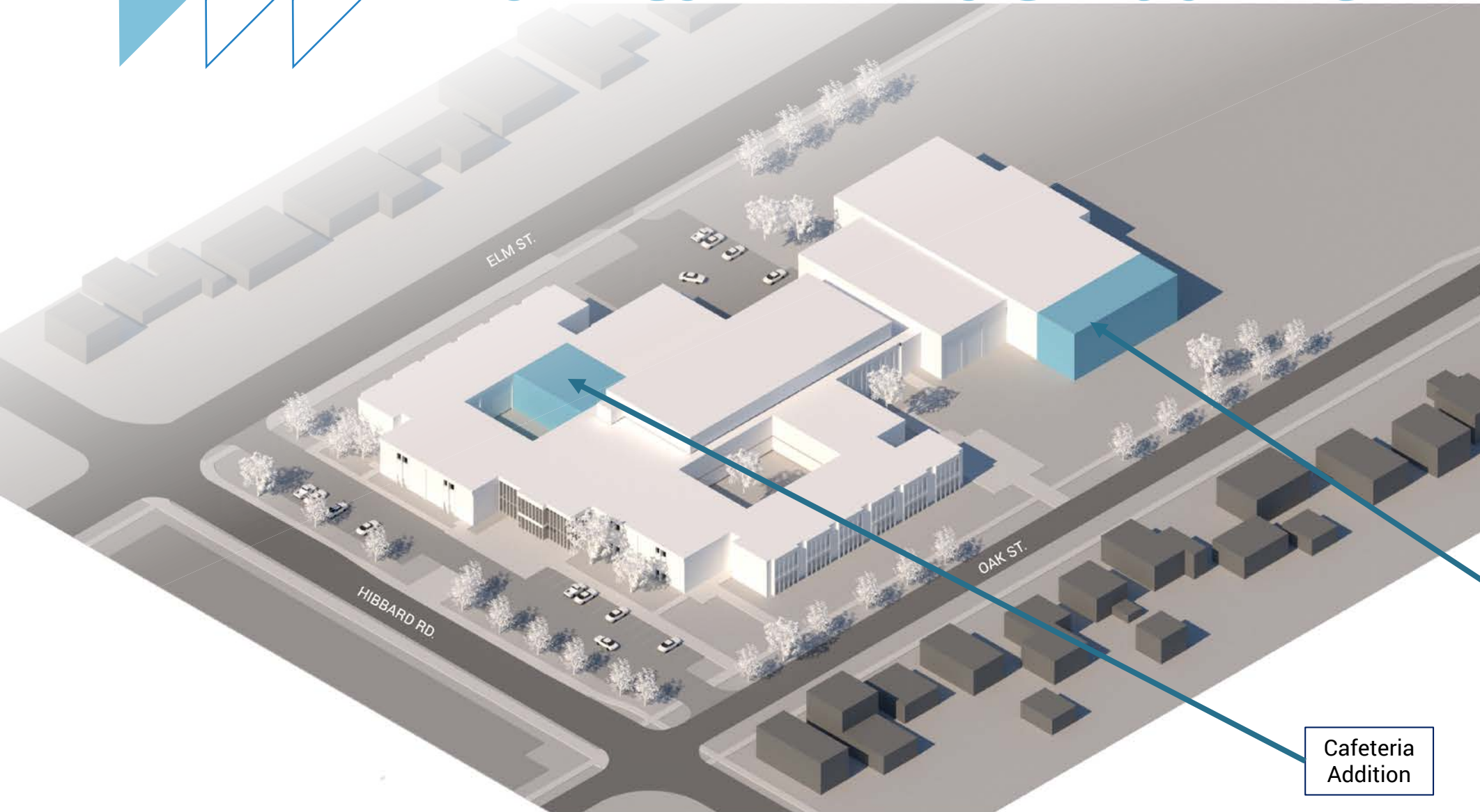

How will two additional grades fit at Washburne?

Washburne currently serves ~55% of its optimal capacity.

Some spaces may need to be shared, which is a change from the way Washburne is currently used.

Kinetic Wellness Addition

Cafeteria Addition

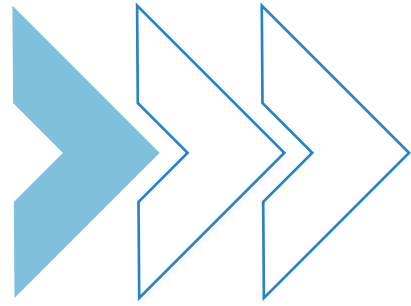

Maintain: Crow Island

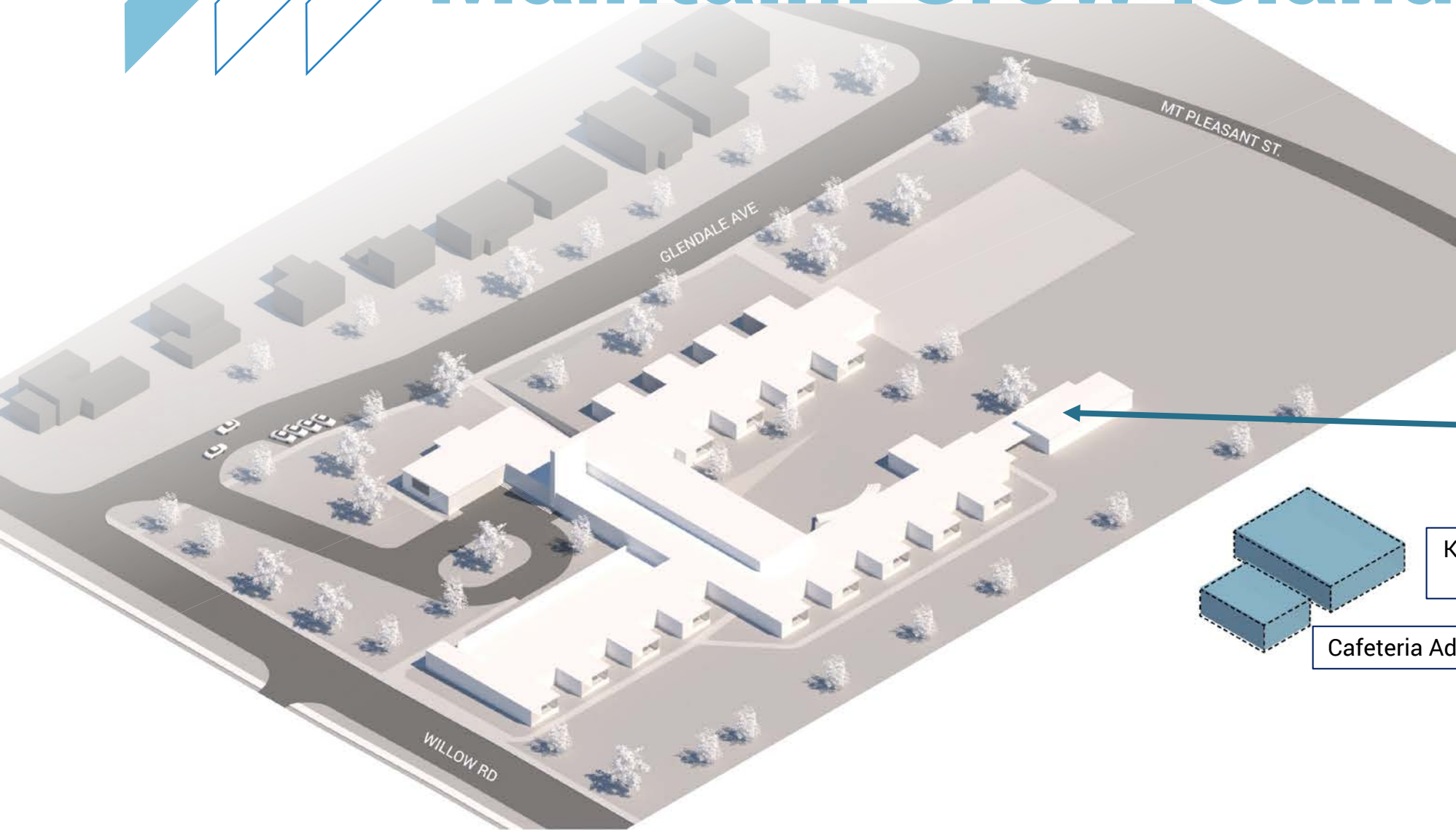

Due to Crow Island School's status as a National Historic Landmark building, necessary additional square footage is shown in amount only. Any additions to Crow Island would need to be designed in a historically appropriate and sensitive manner.

Temporary classroom (TACO) could be decommissioned with a return to more shared space

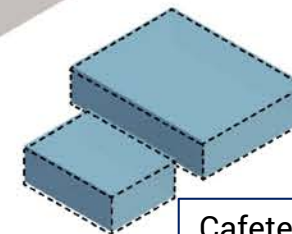

Kinetic Wellness Addition

Cafeteria Addition

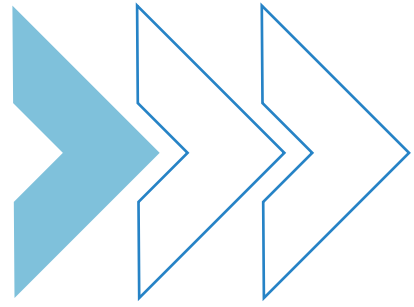

Maintain: Greeley

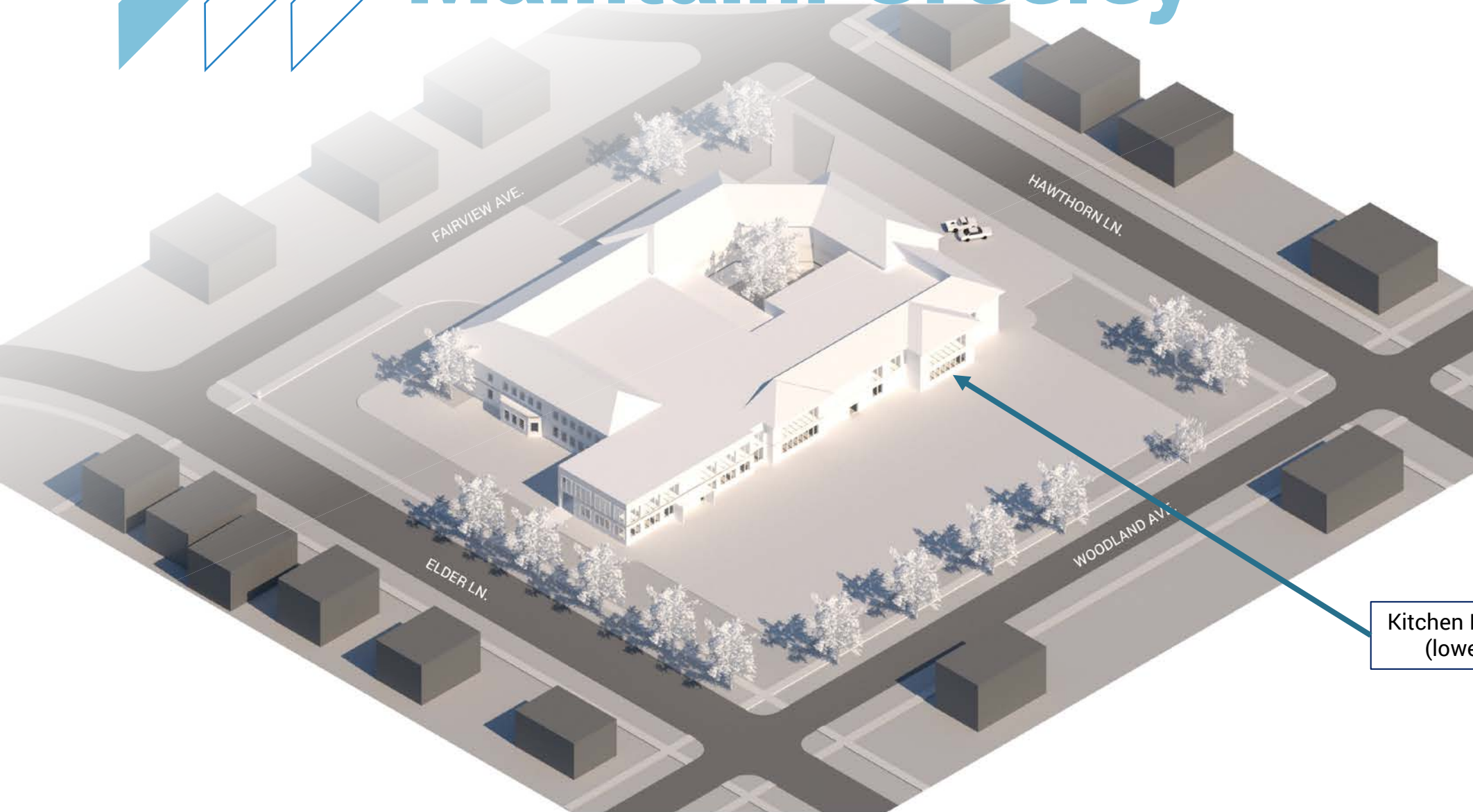

Kitchen Renovation
(lower level)

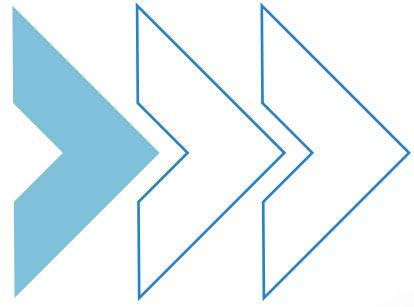

Maintain: Hubbard Woods

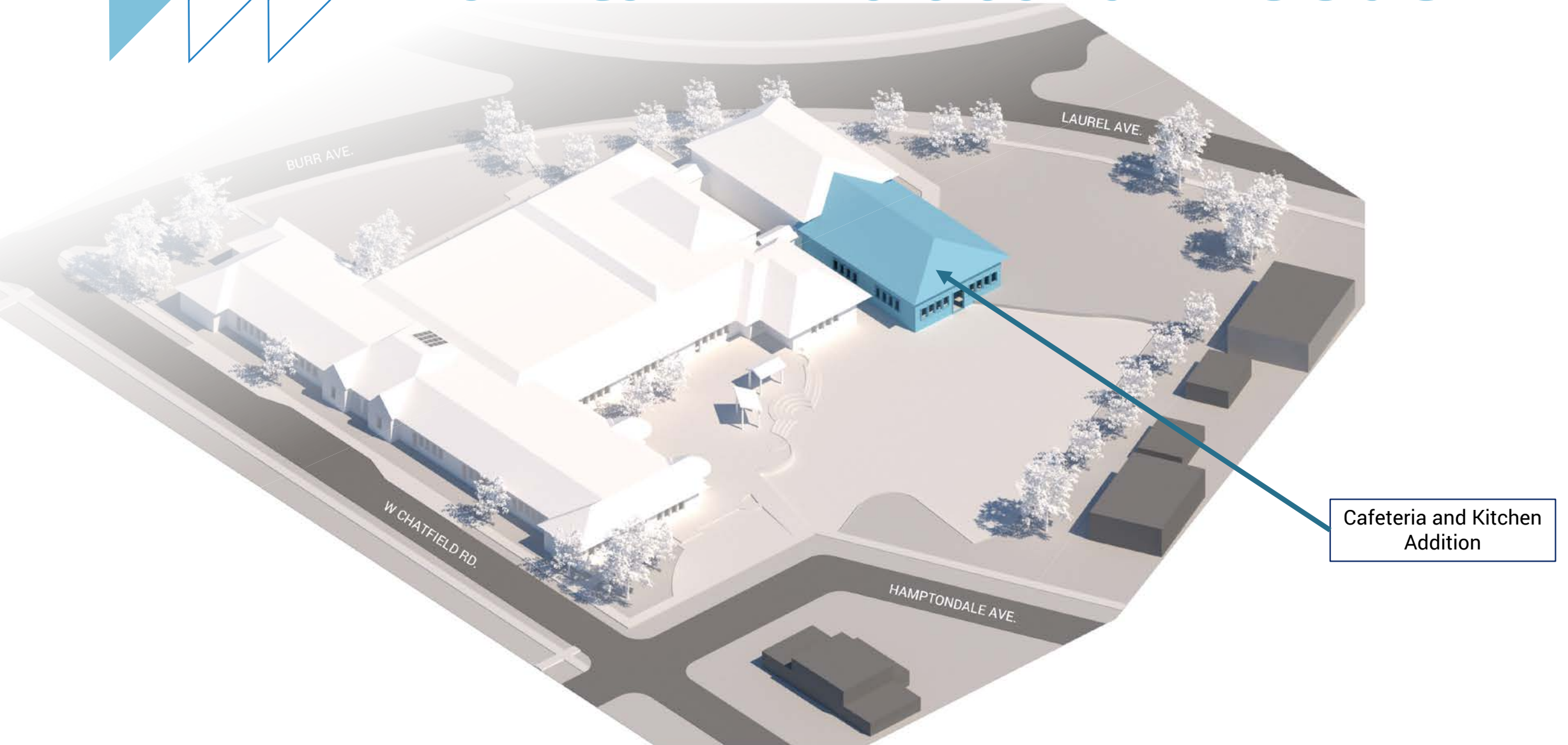



**FUTURE
READY
D36**

Honoring our past.
Planning our future.



Enhance



Enhance

Four Schools; One Transition

- Three K-3 elementary schools
 - *Crow Island: ~250 students*
 - *Greeley: ~225 students*
 - *Hubbard Woods: ~225 students*
- Washburne becomes 4-8 with additions and renovations
 - *~965 students*
- Skokie reduced to auditorium only, preserved as community facility

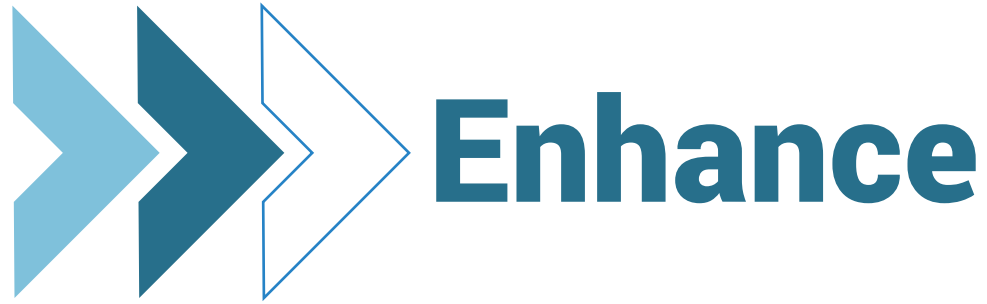

Facilities

- Demolish north and south wings of The Skokie School; auditorium and community space preserved for community use
- Cafeterias and/or Kitchens at elementary schools
- Additions and renovations to Washburne
- Traffic flow improved with additional drop-off points



Enrollment

- Neighborhood Schools: Neighborhood elementary schools are maintained



Vision for Teaching and Learning

- Future Ready: Washburne (4-8)
- Class Sizes: Current class size guidelines can be upheld
- Transitions: Grade level reconfiguration results in one transition
- Thermal Comfort: Thermal comfort can be addressed by upgrading existing systems (adding AC)
- Expanded Kinetic Wellness spaces at Crow Island and Washburne



Enhance: Washburne

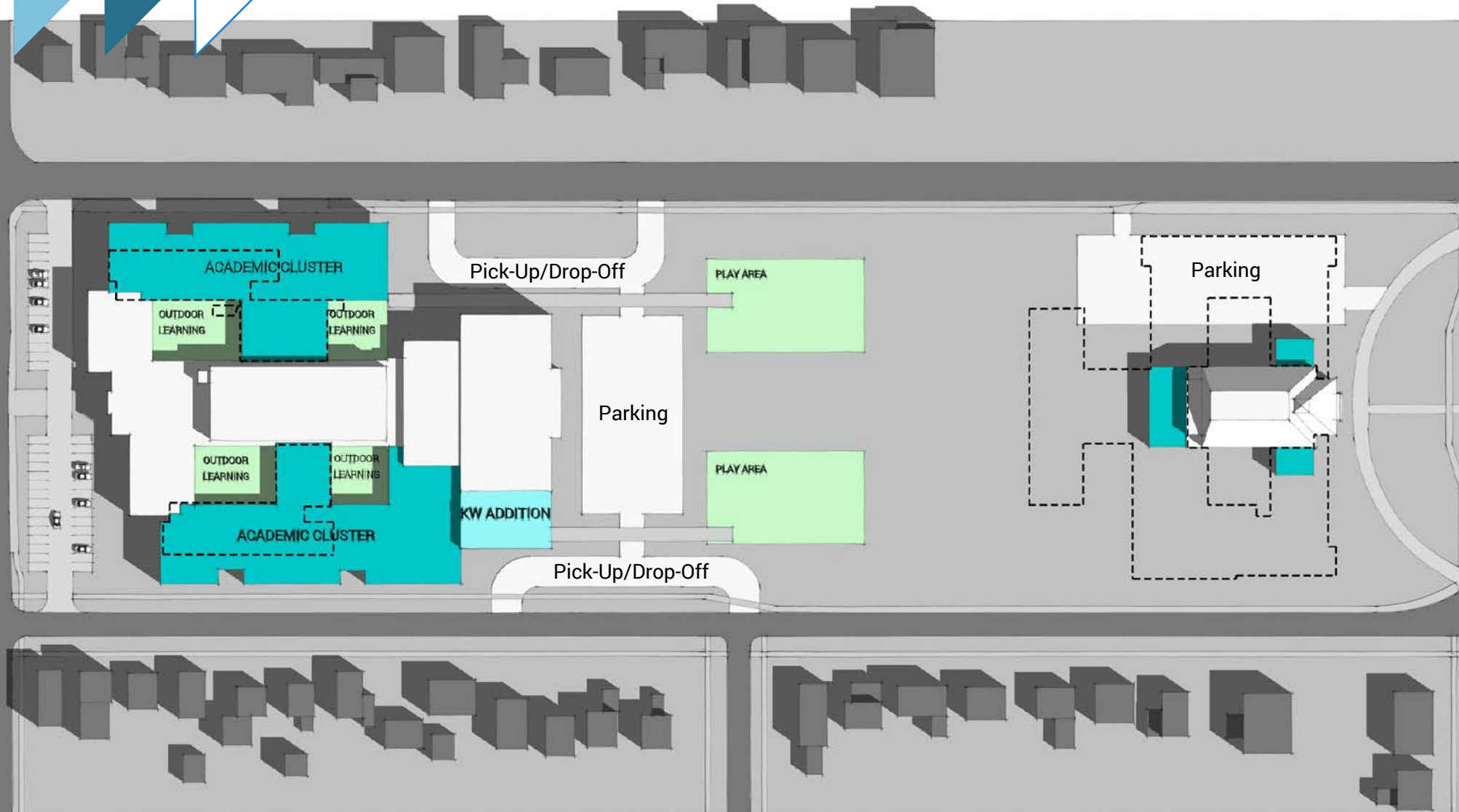

Existing
Building
Footprint

Existing
Building

Planned
Expansion
/Addition

Outdoor
Play &
Learning*

*Outdoor play and learning spaces would be designed to be developmentally appropriate for grades in the adjacent classrooms.



Enhance

**Proposed Concept:
Future Ready
Washburne (Grades 4-8)**

[Click here to view video](#)

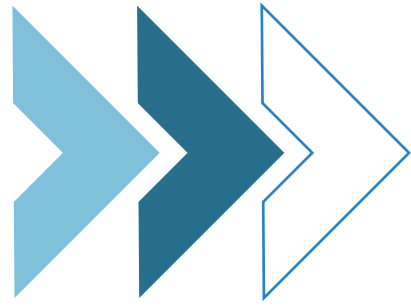

Enhance: Crow Island

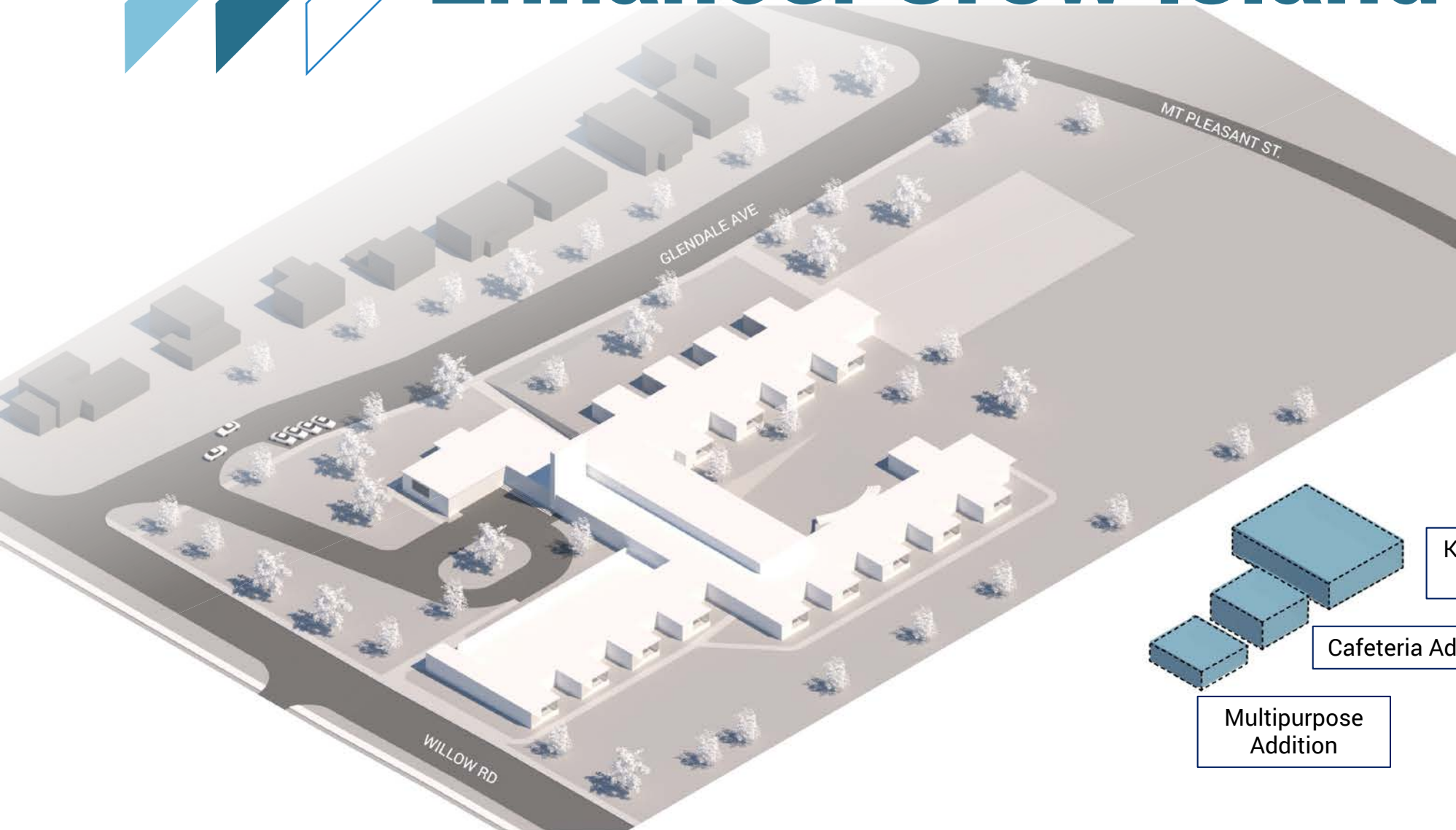

Due to Crow Island School's status as a National Historic Landmark building, necessary additional square footage is shown in amount only. Any additions to Crow Island would need to be designed in a historically appropriate and sensitive manner.

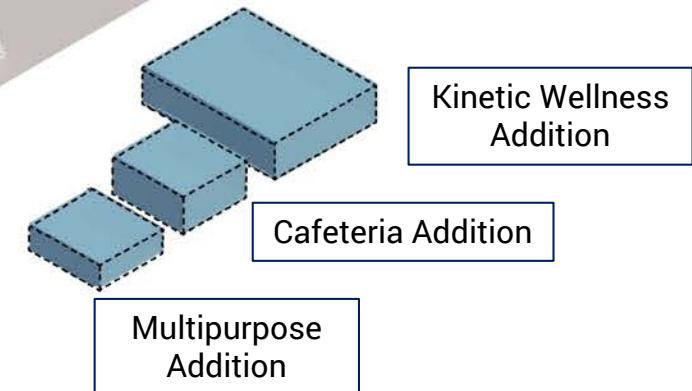

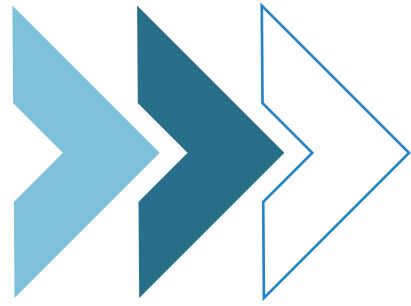

Enhance: Greeley

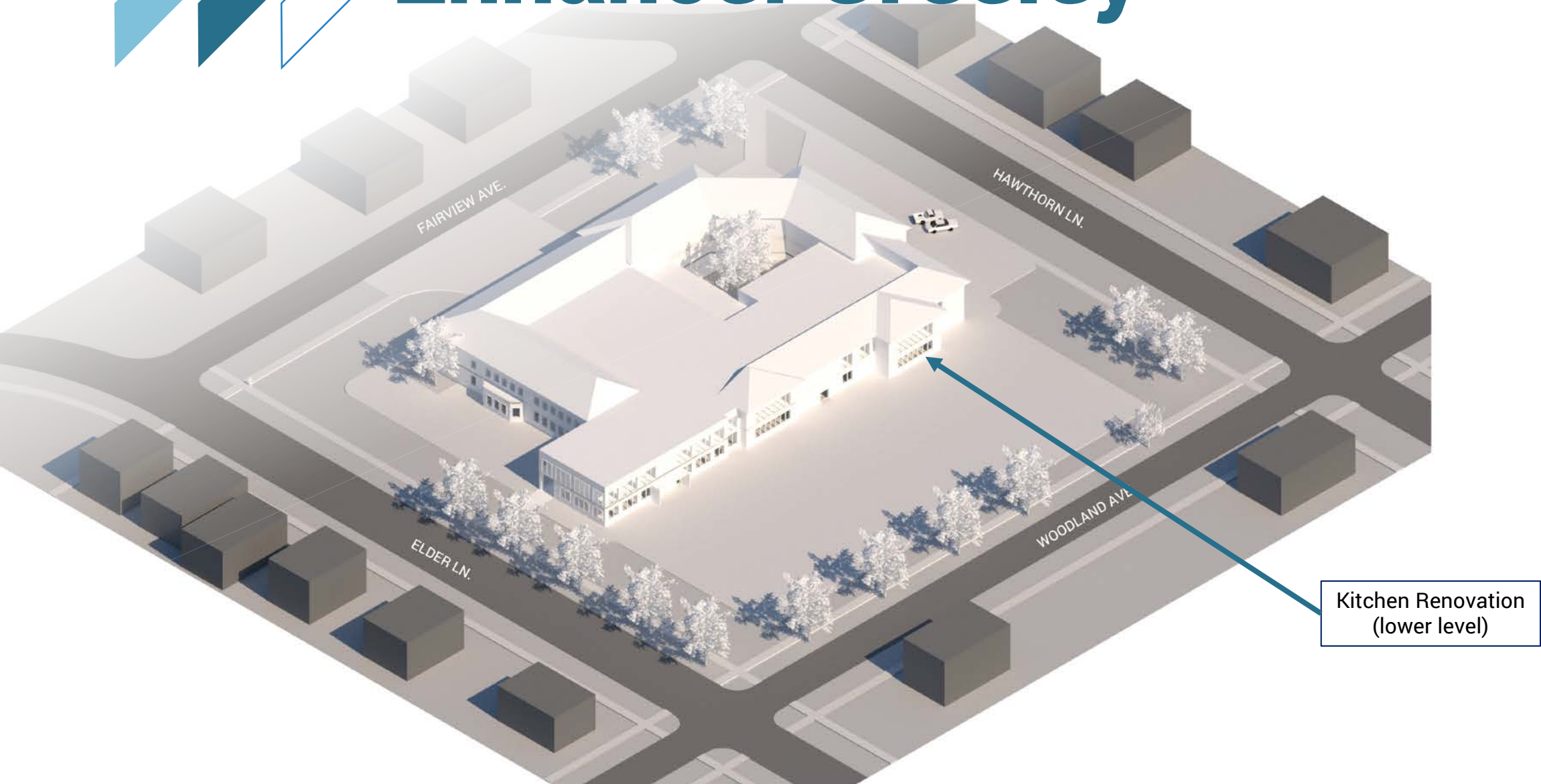

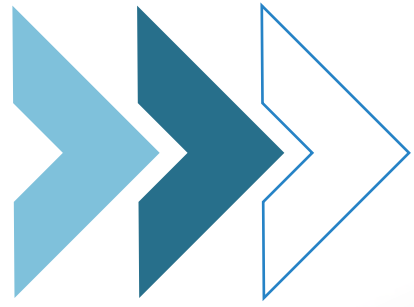

Enhance: Hubbard Woods

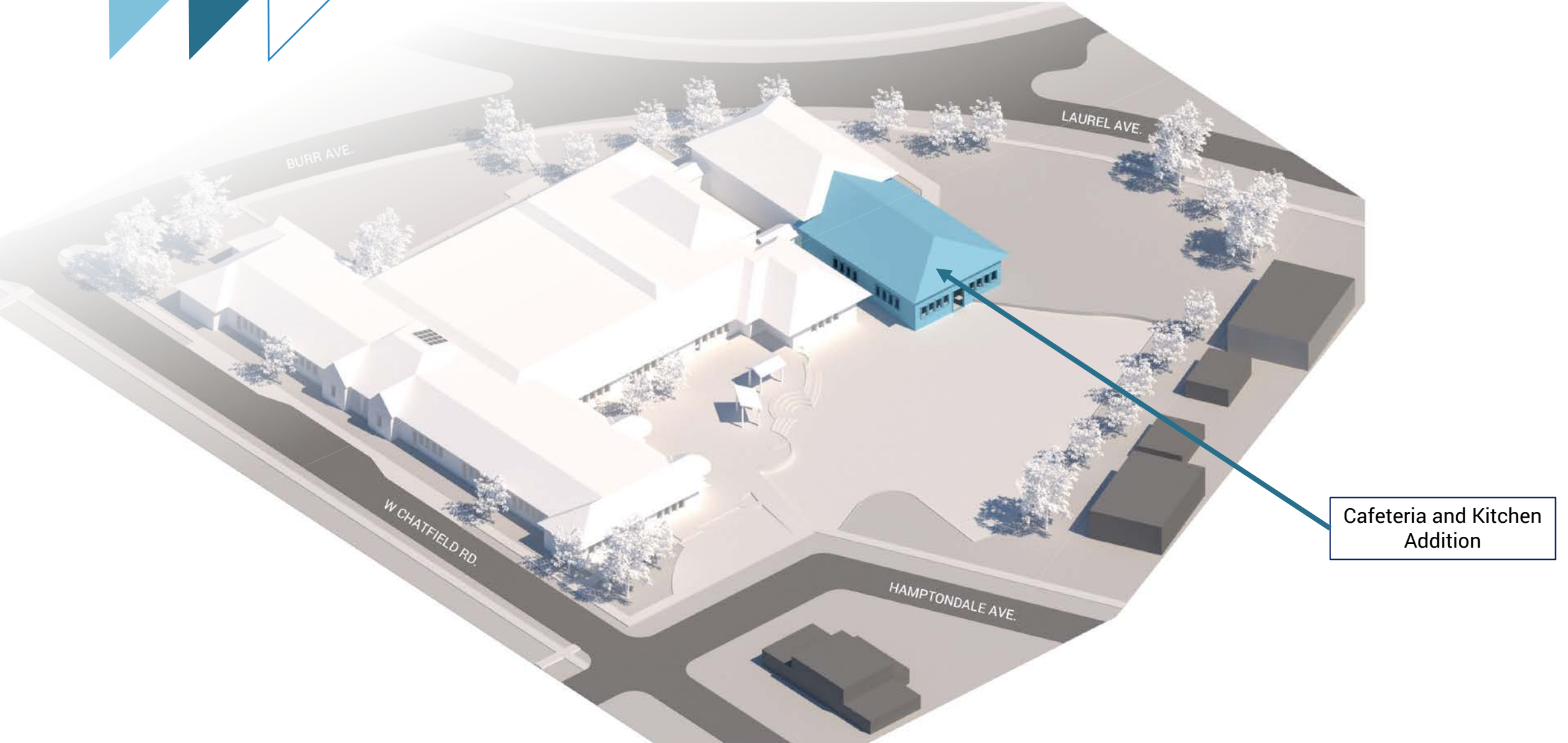



**FUTURE
READY
D36**

Honoring our past.
Planning our future.



Transform



Transform

Two Schools; One Transition

- One K-1 center at Crow Island
- New 2-8 Center constructed at Skokie site
- Washburne gymnasium preserved as community facility
- Decommission Greeley and Hubbard Woods
 - *Rent or repurpose*



Transform



Facilities

- Improved Safety & Security: New 2-8
- Universal Accessibility: New 2-8
- Traffic flow diverted from main road with pick-up/drop-off circle



Enrollment

- Neighborhood Schools: No neighborhood elementary schools
- One Winnetka school community



Vision for Teaching and Learning

- Future Ready: All students attend Crow Island for K-1 and Future Ready New 2-8 at Skokie site
- Class Sizes: Current class size guidelines upheld
- Transitions: Grade level reconfiguration results in one transition
- Thermal Comfort: Thermal comfort can be addressed in an optimal way in New 2-8, and AC would be added to Crow Island.
- Expanded Kinetic Wellness space and multipurpose at Crow Island



Transform: Skokie

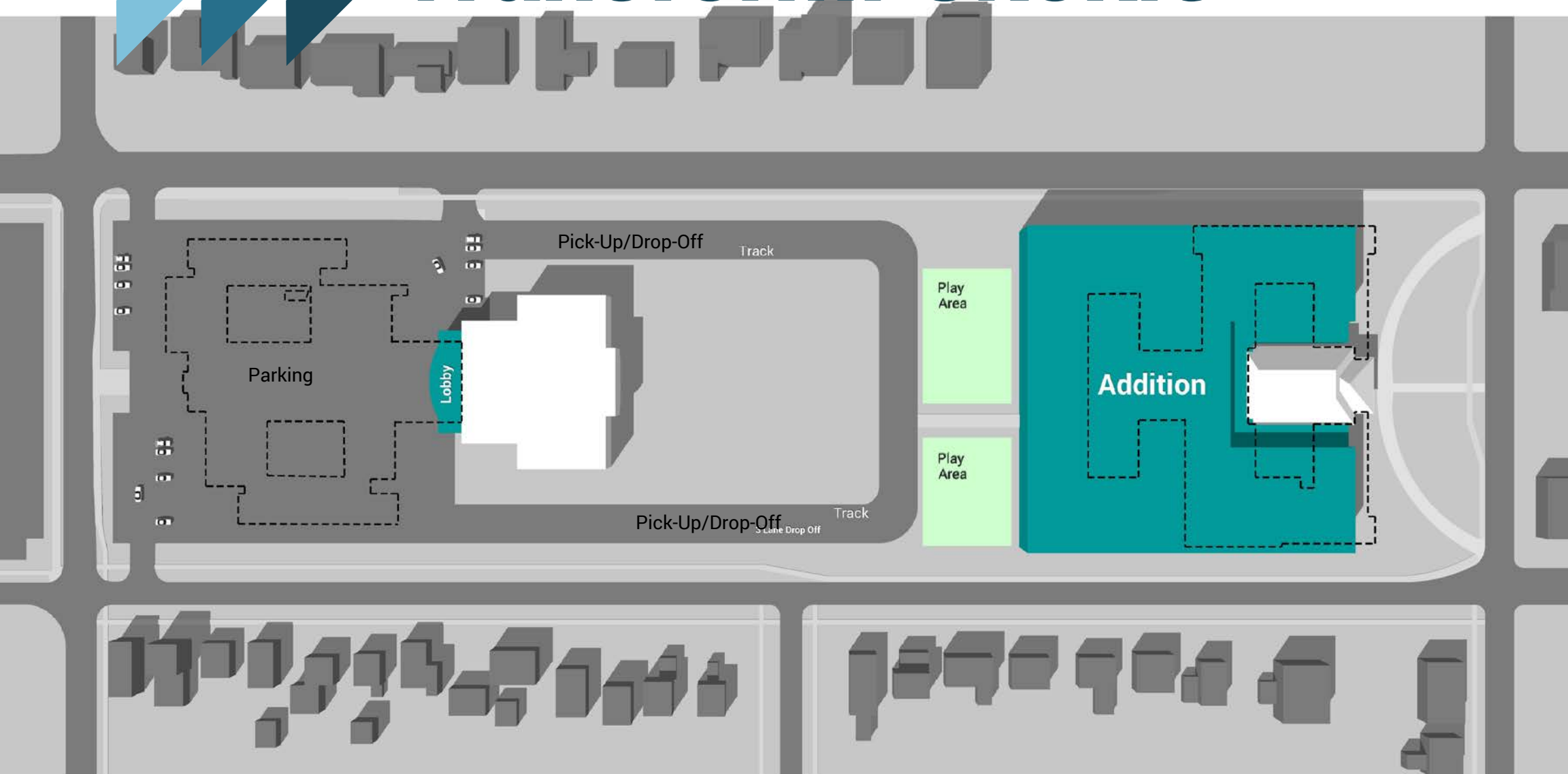

Existing Building Footprint

Existing Building

Planned Expansion / Addition

Outdoor Play & Learning*

*Outdoor play and learning spaces would be designed to be developmentally appropriate for grades in the adjacent classrooms.



**Proposed Concept:
Future Ready 2-8 at
Skokie School**

[Click here to view video](#)



Transform: Crow Island

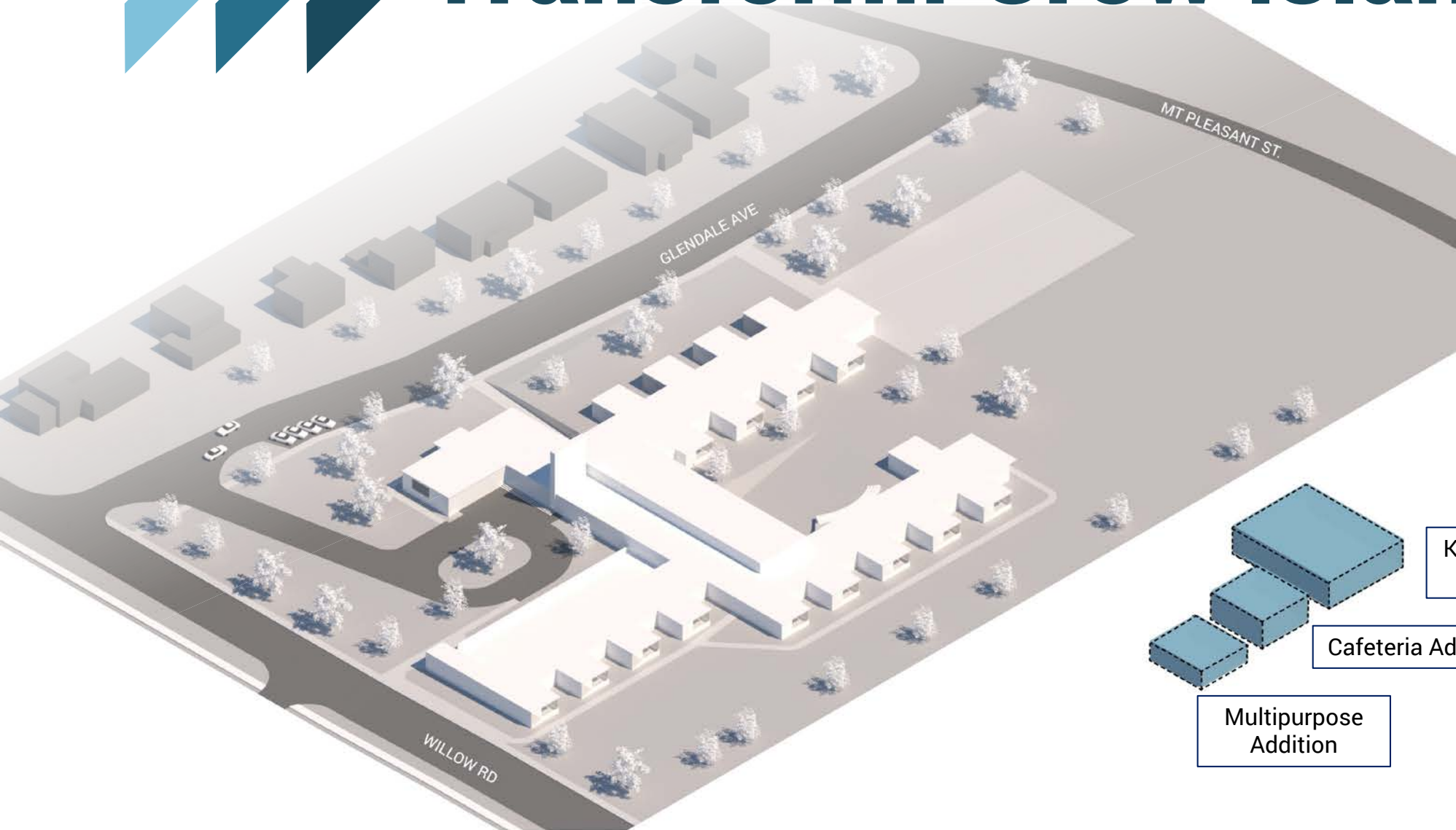

Due to Crow Island School's status as a National Historic Landmark building, necessary additional square footage is shown in amount only. Any additions to Crow Island would need to be designed in a historically appropriate and sensitive manner.

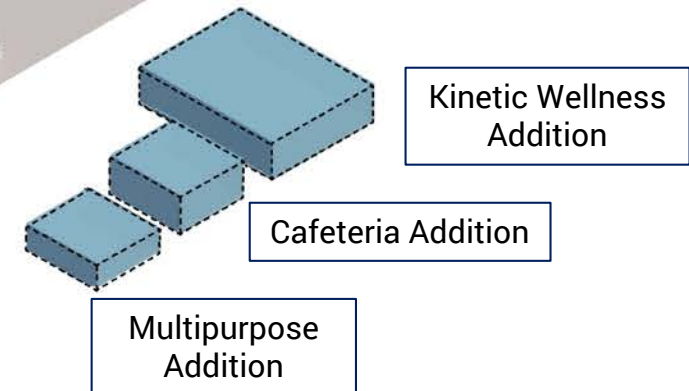



**FUTURE
READY
D36**

Honoring our past.
Planning our future.



Maintain, Enhance or Transform?

Given the **considerable estimated cost** to repair our current buildings, we have to stop and ask:

What is the best way to invest for the future?

Phase I

A physical assessment of all District 36 facilities took place in July 2017

- Health Life Safety Items \$13,559,974
- HVAC (exclusive of A/C) \$3,099,137
- Accessibility \$4,447,383
- Cosmetic \$1,314,275

Total: \$22.4M (1,364 items, minor to major)

Total with A/C: \$33.7M-\$38.2M



Redistrict to Balance Enrollment
(3) K-4 Elementary Schools
(1) 5-8 at Washburne



Redistrict to Balance Enrollment
(3) K-3 Elementary Schools
(1) 4-8 at Washburne



Eliminate Boundaries with
Grade Level Centers
(1) K-1 at Crow Island
(1) 2-8 Center New at Skokie

Concept Comparison

	Shift Attendance Boundaries?	Neighborhood Elementary Schools?	Maintain Class Size?	School Transitions (at grade levels)	Future Ready	Enhanced Safety & Security	Thermal Comfort	Improved ADA Access	Cost to Build (Year 1)	Cost Over Time (Years 2-30)	OM&E (Years 2-30)
Baseline	Yes	Yes	No	4 th →5 th 6 th →7 th		✓		✓	\$	\$\$\$\$\$	+\$
Maintain	Yes	Yes	No	4 th →5 th		✓	✓	✓	\$\$\$	\$\$\$\$	-\$
Enhance	Yes	Yes	Yes	3 rd →4 th	✓✓	✓✓	✓✓	✓✓	\$\$\$	\$\$\$	-\$
Transform	Yes	No	Yes	1 st →2 nd	✓✓✓	✓✓✓	✓✓✓	✓✓✓	\$\$\$\$	\$\$	-\$
Reach	Yes	?	?	?	✓✓✓	✓✓✓	✓✓✓	✓✓✓	\$\$\$\$\$	\$\$	-\$

✓ = Good ✓✓ = Better ✓✓✓ = Best

Potential Timeline of Concepts



Maintain

2-6 years

Enhance

5 years

Transform

3 years

March 2018

- Share concepts with board and community
- Gather feedback to inform the next iteration
- Refine concepts

April-June 2018

- Continue refining concepts
- Gather board and community feedback on next versions

June 2018

- Educational Master Facility Plan recommendation to School Board

Upcoming Engagement Opportunities:

Community meetings on March 16th (9:30 AM) and 22nd (7:00 PM)

Community survey at www.winnetka36.org

Email comments to futureready@winnetka36.org



**FUTURE
READY
D36**

Honoring our past.
Planning our future.

Board Discussion